

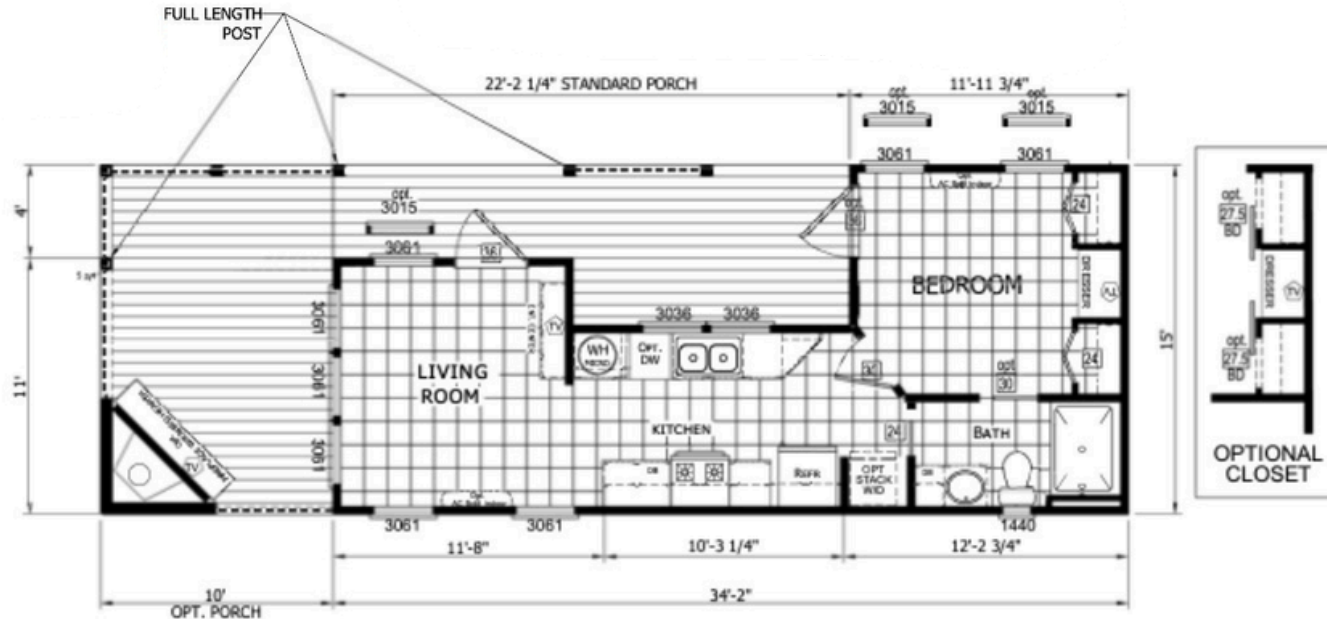

**FACTORY SHOWCASE  
HOMES**

**WWW.FACTORYSHOWCASEHOMES.COM**

**682-400-8590**



**MODEL APH-520-Monoslope**  
1 BEDROOM, 1 BATH  
ACTUAL SIZE: 15' x 33'-6"  
TOTAL AREA: 399.8

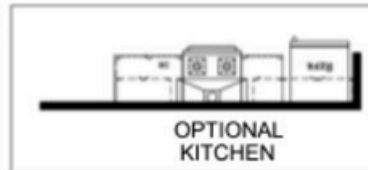

**Starting at:**

\$ \_\_\_\_\_

**Good till:**

\_\_\_\_\_

**Base price includes delivery within 100 miles, heat & air system, stainless steel electric coiled oven range & stainless steel 18 cf fridge.**

**ANSI 119.5 & RVIA inspected and certified.**

**\*Due to continuous improvements, productspecifications,andcurrentmarketingpricingfloorplans/pricing are subject to change without notice\***

# Factory Showcase Homes

For the Park Model 520MS The Standard Floor Plan is 15' x 34'2".

It's spacious yet compact for easy living and minimal maintenance. It offers plenty of windows in the living areas, providing a bright, open view and a cheerful ambiance.

Looking through the galley kitchen windows, you see a welcoming outdoor side-entry porch that protects you from the weather on arrival and departure while adding curb appeal.

Popular options are:

-Additional clerestory windows on the deck side. Improves daylight and views from the deck area.

-Optional 10 × 15 deck. Expands the total floor plan footprint from 15' × 34'2" to 15' × 44'2".

-Wood-burning stone fireplace with optional TV accessories over the mantel, creating a cozy heat source with integrated media hookup.

-Optional 72-inch windows in place of standard 30/36-inch (3036) windows. Four larger openings to enhance light and views.

-Galley kitchen optional upgrade with a glass Euro hood. Replaces the traditional hood for a sleek, modern look.

-Several different kitchen appliance upgrades, including an optional 24-inch dishwasher.

-Tile shower to the ceiling option for a full-height tile enclosure with a clean, finished look.

-Optional pocket door from the bedroom to the bathroom, creating additional access for those who may need assistance in the shower, etc., or an optional second exterior door off the bedroom to the side porch, creating a second entry.

-Rolling barn door option with a plant shelf ledge above it. The decorative ledge adds additional storage and display area.



**FACTORY SHOWCASE**

**HOMES**