

REV.	DATE	DRWN.	CHKD.	APPRD.	REMARK
D	19-02-2019	FS			General Update
E	19-03-2019	FS			General Update
G	19-07-2019	FS			Bollard Pull

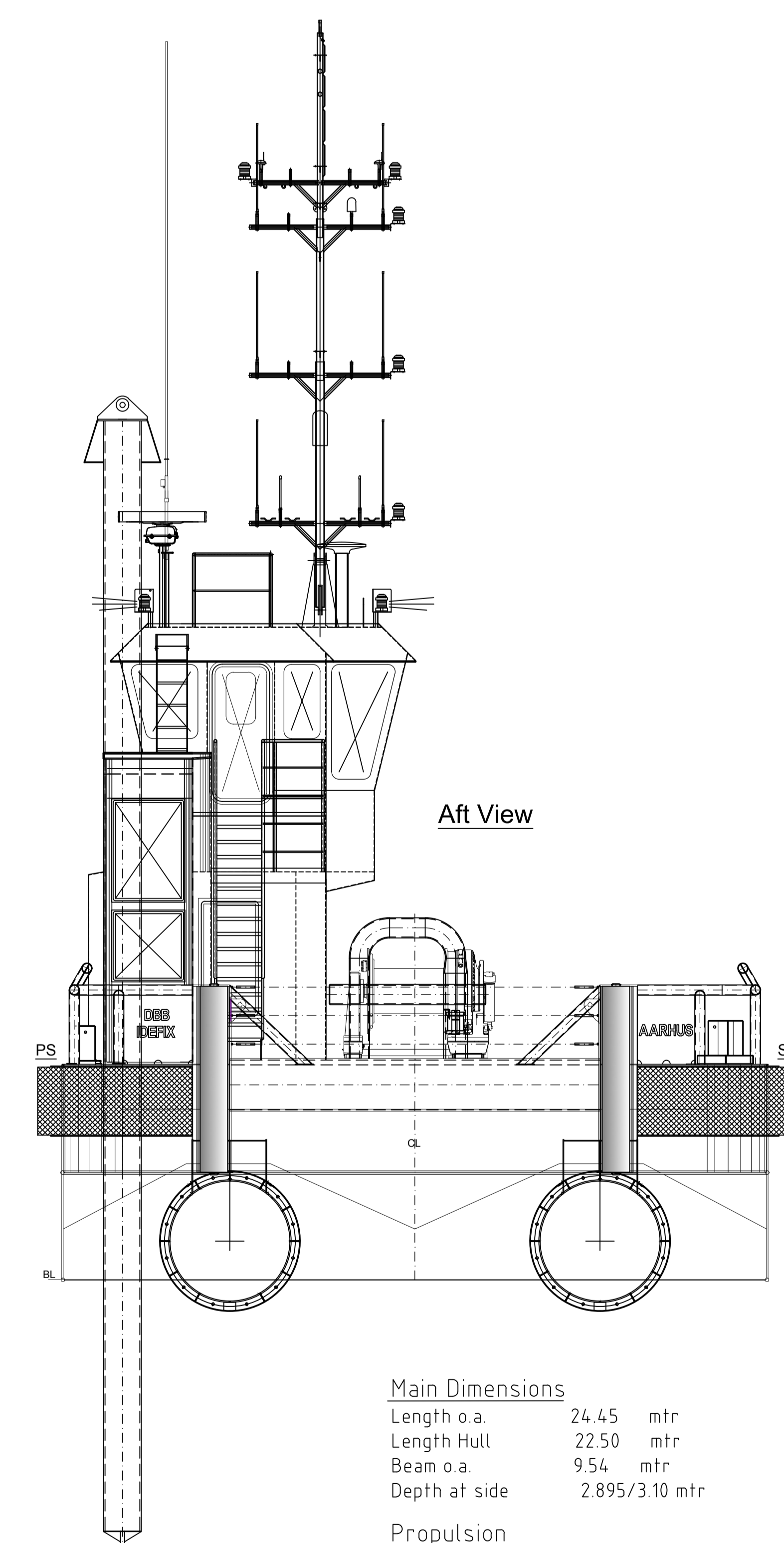

Engine Room

Accommodation

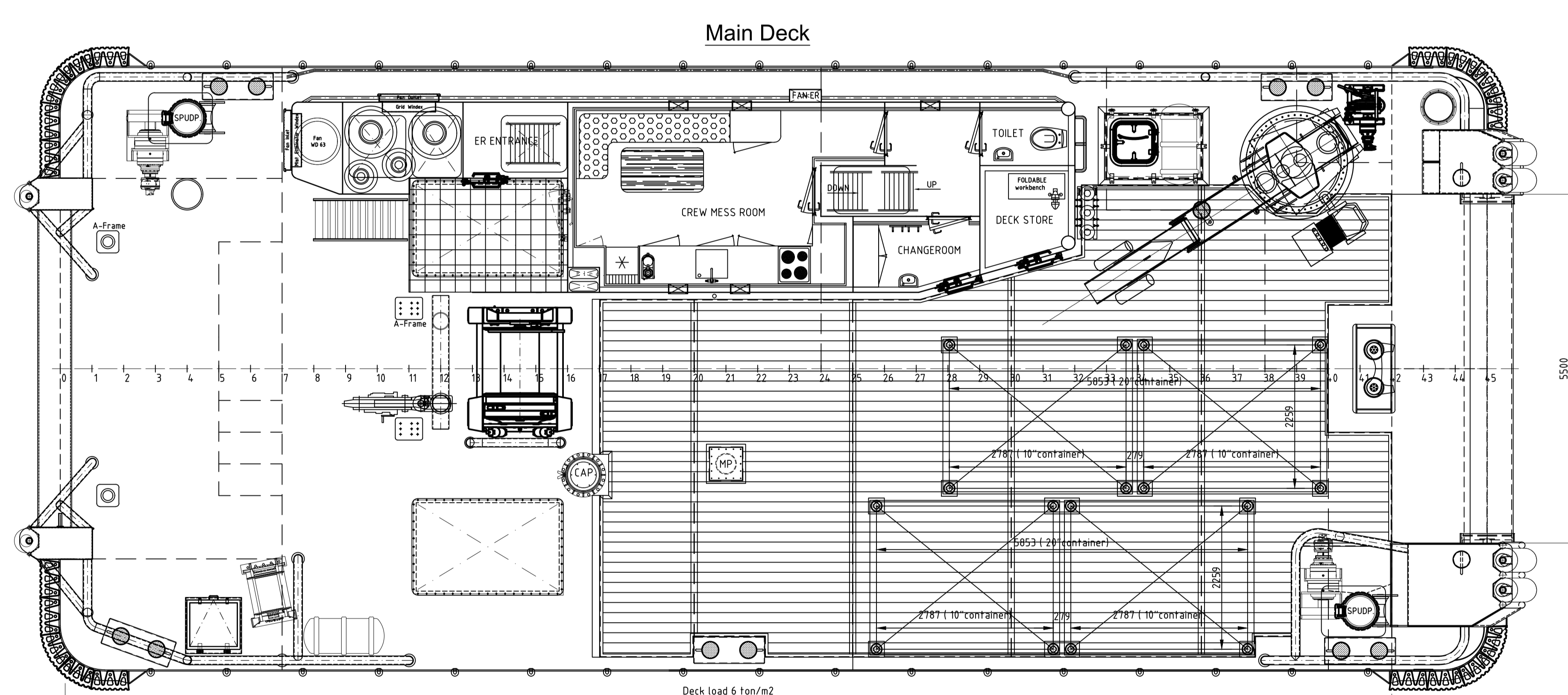
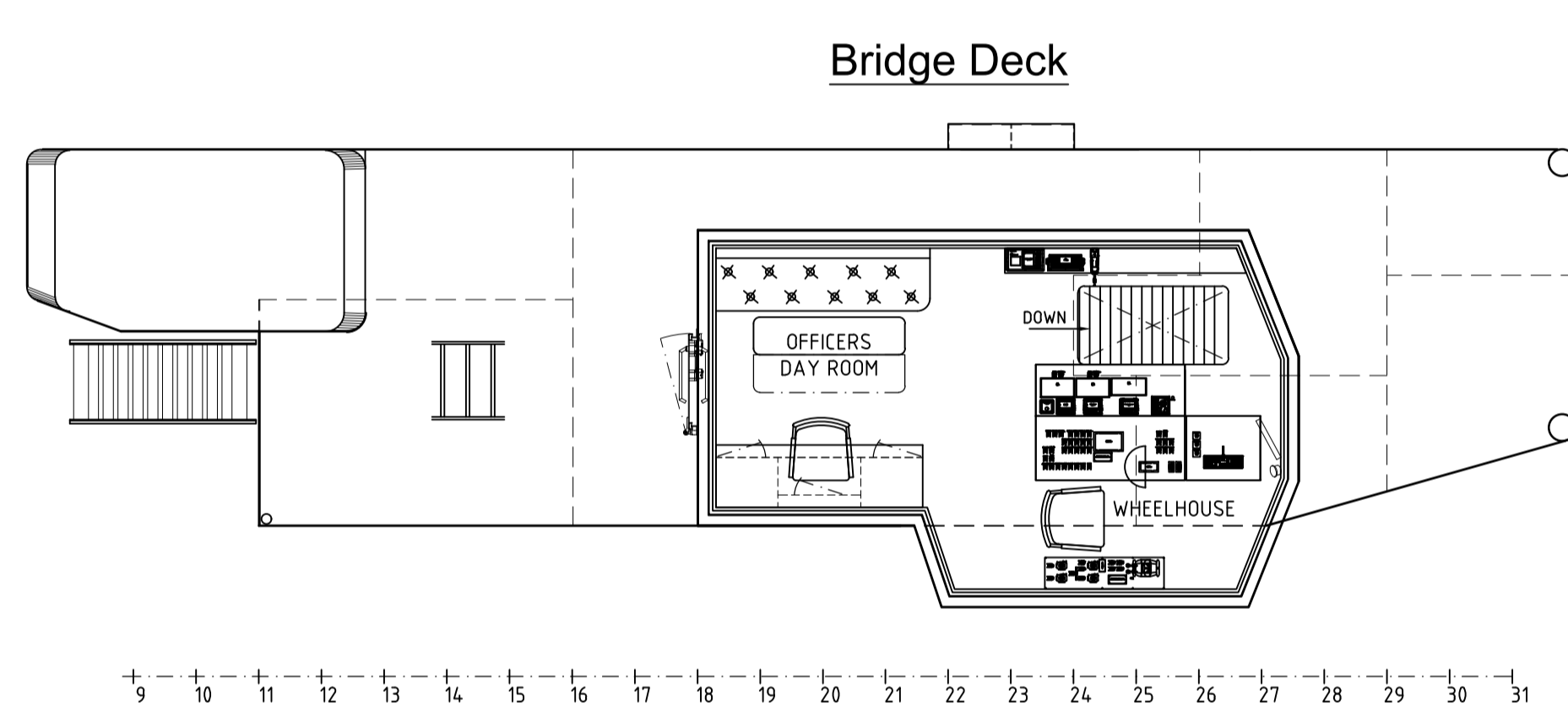
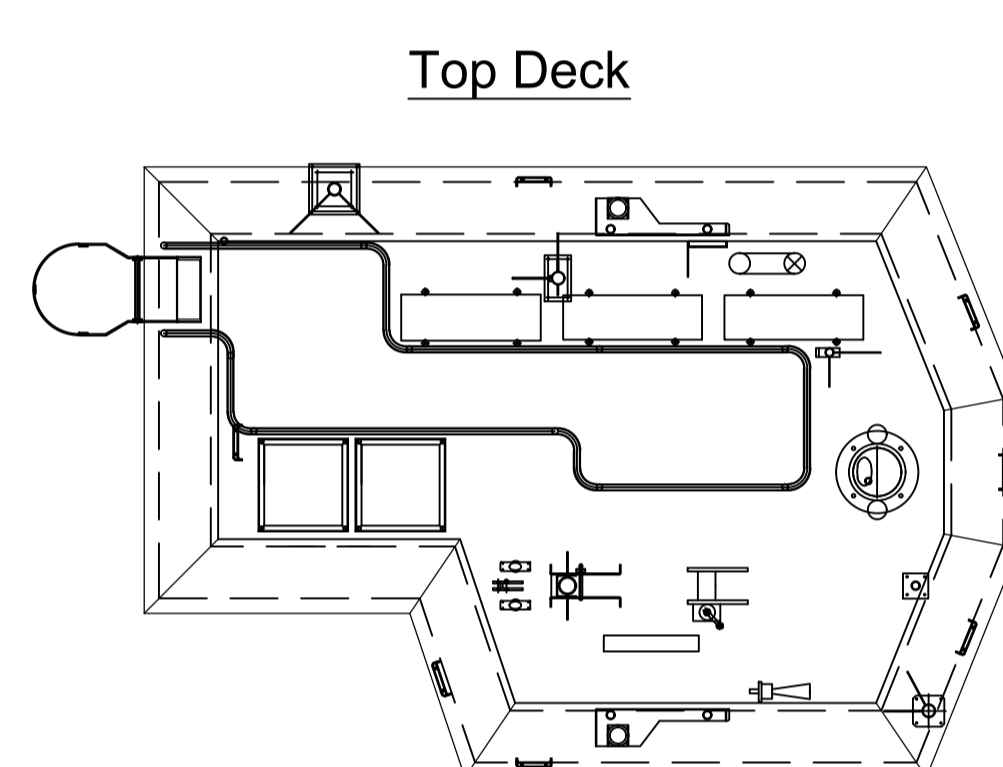
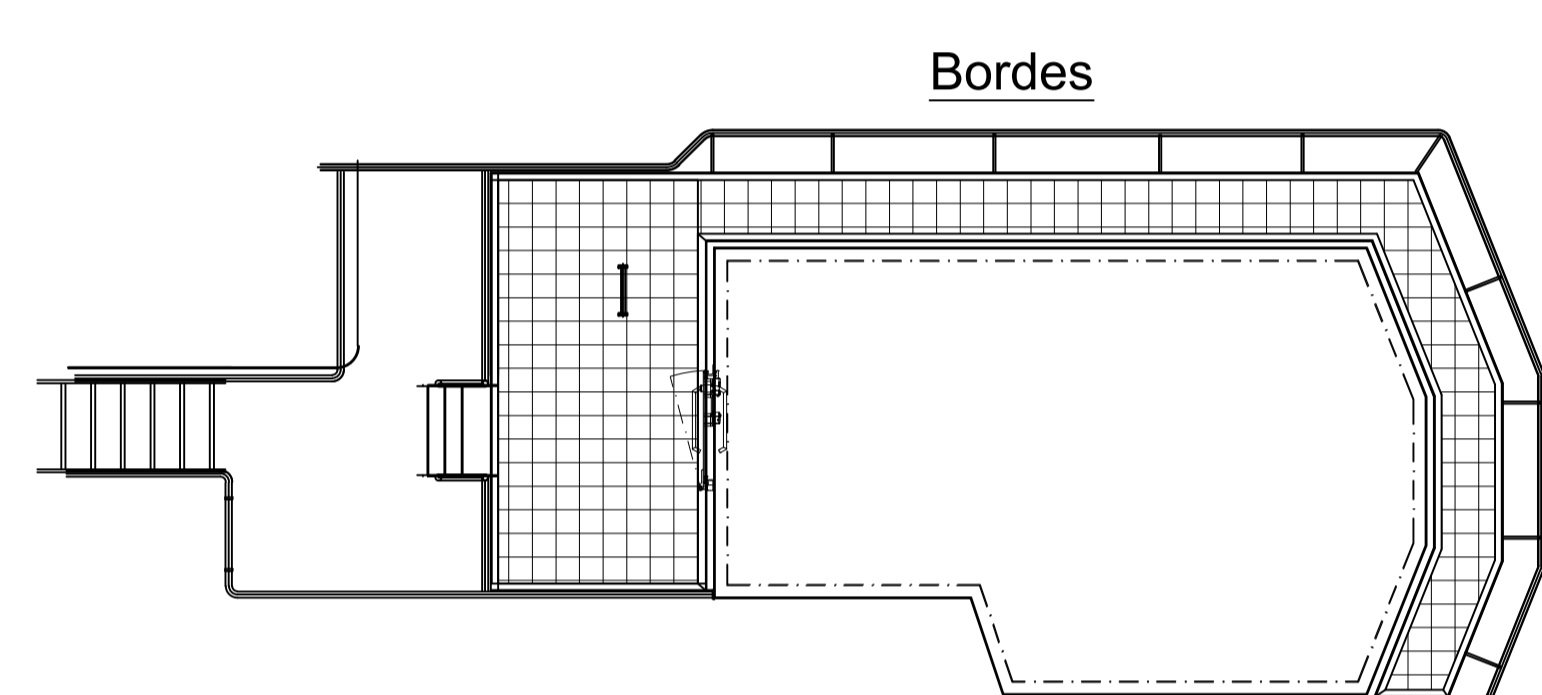
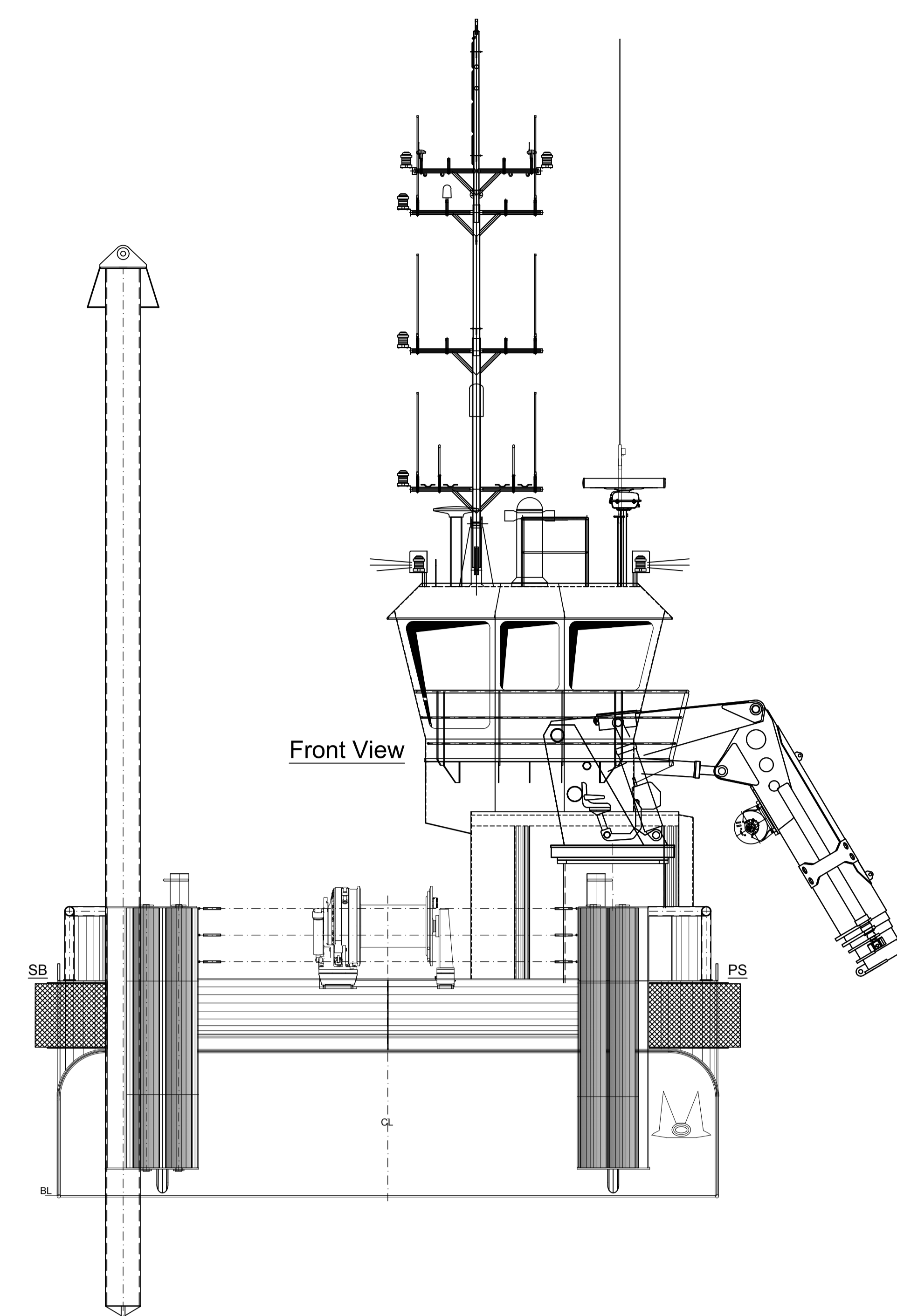
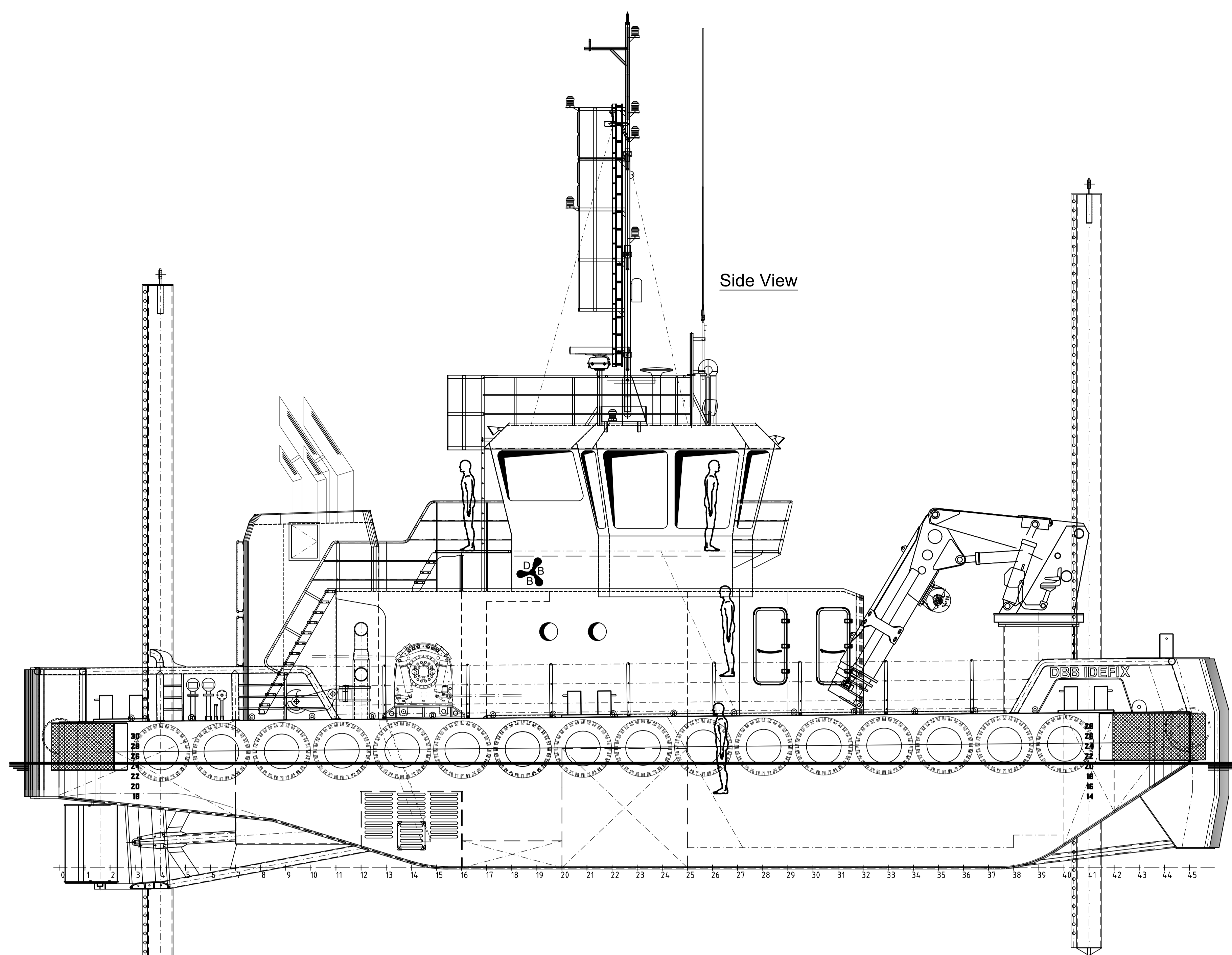
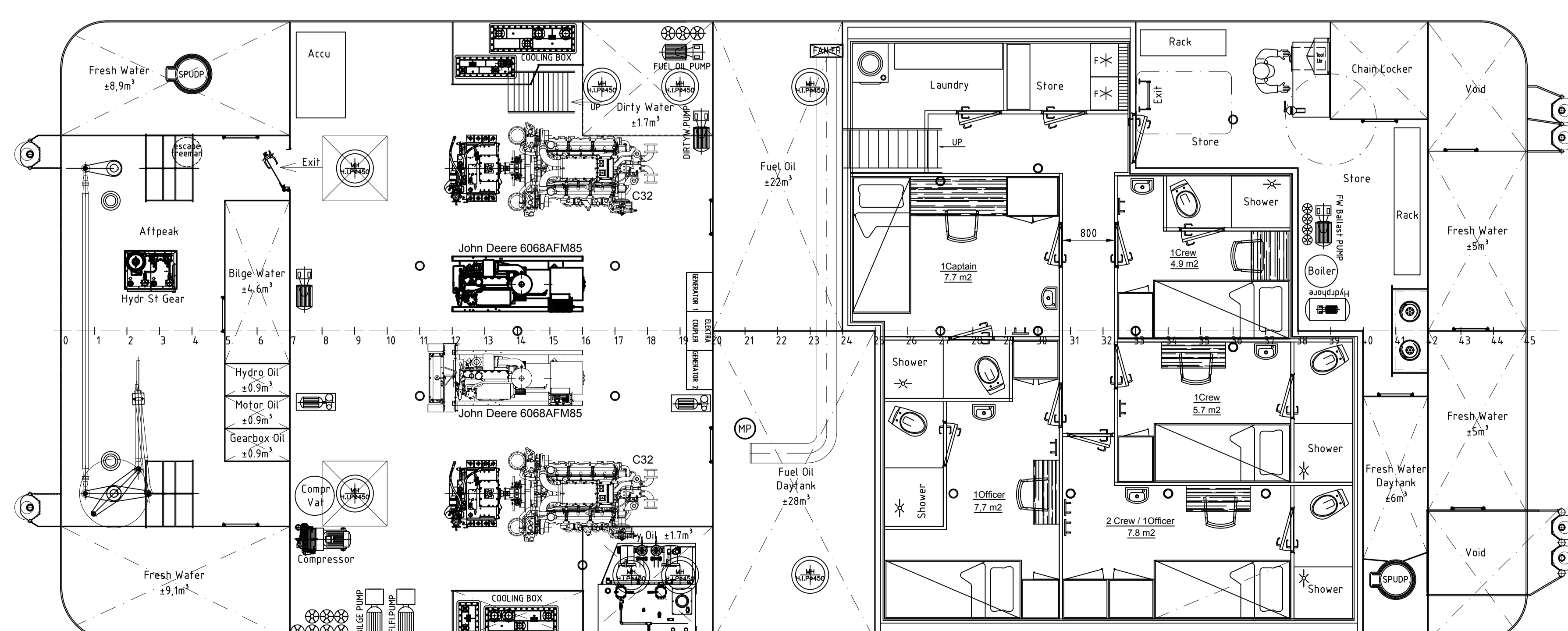

Main Dimensions

Length o.a. 24.45 mtr
 Length Hull 22.50 mtr
 Beam o.a. 9.54 mtr
 Depth at side 2.895/3.10 mtr

Propulsion

2x Main Engine Cat C32 - 2x 634 kW @1800 rpm
 2x Gearbox
 Bollard Pull 24 ton

Gensets

2x Generator John Deere DJL 159K - 2x 127 kW

Tank Capacities

Fuel oil ± 50.0 m³
 Fresh water ± 36.0 m³

Hydraulic Crane : Heila HLRM 170-4S

Hydraulic Handling Winch : 50 T

Equipment Number acc NR600 :

2x Anchor ; Very high holding power 236 kg
 2x Anchor Chain ; Q2, φ 17.5, L=82.5

Classification

Bureau Veritas : Hull ● Mach ● AUT-UMS
 Special service : Tug -Coastal area - GMDSS area A2
 BV Registration Number: 36389F
 Deck Load: 6.0 t/m²

NEPTUNE ENGINEERING
 RIVIERDIJK 586, 3371ED
 HARDINVELD-GIESSENDAM Holland
 Tel:+31(0)184-621423, Fax:+31(0)184-612742

Scale: 1:50	Date: 07-11-2018	Drawn: 553-051.0	Rev: 1 of 1
Checked by: NMS	Building No: 553	553-051.0	G
Drawn by: FS	Drawn/Rev: A0	COPYRIGHT RESERVED ACC. LAW	