

## Understanding the Hoppe Contemporary multi-point lock system.

This system has a clean minimal look:

### Exterior:

The exterior of the door will only have a keyed cylinder. There will be no knob or lever. To open the door from outside, you will need the key. The key is inserted into the cylinder & rotated a couple times to retract the latch/locking points allowing you to push the door open. Cylinders come with round or square rosettes, in black or stainless-steel finish.



**E52ZNSB/52S**  
duraplus®  
HOPPE stainless steel security escutcheon pair for entrance doors:

- Base: zamak outside, steel inside, supporting lugs
- Fixing: concealed, bolt-through, M5 thread screws

Article description	Keyhole	Part Number for Stainless Steel	Part Number for Matte Black
Security escutcheon, pair		11537365	11795001

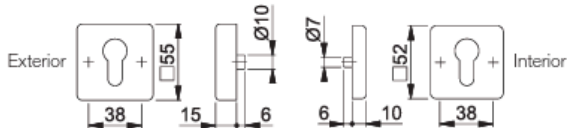



**E42ZNSB/42HS**  
duraplus®  
HOPPE stainless steel security escutcheon pair for entrance doors:

- Base: zamak outside, steel inside, supporting lugs
- Fixing: concealed, bolt-through, M5 thread screws

Article description	Keyhole	Part Number for Stainless Steel	Part Number for Matte Black
Security escutcheon, pair		11537218	11795025

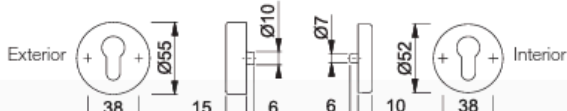

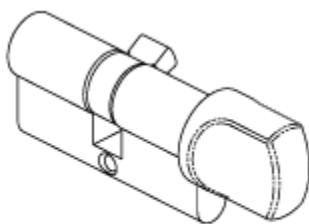

Stainless Steel  
E- Knob

Interior:

The interior has 2 options. There will be a thumb turn on the back side of the keyed cylinder which is used to open/lock/unlock the door. You must turn the thumb turn a few times to engage/set the locking points & deadbolt. To exit, you must turn the thumb turn in the opposite direction to retract the locking points. Hold the thumb turn fully open to keep the door latch retracted while opening the door.

As an additional option on the interior, you may add one of two lever options. The Amsterdam with a round rosette, or the Dallas with a square rosette. Black or stainless-steel finish. The lever can be used to exit provided the door is unlocked. The lever only retracts the door latch. If the door is locked, you must first turn the thumb turn to retract the locking points, then you may use the lever to exit.



Quick-Fit

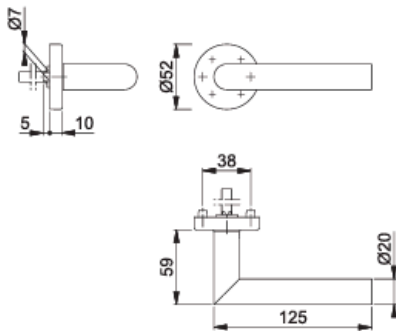

#### Amsterdam - E1400Z/42H

HOPPE stainless steel handle half set on rose with mounting module for roses, for entrance doors (interior):

- Bearing: loose door handle, non-handed spring cassette, maintenance-free slide bearing
- Connection: **HOPPE Quick-Fit connection** with HOPPE solid spindle, pre-assembled in the base
- Base: steel, supporting lugs; suitable for aluminium, wood and PVC doors
- Fixing: concealed, additional diagonal 4-screw fixing option, for multi-purpose screws

Article description		Part Number for Stainless Steel	Part Number for Matte Black
Door handle half set (interior) with supporting lugs	8/42	10809073	11909997

duraplus®



Quick-Fit

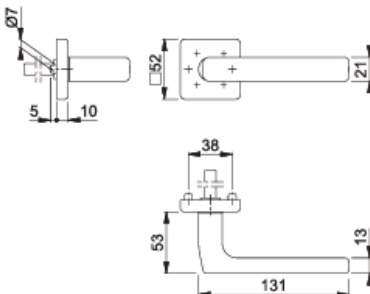

#### Dallas - E1643Z/52

HOPPE stainless steel handle half set on rose with mounting module for roses, for entrance doors (interior):

- Bearing: loose door handle, non-handed spring cassette, maintenance-free slide bearing
- Connection: **HOPPE Quick-Fit connection** with HOPPE solid spindle, pre-assembled in the base
- Base: steel, supporting lugs; suitable for aluminium, wood and PVC doors
- Fixing: concealed, additional diagonal 4-screw fixing option, for multi-purpose screws

Article description		Part Number for Stainless Steel	Part Number for Matte Black
Door handle half set (interior) with supporting lugs	8/42	3555749	11910008

duraplus®

As an additional option, we can swap the door latch for a roller latch. Everything functions the same way. However, with the roller latch, you can simply push the door open from the exterior without inserting & turning the key provided the lock is not set/engaged. For example, if you exit the house & close the door behind you, with the standard door latch, the door will latch & you can only re-enter using the key. With the roller latch, you will be able to push the door open as only the spring-loaded roller will be holding the door closed. The door will remain unlocked until the system is set/engaged using the key or the thumbturn.



Roller Latch

Tall pull handles are often added to doors with this system. If you have selected to have a lever on the interior of the door, the pull handle will need to be offset enough to allow clearance for the lever. Pull handles can be installed on one or both sides of the door.

Roller latch installed





Thumb turn with lever added on interior



Exterior keyed cylinder:





Additional locking points:



Interior view with lever option:





Exterior view:

