

**Your Partner in
Exhaust and Emission**

going the extra mile



AFTERMARKET

UNIVERSAL PARTS FROM TURBO TO TAILPIPE



Dinex.net

Table of Content

Clamps and Brackets

FlexFit & FlexJoiner Clamps	4
Circle & ButtFit Flat Clamps	5
PipeFit & TightFit Clamps	6
HoseFit & CT Band Clamps	7
Heavy Duty	8
Truck Make Clamps	9
U-Bolt Clamps	12
DIN Clamps	13
Hinged Clamps, Pipe Brackets & Pipe Clamps ...	14

V-Clamp Connection

V-Clamp Connection Kits (Truck Make Specific) .	15
V-Clamps Low Leakage	16
Exhaust Assembly Paste	16

Rubber Mountings

Rubber Mountings	17
------------------------	----

Pipe & Silencer Straps

Pipe & Silencer Straps	18
------------------------------	----

Bends & Elbows

Bends OD/OD	19
Bends OD/ID	21
Elbows	23

Pipes & Adaptors

Straight Pipes	25
Extension Pipes	26
Tail Pipes	27
T & Y Adaptors, Connectors	28
Pipe Connectors	29
Flex Pipes	31
Bellows	34
Bellow Flex	36

Silencers

Absorption Silencers	37
Auxiliary Heater Exhaust Flex pipes	37
Universal Silencers	38

Rain Caps

Rain Caps	43
-----------------	----

Spark Arrestors

Pipe Spark Arrestors	43
----------------------------	----

DPF

DPF Accessory Kits	44
--------------------------	----

Sensors

UniNox	45
Sensor Port	45
Insulation	45



We provide a wide range of Universal Products

With more than 15,000 products available we offer the world's widest product range for on-road transport (LCV, trucks and buses), off-road and construction equipment.

- Diesel Oxidation Catalysts
- Selective Catalytic Reduction
- Diesel Particle Filters
- Front pipes
- Tailpipes
- Three Way Catalyst
- Pipe insulation
- Clamps
- Flex pipes and bellows
- Sensors
- Fittings
- Injectors
- Pumps

Integrated OE quality

Reliable performance is our main priority. We handle all production of ceramics, coating and metal forming in our own factories, and our entire programme is 95% in-house manufactured. This is our way to ensure optimum quality that equals and in many cases even surpasses original equipment.

Certified and approved

Probably needless to say, but Dinex is certified according to a number of international standards, including:

ISO 9001, ISO 14001, ISO 18001, ISO 50001, IATF 16949

Warranty

3 years for aftertreatment systems (DPFs, DOCs,SCRs), pipe treatment systems, 2 years for reconditioned DPFs and 1 year on accessories, electronic equipment (Mechatronic products), bellows and flex.



Symbol Identification

L	=	Length	ALU	=	Aluminised
W	=	Width	INOX	=	Stainless Steel
mm	=	Millimetre	ZINC	=	Zinc Coated
Inch	=	Inch	GALV	=	Galvanized
Ø	=	Diameter	SPD	=	Mild Steel
OD	=	Outside Diameter	OE	=	Original Equipment
ID	=	Inside Diameter	HP	=	Horse Power
CLR	=	Center Line Radius	BP	=	Back Pressure



= For on-road heavy duty vehicles.



= For off-road vehicles.



= For remanufactured parts.



FlexFit & FlexJoiner Clamps

The proper way to connect flexible with regular pipes to ensure a gas-tight connection.



FlexFit Clamps



Dinex no.		Ø flex		Ø pipe	
ALU	INOX	mm	Inch	mm	Inch
99250	99251	55,0	2 1/8	50,0	2
99257		57,0	2 1/4	62,0	2 1/2
	99258	57,0	2 1/4	62,0	2 1/2
99260	99261	65,0	2 1/2	60,0	2 3/8
99264	99265	67,0	2 2/3	63,5	2 1/2
99270	99269	75,0	3	70,0	2 3/4
99276	99277	81,2	3 1/5	76,2	3
99280	99281	84,0	3 1/3	80,0	3 1/8
99289	99290	93,6	3 2/3	88,9	3 1/2
99300	99301	105,0	4 1/5	100,0	3 7/8
99302	99303	106,6	4 1/5	101,6	4
99308		113,0	4 1/2	108,0	4 1/4
99310	99311	115,0	4 1/2	110,0	4 1/3
80871	99315	119,0	4 3/4	114,3	4 1/2
99320	99321	125,0	5	120,0	4 3/4
99327	99328	131,0	5 1/5	127,0	5
99352	99350	158,0	6 1/5	152,0	6

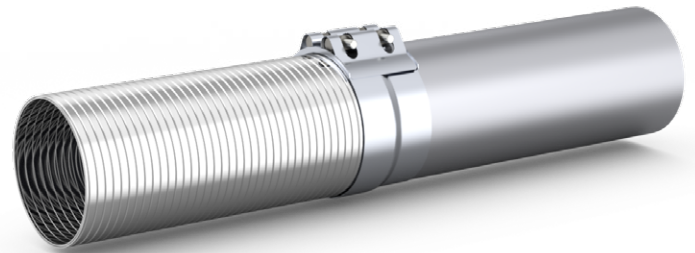
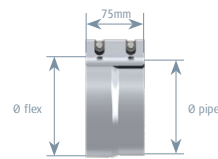

FlexJoiner Clamps



Dinex no.		Ø flex	
ALU	INOX	mm	Inch
	99291	88,9	3 1/2
	99306	102,7	4 3/8
99330		132,0	5 1/16
99341	99342	157,5	6 1/5

Material thickness 0,7 mm

Circle & ButtFit Flat Clamps

Circle clamps are designed for concentrated clamping force, works best with pipe connections that are no longer fresh.

ButtFit flat clamps are designed for applying uniform clamping force across a large area, works best with precise pipe connections.



Circle Clamps



Dinex no.	Ø mm	Ø Inch
ZINC		
99082	76,0 - 82,0	3
99094	83,0 - 94,0	3 1/2
99107	95,0 - 107,0	4
99114	108,0 - 114,0	4 1/4
99119	115,0 - 119,0	4 1/2
99132	120,0 - 132,0	5
99154	142,0 - 154,0	6

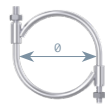

ButtFit Flat Clamps



Dinex no.	Dinex no.	Ø mm	Ø Inch
ALU	INOX		
99357		57,0	2 1/4
99363	99463	63,5	2 1/2
99370		69,9	2 3/4
99376	99476	76,2	3
99389	99489	88,9	3 1/2
99402	99502	101,6	4
99408		108,0	4 1/4
99414	99514	114,3	4 1/2
99427	99527	127,0	5
99428		140,0	5 1/2
99455	99554	152,4	6



Material thickness 0,7 mm

PipeFit & TightFit Clamps

The optimum way for fast, easy and precise pipe connections. Provides adequate support area along with reasonable clamping pressure.

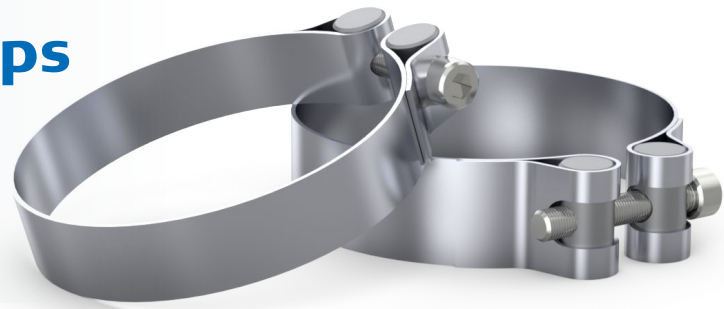

PipeFit Clamps



Dinex no.	Ø mm	Ø Inch	Clamp size range
INOX			Ø mm
99815	47,6	1 7/8	48 - 54
99800	50,8	2	51 - 57
99801	57,0	2 1/4	57 - 63
99816	60,3	2 3/8	60 - 66
99802	63,5	2 1/2	64 - 70
99817	66,7	2 5/8	67 - 73
99803	69,9	2 3/4	70 - 76
99804	76,2	3	76 - 82
99818	79,4	3 1/8	80 - 86
99806	88,9	3 1/2	89 - 95
99819	100,0		100 - 106
99807	101,6	4	102 - 108
99809	114,3	4 1/2	114 - 120
99810	120,0		120 - 126
99811	127,0	5	127 - 133
99812	139,7	5 1/2	140 - 146
99813	152,4	6	152 - 158

Material thickness 1.5 mm
Heavy Duty

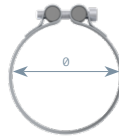

TightFit Clamps



Dinex no.	Dinex no.	Ø mm	Ø Inch
ALU	INOX		
99851	99852	51,0 - 54,0	2
99858	99859	54,0 - 57,0	2 1/4
99860	99861	60,0 - 63,0	2 3/8
99864	99865	64,0 - 67,0	2 1/2
99866	99867	66,0 - 69,0	2 5/8
99871	99872	71,0 - 74,0	2 3/4
99877	99878	78,0 - 81,0	3
99880	99881	81,0 - 84,0	3 1/8
99885		86,0 - 89,0	3 1/3
	99890	90,0 - 93,0	3 1/2
99892	99893	91,0 - 94,0	3 1/2
	99901	101,0 - 105,0	4
99903	99904	102,0 - 106,0	4
99910	99911	111,0 - 116,0	4 3/8
99915	99916	115,0 - 119,0	4 1/2
99920	99921	122,0 - 127,0	4 3/4
99928	99925	128,0 - 132,0	5
	99944	142,0 - 146,0	5 1/2
99953	99954	153,0 - 158,0	6
	99956	158,0 - 163,0	6 1/5

Material thickness 1.5 mm

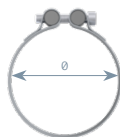

HoseFit & CT Band Clamps

The quicker clamping solution for connections that require less force.



CT Band Clamps



Dinex no.	Ø mm	Ø Inch
INOX		
98870	32 - 54	1 1/4 - 2 1/8
98871	44 - 67	1 3/4 - 2 5/8
98872	57 - 79	1 1/4 - 3 1/8
98873	70 - 92	2 3/4 - 3 5/8
98874	83 - 105	3 1/4 - 4 1/8
98875	95 - 117	3 3/4 - 4 5/8
98876	108 - 130	4 1/4 - 5 1/8
98877	121 - 143	4 3/4 - 5 5/8
98878	133 - 156	5 1/4 - 6 1/8
98879	146 - 168	5 3/4 - 6 5/8
98880	159 - 181	6 1/4 - 7 1/8
98881	171 - 194	6 3/4 - 7 5/8
98882	184 - 206	7 1/4 - 8 1/8
98883	197 - 219	7 3/4 - 8 5/8
98884	210 - 232	8 1/4 - 9 1/8

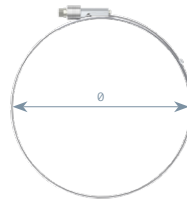

HoseFit Clamps



Dinex no.	Ø mm	Ø Inch	A mm
INOX			
99150	50,0 - 55,0	2 - 2 1/5	20
99157	55,0 - 59,0	2 1/5 - 2 1/3	20
99160	59,0 - 63,0	2 1/3 - 2 1/2	20
99164	63,0 - 68,0	2 1/2 - 2 2/3	25
99176	79,0 - 85,0	3 - 3 1/3	25
99189	91,0 - 97,0	3 1/2 - 3 4/5	30
99202	104,0 - 112,0	4 - 4 2/5	25
99214	112,0 - 121,0	4 2/5 - 4 4/5	20
99227	121,0 - 133,0	4 4/5 - 5 1/5	30
99235	130,0 - 140,0	5 - 5 1/2	30

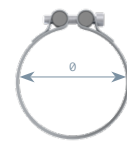

Heavy Duty Clamps

These clamps are designed to provide maximum clamping force over a reasonable area.



Heavy Duty Clamps



Dinex no	Ø mm	Ø Inch
ALU		
99548	45,5 - 48,5	1 4/5 - 1 9/10
99550	47,5 - 50,5	1 9/10 - 2
99553	50,5 - 53,5	2 - 2 1/10
99555	52,5 - 55,5	2 - 2 2/5
99558	55,5 - 58,5	2 2/5 - 2 1/3
99560	57,5 - 60,5	2 1/4 - 2 2/5
99563	60,5 - 63,5	2 2/5 - 2 1/2
99565	62,5 - 65,5	2 1/2 - 2 2/3
99568	65,5 - 68,5	2 2/3 - 2 7/10
99570	67,5 - 70,5	2 2/3 - 2 7/8
99573	71,5 - 73,5	2 4/5 - 2 9/10
99575	73,5 - 75,5	2 9/10 - 3
99578	75,5 - 78,5	3 - 3 1/9
99580	77,5 - 80,5	3 - 3 1/6
99585	82,5 - 85,5	3 1/4 - 3 2/5
99589	87,5 - 90,5	3 2/5 - 3 1/2
99594	91,5 - 94,5	3 5/8 - 3 5/7
99600	97,5 - 100,5	3 4/5 - 4
99604	101,5 - 104,5	4 - 4 1/8
99607	104,5 - 107,5	4 1/8 - 4 1/4
99610	107,5 - 110,5	4 1/4 - 4 1/3
99614	111,5 - 114,5	4 2/5 - 4 1/2
99620	117,5 - 120,5	4 5/8 - 4 6/8
99624	121,5 - 124,5	4 4/5 - 4 7/8
99627	124,5 - 127,5	4 7/8 - 5
99630	124,5 - 127,5	5 - 5 1/8
99633	130,5 - 133,5	5 1/8 - 5 1/4



Truck Make Clamps

The preferred clamping solutions for each OE manufacturer.



DAF U-bolt Clamps M10



Dinex no	A mm	C mm	Ø mm	Ø Inch	OE
ZINC					
90172	120,0	40,0	72,0	2 3/4	
90084	130,0	40,0	84,0	3 1/4	682602
90192	140,0	40,0	92,0	3 5/8	
90096	145,0	40,0	96,0	3 3/4	682603
90098	150,0	40,0	98,0	3 3/4	682604
90105	195,0	40,0	105,0	4 1/8	682606
90109	160,0	40,0	109,0	4 1/4	682605
90120	170,0	40,0	120,0	4 3/4	682608
90130	185,0	60,0	130,0	5 1/8	682610
90142	195,0	40,0	142,0	5 5/8	682611
90155	205,0	40,0	155,0	6	682612
88887	220,0	80,0	155,0	6	
90165	220,0	55,0	165,0	6 1/2	

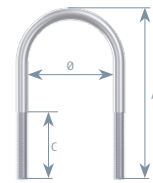

SCANIA Clamps



Dinex no.	Ø mm	Ø Inch	OE
ALU			
68818	114,0-119,0	4 1/2	328928
68819	119,0-124,0	5	1300367



Truck Make Clamps



VOLVO / RENAULT Clamps



Dinex no.	Dinex no.	Ø mm	Ø Inch	OE
ALU	INOX			
99042		39,0 - 42,0	1 5/8	
99045		42,0 - 45,0	1 3/4	
99048		45,0 - 48,0	1 7/8	
99051		48,0 - 51,0	2	
99055		52,0 - 55,0	2 1/8	975259
99058		55,0 - 58,0	2 1/4	975260
99061		58,0 - 61,0	2 3/8	
99064		61,0 - 64,0	2 1/2	
99067		65,0 - 67,0	2 5/8	
99071		68,0 - 71,0	2 3/4	
99074		71,0 - 74,0	2 7/8	
99077		74,0 - 77,0	3	
99083	99084	78,0 - 82,0	3 1/8	
99087		83,0 - 87,0	3 1/4	
99096		91,0 - 96,0	3 5/8	1193870
99100		100,0 - 104,0	3 7/8	
99108	99109	104,0 - 107,0	4	475499
99115	99116	108,0 - 114,0	4 1/2	
99120	99121	115,0 - 120,0	4 3/4	1589141
99127		123,0 - 128,0	5	
99135	99136	130,0 - 135,0	5 1/4	
99147		142,0 - 147,0	5 3/4	
99159		154,0 - 159,0	6	

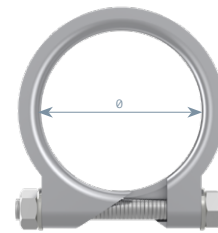

Truck Make Clamps



MERCEDES / IVECO Clamps



Dinex no.	Ø mm	Ø Inch	OE	Design
ALU				
28810	59,5 - 62,5	2 3/8	8585923	A
28881	63,0 - 66,0	2 1/2	8591167	A
28811	65,0 - 68,0	2 1/2	8582510	A
28880	67,0 - 70,0	2 3/4	8567698	A
50926	74,0 - 77,0	3	6.734.920.140	A
50945	76,0 - 79,0	3	61597491	A
28853	80,0 - 83,0	3 1/8	4839513	A
50927	87,5 - 90,5	3 1/2	4819971	A
50924	92,0 - 96,0	3 3/4	6.744.920.040	A
28873	102,0 - 105,0	4	42081440 / 42075778	B
28856	104,0 - 107,0	4	61605919	A
28874	106,0 - 110,0	4 3/8	2491711	B
28865	114,0 - 118,0	4 1/2	42075779 / 42090154	B
28866	118,0 - 122,0	4 3/4	42075780 / 42094001	B
28875	128,0 - 132,0	5	42092219	B
28876	131,0 - 135,0	5 1/4	42091873	B

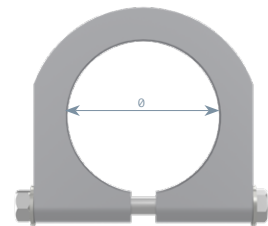
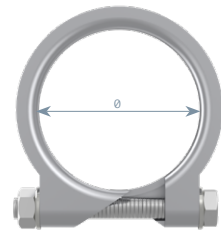

Design A



Design B



U-Bolt Clamps

Designed for concentrated clamping force with single-sided tightening. Works best with loose or beat-up, hard to access connections.



U-Bolt Clamps M8



Dinex no.	Dinex no.	A mm	C mm	Ø mm	Ø Inch
ZINC	INOX				
90028		50,0	25,0	29,0	1 1/8
90032		60,0	23,0	32,0	1 1/4
90035		63,0	26,0	37,0	1 3/8
90038		65,0	26,0	38,0	1 1/2
90041		70,0	29,0	44,0	1 5/8
90045		75,0	25,0	45,0	1 3/4
90048		75,0	25,0	48,0	1 7/8
90052		80,0	25,0	52,0	2
90054		85,0	25,0	54,0	2 1/8
90057		85,0	40,0	57,0	2 1/4
90060		90,0	33,0	60,0	2 3/8
90061		100,0	43,0	60,0	2 3/8
90064		95,0	35,0	65,0	2 1/2
90067		95,0	22,0	67,0	2 5/8
90070		100,0	22,0	70,0	2 3/4
90069		105,0	27,0	70,0	2 3/4
90073		100,0	22,0	73,0	2 7/8
90076		105,0	25,0	76,2	3
90078		115,0	35,0	76,2	3
90079		120,0	25,0	80,0	3 1/8
90083		115,0	24,0	83,0	3 1/4
90089		125,0	25,0	88,9	3 1/2
90131		140,0	40,0	89,0	3 1/2
90092		130,0	30,0	92,0	3 5/8
90095		135,0	40,0	95,3	3 3/4
90102	90107	135,0	30,0	102,0	4
90113		150,0	50,0	102,0	4
90106		140,0	35,0	105,0	4 1/8
	90108	155,0	40,0	114,3	4 5/8
90117		162,0	50,0	114,3	4 5/8
90114	90111	150,0	40,0	114,3	4 5/8
90127	90112	165,0	33,0	127,0	5
90129		177,0	48,0	130,0	5 1/8
	90139	184,0	62,0	139,7	5 1/2

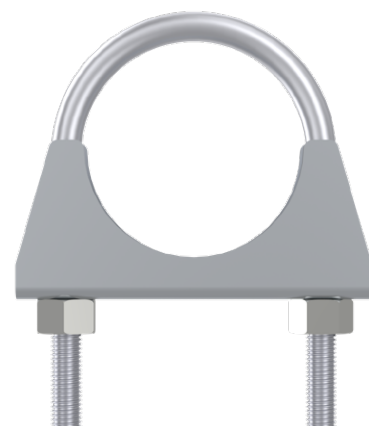
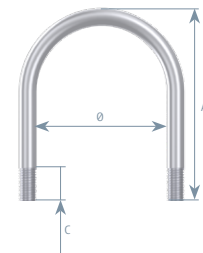

Can be used for trailers (example - mud flaps)

DIN Clamps

The referred clamping solution for fast and secure connections.



DIN Clamps



Dinex no.	Dinex no.	Ø mm	Ø Inch	Mercedes OE	MAN OE
ALU	INOX				
99741		40,3	1 1/4	071.555.040.300	
99742		42,5	1 1/2	071.555.042.500	
99745		45,5	1 3/4	071.555.045.500	
99748		48,5	1 7/8	071.555.048.500	
99750		50,5	2	071.555.050.500	
99753		53,5	2 1/8	071.555.053.500	
99755		55,5		071.555.055.500	
99758		58,5	2 1/4	071.555.058.500	
99760		60,5	2 3/8	071.555.060.500	
99763		63,5	2 1/2	071.555.063.500	
99765		65,5		071.555.065.501	
99768		68,5	2 5/8	071.555.068.500	
99770		70,5	2 3/4	071.555.070.500	
99773		73,5	2 3/4	071.555.073.500	
99775		75,5		071.555.075.500	
99776	99777	76,5	3		
99778		78,5	3 1/8	071.555.078.502	
99780		80,5		071.555.080.502	
99785		85,5	3 3/8	071.555.085.502	06.67041.0121
99789	99790	90,5	3 1/2	071.555.090.501	06.67041.0123
99794		94,5	3 3/4	071.555.094.502	06.67041.0125
99700		100,5		071.555.100.500	06.67041.0124
99702		102,5	4		
99704	99703	104,5	4 1/8	071.555.104.501	81.97420.2017
99708		108,5	4 1/4		
99710		110,5	4 3/8	071.555.110.501	81.97420.0073
99714	99715	114,5	4 1/2	81.97420.0085	
99720	99721	120,5	4 3/4	071.555.120.500	81.97420.0076
99724		124,5	4 7/8	071.555.124.500	
99727	99728	127,5	5	071.555.124.501	
99730		130,5	5 1/8	071.555.130.500	81.97401.0731

Material thickness 3-5 mm.

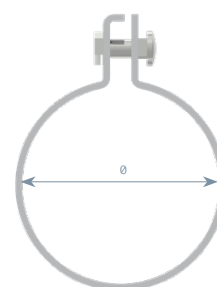

Hinged Clamps, Pipe Brackets & Pipe Clamps

The clamping solutions for applications with limited space.

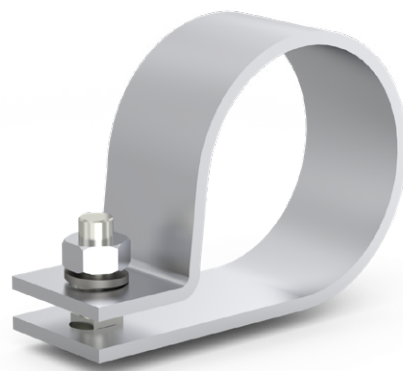

Hinged Clamps



Dinex no.	Ø mm	Ø Inch
ZINC		
98780	80,5	3 1/8
98700	100,5	3 7/8
98715	114,5	4 1/2
98730	130,5	5 1/8

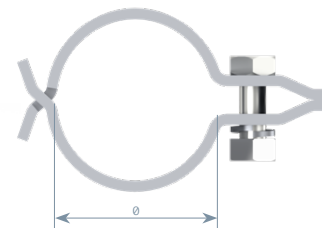

Pipe Clamps



Dinex no.	Ø mm	Ø Inch
ZINC		
99475	75	3
99480	80	3 1/8
99410	110	4 3/8

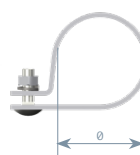

Pipe Brackets



Dinex no.	Ø mm	Ø Inch	C mm	C Inch	L mm	Design
ZINC						
90104	100,0	3 7/8	11	1/2	120,0	B
90110	110,0	4 3/8	11	1/2	150,0	A

A

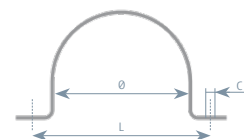

B

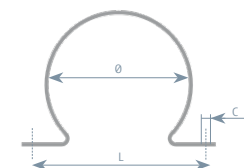

V-Clamp Connection Kits (Truck Make Specific)

The most gas-tight clamp design supplemented with specifications from OE manufacturers.

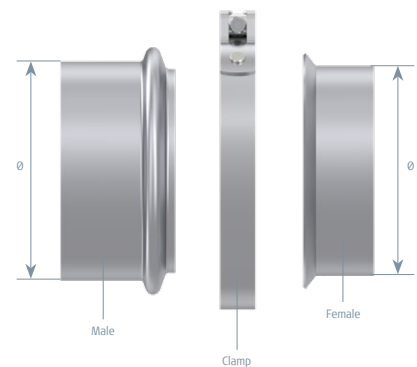

DAF



Dinex no.	Dinex no.	Dinex no.	Dinex no.	Ø mm	Ø Inch
Male	Clamp	Clamp	Female		
ALU	ALU	INOX	ALU		
78201	21817		78217	101,6	4
78215	21821		78216	114,3	4 1/2
78229		21850	78230	127,0	5

MERCEDES



Dinex no.	Dinex no.	Dinex no.	Dinex no.	Dinex no.	Ø mm	Ø Inch
Male	Clamp	Clamp	Female	Female		
ALU	ALU	INOX	ALU	INOX		
78150	50829				50,0	2
	50810	50972	50218	51285	71,0	2 4/5
78175					75,0	3
78189	50852	50973	51170		85,0	3 3/8
	50849		51126		95,0	3 7/8
78200					106	4 1/5

VOLVO



Dinex no.	Dinex no.	Dinex no.	Dinex no.	Dinex no.	Dinex no.	Ø mm	Ø Inch
Male	Male	Clamp	Clamp	Female	Female		
ALU	INOX	ALU	INOX	ALU	INOX		
78190		80905	78890	78191	78235	88,9	3 1/2
78202	78223	80910	78803	78203		101,6	4
78214	78224	80848	78815	78218	78236	114,3	4 1/2
78227	78244	80921	78828	78228	78232	127,0	5

SCANIA



Dinex no.	Dinex no.	Dinex no.	Ø mm	Ø Inch
Male	Clamp	Female		
ALU	ALU	ALU		
78256	68835	78257	114,3	4 1/2
78269	68858	78268	127,0	5

Other clamps



Dinex no.	Dinex no.	Ø mm	Ø Inch	Design
ZINC	INOX			
50829		50	2	1
50810	50972	76	3	1
80905		88,4	3 1/2	3
50852	50973	88,9	3 1/2	1
80910		101,6	4	3
50849		102	4	1
21817		110	4 1/2	3
80848		114	4 1/2	2
21821	21850	127	5	3
81921		127	5	4



V-Clamp Low Leakage (For Euro IV to VI application)

V-clamp supplemented with a gasket to ensure an even greater seal especially at high temperatures.



Single Bolt (For Applications < 550°C)



Dinex no.	Dinex no.	L1	Dinex no.	Dinex no.	L2	Ø	Ø
Clamp	Male	mm	Gasket	Female	mm	mm	Inch
99679	532511	100	78844	532510	100	76,1	3
99680	532515	61	78845	532514	100	88,9	3 1/2
99681	532517	100	78846	532516	100	101,6	4
99682	532521	100	78847	532520	100	114,3	4 1/2
99683	532523	55	78848	532522	100	127,0	5



Double Bolt (For Applications < 1000°C)



Dinex no.	Dinex no.	L1	Dinex no.	Dinex no.	L2	Ø	Ø
Clamp	Male	mm	Gasket	Female	mm	mm	Inch
99684	532511	100		532510	100	76,1	3
99685	532515	61	78840	532514	100	88,9	3 1/2
99686	532517	100	78841	532516	100	101,6	4
99687	532521	100	78842	532520	100	114,3	4 1/2
99688	532523	55	78843	532522	100	127,0	5

Exhaust Assembly Paste

Dinex no.	ml
78800	500



Withstand temperatures up to 1000 °C.

Rubber Mountings

Made to absorb even the roughest vibrations to protect the exhaust system components under any circumstances.



M 8

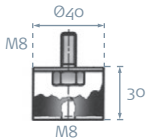

49907
81.96210.052

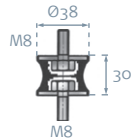

21822
0285530
651183

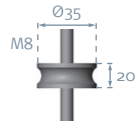

50907
322.504.0212

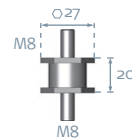

51941
001.987.5240

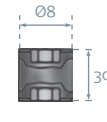

28837
98415197

M 10

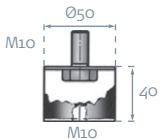

49838
81.96210.0101

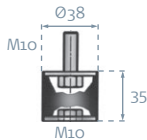

50950
697.987.0139

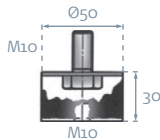

49910
81.96210.0153

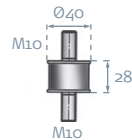

64804
5000750531

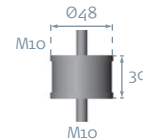

44800
0487257

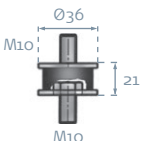

50910
001.987.5340

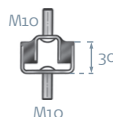

69804
4.771.333.000

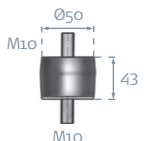

80949
324842

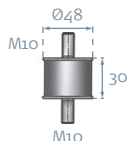

64817
5000750630

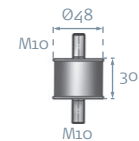

69817
4.771.244.000

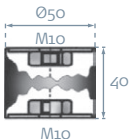

80951
1580440

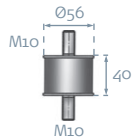

70807
36233 S1

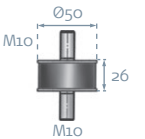

24903
104939-8

M 12

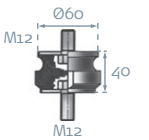

21820
0221342

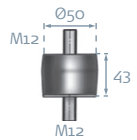

80950
6 850149

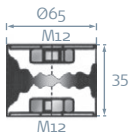

68900
40607

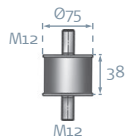

92975
4.771.308.000

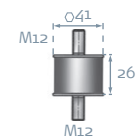

21905
1405183

Universal

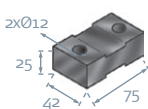

50912
667.490.0037



50809
381.492.0082

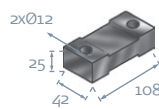

50904
309.490.0037



50984
202.492.0344



50985
901.492.0044

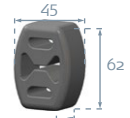

28901
93818454

Pipe & Silencer Straps

Fast and easy solution for additional installation security for pipes and silencers.

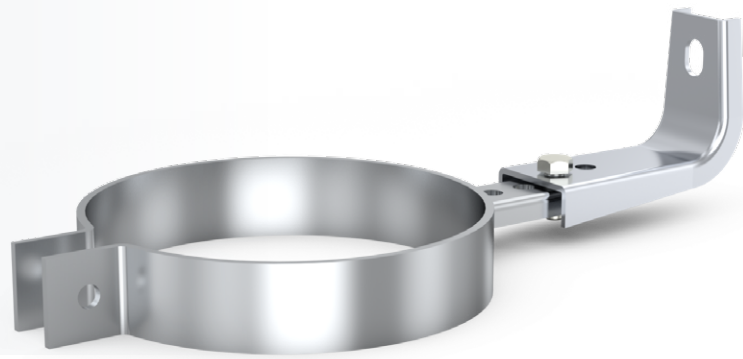

		
Dinex no.	Ø mm	Ø Inch
ALU		
98076	76,2	3
98089	88,9	3 1/2
98102	101,6	4
98114	114,3	4 1/2
98127	127,0	5
98155	155,0	6
98184	184,0	7

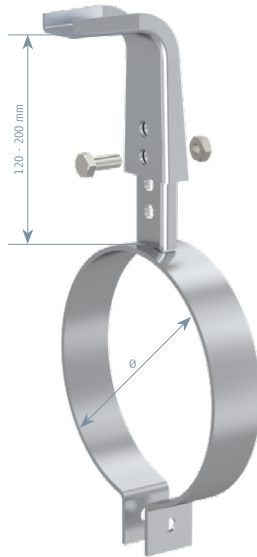

		
Dinex no.	Ø mm	Ø Inch
ALU		
49815	180x280	7 x 10 3/4
49841	180x280	7 x 10 3/4
50860	180x280	7 x 10 3/4
49801	250x300	9 7/8 x 11 7/8



49841



49815



50860



49801

		
Dinex no.	Ø mm	Ø Inch
ALU		
98752	155,0	6
98784	184,0	7 1/4
98703	206,0	8
98754	254,0	10
98779	284,0	11
98805	300,0	12
28800	380,0	15

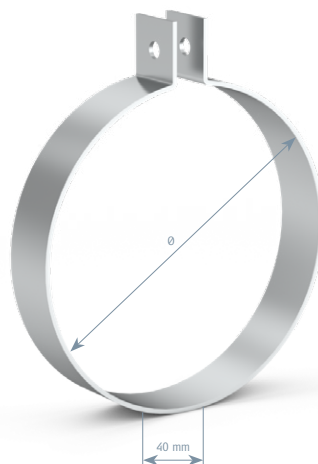

Bends OD/OD

Single bend with plain (male) ends.



90° (OD/OD)



Dinex no.	Dinex no.	L mm	OD mm	OD Inch	CLR
ALU	INOX				
91039		129	38,0	1 1/2	54,0
91046		180	45,0	1 3/4	64,0
91050		190	50,0	2	95,0
91056		240	57,0	2 1/4	85,0
91059	91259	240	60,0	2 3/8	100,0
	91264	190	63,5	2 1/2	85,0
91063		265	63,5	2 1/2	85,0
91065		265	65,0	2 5/8	91,0
91071		270	70,0	2 3/4	98,0
91073		290	75,0	3	135,0
91075	91275	295	76,2	3	99,1
91080		290	80,0	3 1/8	115,0
91088	91288	320	88,9	3 1/2	135,0
91100		380	100,0	3 7/8	203,0
91101	91201	380	101,6	4	150,0
91106	91201	254	101,6	4	150,0
91109		400	110,0	4 3/8	148,0
91111		450	110,0	4 3/8	148,0
91113		390	114,3	4 1/2	161,0
	91213	400	114,3	4 1/2	161,0
91120		410	120,0	4 3/4	170,0
91125		330	127,0	5	173,0
91127	91228	415	127,0	5	173,0
91153		475	152,4	6	225,0

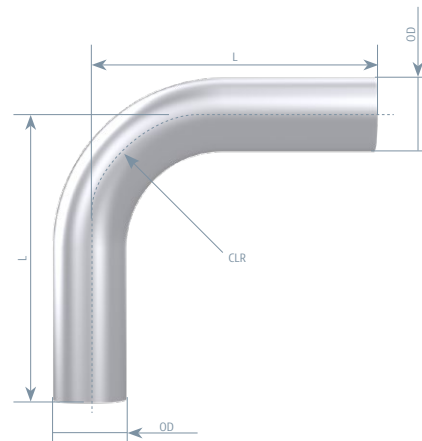

Material thickness ranging from 1,5 to 2,0 mm.

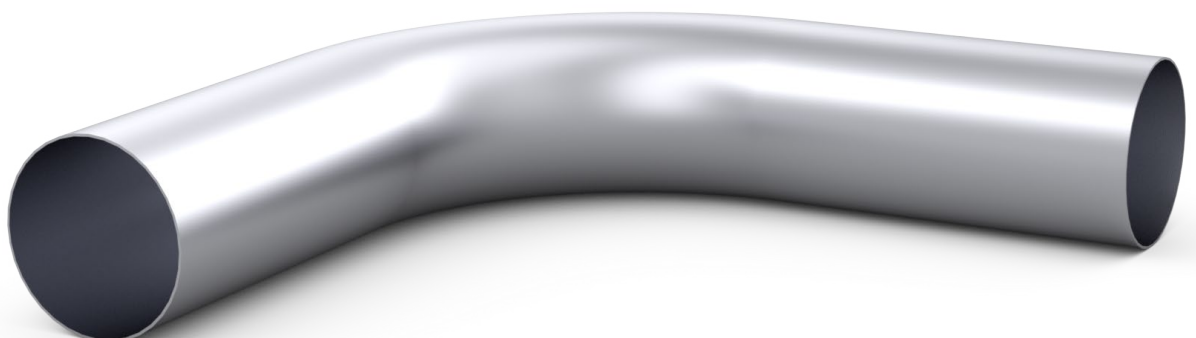

Bends OD/OD

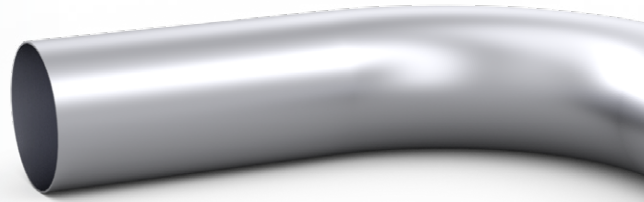

60° (OD/OD)



Dinex no.	L mm	OD mm	OD Inch	CLR
ALU				
92450	155	50,0	2	95,0
92460	165	60,0	2 3/8	100,0
92465	205	65,0	2 5/8	91,0
92470	180	70,0	2 3/4	135,0
92475	190	75,0	3	135,0
92476	180	76,2	3	99,1
92480	250	80,0	3 1/4	115,0
92489	205	88,9	3 1/2	135,0
92490	210	90,0	3 5/8	177,0
92500	250	100,0	4	150,0
92510	360	110,0	4 3/8	148,0
92520	380	120,0	4 3/4	173,0
92526	320	127,0	5	173,0

45° (OD/OD)



Dinex no.	Dinex no.	L mm	OD mm	OD Inch	CLR
ALU		INOX			
92046		142,5	45,0	1 3/4	64,0
92050		140,0	50,0	2	95,0
92056		150,0	57,0	2 1/4	85,0
92059		150,0	60,0	2 3/8	100,0
92062		180,0	63,5	2 1/2	85,0
92065		180,0	65,0	2 5/8	91,0
92071		205,0	70,0	2 3/4	98,0
92075		230,0	76,2	3	99,1
92080		230,0	80,0	3 1/8	115,0
92088		225,0	88,9	3 1/2	177,0
92100		245,0	100,0	3 7/8	203,0
92101		245,0	101,6	4	203,0
92104		235,0	101,6	4	150,0
92109		260,0	110,0	4 3/8	148,0
92113		260,0	114,3	4 1/2	161,0
92120		365,0	120,0	4 3/4	170,0
92127		365,0	127,0	5	173,0
92129		305,0	127,0	5	173,0
92153		338,0	152,4	6	225,0

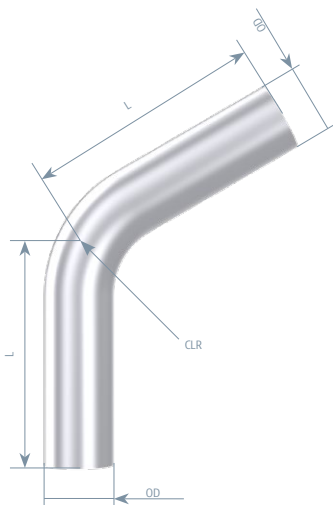

Material thickness ranging from 1,5 to 2,0 mm.

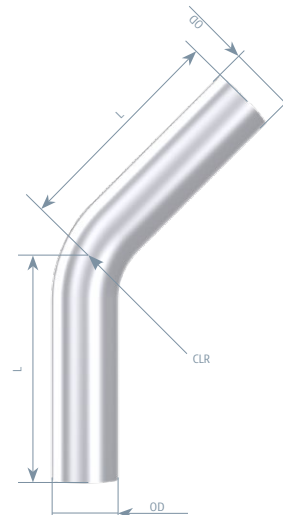

Bends OD/ID

Single bend with male connection on one end, and female connection on the other.

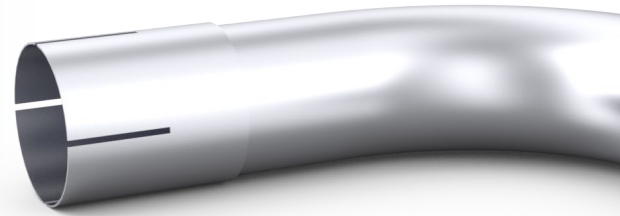

90° (OD/ID)



Dinex no.	Dinex no.	L mm	ID mm	OD mm	OD Inch	CLR
ALU	INOX					
91038		129	39,0	38,0	1 1/2	54,0
91045		180	46,0	45,0	1 3/4	64,0
91051		195	51,5	50,0	2	95,0
	91550	195	51,3	51,0	2	95,0
91057		240	57,6	57,0	2 1/4	85,0
91060	91560	240	60,5	60,0	2 3/8	100,0
	91563	190	64,0	63,5	2 1/2	85,0
91064		265	64,0	63,5	2 1/2	85,0
91066		265	65,3	65,0	2 5/8	91,0
91070		270	70,3	70,0	2 3/4	98,0
91074		290	75,5	75,0	3	135,0
91076		290	76,5	76,1	3	99,1
	91576	295	76,7	76,1	3	135,0
91089	91589	320	89,4	88,9	3 1/2	177,0
91102		380	102,1	101,6	4	150,0
	91502	380	102,1	101,6	4	150,0
91103		200	102,1	101,6	4	150,0
91105		254	102,1	101,6	4	150,0
91108		400	108,5	108,0	4 1/4	148,0
91110		400	110,5	110,0	4 3/8	148,0
91114	91514	390	114,8	114,3	4 1/2	161,0
91121		410	121,0	120,0	4 3/4	170,0
91128	91527	415	128,0	127,0	5	173,0
91129		330	128,0	127,0	5	173,0
91152		475	153,5	152,4	5	225,0

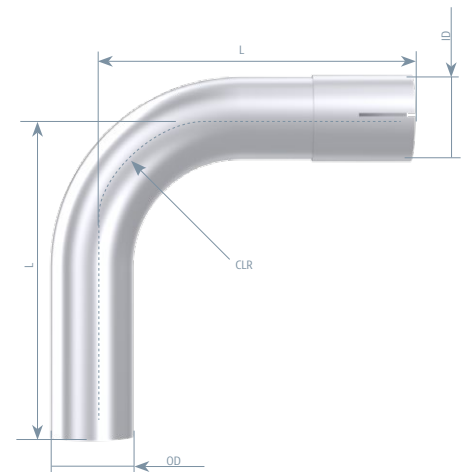

Material thickness ranging from 1,5 to 2,0 mm.

Bends OD/ID

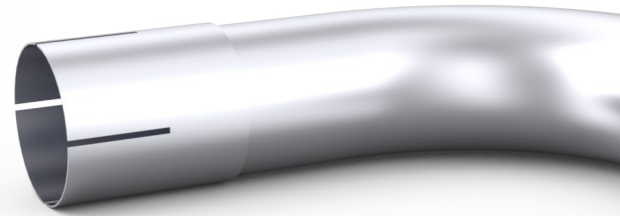

60° (OD/ID)



Dinex no.	L mm	ID mm	OD mm	OD Inch	CLR
ALU					
92370	200,0	70,3	70,0	2 3/4	135
92375	250,0	75,3	75,0	3	135
92380	250,0	80,3	80,0	3 1/4	115
92389	202,4	89,2	88,9	3 1/2	177
92390	200,0	90,3	90,0	3 5/8	177
92400	254,0	100,3	100,0	4	150
92410	210,0	110,3	110,0	4 3/8	260
92420	400,0	120,3	120,0	4 3/4	161

45° (OD/ID)



Dinex no.	Dinex no.	L mm	ID mm	OD mm	OD Inch	CLR
ALU						
INOX						
92051		140,0	51,3	50,0	2	95,0
92057		150,0	57,6	57,0	2 1/4	85,0
92060		150,0	60,5	60,0	2 3/8	100,0
92064		180,0	64,0	63,5	2 1/2	85,0
92066		180,0	65,5	65,0	2 5/8	91,0
92070		205,0	70,3	70,0	2 3/4	98,0
92074		230,0	75,5	75,0	3	135,0
92076	92576	205,0	76,7	76,1	3	99,1
92089	92589	225,0	89,4	88,9	3 1/2	177,0
92102	92502	245,0	102,1	101,6	4	203,0
92103		235,0	102,1	101,6	4	150,0
92108		260,0	108,5	108,0	4 1/4	148,0
92110		260,0	110,5	110,0	4 3/8	148,0
92114	92514	260,0	114,8	114,3	4 1/2	161,0
92121		365,0	121,0	120,0	4 3/4	170,0
92126		305,0	128,0	127,0	5	173,0
92128	92528	365,0	128,0	127,0	5	173,0
92152		338,0	153,5	152,4	6	225,0

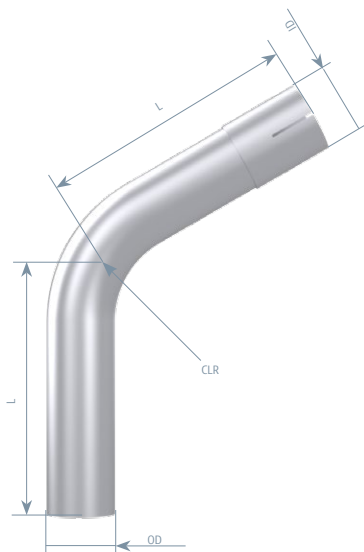

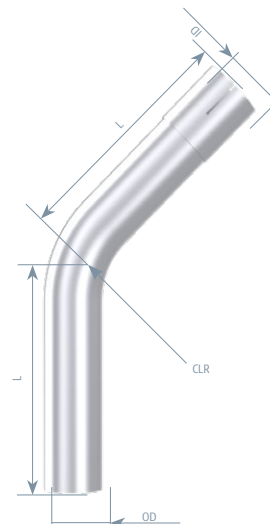

Material thickness ranging from 1,5 to 2,0 mm.

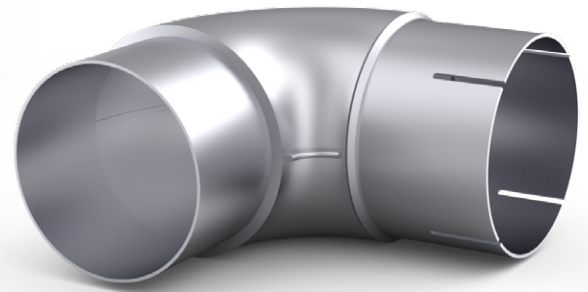

Elbows

Sharper turn for limited space.



OD/OD 					
Dinex no.	L mm	Dinex no.	L mm	OD mm	OD Inch
SPD		INOX			
96064	200			63,5	2 1/2
96075	194		200	76,2	3
96088	180		201	88,9	3 1/2
96101	200		236	101,6	4
91104	202			101,6	4
96107	190			108,0	4 1/4
96113	200		200	114,3	4 1/2
96126	223	96426	266	127,0	5

OD/OD (Cast) 					
Dinex no.	Dinex no.	OD mm	OD Inch	T mm	CLR
SPD		INOX			
96260		60,0	2 3/8	2,9	76
	96277	76,1	3	2,0	95
96276		76,1	3	2,9	95
96289		88,9	3 1/2	3,2	115
96202		101,6	4	3,6	134
	96204	104,0	4	2,0	150
96208		108,0	4 1/4	3,6	143
	96215	114,3	4 1/2	2,0	152
96214		114,3	4 1/2	3,6	153
	96230	129,0	5 1/8	2,0	188

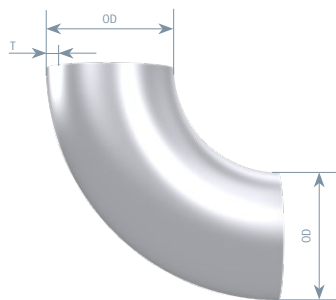
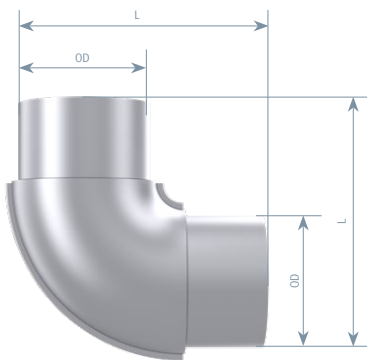



OD/OD (Welded/Thin Wall) 					
Dinex no.	Dinex no.	OD mm	OD Inch	T mm	CLR
SPD		INOX			
96046	96246	50,8	2	1,5	50,8
96063		63,5	2 1/2	1,5	50,8
	96263	63,5	2 1/2	1,5	63,0
	96274	76,2	3	1,5	63,5
96074		76,2	3	1,5	76,2
	96287	88,9	3 1/2	1,5	76,0
96087	96288	88,9	3 1/2	1,5	88,9
	96300	101,6	4	1,5	85,0
96100	96301	101,6	4	1,5	101,6
96106		108,0	4 1/4	1,5	76,0
	96312	114,3	4 1/2	1,5	96,8
96112		114,3	4 1/2	1,5	114,3
	96325	127,0	5	1,5	100,0
96109		127,0	5	1,5	127,0
96125		130,0	5 1/8	1,5	100,0

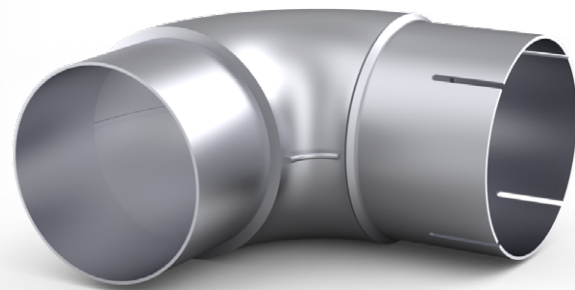

Material thickness ranging from 1,5 to 4,0 mm.

Elbows

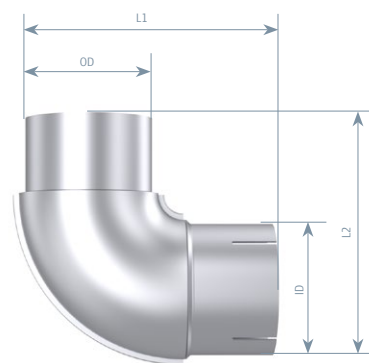

OD/ID		 				
Dinex no.	Dinex no.	L1 mm	L2 mm	OD mm	ID mm	OD Inch
SPD	INOX					
96051		200	200	50,0	51,3	2
96065		200	200	63,5	64,0	2 1/2
96076		200	200	76,1	77,0	3
96089		200	210	89,0	89,5	3 1/2
96102		200	210	101,6	102,5	4
	96402	243	243	101,6	102,1	4
96108		200	210	108,0	108,5	4 1/4
96110		200	210	110,0	111,0	4 1/3
96114		207	207	114,3	114,5	4 1/2
91126		255	255	127,0	128,0	5
96127		225	223	127,0	128,0	5
	96427	265	265	127,0	128,0	5



ID/ID		 			
Dinex no.	Dinex no.	L1 mm	L2 mm	ID mm	ID Inch
SPD	INOX				
97051		200	200	51,3	2
97065		200	200	64,0	2 1/2
97076		200	200	77,0	3
	96377	200	200	76,8	3
97089		200	200	89,5	3 1/2
97102		200	210	102,5	4
97108		200	210	108,5	4 1/4
97110		220	210	110,5	4 3/8
97114		207	207	114,5	4 1/2
97127		225	225	128,0	5

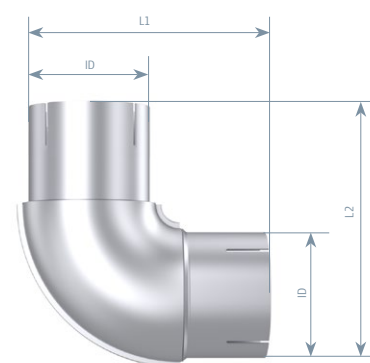

Material thickness ranging from 1,5 to 2,0 mm.

Straight Pipes

A single straight piece of pipe with plain (male) ends.

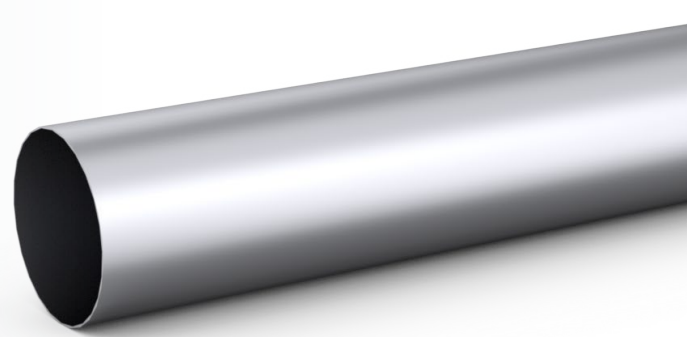

ALU



Dinex no.	OD mm	OD Inch
L2000mm		
93738	38,0	1 1/2
93745	45,0	1 3/4
93750	50,0	2
94754	54,0	2 1/8
94757	57,0	2 1/4
93361	60,0	2 3/8
93364	63,5	2 1/2
93366	65,0	2 5/8
93371	70,0	2 3/4
94774	75,0	2 7/8
94775	76,0	3
94780	80,0	3 3/8
94790	88,9	3 1/2
94700	100,0	4
94703	101,6	4
94710	110,0	4 1/4
94715	114,3	4 1/2
94720	120,0	4 3/4
94727	127,0	5
94740	140,0	5 1/2
94750	150,0	5 7/8
93753	152,4	6

Material thickness 1,5 mm.



MILD STEEL



Dinex no.	Dinex no.	OD mm	OD Inch
L2000mm		L3000mm	
93332		32,0	1 1/4
93335		35,0	1 3/8
93338		38,0	1 1/2
93344		45,0	1 3/4
93348		48,0	1 7/8
93350		50,0	2
93354		54,0	2 1/8
93357		57,0	2 1/4
93358		60,0	2 3/8
93377		76,2	3
93379		80,0	3 1/8
93390		88,9	3 1/2
93303	93302	101,6	4
93309		108,0	4 1/4
93310		110,0	4 5/16
93315	93314	114,3	4 1/2
93352		152,4	6

INOX



Dinex no.	Dinex no.	Dinex no.	OD mm	OD Inch
L1000mm			L2000mm	
			L2500mm	
	93551		51,0	2
	93560		60,0	2 3/8
93545	93566		63,0	2 1/2
	93576		76,2	3
	93589		88,9	3 1/2
	93502		101,6	4
	93514		114,3	4 1/2
	93527		127,0	5

Extension Pipes

A single straight piece of pipe with male connection on one end, and female connection on the other.

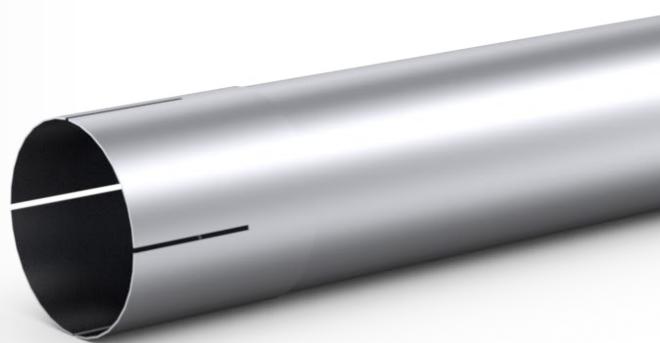

ALU



Dinex no.	Dinex no.	Dinex no.	Dinex no.	ID mm	OD mm	OD Inch
L600mm	L1000mm	L1500mm	L2500mm			
93651	93051	93151		51,3	50,0	2
93660	93060	93160		60,5	60,0	2 3/8
93664	93064	93164		64,0	63,5	2 1/2
93670	93070	93170		70,3	69,8	2 3/4
93676	93076	93176		76,7	76,2	3
93689	93089	93189		89,4	88,9	3 1/2
93602	93002	93102		102,1	101,6	4
93608	93008			108,5	108,0	4 1/4
93610	93010	93110		111,0	110,0	4 3/8
93614	93014	93114		114,8	114,3	4 1/2
93620	93020	93120		121,0	120,0	4 3/4
93627	93027	93127		128,0	127,0	5



INOX



Dinex no.	ID mm	OD mm	OD Inch
L1500mm			
	64,0	63,5	2 1/2
93577	76,7	76,2	3
93503	102,1	101,6	4
93528	128,0	127,0	5



Material thickness 1,5 mm.

Tail Pipes

A single tail pipe with male or female connection.



Tail Pipes OD



Dinex no.	Dinex no.	OD mm	OD Inch	L mm
ALU	INOX			
91477	91476	76,1	3	1000
80714		88,9	3 1/2	1220
91403		101,6	4	1500
91428	91427	127,0	5	1000
91429	91426	127,0	5	1500

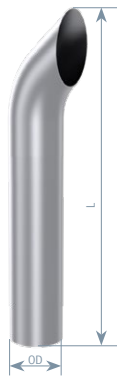

Tail Pipes ID



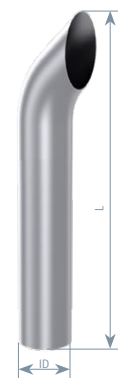

Dinex no.	Dinex no.	ID mm	ID Inch	L mm
ALU	INOX			
91450		50,5	2	260
91460		60,5	2 3/8	305
91470		70,5	2 3/4	300
91475		75,5	3	365
	91077	76,2	3	500
91480		80,5	3 1/8	340
	91090	90,2	3 1/2	500
	91290	89,5	3 1/2	1510
91491		90,5	3 1/2	360
91401		101,0	3 7/8	375
	91003	102,0	4	500
91412		111,0	4 3/8	535
91421		121,0	4 3/4	515
91431	91432	128,0	5	500
91430		128,0	5	1500





T & Y Adaptors, Connectors

Two or three way junction connections for different configurations.



 		
Dinex no.	OD mm	OD Inch
ALU		
91727	127,0	5

 			
Dinex no.	OD mm	OD Inch	Design
INOX			
91814	114,3	4 1/2	T

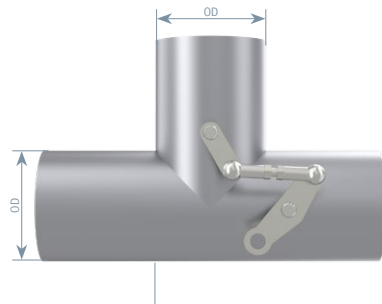

Pipe Connectors

A single piece stepped pipe connector for joining different diameters.

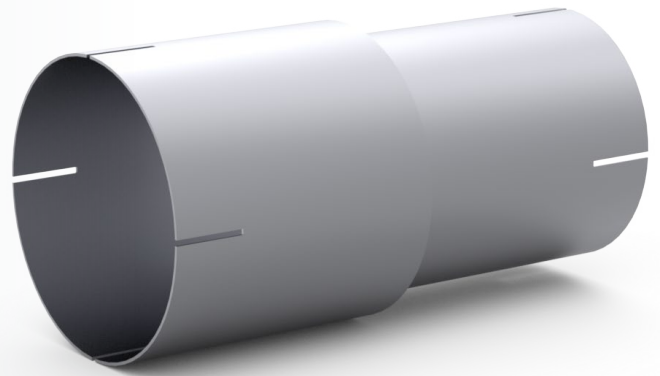

ID/ID



Dinex no.	ID1 mm	ID2 mm	ID1 Inch	ID2 Inch
ALU				
93751	51,0	60,5	2	2 3/8
93760	60,5	64,0	2 3/8	2 1/2
93762	60,5	76,7	2 3/8	3
93764	64,5	70,8	2 1/2	2 3/4
93770	70,5	76,7	2 3/4	3
93776	76,7	89,5	3	3 1/2
93777	76,7	103,0	3	4
93780	80,5	89,5	3 1/8	3 1/2
93789	89,4	102,1	3 1/2	4
93793	89,4	114,8	3 1/2	4 1/2
93713	102,1	114,8	4	4 1/2
93705	102,1	127,5	4	5
93718	110,5	127,5	4 1/2	5
93719	114,8	127,5	4 1/4	5
93720	120,5	127,5	4 3/4	5

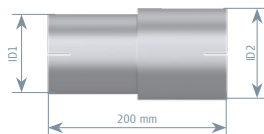

ID/OD



Dinex no.	Dinex no.	ID mm	OD mm	ID Inch	OD Inch
ALU	INOX				
93769		70,8	76,2	2 3/4	3
	93775	76,7	88,9	3	3 1/2
93785		77,0	102,0	3	4
93778		89,4	101,6	3 1/2	4
93714		102,1	114,3	4	4 1/2
93225		103,0	127,0	4	5
93729		115,0	127,0	4 1/2	5

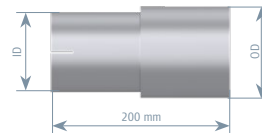

ID/OD



Dinex no.	Dinex no.	ID mm	OD mm	ID Inch	OD Inch
ALU	INOX				
93782		77,0	76,0	3	3
93790		89,4	76,2	3 1/2	3
93783		103,0	76,0	4	3
93703		102,1	88,9	4	3 1/2
93715		114,8	101,6	4 1/2	4
93722		128,0	102,0	5	4

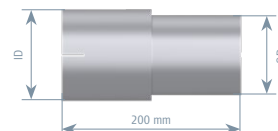

Pipe Connectors

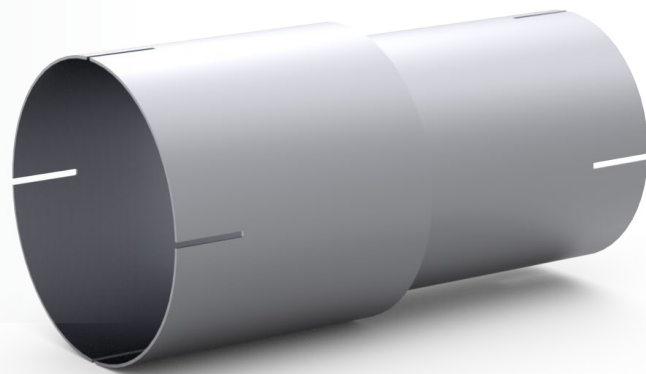

ID/ID



Dinex no.	ID mm	ID Inch	L mm
ALU			
93752	51,0	2	200
93759	61,0	2 3/8	200
93765	66,0	2 5/8	220
93771	71,0	2 3/4	210
93773	76,0	3	200
93781	76,5	3	200
93779	81,0	3 1/8	270
93788	90,0	3 1/2	250
93784	101,0	4	300
93706	103,0	4	200
93786	111,0	4 3/8	210
93725	115,0	4 1/2	300
93723	121,0	4 3/4	210
93724	128,0	5	205

Material thickness 1,5 mm

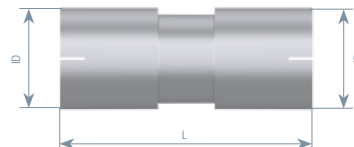

Flex Pipes

The Dinex brand piece of flexible pipe providing optimal sealing, flexibility and life-expectancy.

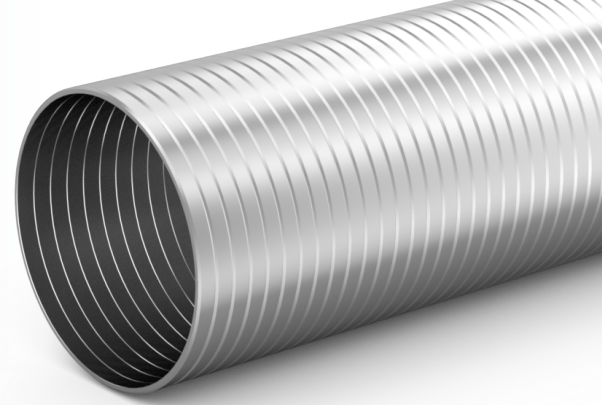

ZINC



Dinex no.	Dinex no.	OD mm	OD Inch	ID mm	ID Inch	Flex
L1000mm	L2000mm					
94125	94225	29,0	1 1/7	25,0	1	D2S
94128	94228	34,0	1 1/3	30,0	1 1/8	D2S
94132	94232	36,0	1 2/5	32,0	1 1/4	D2S
94135	94235	40,0	1 3/5	36,0	1 3/8	D2S
94138	94238	43,0	1 5/7	39,0	1 1/2	D2S
94141	94241	46,0	1 4/5	42,0	1 5/8	D2S
94144	94244	49,0	1 9/10	45,0	1 3/5	D2S
94148	94248	52,0	2	48,0	1 7/8	D2S
94151	94251	55,0	2 1/6	51,0	2	D2S
94154	94254	58,5	2 2/6	54,5	2 1/8	D2S
94157	94257	62,0	2 2/5	58,0	2 1/4	D2S
94160	94260	65,0	2 4/7	61,0	2 3/8	D2S
94164	94264	68,0	2 2/3	64,0	2 1/2	D2S
	94265	70,0	2 5/7	66,0	2 5/8	D2S
94167	94267	71,0	2 4/5	67,0	2 5/8	D2S+
94170	94270	74,0	2 9/10	70,0	2 3/4	D2S
94176	94276	80,5	3 1/5	77,1	3	D2S+
94180	94280	84,4	3 1/3	81,0	3 1/8	D2S+
94183	94283	87,0	3 2/5	83,0	3 1/4	D2S
94185	94285	90,0	3 1/2	86,0	3 2/5	D2S
94189	94289	93,3	3 2/3	89,9	3 1/2	D2S+
	94292	97,0	3 4/5	93,0	3 5/8	D2S+
94195	94295	99,0	3 8/9	95,0	3 3/4	D2S
94100	94200	104,4	4 1/8	101,0	3 7/8	D2S+
94102	94202	106,1	4 1/5	102,7	4	D2S
94108	94208	112,0	4 2/5	108,0	4 1/4	D2S+
94110	94210	113,4	4 1/2	110,0	4 3/8	D2S+
94114	94214	118,9	4 5/7	115,5	4 1/2	D2S+
94120	94220	125,2	4 9/10	121,2	4 3/4	D2S+
94126	94226	130,5	5 1/8	126,5	5	D2S
94127	94227	131,7	5 1/5	128,3	5	D2S+
94131	94231	135,5	5 1/3	131,5	5 1/6	D2S
94140	94240	144,4	5 3/4	141,0	5 1/2	D2S+
94152	94252	157,5	6 1/5	153,8	6	D2S+

Max temperature 550 degrees - corrosion can occur at high temperatures.



L - compressed length



D2S

D2S+

Flex Pipes

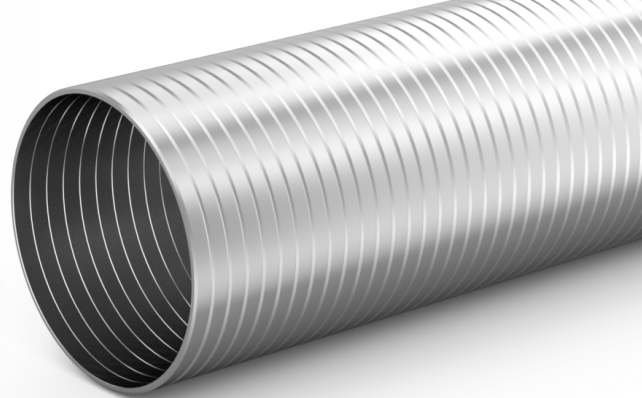

INOX



Dinex no.	Dinex no.	OD mm	OD Inch	ID mm	ID Inch	Flex
L1000mm	L2000mm					
95125	95225	29,0	1 1/7	25,0	1	D2S
95132	95232	36,0	1 2/5	32,0	1 1/4	D2S
95138	95238	43,0	1 5/7	39,0	1 1/2	D2S
95141	95241	46,0	1 4/5	42,0	1 5/8	D2S
95144	95244	49,0	1 9/10	45,0	1 3/4	D2S
95151	95251	55,0	2 1/6	51,0	2	D2S
95154	95254	58,0	2 1/4	54,0	2 1/8	D2S
	95257	62,0	2 2/5	58,0	2 1/4	D2S
95160	95260	65,0	2 1/2	61,0	2 3/8	D2S
95164	95264	68,0	2 1/6	64,0	2 1/2	D2S
95165	95265	70,0	2 5/7	66,0	2 5/8	D2S
95170		74,0	2 9/10	70,0	2 3/4	D2S
95176	95276	80,5	3 1/5	77,1	3	D2S+
95180	95280	84,4	3 1/3	81,0	3 1/8	D2S+
95185	95285	90,0	3 1/2	86,0	3 2/5	D2S
95189	95289	93,3	3 5/7	89,9	3 1/2	D2S+
	95217	93,9	3 5/7	89,9	3 1/2	D3S
95100	95200	104,4	4 1/8	101,0	3 7/8	D2S+
95102	95202	106,1	4 1/5	102,7	4	D2S+
	95218	106,7	4 1/2	102,7	4	D3S
95108	95208	112,0	4 2/5	108,0	4 1/4	D2S
95110	95210	113,4	4 1/2	110,0	4 3/8	D2S+
95114	95214	118,9	4 5/7	115,5	4 1/2	D2S+
95120	95220	124,6	4 9/10	121,2	4 3/4	D2S+
95126	95226	130,5	5 1/8	126,5	5	D2S
95127	95227	131,7	5 1/5	128,3	5	D2S+
	95219	132,3	5 1/5	128,3	5	D3S
95131	95231	135,5	5 1/3	131,5	5 1/8	D2S
95140		144,4	5 2/3	141,0	5 1/2	D2S+
95153	95253	157,2	6 1/5	153,8	6	D2S+

Max temperature 550 degrees.

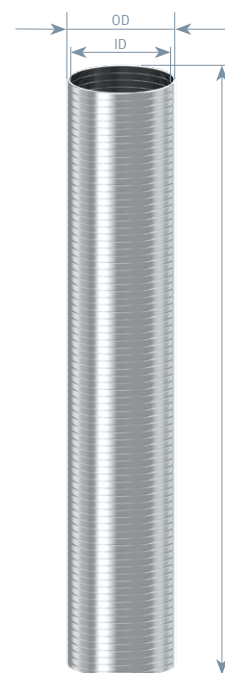

L - compressed length

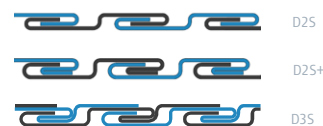

INOX - Convuluted Flex



Dinex no.	L mm	OD mm	OD Inch	ID mm	ID Inch
95191	1000	103,0	4	77,0	3

Flex Pipes

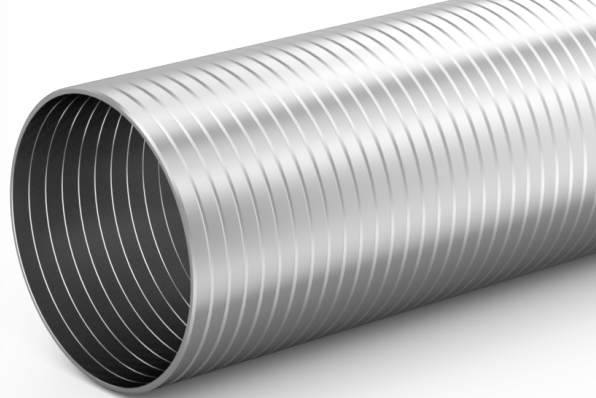

INOX (L<1000 mm)



Dinex no.	L mm	OD mm	OD Inch	ID mm	ID Inch	Flex
80220	326	80,5		77,1	3	D2S+
80513	258	93,3		89,9	3 1/2	D2S+
80155	392	93,3		89,9	3 1/2	D2S+
49199	353	104,4	4	101,0	3 7/8	D2S+
82133	334	106,1		102,7	4	D2S+
94500	513	106,1		102,7	4	D2S+
49133	315	113,4		110,0	4 3/8	D2S+
68217	262	118,9		115,5	4 1/2	D2S+
81224	306	118,9		115,5	4 1/2	D2S+
80131	373	118,9		115,5	4 1/2	D2S+
82187	233	118,9		115,5	4 1/2	D2S+
49247	382	125,5		121,2	4 3/4	D2S+
81728	124	131,7		128,3	5 1/16	D2S+
82140	295	131,7		128,3	5 1/16	D2S+
94501	513	131,7		128,0	5	D2S+

Max temperature 550 degrees.



L - compressed length



Flex Pipes & Bellows

A single piece of flexible pipe with the connection of your choice.

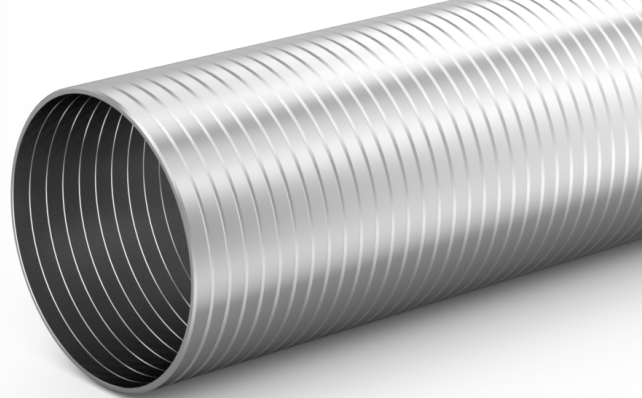

Flex Pipes with Joints



Dinex no.	A-end		B-end		L mm	Flex
	Type	Ø mm	Type	Ø mm		
53162	Plain	OD 71,5	Slitted	ID 77,0	365	D2S+
51290	Plain	OD 88,9	Slitted	ID 90,5	365	D2S+
52176	Slitted	ID 76,0	Slitted	ID 72,5	365	D2S+
47194	Plain	OD 110,0	Flex	ID 110,5	415	D2S+
47183	Plain	OD 110,0	Flex	ID 110,5	375	D2S+

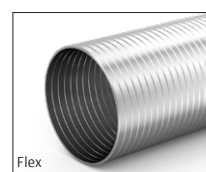
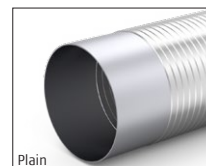

With Exterior Steel Braid



Dinex no.	L mm	ID mm	C mm	D mm
INOX				
95350	280	ID 51,5	230	25
95361	250	ID 60,5	200	25
95362	150	ID 60,5	100	25
95364	250	ID 63,8	200	25
95376	380	ID 76,0	320	30
95375	250	ID 76,5	200	25
95389	380	ID 90,0	300	50
95301	385	ID 103,0	285	50

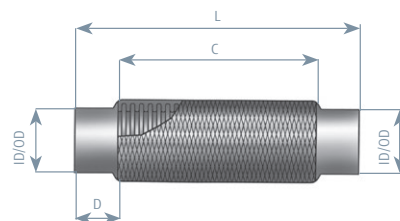

With Steel Braid & Inner Flex Layer



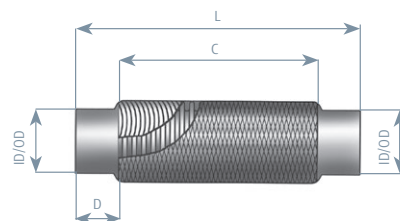

Dinex no.	L mm	ID mm	C mm	D mm
INOX				
95363	200	ID 60,5	150	25
95334	152	ID 76,2	98	17
95335	203	ID 76,2	153	25
95336	255	ID 76,5	204	25





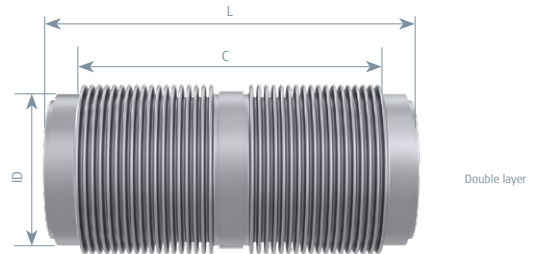

Bellows

A single bellow designed to cope with uniform vibration for extended period of time.



 				
Dinex no.	L mm	ID mm	C mm	D mm
INOX				
95313	298	111,0	288	30

 				
Dinex no.	L mm	ID/OD mm	C mm	D mm
INOX				
95302	179	OD 102,0	103	38

 				
Dinex no.	L mm	OD mm	C mm	D mm
INOX				
87141	160	102,0	95	35



Bellow Flex

This unique and strong lasting decoupling element with a combination of bellow and flexible pipe is mainly for off-road applications.



Dinex no.	L mm	ID mm	Connection Type
INOX			
9BB073	200	101,6	Female
9BB074	300	101,6	Male
9BB075	400	101,6	Straight pipe
9BB076	200	127	Female
9BB077	300	127	Male
9BB078	400	127	Straight pipe



Advantages:

- Outstanding flexibility
- Fully leak-tight component
- Protected thermal insulation
- Noise reduction
- Low surface temperature
- Enhanced durability
- Options with changeable flexible part available

Absorption Silencers

A single straight piece acoustic silencer for noise reduction with female connections.

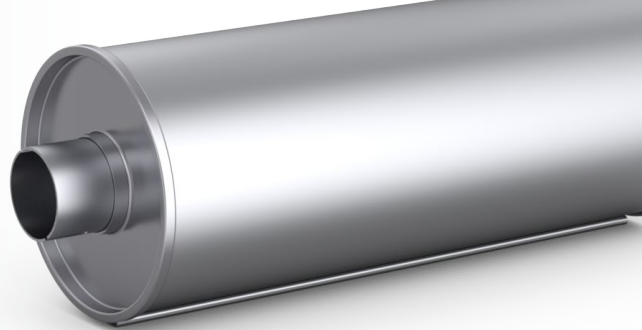

Dinex no.	L mm	Ø mm	ID mm	ID Inch
ALU				
89360	954	184	61	2 3/8
89376	1140	184	76,5	3
89438	890	206	103,0	4
68305	1050	300	111,0	4 3/8
89327	1140	249	128,0	5

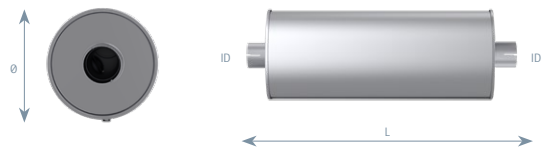

Auxiliary Heater Exhaust Flex pipes

Auxiliary heater exhaust flex pipes (Double-layer)



Dinex no.	Dinex no.	Dinex no.	ID mm	Wall thickness	Bending
L1000mm	L2000mm	L2000mm		mm	Radius mm
95279	95281	95081	22	1,7	~44
95284	95282	95084	24	1,7	~48
	95286	95088	30	1,7	~60
	95291	95094	38	1,7	~76
	95296	95096	70	1,7	~140

Material: INOX

Thermal resistance: -40°C to + 300°C

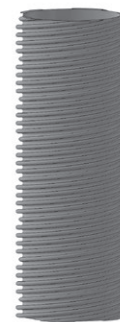

Universal Silencers

A single silencer with both male and female connections for a variety of configurations.

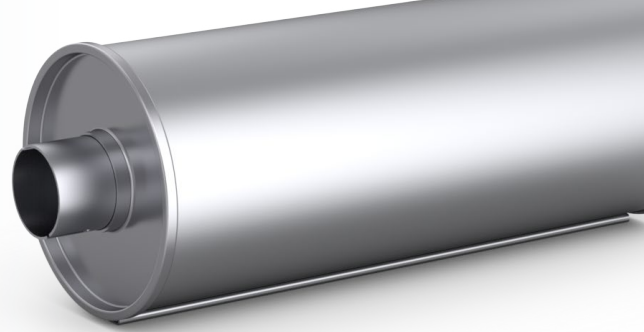

Ø50-70/20-160 HP (kW = HP/1,36)



Dinex no.	HP	KW	L mm	Ø mm	Inlet	Outlet
ALU						
89441	20-70	15-52	495	152	ID 51,5	OD 50

Dinex no.	HP	KW	L mm	Ø mm	Inlet	Outlet
ALU						
50401	50-110	37-81	770	181	ID 51,0	ID 51,0

Dinex no.	HP	KW	L mm	Ø mm	Inlet	Outlet
ALU						
29302	90-160	66-118	1025	203	ID 64,5	ID 77,0

Dinex no.	HP	KW	L mm	Ø mm	Inlet	Outlet
ALU						
49311	90-140	66-103	950	203	ID 65,5	ID 65,5

Dinex no.	HP	KW	L mm	WxL	Inlet	Outlet
ALU						
47300	90-160	66-118	810	180x277	ID 66,0	ID 90,5

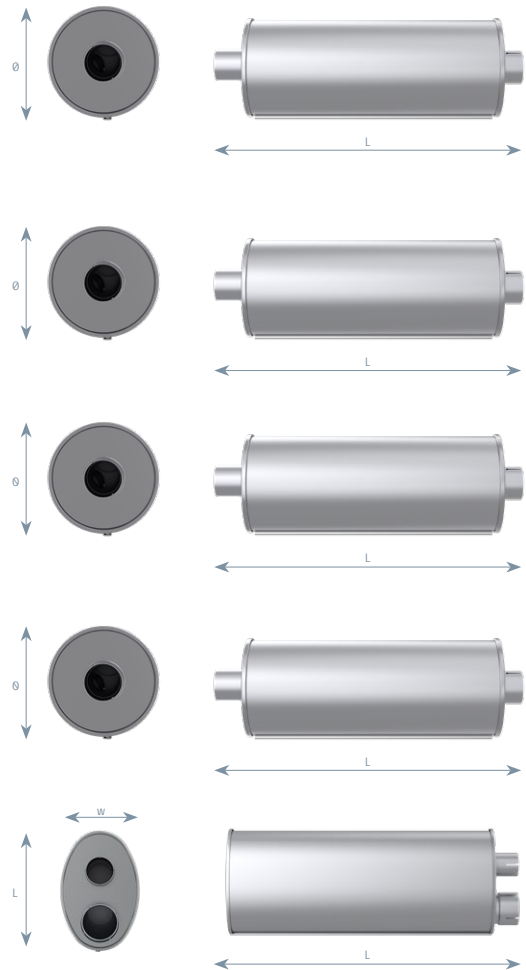

Universal Silencers

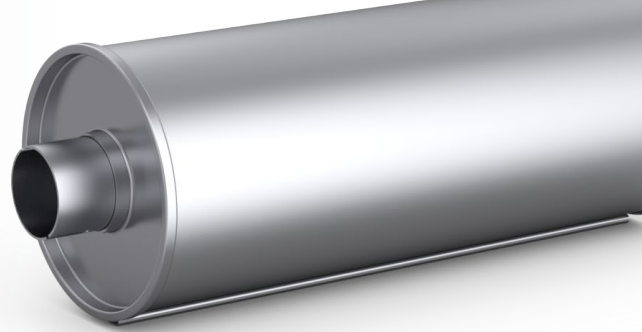

075-080 / 90-240 HP (kW=HP/1,36)



Dinex no.	HP	KW	L mm	WxL	Inlet	Outlet
ALU					ID	OD
28331	100-230	73-170	750	210x330	77,0	76,2

Dinex no.	HP	KW	L mm	Ø mm	Inlet	Outlet
ALU					ID	OD
21335	90-230	66-170	850	263	77,0	88,9

Dinex no.	HP	KW	L mm	Ø mm	Inlet	Outlet
ALU					ID	ID
16305	90-230	66-170	740	203	77,0	77,0

Dinex no.	HP	KW	L mm	Ø mm	Inlet	Outlet
ALU					ID	ID
15301	90-160	66-118	825	203	77,0	77,0

Dinex no.	HP	KW	L mm	Ø mm	Inlet	Outlet
ALU					ID	ID
80316	90-160	66-118	585	246	77,0	77,0

Dinex no.	HP	KW	L mm	Ø mm	Inlet	Outlet
ALU					ID	ID
44337	90-140	66-103	830	246	77,0	90,5

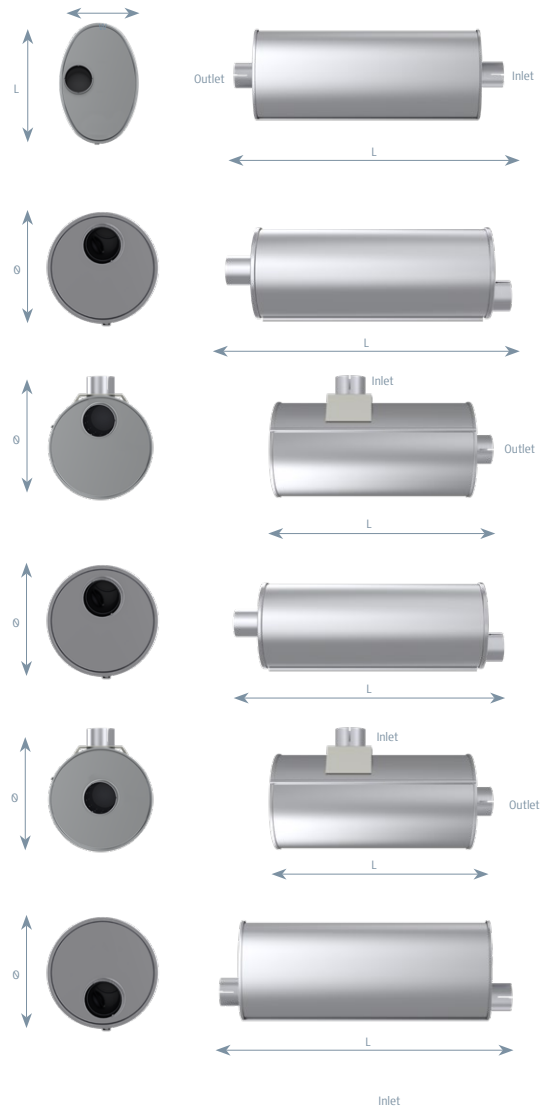

Universal Silencers



Ø90-Ø115 / 90-250 HP (kW=HP/1,36)



Dinex no.	HP	KW	L mm	Ø mm	Inlet	Outlet
ALU					ID	ID
89390	90-250	66-184	1000	183,5	90,0	90,0

Dinex no.	HP	KW	L mm	Ø mm	Inlet	Outlet
ALU					ID	OD
89326	90-250	66-184	740	263	89,5	102,0

Dinex no.	HP	KW	L mm	WxL	Inlet	Outlet
ALU					ID	OD
50337	90-200	66-147	1120	186x286	90,5	86,5

Dinex no.	HP	KW	L mm	WxL	Inlet	Outlet
ALU					ID	OD
50356	90-150	66-111	1050	186x286	90,5	71,5

Dinex no.	HP	KW	L mm	Ø mm	Inlet	Outlet
ALU						
21312	100-250	73-184	840	297	ID 90,5	OD 89,0
50399	160-250	120-184	1200	234	ID 90,5	ID 90,5

Dinex no.	HP	KW	L mm	Ø mm	Inlet	Outlet
ALU					ID	ID
80334	100-220	73-162	845	246	90,5	90,5

Dinex no.	HP	KW	L mm	WxL	Inlet	Outlet
ALU					ID	OD
50425	170-240	125-177	1060	186x286	90,5	86,5

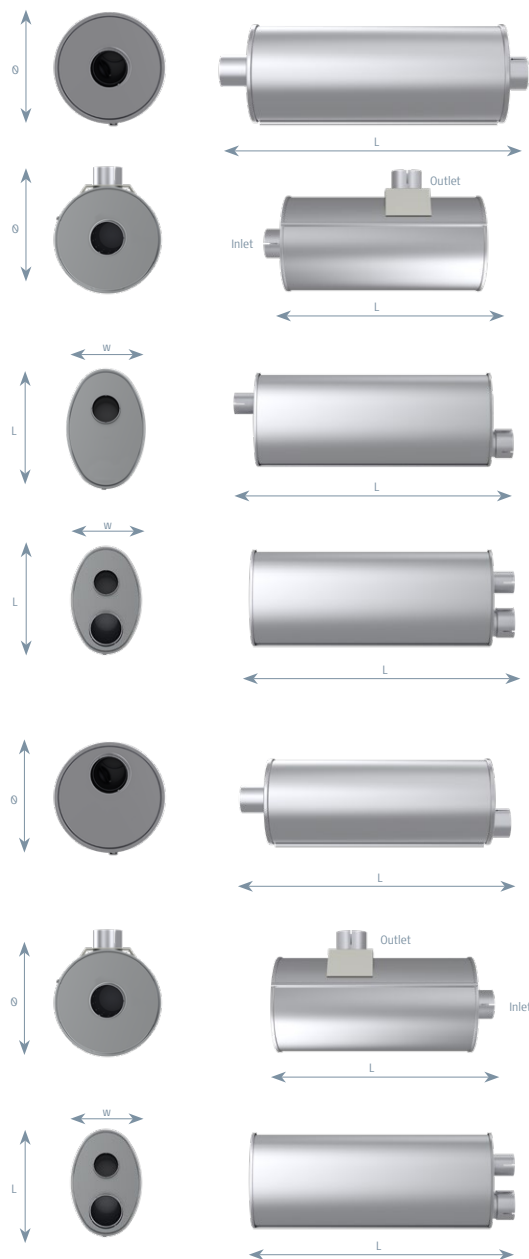

Universal Silencers

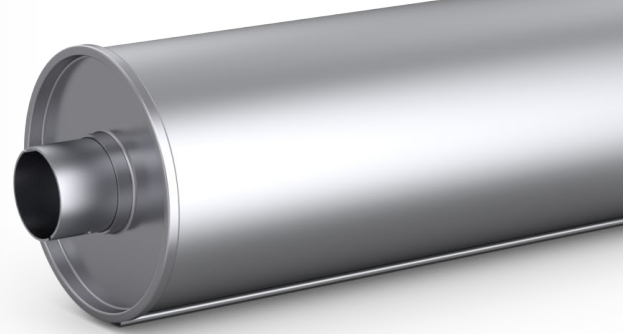

Ø100-Ø111 / 200-450 HP (kW=HP/1,36)



Dinex no.	HP	KW	L mm	Ø mm	Inlet	Outlet
ALU						
89403	200-300	147-221	1000	185	ID 103,0	ID 103,0

Dinex no.	HP	KW	L mm	Ø mm	Inlet	Outlet
ALU						
50404	200-340	147-250	1220	300	ID 101,3	OD 104,3

Dinex no.	HP	KW	L mm	Ø mm	Inlet	Outlet
ALU						
50392	200-300	147-221	1155	281	ID 101,0	OD 100,0

Dinex no.	HP	KW	L mm	Ø mm	Inlet	Outlet
ALU						
50422	200-300	147-221	839,5	281	ID 102,4	OD 85,0

Dinex no.	HP	KW	L mm	Ø mm	Inlet	Outlet
ALU						
44304	200-300	147-221	1220	246	ID 101,9	ID 101,9

Dinex no.	HP	KW	L mm	Ø mm	Inlet	Outlet
ALU						
89322	300-450	221-331	1050	297	ID 111,0	ID 111,0

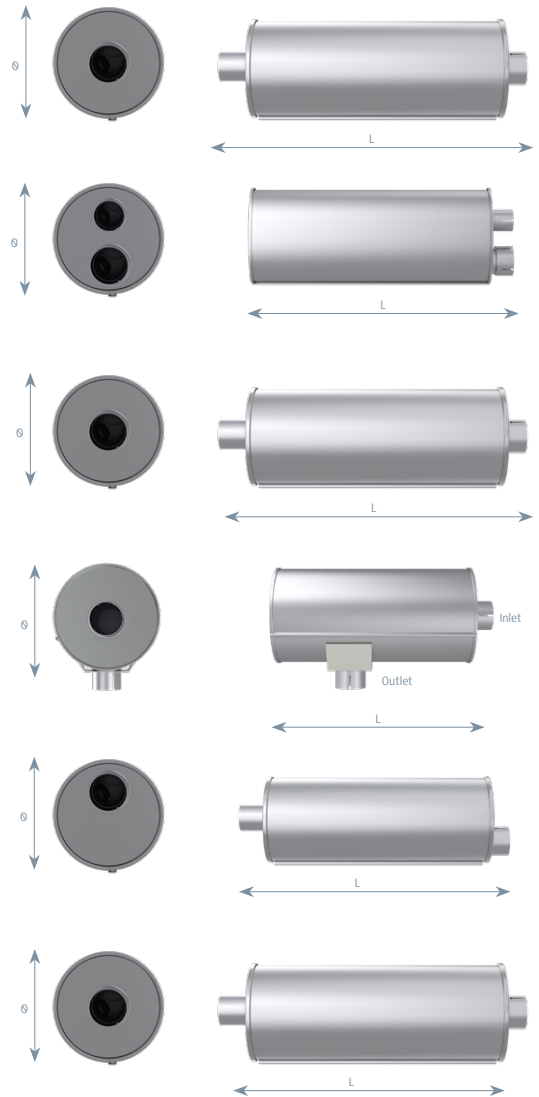

Universal Silencers

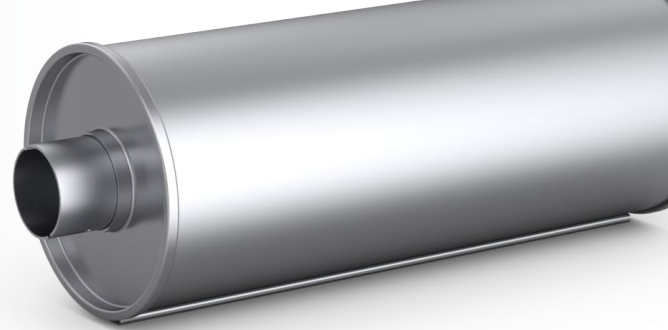

Ø102-Ø128 / 300-500 HP (kW=HP/1,36)



Dinex no.	HP	KW	L mm	Ø mm	Inlet	Outlet
ALU						
89415	300-350	221-258	1000	185	ID 115,0	ID 115,0

Dinex no.	HP	KW	L mm	WxL	Inlet	Outlet
ALU						
24313	300-450	221-331	1240	251x327	ID 115,0	ID 115,0

Dinex no.	HP	KW	L mm	Ø mm	Inlet	Outlet
ALU						
21327	300-450	221-331	970	347	ID 115,0	OD 114,3

Dinex no.	HP	KW	L mm	Ø mm	Inlet	Outlet
ALU						
80407	300-500	221-368	1565	246	ID 129,0	ID 129,0

Dinex no.	HP	KW	L mm	WxL	Inlet	Outlet
ALU						
70324	300-500	221-368	1075	252x379	ID 128,0	ID 128,0

Dinex no.	HP	KW	L mm	Ø mm	Inlet	Outlet
ALU						
70320	300-500	221-368	1235	246	ID 129,0	ID 129,0

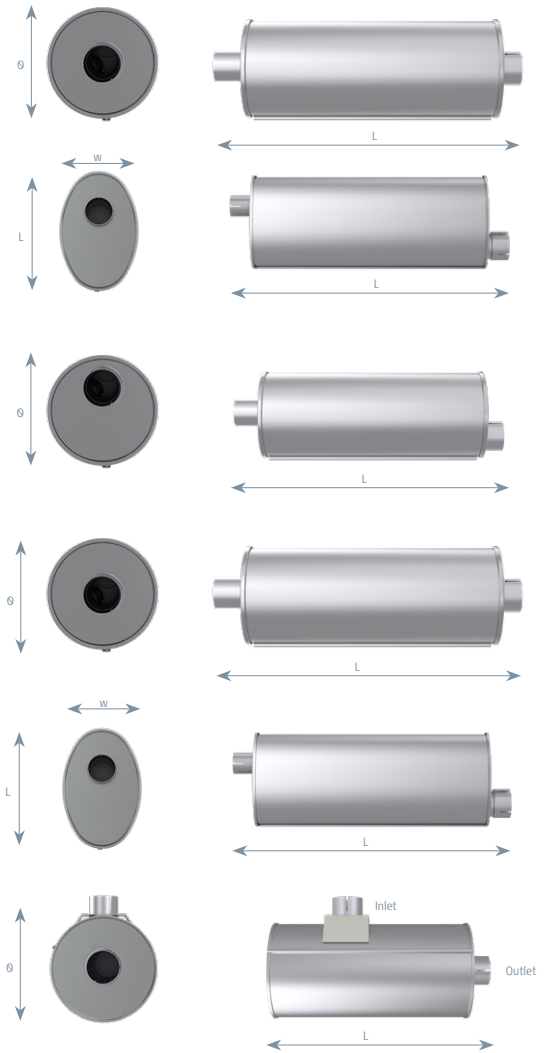

Rain Caps

Rain caps for preventing rain or other water from entering in a vertical outlet pipe.



Dinex no.	Dinex no.	Ø mm	Ø Inch
ZINC	INOX		
98450	98550	50,5	2
98460	98560	60,5	2 3/8
98464	98564	63,5	2 1/2
98470		70,5	2 3/4
98476	98576	76,5	3
98480	98580	80,5	3 1/8
98489	98589	90,0	3 1/2
98400	98500	100,5	3 7/8
98402	98602	102,0	4
98410		110,5	4 3/8
98414	98614	115,0	4 1/2
98420	98620	120,5	4 3/4
98427	98627	127,5	5
98451	98651	152,0	6



Dinex no.	Ø mm	Ø Inch
ZINC		
98445	45,0	1 3/4
98452	50,0	2
98455	55,0	2 1/8
98461	60,0	2 3/8
98465	65,0	2 5/8
98475	75,0	3
98481	80,0	3 1/8
98491	90,0	3 1/2
98401	100,0	3 7/8
98415	115,0	4 1/2
98421	120,0	4 3/4
98430	130,0	5 1/8

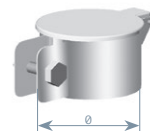

Pipe Spark Arrestors

Spark arrestor solutions for fitting on pipes. Designed to prevent spark emissions for the harshest of environments.

Dinex no.	Ø mm
GALV	
40800	32,5 - 39,0
40801	39,5 - 44,0
40802	44,5 - 49,0
40803	49,5 - 54,0
40804	54,5 - 59,0

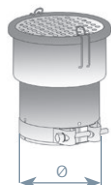

Repair kit

Dinex no.
GALV
40822

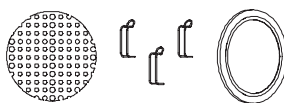

Dinex no.
GALV
40805

Dinex no.	Ø mm
GALV	
40806	50,5
40807	55,5
40808	60,5
40809	65,5
40810	70,5
40811	75,5
40812	80,5
40813	85,5
40814	90,5
40816	101,0
40817	106,0
40818	111,0
40819	116,0
40820	121,0 - 126,0
40821	131,0 - 136,0

DPF Accessory Kits

Dinex offers DPF accessory kits with all clamps and gaskets needed to replace DPF.



Make	Model	OE No	Dinex No	Parts in Kit	OE No for Kit Parts	Type	Q-ty per kit. pcs.
DAF	LF/CF	1997442	2AL017	2AL018	-	Gasket	1
				2AL019	-	V-clamp	1
DAF	LF/CF	1926845	2AL022	6LL012	-	Gasket	1
				6LL011	-	V-clamp	1
DAF	CF/XF	1927181	2AL038	2AL008	-	Gasket	1
				2AL009	-	V-clamp	1
				2AL010	-	Gasket	1
				2AL011	-	Rope	1
				2AL012	-	Knitwire	1
				2AL043	2325404	V-clamp	1
DAF	CF/XF	2192099	2AL042	2AL044	-	Gasket	2
				2AL045	-	Knitwire	1
				2AL046	-	Rope	1
				2KL014	-	V-clamp	1
Iveco	Stralis/Crossway/Urbanway/ Crossway/Arway	5801651134	2KJ000	2KL015	-	Flat clamp	1
				2KL016	-	Gasket	1
				2KL028	-	Gasket	1
Iveco	Eurocargo	5801651206	2KL017	2KL030	-	V-clamp	1
				2KL029	-	Flat clamp	1
				4IL003	81.15901.0043	Gasket	2
MAN	TGS/TGX		4IJ002	4IL005	81.15901.0044	Gasket	1
				4IL004	81.97420.0184	V-clamp	1
				4IL006	81.97420.0185	V-clamp	1
				4IL014	81.15901.0046	Gasket	1
MAN	TGL/TGM		4IJ003	4IL013	81.15901.0047	Gasket	2
				4IL016	06.67431.4307	V-clamp	1
				4IL017	06.67431.4125	V-clamp	1
MAN	TGL/TGM		4IJ004	4IL014	81.15901.0046	Gasket	1
				4IL025	81.15901.0045	Gasket	2
				4IL021	06.67431.4282	V-clamp	1
				4IL017	06.67431.4125	V-clamp	1
Mercedes	Actros/Antos/Arocs	003.995.0702	5AL028	5AL032	002.995.9402	V-clamp	1
				5AL033	-	Gasket-graphit	1
				5AL034	-	Gasket-metallic	1
Mercedes	Atego		5AL029	5AL005	000.491.1380	Gasket	1
				5AL001	001.995.4544	Flat clamp	1
				35822	680.995.0202	V-clamp	1
Mercedes	Actros/Travego/Citaro/ Connecto/Tourismo/Integro		5AL030	50902	000.491.1580	Gasket	1
				5AL001	001.995.4544	Flat clamp	1
				5AL003	000.995.1833	V-clamp	1
Mercedes	Actros/Travego/Citaro/ Connecto/Tourismo/Integro		5AL031	50902	000.491.1580	Gasket	1
				5AL004	001.995.5644	Flat clamp	1
				5AL003	000.995.1833	V-clamp	1
Mercedes	Actros/Antos/Arocs		5AL062	5AL055	000.995.1833	V-clamp	1
				5AL021	000.491.1280	Gasket	1
				5AL004	001.995.5644	Flat clamp	1
Volvo	FE/FL	21922979	8AL030	8AL013	21664918	Gasket	2
				8AL014	21664904	V-clamp	1
				8AL015	21664906	V-clamp	1
				8AL005	21570880	Gasket	2
Volvo	FH/FM	21775801	8AL031	8AL006	21445539	V-clamp	1
				8AL016	21445536	V-clamp	1

Sensor Port

Replacement sensor ports in the form of threaded bushings or weld bungs.

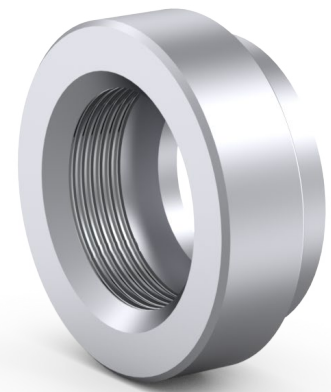

Dinex no.	Bushing Size	Type
9BB020	M20 x 1.5	1
9BB021	M20 x 1.5	2
9BB022	M18 x 1.5	3
9BB023	M18 x 1.5	4
9BB024	M16 x 1.5	5
9BB025	M16 x 1.5	6
9BB026	M14 x 1.5	7
9BB027	M14 x 1.5	8

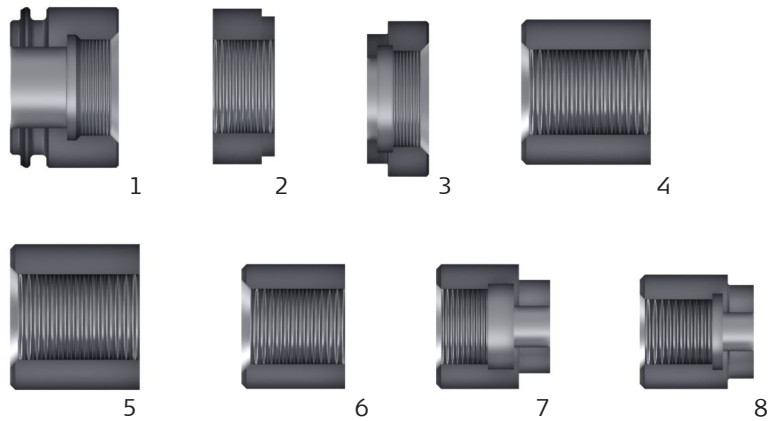

UniNox

Universal NOx sensors for a variety of applications using standardized fixtures, connectors and communication protocol.

Dinex no.	OE no.
9BB030	5WK96756A
9BB031	5WK96714B
9BB032	5WK96614J

Insulation

Dinex no.	Layer	Dimensions
210085	Reflect Ins layer	50 mm / 5,5 m
210084	Reflect Ins layer	100 mm / 5,5 m
210086	Protective outer layer	80 mm / 5,0 m

Dinex e-commerce platform

The Dinex e-commerce platform will increase efficiency and ease the procurement of goods for Dinex' aftermarket customers.

Dinex – Easy to do business with.



Visit the new Dinex webshop at dinex.net/webshop or scan QR code with your smartphone

- Custom made data transfer (API)
- Personalized webshop
- Claim handling
- Online return system
- Order / invoice history
- Available 24/7/365
- Time saving
- Warehouse status
- Gross-/net prices
- CSV import
- Responsxive on ALL devices
- Live events (product news, presentations, etc.)
- Detailed descriptions and pictures
- Installation videos
- 7 languages

Please contact your local Dinex office to create an user account.

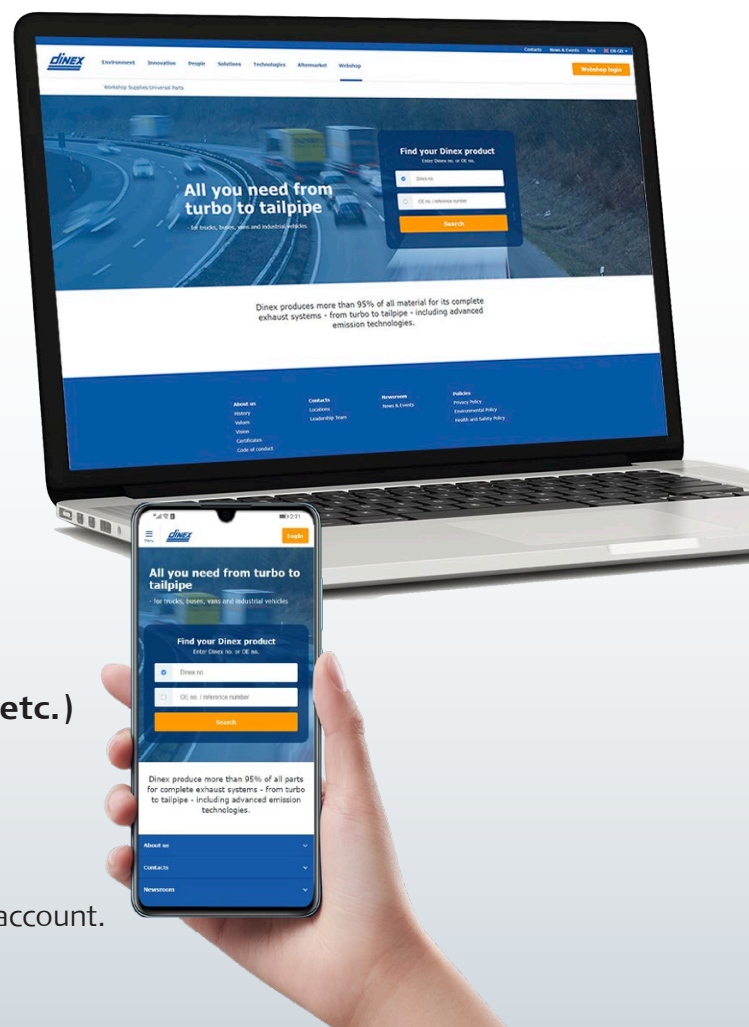

The aftermarket division of Dinex is a leading global manufacturer and distributor of innovative engineered exhaust and aftertreatment systems for the heavy duty truck industry with activities in Europe, North America and Russia.

With a program of more than 10.000 spare parts Dinex supply on a daily basis to over 6.000 distributors on a global scale. Our products are designed to the same level as OE or better. We take pride in our solutions with core technologies within modern aftertreatment systems for EURO 5 and 6 for Europe/Russia as well as EPA 07 and 10 for North America.

- | | | |
|----------------------------|--------------------------------------|--|
| ● Headquarter | ● Dinex A/S, DK | ● Dinex Polska Sp. Z.o.o., PL |
| ● Tech. Center | ● Dinex Latvia SIA, LV | ● Dinex SAS, FR |
| ● Factories | ● Dinex Emission Inc., US | ● Dinex Italia S.R.L., IT |
| ● Warehouse & Distribution | ● Dinex RUS LLC, RU | ● Dinex Ibérica Sistemas de Esca, ES |
| | ● Dinex Egzoz ve Emisyon Tekn.sa, TR | ● Dinex Balkan D.O.O., RS |
| | ● Dinex Exhausts Ltd., GB | ● Dinex Deutschland GmbH (Kalbach), DE |



Dinex is ready to serve you



06-2023 / 1AA043 "All drawings & illustrations are the property of Dinex and cannot be copied, duplicated or re-printed in any form without the prior written consent from Dinex."

going the extra mile

