



LAKES PRECISION^{INC.}

Your Global Source for Wire Processing Perishable Tooling

WANGSTON MACHINE SERIES

THIS SECTION CONTAINS BLADES FOR WANGSTON CMK-65 MACHINE SERIES

Your Global Source for Wire Processing Perishable Tooling

www.lakesprecision.com

WANGSTON CMK-65 MACHINE SERIES

COLLINEAR ANGLE STRAIGHT EDGE STRIP BLADES CLASS: CL-A

COLLINEAR ANGLE STRIP BLADES

Sharp edge is ground to a flat collinear angle.

This class of blade was designed to allow multiple conductor wire to be processed with one set of blades. This class is also used in many rotary strip models. The main advantage of this class is the ability to process many different wire gauges with the same blades, (dependent upon machine function).

There will always be a percentage of insulation tear with this class of blade. This class does not work well with thin wall insulation.

- *TC Coating Available* -

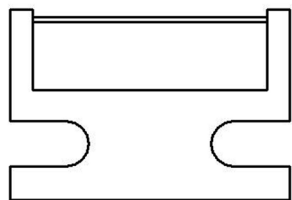

123271-XX

ITEM NUMBER	MARK	DESCRIPTION
123271-1	0.75 mm ²	CL-A STRAIGHT EDGE STRIP

WANGSTON CMK-65 MACHINE SERIES

COLLINEAR RADIUS / COLLINEAR ANGLE STRIP BLADES CLASS: CL-A / CL-R

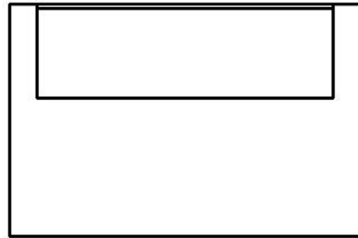

122792
1.2
CL-A STRIP

FOR ADDITIONAL INFORMATION ON WANGSTON BLADES,
PLEASE CONTACT LAKES PRECISION, INC.

- TC Coating Available -

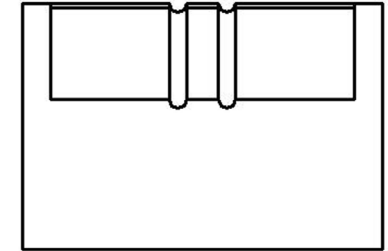

122793
048X134
CL-R STRIP

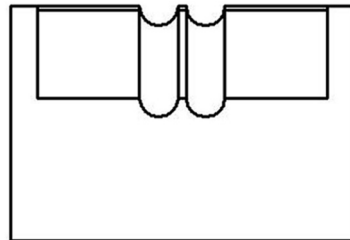

122794
110X134
CL-R STRIP

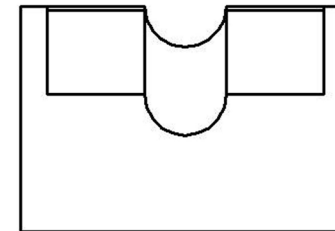

123020-XX
CL-R STRIP

• THREE LAKES, WI (715) 546-3070 • **CONTACT LAKES PRECISION** • EL PASO, TX (915) 856-6606 •
• EMAIL: BLADES@LAKESPRECISION.COM •