



# LAKES PRECISION<sup>INC.</sup>

*Your Global Source for Wire Processing Perishable Tooling*

## MAIER MACHINE SERIES

*THIS SECTION CONTAINS BLADES FOR MAIER MACHINE SERIES*

**Your Global Source for Wire Processing Perishable Tooling**

[www.lakesprecision.com](http://www.lakesprecision.com)

# MAIER MACHINE SERIES

TANGENT RADIUS “V” STRIP BLADES CLASS: TA-V

## TANGENT RADIUS “V” STRIP BLADES

The sharp edge is ground to an arc whose radius approximates awg wire size. The entry angle lines meet the arc at a tangent point. This type of blade, when closed, presents a diamond shaped edge profile.

**Advantages:** By adjusting cutter head shut height, ( if insulation material and wall thickness allow ), you can process adjacent wire extrusions.

**Disadvantages:** Inadequate for processing thin wall and/or hard insulations such as cross-link or fiberglass jackets.

- TC Coating Available -



123432-X

SIZE	MARK	ITEM NUMBER
CL	CL	123432-25
CLA	CLA	123432-26
V-012S	V-012S	123432-21
V-012L	V-012L	123432-22
V-022S	V-022S	123432-19
V-022L	V-022L	123432-20
V-034S	V-32	123432-1
V-034L	V-32L	123432-2
V-042S	V-364	123432-3
V-042L	V-364L	123432-4
V-052S	V-052S	123432-5
V-052L	V-052L	123432-6
V-062S	V-16	123432-7
V-062L	V-16L	123432-8

SIZE	MARK	ITEM NUMBER
V-076S	V-564	123432-9
V-076L	V-564L	123432-10
V-096S	V-332	123432-11
V-096L	V-332L	123432-12
V-112S	V-8	123432-13
V-112L	V-8L	123432-14
V-172A	V-316	123432-15
V-172L	V-316L	123432-16
V-172S	V-316S	123432-28
V-222A	V-732A	123432-17
V-222L	V-732L	123432-18
V-250A	V-4A	123432-23
V-250L	V-4L	123432-24
V-250S	V-4S	123432-27

### TRU-RADIUS STRIP BLADE

The sharp edge is ground to a half circle whose radius approximates awg wire size. The entry angle lines intersect the half circle at the quadrant points. This type of blade, when closed, presents a true circle profile.

**Advantages:** This type of blade is excellent for precise and clean jacket removal because it combines the scissor-like shearing action of the by-pass blade with the exact hole profile matching a conductor gauge. Excellent for thin wall cross-link PVC and most rubbery or elastic insulations ( thin or thick wall ).

**Disadvantages:** Shut height cannot be modified to process adjacent wire sizes. Off center wire condition has to be considered when choosing blade size

- TC Coating Available -

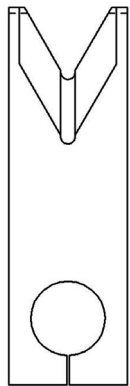

123437-X

ITEM NUMBER	MARK	DESCRIPTION
123437-21	TRV-022S	TR-V STRIP
123437-22	TRV-022L	TR-V STRIP
123437-17	TRV-052S	TR-V STRIP
123437-18	TRV-052L	TR-V STRIP
123437-11	TRV-078S	TR-V STRIP
123437-12	TRV-078L	TR-V STRIP
123437-13	TRV-094S	TR-V STRIP
123437-14	TRV-094L	TR-V STRIP
123437-19	TRV-120S	TR-V STRIP
123437-20	TRV-120L	TR-V STRIP
123437-23	TRV-190A	TR-V STRIP
123437-24	TRV-190L	TR-V STRIP
123437-25	TRV-190S	TR-V STRIP

ITEM NUMBER	MARK	DESCRIPTION
123437-15	TRV-130S	TR-V STRIP
123437-16	TRV-130L	TR-V STRIP
123437-1	TRV-250A	TR-V STRIP
123437-2	TRV-250L	TR-V STRIP
123437-3	TRV-275A	TR-V STRIP
123437-4	TRV-275L	TR-V STRIP
123437-5	TRV-300A	TR-V STRIP
123437-6	TRV-300L	TR-V STRIP
123437-7	TRV-325A	TR-V STRIP
123437-8	TRV-325L	TR-V STRIP
123437-9	TRV-340A	TR-V STRIP
123437-10	TRV-340L	TR-V STRIP

# MAIER MACHINE SERIES

WIDE ENTRY ANGLE / TRU-RADIUS “V” BLADES CLASS: WE-A / TR-V

## WIDE ENTRY ANGLE

The sharp edge is ground at an angle that results in a “V” opening above 90 degrees.

Characteristics: Wide angle is not as effective for gathering wire towards the operating radius. This type works well for gathering thick, soft insulations, ( such as ignition wire ).

- TC Coating Available -

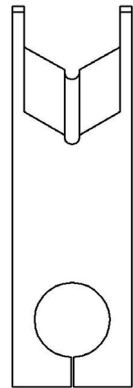

123476-X

ITEM NUMBER	MARK	ENTRY ANGLE	DESCRIPTION
123476-1	WE-TRV-078S	120	WE-A / TR-V STRIP
123476-2	WE-TRV-078L	120	WE-A / TR-V STRIP