



# LAKES PRECISION<sup>INC.</sup>

*Your Global Source for Wire Processing Perishable Tooling*

## COSMIC MACHINE SERIES

THIS SECTION CONTAINS BLADES FOR THE FOLLOWING MACHINE SERIES:

□ 30M      □ 32M      □ 48R      □ 927R      □ C-1010

**Your Global Source for Wire Processing Perishable Tooling**

[www.lakesprecision.com](http://www.lakesprecision.com)

## COLLINEAR ANGLE STRIP BLADES

Sharp edge is ground to a flat collinear angle.

This class of blade was designed to allow multiple conductor wire to be processed with one set of blades. This class is also used in many rotary strip models. The main advantage of this class is the ability to process many different wire gauges with the same blades, ( dependent upon machine function ).

There will always be a percentage of insulation tear with this class of blade. This class does not work well with thin wall insulation.

*- TC Coating Available -*

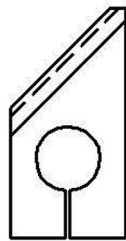

123574

ITEM NUMBER	DESCRIPTION	CLASS
123574	ROTARY STRIP	CL-A

## UNIVERSAL STRIP BLADES

The sharp edge is ground at an angle that results in a “V” opening of exactly 90 degrees.

Characteristics: 90 degree angle is widely accepted as the best entry angle to use for processing a wide range of wire sizes using the same blade setup. Most of the time, this class of blade incorporates a sharp edge ground to a very small or non-existing radius. It works sufficiently for most of standard wall insulation but is marginal for thin wall, cross-linked PVC, very rubbery insulations, woven fiber or thin-walled multi-conductors.

- TC Coating Available -

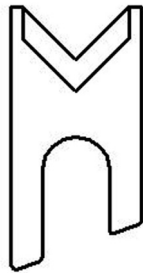

122163

ITEM NUMBER	OEM #	DESCRIPTION
122163	C21211	UN-V BLADE

### COLLINEAR ANGLE STRIP BLADES

Sharp edge is ground to a flat collinear angle.

This class of blade was designed to allow multiple conductor wire to be processed with one set of blades. This class is also used in many rotary strip models. The main advantage of this class is the ability to process many different wire gauges with the same blades, ( dependent upon machine function ).

There will always be a percentage of insulation tear with this class of blade. This class does not work well with thin wall insulation.

- TC Coating Available -

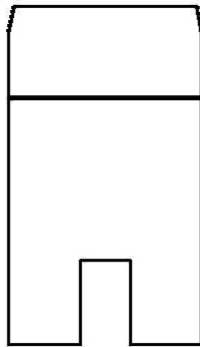

124595-XX

ITEM NUMBER	OEM #	MATERIAL	DESCRIPTION
124595-1	C-48902	A2 TOOL STEEL	CL-A
124595-2	-----	CARBIDE	CL-A
124595-3	-----	M2 TOOL STEEL	CL-A

### COLLINEAR ANGLE STRIP BLADES

Sharp edge is ground to a flat collinear angle.

This class of blade was designed to allow multiple conductor wire to be processed with one set of blades. This class is also used in many rotary strip models. The main advantage of this class is the ability to process many different wire gauges with the same blades, ( dependent upon machine function ).

There will always be a percentage of insulation tear with this class of blade. This class does not work well with thin wall insulation.

- *TC Coating Available* -

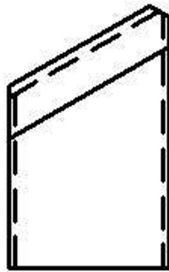

123777-X

OEM #

9-547951-2

ITEM NUMBER	DESCRIPTION	MATERIAL	CLASS
123777-1	ROTARY STRIP	TOOL STEEL	CL-A
123777-2	ROTARY STRIP	TUNGSTEN CARBIDE	CL-A

### COLLINEAR ANGLE STRIP BLADES

Sharp edge is ground to a flat collinear angle.

This class of blade was designed to allow multiple conductor wire to be processed with one set of blades. This class is also used in many rotary strip models. The main advantage of this class is the ability to process many different wire gauges with the same blades, ( dependent upon machine function ).

There will always be a percentage of insulation tear with this class of blade. This class does not work well with thin wall insulation.

- TC Coating Available -

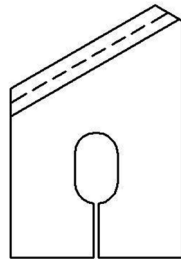

123702

ITEM NUMBER	DESCRIPTION	OEM #	CLASS
123702	ROTARY STRIP	-----	CL-A