



# LAKES PRECISION<sup>INC.</sup>

*Your Global Source for Wire Processing Perishable Tooling*

## **MECAL MACHINE SERIES**

*THIS SECTION CONTAINS BLADES FOR MECAL PRESS MACHINE SERIES*

**Your Global Source for Wire Processing Perishable Tooling**

[www.lakesprecision.com](http://www.lakesprecision.com)

### TRU-RADIUS STRIP BLADE

The sharp edge is ground to a half circle whose radius approximates awg wire size. The entry angle lines intersect the half circle at the quadrant points. This type of blade, when closed, presents a true circle profile.

**Advantages:** This type of blade is excellent for precise and clean jacket removal because it combines the scissor-like shearing action of the by-pass blade with the exact hole profile matching a conductor gauge. Excellent for thin wall cross-link PVC and most rubbery or elastic insulations ( thin or thick wall ).

**Disadvantages:** Shut height cannot be modified to process adjacent wire sizes. Off center wire condition has to be considered when choosing blade size.

- TC Coating Available -

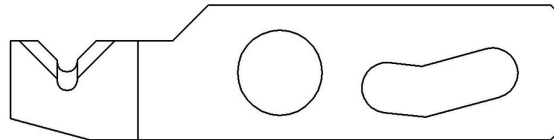

122987-XX

ITEM NUMBER	OEM #	DESCRIPTION
122987-016	-----	TR-V STRIP
122987-028	791130014	TR-V STRIP
122987-034	-----	TR-V STRIP
122987-039	791130011	TR-V STRIP
122987-059	791130020	TR-V STRIP
122987-072	-----	TR-V STRIP
122987-079	791130015	TR-V STRIP
122987-095	-----	TR-V STRIP
122987-100	-----	TR-V STRIP
122987-112	-----	TR-V STRIP
122987-118	791130016	TR-V STRIP
122987-125	-----	TR-V STRIP
122987-157	791130017	TR-V STRIP
122987-180	-----	TR-V STRIP

### TANGENT RADIUS “V” CUT / STRIP BLADES

The sharp edge is ground to an arc whose radius approximates awg wire size. The entry angle lines meet the arc at a tangent point. This type of blade, when closed, presents a diamond shaped edge profile.

**Advantages:** By adjusting cutter head shut height, ( if insulation material and wall thickness allow ), you can process adjacent wire extrusions.

**Disadvantages:** Inadequate for processing thin wall and/or hard insulations such as cross-link or fiberglass jackets.

- *TC Coating Available* -

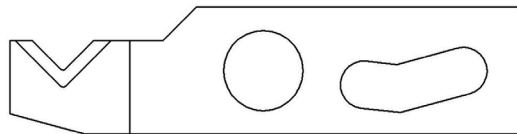

**122580-XX**

ITEM NUMBER	MARK	DESCRIPTION
1225801-1	R 0.15	TA-V CUT / STRIP
122580-2	R 0.5	TA-V CUT / STRIP
122580-3	R 0.75	TA-V CUT / STRIP
122580-4	R 1.0	TA-V CUT / STRIP
122580-7	R 1.2	TA-V CUT / STRIP
122580-5	R 1.5	TA-V CUT / STRIP
122580-6	R 2.0	TA-V CUT / STRIP
122580-8	R 0.35	TA-V CUT / STRIP