



## Under Sink Water Filtration System

### 智能PURA系列RO淨水器

#### 使用說明書

#### User Manual

使用前請仔細閱讀本說明書，並妥善保管

Please read this manual carefully before use, and keep it properly.

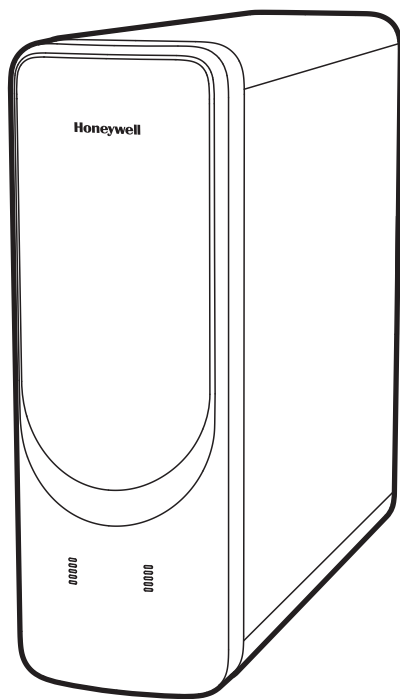

---

URHD1-210-S5-T

---



請先閱讀：用戶必讀和安裝注意事項  
Before use, please read the Must-Read  
and Installation Precautions.

目錄 .....	1
包裝內容 .....	2
產品介紹 .....	3
安裝 .....	5
使用淨水器 .....	7
濾心更換 .....	10
注意事項 .....	11
產品性能故障表及排除方法 .....	13
保固說明 .....	14
PACKING LIST .....	15
PRODUCT INTRODUCTION .....	16
INSTALLATION .....	18
USE INSTRUCTIONS .....	21
REPLACEMENT OF THE FILTER .....	23
NOTICE .....	26
TROUBLESHOOTING .....	28
PRODUCT WARRANTY INSTRUCTIONS .....	29

# 包裝內容

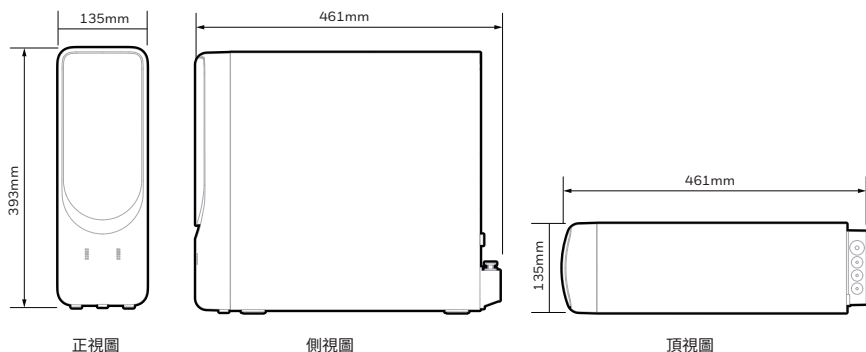

產品外觀示意，請以實物為準

名稱	數量
淨水器	1台
說明書	1本
進水三通球閥	1套
止水帶	1捲
拔管工具	1個
快接2分直通	1個
2分O型圈	3個為備品
3分O型圈	3個為備品
2分爪子	3個為備品
2分PE管線	2捲
3分PE管線	1捲
智能龍頭	1套
變壓器	1個
2分藍卡	安裝使用5個，多餘為備品
3分藍卡	安裝使用 1個，多餘為備品
3分爪子	3個為備件
長效複合式逆滲透濾心	1支
逆滲透膜濾心	1支
濾心接頭O型密封圈	2個為備品
手套	1雙
板手	1個

## 產品介紹

產品型號與規格	
名稱	Honeywell URHD1-210-S5-T 智能PURA系列RO淨水器
型號	URHD1-210-S5-T
純水流量	2.6L/min
純水額定總淨水量	5000L
額定功率	120W
淨水器額定電壓	24V $\overline{=}$
變壓器額定電壓	100~240V 50Hz/60Hz 2.5A
進水水質	限用自來水
進水壓力	15-60psi
工作壓力	60-120psi
適用水溫	5~38°C
產地	中國

★淨水流量和總額總淨水量，依照實際使用與地區水源品質而有所差異。

★機器適用進水壓力為15-60psi,壓力過高時，請安裝減壓閥。

# 產品介紹(續)

## 一、原理圖

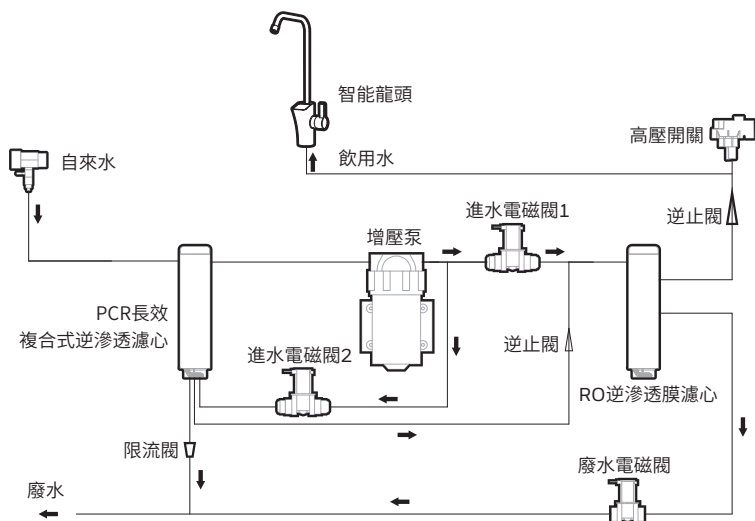

## 二、電氣圖

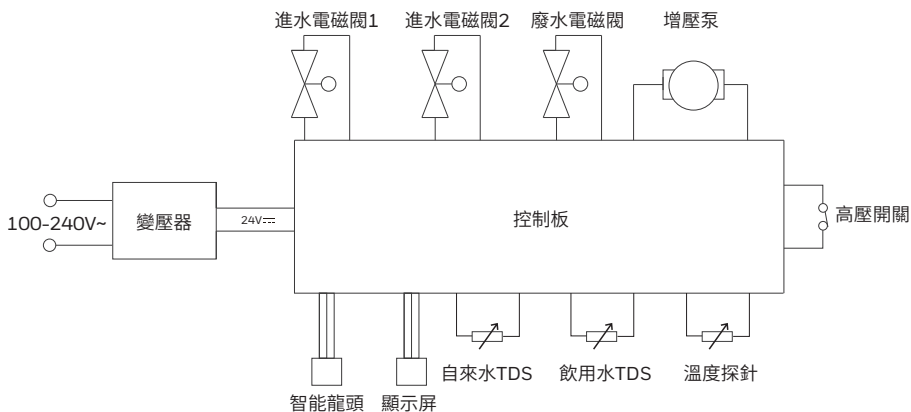

# 安裝

## 一、安裝前準備

- 1.開箱檢查產品及配件是否齊全,有無缺損。如有缺損,請勿進行安裝,應及時聯絡授權經銷商進行更換。
- 2.根據實際狀況,確認淨水器需要安裝的位置,應確保淨水器及接管口周圍有足夠空間便於維護,連接管不可折彎或強拉硬拉。
- 3.準備安裝所需的工具。
- 4.安裝完成前請勿通水、通電。

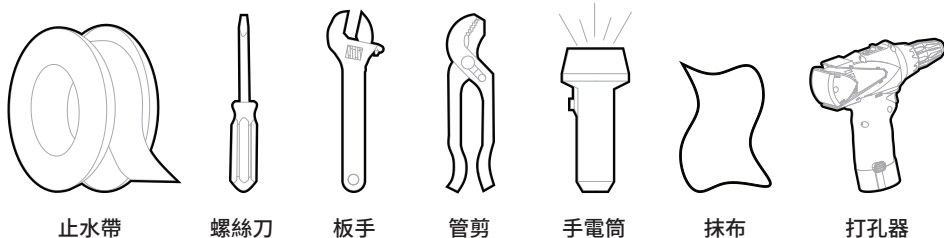

## 二、進水球閥及進水管的安裝

- 1.將自來水冷水閥上的金屬軟管擰下,取出淨水器配件中的三通進水球閥,將三通進水球閥內螺紋的一端擰緊在冷水閥上,將剛才擰下的金屬軟管擰緊在三通進水球閥外螺紋的一端。
- 2.取出淨水器包裝箱內的三分(3/8")PE管(灰色),剪取合適的長度,一端插入進水球閥上側面的快插接口,另一端與淨水器後面標識有「進水」的接口連接,注意PE管安裝到位,防止漏水。

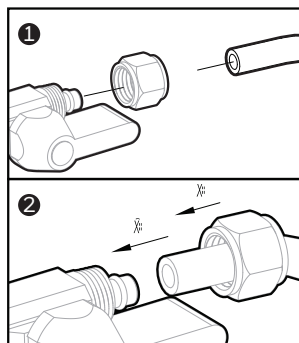
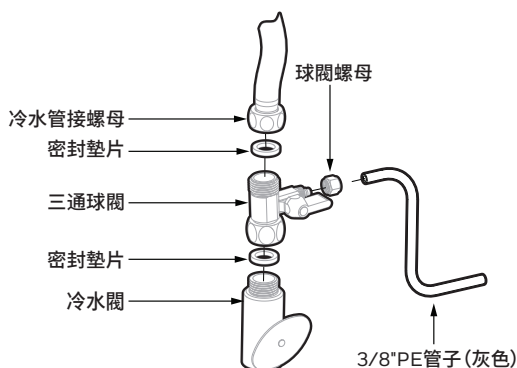

## 安裝(續)

### 三、智能龍頭的安裝

1. 確認檯面上的安裝孔尺寸在27~30mm之間並可以使用。
2. 依照智能龍頭安裝示意圖安裝智能龍頭,用螺帽鎖緊螺紋管固定好智能龍頭。
3. 2分直通連接到水龍頭的飲用水進水端。
4. 用管剪剪取適當長度的一段2分PE管(藍色),一端插入到直通,另一端插入到淨水器後面標識有「飲用水」端口,確保連接正確。

注意:清洗智能龍頭表面時,請用海綿等柔軟的東西擦拭,切勿使用鋼絲球等尖硬物體,以免對智能龍頭表面造成刮傷。

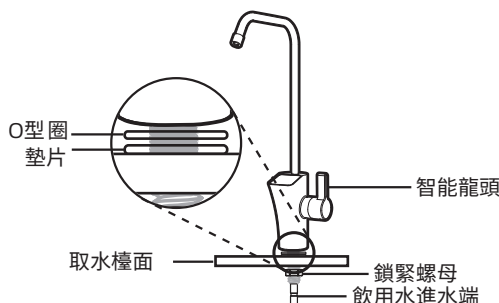

### 四、廢水管的安裝

在水池的排水管上用 $\Phi 6\text{mm}$ 的鑽頭鑽一個小孔,用管剪剪取合適長度的2分PE管(紅色),一端插入到孔內,用紮帶將廢水管與水池排水管紮在一起,在廢水管與水池排水管接觸部位打上玻璃膠以防止漏水,廢水管另一端插入到機器後方標示有「廢水」的接口。

### 五、淨水器的固定

此淨水器非壁掛式機器,在濾心安裝完成後,直接放置於櫥櫃內即可。

### 六、變壓器的安裝

變壓器根據實際情況,進行安裝,本電器僅可由電器隨附之電源供應單元供電。

### 七、淨水器的調試

1. 確認各水管接頭處都安裝到位,確保水源及電源正常。
2. 打開自來水進水閥及淨水器進水閥,插上電源,待濾瓶充滿水後,打開智能龍頭開始有水流出,檢查接頭,濾心等地方是否有漏水現象。
3. 關閉智能龍頭,等待1分鐘後,觀察淨水器是否停止工作,是否有漏水現象。



## 安裝(續)

### 八、整機安裝示意

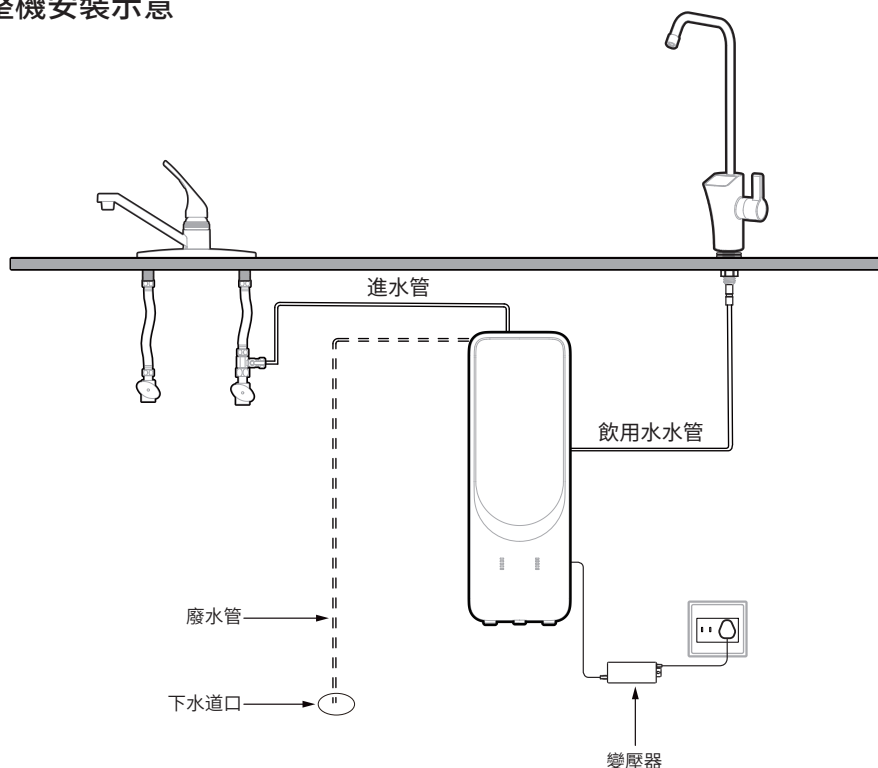

## 使用淨水器

### 一、首次沖洗

整機連接完成後打開進水龍頭,確認管路連接處無漏水後,需按照下面的步驟執行首次沖洗。

1. 整機接通電源後開始進行濾心沖洗5分鐘倒數計時,智能龍頭數位螢幕顯示5分鐘倒數計時,沖洗指示燈閃爍,運行完成後蜂鳴一聲。
2. 打開飲用水龍頭, RO濾心自動進行製水沖洗10分鐘,智能龍頭數位顯示倒數10分鐘,智能龍頭製水燈閃,結束後蜂鳴一聲,需關閉智能龍頭(未關閉龍頭每4秒蜂鳴一次提示)。
3. 關閉智能龍頭後,機器自動進行鮮活水循環,智能龍頭數碼顯示倒數6分鐘,智能龍頭沖洗指示燈閃爍,結束後蜂鳴一聲,進入主界面待機狀態。

註:由於逆滲透膜內含有保濕液(主要是食品級甘油),為保證出水水質的衛生安全,安裝或更換濾心後第一天盡可能使用機器,產水不建議飲用,可用於廚房清洗用水。若無法依上述操作,建議先製水25分鐘,停機3小時,製水25分鐘為1個循環,重複以上循環8次即可。

二、主機顯示與操作

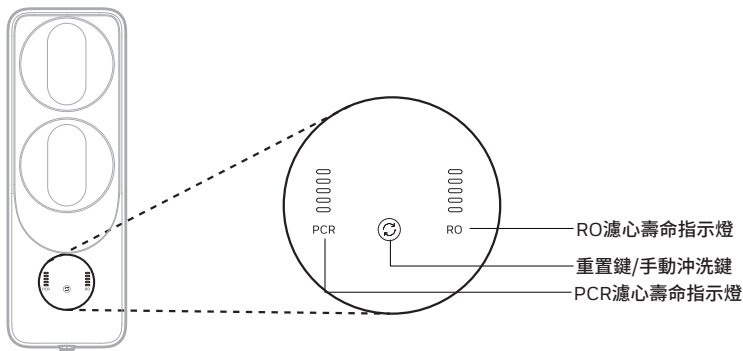

運行方式:

每次機器上電，蜂鳴器鳴響1聲，機器進入自檢，所有指示燈亮1秒減0.5秒後進入正常顯示狀態。

沖洗:

- 1.每次通電，系統會自動進行自動沖洗；累計製水5分鐘，水滿（後）以及待機24小時後，系統都會進行自動沖洗。
  - 2.短按手動沖洗鍵，機器自動沖洗30秒，再次短按關閉沖洗。
- 註:鮮活水模式下無累計製水5分鐘水滿自動沖洗和待機24小時後自動沖洗功能。

製水:偵測到高壓開關接通,開始製水。

待機:偵測到高壓開關斷開,進入待機狀態。

濾心壽命、濾心重置:請參考下表格

按鍵名稱	操作	顯示	效果	
手動沖洗	短按		短按手動沖洗鍵，機器自動沖洗30秒，再次短按關閉沖洗	
重置鍵	長按3秒		1. 長按3秒進入濾心重置選擇 2. 再次短按循環選擇需要重置的濾心 3. 再次長按3秒，濾心重置成功	
	短按	被選中的濾心閃爍		
	長3秒	濾心壽命指示燈滿格顯示		
		濾心壽命指示燈	濾心壽命 $\geq 80\%$	滿格顯示
			$60\% \leq$ 濾心壽命 $< 80\%$	四格顯示
			$40\% \leq$ 濾心壽命 $< 60\%$	三格顯示
			$20\% \leq$ 濾心壽命 $< 40\%$	二格顯示
			$0 <$ 濾心壽命 $< 20\%$	一格顯示
			濾心壽命到期	不顯示

三、智能龍頭指示燈



圖標	功能說明
TDS顯示	製水時每隔3秒切換自來水TDS值和飲用水TDS值
自來水TDS顯示指示燈	顯示自來水TDS值時亮起
飲用水TDS顯示指示燈	顯示飲用水TDS值時亮起
沖洗燈指示燈	沖洗時閃爍
製水指示燈	製水時閃爍
濾心壽命指示燈	白色常亮: 濾心壽命正常 紅色閃爍: 濾心壽命即將到期 紅色常亮: 濾心壽命到期
故障代碼E5、E7、E3等	請查閱《產品性能故障表及排除方法》

四、使用說明

製水：

打開智能龍頭，製水指示燈白色閃爍。顯示幕顯示自來水和飲用水TDS值，每3秒切換顯示1次。

鮮活水：

1. 自動啟動：

- 1) 系統默認智能龍頭關閉後，設備將自動啟動鮮活水循環功能。
- 2) 待機12小時後，設備將自動啟動鮮活水循環功能。

2. 關閉和切換：

- 1) 上電1分鐘後，長按「重置鍵」10秒，蜂鳴1聲，可關閉鮮活水功能。
- 2) 再次長按「重置鍵」10秒，蜂鳴2聲，重新開啟鮮活水功能。
- 3) 再次長按「重置鍵」10秒，蜂鳴3聲，可將鮮活水功能切換為：智能龍頭關閉5分鐘後，設備將自動開啟鮮活水循環功能。

# 濾心更換

## 一、濾心的更換時間

產品各濾心在使用一段時間後，會在濾心中累積各種雜質，影響出水速度及水質，為確保正常出水及獲得較好的口感，應定期對產品濾心進行更換。

(1)本機所建議各類濾心的更換週期，是參考了各地自來水的平均指標而得。使用者實際使用處的水質及機器的使用率如與平均指標存在較大出入時，濾心的實際使用時間估算週期會有較明顯的差距，如濾心過早堵塞、過早失效等，此時應以實際使用狀態作為濾心更換的依據，並及時與授權經銷商聯繫。

(2)本機濾心使用週期的估算是以一般家庭用水量和用水週期為基準的，並且只適合家用，請勿將本機安裝在用水量大的公用場合。

(3)根據經驗設計，以自來水為原水，根據家庭平均用水量和進水的水質條件，濾心使用週期大約如下(以下數據僅供參考)：

濾心	建議更換週期
長效複合式逆滲透濾心(PCR)	12~18個月
逆滲透膜濾心(RO)	24~36個月

### 注意

濾心的壽命受自來水水質等諸多因素影響，用戶一旦發現有下述情況之一，應考慮更換濾心：

- a.出水水質較差，口感下降
- b.出水流量明顯減少，檢查濾心或逆滲透膜是否阻塞
- c.濾心嚴重阻塞導致機器無法製水或無純水流出

濾心的建議使用週期不是濾心的品質保證期限，以一般家庭正常用水為基準的理想濾心使用週期。

## 二、濾心更換方法

濾心更換拆封前應仔細檢查濾心表面與安裝接口有無開裂及異常情況，安裝使用過後的濾心如出現開裂等人為因素造成的損失本公司不提供免費更換服務。

1.關閉進水三通閥，打開龍頭飲用水端，直至無水流出，向外摘下面罩。

2.將所要更換的濾心向左旋轉45度到箭頭標示位置。

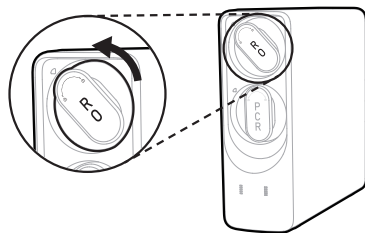
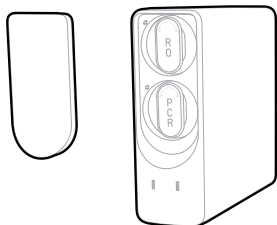

## 濾心更換(續)

3.將濾心取出

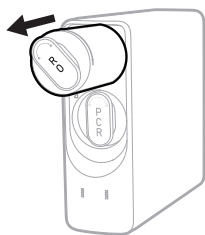

5.順時針旋轉濾心直到濾心底墊顯示內容正直。

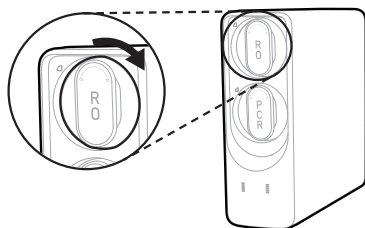

4.將新濾心插入到對應濾心安裝孔中,將濾心推到安裝孔底部。

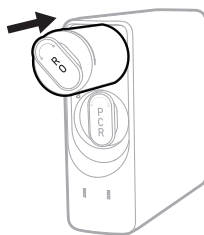

注意：

- 1.濾心更換完成後,重新通水,依照濾心重置操作指引對濾心進行重置。
- 2.重置完成後,依照首次使用的沖洗方式進行對應濾心的沖洗。

## 注意事項

### 一、安全注意事項

- 1.當您長期外出或不使用本淨水器時,請關閉進水水源「進水三通」(開關垂直為關閉)。
- 2.當有以下任何情況出現時,請立即斷開淨水器進水水源「進水三通」關閉,並及時與「瀚頓國際淨水客服部」聯繫。
  - (1)淨水器的管路或相關部件漏水。
  - (2)淨水器的相關部件失去作用。
  - (3)有其他任何異常現象或故障。
  - (4)發現漏水情形,請先將進水水源「進水三通」如下圖,開關關閉(開關垂直為關閉)。

(1)進水三通\_開啟

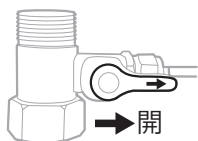

(2)進水三通\_關閉

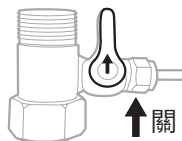

## 注意事項(續)

### 二、漏水斷路器

- 1.檢測到漏水時，蓋子會彈起，通知已檢測到漏水。
- 2.水龍頭關機或拔掉插頭，或關閉進水三通。
- 3.請依照漏水情況選擇處理方式。

正常  
使用  
情況

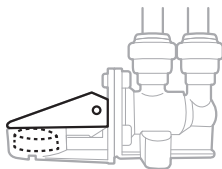

漏水  
使用  
情況

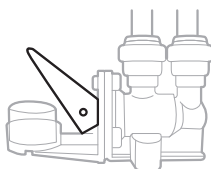

※蓋子彈起時,代表發生漏水情形,須來電至「瀚頓國際淨水客服部」派人員進行檢查漏水情形,以免廚房發生漏水危機。

☆ 蓋子彈起 ☆

☆ 蓋子彈起,廚下四周圍無漏水 ☆

- 1.將膨脹的吸水棉取出,四周圍水擦乾淨,放入全新的吸水綿(透明包裝拿掉)。
- 2.蓋子蓋上,並持續觀察三天是否有滲水情形再次發生,確保無漏水。
- 3.將水閥門開啟,並開啟水龍頭。

☆ 蓋子彈起,廚下發現四周圍漏水 ☆

請勿更換吸水棉,並請撥打以下客服電話報修或者使用瀚頓國際官方Line通知漏水情形,並拍照上傳與報修。

# 產品性能故障表及排除方法

故障症狀/現象	故障原因	解決方法
通電無顯示	電源沒有接通	檢查電源或電源插頭
按鍵無效	顯示板錯誤	切斷電源重啟
機器純水流量小或不出水	停水或進水三通球閥未打開	檢查水源並打開進水三通球閥
	濾心阻塞	更換濾心
	PE管打折	理順PE管
	水壓過低或停水	檢查進水水壓
機器停機但廢水不停	進水電磁閥失效	聯繫瀚頓國際客服部更換進水電磁閥
出水有異味	濾心失效	更換濾心
	機器長時間未使用	開機沖洗濾心40分鐘
E7	水溫低於3攝氏度低溫保護提醒	關閉進水,排空機器內部餘水,防止機器結冰損壞
E3	水泵頻繁啟停	檢查機器水路連接, 檢察龍頭是否有滴漏現象
		龍頭沒有完全打開
E5	連續製水超過30分鐘, 製水超時保護	關閉龍頭,機器重新上電
其它	請撥打客服電話聯繫瀚頓國際客服部進行檢修,勿自行拆卸維修	

# 保固說明

瀚頓國際保證本產品由消費者自購買日起，於正常使用與維修下享有壹年保固期，在機體或材質上均無缺失。若期間本產品確有缺陷或發生故障，瀚頓國際將會予以修復或更換（瀚頓國際保有選擇權）。

如該產品是有缺陷的，

- (1) 將它併同買賣契約（發票）或其他註有日期之購買證明，送回至你原購買處所。
- (2) 請撥打瀚頓國際客服專線 0800-201-666。

本保固不包括移除或重新安裝費用。若瀚頓國際證明，肇致該缺陷或故障之損害，係於消費者持有本產品期間所發生的，則本保固不適用。

瀚頓國際唯一的責任是在上述項目範圍內，修復或更換產品。

直接或間接地違反任一保固條款，導致包含任何伴隨或必然之產品損害，對於該項陳述或暗示或其他型態的產品失敗或損傷，瀚頓國際將不負有法律責任。

本保固係瀚頓國際在本產品上唯一的保固陳述。任何意味保固的有效期，包含針對一特定目的適銷與適當的保固，於此聲明限制在本保固的壹年期間。

## 保 固 書

使 用 者	
機 型	URHD1-210-S5-T
淨 水 器	PCR、RO

保固書登錄



請於官網登錄您的  
使用者資料，保障  
售後服務權益。

總代理章

經銷商章



# PACKING LIST

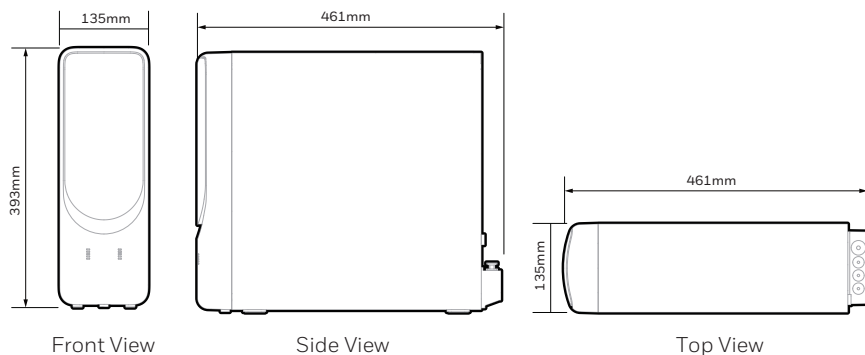

Product appearance is only a diagram. Please refer to the actual product.

Name	Quantity
Water purifier	1 set
User manual	1 pc
Tee ball valve	1 pc
Teflon seal tape	1 pc
Pipe pulling tool	1 pc
1/4" quick connector	1 pc
1/4" O-ring	3 pc
3/8" O-ring	3 pc
1/4" claw	3 pc
1/4" PE pipe	2 pc
3/8" PE pipe	1 pc
Water faucet	1 pc
Power adapter	1 pc
1/4" clip	10 pc
3/8" clip	4 pc
3/8" claw	3 pc
PCR composite filter	1 pc
Reverse osmosis membrane filter	1 pc
Filter joint O-ring	2 pc
Gloves	1 pair
Wrench	1 pc

# PRODUCT INTRODUCTION

## PRODUCT MODEL AND SPECIFICATIONS

Product name	Honeywell URHD1-210-S5-T Water Purifier
Product model	URHD1-210-S5-T
Flow rate	2.6L/min
Filtration capacity	5000L
Rated power	120W
Rated voltage of the water purifier	24V $\overline{\text{---}}$
Rated voltage of adapter	100~240V 50Hz/60Hz 2.5A
Feed water requirement	Municipal tap water
Feed water pressure	15-60psi
Working pressure	60-120psi
Feed water temperature	(5~38)°C
Country of origin	China

★The water flow rate and filtration capacity will vary due to different water quality and usage environment in different places.

★The suitable water inlet pressure of the machine is 15-60psi. If the pressure is too high, please install a pressure reducing valve.

# PRODUCT INTRODUCTION(CONTINUED)

## I. Schematic Diagram

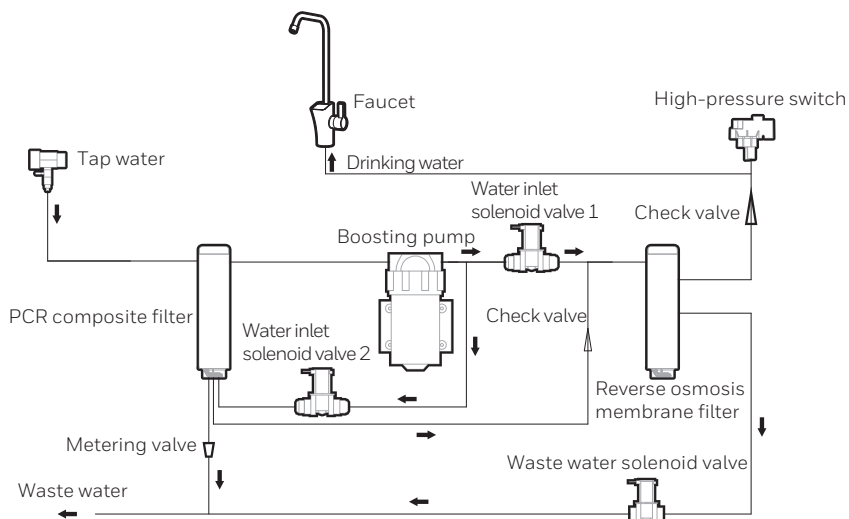

## II. Electrical Diagram

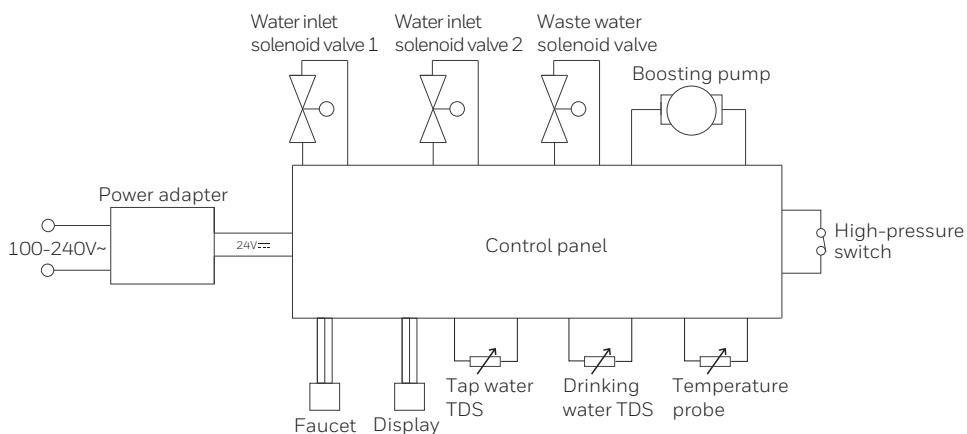

# INSTALLATION

## I. Prepare for installation

1. Check the product and accessories before installation. If there is any missing accessories or damage, please contact the after-sales service hotline for replacement.
2. Confirm the location where the water purifier will be installed and make sure there is enough space around the water purifier and its connector for maintenance. Do not bend or forcefully pull the connecting pipe.
3. Prepare the tools required for installation.
4. Do not turn on the water supply or power on the product before the installation is complete.

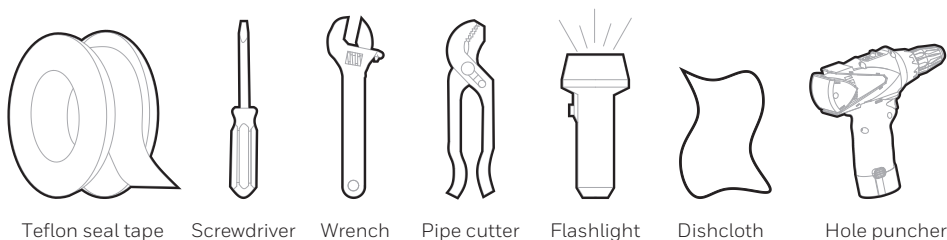

## II. Installation of three-way ball valve and inlet pipe

1. Remove the metal hose on the cold water valve and take out the three-way ball valve from the accessories. Tighten one end of the three-way ball valve(inner thread) onto the cold water valve and tighten the other end(outer thread) onto the metal hose.
2. Take out the 3/8" PE pipe (gray) and cut it to a suitable length. Insert one end into the quick connector of the three-way ball valve and the other end to the connector marked "进水" on the back of the water purifier. Make sure the PE pipe is installed in place to prevent water leakage.

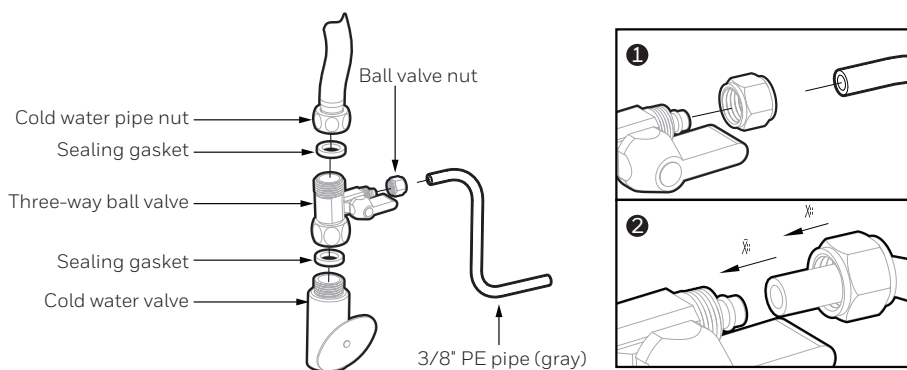

## INSTALLATION(CONTINUED)

### III. Install the faucet

1. Confirm that the size of the soap dispenser installation hole on the basin is between 27 and 30 mm and can be used.
2. Install the faucet according to the faucet installation diagram and fix the faucet with a nut to lock the threaded pipe.
3. Connect the 1/4" connector to the drinking water inlet of the faucet.
4. Cut the 1/4" PE pipe (blue) of appropriate length with pipe cutter. Insert one end into the drinking water inlet and the other end into the connector marked with "饮水" on the back of the water purifier.

**Note:** When cleaning the faucet surface, please wipe it with sponge or other soft objects. Do not use sharp objects such as steel wool to avoid scratching the faucet surface.

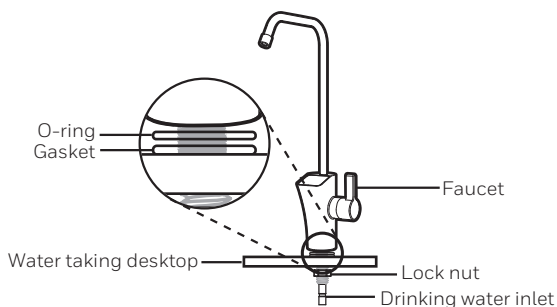

### IV. Install the waste water pipe

Drill a small hole on the drain pipe with a diameter of 6mm and cut a 1/4" PE pipe (red) of appropriate length with pipe cutter. Insert one end into the hole on the drain pipe and tie the PE pipe and drain pipe together with cable tie and apply glass glue on the contact part to prevent water leakage. Insert the other end into the connector marked with "废水" on the back of the water purifier.

### V. Fix the water purifier

This water purifier is not wall-mounted. Please place it in the cupboard after installation.

### VI. Install the power adapter

The power adapter should be installed according to the actual situation. This appliance must be powered by the included adapter only.

## INSTALLATION(CONTINUED)

### VII. Commissioning of the water purifier

1. Make sure all water pipe joints are installed in place and ensure that the water source and power supply are normal.
2. Turn on the tap water inlet valve and the water purifier inlet valve, plug in the power supply, wait for the filter bottle to be filled with water, turn on the faucet and water will start to flow out, check the joints, filter and other places for water leakage.
3. Turn off the faucet, wait for 1 minute, and then observe whether the water purifier stops working and whether there is any water leakage.

### VIII. Installation Schematic Diagram

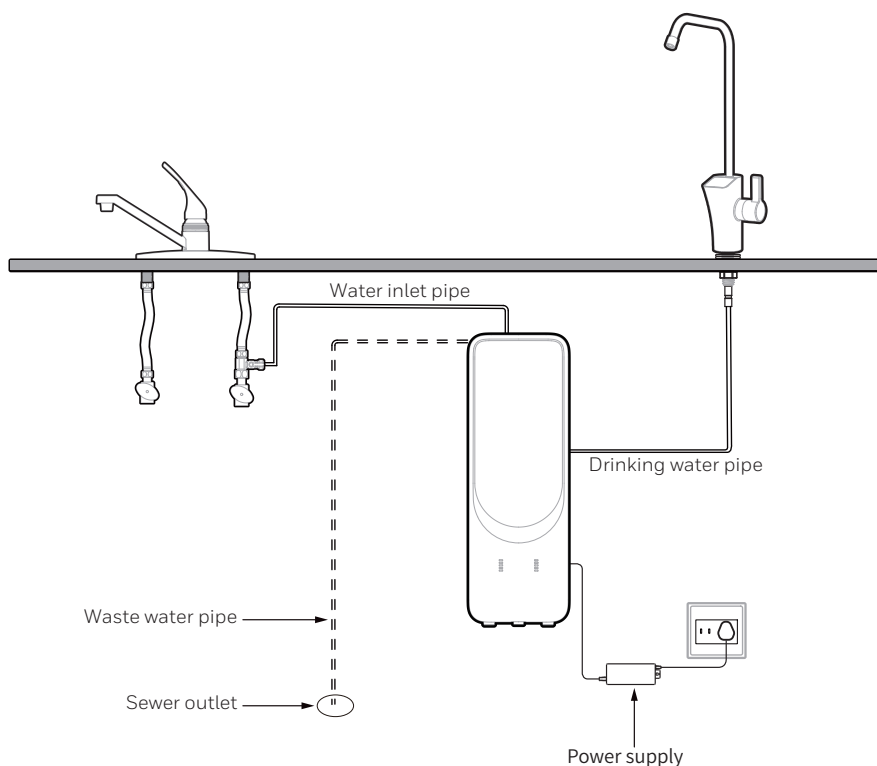

# USE INSTRUCTIONS

## I. Flushing for the first time

After installation, please turn on the faucet and make sure there isn't any leakage on the pipeline connectors. Please start the first flush as the following steps.

1.After power on, the product will start the flush for 5 minutes. The digital display on the faucet shows a 5-minute countdown and the producing water indicator flashes. The buzzer will sound an alarm when the flushing is finished.

2.Turn on the faucet, the RO filter will automatically flush for 10 minutes. The digital display on the faucet shows a 10-minute countdown and the producing water indicator flashes. The buzzer will sound an alarm when the flushing is finished.

After that, please turn off the faucet.(Note: If the faucet has not been turned off, the buzzer will sound an alarm every 4 seconds.)

3.After the faucet is turned off, the product will start the fresh water circulation. The digital display on the faucet shows a 6-minute countdown and the producing water indicator flashes. The buzzer will sound an alarm when the flushing is finished. After that, the product enter the standby mode.

**Note:** Since the reverse osmosis membrane contains moisturizing liquid (mainly food-grade glycerin), in order to ensure the hygienic and safe quality of the output water, the machine should be used as much as possible on the first day after installing or replacing the filter. The produced water is not recommended for drinking, but can be used for cleaning. If the above operation cannot be performed, it is recommended to produce water for 25 minutes, then shut down for 3 hours, and continue producing water for 25 minutes as one cycle, and repeat the above cycle for 8 times.

## II. Display and operation of the product

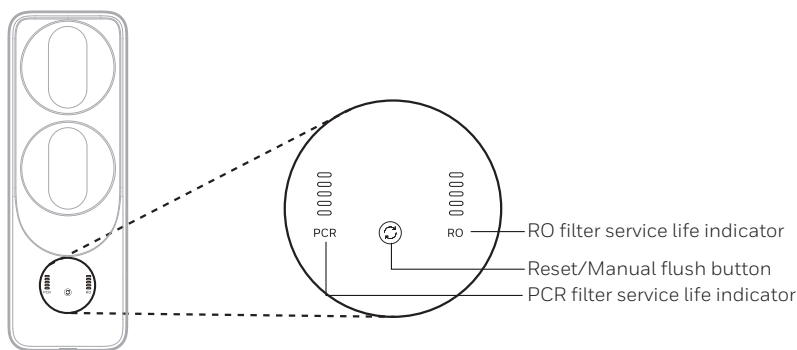

### Operation method

Each time the product is powered on, the buzzer sounds once, the product enters self-check, all indicators turn ON for 1 second and then turn OFF for 0.5 seconds before entering the normal display state.

# USE INSTRUCTIONS(CONTINUED)

## Flushing

The water purifier will start automatic flushing on the following conditions:

- 1) Each time the power is turned on.
- 2) After the cumulative water production reaching 5 minutes and the faucet is turned off.
- 3) After the water purifier is in standby mode for 24 hours.
- 4) Press the 'Manual flush' button, the water purifier will automatically flush for 30s and press again to stop the flush.

**Note:** Under fresh water mode, the step 2) and 3) will not perform.

## Producing water

The product will start producing water when the high-pressure switch is turned on.

## Standby

When it is detected that the high voltage switch is disconnected, the system will enter standby state.

Filter service life and reset: Please refer to the form below.

Button Name	Operation	Display	Effect	
Manual flush	Press		The water purifier automatically flushes for 30s. Press again to stop the flushing	
Reset	Press and hold it for 3s		1. Press and hold the reset button for 3s to enter the filter reset mode 2. Press the reset button again to select the filter to be reset 3. Press and hold it for 3s again to finish the filter reset	
	Press again	The selected filter flashes		
	Press and hold it for 3s again	The filter service life indicator displays with all grids		
		Filter life indicator	Filter service life $\geq 80\%$	Display with all grids
			$60\% \leq \text{Filter service life} < 80\%$	Display with four grids
			$40\% \leq \text{Filter service life} < 60\%$	Display with three grids
			$20\% \leq \text{Filter service life} < 40\%$	Display with two grids
			$0 < \text{Filter service life} < 20\%$	Display with one grid
			The filter service life expired.	Do not display

## III. Faucet indicator

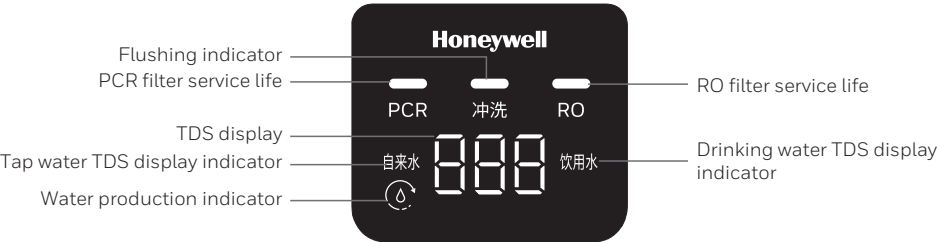



## USE INSTRUCTIONS(CONTINUED)

Icon	Function Description
TDS display	Switching the tap water TDS valve and drinking water TDS valve every 3 seconds during water production
Tap water TDS display indicator	The TDS indicator of the tap water is on
Drinking water TDS display indicator	The TDS indicator of the drinking water is on
Flushing indicator	Flashes when flushing
Water production indicator	Flashes when producing water
Filter service life indicator	Stay in white: Filter service life is normal Flashes white: Filter service life is about to expire Flashes red: Reach filter service life
Fault code E5, E7, E3, etc.	Please refer to the "TROUBLE SHOOTING"

### IV. Use instructions

#### Producing water

Turn on the faucet, the water production indicator flashes white. The display shows the TDS value of the tap water and drinking water every 3 seconds in turn.

#### Fresh water

##### 1. Automatic Start

- 1) The water purifier will automatically start the fresh water function each time the faucet is turned off.
- 2) After the water purifier has been in standby mode for 12 hours, it will automatically start the fresh water function.

##### 2. Turn Off and Switch

- 1) One minute after power-on, press and hold the "Reset" Button for 10 seconds until a single beep is heard. The fresh water function will then be turned off.
- 2) Press and hold the "Reset" button for 10 seconds again until two beeps are heard. The fresh water function will then be reactivated.
- 3) Press and hold the "Reset" button for 10 seconds once more until three beeps are heard, and the fresh water function will be switched to: the water purifier automatically performs the fresh water function 5 minutes after the faucet is closed.

## REPLACEMENT OF THE FILTER

### I. Filter service life

After using the filter for a period of time, various impurities will accumulate in the filter, affecting the water flow and water quality of the product. In order to ensure the normal water flow and obtain a better taste, the filter should be replaced regularly.

# REPLACEMENT OF THE FILTER(CONTINUED)

- 1. The recommended service life is based on average index of municiple tap water in different places. If the water quality and frequency of use are significantly different from the average index, the service life of the filter may differ from the recommended cycle. In cases of early clogging or early failure of the filter, it should be replaced according to the actual usage status and contact local after-sales service promptly.
- 2. The recommended service life is based on the water consumption and water cycle of ordinary households, and is only suitable for household use. Do not install this product in public places with high water consumption.
- 3. With municiple tap water as feed water and based on the average household water consumption and water quality, the recommended service life is as follows (for reference only):

Icon	Function Description
Polypropylene melt-blown activated carbon reverse osmosis membrane composite filter (PCR)	12-18 months
Reverse osmosis membrane filter(RO)	24-36 months

**Note:**

The life of the filter is affected by many factors such as the quality of tap water. Once the user finds any of the following conditions, the filter should be replaced:

- a. The output water quality is poor and the taste is reduced.
- b. The output water flow rate is significantly reduced. Check whether the filter or reverse osmosis membrane is blocked.
- c. The filter is seriously clogged, causing the machine to be unable to produce water or no pure water to flow out.

The recommended service life of the filter is not the quality assurance period of the filter. The service life is based the normal water consupmtion of ordinary households.

## II. Method to replace the filter

Before replacing the filter, carefully check the filter surface and installation interface for cracks and abnormalities. If the filter is damaged by cracks or other factors resulting from user error after installation and use, our company will not provide a free replacement service.

- 1. Turn off the three-way ball valve, turn on the faucet until no water flows out and remove the front cover.

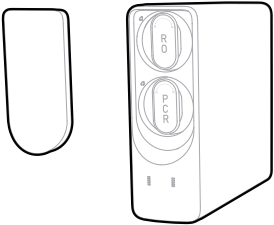

## REPLACEMENT OF THE FILTER(CONTINUED)

2. Rotate the filter to be replaced 45° to the left to the position indicated by the arrow.

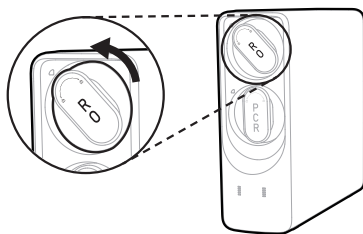

3. Take out the filter.

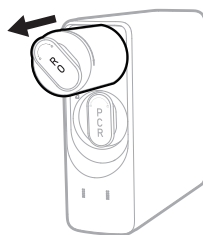

4. Insert the new filter into the corresponding filter mounting hole and push the filter to the bottom of the mounting hole.

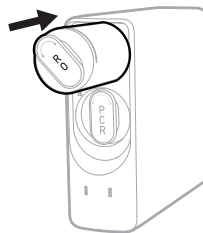

5. Rotate the filter clockwise until the filter bottom pad shows the contents are upright.

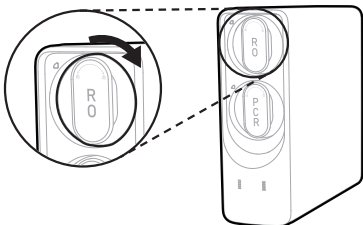

## REPLACEMENT OF THE FILTER(CONTINUED)

### Note:

1. After replacing the filter, turn on the water supply and reset the filter according to the filter reset instructions.
2. After the reset is complete, flush the corresponding filter according to the instructions in "Flushing for the first time".

## NOTICE

### I. Safety Notcie

1. When you are away for an extended period or not using this water purifier, please turn off the water supply at the 'three-way ball valve' (the valve is closed when it is in a vertical position).
2. If any of the following situations occur, please immediately disconnect the water purifier's water supply and contact the customer service.
  - (1) Water leakakge in the pipes or related components.
  - (2) The related components are inoperative.
  - (3) Other abnormal phenomena or malfunctions
- (4) In the event of a leak, first shut off the water supply at the 'three-valve ball valve' as indicated in the diagram below. Turn the switch to the off position (the switch is closed when it is vertical).

(1) Three-way ball valve-Turn on

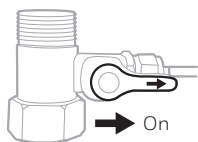

(2) Three-way ball valve-Turn off

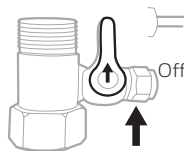

### II. Water Leakage Circuit Breaker

1. Upon detecting a water leak, the cover will spring up to signal that a leak has been detected.
2. Turn off the faucet, unplug the device, or close the three way ball valve.
3. Please select the appropriate action based on the specifics of the water leak situation.

## NOTICE(CONTINUED)

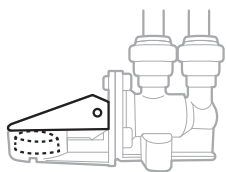

Normal using condition

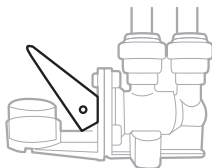

Water leakage condition

\*Cover spring up

\*When the cover springs up, it indicates that a water leak has occurred. You should contact the customer service to dispatch personnel to inspect the water leak situation and prevent a potential crisis in the kitchen due to water leakage.

\*If the cover springs up and there is no water leakage around the kitchen area, follow these steps:

1. Remove the expanded water-absorbing cotton and clean up any surrounding water. Then, replace it with a new water-absorbing cotton(remove the transparent packaging).
2. Close the cover and continue to observe for three days to see if there is any recurrence of water seepage, ensuring no leakage.
3. Turn on the water valve and open the faucet.

\*If the cover springs up and water leakage is found around the kitchen area: Please do not replace the water-absorbing cotton. Instead, contact our customer service by phone to report the issue for repair. Alternatively, you can use the official Line to inform us of the water leakage and submit photos for the repair documentation.

# TROUBLESHOOTING

Fault /Phenomenon	Cause	Solution
No display after power on	The power is not on	Check the power supply or power plug
No response of the buttons	Display board error	Cut off the power supply and restart the product
The pure water flow of the product is small or no pure water is output	Water outage or water inlet three-way ball valve is not turned on	Check the water source and turn on the water inlet three-way ball valve
	Filter is clogged	Replace the filter
	PE pipe is bent	Straighten the PE pipe
	Low water pressure or water outage	Check the inlet water pressure
The product stops working but the waste water is still draining	Water inlet solenoid valve failure	Contact the after-sales service to replace the water inlet solenoid valve
The output water has an unusual smell	Filter failure	Replace the filter
	The product is not put in use for a long period	Turn on the faucet to flush the filter for 40 minutes
E7	Low temperature protection reminder when water temperature is below 3°C	Turn off the faucet and drain the remaining water inside the product to prevent it damage from icing
E3	Water pump starts and stops frequently	Check the water path connection of the machine and check whether the faucet is leaking
		The faucet is not fully turned on
E5	The product performs timeout protection because the product produces water for more than 30 minutes continuously	Turn off the faucet and restart the product
Others	Please contact our after-sales service hotline for inspection and maintenance.	

# PRODUCT WARRANTY INSTRUCTIONS

The warranty period begins on the date of sale. Hamton Watertec offers a one-year warranty from the date of purchase for products used under normal conditions and properly maintained, assuming there are no defects in the product or materials. Should the product prove to be defective or malfunction during this period, Hamton Watertec will either repair or replace it (at Hamton Watertec's discretion).

If the product is found to be defective,

(1) Please return the product, along with the sales contract (invoice) or other dated proof of purchase, to the original place of purchase.

(2) Please contact Hamton Watertec's customer service hotline at 0800-201-666.

This warranty does not cover the costs associated with the removal or reinstallation of the product. If Hamton Watertec determines that the damage leading to a defect or malfunction occurred while the product was in the consumer's possession, this warranty will not be applicable.

Hamton Watertec's sole liability under this warranty is to repair or replace the product within the limits of the aforementioned coverage.

Directly or indirectly violating any warranty term that results in incidental or consequential product damage, Hamton Watertec shall not be legally liable for for any form of product failure or damage.

This warranty represents Hamton Watertec's sole warranty statement for this product. Any implied warranty of merchantability or fitness for a particular purpose is hereby limited to the one-year duration of this warranty

Warranty Card

User	
Product model	URHD1-210-S5-T
Filter type	PCR、RO

Agency stamp

Distributor stamp

**代理商:瀚頓國際貿易有限公司**

地址:新北市汐止區中興路86號8樓之1

免費服務專線:0800-201-666

**製造商:霍明科技(廣東)有限公司**

服務專線:4006309798

地址:廣東省佛山市順德區容桂街道振華社區桂

洲大道中海駿達廣場1座35層3501單元

Huoming Technology (Guangdong) Co., Ltd.

Address: Room 3501, Haijunda Plaza,  
Guizhou Avenue, Shunde District, Foshan

City, Guangdong Province

The Honeywell Trademark is used  
under license from Honeywell  
International Inc.

This product is manufactured by  
Huoming Technology (Guangdong)  
Co., Ltd.

**Honeywell**