

Honeywell

Under Sink Water Filtration System 櫥下智控RO淨化飲水機

使用說明書

User Manual

使用前請仔細閱讀本說明書，並妥善保管

Please read this manual carefully before use, and keep it properly.

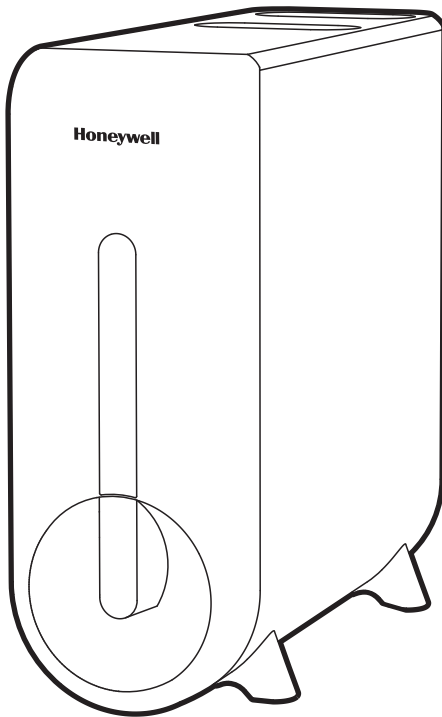

ProPura-RO800-I-TW

目錄

請先閱讀：用戶必讀和安裝注意事項

Before use, please read the Must-Read and Installation Precautions.

目錄	1
包裝內容	2
產品介紹	3
安裝	5
使用飲水機	10
濾心更換	14
安全注意事項	15
產品性能故障表及排除方法	17
保固說明	18
PACKING LIST	19
PRODUCT INTRODUCTION	20
INSTALLATION	22
USE INSTRUCTIONS	27
REPLACEMENT OF THE FILTER	33
NOTICE	35
PRODUCT WARRANTY INSTRUCTIONS	38
TROUBLESHOOTING	40

包裝內容

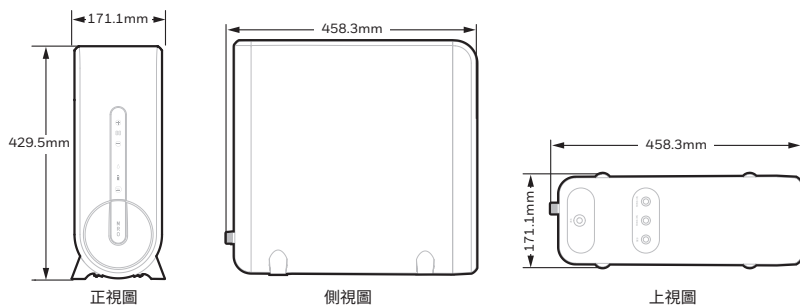

產品外觀示意，請以實物為準

名稱	數量
主機	1套
三通接頭	1套
快接鎖片配件包	1套
1/4"PEX管(紅色)	1個
3/8"PE管(灰色)	1個
龍頭及配件包	1套
說明書(含保固卡、合格證)	1套
手套	1雙
防滑墊	1個
使用者必讀/安裝注意事項	1個

產品介紹

產品型號與規格

名稱	Honeywell櫥下智控RO淨化飲水機(奢華黑曜系列)
型號	ProPura-RO800-I-TW
淨水流量	2.1L/min
純水額定 總淨水量	5000L
熱水流量	1.9L/min
進水壓力	(0.1~0.4)MPa
工作壓力	(0.42~0.8)MPa
適用水溫	5~38°C
進水水質	限用自來水水源
額定功率	765W
額定電源	110V~ 60Hz

· 淨水流量:依實際使用的環境、水壓、水質的實際情況會有所不同。

 須由專業的維護人員操作,依照實際使用與地區水質品質而有所差異,若濾心沒定期更換、清潔、保養,可能導致飲水機故障則不在保固範圍。

產品介紹(續)

一、原理圖

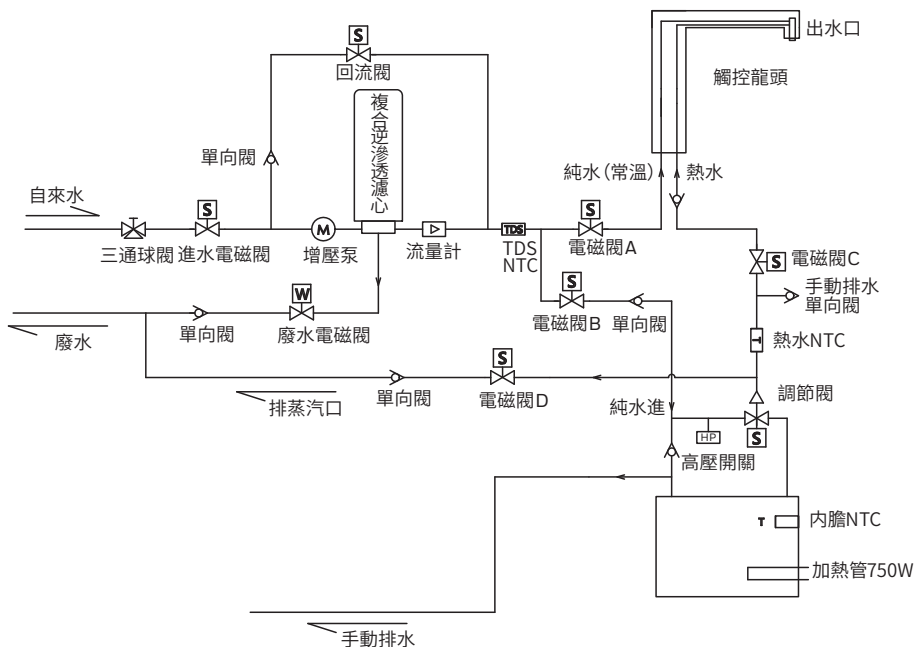

二、電器圖

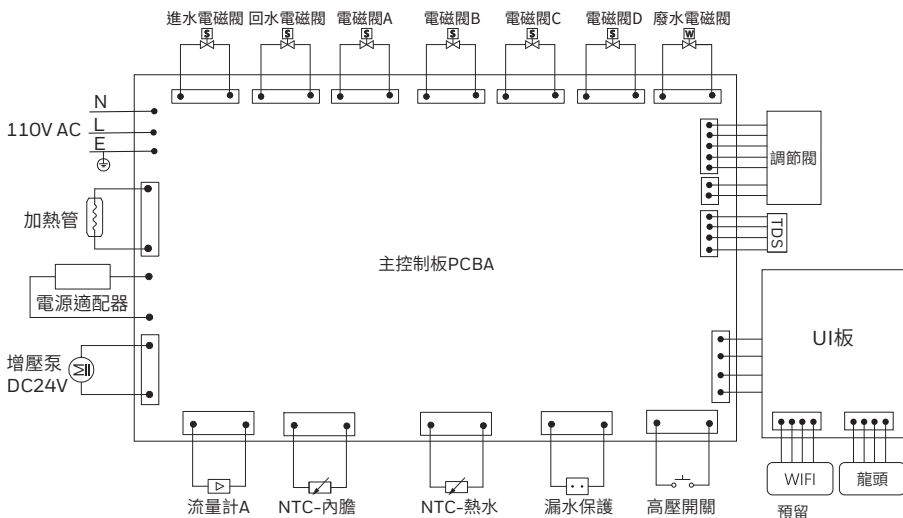

安裝

一、安裝前準備

1. 安裝前請檢查電源線,如出現損壞,為了避免危險,必須由瀚頓國際或專業人員更換。
2. 確認飲水機要安裝的位置。
3. 確認安裝位置有安裝標準的接地電源插座。
4. 核對說明書中的裝箱清單並確認實際配件是否齊全。
5. 準備安裝所需的工具。



止洩帶



螺絲起子

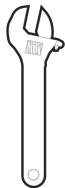

扳手



管鉗



手電筒



抹布

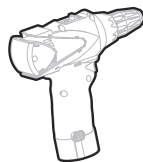

電鑽

二、角閥安裝

1. 關閉冷水閥,將冷水軟管從冷水閥上旋下。
2. 將三通球閥安裝在冷水閥上,並用活動扳手擰緊(安裝時請勿遺漏角閥上的密封墊)。
3. 將冷水軟管安裝在三通球閥上,並用活動扳手擰緊(安裝時請勿遺漏冷水軟管上的密封)。
4. 將3/8"PE管子穿過球閥螺帽並壓入角閥上的凸形接口,壓到底後用扳手旋緊球閥螺帽。

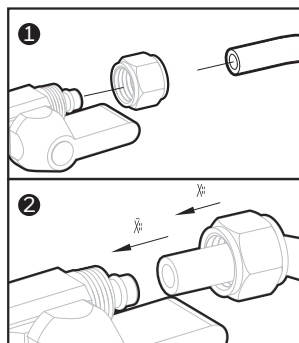
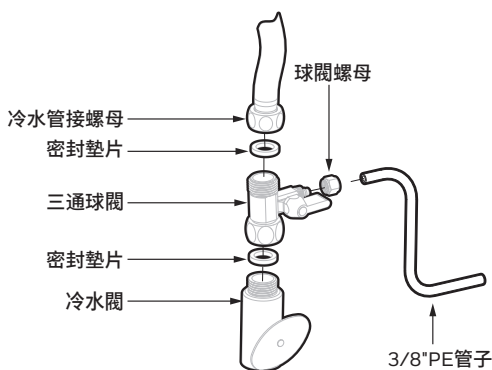

三、安裝觸控龍頭

1. 在水槽或檯面上選擇適當的安裝位置,安裝於平整的帶孔平面上,安裝孔尺寸為 28mm-30mm。
2. 將龍頭按圖示安裝好。
 - a. 將龍頭連接桿端放入水槽板安裝孔中。
 - b. 依圖示零件依序套入連接桿中,注意管線之間不可纏繞。
 - c. 將螺帽旋入連接桿,並旋緊。

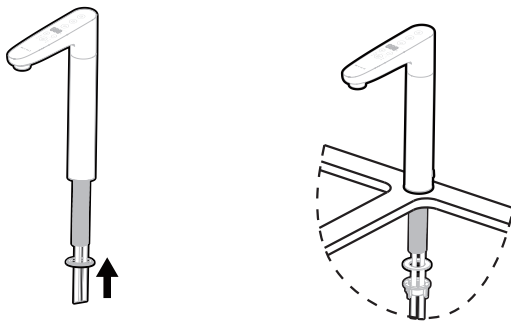

四、安裝飲水機

依照主機擺放位置選擇飲水機固定方向並在主機底部鋪設防滑墊。擺放的位置務必水平,若安裝檯面有傾斜可能造成機器出水延遲。若機器出現出水延遲較為明顯的情況,處理方法如下:

1. 打開龍頭出水;
2. 將機器尾部稍稍抬起一定高度;
3. 待龍頭出水穩定後將機器安裝回原位置。

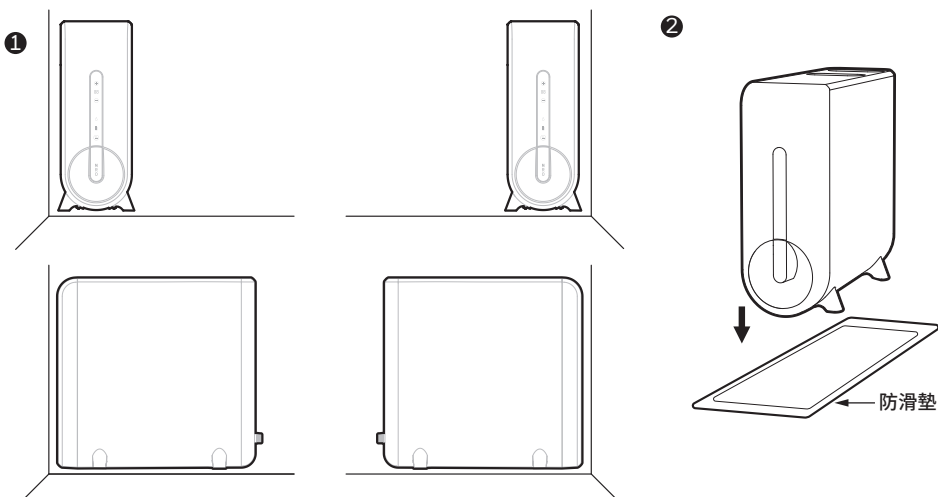

五、安裝管路

裁剪適量長度的PE管,切口需平齊,如下圖所示:



六、安裝進水管

- 1.將與角閥接頭連接的PE管用管剪切下一段適量長度;
- 2.將管另一端插入進水口,插到底後再在快接接頭卡槽位置插上快接鎖片。

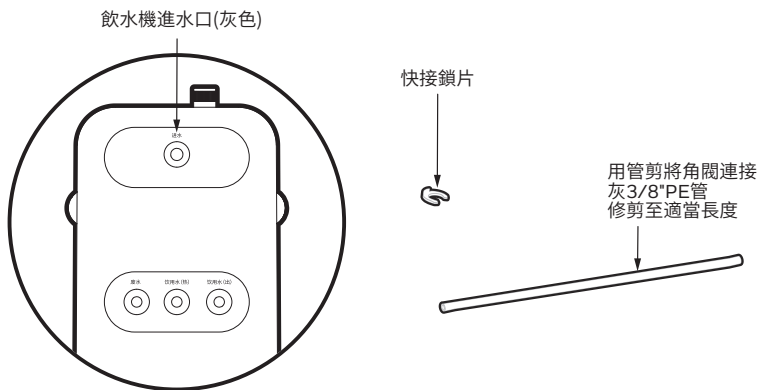

七、安裝飲用水出水管

- 1.使用管剪將配套的觸控龍頭的藍色1/4"PE管修剪到適當長度;
- 2.將管插入飲水機飲用水出口,插到底後在快接接頭卡槽位置插上快接鎖片。

安裝(續)

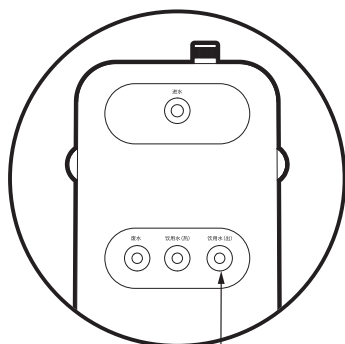

飲水機飲用水出水口 (藍色)

快接鎖片



用管剪將配套觸控龍頭上
連接藍色1/4"PE管
修剪至適當長度



八、安裝廢水管

1. 使用管剪將配套的紅色1/4"PEX管修剪到適當長度;
2. 將管一端插入飲水機廢水出水口,插到底後在快接接頭卡槽位置插上快接鎖片;
3. 將管另一端引至排污口並固定好。

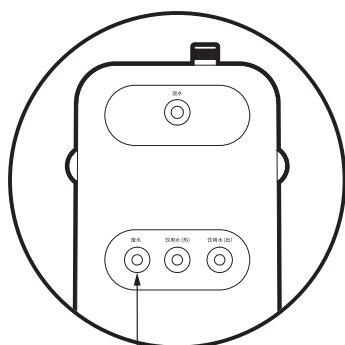

飲水機廢水口(紅色)

快接鎖片



用管剪切取適當長度的
1/4"紅色PEX管

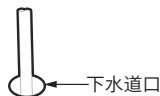

下水道口

九、飲水機熱水出水口安裝

1. 用管剪將配套的觸控龍頭白色1/4"PTFE管切取一段適量長度;
2. 將管插入飲水機熱水出水口,插到底後在快接接頭卡槽位置插上快接鎖片;

安裝(續)

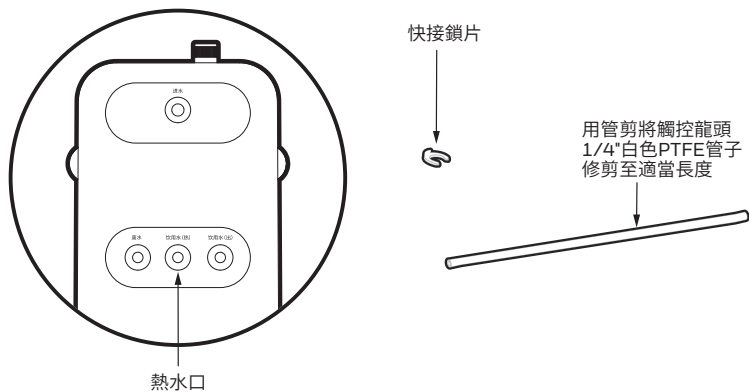

十、整機安裝示意

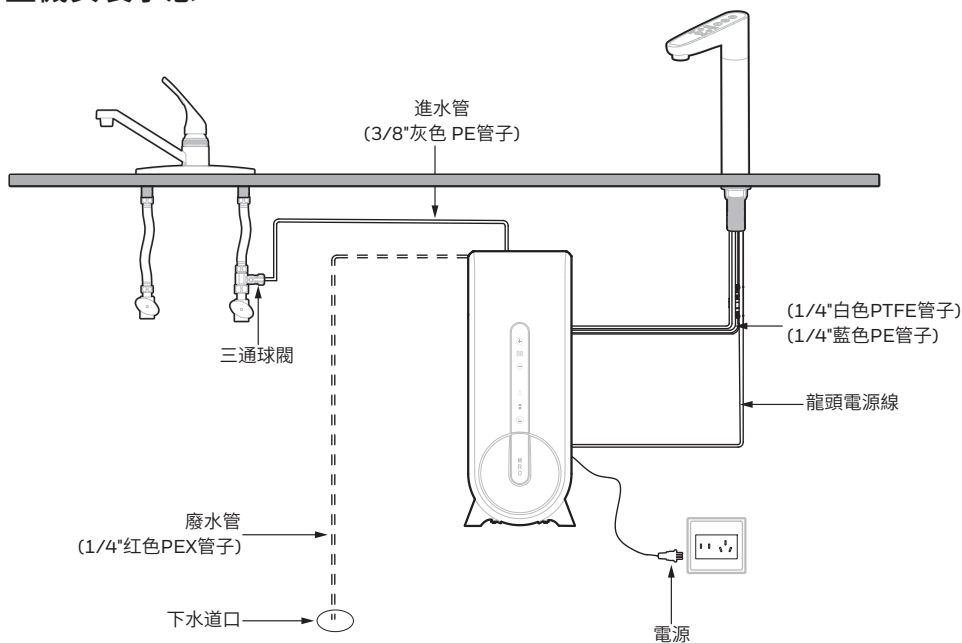

注意事項:

1. PE管切口必須平整無毛屑,避免毛屑影響密封;
2. 確保裁剪後管子無變形,保證ORING密封良好不漏水;
3. 連接完成後檢查各水管接頭連接處不漏水;
4. 廢水出水管必須與排污下水道相連並固定好,勿用儲水裝置接水,以免機器自動沖洗造成溢水;
5. 電源線拔插需在斷電狀態下,不可帶電操作。

使用飲水機

一、使用說明

首次使用

1. 首次開機

上電後蜂鳴器鳴叫0.1秒,各種類型顯示燈同時亮起,每種類型燈依狀態順序,三色燈每種狀態亮1秒,單色燈常亮3秒,雙色燈各1.5秒;3秒後進入首次沖洗狀態。

2. 首次沖洗

1). 膜前沖洗:首次開機後,機器進入強制膜前沖洗狀態,龍頭顯示35分鐘倒數,濾心壽命指示燈常亮,水質燈紅色閃爍,此時龍頭不可操作。

2). 膜後沖洗:使用者需按下龍頭上的常溫水按鍵,取常溫水15分鐘,15分鐘後,龍頭自動切換至取熱水15分鐘,水質燈顯示水質即時數據,1Hz閃爍。沖洗完成後進入待機狀態,濾心壽命指示燈常亮,加熱指示燈熄滅。

註:

1). 沖洗階段如關閉龍頭,常溫水按鍵繼續閃爍,20秒後龍頭進入待機狀態,喚醒龍頭後,常溫水按鍵繼續閃爍,且只有常溫水按鍵可操作,輕觸常溫水按鍵繼續沖洗。

2). 沖洗時務必仔細檢查產品各部位的密封性,用面紙擦拭各連接點,看面巾紙是否有濕潤現象。檢查各水路管是否安裝正確、完全。

3). 確認沖洗完成後,關閉觸控龍頭並確定觸控龍頭不漏水,至此機器調整完成。

3. 首次使用熱水

出廠預設飲水機加熱電源是關閉的,待首次沖洗完成之後,需手動打開加熱開關,沖洗未完成加熱開關無法開啟。首次取熱水時,機器先充滿管路後龍頭才開始出水。

鮮活水功能

1. 龍頭關閉後,若達5分鐘龍頭未打開取水,則回流沖洗1分鐘。

2. 龍頭關閉後,達8小時龍頭未打開取水,則回流沖洗1分鐘。

3. 若製水停機不到5分鐘有重新製水,則停機後重新計時。

4. 回流沖洗中,若龍頭開啟則退出模式重新計時。

5. 上電10秒內,長按「濾心復位鍵+加熱開關鍵」5秒,可關閉鮮活水功能,再次操作恢復。

智能省電模式

1. 連續48H用戶無制水,關閉飲水機加熱,每隔48H進行一次內膽換水(3分鐘),當用戶取水時,恢復正常模式。

2. 上電10秒內,長按「加熱開關鍵」5秒,可關閉智慧省電模式,再次操作恢復。

濾心復位及沖洗

長按「濾心復位鍵」5秒,蜂鳴0.5秒,將目前操作的濾心壽命進行重置操作,重設成功壽命燈常亮顯示藍色;復位成功後進入沖洗狀態,累計膜前沖洗5分鐘(強制沖洗,龍頭不可操作),膜後沖洗30分鐘(15+15),完成後進入待機狀態。

註:沖洗過程中再次長按「濾心復位鍵」5秒,跳過沖洗程序,進入正常使用介面。

使用飲水機(續)

故障及保護

泵浦超時保護

幫浦連續工作時間達30分鐘,執行超時提醒,蜂鳴器鳴叫1秒停1秒。工作時間超過33分鐘執行超時保護,此時停止鳴叫。

高原沸點判定模式

上電10秒後,長按「加熱開關鍵」5秒,鳴叫3秒,進入海拔適應功能(相同按鍵操作退出此功能)。

保溫桶水排空操作

排空前先重新上電,5秒後再斷電;旋開機器後部的排水口蓋並取下矽膠塞然後使用回形針等將保溫桶進氣口頂開,保持進氣口頂開狀態直到水排空為止。

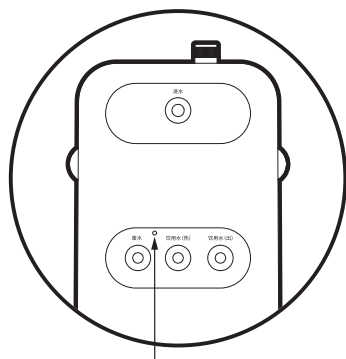

保溫桶進氣口

二、主機顯示與操作

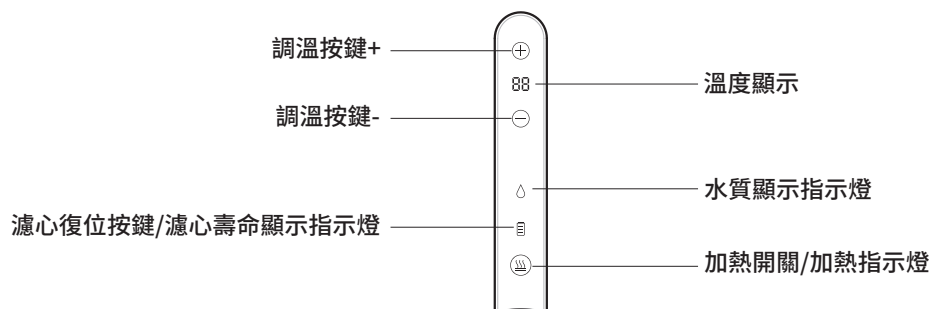

使用飲水機(續)

按鍵名稱	操作	顯示	效果	備註
調溫按鍵+	短按	溫度顯示增加	每按1次, 增加1°C	在飲水機加熱開啟狀態下有效; 調溫範圍 (40°C-95°C) *1; 5秒內無其它操作, 溫度默認設定完成
	長按		快速增加, 放開停止	
調溫按鍵-	短按	溫度顯示減少	每按1次, 減少1°C	
	長按		快速減少, 放開停止	
		顯示E2、E3、E4等	產品故障代碼	請查閱《產品性能故障表及排除方法》
		水質顯示燈點亮	藍色 水質優, 可直飲	
			黃色 水質良, 檢查原水和濾心狀態	
			紅色 水質差, 不建議直飲	
濾心復位按鍵	長按	濾心壽命指示燈點亮	藍色 濾心復位成功	*2
		濾心壽命指示燈點亮	藍色 濾心壽命正常	
			黃色 濾心壽命即將到期	
			紅色 濾心壽命到期或故障	
加熱開關	短按	加熱指示燈點亮	開啟或關閉加熱功能	首次沖洗完成後, 加熱功能才能啟動
		加熱指示燈顯示	紅色 加熱中	
		白色 待機狀態		

調溫按鍵*1

說明: 海拔高度對沸點有影響, 最高溫度設定需參考下表:

海拔高度	沸點	最高溫度設定
0m-500m	97°C-100°C	92°C-95°C
500m-1500m	94°C-96°C	89°C-91°C
>1500m	90°C-93°C	85°C-88°C

濾心壽命提示燈*2:

壽命階段	剩餘使用時間(天)	剩餘處理量(淨水量/升)	提示方式	
			壽命指示燈	蜂鳴器
正常	>15	>150	藍色常亮	無提示
預警	>0且≤15	>0且≤150	黃色常亮	壽命減少至剩餘量, 取水時鳴叫2次(鳴0.3秒, 停1秒)
報警	≤0	≤0	紅色常亮	取水時鳴叫(鳴0.3秒, 停0.3秒)

使用飲水機(續)

三、龍頭顯示及操作

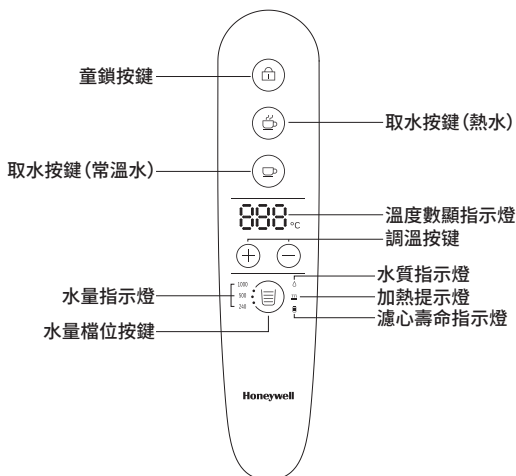

20秒無動作龍頭進入待機狀態,待機狀態燈全熄滅;輕觸任意按鍵喚醒介面,然後可以再操作;使用狀態下,所有燈即時顯示。

按鍵名稱	操作	顯示	效果	備註
童鎖按鍵	短按1秒	熄滅	童鎖臨時解鎖、童鎖燈滅,蜂鳴0.1秒,	1.臨時解鎖後,停止取熱水10S內無動作機器自動上鎖,10S期間再次輕觸童鎖鍵,手動上鎖。 2.溫度檔位大於40°C時童鎖鍵上鎖,燈亮,此時按熱水取水鍵無反應,童鎖燈亮紅色閃2次。
	長按5秒		童鎖鍵功能去除	
取水按鍵(熱水)	短按	指示燈紅色	出熱水	內膽溫度低於選擇檔位溫度,停止出熱水,再次點擊熱水取水鍵可取水。
		指示燈熄滅	停止出水	
取水按鍵(常溫水)	短按	指示燈白色	出常溫水	取水時再次輕觸,燈滅,停止出水。
調溫按鍵(加、減)	短按	溫度數顯指示白色常亮	顯示選擇熱水出水溫度	無任何操作狀態下,顯示選擇檔位的溫度; 故障提示E0, E2, E4, E5, E6...
水量檔位按鍵	短按	對應的水量指示燈亮	進行水量選擇 順序為: 240ml、500ml、1000ml	首次使用,水量檔位關閉,水量燈熄滅;當水量檔位為1L時,再次輕觸水量檔位按鍵則關閉水量檔位選擇,水量燈熄滅。
		水質顯示燈點亮	藍色 水質優, TDS值100以下	取水時燈亮。
	黃色 水質良, TDS值100-150			
	紅色 水質差, TDS值150以上			
		濾心壽命指示燈點亮	藍色 濾心壽命正常	
	黃色 濾心壽命即將到期			
	紅色 濾心壽命到期或故障			
		加熱指示燈顯示	紅色 加熱中	飲水機不加熱時燈滅。
			白色 待機狀態	

濾心更換

1. 確保機器處於斷電斷水狀態。
2. 將待換濾心逆時針旋90°後拉出,擠壓濾心口標識處進行洩壓,避免濺傷。

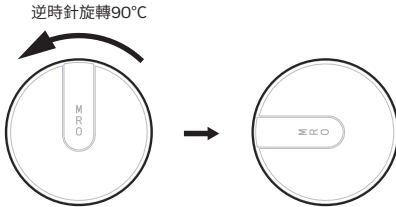

3. 推入新濾心,順時針旋轉90°。

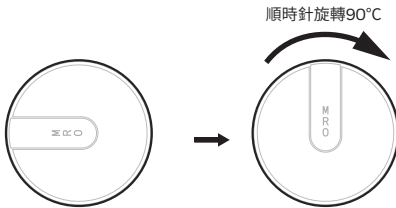

4. 進行濾心復位(詳見第10頁「濾心復位及沖洗」)。
5. 打開龍頭進行適當沖洗(詳見第10頁「濾心復位及沖洗」)。

濾心	過濾性能	建議更換週期
MRO逆滲透複合濾心	可有效過濾懸浮物、泥沙、鐵鏽、膠體等雜質	濾心更換建議週期18個月
	吸附餘氯、有機物異色、異味	
	有效過濾原水中的可溶性固體、重金屬離子、有機物、膠體、細菌等雜質	

1. 淨水器所建議的濾心更換週期是參考了各地自來水的平均指標統計估算而得。使用者實際使用處的水質及機器的使用率如與平均指標存在較大出入時,濾心的使用與估算週期會有較明顯的差異,如濾心過早堵塞、過早失效等,此時應以實際使用狀態作為「濾心更換的依據」。

2. 流速在攝氏25度條件下測試,水溫降低會降低RO製水速度。

安全注意事項

一、安全注意事項

- 1.當您長期外出或不使用本飲水機時，請關閉進水水源「進水三通」（開關垂直為關閉）。
- 2.當有以下任何情況出現時，請立即斷開飲水機進水水源「進水三通」關閉，並即時與「瀚頓國際淨水客服部」聯繫。
 - (1)淨水器的管路或相關零件漏水。
 - (2)淨水器的相關零件失去作用。
 - (3)有其他任何異常現象或故障。
 - (4)發現漏水情形，請先將進水水源「進水三通」如下圖，開關關閉（開關垂直為關閉）。

(1)進水三通_開啟

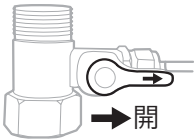

(2)進水三通_關閉

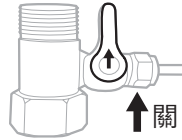

二、漏水斷路器

- 1.檢測到漏水時，蓋子會彈起，通知已檢測到漏水。
- 2.水龍頭關機或拔掉插頭，或關閉進水三通。
- 3.請依照漏水情況選擇處理方式。

正常
使用
情況

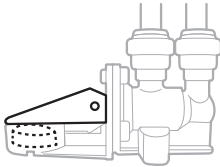

漏水
使用
情況

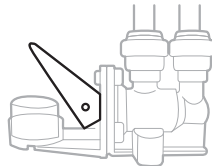

※蓋子彈起時，代表發生漏水情形，須來電至「瀚頓國際淨水客服部」派人員進行檢查漏水情形，以免廚房發生漏水危機。

☆ 蓋子彈起 ☆

☆ 蓋子彈起，櫥下四周圍無漏水 ☆

- 1.將膨脹的吸水棉取出，四周圍水擦乾淨，放入全新的吸水綿(透明包裝拿掉)。
- 2.蓋子蓋上，並持續觀察三天是否有滲水情形再次發生，確保無漏水。
- 3.將水閥門開啟，並開啟水龍頭。

☆ 蓋子彈起，櫥下發現四周圍漏水 ☆

請勿更換吸水棉，並請撥打以下客服電話報修或者使用瀚頓國際官方Line通知漏水情形，並拍照上傳與報修。

安全注意事項(續)

產品中有害物質的名稱及含量

設備名稱 : Honeywell 櫥下智控RO淨化飲水機

型號(型式) : ProPura-RO800-I-TW

Equipment name Sample and its location

Type designation (Type)

單位	限用物質及化學符號 Restricted substances and its chemical symbols					
	鉛 Lead (Pb)	汞 Mercury (Hg)	鎘 Cadmium (Cd)	六價鉻 Hexavalent chromium (Cr ⁶⁺)	多溴聯苯 Polybrominated biphenyls (PBB)	多溴二苯醚 Polybrominated diphenyl ethers (PBDE)
外殼塑料	○	○	○	○	○	○
電磁閥	○	○	○	○	○	○
電源線	○	○	○	○	○	○
電子組件	○	○	○	○	○	○
加熱元件	○	○	○	○	○	○
馬達	○	○	○	○	○	○
電路板	○	○	○	○	○	○
線束組件	○	○	○	○	○	○

說明:

備考1: “超出0.1wt%”及超出0.01wt%”係指限用物質之百分比含量超出百分比含量基準值。

備考2: “0”表示該項有害物質之百分比含量未超出百分比含量基準值。

備考3: “—”係指限用物質為排除項目。



警語

1. 若電源線損壞時，必須由製造商、其服務處或具有相關資格的人員加以更換以避免危險。
2. 本電器不預期供生理、感知、心智能力、經驗或知識不足之使用者(包含孩童)使用，除非在對其負有安全責任的人員之監護或指導下安全使用。
3. 孩童應受監護，以確保孩童不嬉玩電器。
4. 本電器為家用。
5. 清潔電器內與食物接觸之表面，請用清水擦拭。
6. 取用熱水後，龍頭本體出水口仍有餘溫，請勿碰觸以免燙傷。
7. 請依照使用說明書使用電器，誤用將造成不可預期的危害。
8. 須使用電器附帶的新軟管，舊軟管不得重複使用。
9. 電器不得浸水。

產品性能故障表及排除方法

故障症狀/現象	故障原因	解決方法
E0(內膽壓力過大保護)	確認廢水管是否阻塞或折管	重新上電,打開熱水鍵排壓
E2(漏水防護)	1.確認PE管是否破裂 2.PE管是否插入到位 3.PE管剪切端口是否平整 4.矽膠軟膠是否有破損	1.更換PE管 2.重新插入PE管 3.重新剪切PE管 4.重新剪切矽膠軟膠
	確認濾心是否安裝到位	重新安裝濾心到位
	確認角閥是否安裝到位	重新安裝角閥
	確認是否拔插管導致機器進水	抬起機器頭部3-5分鐘
E4(馬達到位故障偵測)	待內膽加熱完畢後確認是否能出45度及95度水	重新上電
E5(加熱超時保護)	在不製水情況下,加熱時間超過20分鐘,退出加熱模式	重新上電,開啟加熱功能
E6(內膽NTC異常)	確認內膽溫度0-100度	重新上電,開啟加熱功能
	溫度探頭故障	更換溫度探頭故障
E7(低溫保護)	原水進水溫度過低(<3°C)	停止使用機器
	溫度探頭故障	更換溫度探頭
	確認是否調節閥故障	更換調節閥
E8(通水異常&乾燒保護)	1.確認連接管是否破裂 2.連接管是否插入到位 3.連接剪切埠是否平整	1.更換連接管 2.重新插入連接管 3.重新剪切連接管
	確認濾心是否安裝到位	重新安裝濾心到位
	確認三通球閥是否安裝到位	重新安裝三通球閥
	確認龍頭熱水是否正常出水	重新上電,打開熱水龍頭水注入內膽,直至龍頭穩定出水,重新開啟加熱功能
E9(通訊異常)	確認龍頭與主機連接線是否接好	斷開電源後重新拔插龍頭與主機連接線再重新上電
龍頭水花分叉	龍頭出水口沉積碎屑	旋下龍頭出水嘴,清出水口
控制面板無顯示	確認電源是否接好	重插拔電源
	確認前蓋是否未裝到位	重新安裝前蓋
龍頭觸控失靈	確認龍頭操作界面是否乾燥	擦拭龍頭保持乾燥
	確認手是否有太多水或油污	保持手上無較多的水或油污
飲水機自動停機	確認故障燈是否為增壓幫浦工作超時	重新上電
	確認故障燈是否為增壓幫浦頻繁啟動停止	確認龍頭完全關閉,無漏水狀態,重新上電

保固說明

瀚頓國際保證本產品由消費者自購買日起，於正常使用與維修下享有壹年保固期，在機體或材質上均無缺失。若期間本產品確有缺陷或發生故障，瀚頓國際將會予以修復或更換（瀚頓國際保有選擇權）。

如該產品是有缺陷的，

(1) 將它併同買賣契約（發票）或其他註有日期之購買證明，送回至你原購買處所。

(2) 請撥打瀚頓國際客服專線 0800-201-666。

本保固不包括移除或重新安裝費用。若瀚頓國際證明，肇致該缺陷或故障之損害，係於消費者持有本產品期間所發生的，則本保固不適用。

瀚頓國際唯一的責任是在上述項目範圍內，修復或更換產品。

直接或間接地違反任一保固條款，導致包含任何伴隨或必然之產品損害，對於該項陳述或暗示或其他型態的產品失敗或損傷，瀚頓國際將不負有法律責任。

本保固係瀚頓國際在本產品上唯一的保固陳述。任何意味保固的有效期，包含針對一特定目的適銷與適當的保固，於此聲明限制在本保固的壹年期間。

保 固 書

使 用 者	
機 型	ProPura-RO800-I-TW
淨 水 器	MRO

保固書登錄



請於官網登錄您的使用者資料，保障售後服務權益。

總代理章

經銷商章

PACKING LIST

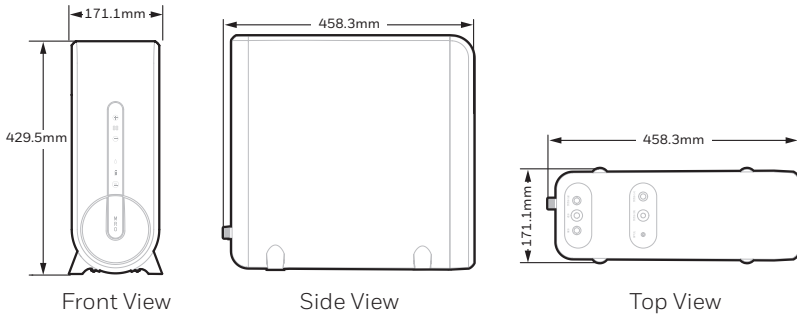

Product appearance is only a diagram. Please refer to the actual product.

Name	Quantity
Water purifier	1 pc
Tee joint	1 pc
Quick-connect locking plate accessories	1 set
1/4" PEX pipe (red)	1 pc
3/8" PE pipe (gray)	1 pc
Faucet and accessories	1 set
User manual (including Warranty Card, Certificate of Conformity)	1 pc
Gloves	1 pair
Non-slip mat	1 pc
Must-Read and Installation Precautions	1 pc

PRODUCT INTRODUCTION

PRODUCT MODEL AND SPECIFICATIONS

Product name	Honeywell ProPura-RO800-I-TW Water Purifier
Product model	ProPura-RO800-I-TW
Flow rate of ambient drinking water	2.1L/min
Filtration capacity	5000L
Flow rate of hot drinking water	1.9L/min
Feed water pressure	(0.1~0.4) MPa
Working pressure	(0.42~0.8) MPa
Feed water temperature	5~38 C
Feed water requirement	Municipal tap water
Rated power	765W
Rated voltage	110V~ 60Hz

· The water flow rate and filtration capacity are measured according to the inspection regulations of the National Health Commission. The actual filtration capacity will vary due to different water quality and usage environment in different places.



It must be operated by professional maintenance personnel. The operation time varies depending on the actual use and the local water quality. If the filter is not replaced, cleaned and maintained regularly, it may cause the water dispenser to malfunction and will not be covered by the warranty.

PRODUCT INTRODUCTION(CONTINUED)

I. Schematic Diagram

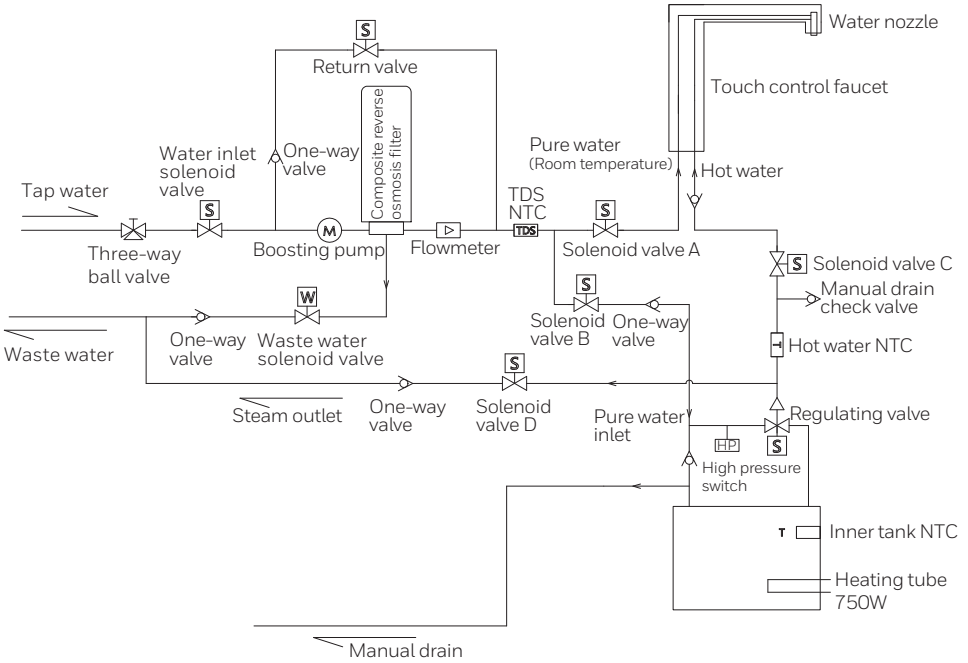

II. Electrical Diagram

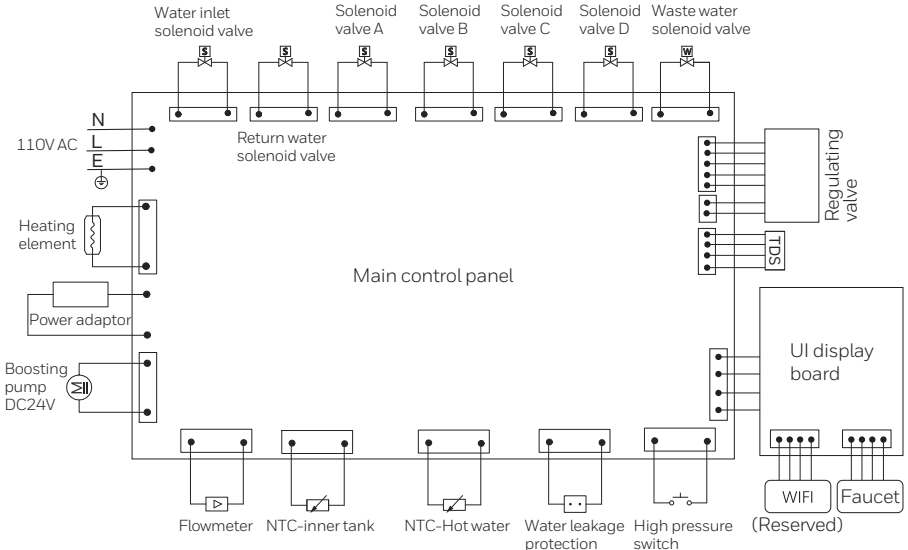

INSTALLATION

I. Prepare for installation

1. Check the power cord before installation. If there is any damage, please contact our after-sales hotline and replace it by professionals to avoid dangers.
2. Confirm the location where the water purifier will be installed.
3. Make sure that a standard grounded power socket is installed at the installation location.
4. Check the packing list in the User Manual and confirm whether the accessories are complete.
5. Prepare the tools required for installation.

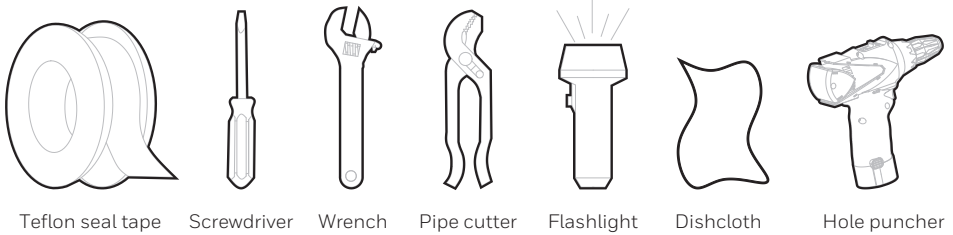

II. Install the ball valve

1. Turn off the cold water valve and unscrew the cold water hose.
2. Install the three-way ball valve on the cold water valve and tighten it with an adjustable wrench.
* do not miss the sealing gasket on the angle valve
3. Install the cold water hose on the three-way ball valve and tighten it with an adjustable wrench.
* do not miss the sealing gasket on the cold water hose
4. Pass the 3/8" PE pipe through the ball valve nut and press it into the convex interface on the angle valve. Press it to the bottom and tighten the ball valve nut with a wrench.

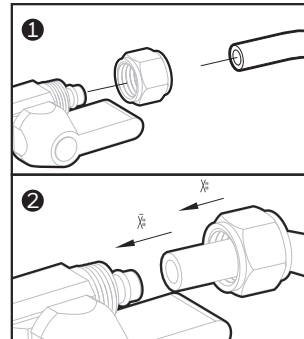
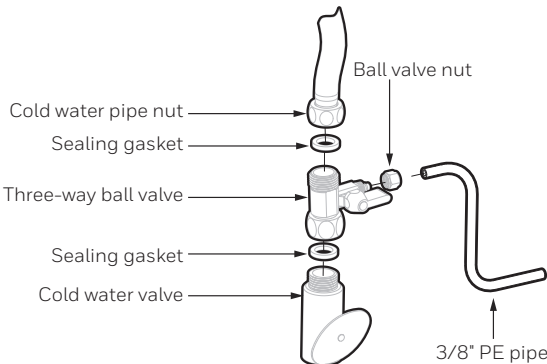

INSTALLATION(CONTINUED)

III. Install the faucet

1. Choose a suitable installation location on the sink or countertop and install it on a flat surface with holes. The installation hole size is 28mm-30mm.
2. Install the faucet as shown in the figure.
 - a. Place the connecting rod into the mounting hole of the sink plate.
 - b. Insert the parts into the connecting rod one by one as shown in the figure, make sure not to entangle the pipes and wires.
 - c. Thread the nut onto the connecting rod and tighten it.

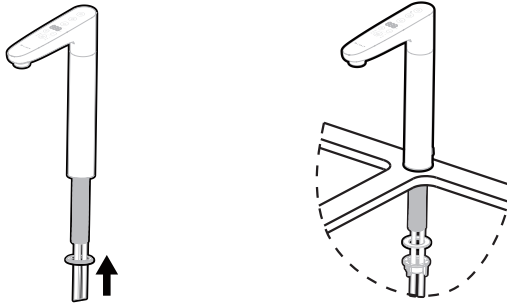

IV. Install the water purifier

Confirm the direction to place the product and lay a non-slip mat provided at the bottom of the product. Ensure that the position where the water purifier is placed is horizontal. If there is a significant delay in the water output, follow these steps to resolve the issue:

1. Turn on the faucet;
2. Slightly lift the rear end of the product to a certain height;
3. Once the water flow from the faucet is stable, carefully return the product to its original position.

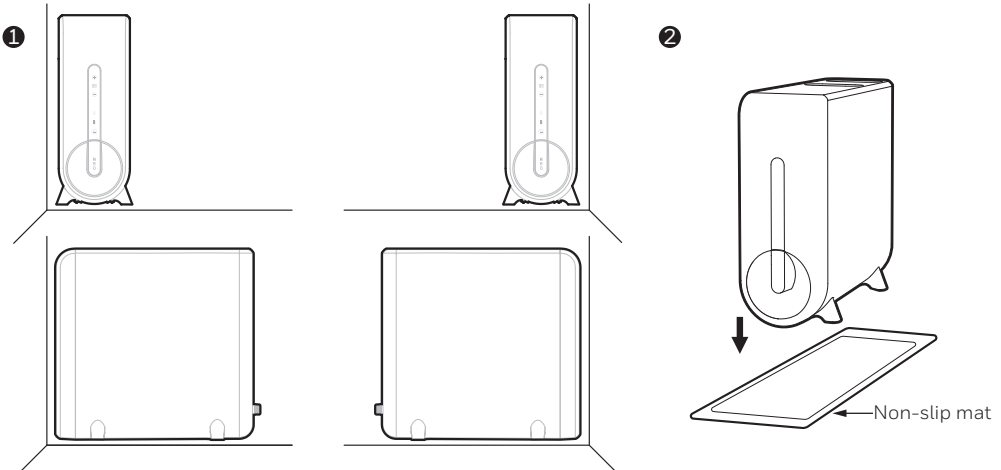

INSTALLATION(CONTINUED)

V. Install the pipeline

Cut the PE pipe to an appropriate length, and make sure the notch is flush, as shown in the following figure:

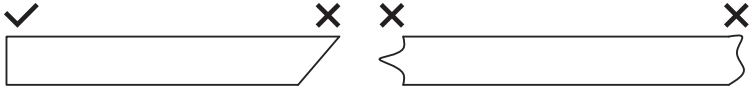

VI. Install the water inlet pipe

1. Cut the PE pipe connected to the angle valve to an appropriate length with pipe cutter;
2. Insert the other end of the pipe into the water inlet, insert it to the bottom and then insert the quick-connect locking plate into the quick connector slot.

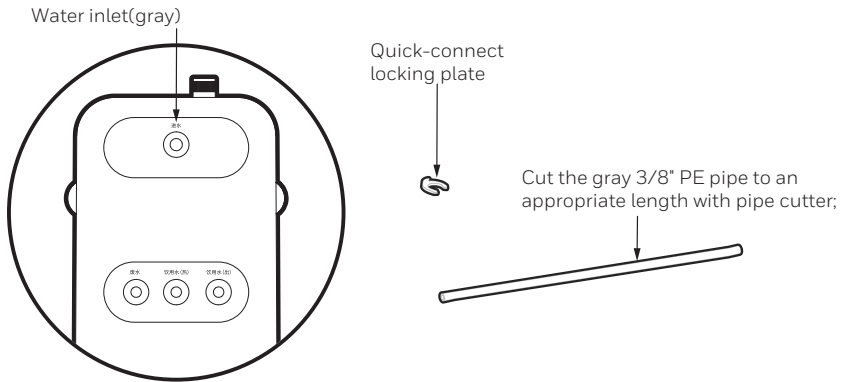

VII. Install the drinking water outlet pipe

1. Cut the blue 1/4" PE pipe of the touch control faucets to an appropriate length with pipe cutter;
2. Insert the pipe into the drinking water outlet of the water purifier, insert it to the bottom and then insert the quick-connect locking plate into the quick connector slot.

INSTALLATION(CONTINUED)

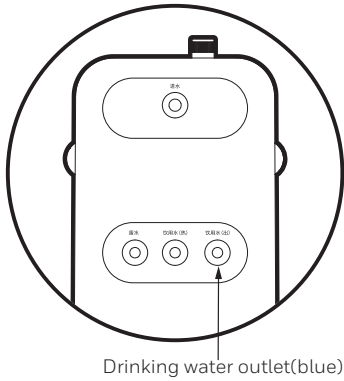

Quick-connect locking plate



Cut the blue 1/4" PE pipe to an appropriate length with pipe cutter;



VIII. Install the waste water pipe

1. Cut the red 1/4" PEX pipe to an appropriate length with pipe cutter;
2. Insert one end of the pipe into the waste water outlet of the water purifier, insert it to the bottom and then insert the quick-connect locking plate into the quick connector slot;
3. Insert the other end of the red 1/4" pipe to the sewer outlet and fix it.

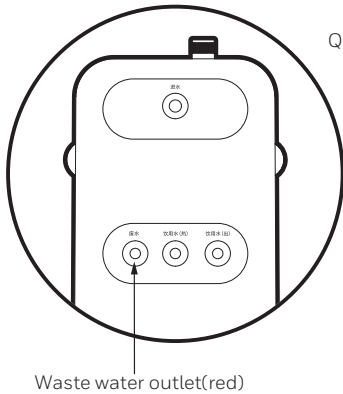

Quick-connect locking plate



Cut the 1/4" red PEX pipe to an appropriate length with pipe cutter;



Sewer outlet

IX. Installation of hot water outlet

1. Cut the white 1/4" PTFE pipe of the touch control faucets to an appropriate length with pipe cutter;
2. Insert the pipe into the hot water outlet of the water purifier, insert it to the bottom and then insert the quick-connect locking plate into the quick connector slot.

INSTALLATION(CONTINUED)

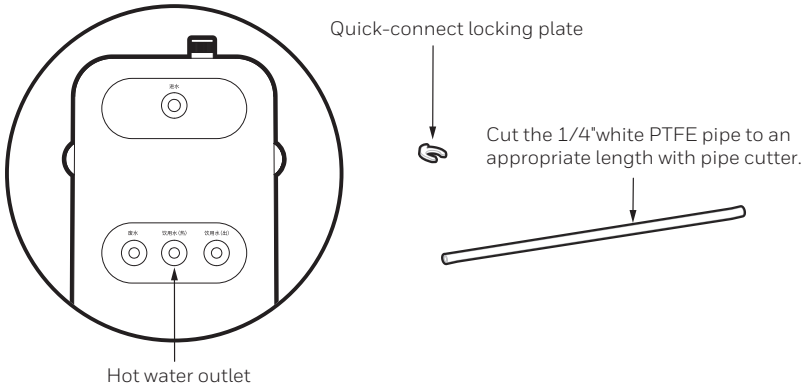

XII. Installation diagram

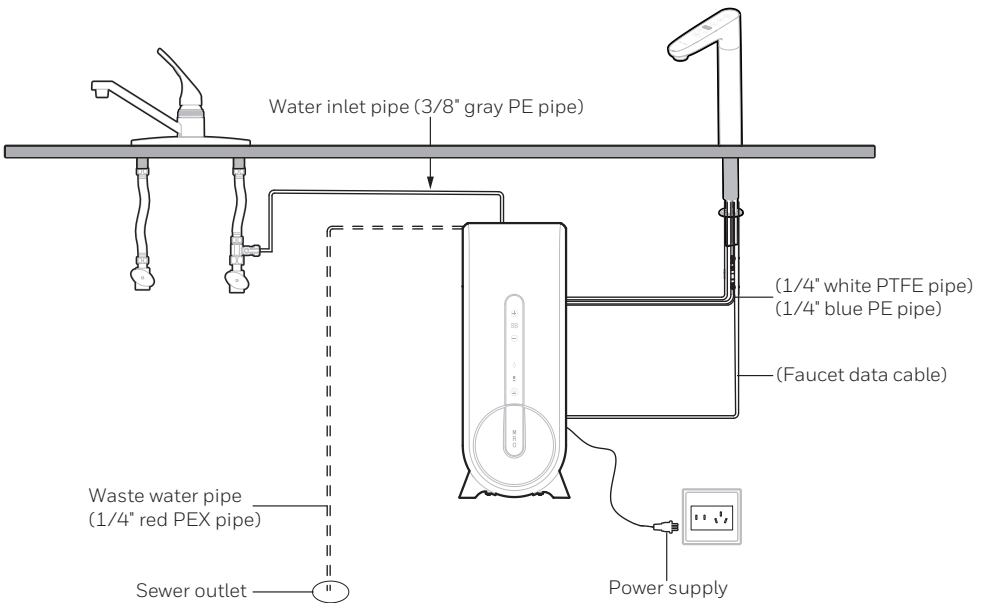

Notes:

1. The notches of PE pipe and silicone pipe must be smooth and free of burr which may affect the sealing effect;
2. Make sure that the pipe is not deformed after cutting and that the ORING is well sealed without water leakage;
3. Check that there is no water leakage at the joints of each water pipe and the pipes are not bent;
4. The waste water outlet pipe must be connected to the sewer outlet and fixed. Do not collect waste water with water storage device to avoid overflow due to automatic flushing of the product.
5. Ensure the power is off when plugging or unplugging the data cable.

USE INSTRUCTIONS

I. Use for the first time

First use

1. First start

After power-on, the buzzer beeps for 0.1s, all the indicators turn on at the same time, and then each type of indicator turns on for 1s in sequence. The tri-color indicators turn on in each state for 1s, the single-color indicators keep on for 3s, and the bi-color indicators turn on for 1.5s respectively. After that, the product will enter the first flush within 3s.

2. First flush

1) Pre-membrane flush: When the power is on, the water purifier will flush the RO membrane automatically for 35 minutes. The faucet displays the countdown, the filter service life indicator keeps on and the water quality indicator flashes red. In this conditions, the faucet cannot be operated.

2) Post-membrane flush: Touch the ambient drinking water on the faucet to flush the RO membrane for 15 minutes. After 15 minutes, the faucet will automatically switch to hot water and flush for 15 minutes again. During flush, the water quality indicator will display the real-time water quality condition and flashes at 1Hz. After flushing, it enters the standby state and the filter service life indicator keeps ON and the heating indicator keeps OFF.

Note:

1) During the flushing process, if the faucet is turned off, the ambient water button will continue flashing, and the faucet will enter standby mode after 20 seconds. After waking up the faucet, the ambient water button will continue flashing, and only the ambient water button will be operational. Tap the ambient water button to resume flushing.

2) When flushing, check the sealing of each part of the product carefully and wipe each connections with a tissue and check if the tissue is wet. Check whether the water pipes are installed correctly and in place.

3) After flushing, turn off the faucet and make sure that the faucet is not leaking. After that, the commission of the product is completed.

First use of hot water

The factory default setting is that the heating function of the water purifier is off. After flushing, users should turn on the heating switch manually. Before the first flush is completed, the heating switch cannot be turned on. When taking hot water for the first time, the system will fill the pipe first and the faucet starts to flow out water.

USE INSTRUCTIONS(CONTINUED)

Fresh water function

1. After the faucet is turned off and isn't turned on again within 5 minutes, the water purifier will be backwashed for 1 minute.
2. If the faucet is not turned on for taking water within 8 hours, the water purifier will be backwashed for 1 minute.
3. If the water production is restarted within 5 minutes after the water production is stopped, the timing will be restarted after shutdown.
4. If the faucet is turned on during backwashing, the product will exit the fresh water function and restart the timing.
5. Within 10s after power on, hold the "Filter reset + Heating switch" for 5s to disable the fresh water function, and then operate again to restore.

ECO mode

1. If user does not take water for 48h, the product will automatically stop heating and exchange the water in the inner tank every 48 hours. When the user takes water again, it turns to normal using condition.
2. Within 10s after power-on, hold the "Heating switch" for 5s to disable the ECO mode, and operate again to restore.

Filter reset and flushing

Hold the "Filter reset" button for 5s, the buzzer will beep for 0.5s, and the current filter service life will be reset. After resetting successfully, the filter service life indicator will keep ON in blue and the product will enter the flushing state. The product will flush the pre-membrane for 5 minutes (forced flushing and the faucet cannot be operated) and flush the post-membrane for 30 minutes (15+15). After flushing, the system will enter the standby state.

Note:

During flushing, hold the "Filter reset" button for 5s again to skip the flushing process and enter the normal use interface.

Fault and protection

Pump timeout protection

When the pump works continuously for 30 minutes, a timeout reminder will be given and the buzzer will beep for 1s and then stop for 1s. When the working time exceeds 33 minutes, the timeout protection will be executed and the beeping stops

Boiling point adjustment

Within 10s after power-on, hold the "heating switch" for 5s, the buzzer will beep for

USE INSTRUCTIONS(CONTINUED)

'3s and the water purifier will enter the boiling point adjusting state.(press this button again to exit this state.)

Inner tank emptying

Before draining, power on the product again and then sut off the power supply after 5s. Unscrew the drain cover at the rear of the water purifier and remove the silicone plug, then eject to open the air inlet of the heat storage tank the inner tank with clip, and keep the air inlet open until the water is drained..

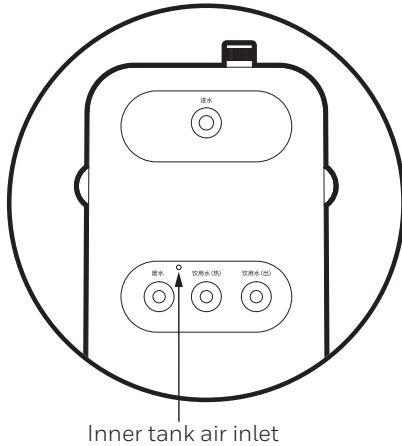

USE INSTRUCTIONS(CONTINUED)

II. Display and operation

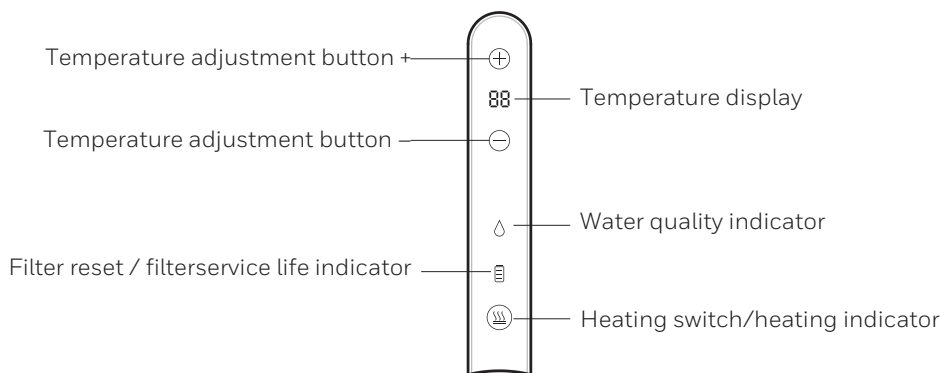

Button Name	Operation	Display	Effect	Remarks	
Temperature adjustment button +	Press	Increase the temperature	Press it once to increase the temperature by 1°C	The temperature can be adjusted only when the heating function of the water purifier is on. The temperature adjustment range is (40°C -95°C)*1. If there isn't any operation within 5 second, the setting is completed.	
	Hold it		Rapidly increase the temperature, release it to stop increasing		
Temperature adjustment button -	Press	Decrease the temperature	Press it once to decrease the temperature by 1°C	The temperature can be adjusted only when the heating function of the water purifier is on. The temperature adjustment range is (40°C -95°C)*1. If there isn't any operation within 5 second, the setting is completed.	
	Hold it		Rapidly decrease the temperature, release it to stop increasing		
		Display E2, E3, E4, etc.	Product fault codes	Please refer to the "TROUBLE SHOOTING" section.	
		Water quality indicator turns on	Blue	The water quality is good, the water is directly drinkable.	
			Yellow	The water quality is fairly good, check the status of the tap water and filter.	
			Red	The water quality is poor, it is not recommended for direct drinking.	
Filter reset	Hold it	Filter service life indicator turns on	Blue	The filter service life has been reset	
		Filter service life indicator turns on	Blue	The filter life is normal.	
			Yellow	The filter life is about to expire.	*2
			Red	The filter life expired or faulty.	
Heating switch	Press	Heating indicator turns on		Turn on or off the heating function	
		The heating indicator turns on	Red	Heating	The heating function cannot be turned on before the first flushing is completed.
			White	Standby state	

USE INSTRUCTIONS(CONTINUED)

Temperature adjustment button*1

Notes: The boiling point will be affected by the altitude. Please refer to the following table for the maximum set temperature.

Altitude	Boiling point	Maximum set temperature
0m-500m	97°C-100°C	92°C-95°C
500m-1500m	94°C-96°C	89°C-91°C
>1500m	90°C-93°C	85°C-88°C

Filter service life indicator*2:

Service life stage	Remaining days	Remaining capacity(L)	Prompt Method	
			Service life indicator	Buzzer
Normal	>15	>150	Keep on in blue	No prompt
Early warning	>0≤15	>0≤150	Keep on in yellow	When the life is reduced to the remaining volume, beep twice when taking water (beep for 0.3 seconds and then stop for 1 second)
Alarm	≤0	≤0	Keep on in red	Beep when taking water (beep for 0.3 seconds and then stop for 0.3 seconds)

III. Faucet display and operation

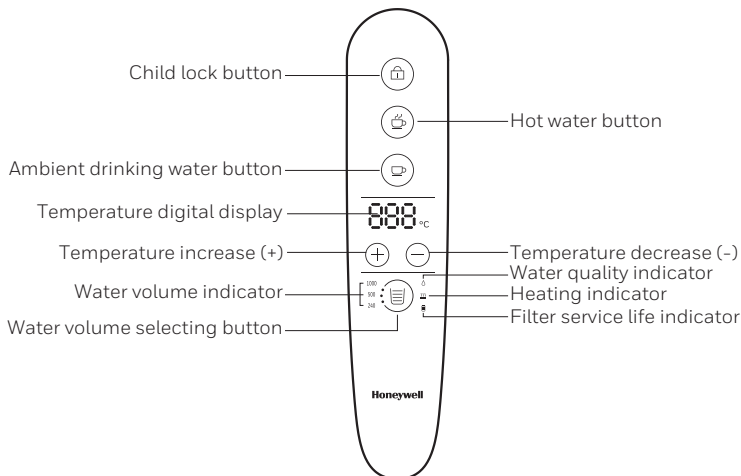

USE INSTRUCTIONS(CONTINUED)

If it is not operated for 20 seconds, the faucet will enter standby state, and all standby indicators turn OFF. Touch any button to wake up the interface, and then you can operate it again. When in using, all indicators display in real time.

Button Name	Operation	Display	Effect	Remarks	
Child lock button	Press 1 second	OFF	When the child lock is temporarily unlocked, the child lock light turns OFF, and the buzzer sounds for 0.1S.	1. After temporary unlocking, stop taking hot water and the water purifier will automatically lock if it is not operated within 10 seconds. Touch the child lock button again during the 10 seconds to lock manually. 2. When the temperature is higher than 40°C, the child lock button is locked and the indicator turns ON. At this time, it is invalid to press the hot water button and the child lock indicator flashes twice in red.	
	Hold it for 5 seconds		Disable the child lock function.		
Hot water button	Press	Indicator displays in red	Output hot water	When the temperature of the inner tank is lower than the temperature of the selected level, stop outputting hot water. Click the hot water button again to take hot water.	
		Indicator OFF	Stop water output		
Ambient drinking water button	Press	Indicator displays in white	Output ambient drinking water	Touch it again when taking water, the indicator turns OFF and the water stops outputting.	
Temperature increase (+) Temperature decrease (-)	Press	The temperature digital display keeps ON in white	Display the selected hot water output temperature	When there is no operation, display the temperature of the selected level; Fault prompts E0, E2, E4, E5, E6...	
Water volume selecting button	Press	The corresponding water amount indicator turns ON	Select water amount The order is: 240ml, 500ml, 1000ml.	When using it for the first time, the water amount level is closed and the water amount indicator is OFF. When the water amount level is 1L, touch the water amount level button again to close the water amount level selection and the water amount indicator turns off.	
		Water quality indicator turns on	Blue	The water quality is good, the TDS value is <100.	The indicator is ON when taking water.
	Yellow		The water quality is fairly good, the TDS value is 100-150.		
	Red		The water quality is poor, the TDS value is >150.		

USE INSTRUCTIONS(CONTINUED)

Button Name	Operation	Display	Effect	Remarks	
		Filter service life indicator turns on	Blue	The filter life is normal.	The indicator is ON when taking water.
	Yellow		The filter life is about to expire.		
	Red		The filter life expired or faulty.		
		The heating indicator turns on	Red	Heating	The indicator is OFF when it is not heating.
			White	Standby	

REPLACEMENT OF THE FILTER

1. Make sure the product is power off and the water supply is cut off.
2. Rotate the filter to be placed counterclockwise 90° and pull it out. Please pay attention to the splashing because the filter will release pressure during rotation.

Rotate 90° counterclockwise

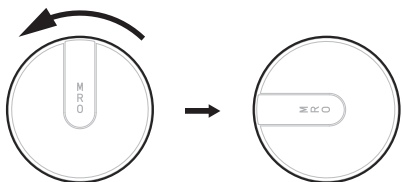

3. Push in the new filter and rotate it 90° clockwise.

Rotate 90° clockwise

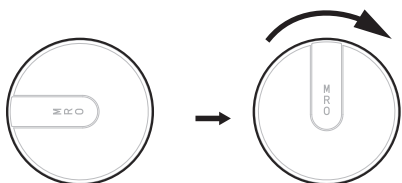

4. Reset the filter.
5. Turn on the faucet and flush (Please refer to “Filter reset and flushing” on page 27).

REPLACEMENT OF THE FILTER(CONTINUED)

Function Description	Performance	Recommended Replacement Period
MRO reverse osmosis composite filter	Effectively intercept sediment, rust, colloids, suspended solids and other large particles of impurities and improve water turbidity.	The recommended filter replacement period is 18 months.
	Deeply absorb residual chlorine, disinfection by-products, organic matter, bad taste and odors and effectively improve the taste of water.	
	Effectively reduce bacteria, viruses, heavy metals, plasticizers, antibiotics, pesticides and other harmful substances.	

1. The recommended service life is based on average index of municipal tap water in different places. If the water quality and frequency of use are significantly different from the average index, the service life of the filter will be different from recommended cycle, such as early clogging and early failure of the filter, the filter should be replaced according to the actual using status and contact local after-sales service timely.
2. The water flow rate is tested under the water temperature of 25°C. The flow rate will be reduced if the water temperature decreases.

NOTICE

I. Safety Notice

1. When you are away for an extended period or not using this water purifier, please turn off the water supply at the 'three-way ball valve' (the valve is closed when it is in a vertical position).

2. If any of the following situations occur, please immediately disconnect the water purifier's water supply and contact the customer service.

(1) Water leakage in the pipes or related components.

(2) The related components are inoperative.

(3) Other abnormal phenomena or malfunctions

(4) In the event of a leak, first shut off the water supply at the 'three-way ball valve' as indicated in the diagram below. Turn the switch to the off position (the switch is closed when it is vertical).

(1) Three-way ball valve-Turn on

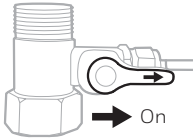

(2) Three-way ball valve-Turn off

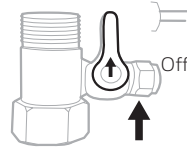

II. Water Leakage Circuit Breaker

1. Upon detecting a water leak, the cover will spring up to signal that a leak has been detected.

2. Turn off the faucet, unplug the device, or close the three way ball valve.

3. Please select the appropriate action based on the specifics of the water leak situation.

NOTICE(CONTINUED)

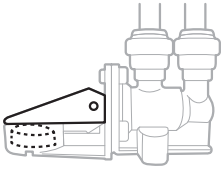

Normal using condition

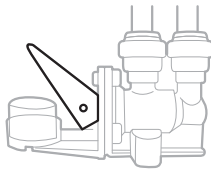

Water leakage condition

*Cover spring up

*When the cover springs up, it indicates that a water leak has occurred. You should contact the customer service to dispatch personnel to inspect the water leak situation and prevent a potential crisis in the kitchen due to water leakage.

*If the cover springs up and there is no water leakage around the kitchen area, follow these steps:

1. Remove the expanded water-absorbing cotton and clean up any surrounding water. Then, replace it with a new water-absorbing cotton(remove the transparent packaging).
2. Close the cover and continue to observe for three days to see if there is any recurrence of water seepage, ensuring no leakage.
3. Turn on the water valve and open the faucet.

*If the cover springs up and water leakage is found around the kitchen area: Please do not replace the water-absorbing cotton. Instead, contact our customer service by phone to report the issue for repair. Alternatively, you can use the official Line to inform us of the water leakage and submit photos for the repair documentation.

NOTICE(CONTINUED)

Name and content of hazardous substances in the product

Equipment name Sample and its location :		Type designation (Type):				
Honeywell Water Purifier		ProPura-RO800-I-TW				
unit	Restricted substances and its chemical symbols					
	Lead (Pb)	Mercury (Hg)	Cadmium (Cd)	Hexavalent chromium (Cr ⁶⁺)	Polybrominated biphenyls (PBB)	Polybrominated diphenyl ethers (PBDE)
Plastic housing	○	○	○	○	○	○
Solenoid valve	○	○	○	○	○	○
Power cord	○	○	○	○	○	○
Electronic components	○	○	○	○	○	○
Heating element	○	○	○	○	○	○
Motor	○	○	○	○	○	○
Circuit board	○	○	○	○	○	○
Wire harness assembly	○	○	○	○	○	○

instruction:

Note 1: "Exceeding 0.1wt%" and "Exceeding 0.01wt%" refer to the percentage content of the restricted substance exceeding the percentage content benchmark value.

Note 2: "0" indicates that the percentage content of the hazardous substance does not exceed the percentage content benchmark value.

Note 3: "-" indicates that the restricted substance is an excluded item.

Warnings

1. If the power cord is damaged, it must be replaced by the manufacturer, its service center, or a qualified person to avoid danger.
2. This appliance is not intended for use by users (including children) with insufficient physical, sensory, mental, experiential, or knowledge capabilities, unless used safely under the supervision or guidance of personnel responsible for their safety.
3. Children should be supervised to ensure they do not play with the appliance.
4. This appliance is for household use.
5. To clean surfaces inside the appliance that may come into contact with food, wipe with clean water.
6. After dispensing hot water, the tap spout may still be warm; do not touch it to avoid burns.
7. Please use the appliance according to the instruction manual. Misuse may cause unforeseen harm.
8. Only the new hose provided with the appliance must be used; old hoses must not be reused.
9. The appliance must not be immersed in water.



PRODUCT WARRANTY INSTRUCTIONS

The warranty period begins on the date of sale. Hamton Watertec offers a one-year warranty from the date of purchase for products used under normal conditions and properly maintained, assuming there are no defects in the product or materials. Should the product prove to be defective or malfunction during this period, Hamton Watertec will either repair or replace it (at Hamton Watertec's discretion).

If the product is found to be defective,

(1) Please return the product, along with the sales contract (invoice) or other dated proof of purchase, to the original place of purchase.

(2) Please contact Hamton Watertec's customer service hotline at 0800-201-666.

This warranty does not cover the costs associated with the removal or reinstallation of the product. If Hamton Watertec determines that the damage leading to a defect or malfunction occurred while the product was in the consumer's possession, this warranty will not be applicable.

Hamton Watertec's sole liability under this warranty is to repair or replace the product within the limits of the aforementioned coverage.

Directly or indirectly violating any warranty term that results in incidental or consequential product damage, Hamton Watertec shall not be legally liable for for any form of product failure or damage.

This warranty represents Hamton Watertec's sole warranty statement for this product. Any implied warranty of merchantability or fitness for a particular purpose is hereby limited to the one-year duration of this warranty

Warranty Card

User	
Product model	ProPura-RO800-I-TW
Filter type	MRO

Agency stamp

Distributor stamp

TROUBLESHOOTING

Fault /Phenomenon	Cause	Solution
E0 (Inner tank overpressure protection)	Check whether the waste water pipe is blocked or bent.	Power on again and press the heating switch to release the pressure
E2 (Water leakage protection)	1. Check whether the PE pipe is broken 2. Check whether the PE pipe is inserted in place 3. Check whether the PE pipe notch is smooth 4. Check whether the silicone hose is damaged	1. Replace the PE pipe 2. Reinsert the PE pipe 3. Re-cut PE pipe 4. Re-cut the silicone hose
	Check whether the filter element is installed properly.	Reinstall the filter element in place
	Confirm whether the angle valve is installed in place.	Reinstall the angle valve
	Confirm whether the water ingress in the machine due to pipe plugging and unplugging.	Lift the machine head for 3-5 minutes
E4 (Electric control valve fault detection)	After the inner tank is heated, check whether the water purifier can output water of 45°C and 95°C.	Power on the product again
E5 (Heating timeout protection)	Confirm whether the heating time exceeds 20 minutes	Power on the product again, start the heating function.
E6 (NTC of the inner tank failure)	Confirm whether the inner tank temperature is 0-100°C	Power on the product again, start the heating function.
	Temperature probe failure	Replace the temperature probe
E7 (Low temperature protection)	Raw water inlet temperature is too low (< 3°C)	Stop using the product
	Temperature probe failure	Replace the temperature probe
	Confirm whether the regulating valve is failure	Replace the regulating valve

TROUBLESHOOTING

Fault /Phenomenon	Cause	Solution
E8 (Water supply abnormal/ dry-burning protection)	1. Check whether the connecting pipe is broken; 2. Check whether the connecting pipe is inserted in place; 3. Check whether the notch of the connecting port is flat.	1. Replace the connecting pipe; 2. Reinsert the connecting pipe; 3. Cut the connecting pipe again.
	Check whether the filter is installed properly	Reinstall the filter in place
	Check whether the three-way ball valve is installed properly	Reinstall the three-way ball valve in place.
	Check whether the hot water outputs from the faucet normally	Power on the product again; Turn on the hot water faucet and pour water into the inner tank until water outputs from the faucet stably; Restart the heating function.
E9 (Communication abnormality)	Check whether the faucet and the product connecting cable is installed properly	After disconnecting the power supply, unplug the connecting cable of the faucet and the product and power on again.
Water is split when outputting from the faucet	Debris deposited on the faucet nozzle	Unscrew the faucet nozzle and clean it.
No display on the control panel	Check whether the power supply is connected properly	Re-plug the power supply.
	Check whether the front cover is not installed properly	Reinstall the front cover.
Faucet touch control failure	Check whether the faucet operating interface is dry	Wipe the faucet and keep it dry.
	Check whether there is water or oil on your hand	Keep the hands clean without water or oil.
The water purifier shuts down automatically	Check whether the fault indicator indicates booster pump timeout	Re-plug the power supply.
	Confirm whether the fault indicator indicates frequent start and stop of the booster pump	Confirm that the faucet is completely turns off and there is no water leakage, then power on again.



R3G457
RoHS

Hamton Watertec Co.,Ltd.

委製/進口商/代理商:瀚頓國際貿易有限公司

地址:新北市汐止區中興路86號8樓之1

服務電話:0800-201-666

霍明科技(廣東)有限公司

服務電話:4006309798

地址:廣東省佛山市順德區容桂街道振華社區桂洲大道中海駿達廣場1座35層3501單元

Huoming Technology (Guangdong) Co., Ltd.

Tel: 4006309798

Address: Room 3501, Haijunda Plaza,
Guizhou Avenue, Shunde District, Foshan
City, Guangdong Province

The Honeywell Trademark is used
under license from Honeywell
International Inc.

This product is manufactured by
Huoming Technology (Guangdong)
Co., Ltd.

Honeywell