



DATE: December 12, 2025

TO: Members of Flexible Pavements of Ohio

FROM: Andrew Gall, President & Executive Director

SUBJECT: Exhibitor Information – 2026 OHIO ASPHALT EXPO

Planning is underway for the 2026 Ohio Asphalt Expo held in conjunction with Flexible Pavements of Ohio's (FPO) Annual Meeting on March 17-18, 2026 at the Polaris Hilton Hotel in Columbus, Ohio. Situated at the interchange of Interstate 71 and Polaris Parkway (8700 Lyra Drive, Columbus, 43240), this hotel provides convenient and easy access for customers to visit the trade show as well as great exposure for outdoor exhibitors.

The Ohio Asphalt Expo program includes educational sessions to appeal to all segments of the industry from small contractors to large asphalt producers, governmental and private sector pavement owners, pavement specifiers, and consultant engineers and architects.

Information the indoor and outdoor exhibitor information and layouts are attached. Please note all exhibit layouts are tentative and are subject to revision based upon demand.

The equipment show will be located in the parking area just outside of the conference meeting area. The indoor booth displays will be located in the Polaris & Gemini Foyers (see enclosed diagrams).

Exhibition is limited to members of Flexible Pavements of Ohio whose dues are paid up-to-date as of the date of the 2026 Ohio Asphalt Expo. Exhibit spaces need to be reserved no later than February 27, 2026 to be included in the final program.

Please contact Flexible Pavements of Ohio for additional information at (614) 791-3600 or by e-mail at info@flexiblepavements.org.

**Flexible Pavements of Ohio
2026 OHIO ASPHALT EXPO
Indoor Exhibitor Information**

INDOOR EXHIBIT SPACE - \$600 (\$650 after February 13, 2026)

- Indoor exhibit space includes:
 - One 6' table and two chairs in a 6' by 10' space.
 - One (1) ticket to the following event functions:
 - Chairman's Reception
 - Scholarship Awards Breakfast.

Indoor Exhibit Space Information

- Table top displays are recommended but not required. The dimension of each exhibit space is six feet deep by ten feet wide. The full exhibit must stay within this footprint to accommodate access to break areas and session rooms and location of the exhibit space must not be altered. Indoor exhibitors are limited to one exhibit space.
- Exhibitors may purchase additional tickets to the Scholarship Awards Breakfast at \$65.00 each. Additional Chairman's Reception tickets may be purchased at \$130 each.
- Each exhibitor must provide a first, second and third choice for display location based on the attached indoor exhibit layout. All exhibit areas will be assigned on a first-come first-serve basis upon receipt of payment. FPO will invoice the company for the requested amount; or, if preferred, payment may be made by major credit card. Payment within 14 days of the date of the invoice will be required to confirm the assigned location.
- Electrical service is available but not provided. Please contact the Hilton Columbus/Polaris directly for additional information.

**Flexible Pavements of Ohio
2026 OHIO ASPHALT EXPO
Outdoor Equipment Exhibit Information**

2026 OHIO ASPHALT EXPO Cost of Outdoor Equipment Exhibit Space			
Space Number (See attached)	Area Size (Square feet)	Cost Per Space (Before January 31)	Cost Per Space (After January 31)
1	5,000	\$1,600	\$1,730
2	6,600	\$1,920	\$2,080
3	1,700	\$940	\$1,020
4	2,000	\$1,000	\$1,090
5	3,500	\$1,300	\$1,410
6	3,200	\$1,240	\$1,340
7	3,500	\$1,300	\$1,410
8	3,200	\$1,240	\$1,340
9	1,200	\$840	\$910
10	1,200	\$840	\$910

Outdoor Equipment Exhibit Space Information

- Outdoor exhibit space includes:
 - One (1) ticket to the following event functions:
 - Quality Paving Awards Luncheon
 - Chairman's Reception; and
 - Scholarship Awards Breakfast.
- Exhibitors may purchase additional tickets to the Scholarship & Individual Awards Breakfast at \$65.00 each. Additional Chairman's Reception tickets may be purchased at \$130 each.
- Upon request, FPO will consider combining or sub-dividing outdoor exhibit areas to accommodate exhibitor needs. Revised areas will be priced on the basis of \$600 + \$0.20/sf.
- Each exhibitor must provide a first, second and third choice for display location based on the attached outdoor exhibit layout. All exhibit areas will be assigned on a first-come first-serve basis upon receipt of payment. FPO will invoice the company for the requested amount; or, if preferred, payment may be made by major credit card. Payment within 14 days of the date of the invoice will be required to confirm the assigned location.
- Electric power for the outside exhibits will not be available or provided. It is suggested outdoor exhibitors needing electric power utilize silenced generators.



2026 OHIO ASPHALT EXPO
March 17-18, 2026
Exhibitor Registration Form

INDOOR EXHIBIT SPACE - \$600 (\$650 after February 13, 2026)

Please select a display location in order of preference based on the exhibit layouts. (See attached indoor layout for available spaces.)

First location choice _____ Second location choice _____ Third location choice _____

OUTDOOR EXHIBIT SPACE

Please select a display location in order of preference based on the exhibit layouts. (See Outdoor Equipment Exhibit Information for layout and price information.)

First location choice _____ Second location choice _____ Third location choice _____

EXHIBITOR REGISTRATION

Name _____

Company Name _____

Mailing Address _____

Phone# _____ Fax# _____ E-mail _____

Each exhibit space rental includes (1) ticket each to the Chairman's Reception, Quality Paving Awards Luncheon and Scholarship Breakfast. Additional event tickets may be ordered below:

- Scholarship Breakfast: _____ @ \$65 each
- Chairman's Reception: _____ @ \$130 each

Amount Due for Sponsorship: \$ _____

Amount Due for Exhibit Rental(s): \$ _____

Amount Due for Additional Event Function Tickets: \$ _____

Total Amount Due: \$ _____

FPO will invoice the company for the requested amount; or, if preferred, payment may be made by major credit card or check. If paying by credit card, please provide the following information for credit card payment:

Name on Card: _____

Type of Card: _____ Card No.: _____ Exp. Date: _____

Billing Address: _____

Authorized Signature: _____

Please return completed form to:

Flexible Pavements of Ohio
6205 Emerald Parkway, Suite B
Dublin, OH 43016-3300
Fax (614) 791-4800

Exhibitor Terms & Conditions

- All exhibit areas will be assigned on a first-come first-serve basis on receipt of payment. FPO will invoice the company for the requested amount; or, if preferred, payment may be made by major credit card or check. Payment within 14 days of the date of the invoice will be required to confirm the assigned location.
- Indoor exhibits will be limited in width to 10 feet to accommodate additional exhibitor participation. Depth of the booth will be limited to six feet. Please respect the exhibit space dimensions to ensure unimpeded flow of foot traffic and location of the exhibit space must not be altered. Indoor exhibitors are limited to one exhibit space.
- Electrical power is available for the indoor exhibits directly from the Hilton at an additional charge. Please complete the attached “Exhibitor Service Order Form” and return it to the Hilton. Electric power for the outside exhibits will not be available. It is suggested outdoor exhibitors who need electric power utilize silenced generators.
- FPO will consider combining or sub-dividing outdoor exhibit areas on request to accommodate exhibitor needs. Revised areas will be priced on the basis of \$600 + \$0.20/sf.
- Please exercise extreme caution to avoid damage to Hilton Hotel property. The exhibitor agrees to pay the cost of repairing any damage resulting from the exhibitor’s equipment, display or activities.
- The trade show provides a unique opportunity for member companies to market equipment and services to the Ohio Asphalt industry. Equipment manufacturers, dealers and suppliers who have supported FPO through their membership and earned the right to market their products and services to the membership at large. As such, we are reminding all exhibitors that the subletting of portions of exhibit areas to non-member companies is not permitted. Also we request that when decorating exhibit areas, exhibitors respect other member companies by using their products for decoration purposes or by masking the name or symbol of any materials displayed from non-member companies.
- Set-up for the outdoor exhibits is from 8:00 AM to 6:00 PM on Monday, March 16, 2026. Set-up for the indoor exhibits is 1:00 PM to 5:00 PM on Monday, March 16, 2026 and from 7:00 AM to 8:00 AM on Tuesday, March 17, 2026.
- Exhibit times are from 8:00 AM to 5:00 PM on Tuesday, March 17, 2026 and from 8:00 AM to 12:00 PM on Wednesday, March 18, 2026.
- No additional security will be provided beyond that normally provided by the hotel.
- Nothing may be attached to the walls or any permanent structure contained in the Hilton Hotel.
- The display of equipment may be accommodated indoors by rental of the appropriate display space and satisfying the requirements of the hotel management for moving and displaying equipment.
- No pressure washing service is provided. Exhibitors will have to make their own arrangements or hire a service of their own choosing. A designated area for pressure washing is available at the rear of the hotel building.
- Tent rental is available from O'Neil Awning and Tent at (614) 837-6352. If a tent is desired, exhibitors must make their own arrangements. Tent set up must occur on Monday, March 16, 2026. A fire department permit is required for any tent over 100 sq. ft. If you wish to use a tent of greater than 100 sq. ft., please coordinate with the Hilton Hotel at (614) 885-1600.

Flexible Pavements of Ohio

2026 Ohio Asphalt Expo

March 17 & 18 2026

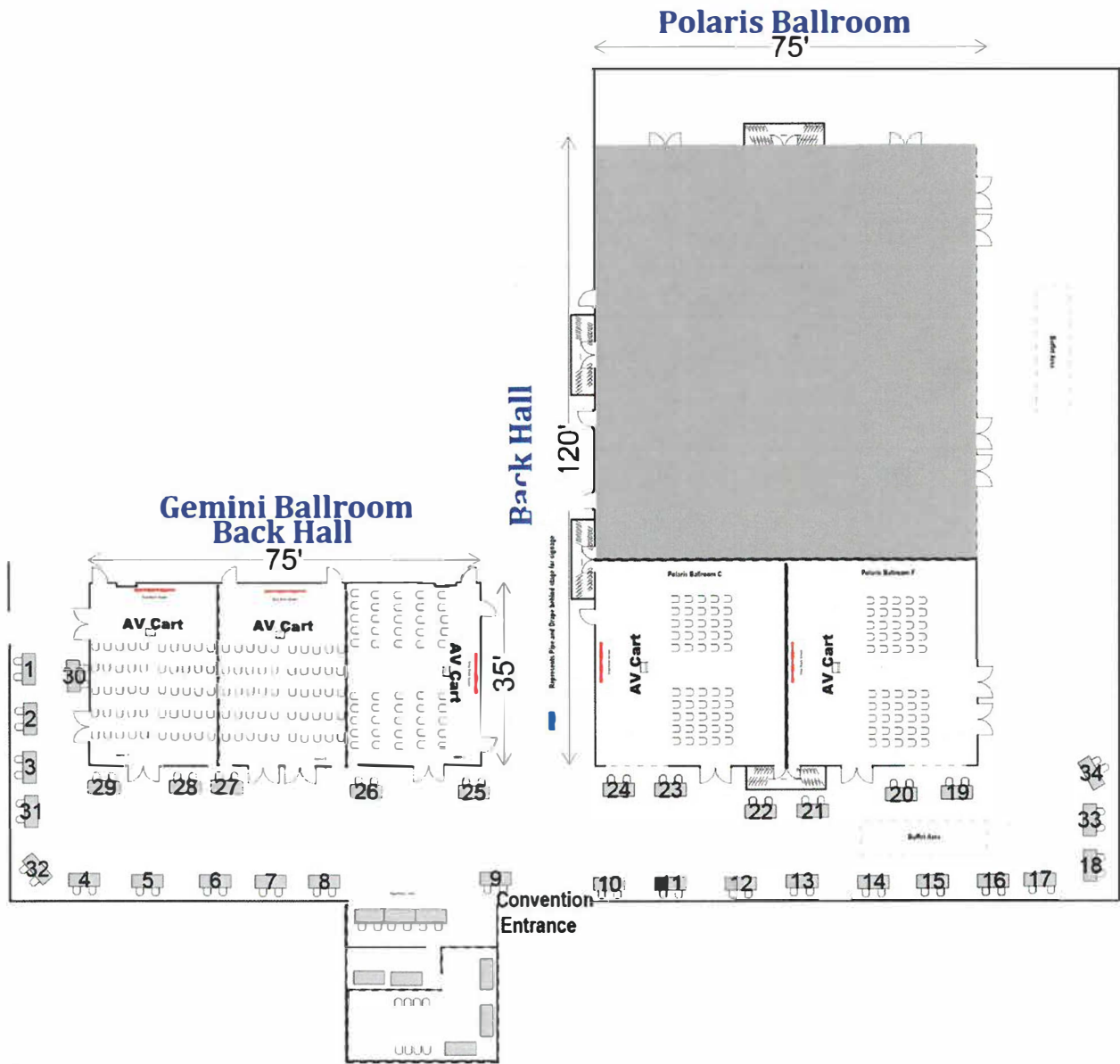

2026 OHIO ASPHALT EXPO
MARCH 17-18, 2026
OUTDOOR EQUIPMENT EXHIBIT SPACE LAYOUT

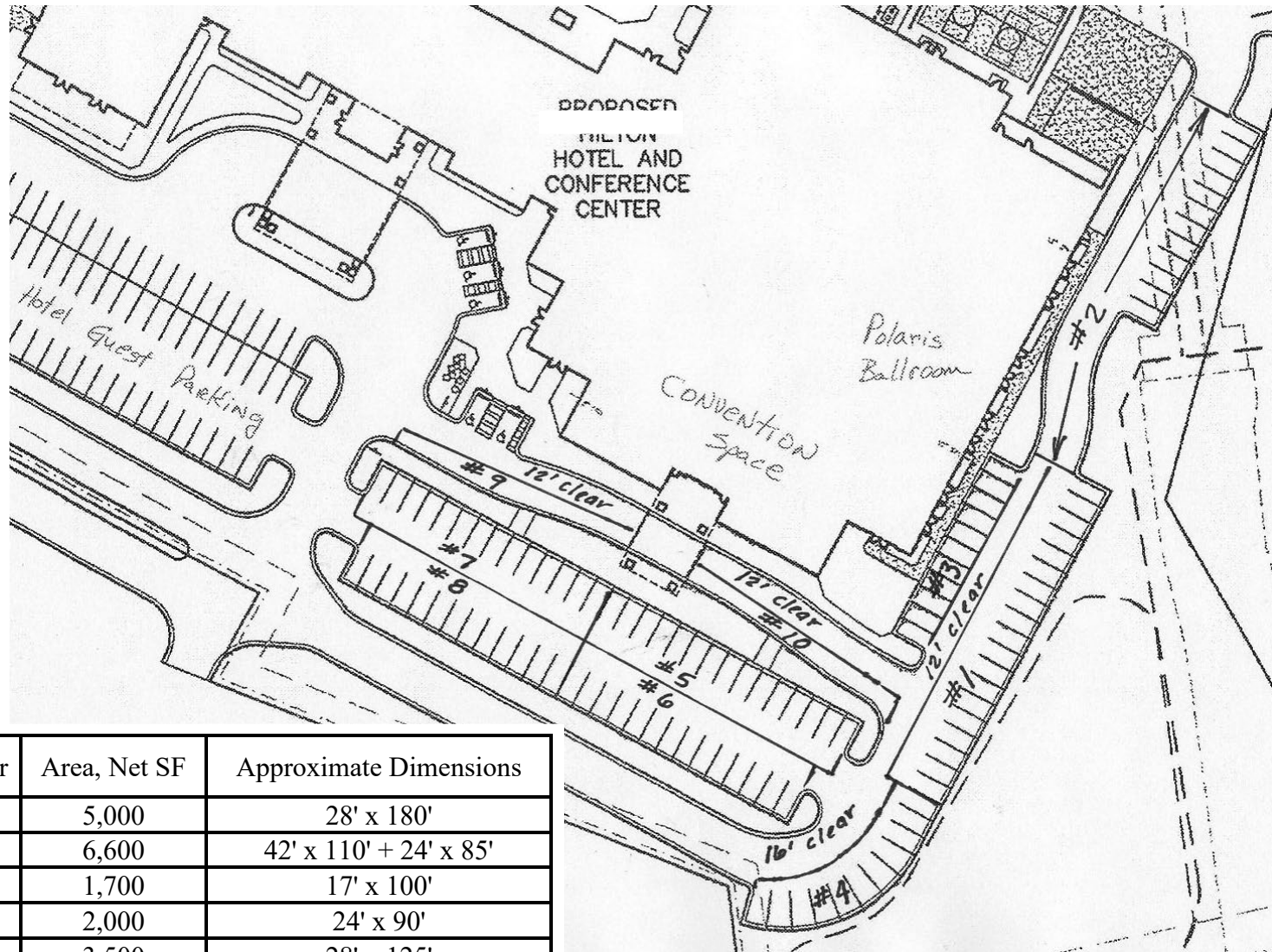

Space Number	Area, Net SF	Approximate Dimensions
1	5,000	28' x 180'
2	6,600	42' x 110' + 24' x 85'
3	1,700	17' x 100'
4	2,000	24' x 90'
5	3,500	28' x 125'
6	3,200	28' x 115'
7	3,500	28' x 125'
8	3,200	28' x 115'
9	1,200	10' x 120'
10	1,200	10' x 120'