

I 20mm ○

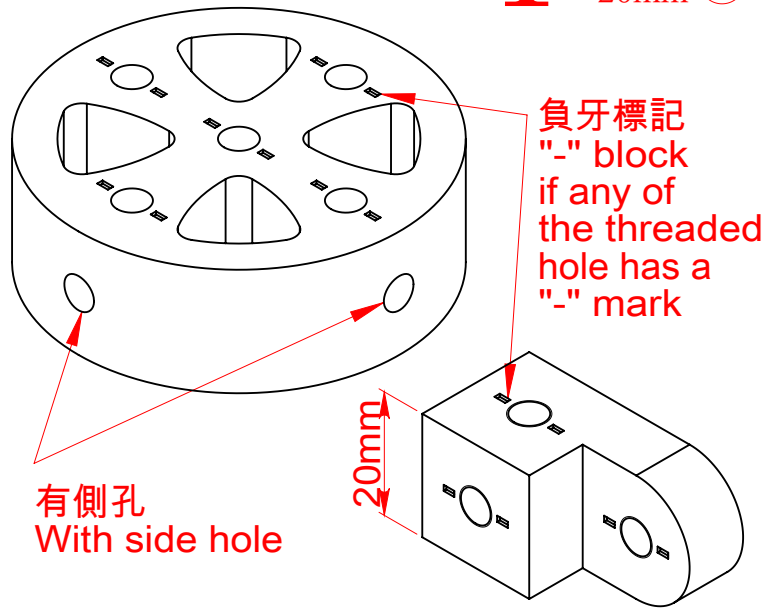

I 20mm ⊗

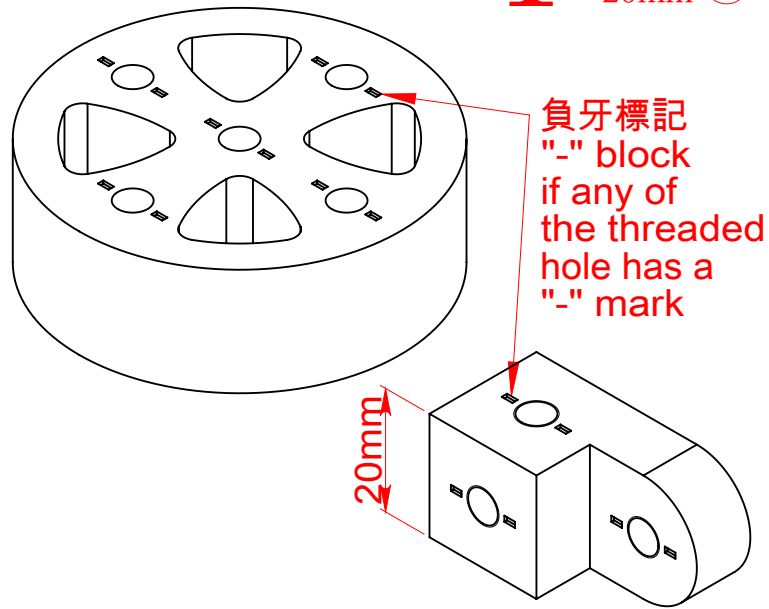

III 10mm

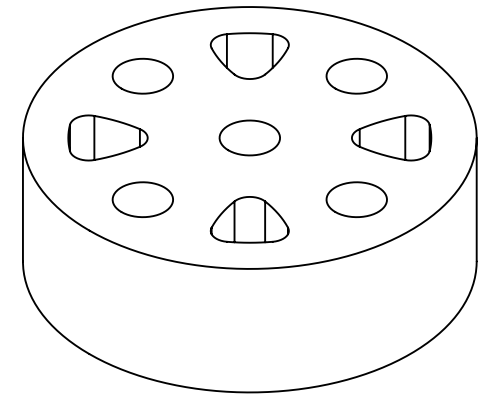

II 15mm ○

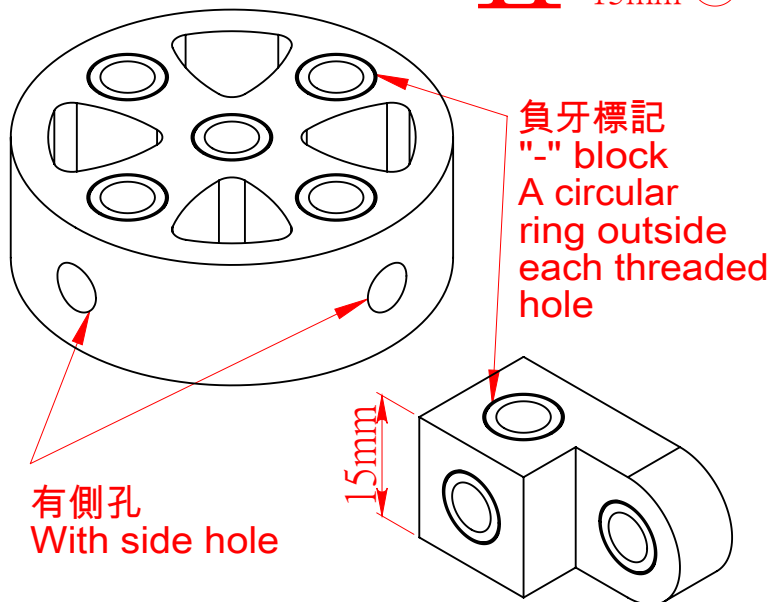

II 15mm ⊗

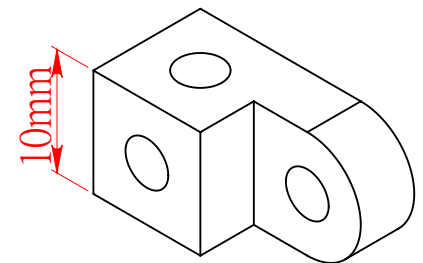
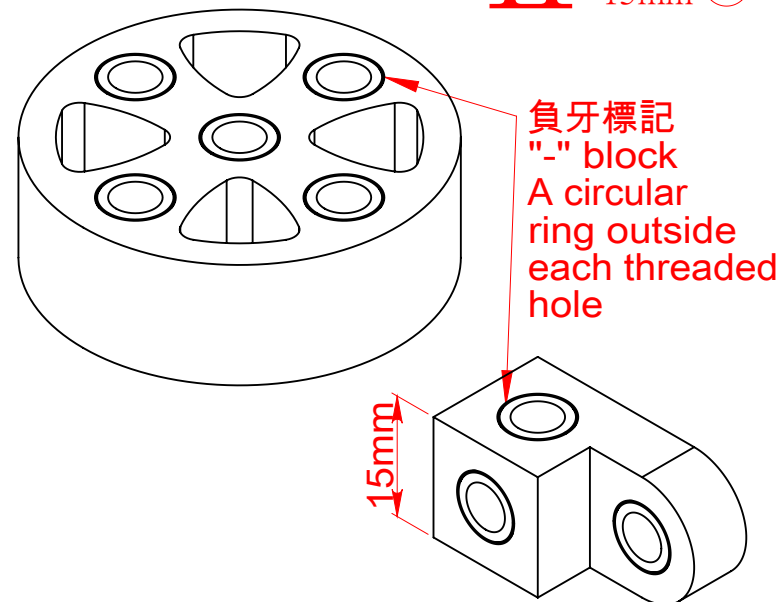

The image displays a sequence of 12 assembly steps for a mechanical model, arranged in a 3x4 grid. Each step is numbered and shows the addition of new components to a growing structure. The components are primarily yellow and grey, with dashed lines indicating the placement of new parts. Arrows show the progression from one step to the next.

- Step 01:** A yellow circular base with four holes is shown. A yellow 1x3 brick is placed on top of it. A white arrow points to the next step.
- Step 02:** A yellow 1x3 brick is placed on top of the yellow 1x3 brick. A white arrow points to the next step.
- Step 03:** A yellow 1x3 brick is placed on top of the yellow 1x3 brick. A white arrow points to the next step.
- Step 04:** A yellow 1x3 brick is placed on top of the yellow 1x3 brick. A white arrow points to the next step.
- Step 05:** A yellow 1x3 brick is placed on top of the yellow 1x3 brick. A white arrow points to the next step.
- Step 06:** A yellow 1x3 brick is placed on top of the yellow 1x3 brick. A white arrow points to the next step.
- Step 07:** A yellow 1x3 brick is placed on top of the yellow 1x3 brick. A white arrow points to the next step.
- Step 08:** A yellow 1x3 brick is placed on top of the yellow 1x3 brick. A white arrow points to the next step.
- Step 09:** A yellow 1x3 brick is placed on top of the yellow 1x3 brick. A white arrow points to the next step.
- Step 10:** A yellow 1x3 brick is placed on top of the yellow 1x3 brick. A white arrow points to the next step.
- Step 11:** A yellow 1x3 brick is placed on top of the yellow 1x3 brick. A white arrow points to the next step.
- Step 12:** A yellow 1x3 brick is placed on top of the yellow 1x3 brick. A white arrow points to the next step.