

Mistica

 1
  1
  55 m²

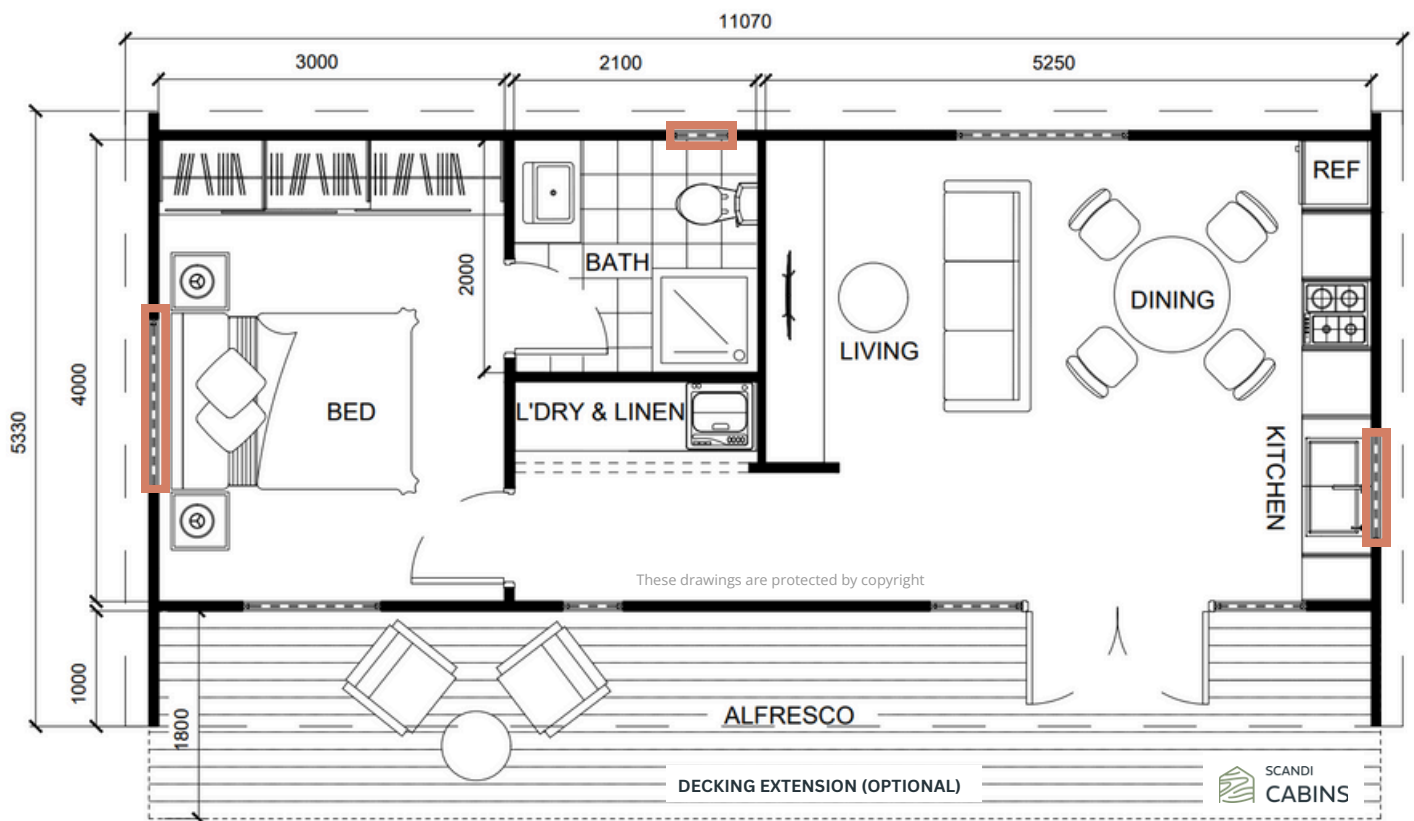

The Mistica 1-bedroom design is a modern and stylish solution for narrow blocks or limited backyard space. With an open-plan living, dining, and kitchen area and ample windows, it creates a bright, spacious feel. This design also features a dedicated laundry room and a generously sized bedroom, making it both practical and comfortable for compact living without sacrificing style.



80

External and internal LGL wall thickness (mm) shown in this drawing



External wall construction: 80mm LGL glulam mass timber walls plus ~120mm insulation and cladding if required



Floor plan can be flipped, must be specified on order



Customizable placement of windows marked red on the floor plan

Features

Mistica



- Ample windows allow natural light
- Open-plan living
- Dedicated laundry room
- Spacious bedroom
- Internal timber creates a cosy and healthy space
- Built on slab or raised subfloor
- Naturally insulated mass timber walls
- Double-glazed windows
- Prefab components built on-site in 4 days^

^on prepared foundation to lockup stage

Get in touch to discuss your project details, receive a rough estimate, or schedule a site inspection with one of our expert builders. Let's bring your dream backyard space to life!

START YOUR PROJECT TODAY

CONTACT US

