

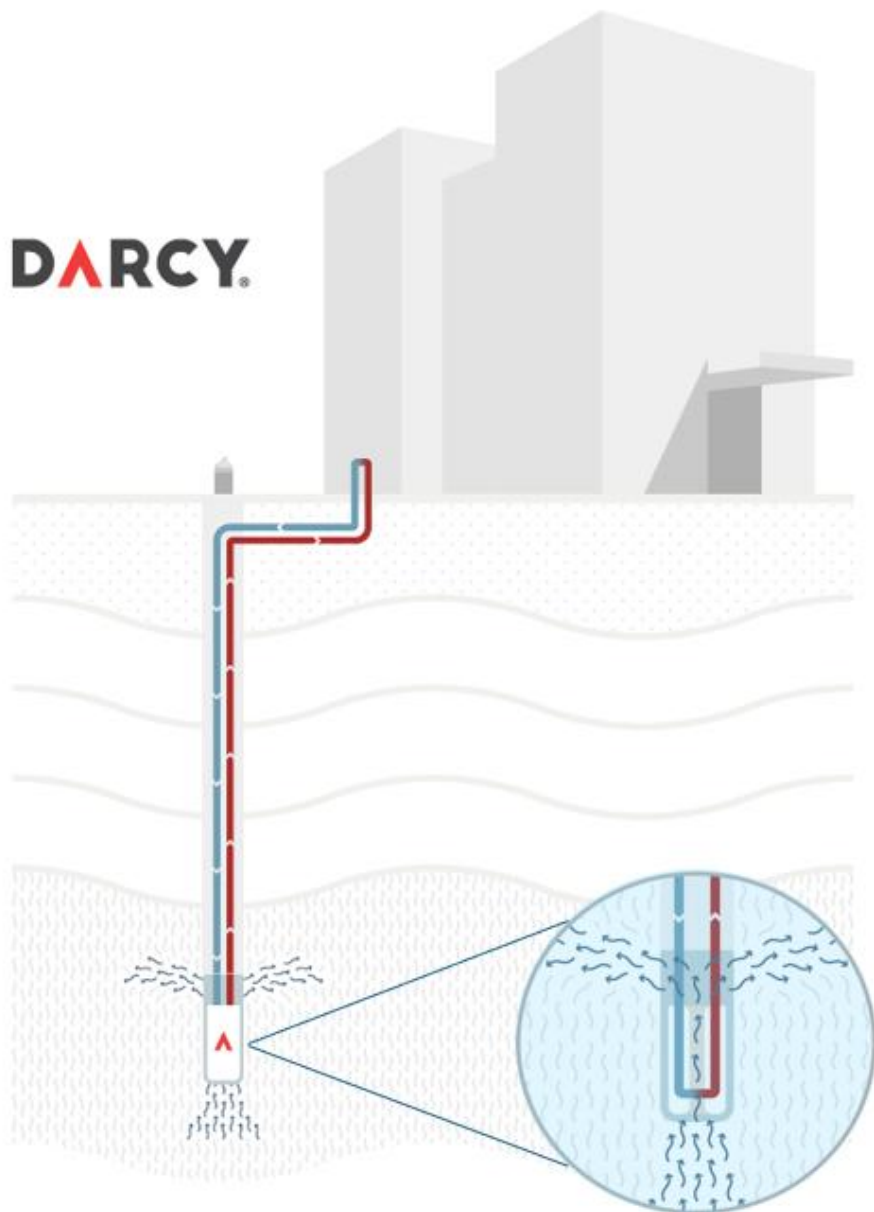

GETTING TO
ZERO
TECH FORUM





Groundwater Enables A New Paradigm for Geothermal.

- ✓ 95% Less Land Mass Required
- ✓ 100x + Energy from a Well
- ✓ Improved CapEx and OpEx

Darcy Geothermal System



Municipal grade 8" or 12" water well construction with standard industry materials



Darcy proprietary heat exchanger placed for optimal performance in aquifer



No water produced or consumed from the well, all circulated via submersible pump remaining in aquifer



Building side loop utilizes water, no glycol



Number of wells scales to meet heating & cooling needs, up to 400 tons and 2400 MBH

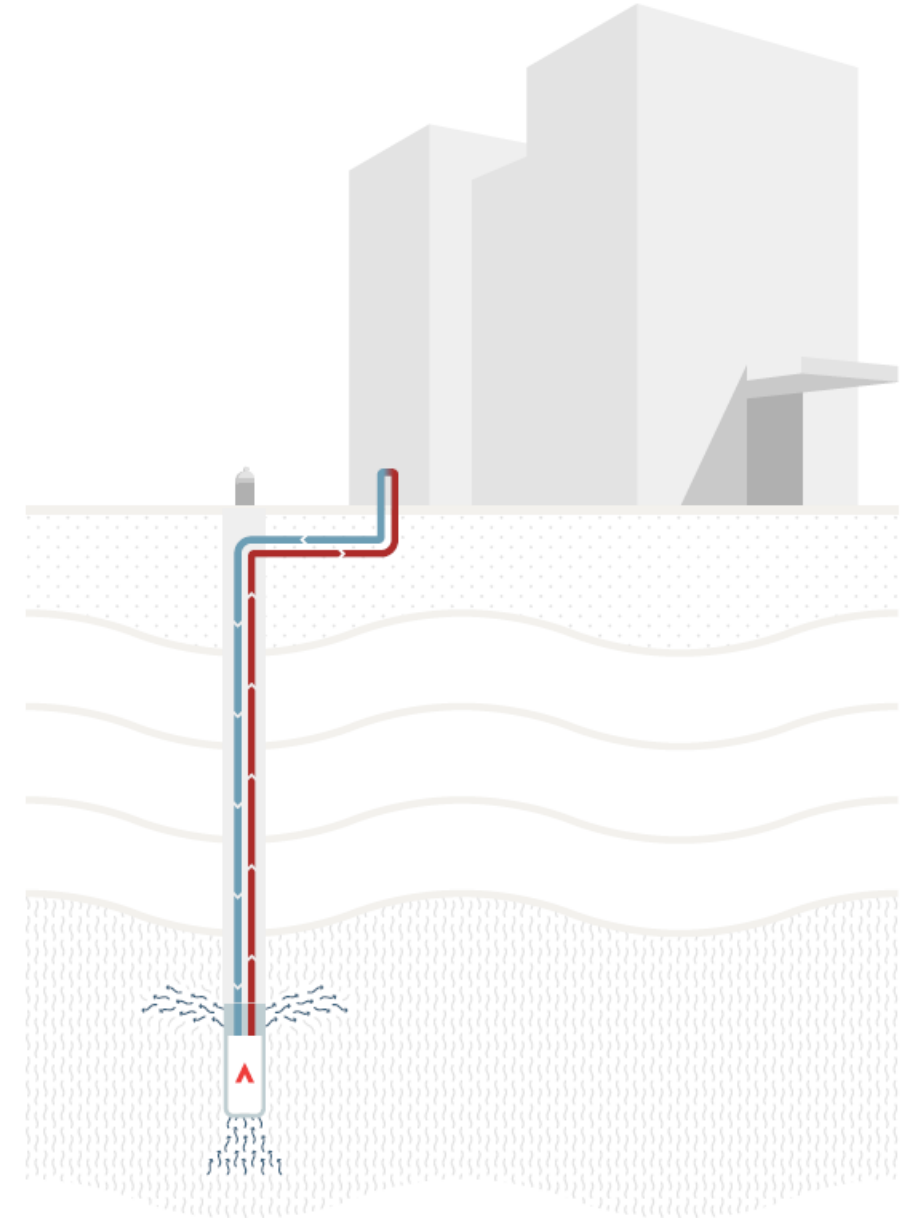

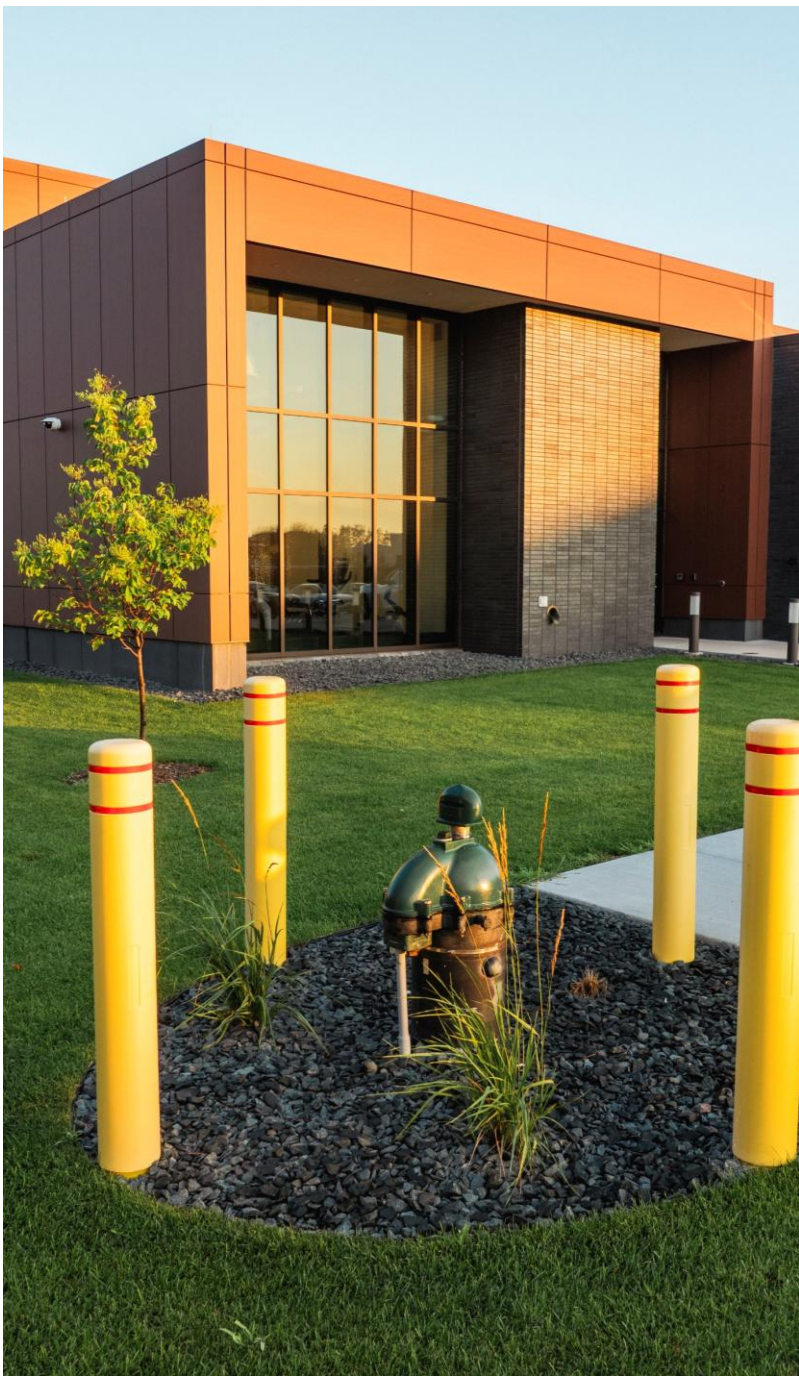

Borefield Land Mass Comparison

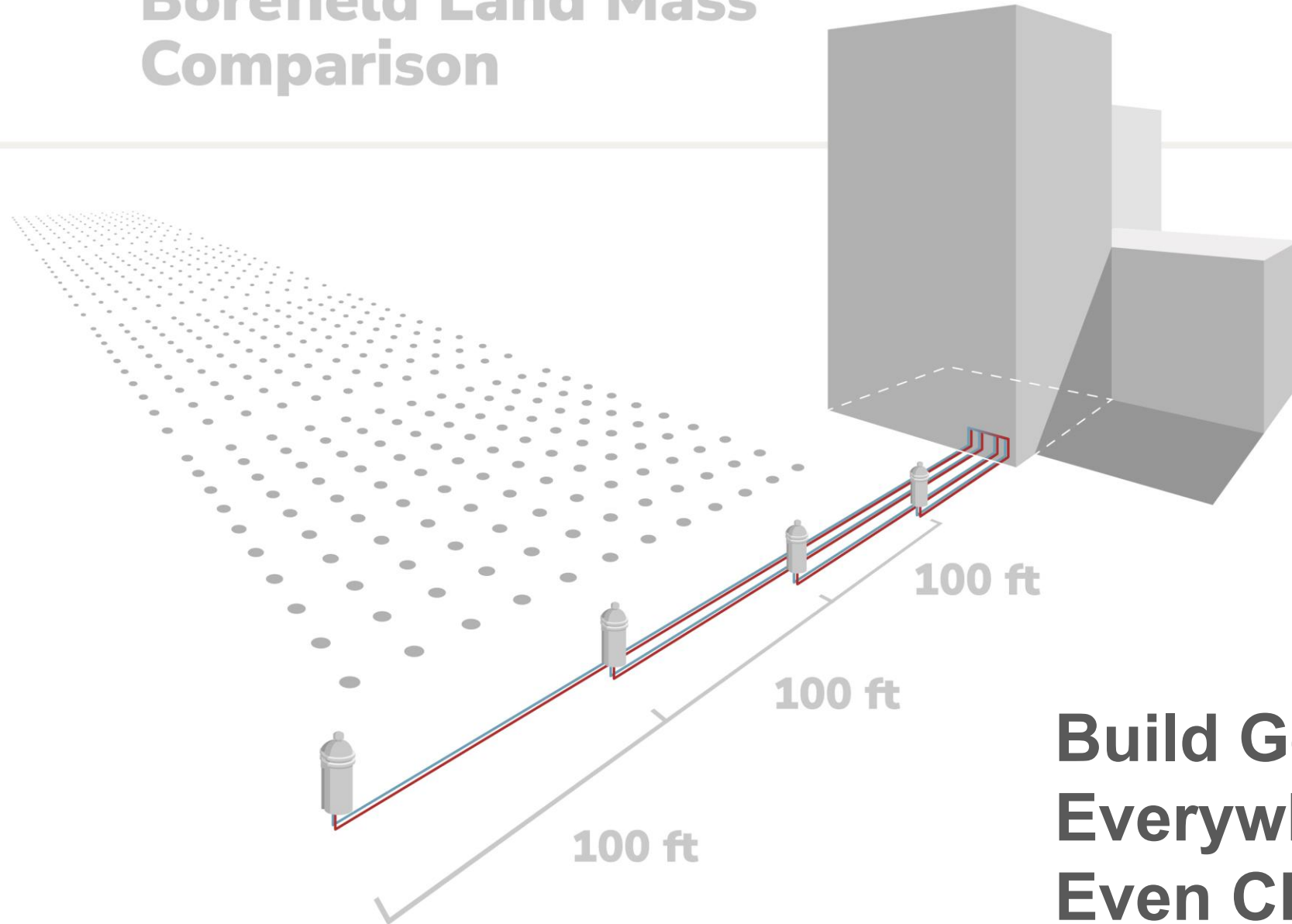

**Build Geothermal
Everywhere.
Even Chicago.**



Installation Advantages

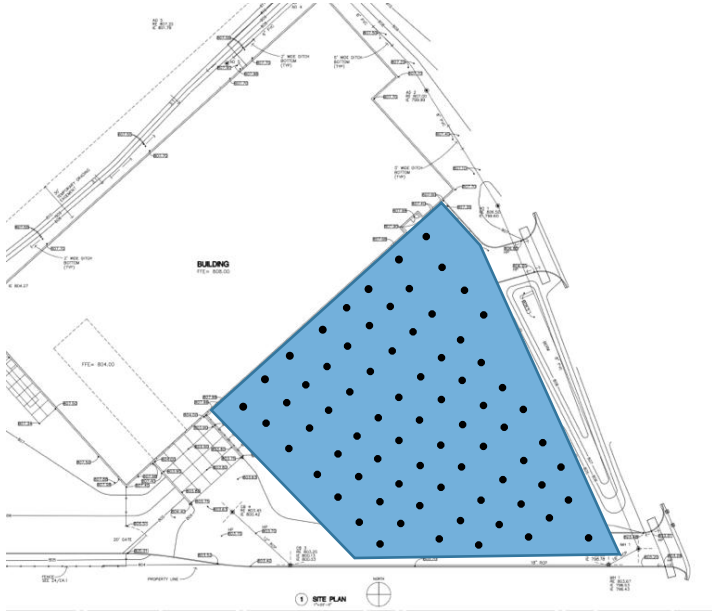

Requires
75-85
boreholes

Traditional geothermal

- Requires removal of entire parking lot
- Maintenance and repairs could require extensive disruption
- Parking lot replacement is expensive, time-consuming and environmentally detrimental



4 Wells
Installed!

Darcy reduces footprint and operational disruption

- Impacts limited to the edge of the parking lot
- System is readily accessible for maintenance and capacity expansion
- Site and business disruption is minimized



What's Next?

- Windy City Representatives is the exclusive partner for Darcy systems in Chicago and Illinois state-wide
- Local engineering support on projects
- Geologic evaluations at no cost, contact:
jforgette@windycityreps.com





GEOFFREY