

MINI

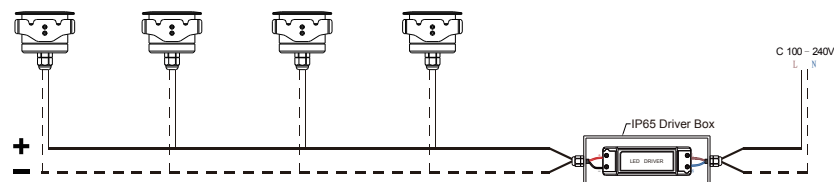

MAXI

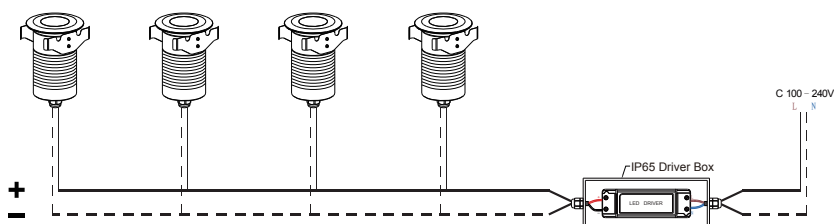

VIGTIGT / IMPORTANT

ATTENTION!

1. Sluk for strømmen ved hovedafbryderen, før installation eller udskiftning af lampe påbegyndes.
2. Tilslut til en 24V forsyning i overensstemmelse med IEE-reglerne.
3. Sørg for, at alle forbindelser er stramme uden løse ledninger.
4. Sørg for, at brandreglerne ikke overtrædes ved montering af dine lamper.

1. Switch off the power at the main switch before commencing installation or lamp replacement.
2. Connect to a 24V supply in accordance with IEE regulations.
3. Ensure all connections are secure with no loose wires.
4. Ensure that fire regulations are not breached when installing your lights.



GROUND E SERIES

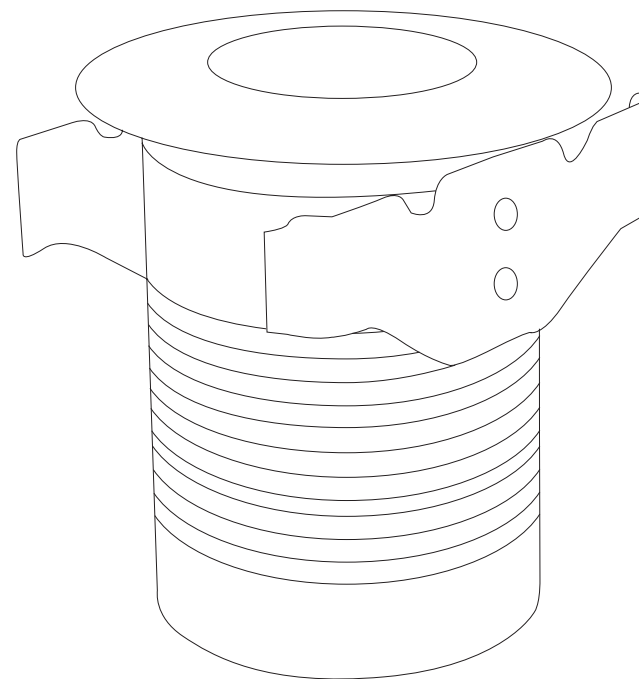

LITE A/S • Østre Fælledvej 11, 9400 Nørresundby
+45 88 72 88 00 • info@lite-led.dk

Målenehed mm / All measurements in mm

GROUND E MINI

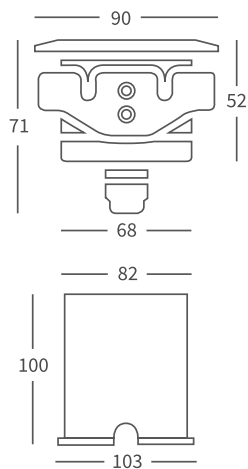

GROUND E MAXI

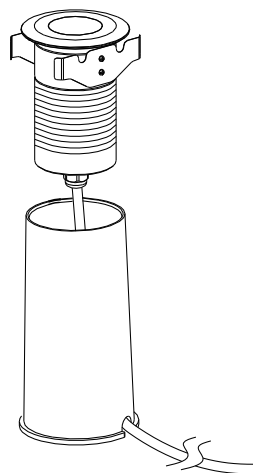
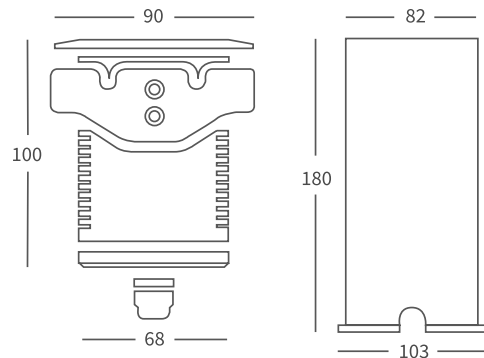

Pre-recessed tube

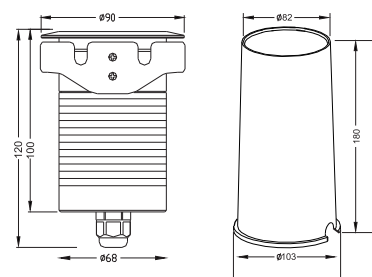

MAXI

MINI

1. Install the pre-recess tube

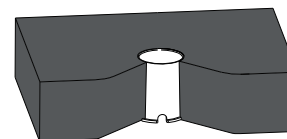

2. Connect the cable to LED driver

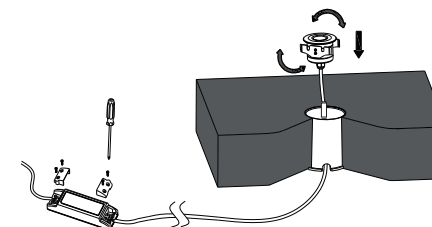

3. Add a connector between LED driver and light engine if the cable is not long enough

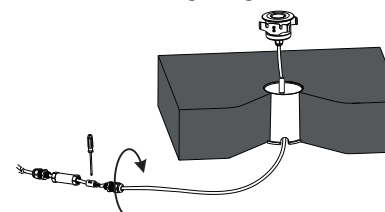

MAXI

1. Install the pre-recess tube

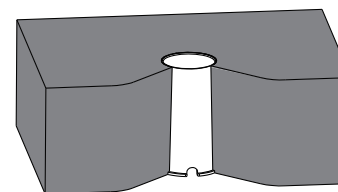

2. Connect the cable

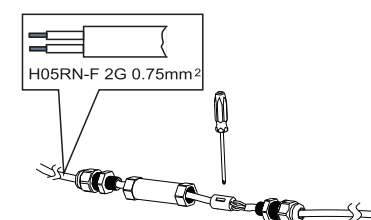

3. Tighten the cable by hand

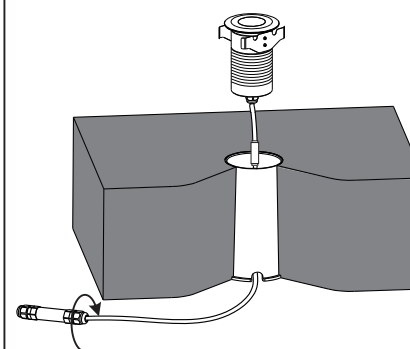

4. Push the whole luminaire in the pre-recess tube

