

Jeanneau DB37 IB



YEAR: 2025 ex demo
TYPE: Sports Coupe
LOA: 11.92m (39'1")
BEAM: 3.55m (11'8")
DRAFT: 1.17m (3'10")
WEIGHT: 7,123 Kg
ENGINE: 2 x Volvo Penta
D4 – 320hp
HOURS: 15 approx.
FUEL: Diesel
FUEL TANK: 690 litres
WATER TANK: 250 litres
BERTHS: 4

PRINCIPAL FEATURES

Comes with new boat warranties, Azure metallic hull wrap, Bow thruster, Volvo Aquamatic joystick, Zipwake auto trim tabs, 2 x Raymarine Axiom+ 12 MFD GPS plotters with fishfinder, Raymarine Ray 90 DSC VHF & AIS700, EVO synthetic teak decking all over, Twin folding side decks, Hi-Lo cockpit table to convert to large sunpad, Foree deck sunpad, Electric anchor windlass with chain counter, Fusion Apollo Bluetooth Stereo with remote and 4 speakers, Cockpit wet bar with BBQ, fridge, pop up lights, sink and storage

LYING: Chichester
PRICE: £431,946 (ex vat)

Description:

Jeanneau expands its DB Yachts line with a second model: the DB/37. Jeanneau reaffirms its ambition to develop the market of premium day boats by meeting the expected codes in this segment while offering unexpected solutions.

t: 01489 886663 m: 07917 148807 e: sales@solentmotoryachts.com
Solent Motor Yachts, Hamble River Boat Yard, Bridge Road, Swanwick, Southampton SO31 7EB



Jeanneau DB37 IB

From day boat, to family fun boat, to cruiser, the DB/37 promises exceptional experiences on the water.

A true entertaining boat, with an optimal interior layout, she also offers the possibility of extended stays onboard... all of this with the stylish allure of elegant lines

Benefiting from all the savoir-faire and creativity of Jeanneau, the DB/37 features a streamlined silhouette designed by Camillo Garroni, with a distinctive personality.

This model perfectly represents the DB Yachts line, upholding the core principles that made the DB/43 a success. The deck plan privileges exterior space and easy movement on board, and while at anchor, side terraces can extend the cockpit toward the sea

On one level, the immense exterior living space fully opens onto the sea. The forward cockpit is easily accessible for taking advantage of the two sun loungers on the forward sundeck.

Guests will fully benefit from the functionality of the central island galley: its large Corian countertop becomes a gathering place for enjoying refreshments and special moments together.

The interior of the DB/37 fulfils all the promises of the DB Yachts line, with refined touches, fine materials, thoughtful details, and a warm atmosphere, all enhanced by natural lighting diffused through vast windows in the hull

The hull designed by Michael Peters Yacht Design features excellent handling. This model is available in an inboard version, with twin Volvo D4-320 engines on sterndrives with aquamatic joystick she is a true delight to handle to make even a beginner look like a professional....

Inviting and protective, the DB/37 is designed for you to fully benefit from the sea, to experience and share unforgettable moments.

Part exchanges will be considered.

Contact Derek or Richard to arrange a viewing today.

Specification and equipment:

- Construction: GRP
- Hull Colour: custom 'Azure Metallic' wrap
- Drive Type: Inboard

t: 01489 886663 m: 07917 148807 e: sales@solentmotoryachts.com
Solent Motor Yachts, Hamble River Boat Yard, Bridge Road, Swanwick, Southampton SO31 7EB

Solent Motor Yachts normally acts as a broker for the vendor who unless otherwise stated is not acting in the course of a business. Whilst every care has been taken in the preparation of these particulars the correctness is not guaranteed and they are intended as a guide only and do not constitute a part of any contract. A prospective buyer is strongly advised to check these particulars and where appropriate and at his own expense to employ a qualified marine surveyor to carry out a survey and/or to have an engine trial conducted which if conducted by Solent Motor Yachts shall not imply any liability on our part.



Jeanneau DB37 IB

- Maximum Speed: 33 knots (approx.)
- Cruising Speed: 22 knots (approx.)
- Hull: Planing

2 x Volvo Penta D4 – 320hp diesel engines on outdrives with only 15 hours and yet to be commissioned so come with full warranty

Volvo Penta Aquamatic joystick

Bow thruster

Zipwake automatic trim tabs

Full Inventory:

- Custom hull wrap in 'Azure Metallic'
- Custom exterior canvas enclosure to maximise usage and maintain the striking looks for the DB37
- Mooring Kit
- Anchoring Kit with stainless steel anchor
- Removable swim ladder for lateral terrace
- Wood cockpit table with telescopic legs for sundeck macadamia white
- Fridge 49L in the breakfast point
- Microwave oven 230V in the breakfast point
- Vitroceramic Hob 220v 50hz in the cockpit galley
- Synthetic EVO teak decking

Packs

Comfort Pack:

- Direct plug for fresh water at the dock
- Leather-covered cockpit handrails
- Venetian blinds in the aft cabin, in lieu of the curtains
- 2 retractable ambient lights in the cockpit galley

Trim Level Premiere Macadamia Pack:

- Ventilation Pack: opening deck hatch and 2nd porthole starboard in the front cabin, 2nd porthole in the head
- Ambiance Pack: LED lights exterior steps + indirect interior LED lights
- 2 lateral electrical terraces (portside and starboard)
- Windlass control with chain counter at the helm station
- Fusion BB100 + remote control + 4 loudspeakers FUSION "FM SERIES" in the cockpit

t: 01489 886663 m: 07917 148807 e: sales@solentmotoryachts.com
Solent Motor Yachts, Hamble River Boat Yard, Bridge Road, Swanwick, Southampton SO31 7EB

Solent Motor Yachts normally acts as a broker for the vendor who unless otherwise stated is not acting in the course of a business. Whilst every care has been taken in the preparation of these particulars the correctness is not guaranteed and they are intended as a guide only and do not constitute a part of any contract. A prospective buyer is strongly advised to check these particulars and where appropriate and at his own expense to employ a qualified marine surveyor to carry out a survey and/or to have an engine trial conducted which if conducted by Solent Motor Yachts shall not imply any liability on our part.



Jeanneau DB37 IB

- Set of PVC Stamoid white covers for: helm station, 3 seats pilot and copilots, cockpit galley and cockpit benches
- Stainless steel bow protection
- 2 aft cockpit spotlights
- Movable backrest of the sliding cockpit bench
- Tilting backrest of the aft bench (transverse sunbed)

Upgraded Raymarine Electronic Pack:

- 2 screens AXIOM+ 12 RV
- Transducer CPTS
- Wifi connectivity for control from a tablet or a smartphone
- Cartography included (Europe, North America or Rest of the world)
- Volvo engine information display
- RAY90 DSC VHF
- AIS700 transceiver

Accommodation:

SLEEPS FOUR IN TWO CABINS

Master Cabin:

- Forward master cabin with double island bed
- Large hanging wardrobe on the port side
- Vanity station with backlit mirror
- Cupboards and storage on the starboard side
- LED mood lighting in cabin
- Large hull windows

Aft Cabin:

- Aft cabin with two single beds and infill to form partly a double bed
- Hanging wardrobe on port side
- Storage unit on starboard side
- Large mirror at the head of bed
- LED mood lighting in cabin

Breakfast Point:

- 49L fridge
- Microwave oven 230v
- Opening drawers

Heads:

- Marine toilet with holding tank
- Separate shower compartment
- Opening porthole

t: 01489 886663 m: 07917 148807 e: sales@solentmotoryachts.com
Solent Motor Yachts, Hamble River Boat Yard, Bridge Road, Swanwick, Southampton SO31 7EB

Solent Motor Yachts normally acts as a broker for the vendor who unless otherwise stated is not acting in the course of a business. Whilst every care has been taken in the preparation of these particulars the correctness is not guaranteed and they are intended as a guide only and do not constitute a part of any contract. A prospective buyer is strongly advised to check these particulars and where appropriate and at his own expense to employ a qualified marine surveyor to carry out a survey and/or to have an engine trial conducted which if conducted by Solent Motor Yachts shall not imply any liability on our part.



Jeanneau DB37 IB

Images:



t: 01489 886663 m: 07917 148807 e: sales@solentmotoryachts.com
Solent Motor Yachts, Hamble River Boat Yard, Bridge Road, Swanwick, Southampton SO31 7EB

Solent Motor Yachts normally acts as a broker for the vendor who unless otherwise stated is not acting in the course of a business. Whilst every care has been taken in the preparation of these particulars the correctness is not guaranteed and they are intended as a guide only and do not constitute a part of any contract. A prospective buyer is strongly advised to check these particulars and where appropriate and at his own expense to employ a qualified marine surveyor to carry out a survey and/or to have an engine trial conducted which if conducted by Solent Motor Yachts shall not imply any liability on our part.



Jeanneau DB37 IB



t: 01489 886663 m: 07917 148807 e: sales@solentmotoryachts.com
Solent Motor Yachts, Hamble River Boat Yard, Bridge Road, Swanwick, Southampton SO31 7EB

Solent Motor Yachts normally acts as a broker for the vendor who unless otherwise stated is not acting in the course of a business. Whilst every care has been taken in the preparation of these particulars the correctness is not guaranteed and they are intended as a guide only and do not constitute a part of any contract. A prospective buyer is strongly advised to check these particulars and where appropriate and at his own expense to employ a qualified marine surveyor to carry out a survey and/or to have an engine trial conducted which if conducted by Solent Motor Yachts shall not imply any liability on our part.



Jeanneau DB37 IB



t: 01489 886663 m: 07917 148807 e: sales@solentmotoryachts.com
Solent Motor Yachts, Hamble River Boat Yard, Bridge Road, Swanwick, Southampton SO31 7EB

Solent Motor Yachts normally acts as a broker for the vendor who unless otherwise stated is not acting in the course of a business. Whilst every care has been taken in the preparation of these particulars the correctness is not guaranteed and they are intended as a guide only and do not constitute a part of any contract. A prospective buyer is strongly advised to check these particulars and where appropriate and at his own expense to employ a qualified marine surveyor to carry out a survey and/or to have an engine trial conducted which if conducted by Solent Motor Yachts shall not imply any liability on our part.



Jeanneau DB37 IB



t: 01489 886663 m: 07917 148807 e: sales@solentmotoryachts.com
Solent Motor Yachts, Hamble River Boat Yard, Bridge Road, Swanwick, Southampton SO31 7EB

Solent Motor Yachts normally acts as a broker for the vendor who unless otherwise stated is not acting in the course of a business. Whilst every care has been taken in the preparation of these particulars the correctness is not guaranteed and they are intended as a guide only and do not constitute a part of any contract. A prospective buyer is strongly advised to check these particulars and where appropriate and at his own expense to employ a qualified marine surveyor to carry out a survey and/or to have an engine trial conducted which if conducted by Solent Motor Yachts shall not imply any liability on our part.



Jeanneau DB37 IB



t: 01489 886663 m: 07917 148807 e: sales@solentmotoryachts.com
Solent Motor Yachts, Hamble River Boat Yard, Bridge Road, Swanwick, Southampton SO31 7EB

Solent Motor Yachts normally acts as a broker for the vendor who unless otherwise stated is not acting in the course of a business. Whilst every care has been taken in the preparation of these particulars the correctness is not guaranteed and they are intended as a guide only and do not constitute a part of any contract. A prospective buyer is strongly advised to check these particulars and where appropriate and at his own expense to employ a qualified marine surveyor to carry out a survey and/or to have an engine trial conducted which if conducted by Solent Motor Yachts shall not imply any liability on our part.



Jeanneau DB37 IB



t: 01489 886663 m: 07917 148807 e: sales@solentmotoryachts.com
Solent Motor Yachts, Hamble River Boat Yard, Bridge Road, Swanwick, Southampton SO31 7EB

Solent Motor Yachts normally acts as a broker for the vendor who unless otherwise stated is not acting in the course of a business. Whilst every care has been taken in the preparation of these particulars the correctness is not guaranteed and they are intended as a guide only and do not constitute a part of any contract. A prospective buyer is strongly advised to check these particulars and where appropriate and at his own expense to employ a qualified marine surveyor to carry out a survey and/or to have an engine trial conducted which if conducted by Solent Motor Yachts shall not imply any liability on our part.

Jeanneau DB37 IB

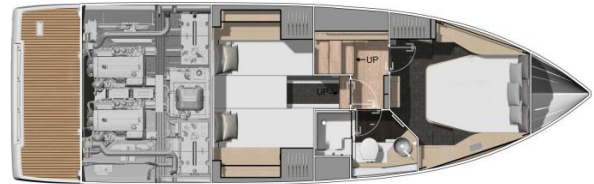

t: 01489 886663 m: 07917 148807 e: sales@solentmotoryachts.com
Solent Motor Yachts, Hamble River Boat Yard, Bridge Road, Swanwick, Southampton SO31 7EB

Solent Motor Yachts normally acts as a broker for the vendor who unless otherwise stated is not acting in the course of a business. Whilst every care has been taken in the preparation of these particulars the correctness is not guaranteed and they are intended as a guide only and do not constitute a part of any contract. A prospective buyer is strongly advised to check these particulars and where appropriate and at his own expense to employ a qualified marine surveyor to carry out a survey and/or to have an engine trial conducted which if conducted by Solent Motor Yachts shall not imply any liability on our part.