

Sealine 310 Statesman



YEAR: 1992
TYPE: Flybridge
LOA: 34.1'
BEAM: 10.5'
DRAFT: 2.9'
WEIGHT: 4,200 Kg
ENGINE: 2 x Volvo Penta
 431 DP 205hp
HOURS: TBC
FUEL: Petrol
FUEL TANK: 552L
WATER TANK: 230L
BERTHS: 6

PRINCIPAL FEATURES

New Port Engine 2019, Rebuilt Port Drive, Re-Upholstered exterior upholstery, Lowrance HDS7 GPS plotters to both helms, Vespa AIS, Raymarine radar to lower helm, Depth and Speed, Icom DSC VHF at lower helm and command mic at fly helm, nmeA2000 Backbone with Quark NMEa0183 WiFi, New Lewmar Windlass with SS Anchor, SS Tender davits, JVC KW-R520 radio/MP3/CD player with new internal and external speakers, Logik TV with DVD in saloon

LYING: Hamble River Boat Yard
PRICE: £46,995 (tax paid)

Description:

This iconic Sealine 310 Statesman 'Flybridge Cruiser' has been recently restored, and benefits from 'Flexiteek' decking on the flybridge, transom, aft deck, with steps which are tastefully complemented by 'Champagne' Silvertex upholstery. This restoration results in a modern up to date feel throughout the vessel, which features a generous aft cockpit, ample seating and steps leading to the flybridge helm, The aft deck sliding patio door provides access to the well-equipped galley located next to the spacious saloon which also converts into an additional guest's double berth. The cruiser has a forward d/b master cabin, with a second cabin to port

t: 01489 886663 m: 07917 148807 e: sales@solentmotoryachts.com
 Solent Motor Yachts, Hamble River Boat Yard, Bridge Road, Swanwick, Southampton SO31 7EB



Sealine 310 Statesman

which also offers a d/b sleeping space for friends and family. There is separate head compartment equipped with hot and cold shower, sink and head. This 310 Statesman has been fully maintained and cared by the current owners and is powered by twin inboard Volvo Penta engines and drives with fully integrated Lowrance navigation and is being offered as one of the best examples of this renowned Sealine Flybridge Cruiser on the market.

Contact Derek or Richard to arrange a viewing a today.

Specification and equipment:

- Construction: GRP
- Hull Colour: White
- Drive Type: Z out drive
- Maximum Speed: 28 knots (approx.)
- Cruising Speed: 24 knots (approx.)
- Hull: Planing

CONSTRUCTION

GRP hull and deck
Built/Sold Sept -1992 – UK VAT Original Sales INVOICE
Sealine 310 Statesman
LOA 10.39m
Beam 3.2m
Draft 0.89m

Last lifted/Antifouled and Anodes - September 2024

MECHANICAL

2x Volvo Penta 4.3L V6 431A 205hp Inboard petrol engines - (New Port Engine 2019)
2x Volvo Penta 290A DP Outdrives – (Rebuilt Port Drive – 2024 by Volvo Dealer)
Full engine instrumentation
SS Morse MT3 Dual Helm Controls with Mechanical Lower helm Switch
Trim tabs – New Eltrim Controls (2023)

Tanks

1x Water 230L
2x 276L Fuel tanks (552L in total)

t: 01489 886663 m: 07917 148807 e: sales@solentmotoryachts.com
Solent Motor Yachts, Hamble River Boat Yard, Bridge Road, Swanwick, Southampton SO31 7EB

Solent Motor Yachts normally acts as a broker for the vendor who unless otherwise stated is not acting in the course of a business. Whilst every care has been taken in the preparation of these particulars the correctness is not guaranteed and they are intended as a guide only and do not constitute a part of any contract. A prospective buyer is strongly advised to check these particulars and where appropriate and at his own expense to employ a qualified marine surveyor to carry out a survey and/or to have an engine trial conducted which if conducted by Solent Motor Yachts shall not imply any liability on our part.



Sealine 310 Statesman

ELECTRICAL

Shore power connection and lead
4x Batteries Domestic/Engine with isolator switches
Charged via engine alternators or by battery charger when on shore power
Battery charger (new 2019)
240v sockets with 12v USB2 in Lounge & Bedrooms
Water heater
TV antenna – with amplifier to Saloon & Master Bedroom.

NAVIGATION

DUAL HELM NAVIGATION HEADS
Lowrance HDS7 Gen3 Master - Lower helm
Lowrance HDS7m Gen2 Touch – Flybridge
Vespa XB6000 AIS
iCom M423DSC VHF radio – Lower helm with Command mic on Flybridge
NMEA2000 Backbone and Quark NMEA0183 Bi-directional wifi
All the above - fully integrated

2x 'Richie' Compass – Flybridge & Lower helm
Raymarine ST6000 Log/Temp & Speed – Flybridge & Lower helm
Raymarine Analogue Radar
Navigation lights

DECK

Mooring lines
Fenders
Lewmar V1 Electric Anchor Windlass (fitted 2023)-Dual helm Control
SS Anchor with galvanised chain and rope
Cockpit shower
Aft black cockpit canopy – (reglazed 2024)
Flybridge black tonneau cover
Twin Horn – Dual helm control
Windscreen wipers
SS Tender davits

t: 01489 886663 m: 07917 148807 e: sales@solentmotoryachts.com
Solent Motor Yachts, Hamble River Boat Yard, Bridge Road, Swanwick, Southampton SO31 7EB

Solent Motor Yachts normally acts as a broker for the vendor who unless otherwise stated is not acting in the course of a business. Whilst every care has been taken in the preparation of these particulars the correctness is not guaranteed and they are intended as a guide only and do not constitute a part of any contract. A prospective buyer is strongly advised to check these particulars and where appropriate and at his own expense to employ a qualified marine surveyor to carry out a survey and/or to have an engine trial conducted which if conducted by Solent Motor Yachts shall not imply any liability on our part.



Sealine 310 Statesman

4x Fender Basket - Transom
Additional fender storage in Anchor Locker – Foredeck
Overhead lighting in Radar Arch
Transom lighting (blue) to stern
X2 Sealine SS Davit ARMs (Not shown but as New).
Outboard Bracket on transom

SAFETY

Fire extinguishers throughout
Electric bilge pump
Manual bilge pump
Carbon monoxide alarm
Fire Alarm

ACCOMMODATION

Forward Master Cabin

Large double berth
Ocean Air dual blackout and flyscreen to hatch
Storage underneath berth
Hanging Wardrobe
Vanity unit with mirror
Shelving
Side Lights with x2 single 240v/USB2 Sockets
x2 - 240v Double Sockets and TV aerial socket
12v Ceiling Lights

Guest Cabin

Double berth
Seat
Hanging wardrobe (with light)
Mirror
Reading light
240v Double/USB2 Socket
Carbon Monoxide Alarm

t: 01489 886663 m: 07917 148807 e: sales@solentmotoryachts.com
Solent Motor Yachts, Hamble River Boat Yard, Bridge Road, Swanwick, Southampton SO31 7EB

Solent Motor Yachts normally acts as a broker for the vendor who unless otherwise stated is not acting in the course of a business. Whilst every care has been taken in the preparation of these particulars the correctness is not guaranteed and they are intended as a guide only and do not constitute a part of any contract. A prospective buyer is strongly advised to check these particulars and where appropriate and at his own expense to employ a qualified marine surveyor to carry out a survey and/or to have an engine trial conducted which if conducted by Solent Motor Yachts shall not imply any liability on our part.



Sealine 310 Statesman

Heads

Jabsco Manual - Sea Toilet
Washbasin with hot and cold water
Shower – with removable carpet mat
Sea Start Sanitation Odour Unit
Mirrors
Shower drain pump

Galley

Sink and hot and cold pressurised tap
Rose LPG gas oven and grill
Oregon 2-burner gas hob
Angel fridge/freezer dual voltage 240v/12v
Storage cupboards & Cutlery Draw

Saloon

U-shaped dining area to port
Helm Seat
Drop Table with Insert to convert to Bedroom 3 - Double
Aft and side pencil blinds
Privacy Curtains on Patio Door
JVC CD/Stereo Radio
Twin Speakers
Clock and barometer
Logik TV with integrated DVD
Fire Alarm

Aft cockpit

L-shaped seating area – **Re-upholstered (2023)**
Flexiteek Decking – (2022)
Table with cupholders
Ladder to flybridge
Access to engine room
Gate to bathing platform
LPG Storage cupboard

t: 01489 886663 m: 07917 148807 e: sales@solentmotoryachts.com
Solent Motor Yachts, Hamble River Boat Yard, Bridge Road, Swanwick, Southampton SO31 7EB

Solent Motor Yachts normally acts as a broker for the vendor who unless otherwise stated is not acting in the course of a business. Whilst every care has been taken in the preparation of these particulars the correctness is not guaranteed and they are intended as a guide only and do not constitute a part of any contract. A prospective buyer is strongly advised to check these particulars and where appropriate and at his own expense to employ a qualified marine surveyor to carry out a survey and/or to have an engine trial conducted which if conducted by Solent Motor Yachts shall not imply any liability on our part.

Sealine 310 Statesman

Flybridge – Re-upholstered (2023)

Double helm seat

Double passenger seat

Flexiteek Decking – (2022)

Twin Speakers

Dual Station Windlass Controls

Images:



t: 01489 886663 m: 07917 148807 e: sales@solentmotoryachts.com
Solent Motor Yachts, Hamble River Boat Yard, Bridge Road, Swanwick, Southampton SO31 7EB

Solent Motor Yachts normally acts as a broker for the vendor who unless otherwise stated is not acting in the course of a business. Whilst every care has been taken in the preparation of these particulars the correctness is not guaranteed and they are intended as a guide only and do not constitute a part of any contract. A prospective buyer is strongly advised to check these particulars and where appropriate and at his own expense to employ a qualified marine surveyor to carry out a survey and/or to have an engine trial conducted which if conducted by Solent Motor Yachts shall not imply any liability on our part.

Solent
MOTOR YACHTS
on your wavelength

Sealine 310 Statesman



t: 01489 886663 m: 07917 148807 e: sales@solentmotoryachts.com
Solent Motor Yachts, Hamble River Boat Yard, Bridge Road, Swanwick, Southampton SO31 7EB

Solent Motor Yachts normally acts as a broker for the vendor who unless otherwise stated is not acting in the course of a business. Whilst every care has been taken in the preparation of these particulars the correctness is not guaranteed and they are intended as a guide only and do not constitute a part of any contract. A prospective buyer is strongly advised to check these particulars and where appropriate and at his own expense to employ a qualified marine surveyor to carry out a survey and/or to have an engine trial conducted which if conducted by Solent Motor Yachts shall not imply any liability on our part.



Sealine 310 Statesman



t: 01489 886663 m: 07917 148807 e: sales@solentmotoryachts.com
Solent Motor Yachts, Hamble River Boat Yard, Bridge Road, Swanwick, Southampton SO31 7EB

Solent Motor Yachts normally acts as a broker for the vendor who unless otherwise stated is not acting in the course of a business. Whilst every care has been taken in the preparation of these particulars the correctness is not guaranteed and they are intended as a guide only and do not constitute a part of any contract. A prospective buyer is strongly advised to check these particulars and where appropriate and at his own expense to employ a qualified marine surveyor to carry out a survey and/or to have an engine trial conducted which if conducted by Solent Motor Yachts shall not imply any liability on our part.

Solent
MOTOR YACHTS
on your wavelength

Sealine 310 Statesman



t: 01489 886663 m: 07917 148807 e: sales@solentmotoryachts.com
Solent Motor Yachts, Hamble River Boat Yard, Bridge Road, Swanwick, Southampton SO31 7EB

Solent Motor Yachts normally acts as a broker for the vendor who unless otherwise stated is not acting in the course of a business. Whilst every care has been taken in the preparation of these particulars the correctness is not guaranteed and they are intended as a guide only and do not constitute a part of any contract. A prospective buyer is strongly advised to check these particulars and where appropriate and at his own expense to employ a qualified marine surveyor to carry out a survey and/or to have an engine trial conducted which if conducted by Solent Motor Yachts shall not imply any liability on our part.

Sealine 310 Statesman



t: 01489 886663 m: 07917 148807 e: sales@solentmotoryachts.com
Solent Motor Yachts, Hamble River Boat Yard, Bridge Road, Swanwick, Southampton SO31 7EB

Solent Motor Yachts normally acts as a broker for the vendor who unless otherwise stated is not acting in the course of a business. Whilst every care has been taken in the preparation of these particulars the correctness is not guaranteed and they are intended as a guide only and do not constitute a part of any contract. A prospective buyer is strongly advised to check these particulars and where appropriate and at his own expense to employ a qualified marine surveyor to carry out a survey and/or to have an engine trial conducted which if conducted by Solent Motor Yachts shall not imply any liability on our part.

Sealine 310 Statesman

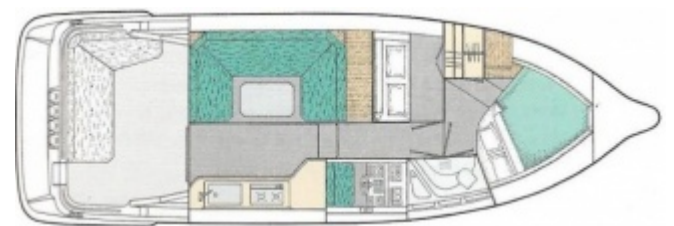
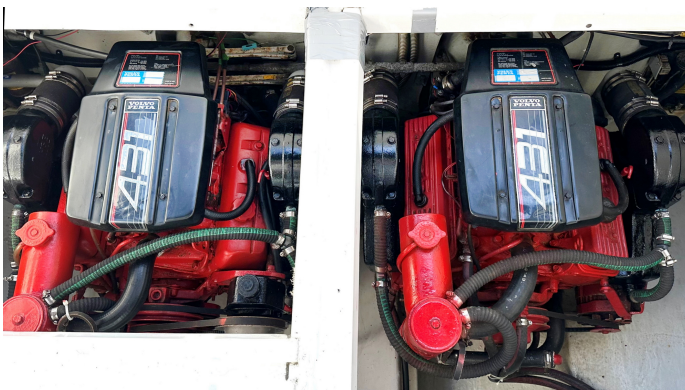
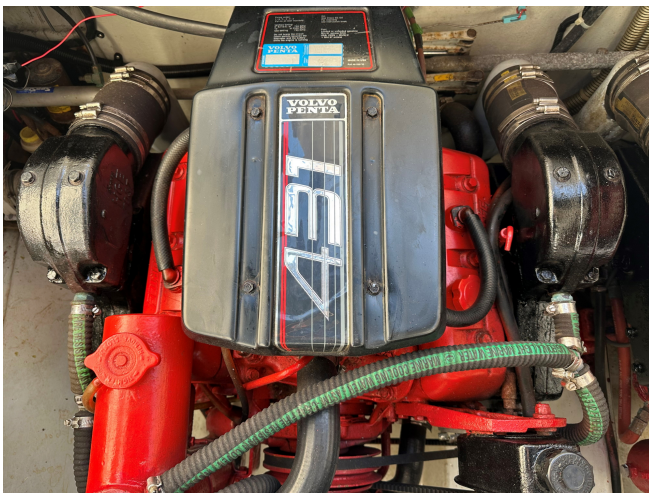

t: 01489 886663 m: 07917 148807 e: sales@solentmotoryachts.com
Solent Motor Yachts, Hamble River Boat Yard, Bridge Road, Swanwick, Southampton SO31 7EB

Solent Motor Yachts normally acts as a broker for the vendor who unless otherwise stated is not acting in the course of a business. Whilst every care has been taken in the preparation of these particulars the correctness is not guaranteed and they are intended as a guide only and do not constitute a part of any contract. A prospective buyer is strongly advised to check these particulars and where appropriate and at his own expense to employ a qualified marine surveyor to carry out a survey and/or to have an engine trial conducted which if conducted by Solent Motor Yachts shall not imply any liability on our part.