

More Flexible, More Durable



OKW120



Detail Reflects Quality

The new OKW12Q mini excavator has many advantages, it is very compact, making it easy to work in narrow spaces. A more scientific operator operation layout, a more comfortable driving experience, and improved work efficiency.



Agriculture



Demolish



Forestry



Engineering



Landscaping



Pipeline



Construction site



Optional: • Side swing • Chassis extension

OKW12Q Product Introduction

Service and performance

The new mini excavator uses the AE simulation analysis system upward-facing arm, increasing the excavation depth from 1500mm to 1800mm compared to other similar products.

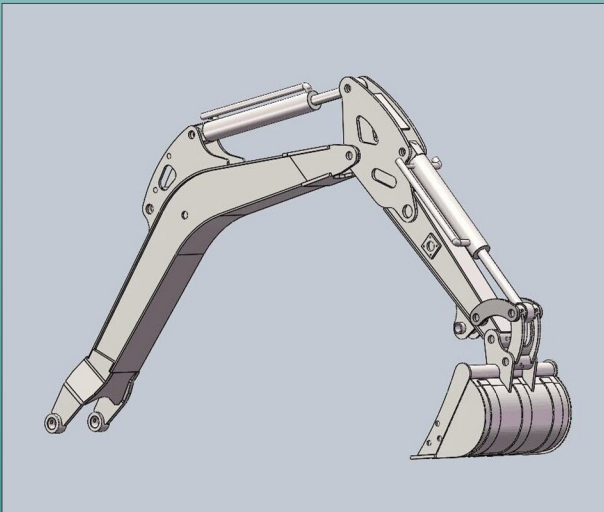

Adjustable track gauge

Adjustable track gauge, from 840mm to 960mm. One-button adjustment, convenient and fast.

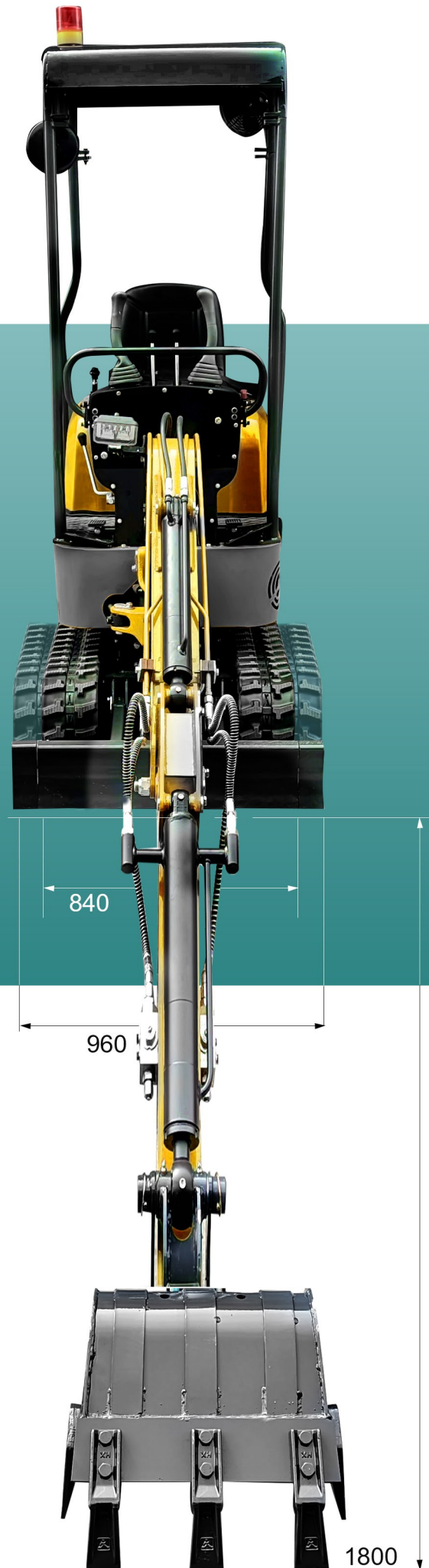

Safety and comfort



New LED boom working light

Can not stop working due to the dark night.



Visibility seat belt

The red seat belt buckle is a visual reminder from the field safety personnel to remind the operator to fasten the seat belt before the engine starts.



Engine compartment

Fully open engine cover for easy maintenance. Easy access to the engine and protected hydraulic service port piping. How secure is it? Antitheft lock protection. Full opening hood with upward tilting operation of the hood exposes most of the engine, making parts more accessible.



Specifications

Model		OKW12Q
Engine	rated power	8.6Kw
	fuel tank capacity	5L
	Standard bucket width	400mm
	Maximum digging force	9KN
	Hydraulic pump	Shimadzu
	Hydraulic flow	18L/min
	Work pressure	20Mpa
Appearance	Swing speed	8
	Walking speed	2
	Climbing angle	30°
	Ground voltage	28Kpa
	Maximum digging depth	1800mm
	Maximum digging distance	3100mm
	Maximum vertical arm digging depth	1700mm
Hydraulic pressure system	Maximum digging height	2800mm
	Maximum unloading height	2000mm
	Minimum turning radius	1400mm
	Chassis width	850mm
	Dozer blade height and width	220*850mm
	Dimensions	3010*850*1520mm
	Track width	180mm

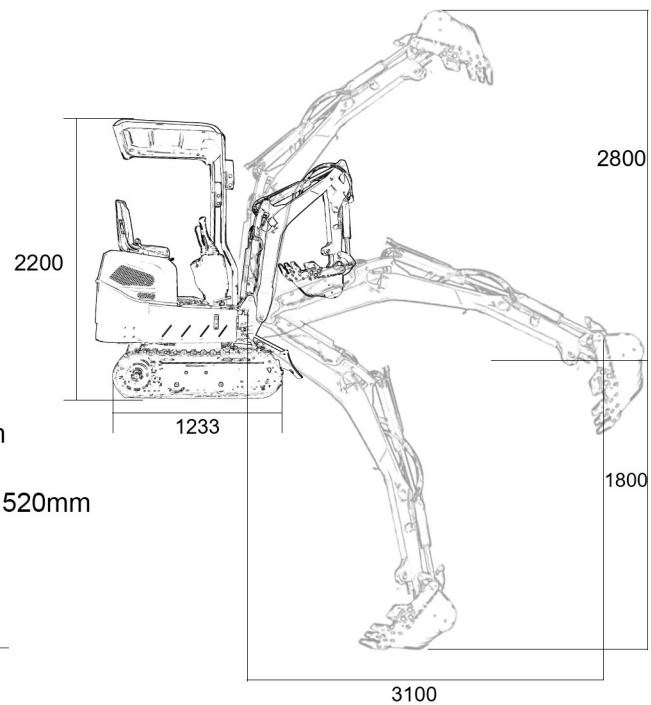
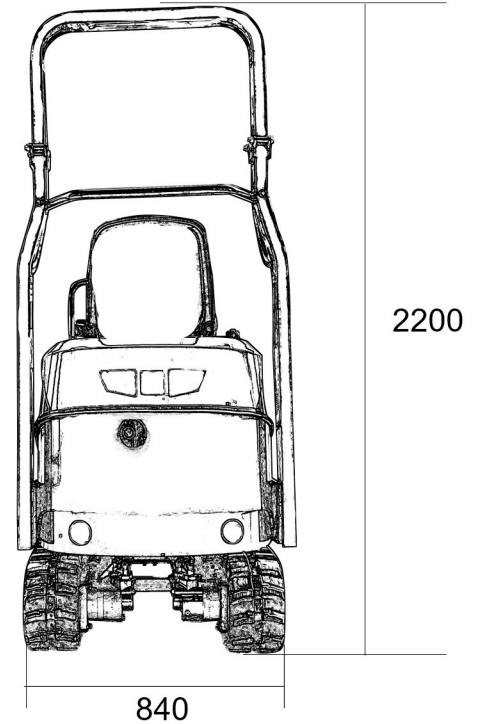

Jining Nicosail Machinery Co., Ltd.

Website: //www.nicosail.com/ Email: Bob<admin@nicosail.com> Address: Jining Nicosail Machinery Co., Ltd.
cn,Room 2004, Block C, Haineng International, Jinyu Road, Jining City, Shandong Province