

NOTE:  
FLOAT GAUGE IS AN OPPTIONAL ADDER.  
NOT INCLUDED IN STANDARD USED - OIL & ANTI - FREEZE ASSEMBLIES.

PART NUMBER	
220 GALLON GEMINI	YELLOW/BLACK
LPE SD (1.5)	01-35088

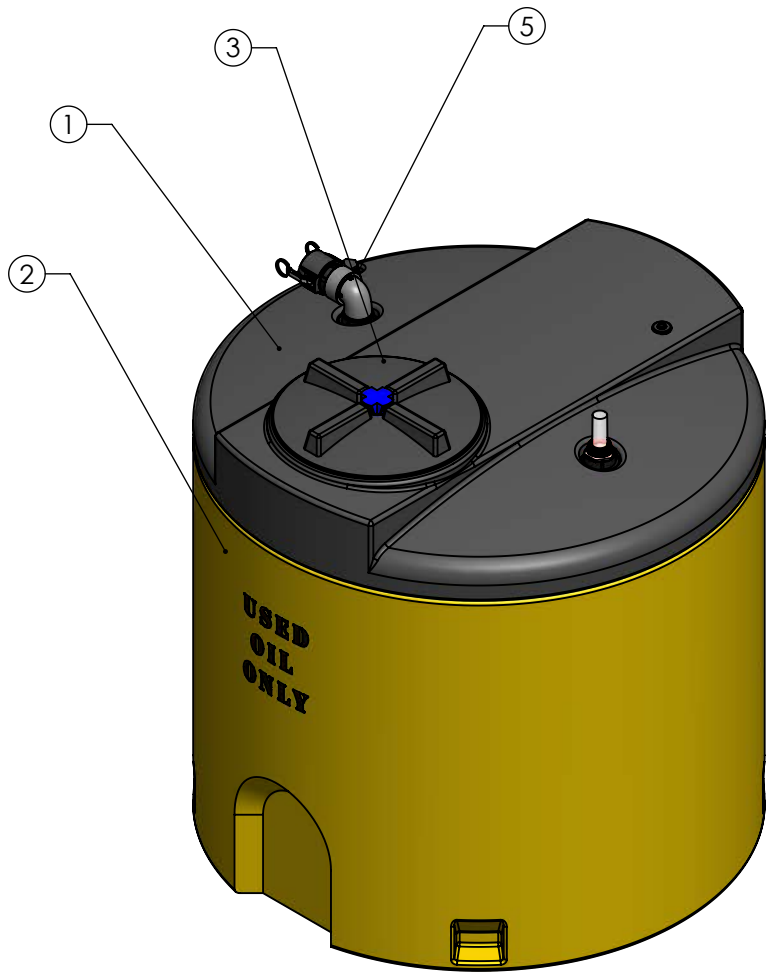

ISOMETRIC VIEW  
ASSEMBLED

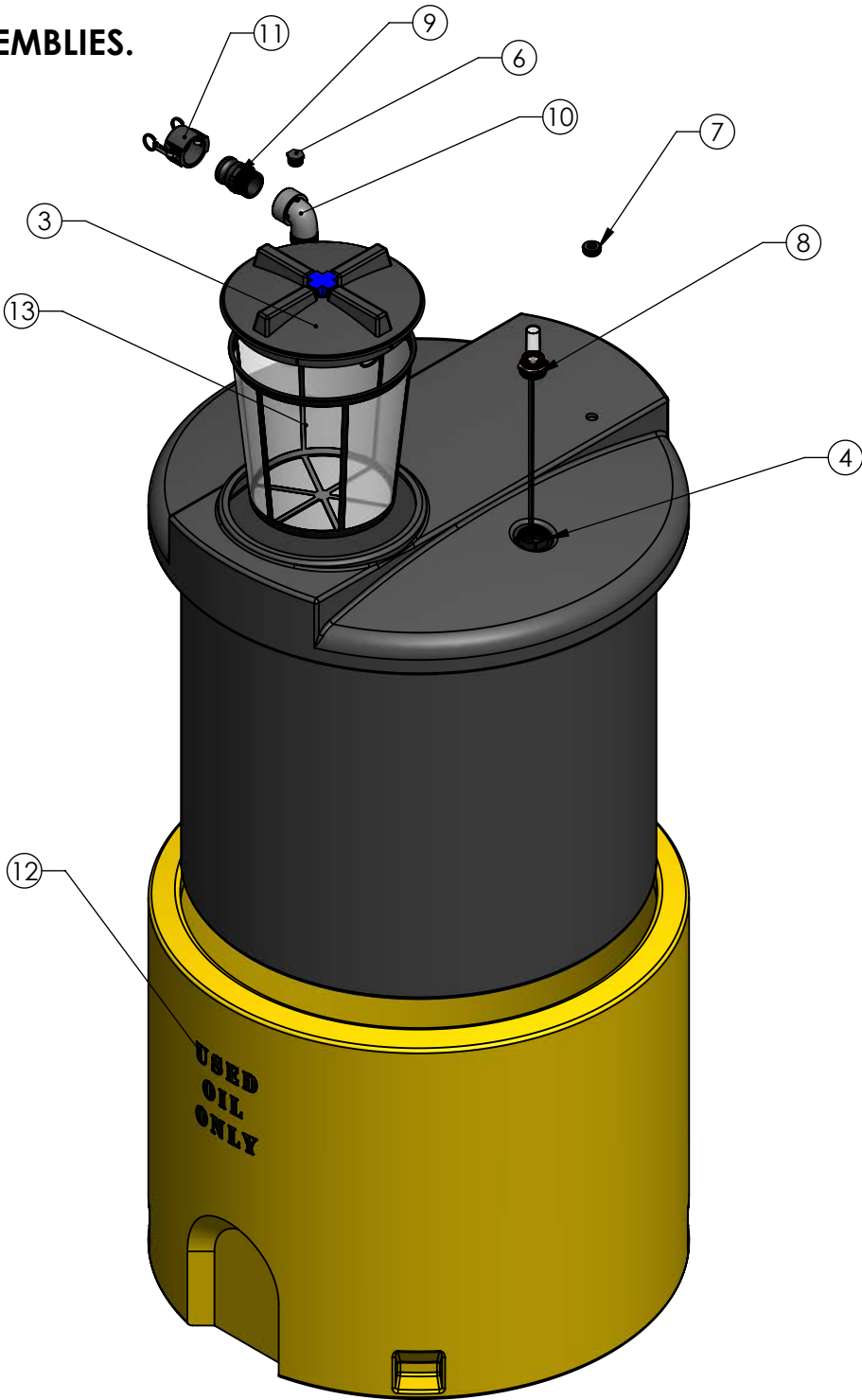

ISOMETRIC VIEW  
EXPLODED

ALTERNATE CONFIGURATION TO MEET  
NSF/ANSI STANDARD 61 AVAILABLE

TOP LEVEL ASSEMBLY		
ITEM NO.	DESCRIPTION	QTY.
1	GEMINI 220G, PRIMARY TANK	1
2	GEMINI 220G, SECONDARY TANK	1
3	Ø 16" ID (18" OD) VENTED TWIST LID ASSEMBLY	1
4	Ø2" FNPT SPIN WELD FITTING, PE	2
5	Ø1" FNPT SPIN WELD FITTING, PE	1
6	Ø1" PLUG, MPT, PE, BLACK	1
7	Ø1-5/8" CAPPLUG / GROMMET ASSY	1
8	Ø2" FLOAT GAUGE	1
9	1" TYPE F ADAPTER, PP, BLACK	1
10	2" 90° STREET ELBOW, PPL	1
11	Ø2" DUST CAP	1
12	STENCIL	2
13	Ø8" SEDIMENT SCREEN	1

- NOTES:
- CAPACITY: 220 GAL. NOMINAL
  - APPROXIMATE WEIGHT: 195 LBS
  - TANK MATERIAL: LLDPE W/ UV INHIBITOR
  - GASKETS: EPDM
  - SERVICE PRESSURE: ATMOSPHERIC

PROPRIETARY AND CONFIDENTIAL  
THE INFORMATION CONTAINED IN THIS  
DRAWING IS THE SOLE PROPERTY OF  
PEABODY ENGINEERING. ANY  
REPRODUCTION IN PART OR AS A WHOLE  
WITHOUT THE WRITTEN PERMISSION OF  
PEABODY ENGINEERING IS  
PROHIBITED.

UNLESS OTHERWISE SPECIFIED:		NAME	DATE	HPTC-35088-PB	
DIMENSIONS ARE IN INCHES TOLERANCES: ±1/4" ANGULAR: ± .5° ONE PLACE DECIMAL ± .3" TWO PLACE DECIMAL ± .13" THREE PLACE DECIMAL ± .063"		DRAWN	JO	08/8/23	PROJECT: GEMINI DUAL CONTAINMENT TANKS
TANK MATERIAL: HDPE		CHECKED			CUSTOMER:
INNER TANK S/N:		ENG APPR.			SITE/LOCATION:
OUTER TANK S/N:		MFG APPR.			SALES ORDER#: SEE TABLE
CUSTOMER PO#		Q.A.			SIZE B
DO NOT SCALE DRAWING		ALTERNATIVE VERSIONS		DESC. 220 GALLON GEMINI TANK, 48" x 48"	
		MATERIALS: XLPE, PPL, PVDF COLORS: NATURAL, BLUE OR BLACK AVAILABLE WITH FRP WRAP		REV. -	
		CALL FOR PART NUMBERS		SCALE: 1:10	
				LAST SAVED: Monday, September 16, 2024 3:04:38 PM	
				SHEET 1 OF 2	

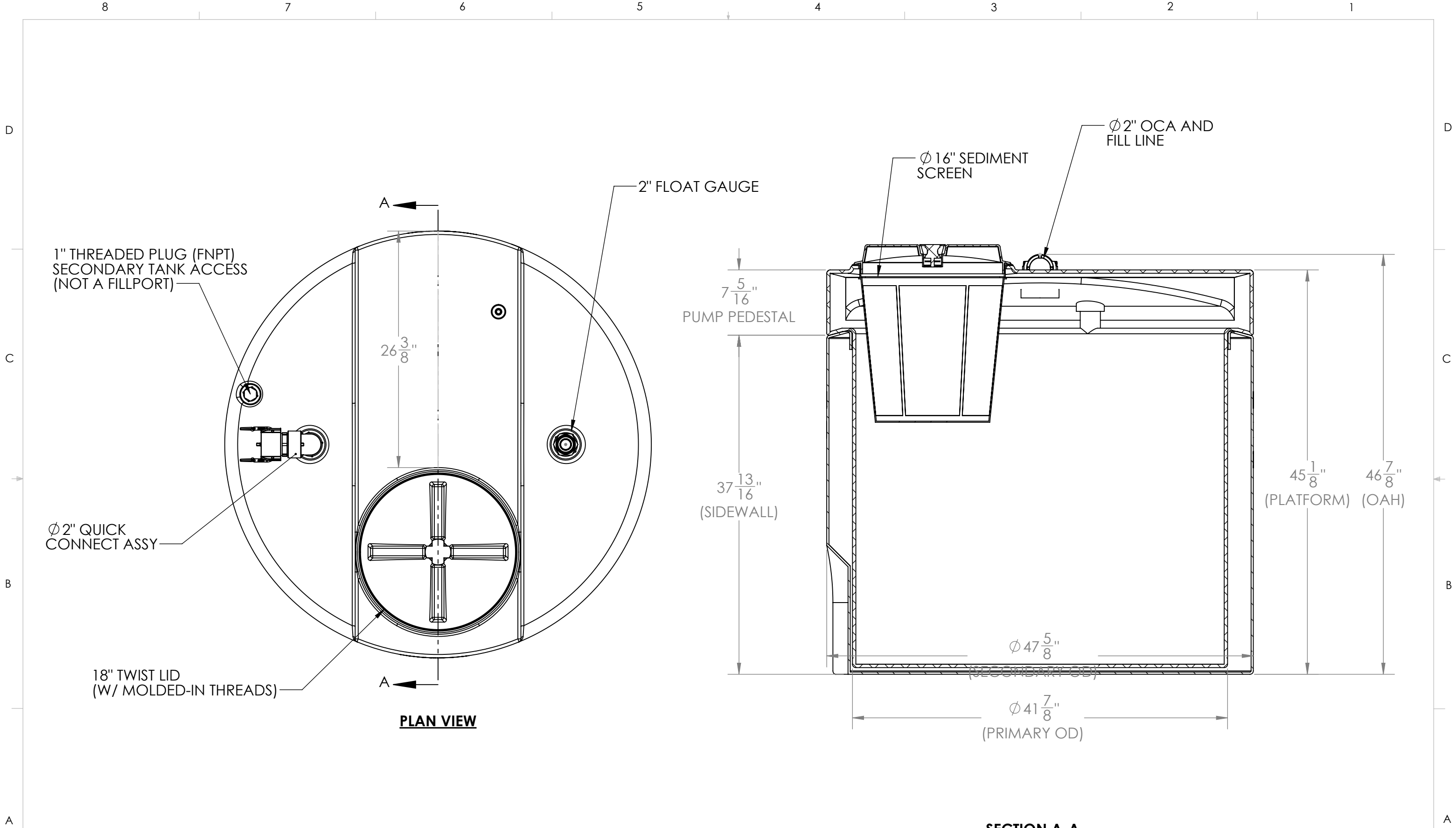

PROJECT:		
220G Gemini Assy		
SCALE: 1:10	REV.	SHEET 2 OF 2

