

Remote Programming Instructions

Remote Operation

Single Channel

Multi Channel

BACK

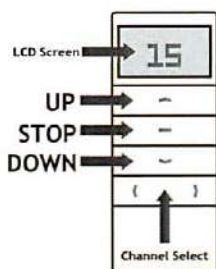
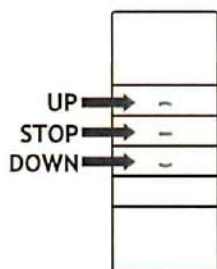

1



Power on shutter
Listen for long BEEP



*Complete programming within 4 seconds of beep

When Motor is on Outside Left

2

Press the Program Button on back 2 times



Listen for 1 BEEP per press

3

Press up button on remote 1 time



Listen for 3 BEEP confirmation

COMPLETE
Now set limits

* If programming is incorrect for up/down, just repeat steps 2-3 for correct side

When Motor is on Outside Right

2

Press the Program Button on back 2 times



Listen for 1 BEEP per press

3

Press down button on remote 1 time

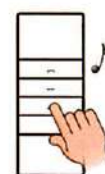

Listen for 3 BEEP confirmation

COMPLETE
Now set limits

* If programming is incorrect for up/down, just repeat steps 2-3 for correct side

Limit Setting Instructions

1

Establish Limit Directions

Outside Left

WHITE = UP LIMIT
RED = DOWN LIMIT



Outside Right

RED = UP LIMIT
WHITE = DOWN LIMIT

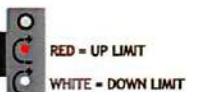

2

Run in down direction until Stopped to establish a 0 point



3

Turn limit using supplied tool to add / subtract limit amount

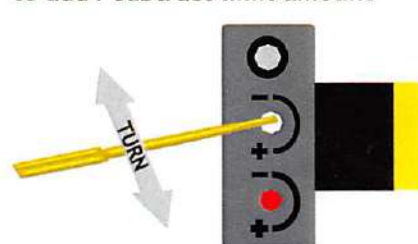

Additional Programming Instructions

Jumping programming

1

On already programmed remote or channel press program Button 2 times

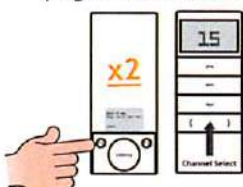

2

On a new remote or new channel press program button 2 times

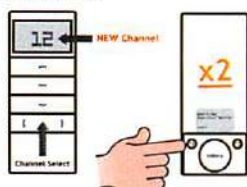

OK COMPLETE

Factory Reset programming

1

Press P2 1 time



2

Press STOP 1 time

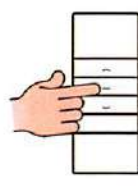

3

Press P2 1 time



Listen for 3 BEEP confirmation



OK Reset Complete