

SIGNING PLAN

2026 FARM TECHNOLOGY DAYS

CLARK, MARATHON AND WOOD COUNTY

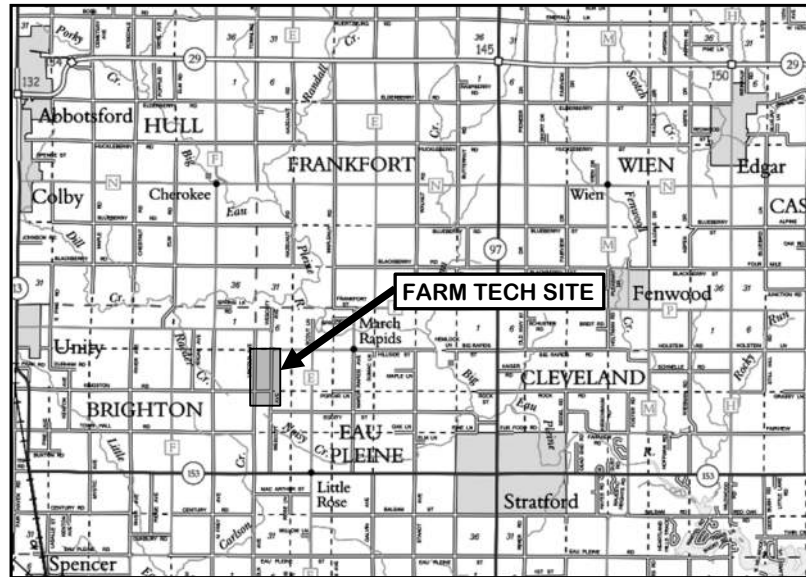
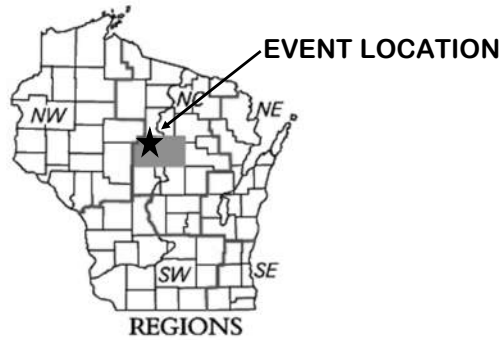

Revised 3/20/26

2026 Farm Technology Days Signing Plan – Guide Route Overview

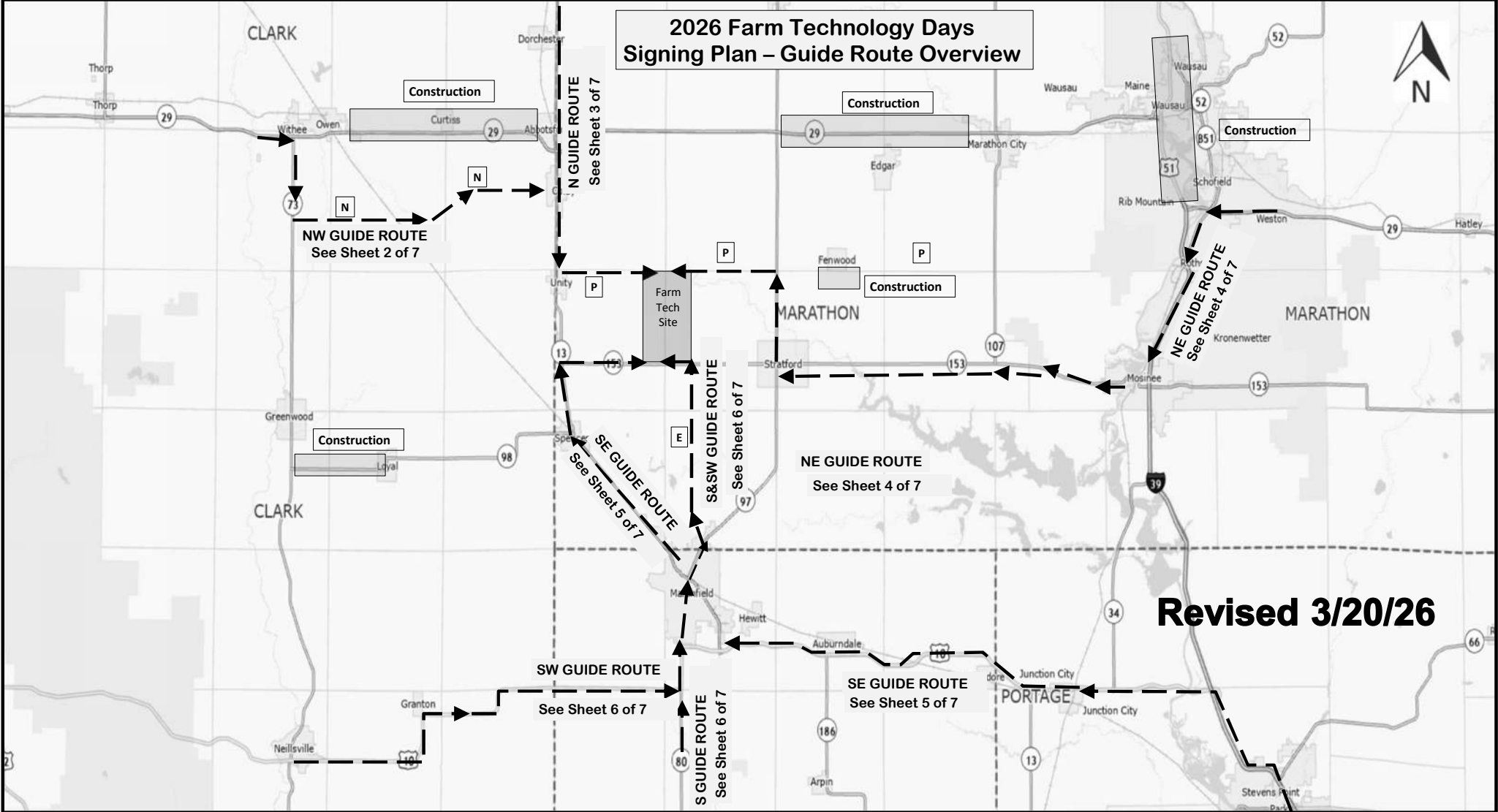

Revised 3/20/26

2026 Farm Technology Days Signing Plan – Northwest Guide Route

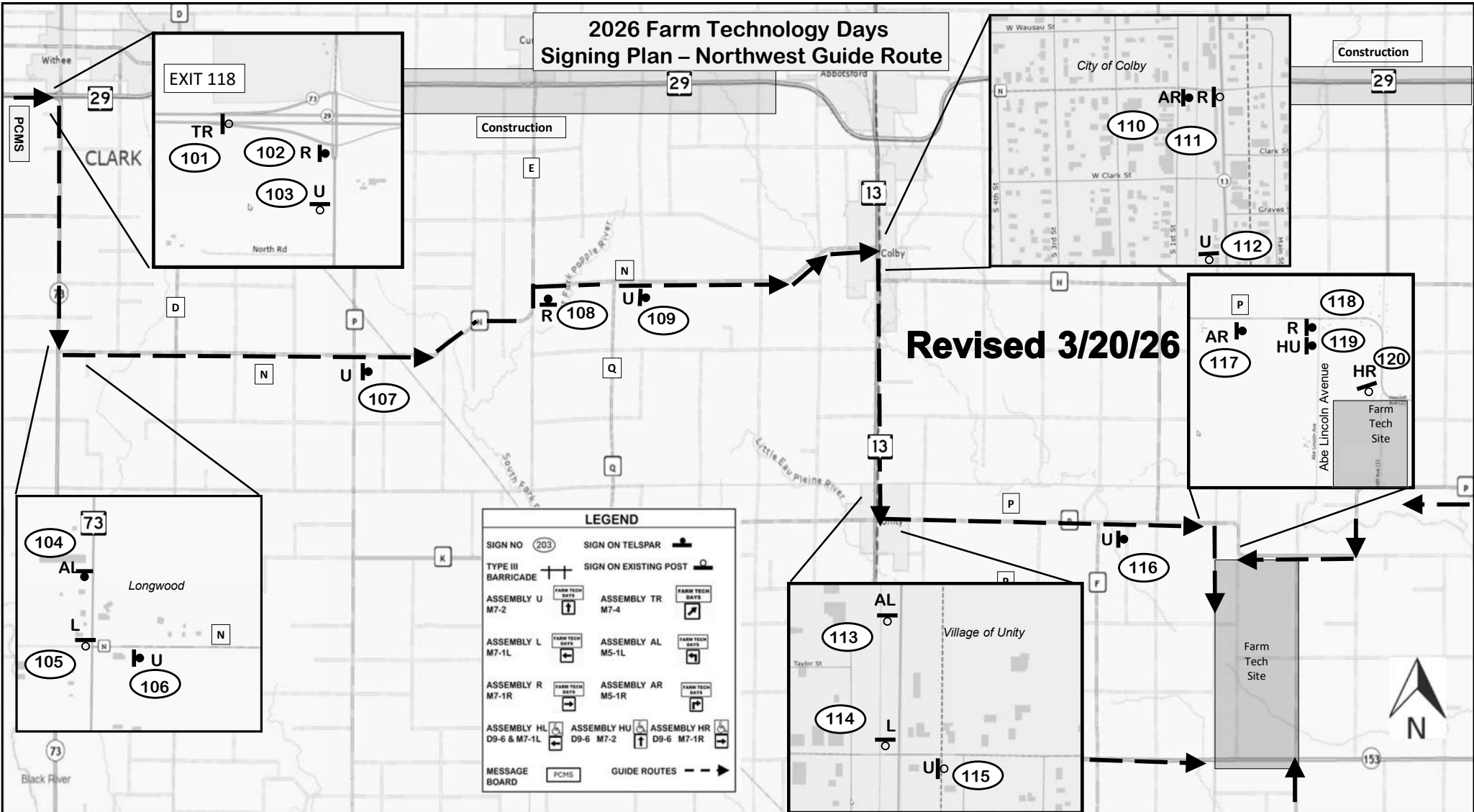

Revised 3/20/26

LEGEND		
SIGN NO 203	SIGN ON TELSPAR	
TYPE III BARRICADE	SIGN ON EXISTING POST	
ASSEMBLY U M7-2	ASSEMBLY TR M7-4	
ASSEMBLY L M7-1L	ASSEMBLY AL M5-1L	
ASSEMBLY R M7-1R	ASSEMBLY AR M5-1R	
ASSEMBLY HL D9-6 & M7-1L	ASSEMBLY HU D9-6 M7-2	ASSEMBLY HR D9-6 M7-1R
MESSAGE BOARD	PCMS	GUIDE ROUTES

**2026 Farm Technology Days
Signing Plan – North Guide Route**

Revised 3/20/26

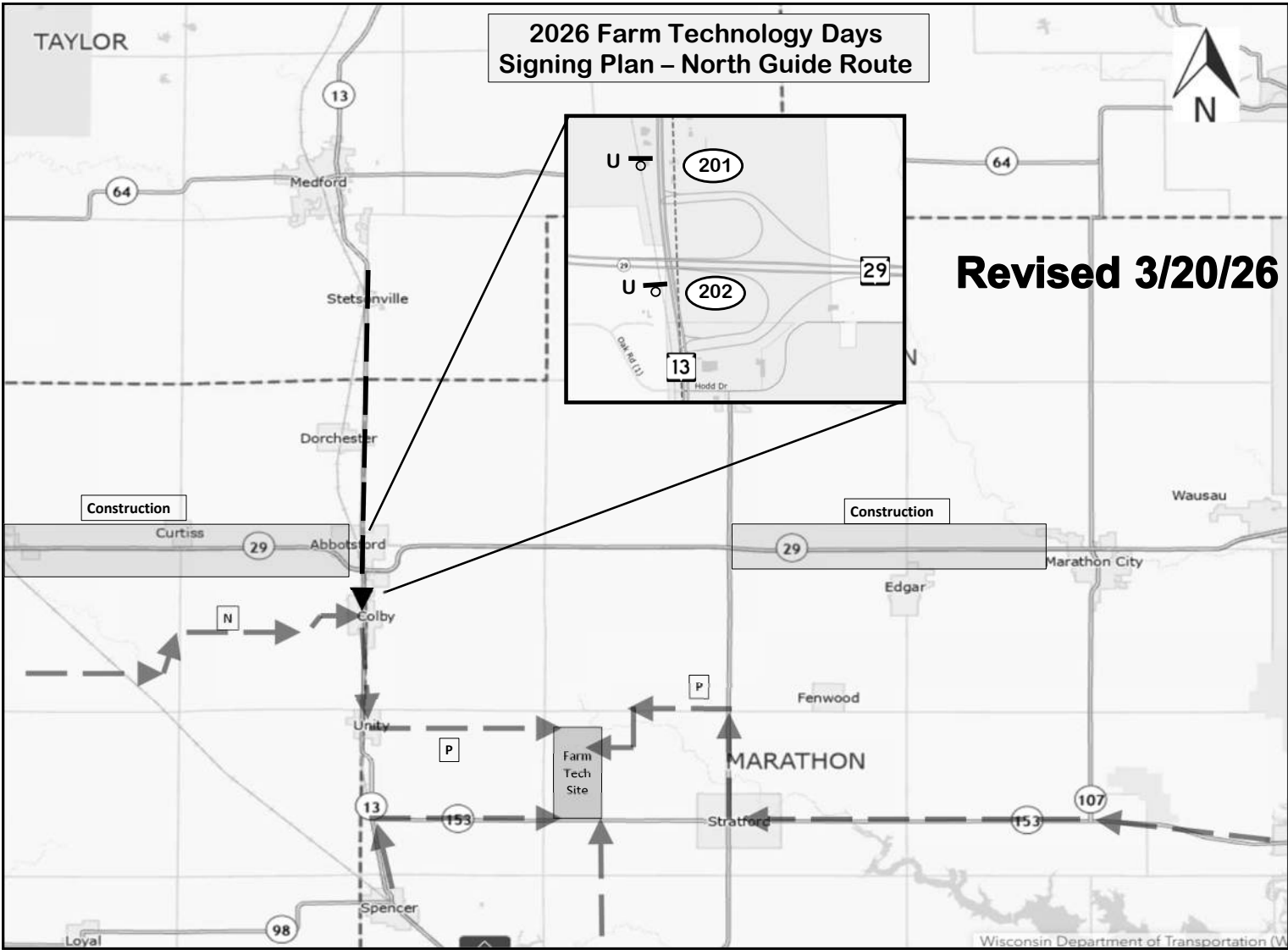

LEGEND		
SIGN NO (203)	SIGN ON TELSPAR	
TYPE III BARRICADE	SIGN ON EXISTING POST	
ASSEMBLY U M7-2	ASSEMBLY TR M7-4	
ASSEMBLY L M7-1L	ASSEMBLY AL M5-1L	
ASSEMBLY R M7-1R	ASSEMBLY AR M5-1R	
ASSEMBLY HL D9-6 & M7-1L	ASSEMBLY HU D9-6 M7-2	ASSEMBLY HR D9-6 M7-1R
MESSAGE BOARD	PCMS	GUIDE ROUTES

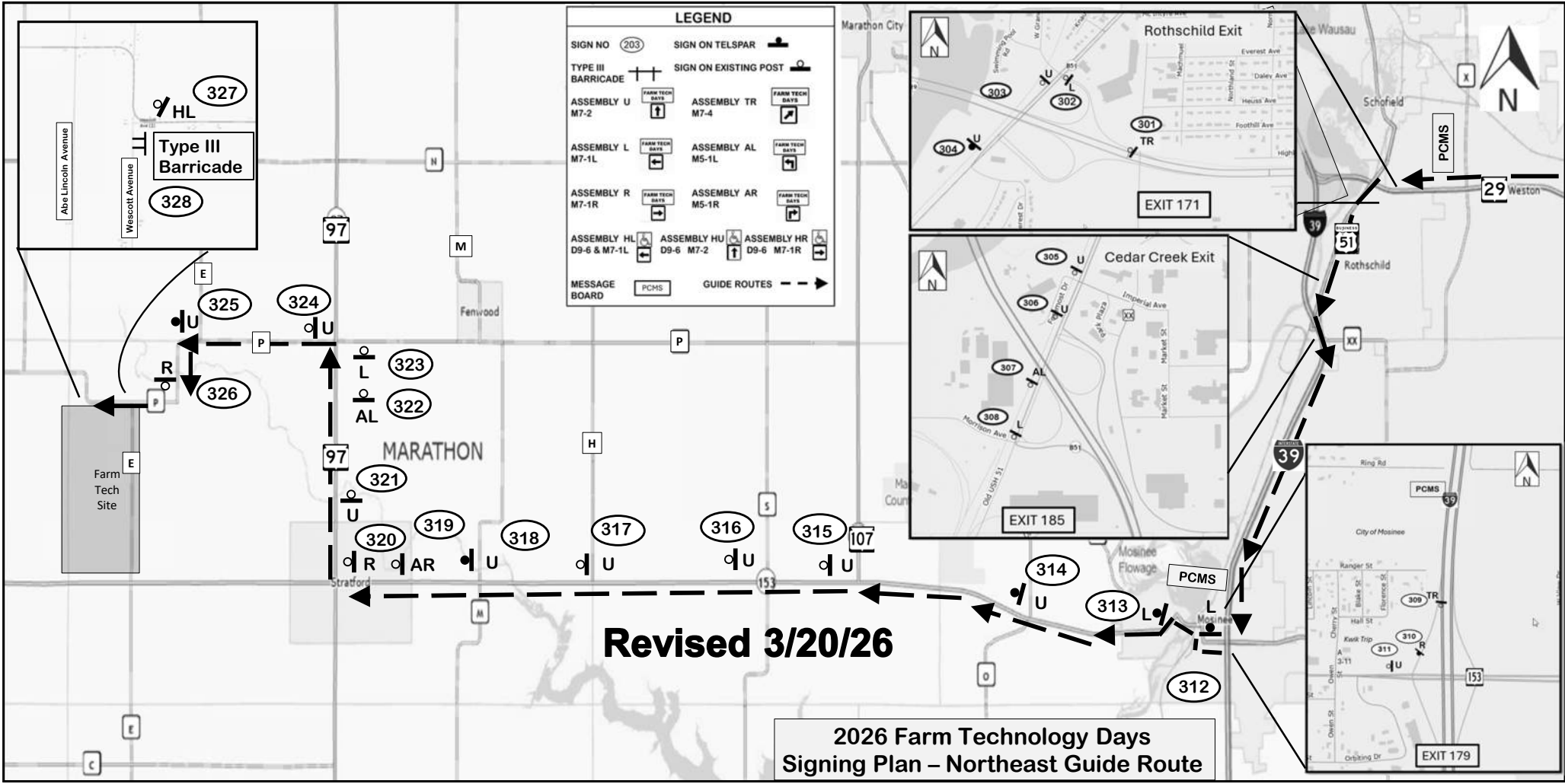

LEGEND

SIGN NO 203	SIGN ON TELSPAR	
TYPE III BARRICADE	SIGN ON EXISTING POST	
ASSEMBLY U M7-2	ASSEMBLY TR M7-4	
ASSEMBLY L M7-1L	ASSEMBLY AL M5-1L	
ASSEMBLY R M7-1R	ASSEMBLY AR M5-1R	
ASSEMBLY HL D9-6 & M7-1L	ASSEMBLY HU D9-6 M7-2	ASSEMBLY HR D9-6 M7-1R
MESSAGE BOARD	PCMS	GUIDE ROUTES

Revised 3/20/26

**2026 Farm Technology Days
Signing Plan – Northeast Guide Route**

2026 Farm Technology Days Signing Plan – Southeast Guide Route

LEGEND	
SIGN NO (203)	SIGN ON TELSPAR
TYPE III BARRICADE	SIGN ON EXISTING POST
ASSEMBLY U M7-2	ASSEMBLY TR M7-4
ASSEMBLY L M7-1L	ASSEMBLY AL M5-1L
ASSEMBLY R M7-1R	ASSEMBLY AR M5-1R
ASSEMBLY HL D9-6 & M7-1L	ASSEMBLY HU D9-6 M7-2
MESSAGE BOARD	GUIDE ROUTES

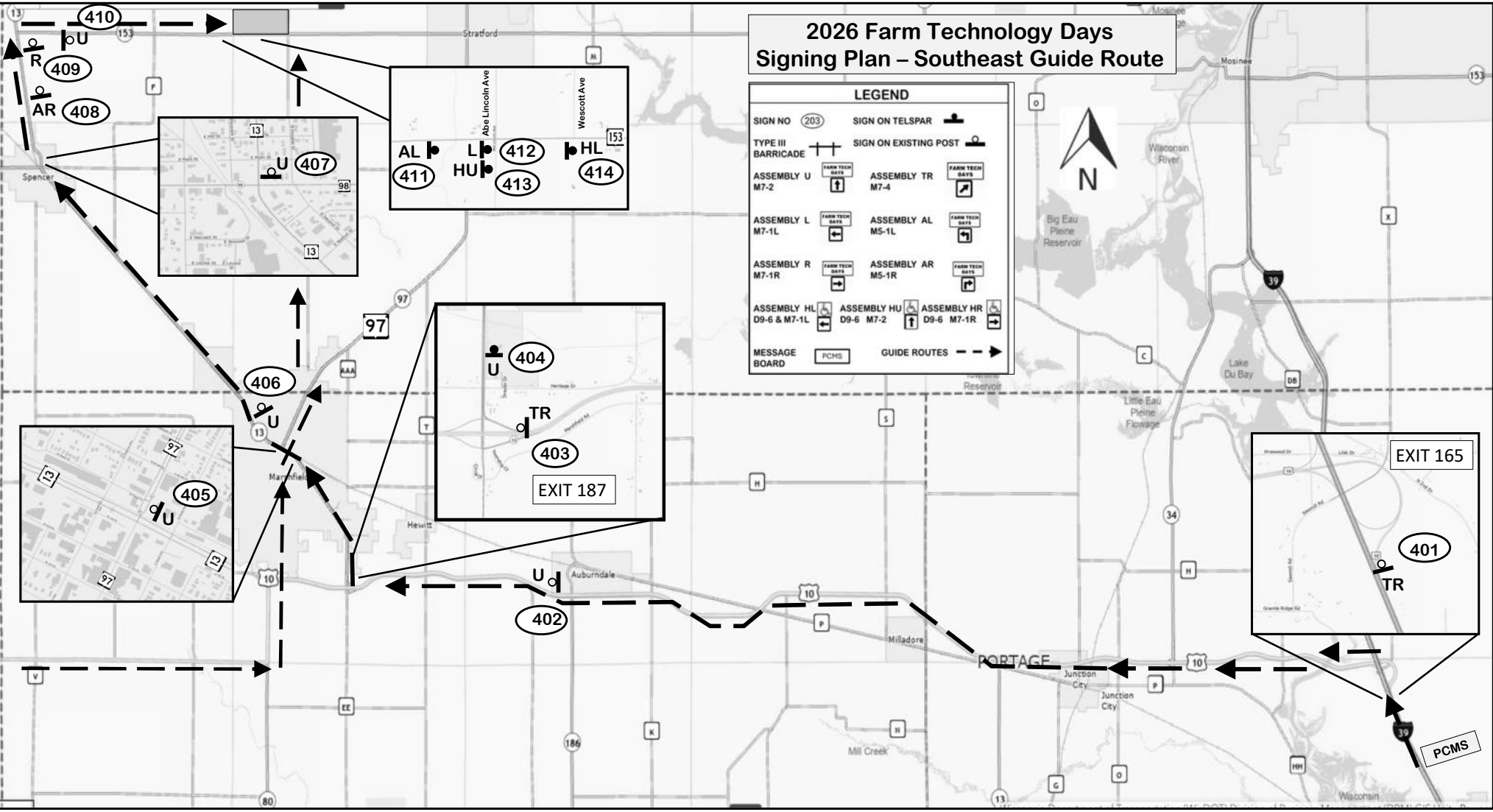

2026 Farm Technology Days Signing Plan – South/ Southwest Guide Route

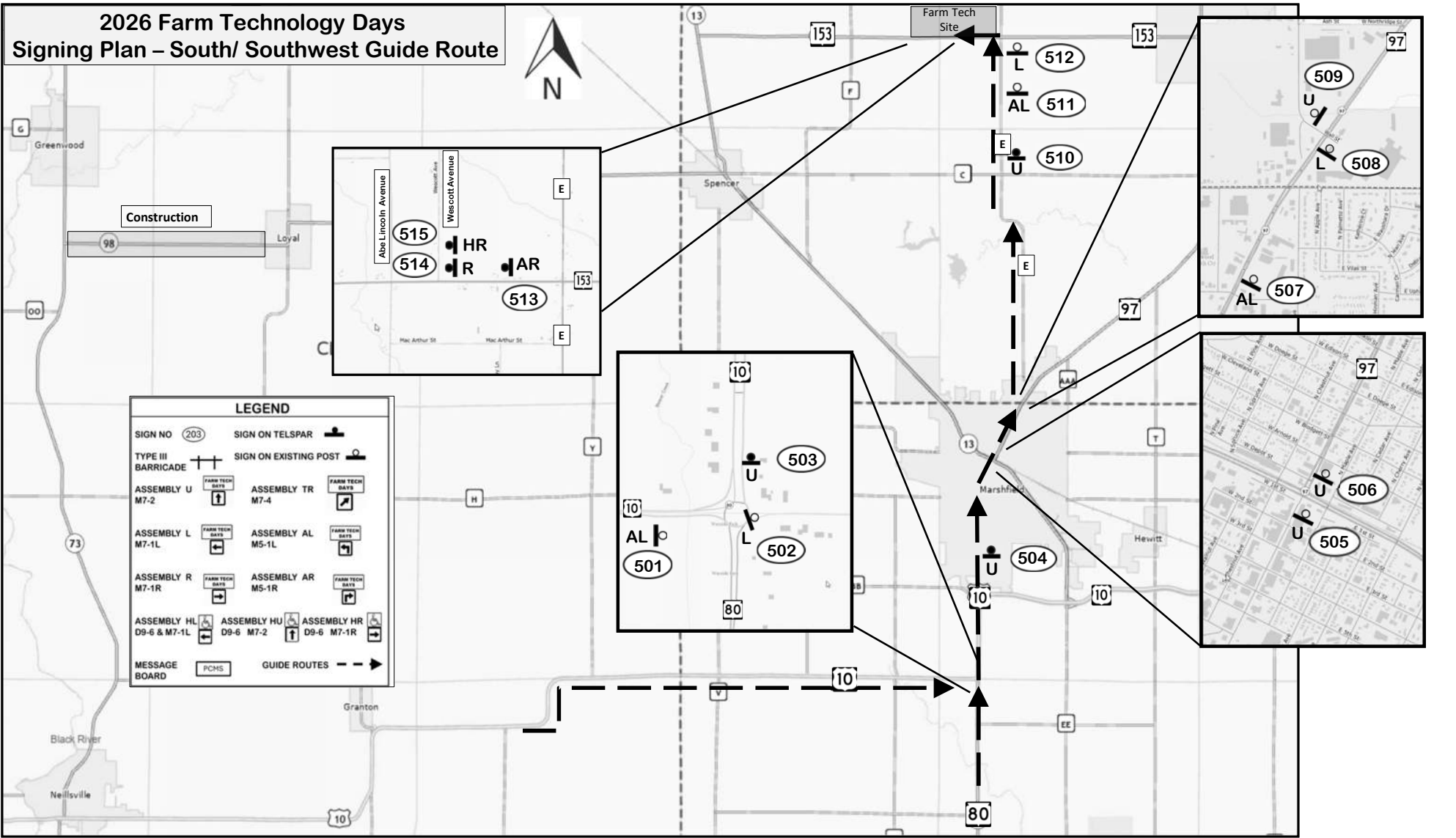

Inset Map 1: Abe Lincoln Avenue / Wisconsin Avenue

Locations: 515, 514, 513, 512, 511, 510

Signs: HR, R, AR

Inset Map 2: US-10 / US-80

Locations: 503, 502, 501

Signs: U, L, AL

Inset Map 3: US-97

Locations: 509, 508, 507

Signs: U, L, AL

Inset Map 4: US-97

Locations: 506, 505

Signs: U, L

LEGEND	
SIGN NO 203	SIGN ON TELSPAR
TYPE III BARRICADE	SIGN ON EXISTING POST
ASSEMBLY U M7-2	ASSEMBLY TR M7-4
ASSEMBLY L M7-1L	ASSEMBLY AL M5-1L
ASSEMBLY R M7-1R	ASSEMBLY AR M5-1R
ASSEMBLY HL D9-6 & M7-1L	ASSEMBLY HU D9-6 M7-2
	ASSEMBLY HR D9-6 M7-1R
MESSAGE BOARD	GUIDE ROUTES

Sign No	Sign Assembly	Handicap Par D9-6	Arm Tech Day	Up Arrow M7-2	Head Left Arrow M5-1L	Left Arrow M7-1	Head Right Arrow M5-1R	Right Arrow M7-1	M7-4	Barricade	Type III	Elspace	Exist Post	Relative Location
101	TR			1									1	Attach to existing Exit 118 sign in gore of EB WIS 29 off-ramp to Wis 73/Co T
102	R			1									1	Install on new post adjacent to stop sign on right side of ramp
103	U			1	1								1	Attach below "ADOPT A HIGHWAY" sign 300 ft south of EB off-ramp on west side of WIS 73/CTH
104	AL			1		1							1	Attach below "CTHN AHEAD LEFT" sign 840 ft north of CTHN on west side of WIS 73
105	L			1				1					1	Attach below "CTHN" sign located 60 ft north of CTHN on west side of WIS 73
106	U			1	1								1	Install on new post 300 ft east of WIS 73 on south side of CTHN
107	U			1	1								1	Install on new post 100 ft east of CTHP on south side of CTHN
108	R			1					1				1	Attach below "CTHE UP / CTHN RIGHT" sign at junction of CTHE and CTHN in SE corner of intersection
109	U			1	1								1	Attach below "CTHN UP / CTH Q RIGHT" sign at junction of CTHN and CTH Q at intersection of CTH Q
110	AR			1						1			1	Install on new post 50 ft east of "RR Exempt" sign (80 ft west of 2nd Street) on south side of CTHN
111	R			1					1				1	Attach below "WIS 13 DOUBLE ARROW / CTHN RIGHT" 85 ft west of WIS 13 on south side of CTHN
112	U			1	1								1	Attach below "30 MPH" sign 100 ft south of CTHN EAST on west side of WIS 13
113	AL			1		1							1	Attach below "JCT CTHP / CTHK" sign 800 ft north of CTHP on west side of WIS 13
114	L			1				1					1	Attach below "CTHP LEFT / CTHK RIGHT" sign 60 ft north of CTHP on west side of WIS 13
115	U			1	1								1	Attach below "35 MPH" sign 200 ft east of WIS 13 on south side of CTHP
116	U			1	1								1	Install on new post 100 ft east of County F on south side of CTHP
117	AR			1						1			1	Install on new post 800 ft west of Abe Lincoln Avenue on south side of CTHP
118	R			1					1				1	Install on new post 100 ft west of Abe Lincoln Avenue on south side of CTHP
119	HU	1		1									1	Install on new post 100 ft west of Abe Lincoln Avenue on south side of CTHP adjacent to SIGN 113
120	HR	1		1					1				1	Install on new post 300 ft west of Wescott Avenue on CTHP on west side of CTHP
201	U			1	1								1	Attach below "COLBY WAUSAU JUP" destination sign located 500 ft north of WB off-ramp on west side of WIS 13
202	U			1	1								1	Attach below "ADOPT A HIGHWAY" sign 200 ft south of WIS 29 overpass on west side
301	TR			1						1			1	Attach to existing Exit 171 sign in gore of WB WIS 29 off-ramp to Business 51 Grand Avenue
302	L			1				1					1	Install on new post 100 ft east of crosswalk in median of WB WIS 29 off-ramp to Business 51
303	U			1	1								1	Attach below "SOUTH Business US 51" sign 250 ft south of WIS 29 WB off-ramp on west side of Bus 51
304	U			1	1								1	Install on new post 50 ft north of crosswalk traffic signal on west side of Business 51
305	U			1	1								1	Attach below "RR Xing" warning sign 300 ft north of CTH XX intersection on west side of Bus 51
306	U			1	1								1	Attach to back of "DO NOT ENTER" sign 80 ft north of Stop Bar at NB I-39 Ramp on west side of Bus 51
307	AL			1		1							1	Attach below "BEGIN LEFT TURN LANE" sign in Median 300 ft north of Stop Bar at I-39 SB ramp intersection
308	L			1				1					1	Attach to SB off-ramp Right Turn Traffic Signal pole in Median adjacent to left turn lane 50 ft north of Stop Bar at I-39 SB ramp intersection
309	TR			1						1			1	Attach to existing Exit 179 sign in gore of SB I-39 off-ramp to WIS 153
310	R			1					1				1	Install on new post 100 ft north of Stop Bar at WIS 153 on west side of off-ramp
311	U			1	1								1	Attach below "35 MPH" sign 300 ft west of I-39 SB off-ramp on north side of WIS 153
312	L			1					1				1	Attach below "Old Hwy S1 TILT RIGHT ARROW" sign on north side of Roundabout on WIS 153
313	L			1					1				1	Attach on Traffic Signal Pole in front of Moinees Brewing Company on west corner of intersection with CTH B
314	U			1	1								1	Attach below "WEST WIS 153" sign 300 ft west of CTH Q intersection on north side of WIS 153
315	U			1	1								1	Attach below "WEST WIS 153" sign 150 ft west of WIS 107 intersection on north side of WIS 153
316	U			1	1								1	Attach below "WEST WIS 153" sign 80 ft west of CTH S intersection on north side of WIS 153
317	U			1	1								1	Attach below "WEST WIS 153" sign 350 ft west of CTH H intersection on north side of WIS 153
318	U			1	1								1	Attach below "WEST WIS 153" sign 300 ft west of CTH N intersection on north side of WIS 153
319	AR			1						1			1	Attach below "Signal ahead" sign at Leacock Street intersection on north side of WIS 153
320	R			1					1				1	Attach on new post 100 ft east of WIS 97 intersection on north side of WIS 153
321	U			1	1								1	Attach below "NORTH WIS 97" sign 150 ft north of WIS 153 intersection on east side of WIS 97
322	AL			1		1							1	Attach below "1st CTHP" sign 825 ft south of CTHP intersection on east side of WIS 97
323	L			1				1					1	Attach below "CTHP DOUBLE ARROW" sign at CTHP intersection on east side of WIS 97
324	U			1	1								1	Attach below "WEST CTHP" sign west of WIS 97 intersection on north side of CTHP
325	U			1	1								1	Attach below "CTHE ARROW" sign at CTHE intersection on north side of CTHP
326	R			1					1				1	Attach below "STOP - RIGHT TURNING STOP" sign at intersection of CTHP, CTHE and Hillside St
327	HL	1											1	Install on new post 300 ft east of Wescott Avenue on CTHP north side of CTHP
328	Type III Barricade												1	Install Type III Barricade to close WB Wescott Avenue

Revised 3/20/26

Sign No	Sign Assembly	Handicap Par	Arm Tech Day	Up Arrow	Head Left Arrow	Left Arrow	Head Right Arrow	Right Arrow	Flt Arrow	Type III	Telspa	Exist Post	Relative Location
		D9-6		M7-2	M5-1L	M7-1	M5-1R	M7-1	M7-4	Barricade			
401	TR		1						1			1	Attach to existing Exit 165 sign in gore of NB I-39 off ramp to US 10
402	U		1	1								1	Attach below "WEST US 10 / NORTH WIS 13" sign west of WIS 186 intersection on north side US 10 (south of Auburndale)
403	TR		1						1			1	Attach to existing Exit 187 sign in gore of WB US 10 off ramp to WIS 13 Marshfield
404	U		1	1							1		Install on new post 300 ft north of Heritage Drive on east side of WIS 13
405	U		1	1								1	Attach below "NORTH WIS 13 UP" sign 200 ft south of WIS 97 / WIS 13 traffic signal intersection in Marshfield
406	U		1	1								1	Attach below "NORTH WIS 13" sign north of CTHY / Oak Ave traffic signal intersection in Marshfield
407	U		1	1								1	Attach below "NORTH WIS 13 sign north of WIS 98 / CTHC traffic signal on east side of WIS 13 in Spencer
408	AR		1				1					1	Attach below "NORTH WIS 13 UP / EAST WIS 153 AHEAD RIGHT" sign 500 ft south of WIS 153
409	R		1					1				1	Attach below "EAST WIS 153 RIGHT" sign 70 ft south of WIS 153
410	U		1	1								1	Attach on back of NO PASSING ZONE sign 550 ft east of WIS 13 on south side of WIS 153
411	AL		1		1							1	Install on new post 350 ft west of Abe Lincoln Ave on south side of WIS 153
412	L		1			1						1	Install on new post 100 ft west of Abe Lincoln Ave on south side of WIS 153
413	HU	1		1								1	Install on new post 100 ft west of Abe Lincoln Ave on south side of WIS 153 adjacent to SIGN 412
414	HL	1				1						1	Install on new post 100 ft west of Wescott Ave on south side of WIS 153
501	AL		1		1							1	Attach below "JCT WIS 80" sign 1400 ft west of Roundabout
502	L		1			1						1	Attach below "Klondike Dr" sign in east splitter island on east side of Roundabout
503	U		1	1								1	Attach below west facing "ONE WAY" sign 500 ft north of Roundabout with FARM TECH UP sign facing south
504	U		1	1								1	Install on new post in Median 300 ft north of US 10 halfway between RAB at US 10 EAST and RAB at Heritage Dr on S Central Ave
505	U		1	1								1	Attach on Light Pole north of "NORTH WIS 97 UP" sign in front of GoodFellas Pub 300 ft south of WIS 13 / WIS 97 intersection in Marshfield
506	U		1	1								1	Install on Light Pole in front of Kwik Trip 260 ft north of WIS 13 / WIS 97 intersection in Marshfield
507	AL		1		1							1	Attach below "JCT CTHE" sign 730 ft south of CTHE
508	L		1			1						1	Attach below "LEFT CTHE" sign 100 ft south of CTHE
509	U		1	1								1	Attach below "CURVE" sign 250 ft north of WIS 97 on east side of CTHE in Kwik Trip sidewalk
510	U		1	1								1	Install on new post 100 ft north of CTHC on east side of CTHE
511	AL		1		1							1	Attach below "JCT WIS 153" sign 600 ft south of WIS 153
512	L		1			1						1	Attach below "DOUBLE ARROW WIS 153" sign at WIS 153
513	AR		1				1					1	Install on new post 700 ft east of Wescott Ave on north side of WIS 153
514	R		1					1				1	Install on new post 100 ft east of Wescott Ave on north side of WIS 153
515	HR	1						1				1	Install on new post 100 ft east of Wescott Ave on north side of WIS 153 adjacent to SIGN 514
Totals		6	72	36	8	13	5	11	5	1	25	53	

Revised 3/20/26