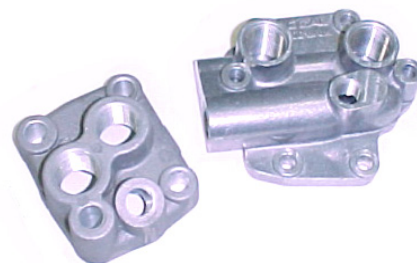

**TOP1LP Type****Bolt-on Type****TOP Type**

## **Engine Oil Take-Off Plates**

If you are looking to relocate your oil filter or want to design a remote filter/oil cooling circuit it all starts with a what we call a "Take-Off" plate. We offer several types of oil take-off 's designed to replace the engine mounted oil filter. Once installed the take-off plate permits hose connections allowing oil flow to a remotely mounted filter, and if required, optionally on to an in-line thermostat and oil cooler. The most universal of these take-offs is our (TOP) type which simply threads onto the male filter nipple and are available in all popular SAE and Metric filter thread sizes. Fluid connections are usually female thread requiring some type of male/male union, which point straight out, for connection to a female hose end. Where space is limited we offer a low profile two piece take-off (TOP1LP) that rotates for 360 degrees for index and has the fluid connections at 90° degrees to the filter nipple. These are great for engine swaps and kit car applications. The last type of oil take off are the bolt-on type. Some engines are equipped with a filter console or pump cover where the stock filter (either spin-on or canister) is located; on other engines it is preferable to remove the stock engine engine mounted oil cooler and fit a plate that deletes the cooler and provides connections to a remote oil cooler. We have a selection of bolt-on take-off plates for these applications.

### **Take-Off Plate FAQ**

**Why install or convert to remote oil filter?** Most likely the filter is in a difficult location or you might want the option of a better flowing, larger filter in a position that is easy to service. This is especially true with newer cars, engine swaps, and kit cars.

**Do I have to convert to remote filter to install an oil cooler?** We generally recommend a sandwich adapter between the engine block and filter, in some cases there is not enough room to insert the plate and get the filter back on or no way to make hose connections to the plate in the stock filter location.

**Can I add an oil cooler with my remote mounted filter?** It is easy to add an in-line thermostat and oil cooler after the filter and before the oil is returned back to the engine. Hooking it up only requires some additional plumbing and the space required to mount a cooler. ANother option would be to use a thermostatic sandwich plate on the remote filter stand.

**What is the difference between BSP & NPT thread size?** NPT is taper, and BSP is a parallel thread. Both have the same pitch and NPT will thread into a BSP female port. BSP has some advantages as it seats on the shoulder "hex" (sealing with a o-ring) and takes up less space than a NPT fitting.

**Standard Oil Take-off Plate**

center thread	port thread	part#	price
3/4"-16	1/2" NPT	TOP111	\$19.55
13/16"-16	1/2" NPT	TOP114	\$19.55
18mm	1/2" NPT	TOP112	\$19.55
20mm	1/2" NPT	TOP116	\$23.55
22mm	1/2" NPT	TOP118	\$23.55

Basic and affordable, this series of aluminum take-offs are suitable for most applications. Price includes o-ring; fittings for fluid connection are sold separately.

**Mocal HD Oil Take-off Plate**

center thread	port thread	part#	price
3/4"-16	1/2" BSP	TOP1	\$41.25
18mm	1/2" BSP	TOP1D	\$41.25
20mm	1/2" BSP	TOP1F	\$41.25

These precision die cast aluminum Mocal manufactured plates are both strong, and lightweight, offering the quality of billet components at a sensible price. Price includes o-ring; fittings for fluid connection are sold separately.

**Mocal Billet Oil Take-off Plate**

center thread	port thread	part#	price
3/4"-16	M22 x 1.5	TOP1-B	\$65.00
20mm	M22 x 1.5	TOP1F-B	\$65.00

We have never understood why typical "billet" engine oil take-off's always wind up being such bulky, heavy, and expensive affairs. Our new minimalist design billet take off plates are elegantly compact, lightweight and reasonably priced. These plates utilize a generously sized M22 x 1.5 ORB threaded port which allow for a wide range of unions, hose ends and banjo fittings. Price includes o-ring; fittings for fluid connection are sold separately.

**Low Profile Oil Take-off Plate**

center thread	port thread	part#	price
3/4"-16	1/2" BSP	TOP1LP	\$89.50
13/16"-16	1/2" BSP	TOP1LPC	\$89.50
18mm	1/2" BSP	TOP1LPD	\$89.50
20mm	1/2" BSP	TOP1LPF	\$89.50

These high quality die cast constructed plates are the choice for use in tight quarters- especially good for engine swaps and kit car applications. Unique 2 piece design allows plate to index 360 degrees before being tightened into place by top cover. Price includes o-ring; fittings for fluid connection are sold separately.

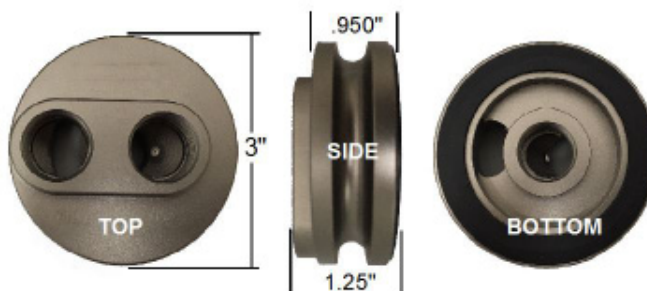



**BOLT-ON TYPE OIL TAKE-OFF PLATES****Bolt-On Oil Take-off Plates**

application	port thread	part#	price
Chevy V8	1/2" NPT	TOP113	\$21.30
Triumph TR7	1/2" BSP	TOP7	\$71.20
FE Ford	1/2" NPT	TOPF8	\$39.25
VW (air cooled)	3/8" NPT	TOP117	\$21.35
Mini R52/53	M22 x 1.5	TOP3	\$195.00
Mini R56	M22 x 1.5	TOP17	\$197.50
Rover/Buick 215 V8	1/2" BSP	PC1	\$179.00

Bolt-on oil take off's are designed to mount in place of existing oil filter canisters or oil pump covers. Most include required hardware and gaskets. Fittings for fluid connection are sold separately.



Mini R56

Mini R52/53

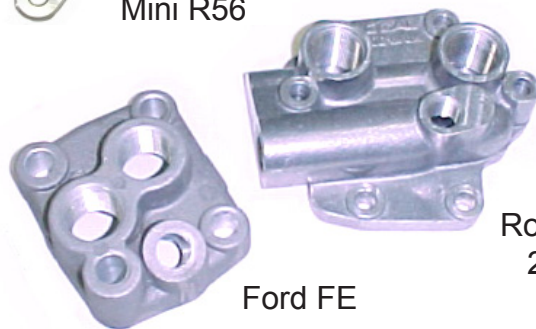

Ford FE

Rover/Buick  
215 V8**Mini R52/53 Take-Off Plate**

description	part#	price
Mini R52/53	T0P3	\$195.00
Supercharged W11B16 "Tritec" T16B4 Engine		
2002-2006 R53 Hatch		
2005-2008 R52 Convertible		

This oil take-off plate replaces the stock water/oil cooler located on the oil filter housing allowing connections to a larger, more efficient, oil cooler of your choice. Inlet/outlet ports are M22 x 1.5 thread so we have a number of options from -AN male unions, -AN hose ends and for low clearance -AN banjos. Machined billet aluminum construction.



Mini R52/53

**Mini R56 Take-Off Plate**

description	part#	price
Mini R56	T0P17	\$197.50
Turbocharged N14B16A "Prince" Engine		
Gen 2 Mini R56 body type 2007-2013		

This oil take-off plate replaces the stock water/oil cooler located on the oil filter housing allowing connections to a larger, more efficient, oil cooler of your choice. Our design incorporates the water passage internally, rather than having to have a tube on the exterior that loops in/out like other (less desirable) versions of this component. We also provide a M12 x 1.5 sender/gauge port. Inlet/outlet ports are M22 x 1.5 thread so we have a number of options from -AN male unions, -AN hose ends and for low clearance -AN banjos. Machined billet aluminum construction.



Threaded adaptors are available in -AN, BSP & metric sizes for all components we offer.



Mini R56

**BOLT-ON TYPE OIL TAKE-OFF PLATES (continued)****GM LS Engine Oil Take-off Plate**

application	port thread	part#	price
-------------	-------------	-------	-------

Chevy LS Engines (-10 AN)		T0PLS	\$99.00
---------------------------	--	-------	---------

Bolt-on billet oil take off's plate replaces blank plate or gauge sender plate on LS type engines providing fluid connections for oil cooling. Threaded for 7/8"-14 (-10AN) o-ring boss type connections with provision for (2) 1/8" NPT sender or oil feed. Includes hardware & gasket. Fittings for fluid connection are sold separately. Suitable for 97 and later rear sump LS and Vortec Gen 3 & 4 engines. Not for front sump or LSX. Some aftermarket headers can make for a tight fit with hose connections.



Threaded adaptors are available in -AN, BSP & metric sizes for all components we offer.

**GM LS Engine Oil Take-off Plate w/Thermo**

application	port thread	part#	price
-------------	-------------	-------	-------

Chevy LS Engines	M22 x 1.5	T0PLS-T	\$189.00
------------------	-----------	---------	----------

Bolt-on billet oil take off's plate with incorporated 180° thermostat replaces blank plate or gauge sender plate on LS type engines providing fluid connections for oil cooling. Threaded for M22 x 1.5 oring boss type connections with provision for (2) 1/8" NPT sender or oil feed. Includes hardware & gasket. Fittings for fluid connection are sold separately. Suitable for 97 and later rear sump LS and Vortec Gen 3 & 4 engines. Not for front sump or LSX. Some aftermarket headers can make for a tight fit with hose connections.

**GM LS Engine Oil Take-off Plate w/Thermo**

application	port thread	part#	price
-------------	-------------	-------	-------

Chevy LS Engines	M22x1.5	AOTGM	\$183.00
------------------	---------	-------	----------

The Mocal thermostat incorporates a thermostatic control that automatically regulates oil flow to connected cooling devices and is the answer when installing oil cooling on high performance engines that see street/track use in varying climates and conditions. The thermo simply bolts in place of factory gauge sender and operates by bypassing oil until minimum temperature (200f) are met before sending full oil flow to the cooler(s). Units are threaded for M22 x 1.5 female oring boss fluid connections (included) with provision for factory M12 x 1.5 sender; includes required hardware and oring/gaskets.

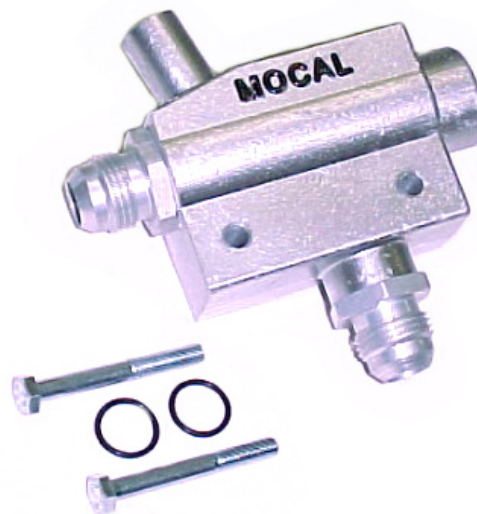



## **BOLT-ON TYPE OIL TAKE-OFF PLATES (continued)**

### **Nissan SR20 Engine Oil Take-off Plate**

application	port thread	part#	price
Nissan SR20	M22x1.5	T0P19	\$119.00

Take-off plate bolts to engine replacing existing stock oil filter mount allowing hose connections to remote filter. Features (2) M22 x 1.5 ports to allow the plumbing of external lines to your remote filter with (2) 1/8" NPT ports for gaugesensor or turbo oil feed. Fittings for fluid connection are sold separately.



### **Ford Focus ST/RS Oil Take-off Plates**

application	port thread	part#	price
Focus ST/RS	M22x1.5	T0P24	\$168.15
Focus ST/RS	M22x1.5	T0P24T	\$227.50

Add additional oil cooling to Focus ST/RS or cars with similar engines with our TOP24 (non thermostat) or TOP24T (thermostatic) take-off plates. These plates eliminate the standard engine mounted water/oil heat exchanger allowing for hose connections to external oil cooler. (2) M22 x 1.5 ports to allow the plumbing of external lines to your remote filter. Fittings for fluid connection are sold separately.



### **Ford Ecoboost & Duratec**

application	port thread	part#	price
Ford Ecoboost	M22x1.5	T0P25	TBA

Take-off plate bolts to engine replacing existing stock oil filter mount allowing hose connections to remote filter. Features (2) M22 x 1.5 ports to allow the plumbing of external lines to your remote filter with (1) port for an oil temperature or oil pressure sensor. Fittings for fluid connection are sold separately.



### **Fiat Abarth 1.4T**

application	port thread	part#	price
Fiat Abarth 1.4T	M22x1.5	T0P29	\$133.90

Plate eliminates the standard engine mounted water/oil heat exchanger allowing for hose connections to external oil cooler. (2) M22 x 1.5 ports to allow the plumbing of external lines to your remote filter. Fittings for fluid connection are sold separately.



## **BOLT-ON TYPE OIL TAKE-OFF PLATES (continued)**

### **VW/AUDI TSI EA113 Engine Take-Off Plate**

application	port thread	part#	price
VW TSi	M22 x 1.5	T0P31	\$156.75

Take-off plate for various VW/Audi EA113 type 1.8L/2.0L engines. Bolts to engine replacing existing stock oil filter mount allowing hose connections to remote filter. Features (2) M22 x 1.5 ports to allow the plumbing of external lines to your remote filter. Fittings for fluid connection are sold separately.



### **AUDI TSFI 2.5L Engine Take-Off Plate**

application	port thread	part#	price
AUDI TSFI 2.5L	M22 x 1.5	T0P32	\$156.75

Take-off plate for 5 cylinder Audi TT RS and RS3. Bolts to engine replacing existing stock oil filter mount allowing hose connections to remote filter. Features (2) M22 x 1.5 ports to allow the plumbing of external lines to your remote filter. Fittings for fluid connection are sold separately.



Threaded adaptors are available in -AN, BSP & metric sizes for all components we offer.

### **Ford Coyote Engine Oil Take-off Plate**

application	port thread	part#	price
Ford Coyote	M22x1.5	T0P20	\$129.50

Plumb a external oil system, oil cooler or oil filter relocation kit with our Coyote engine block adapter oil take-off plate. Mocal's unique lightweight design fits 2011-2014 Blocks & 2015-2018 Blocks (gen 1 and gen 2); replaces the cast spin-on filter plate on the Ford coyote engines and features (2) M22 x 1.5 ports to allow the plumbing of external lines to your remote filter with (1) 1/4" NPT port for an oil temperature or oil pressure sensor. Price includes o-rings; fittings for fluid connection are sold separately.





## BMW Engine & Oil Cooler Take-off's

We can supply a number of options for a variety of BMW engines from the mid 90's to present. There are two basic types. One is a bolt-on adapter that fits engines that have provisions for factory plumbing, often called "Euro housings". The other type is a replacement top cap for the oil filter housing with provisions for fluid connections to a oil cooler that suits M50, S50, S52, S54 engines with aluminum filter cap with through bolt. We are working on a similar version for N52, N54 engines with plastic filter housing.

### BMW E36/E46/E90 Bolt-On Oil Take-off Plate

application	port thread	part#	price
BMW E36/46/90	(M22x1.5)	T0P91	\$40.00

Some BMW E36, E46, E90 chassis cars are factory equipped with oil coolers utilizing manifold "hard lines" that can cause fitment issues for cars with superchargers, Accusumps or other aftermarket plumbing components. Our take off plate allows for more versatile thread-on -AN type fluid connections in place of the factory oil cooler tube/hoses. Once converted -AN hose and fittings can be used to connect to an aftermarket oil cooler. Plate is engineered with M22 x 1.5 female ports that accept -10AN or -12AN male unions for use with standard -AN hose ends or direct to -AN swivel hose ends in 00°, 45° or 90° angles. Although designed for the E36/46/90 engine this filter housing can be used on some E82/92/93 applications with 41.5mm spacing. This is also true for factory oil coolers that uses a similar bolt-on flange fluid connection, again check for 41.5mm spacing. Fittings are optional, specify requirement when ordering.



shown with optional fittings

### BMW Bolt-On Oil Take-off Plate (adjustable)

application	-AN thread	part#	price
BMW (various)	-10AN	T0P92-10	\$63.50
BMW (various)	-12AN	T0P92-12	\$63.50

This take off plate is similar to the above TOP91, but the fittings are adjustable for center to center. This feature is handy as some engines and oil coolers have spacing wider than 41.5mm. Available in either -10AN or -12AN male fluid connections



Threaded adaptors are available in -AN, BSP & metric sizes for all components we offer.





## BMW Engine & Oil Cooler Take-off's (continued)

### BMW Filter Housing Cap w/ Ports

application	port thread	part#	price
BMW (various) M50, S50, S52, S54	(M22x1.5)	FH9	\$209.00

For engines with aluminum oil filter housings and top caps with through bolt, we make this billet aluminum top cap with ports that makes adding an oil cooler easy. Our design incorporates a self adjusting internal sealing mechanism for proper seating against the filter assuring maximum oil flow through the oil cooler and filtration without "blow-by". Cap uses standard type filters and stock cap through bolt. Inlet/outlet Ports are M22 x 1.5 o-ring ports for use with standard -AN hose ends or direct to -AN swivel hose ends in 00°, 45° or 90° angles. A 1/8" NPT side port is provided for external oil pressure gauge (plug included). Fittings are optional, specify requirement when ordering.



Threaded adaptors are available in -AN, BSP & metric sizes for all components we offer.



### BMW Z3/318 M42 Engine Take-Off Plate

application	port thread	part#	price
BMW M42 Engine	M22 x 1.5	T0P9	\$166.50

This oil take-off plate takes the place of the stock canister oil filter assembly and is generally used for remote oil filter/oil cooler installations. Inlet/outlet ports are M22 x 1.5 thread so we have a number of options from -AN male unions, -AN hose ends and for low clearance -AN banjos. Machined billet aluminum - color red, gasket included.

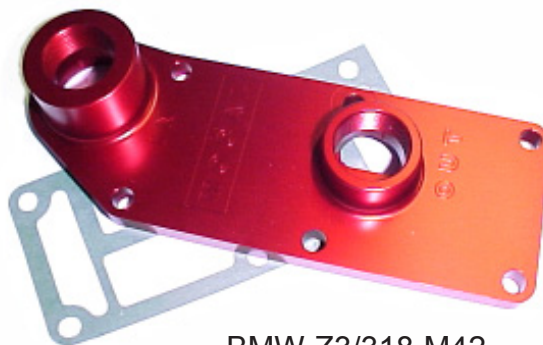

BMW Z3/318 M42

### BMW N20, N54, N55 Engine Take-Off Plate

application	port thread	part#	price
BMW N20, 54, 55	M22 x 1.5	T0P30	\$156.75

Take-off plate bolts to engine replacing existing stock oil filter mount allowing hose connections to remote filter. Features (2) M22 x 1.5 ports to allow the plumbing of external lines to your remote filter. Fittings for fluid connection are sold separately.



TOP30





## Remote Oil Filter Mounts

We offer a variety of remote mount oil filter stands to suit most installations and applications. Relocating the oil filter is often required due to lack of space, engine swaps, drysump oiling systems, or to make filter changes easier. A remote filter mount or "stand" is used in conjunction with a take off plate which is screwed on in place of the original filter. Connection is made between take off and filter stand with 1/2", 5/8", 3/4" i.d. hose and fittings (size depending on application). Filter mounts are manufactured in standard (die cast) or heavy duty (forged) aluminum construction.

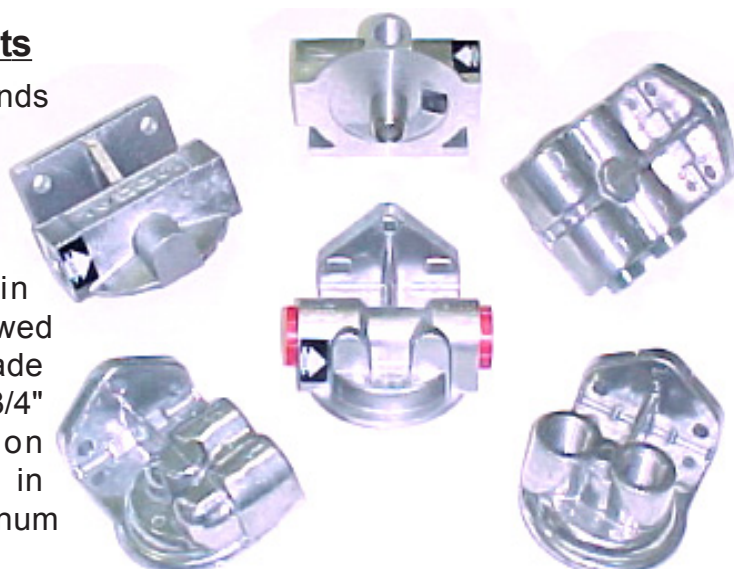

bottom view

### MOCAL H.D. Remote Filter Stands

description	part#	price
Right to Left Flow with gauge port 5/8"-18	RFH1B	\$65.00
Left to Right Flow with gauge port 5/8"-18	RFH1A	\$65.00
Plug 5/8"-18 for above	BSP1-7	\$8.75
Right to Left Flow blank- no gauge port	RFH1F	\$65.00
Left to Right Flow blank- no gauge port	RFH1E	\$65.00

MOCAL RFH1 series remote filter stands are lightweight and sturdy, offering the quality of billet components at a sensible price. We have been making these for over 30 years and they are standard on many vintage road and race applications. Available in right to left, or left to right, oil flow pattern with gauge port or blank. For use with 3/4"-16 filters, oil inlet/outlet is 1/2" BSP- marked for direction of flow.

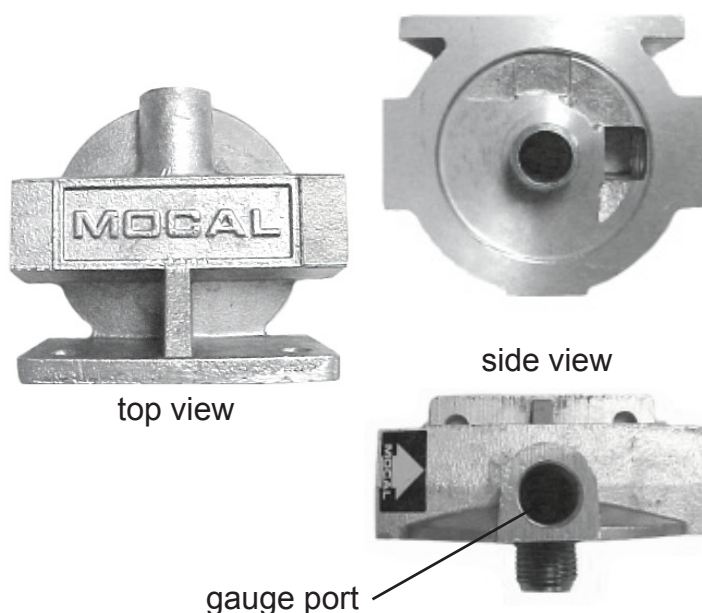

top view

side view

gauge port

### MOCAL O.E. Remote Filter Stands

description	part#	price
Left Inlet/Outlet (3/4 filter)	RFH4LH	\$59.50
Left Inlet/Outlet (M20 filter)	RFH4LHF	\$59.50
Left to Right Flow (3/4 filter)	RFH2	\$55.00
Left to Right Flow (M20 filter)	RFH2F	\$59.50

These Mocal filter stands are original equipment on some current, and past, English vehicles. Use for replacement or where similar specification is needed. For use with 3/4"-16, or 20mm x 1.5 filters as noted. Oil inlet/outlet is 1/2" BSP- marked for direction of flow.



Threaded adaptors are available in -AN, BSP & metric sizes for all components we offer.



Left Inlet/Outlet

Left to Right

## Remote Oil Filter Mounts (continued)

### Standard Remote Filter Stands

description	part#	price
Top Inlet/Outlet	RFH3	\$25.50
Left Inlet/Outlet	RFH4L	\$33.00
Right Inlet/Outlet	RFH4R	\$33.00
Universal* Inlet/Outlet	RFH4	\$38.50
<i>*can be configured as left in/out, right in/out, left to right, right to left- plumb 2 ports and plug the other 2 with supplied plugs.</i>		
Dual Filter Universal	RFH5	\$44.75
<i>as above RFH4 with dual filter</i>		
Adaptor 3/4-16 x 20mm	TN3/4xM20	\$8.75
<i>converts for use with many import oil filters</i>		

Standard series remote filter stands offer good quality at a very reasonable price. Available in top inlet/outlet, right inlet/outlet, or left inlet/outlet, four port universal, oil flow pattern with gauge port or blank. All use 3/4"-16 filters or optionally 20mm x 1.5 (with adaptor above), oil inlet/outlet is 1/2" NPT-marked for direction of flow.

### Oil Filter Nipples

description	part#	price
Filter Nipple 3/4"-16	TN3/4-16	\$2.25
<i>most common filter thread size 3/4"-16</i>		
Filter Nipple 3/4"-16 (long)	TN3/4-16L	\$18.50
<i>as above but extended to 3.25" long</i>		
Filter Nipple 13/16"-16	TN13/16	\$2.45
Filter Nipple 3/4" x 13/16"	TN3/4X13/16	\$8.75
<i>3/4"-16 thread to 13/16"-16</i>		
Filter Nipple 3/4"x16 x 20mm	TN3/4XM20	\$8.75
<i>3/4"-16 thread to M20 x 1.5</i>		
Filter Nipple 20mm x 20mm	TNM20*	\$15.50
<i>M20 x 1.5 to M20 x 1.5</i>		
Filter Nipple M20 x M22	TNM20X22*	\$15.50
<i>1"-12 thread to 3/4"-16</i>		
Filter Nipple 1" x 13/16"	TN1X13/16	\$8.00
<i>1"-12 thread to 13/16"-16</i>		
Filter Nipple 1" x 3/4"-16	TN1X3/4	\$8.00
<i>1"-12 thread to 3/4"-16</i>		
Filter Nipple 1" x M20	TN1XM20	\$8.00
<i>1"-12 thread to M20 x 1.5</i>		

Filter nipples for engine blocks or filter stands. Engines with oil/water heat exchangers (donut coolers) omitted, often need one of these so that filter or oil cooler sandwich plate can be attached. \*TNM20, TNM20X22 have slim fixing nut.



Top inlet/outlet



Right Inlet/Outlet

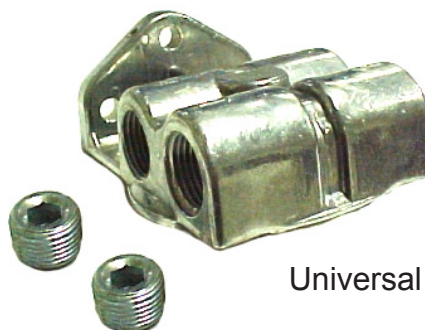

Universal 4 Port



Threaded adaptors are available in -AN, BSP & metric sizes for all components we offer.

TNM20  
TNM20X22





## Billet Remote Filter Mounts

Our latest heavy duty billet aluminum remote filter mounts are available in a few different configurations: left in/out, right in/out and left to right in/out. All are designed with weight savings in mind by keeping size and weight to a minimum. For fluid connection they utilize M22 female ORB ports for high flow and low restriction.

### Remote Oil Filter Mount Left or Right In/Out

filter thread	port thread	part#	price
3/4"-16	M22x1.5	RFH4LB	\$145.00
		left in/out	
3/4"-16	M22x1.5	RFH4RB	\$145.00
		right in/out	

There are two versions of this filter mount: Left IN/OUT and Right IN/OUT, otherwise specifications are the same: 3/4"-16 filter thread, M22 x 1.5 inlet/outlet, filter o-ring size range 2 1/4" min - 3" max., weight 10.8oz, material 6000 series billet aluminum, finish black anodized.



RFH4LB



RFH4RB

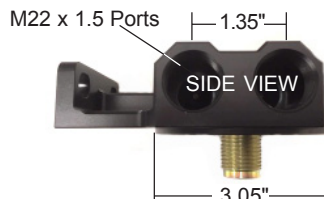
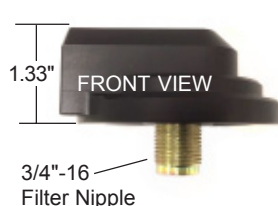

### Remote Oil Filter Mount Left to Right Flow

filter thread	port thread	part#	price
3/4"-16	M22x1.5	RFH2G	\$145.00
		LH > RH	

Our LEFT to RIGHT billet aluminum filter mount uses a large format 1"-12 oil filter which is popular for motorsports, aviation, marine and industrial off highway equipment. Specifications: 1"-12 filter thread, M22 x 1.5 inlet/outlet, filter o-ring size range 2 1/4" min - 3" max., weight 10.8oz, material 6000 series billet aluminum, finish black anodized.



RFH2G

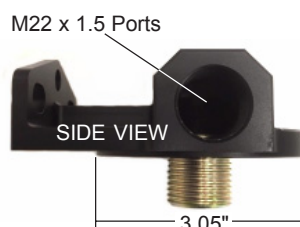
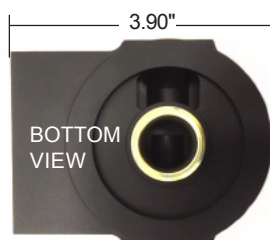

## Thermostatic Remote Filter Mounts

Many installations, from engine swaps to turbo kits, can benefit by relocating the oil filter and incorporating the oil cooler thermostat in one component. This allows more convenient access of the oil filter and/or the easy installation of an oil cooler. The following filter mounts offer that versatility; reducing the number of parts and plumbing saves space and cost.

### Mocal Oil Filter Mount w/Thermostat

filter thread	port threads	part#	price
3/4"-16	M22x1.5	RFHT1L left to right flow	\$215.50
3/4"-16	M22x1.5	RFHT1R right to left flow	\$215.50

Viewed from the front, there are two versions of this filter mount: Left to Right flow and Right to Left flow, otherwise specifications are the same: 3/4"-16 filter thread, M22 x 1.5 inlet/outlet, filter o-ring size range 2 1/4" min - 3" max., weight 14.5oz, black anodized 6000 series billet aluminum.

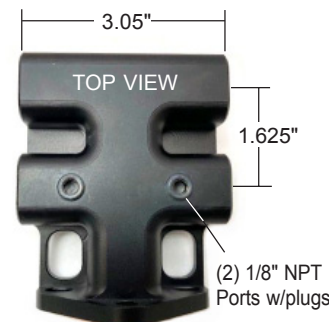
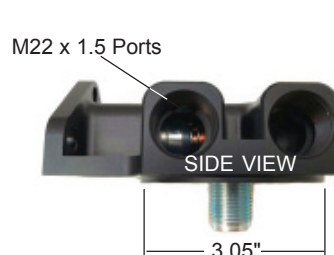
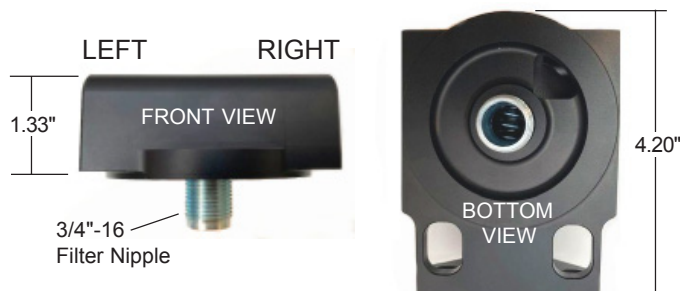
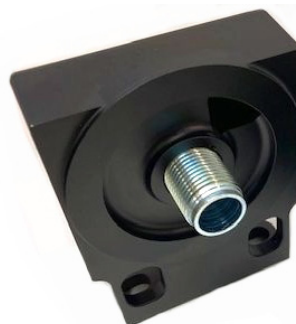

**Setrab**



### Setrab Oil Filter Mount w/Thermostat

filter thread	port threads	part#	price
3/4"-16	M22x1.5	SET-RFHT-LH left to right flow	\$169.00
3/4"-16	M22x1.5	SET-RFHT-RH right to left flow	\$169.00

Viewed from the front, there are two versions of this filter mount: Left to Right flow and Right to Left flow, otherwise specifications are the same: 3/4"-16 filter thread, M22 x 1.5 inlet/outlet, filter o-ring size range 2 1/4" min - 3" max., weight 17oz, metallic anodized aluminum, shown with fittings (sold separately).







## RACING OIL FILTER MOUNT

This large format remote oil filter mount that uses generously sized 22mm inlet/outlet which have greater flow capability over 1/2" NPT. The filter stand is four port type which allows for numerous configurations: left in/out, right in/out, right to left, or left to right. The mounting bracket can even be swapped to that the flow pattern can be switched if you need. All in all a very versatile piece. For filters choose any of the Fram (or alike) HP series racing filters in 13/16" thread. Hardware and (2) M22 plugs are included. Choose M22 x -12AN or -16AN male/male unions (sold separately). *Note -16AN size fittings can only be used in right/left or left right cross configurations, not both in same side.*



### Specifications

- ♦ All aluminum CNC machined housing
- ♦ Interchangeable flow patterns & mounting
- ♦ Large M22 x 1.5 ports are better flowing than 1/2" NPT
- ♦ Uses large can racing oil filters
- ♦ Includes mounting hardware & plugs
- ♦ Made in USA

**HD 4 Port Filter Mount RFH4HD \$99.00**  
for 13/16" thread filter

**3/4"-16 Filter Nipple\* TN1X3/4 \$8.00**  
\*converts RFH4HD to use 3/4"-16 thread filter

**M22 x -8AN Fitting M22AN08-SE \$7.90ea**

**M22 x -10AN Fitting M22AN10-SE \$7.90ea**

**M22 x -12AN Fitting M22AN12-SE \$8.75ea**

**M22 x -16AN Fitting\* M22AN16-SE \$9.60ea**

\*see note comment in description above.





## "FE" ENGINE 427 COBRA FILTER MOUNT & BRACKET

These are reproductions of the oil filter mount (stand) and bracket used on the vintage 427 Cobra allowing the filter to be mounted to the front left of the engine off the water pump. Parts (bracket and mount) can be used together on most Ford "FE" type engines with similar results. Optionally the filter mount could be used on any installation where right hand inlet/outlet is required. Filter stand is cast aluminum with generous fluid passages and 1/2" NPT female ports and accepts standard type 3/4"-16 thread filters. Bracket is supplied in durable black powder coat finish.



**FE Engine Oil Filter Mount RFH4C \$109.20**  
*RH inlet/outlet 1/2" NPT ports uses 13/16" filter*

**Bracket for Filter Mount RMBC \$39.50**  
*Mounts to Ford "FE" type engine water pump*



Threaded adaptors are available in -AN, BSP & metric sizes for all components we offer.



### Oil Filter 90° Degree Adaptor

description	part#	price
Filter Adaptor 90 Degree 3/4-16" filter thread	FHA90	\$109.00

*Handy for engine swaps, kit cars, street rods- moves the filter 90 degrees from the stock (engine block) location. Can be rotated 360 degrees for clearance. For use with 3/4"-16 thread filter applications.*

