

# Setrab

## Oil Coolers

### Pro Line



As the largest stocking distributor of high performance oil coolers in North America, it is logical for us to expand our product coverage and promote a "one stop shopping" approach. For this reason we are adding Setrab oil coolers to our current line which includes; Laminova and our own Mocal brand, giving us the most complete coverage in both air to oil and water to oil cooling

products available. With this in mind, current and future BAT/Mocal jobbers and warehouse distributors have the distinct advantage of access to three product lines without a buy-in requirement on each. Retail customers have access to our technical staff: for inevitable questions and recommendations, and enjoy the benefit of dealing with one source for all their cooling and plumbing needs.

From a size and performance standpoint, Mocal and Setrab oil coolers can be considered interchangeable. Both brands utilize lightweight aluminum construction with internal "turbulators" in the oil-way for maximum efficiency. Cooler sizes are industry standard in one of two core widths, 115mm (series 1) and 235mm (series 6); a wider 310mm (series 9) is available in some core heights in the Setrab brand. All cores are 2" thick. Notable differences between coolers are: Mocal (silver finish with fixed fluid connections- made in England), Setrab (black finish with 22mm female fluid connections- made in Sweden).

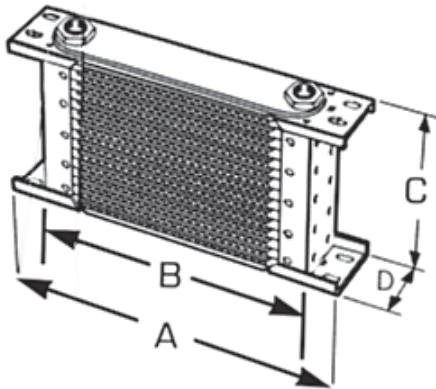

Setrab "Pro Line" oil coolers feature a versatile adaptor fitting system. Select from a range of 22mm x -AN unions or hose ends for direct connection to socketless or stainless braid -AN hose.

- a) Union Adaptor -6 to -16an
- b) Hose End Socketless -6 to -12an
- c) Hose End Swivel -6 to -12an

See next page for complete listing.

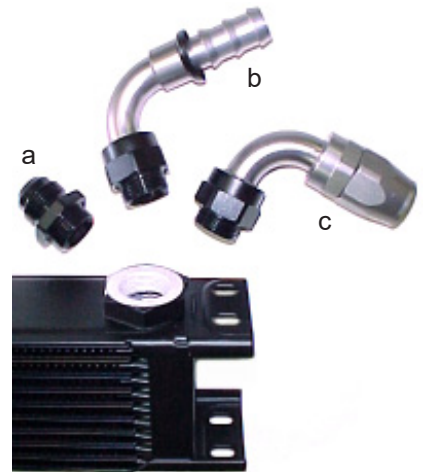

Part #	SERIES 1 DIMENSIONS				03/26 Price
	A	B	C	D	
(107) SET107F22	8.25	6.5	2.0	2.0	\$129.65
(110) SET110F22	8.25	6.5	3.0	2.0	\$149.20
(113) SET113F22	8.25	6.5	4.0	2.0	\$168.70
(116) SET116F22	8.25	6.5	4.75	2.0	\$186.00
(119) SET119F22	8.25	6.5	5.75	2.0	\$205.50
(125) SET125F22	8.25	6.5	7.5	2.0	\$248.75
(134) SET134F22	8.25	6.5	10.25	2.0	\$352.90
(144) SET144F22	8.25	6.5	13.5	2.0	\$465.00
(150) SET150F22	8.25	6.5	15.25	2.0	\$535.00
(160) SET160F22	8.25	6.5	18.5	2.0	\$605.00
(165) SET165F22	8.25	6.5	20.0	2.0	\$653.00
(172) SET172F22	8.25	6.5	22.5	2.0	\$725.00

Part #	SERIES 6 DIMENSIONS				03/26 Price
	A	B	C	D	
(607) SET607F22	13.0	11.25	2.0	2.0	\$163.00
(610) SET610F22	13.0	11.25	3.0	2.0	\$180.00
(613) SET613F22	13.0	11.25	4.0	2.0	\$200.75
(616) SET616F22	13.0	11.25	4.75	2.0	\$224.50
(619) SET619F22	13.0	11.25	5.75	2.0	\$240.30
(625) SET625F22	13.0	11.25	7.5	2.0	\$289.50
(634) SET634F22	13.0	11.25	10.25	2.0	\$422.50
(640) SET640F22	13.0	11.25	12.0	2.0	\$499.00
(644) SET644F22	13.0	11.25	13.5	2.0	\$553.50
(650) SET650F22	13.0	11.25	15.25	2.0	\$609.80
(660) SET660F22	13.0	11.25	18.5	2.0	\$730.50



Representing a 25% increase in cooling area over a standard 235 matrix cooler, Series 9 310mm matrix oil coolers are the widest core size available and are particularly good when a large core is required, but height is limited. We stock Setrab brand series 9 coolers in the following sizes: 10 row, 13 row, 15 row, 19 row, 20 row, 25 row, 34 row and 48 row. Fluid connections are 22mm x 1.5 female for use with Setrab Pro Line adaptors and hose ends (see next page).

Fluid connections are 22mm x 1.5 female for use with Setrab Pro Line adaptors and hose ends (see next page).

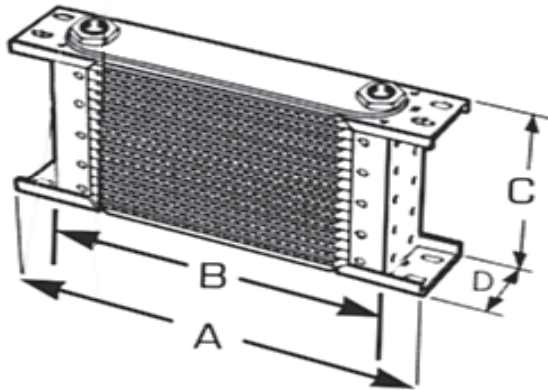

**Series 9 (310mm) Coolers**

Part #	SERIES 9 DIMENSIONS				03/26 Price
	A	B	C	D	
(910) SET910F22	16.0	14.5	3.0	2.0	\$195.00
(913) SET913F22	16.0	14.5	4.0	2.0	\$209.80
(915) SET915F22	16.0	14.5	4.5	2.0	\$237.00
(919) SET919F22	16.0	14.5	5.75	2.0	\$272.00
(920) SET920F22	16.0	14.5	6.0	2.0	\$283.30
(925) SET925F22	16.0	14.5	7.5	2.0	\$367.25
(934) SET934F22	16.0	14.5	10.25	2.0	\$490.00
(948) SET948F22	16.0	14.5	14.75	2.0	\$715.00
(960) SET960F22	16.0	14.5	18.5	2.0	\$759.00

Setrab "Pro Line" oil coolers feature a versatile adaptor fitting system. Select from a range of 22mm x -AN unions or hose ends for direct connection to socketless or stainless braid -AN hose.

- a) Union Adaptor -6 to -16an
- b) Hose End Socketless -6 to -12an
- c) Hose End Swivel -6 to -12an

See next page for complete listing.

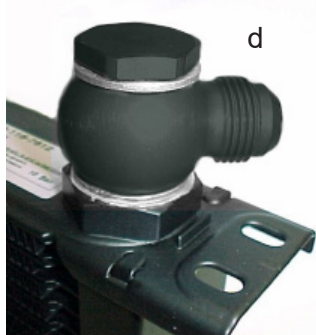
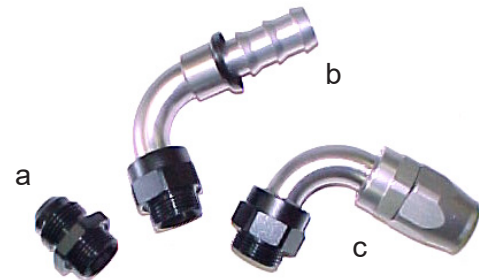

d) Banjo type cooler adaptors are very handy for space limited installations. Available in two sizes, 22mm x -10AN male and 22mm x 8AN male, these banjo adaptors are the most compact connection available (measuring only 1.75" off the top plate of the cooler).

See next page for complete listing.

## Fittings & Adaptors for Setrab Oil Coolers

Setrab Pro Line Series coolers are designed to receive a 22mm male fluid connection; most often this is done with a male/male union which permits connection to any common -AN type female hose end. Another option is to use a specialized "direct to hose" type and connect hose directly to the cooler. These hose end fittings are available for either "socketless" push-on or stainless overbraided "Aeroquip" hose in straight, 45 and 90 degree angles.

### Cooler Adaptor 22mm Male x -AN Male



-AN size	part #	price \$
-6AN	M22AN06-SE	\$7.45
-8AN	M22AN08-SE	\$7.90
-10AN	M22AN10-SE	\$8.95
-12AN	M22AN12-SE	\$8.75
-16AN	M22AN16-SE	\$9.60

### Straight 22mm Male x Braided Hose



-AN size	part #	price \$
-6AN	M22RU06-00	\$15.30
-8AN	M22RU08-00	\$16.50
-10AN	M22RU10-00	\$18.00
-12AN	M22RU12-00	\$20.50

### Straight 22mm Male x Push-on Hose



-AN size	part #	price \$
-6AN	M22PL06-00	\$9.60
-8AN	M22PL08-00	\$11.40
-10AN	M22PL10-00	\$13.15
-12AN	M22PL12-00	\$14.90

### 45 Degree\* 22mm Male x Braided Hose



-AN size	part #	price \$
-6AN	M22RU06-45	\$24.15
-8AN	M22RU08-45	\$27.20
-10AN	M22RU10-45	\$30.00
-12AN	M22RU12-45	\$35.00

\*Swivel Hose End

### 45 Degree 22mm Male x Push-on Hose



-AN size	part #	price \$
-6AN	M22PL06-45	\$23.70
-8AN	M22PL08-45	\$26.30
-10AN	M22PL10-45	\$28.90
-12AN	M22PL12-45	\$31.60

### 90 Degree\* 22mm Male x Braided Hose



-AN size	part #	price \$
-6AN	M22RU06-90	\$24.15
-8AN	M22RU08-90	\$27.20
-10AN	M22RU10-90	\$30.00
-12AN	M22RU12-90	\$35.00

\*Swivel Hose End

### 90 Degree 22mm Male x Push-on Hose



-AN size	part #	price \$
-6AN	M22PL06-90	\$23.70
-8AN	M22PL08-90	\$26.30
-10AN	M22PL10-90	\$28.90
-12AN	M22PL12-90	\$31.60

### 22mm Banjo Accessories



Description	part #
Banjo M22 x -8AN	BJ2208M
Banjo M22 x -10AN	BJ2210M
Banjo Bolt M22 x 1.5	BJBM22
Bonded Seal 22mm	DS-M22

Banjo fittings are the lowest profile option in a fluid connection for Setrab oil coolers.

**Fittings and Adaptors for Setrab Oil Coolers (continued)**

**Cooler Adaptor 22mm Male x BSP Male**



BSP size	part #	price \$
3/8"	M22BS06-SE	\$12.20
1/2"	M22BS08-SE	\$12.20
5/8"	M22BS10-SE	\$13.25
3/4"	M22BS12-SE	\$12.25

Use these adaptors when fitting Setrab coolers to English car applications using BSP factory hoses.

**Cooler Adaptor 22mm Male x Metric Male**



Metric	part #	price \$
M22	AM22AM22	\$13.50
M26	AM22AM26	\$16.95
M30	AM22AM30	\$17.40

Use these adaptors when fitting Setrab coolers to many popular European cars using metric factory hoses.

**Reducer Female x Male (Metric)**



male size	female size	part #
M22x1.5	M12x1.5	912-22-12
M22x1.5	M14x1.5	912-22-14
M22x1.5	M16x1.5	912-22-16
M22x1.5	M18x1.5	912-22-18

Convert Setrab M22 female coolers to accept a variety of smaller M12, M14, M16 & M18 metric unions, adaptors and banjos. These are especially helpful when trying to connect to factory hoses on European and Swedish cars.

**Oil Cooler Mounting**

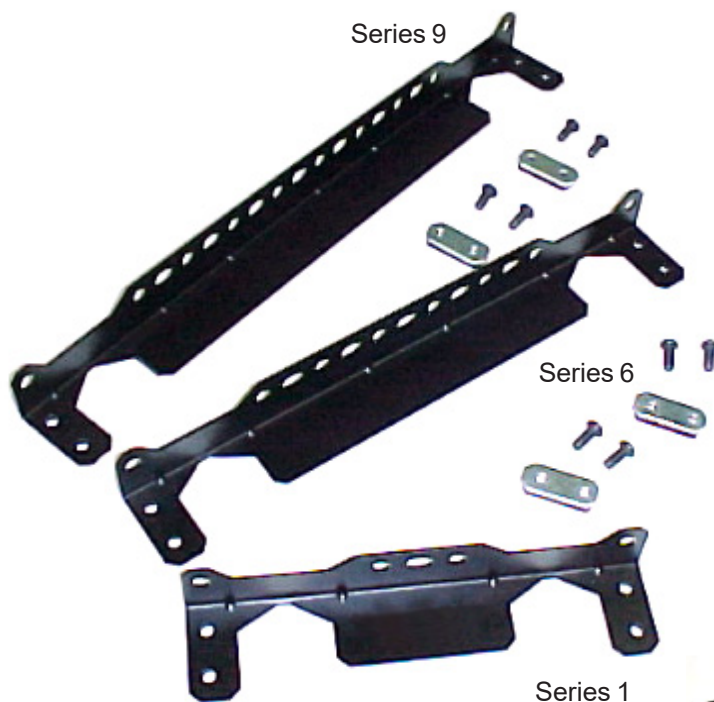

**Oil Cooler Mounting Bracket**

Description	part #	price \$
Cooler Mount (S1)	ABKT-115	\$19.50
Cooler Mount (S6)	ABKT-235	\$23.70
Cooler Mount (S9)	ABKT-310	\$27.15

These versatile formed aluminum brackets provide the most secure method for mounting radiator type oil coolers. Brackets incorporate rubber damping pads to reduce vibration and are available in three widths: Series 1, Series 6 and Series 9. Shorter height coolers (less than 16 row) can use single bracket off one end, larger cores should be supported from both ends. Sold (1) for each cooler end; includes one bracket with hardware.

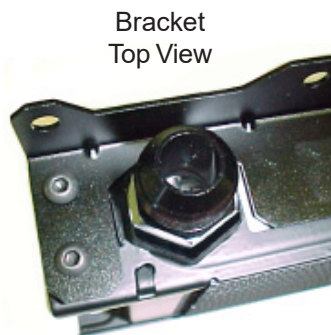

Bracket Top View



Bracket Side View

**Setrab Oil Coolers with Fans (Fan Packs)**



**20 Row Series 9  
Dual 5.25" Fan Pack**



**13 Row Series 1  
4" Fan Pack**



**19 Row Series 1  
5.25" Fan Pack**

**Oil Coolers & Fans (Fan Packs)**

03/26

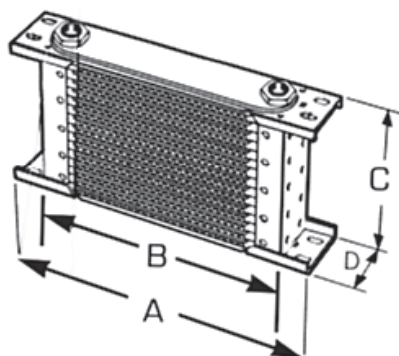

Description	part #	price \$
13 Row Series 1 w/4" fan A) 8.25" B) 7.5" C) 4" D) 4" (2" core, 2" fan) 150cfm fan	SET113FP	\$315.000
19 Row Series 1 w/5.25" fan A) 8.25" B) 7.5" C) 6" D) 4" (2" core, 2" fan) 340cfm fan	SET119FP	\$340.00
20 Row Series 9 w/dual 5.25" fans A) 16" B) 15" C) 6.5" D) 4" (2" core, 2" fan) 2x 340cfm fans (680)	SET920FP	\$555.00
25 Row Series 6 w/6.5" fan A) 16" B) 15" C) 6.5" D) 4" (2" core, 2" fan) 330cfm fan	SET625FP	\$500.00
34 Row Series 6 w/9" fan A) 13" B) 11.25" C) 10.25" D) 4.25" (2" core, 2.25" fan) 630cfm fan	SET634FP	\$667.00
48 Row Series 9 w/12" fan A) 16" B) 15" C) 15" D) 4.25" (2" core, 2.25" fan) 1240cfm fan	SET948FP	\$1000.00
50 Row Series 6 w/dual 6.5" fans A) 16" B) 15" C) 15" D) 4" (2" core, 2" fan) 2x 330cfm fans (660)	SET650FP	\$855.00
60 Row Series 1 w/3x 5.25" fans A) 8.25" B) 7.5" C) 20" D) 4" (2" core, 2" fan) 3x 340cfm fans (1020)	SET160FP	\$850.00



**34 Row Series 6  
9" Fan Pack**



**25 Row Series 6  
6.5" Fan Pack**



**50 Row Series 6  
Dual 6.5" Fan Pack**

*If your application involves low vehicle speeds, restrictive air flow or static industrial cooling installations, a Fan Pack is the logical answer. Setrab versions of the Fan Pack utilize 22mm female connections (see elsewhere in this section for fluid connections). Above prices include: oil cooler, fan shroud and fan(s). Supplied fans are "puller" blade configuration.*

## Oil Cooler Fans & Mounting



25 Row (S6)  
6.5" Fan &  
Shroud



13 Row (S1)  
4" Fan &  
Shroud

### Fan & Mounting Shroud (less cooler)

Description	part #	price \$
Fan & Shroud Series 1 13 Row <i>single 4" fan</i>	FP113KIT	\$140.50
Fan & Shroud Series 1 19 Row <i>single 5.25" fan (also fits 25-72 row Series 1 coolers)</i>	FP119KIT	\$145.00
Fan & Shroud Series 6 25 Row <i>single 6.5" fan</i>	FP625KIT	\$200.00
Fan & Shroud Series 6 34 Row <i>single 9" fan</i>	FP634KIT	\$250.00
Fan & Shroud Series 6 50 Row <i>dual 6.5" fans</i>	FP650KIT	\$405.00
Fan & Shroud Series 9 20 Row <i>dual 5.25" fans</i>	FP920KIT	\$275.00
Fan & Shroud Series 9 48 Row <i>single 12" fan</i>	FP948KIT	\$280.00



19 Row (S1)  
5.25" Fan &  
Shroud

Already have a 113, 119, 625, 634, 650, 920 or 948 size oil cooler and want to add a fan? This kit includes fan, shroud/brackets and hardware from our complete cooler fan packs, less the oil cooler. Fans have water-resistant motors and are supplied in "puller" blade configuration. The 119 version can also be fitted to a portion of a larger 44, 50, 60, 72 row series 1 (115mm) cooler or use multiples fans for increased coverage.

### Oil Cooler Fan Mounting Strips

Description	part #	price \$
Cooler/Fan mounting strips	ABKT1	\$16.45

Special slim gauge nylon "zip strip" mounting provide a simple and secure method for mounting fans to oil coolers, water radiators or intercoolers. They can also be used to mount oil coolers to water radiators or alike components. Kit includes four heavy duty tie mounts with protective foam pads for easy installation.

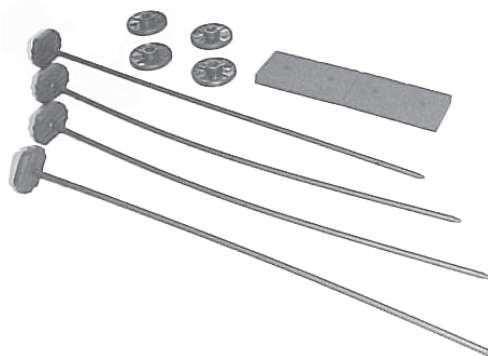

**Fan Accessories**

**Fan Switches & Associated Parts**

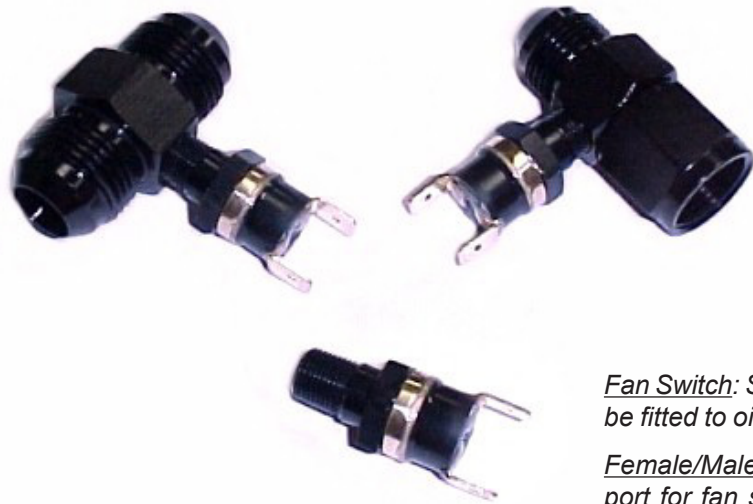

Description	part #	price \$
Fan Switch 180 Deg	FS180	\$22.50
Fan Switch 190 Deg	FS190	\$22.50
Fan Switch 200 Deg	FS200	\$22.50
-8AN Male/Female	GA8MF-2	\$12.60
-8AN Male/Male	GA8MM-2	\$10.60
-10AN Male/Female	GA10MF-2	\$16.25
-10AN Male/Male	GA10MM-2	\$14.25
-12AN Male/Female	GA12MF-2	\$19.50
-10AN Male/Male	GA12MM-2	\$17.10

*Fan Switch:* Small preset f°degree switch with 1/8" NPT male thread can be fitted to oil coolers or plumbing to activate auxiliary fan(s).

*Female/Male:* Installs over an existing -AN male. Provides (1) 1/8" NPT port for fan switch or gauge sender. Adds about 1" additional length depending on size.

*Male/Male:* Installs in hose. Provides (1) 1/8" NPT port for fan switch or gauge sender. Adds about 1 1/2" additional length to hose depending on size.

**Fan Relay 12v with Harness**

Description	part #	price \$
12v Relay	Relay12	\$8.50

Fans should be supplied power through a relay which provides power directly from 12v source. Use a fan switch (above) or manual switch (you provide) to trigger relay. Harness/plug included, 12 volt 30/40 amp rated.

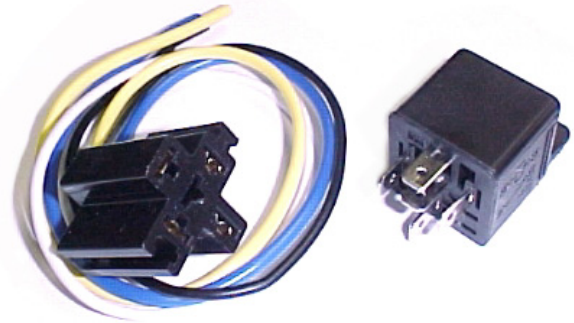
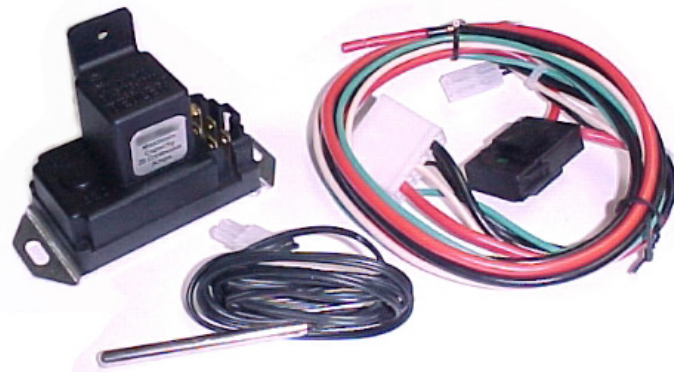

**Fan Wiring Kit - Adjustable 150f - 240f**

Description	part	price \$
Fan Wiring Kit Adjustable	AFTR1	\$105.00

Adjustable turn-on range 150f - 240f fan wiring kit uses push-in probe sensor. Turn-off is -10f lower than turn on. Controller has simple potentiometer control for temperature set and incorporates 40amp relay. Override circuit is built in for manual switch or trigger with a/c compressor (on). Wiring and fuse holder is included. Sensor is a serviceable part.

**Oil Cooler Ducting**



OCD13, OCD16



16 row 616 Cooler w/ OCD16

**Oil Cooler Ducting**

Description	part #	price \$
Duct for 13 row	OCD13	\$83.10
Duct for 16 row	OCD16	\$89.50
Duct for 19 row	OCD19	\$94.00

Oil cooler ducting is a simple and effective way to maximize cooling performance, especially when the cooler is mounted in a reduced airflow location. Available for 6 series size 13, 16 and 19 row coolers, brackets and hardware are included. Hose connections are single 3" or 3.5" on 13 and 16 row size and double 2.5" or 3" on the 19 row size. Maximum depth required is 6" (other dimensions are the same as cooler matrix area).



OCD19



**Universal Cooler Mounting Brackets (pair)**

Description	part #	price \$
Cooler Mounts (pair)	OCB1	\$21.50

These reinforced steel brackets offer a universal mounting solution for all sizes and widths of Mocal and Setrab oil coolers, with options for orientation. Brackets feature a durable powdercoated finish and 70A durometer damping pads to help isolate coolers from vibration. Sold as a pair (2) and include rubber damping, threaded backing plates and hardware.



# Slimline Series Oil Coolers

Slimline series oil coolers offer an alternative to standard 1-9 series oil coolers. With a range of unique sizes and thinner 1.25" core profile, their lightweight aluminum construction is perfectly suited to the high performance motor racing market. Slimline coolers are available in four core lengths and three row heights incorporating mounting bosses and 22mm female boss for flexible fluid connection options. Uses: engine oil cooling, transmission & differential cooling, water cooling radiator for "hot side" of air/water intercooling systems.

**NEW**



Dimensions: Slimline Oil Coolers (SLM)

Part no.	Type	Length		Height		Depth		C/C M6 studs
		Core	Total	Core	Total	Core	Total	
53-10740	SLM 141-06	141	204	52	64	31	40	90
53-10741	SLM 141-10	141	211	88	100	31	40	90
53-10742	SLM 141-14	141	211	124	138	31	40	90
53-10743	SLM 250-06	250	313	52	64	31	40	200
53-10744	SLM 250-10	250	320	89	103	31	40	200
53-10745	SLM 250-14	250	320	124	138	31	40	200
53-10746	SLM 420-06	420	483	53	67	31	40	320
53-10747	SLM 420-10	420	490	89	103	31	40	320
53-10748	SLM 420-14	420	490	124	138	31	40	320
53-10749	SLM 592-06	592	655	53	67	31	40	492
53-10750	SLM 592-10	592	662	89	103	31	40	492
53-10751	SLM 592-14	592	662	124	138	31	40	492

Total height= incl mountingpoints





## Dimensions: Slimline Oil Coolers (SLM)

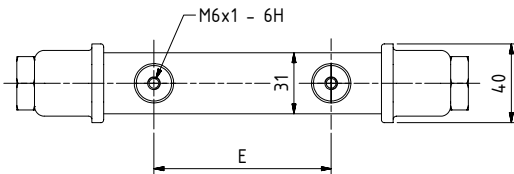
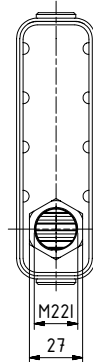
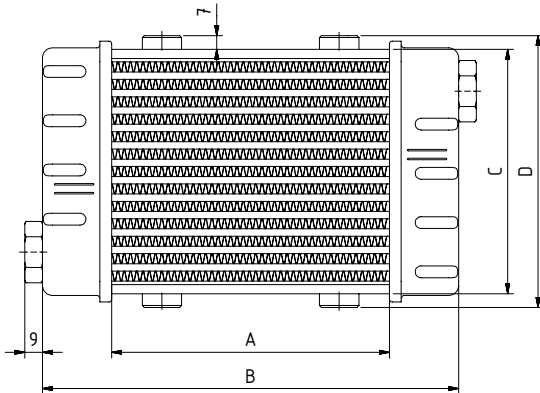

Measure explanation and Part no. for Pro Line SLM-cooler						
Part no.	Type	A	B	C	D	E
53-10740*	SLM 141-06	141	204	52	64	90
53-10741*	SLM 141-10	141	211	88	100	90
53-10742	SLM 141-14	141	211	124	138	90
53-10743*	SLM 250-06	250	313	52	64	200
53-10744	SLM 250-10	250	320	89	103	200
53-10745	SLM 250-14	250	320	124	138	200
53-10746	SLM 420-06	420	483	53	67	320
53-10747	SLM 420-10	420	490	89	103	320
53-10748	SLM 420-14	420	490	124	138	320
53-10749	SLM 592-06	592	655	53	67	492
53-10750	SLM 592-10	592	662	89	103	492
53-10751	SLM 592-14	592	662	124	138	492

\*Two mounting studs on top plate only



To simplify selection, use this approximate performance comparison between traditional (standard) type oil cooler cores and Slimline (SLM).

Standard	SLM	Notes:
S1 10 row	141-06	<i>Core Reference:</i> S1 = Series 1 115mm core S6 = Series 6 235mm core S9 = Series 9 310mm core
	141-10	
S1 13 row	141-14	
S1 16 row		
S1 19 row	250-06	
S6 10 row	420-06	
S1 25 row	250-14	
S6 13 row	592-06	
S9 10 row	420-10	
S6 16 row		
S1 44 row		<i>input parameters:</i> oil type: 20/50 oil flow: 4.5 gpm input temp: 235f air temp: 80f airflow: 75mph
S6 19 row		
S1 50 row	420-14	
S9 15 row	592-10	
S1 60 row		
S6 25 row		
S1 65 row		
S9 20 row		
S1 72 row	592-14	

### 2025 Slimline Cooler Pricing

Part Number	Price \$
SLM141-06	\$286.40
SLM141-10	\$310.90
SLM141-14	\$340.45
SLM250-06	\$310.90
SLM250-10	\$340.45
SLM250-14	\$377.50
SLM420-06	\$351.00
SLM420-10	\$377.50
SLM420-14	\$419.50
SLM592-06	\$387.50
SLM592-10	\$451.00
SLM592-14	\$510.00



SLimline oil coolers are also available in a number of smaller sizes that are well suited to motorcycle and other small engine applications. Sizes and specifications below. Fluid connections are normally push-on barb. *Click on link or photo for dimensional drawings.*

3050 6-row universal (w/tabs)	A: 8.25" B: 2.5" C: 1.5"	\$208.20	
3080 14-row universal (w/tabs)	A: 8.25" B: 5.2" C: 1.5"	\$296.25	
3090 6-row universal	A: 8.25" B: 2.5" C: 1.5"	\$208.20	
3100 6-row universal	A: 8.25" B: 2.5" C: 1.5"	\$208.20	
3110 6-row universal	A: 8.25" B: 2.5" C: 1.5"	\$208.20	
3120 10-row universal	A: 8.25" B: 4.0" C: 1.5"	\$272.45	
3130 10-row universal	A: 8.25" B: 4.0" C: 1.5"	\$272.45	
3140 10-row universal (-6AN)	A: 8.25" B: 4.0" C: 1.5"	\$272.45	





## Front Spoiler Oil Coolers

M22 Female Port Accepts (shown w/ M22 plug, others optional)



M22 Female Port Accepts (shown w/ -12AN union, others optional)

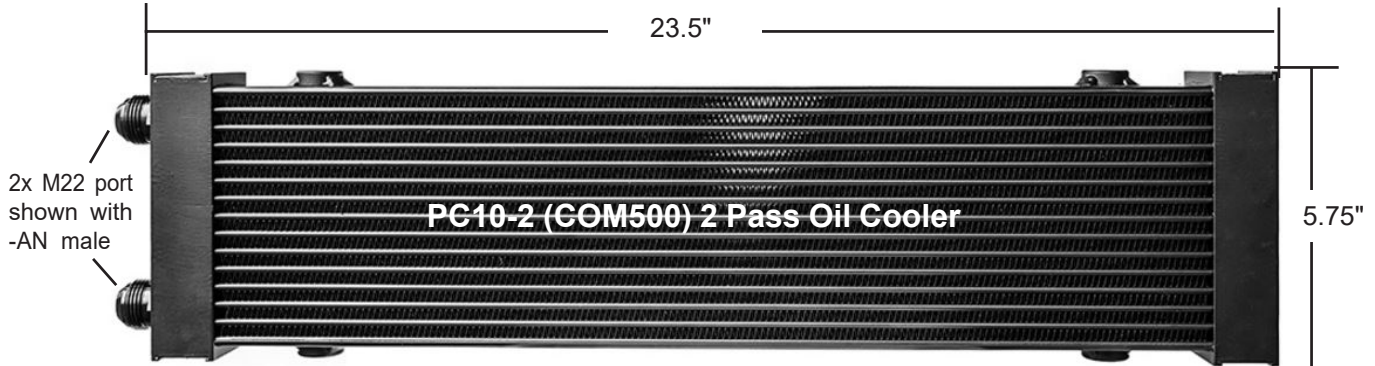
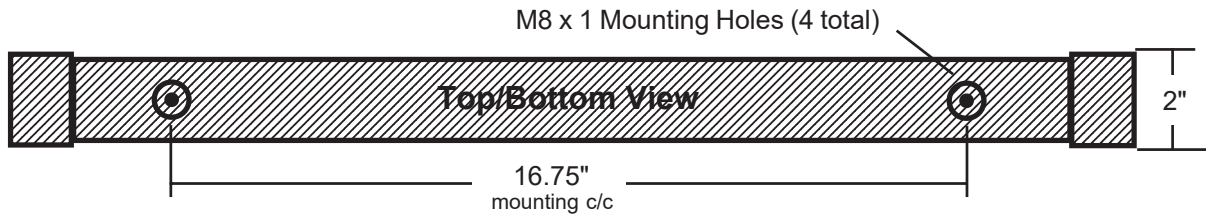

These large, versatile oil coolers make fitting front spoiler applications a breeze. The competition derived PC10 oil cooler is a cross flow type with one fluid connection per side. Oil flows across cooler, side to side using one of the two provided ports at end or rear. The remaining 2 ports are plugged or may be fitted with a temperature sender for use with a gauge. For installations where fluid connection is preferred on the same side we offer a dual pass version, the PC10-2, with both fluid connections on one side (oil flows across cooler and returns to the same side). Fluid connection ports on both PC10 and PC10-2 are M22 x 1.5 female thread which accepts -AN (-12, -16) or metric (M26, M30) size plumbing.

<b>Cross Flow Oil Cooler</b>	<b>PC10</b>	<b>\$795.00</b>
<b>Dual Pass Oil Cooler</b>	<b>PC10-2</b>	<b>\$795.00</b>



**Back to HOME**

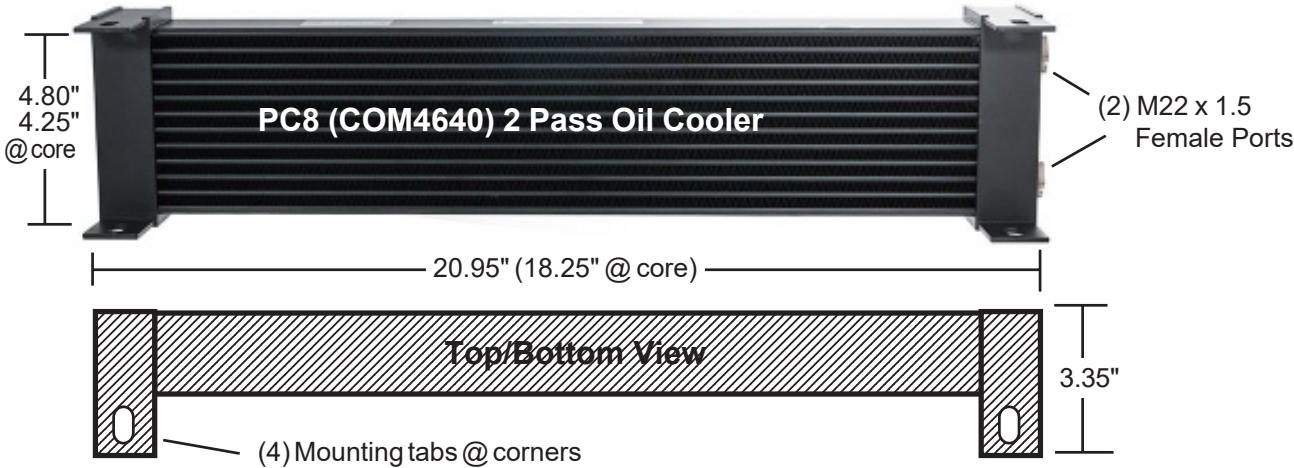

The competition derived COM4640 oil cooler is a 2 pass type with both fluid connection on one side (oil flows across cooler and returns to the same side). Fluid connection ports are M22 x 1.5 female thread which accepts -AN (-12, -16) or metric (M26, M30) size plumbing. To aid in installation, cooler is constructed with mounting tab at four corner points.

**2 Pass Flow Oil Cooler                      COM4640                      \$570.00**