

Product Description

Furine® Vet is a non-invasive fecal management system designed for application to the perianal skin of animal patients with diarrhea. The system diverts liquid fecal matter away from the skin and into a collection bag, thereby helping to protect the skin and maintain a clean care environment.

The Furine Vet system allows liquid fecal matter to seep from the anal opening through the device and into the fecal collection bag (Furine Collect).

Intended Use

Furine Vet is intended to divert and collect liquid fecal matter from animal patients with diarrhea, to:

- Protect perianal skin
- Reduce skin exposure to fecal effluent
- Maintain hygiene in veterinary care environments

The device is intended for use on patients producing stool types 6 or 7 according to the Bristol Stool Scale (BSS).

Intended Users and Use Environment

- Intended users: Trained veterinary professionals
- Intended environment: Veterinary medical care settings

Contents

- 1 x Furine Vet device
- 1 x Furine Collect
- 1 x Securin Skin Barrier
- 2 x Securin Adhesive Remover Wipe



Duration of Use

- Furine Vet may be used for up to 7 days, provided skin integrity is maintained and proper adhesion is ensured.
- Furine Collect must be replaced daily, or more frequently if required.

Contraindications

Do not use Furine Vet on patients with:

- Solid or formed stools
- Rectal prolapse
- Perianal sores
- Known allergy or sensitivity to any of the device components.

Warnings and Precautions

- Single-use device. Do not reuse or reprocess. Reuse may result in infection or cross-contamination.
- Do not sterilize Furine Vet or its components.
- Discontinue use immediately if perianal skin irritation, inflammation or infection occurs.
- Ensure the skin is clean, dry and intact prior to application.
- Use only Furine ApS-recommended accessories with this device.
- Furine ApS is not responsible for damage or injury resulting from use outside the instructions or recommendations provided.

Materials Information

- Securin Adhesive Remover Wipes and Securin Skin Barrier contain siloxane.
- Safety Data Sheets (SDS) are available upon request.

MRI Information

- MRI safety has not been evaluated.
- Not intended for use in human MRI environments

For additional information or technical assistance, please visit www.furine.com



Consult instructions for use

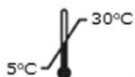

Storage conditions



Non-Sterile



Single Use



Batch code
See primary packaging



Use-by date
See primary packaging



Reference code
See primary packaging



Legal Manufacturer

Furine ApS
Industrivaenget 1
3320 Skaevinge
Denmark

IFUV10Y-01US 2026-02



Preparation:

1. Remove hair from the perianal skin to allow attachment of the adhesive base.
2. Cleanse and thoroughly dry the perianal skin.
 - Ensure the skin is completely dry and intact.
 - Prepare the skin using **Securin Adhesive Remover Wipe** to ensure firm adhesion.
 - Do **not** use other skin barrier film products.
3. If necessary, adapt the adhesive base to fit the patient's anatomy.

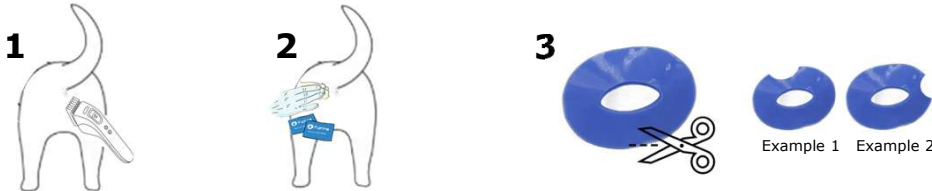

Application:

4. Apply Securin Skin Barrier to the exposed skin around anus using the swab stick.
 - Apply in a width slightly larger than the size of the adhesive base.
 - **Note:** The entire adhesive base must adhere to skin treated with Securin Skin Barrier.
5. Allow the Securin Skin Barrier to dry completely for 1-2 min. Hold the tail up, if necessary.
 - **Important:** The Securin Skin Barrier must be **completely dry** before applying Furine Vet.
 - Application to wet or partially dry Securin Skin Barrier will result in reduced adhesion and leakage.
6. Using the applicator, position Furine Vet around the anus on the perianal skin where Securin Skin Barrier has been applied. Press the entire adhesive base firmly onto the skin.
7. Carefully remove the applicator while holding Furine Vet in place with the other hand.
 - Press the adhesive base firmly **again** to ensure full contact.
8. Remove excess Securin Skin Barrier from surrounding skin using the second Securin Adhesive Remover Wipe provided.
9. Attach Furine Collect by pressing it on to the outlet of the tube (1). Insert the safety hooks (2) into the holes in Furine Collect. The hanger (3) can be used to position the bag on the side of the cage, if appropriate.

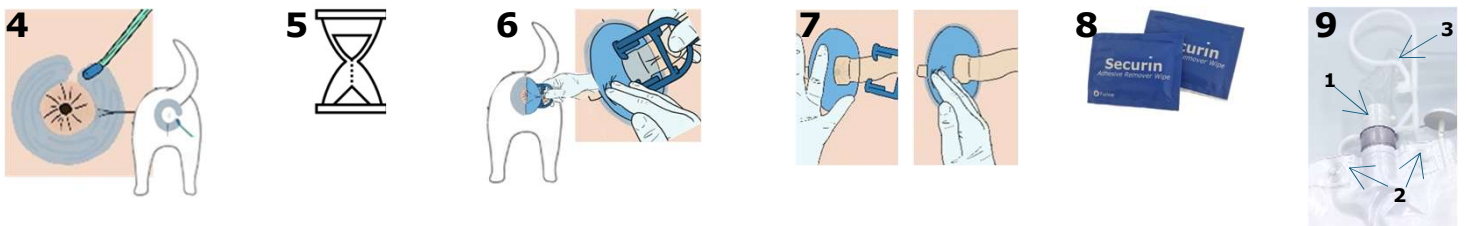

Maintenance:

Regular maintenance optimizes wear-time and performance. Maintenance should be done every two hours, and includes:

1. Ensure the tube is not kinked or stretched and that free passage is maintained.
2. Press firmly on the entire surface of the adhesive base to reinforce adhesion.
3. Inspect for leakage. If leakage is detected, repair using Securin Skin Barrier.

Removal:



1. Remove Furine Vet using Securin Adhesive Remover Wipe and/or Spray as recommended by Furine ApS.
2. Gently lift an edge of the adhesive base while wiping with 2-3 Wipes and/or spraying adhesive remover.
3. Carefully remove all residue of Securin Skin Barrier from the skin.

Do not:

- use wipes that have dried out.
- use wipes or sprays that are not siloxane-based.

Disposal:

Dispose of used Furine Vet and accessories in accordance with local regulations and procedures.