



20557 Grace Ave
Pierre, SD 57501



286-2,400 SF +/-



For Lease

LOCATION

These premium shop spaces in Pierre, SD offer a variety of features and amenities to fit your needs. A professionally managed HOA will take care of all exterior maintenance, allowing you to spend more time on the things that matter!

DESCRIPTION

- Private Bathroom
- Heated Shop
- Shop Sink
- Floor Drain
- Water & Sewer
- LED Lighting
- Hose Hookups
- Optional mezzanine, additional shop sink, and other amenities available at tenants request. Additional fees may be applied.

FACILITY LAYOUT

BUILDING #1

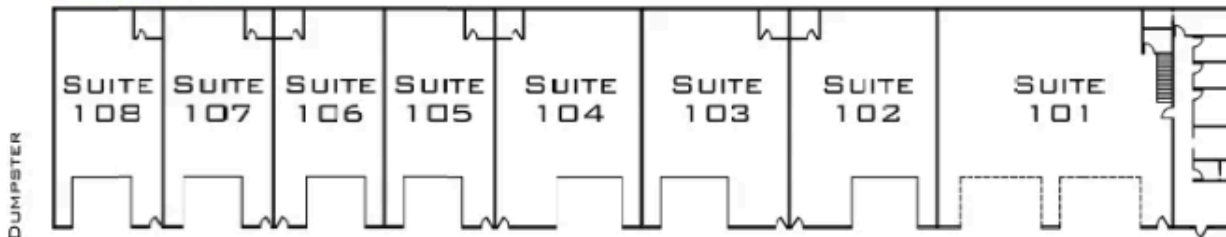

BUILDING #2

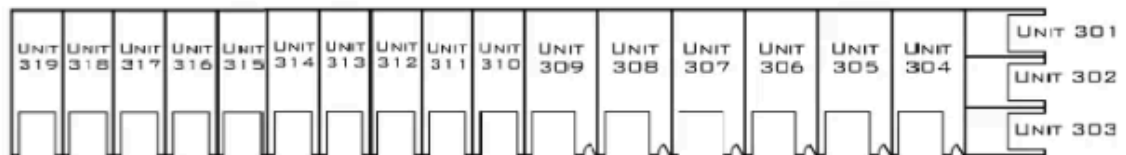
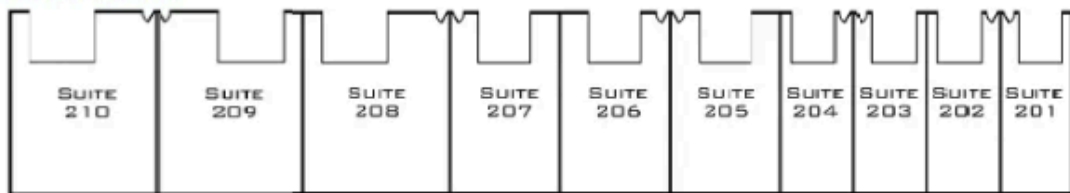

BUILDING #3

BUILDING #4



FLOORPLANS

BUILDING 1-2

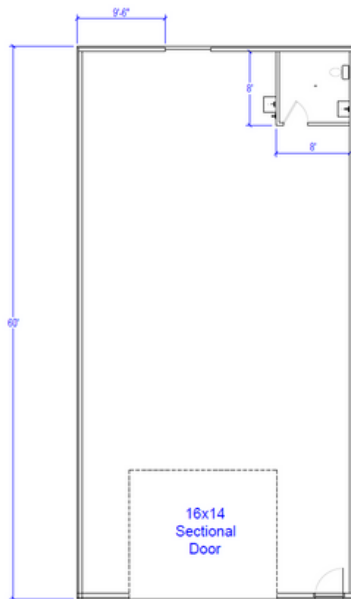

Building 1 - 30x60
(1,800 sq ft)

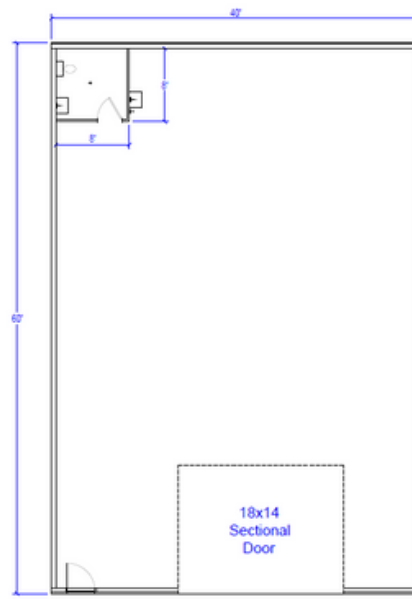

Building 1 - 40x60
(2,400 sq ft)

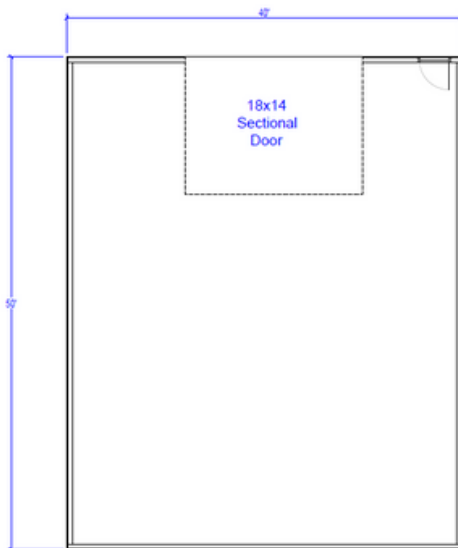

Building 2 - 40x50
(2,000 sq ft)

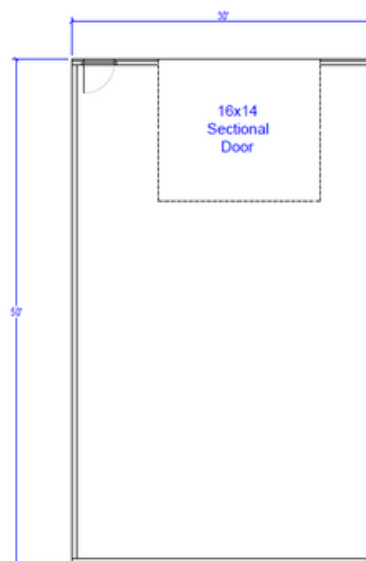

Building 2 - 30x50
(1,500 sq ft)

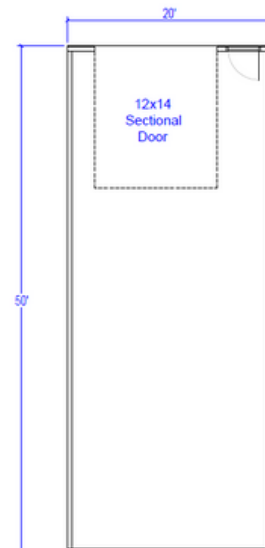

Building 2 - 20x50
(1,000 sq ft)

FLOORPLANS

BUILDING 3

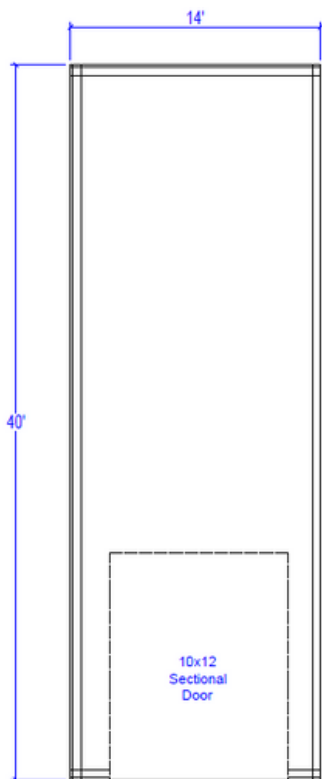

Building 3 - 14x40
(560 sq ft)

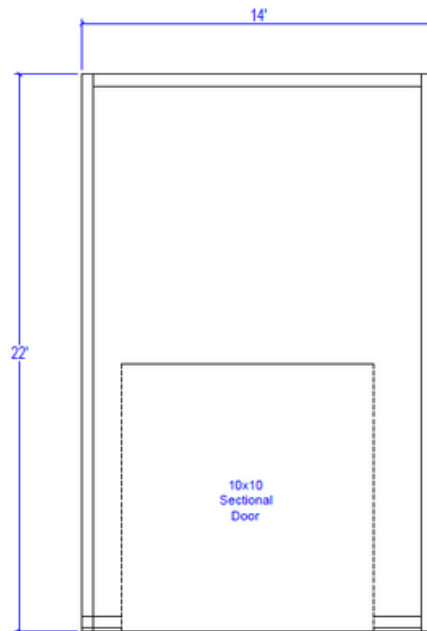

Building 3 - 14x22
(308 sq ft)

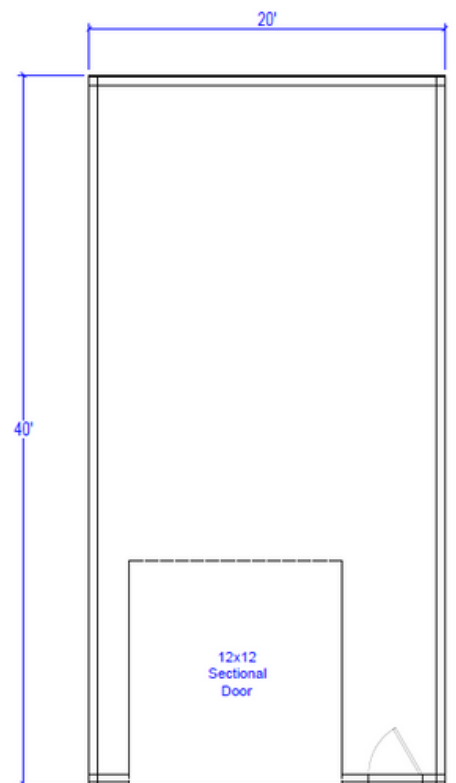

Building 3 - 20x40
(1,000 sq ft)

PHOTO GALLERY

***Amenities vary by unit size**

