

Monopolar Survey: Abbott Informity

Meredith Hatcher, PA-C, CMRD

February 20, 2026



AMDAPP
Association of Movement Disorder Advanced Practice Providers

Jessica Karl – Relevant Financial Relationships

- No disclosures to report.

All relevant financial relationships have been mitigated

Outline

1. Monopolar survey – Overview
2. Abbott platform – Buttonology
3. Infirmity

Monopolar survey

- Completed ~3-4 weeks post-DBS surgery
- Determine benefit and side effect threshold of each electrode level on the DBS lead
 - Individual segment review completed at a subsequent visit
- **Goal:** to determine the most optimal electrode level
- PD patients:
 - Completed in the medication-OFF state
- Abbott has the Informity tool to assist in performing and documenting the monopolar survey

Mono-polar survey with Infirmity



Patient Controller NR
Version 3.11



Patient Controller RC
Version 2.0

Infinty™ and Liberta™ RC DBS systems

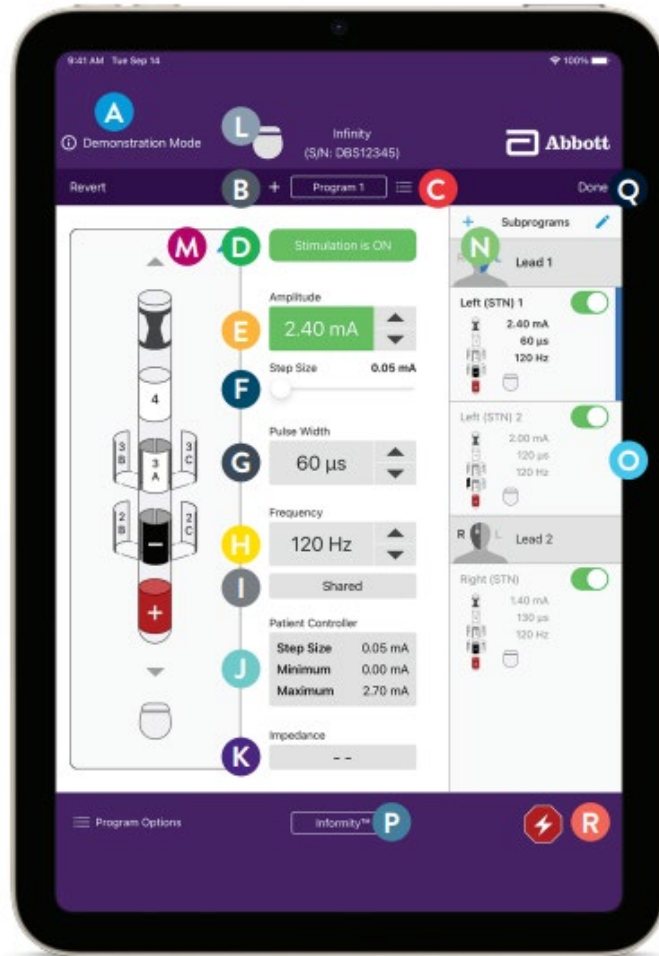

- A PATIENT AND SYSTEM HEADER**
Tap on the patient's name to allow you to edit the name and add other pertinent patient information. For Liberta RC™ DBS Systems, you can access saved reports here.
- B CREATE NEW PROGRAM**
- C MANAGE PROGRAM**
- D STIMULATION ON/OFF**
- E AMPLITUDE ADJUSTMENT**
- F AMPLITUDE ADJUSTMENT STEP SIZE**
- G PULSE WIDTH**
- H FREQUENCY ADJUSTMENT**
- I FREQUENCY MODE**

- J PATIENT CONTROLLER ADJUSTMENT SETTINGS**
- K IMPEDANCE CHECK**
- L SYSTEM INFORMATION**
Access logs and battery life information, and activate MRI or surgery mode.
- M LEAD CONFIGURATION**
- N ADD AND EDIT SUBPROGRAMS**
(in shared frequency mode)
- O MULTISTIM™ PROGRAMMING FEATURE TOGGLE**
(in shared frequency mode)
- P INFORMITY™ PROGRAMMING SOFTWARE**
- Q SAVING AND CLOSING SESSION**
- R EMERGENCY SHUTOFF**

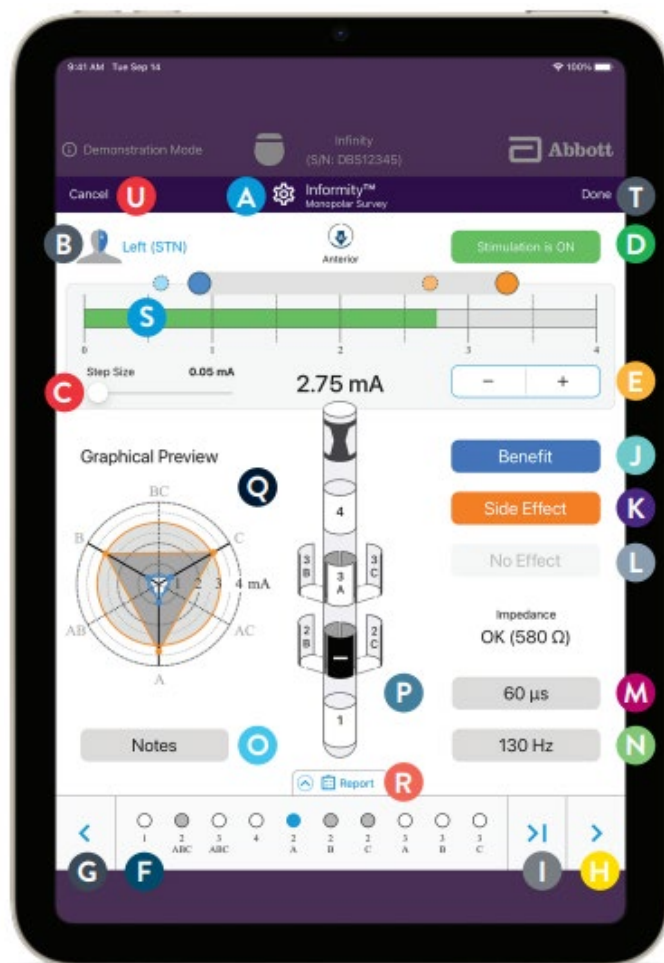

- A MONOPOLAR SURVEY SETTINGS**
Adjust default settings and information presented during survey.
- B SELECT HEMISPHERE**
- C AMPLITUDE ADJUSTMENT STEP SIZE**
- D STIMULATION ON/OFF**
- E AMPLITUDE ADJUSTMENT**
- F CONTACT SELECTION BAR**
- G SELECT PREVIOUS CONTACT**
- H SELECT NEXT CONTACT**
- I CONTACT SELECTION BAR NAVIGATION**
- J RECORD THERAPY BENEFIT**
Select partial or complete and managed symptom.

- K RECORD SIDE EFFECT**
Select transient or sustained and observed side effect.
- L RECORD NO EFFECT OBSERVED**
- M PULSE WIDTH**
- N FREQUENCY ADJUSTMENT**
- O RECORD NOTES**
- P SELECT CONTACT**
- Q PREVIEW GRAPHICAL REPORT**
- R ACCESS REPORTS**
- S STIMULATION AND THERAPEUTIC WINDOW DISPLAY**
- T COMPLETE MONOPOLAR SURVEY**
- U CANCEL MONOPOLAR SURVEY**

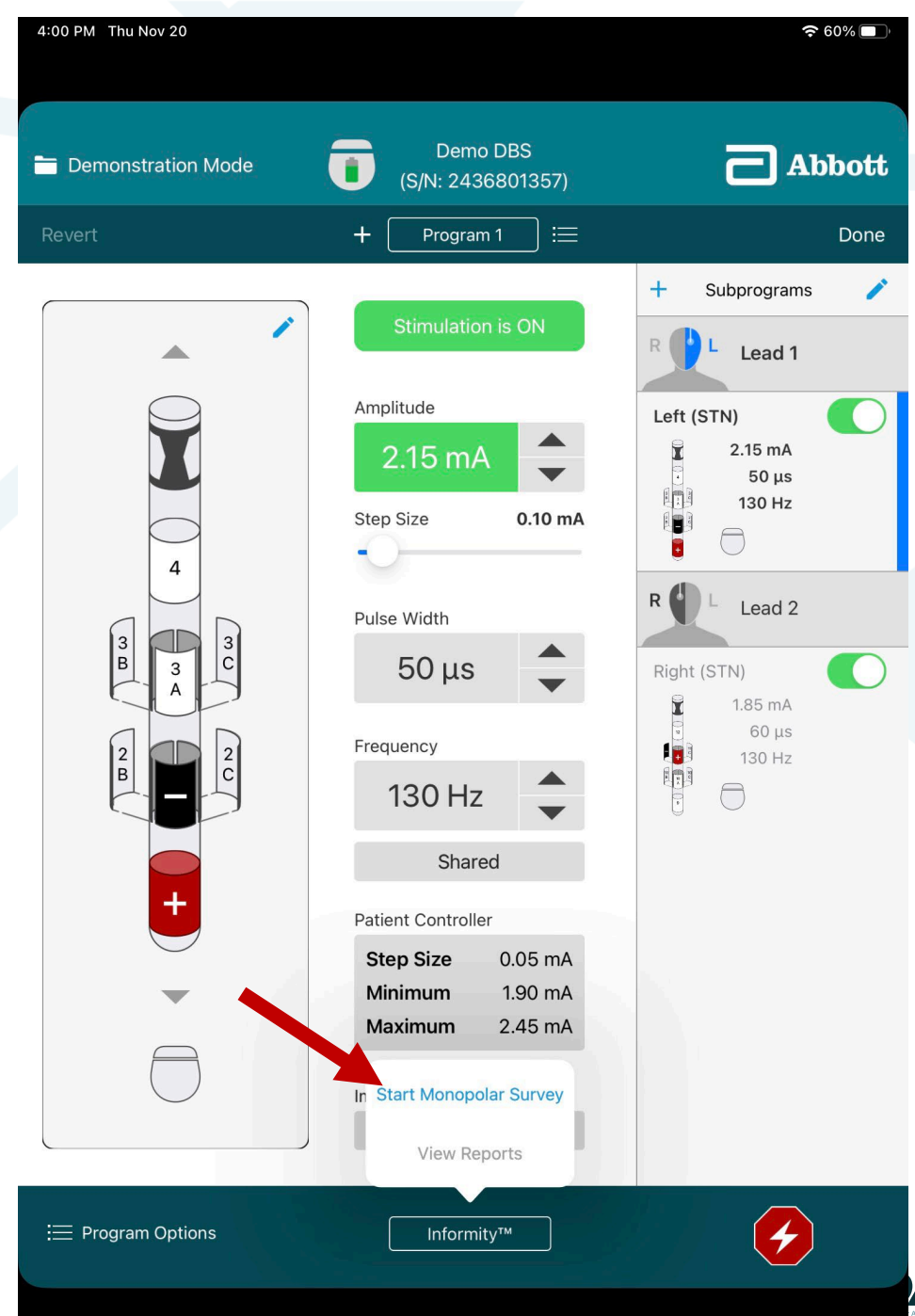
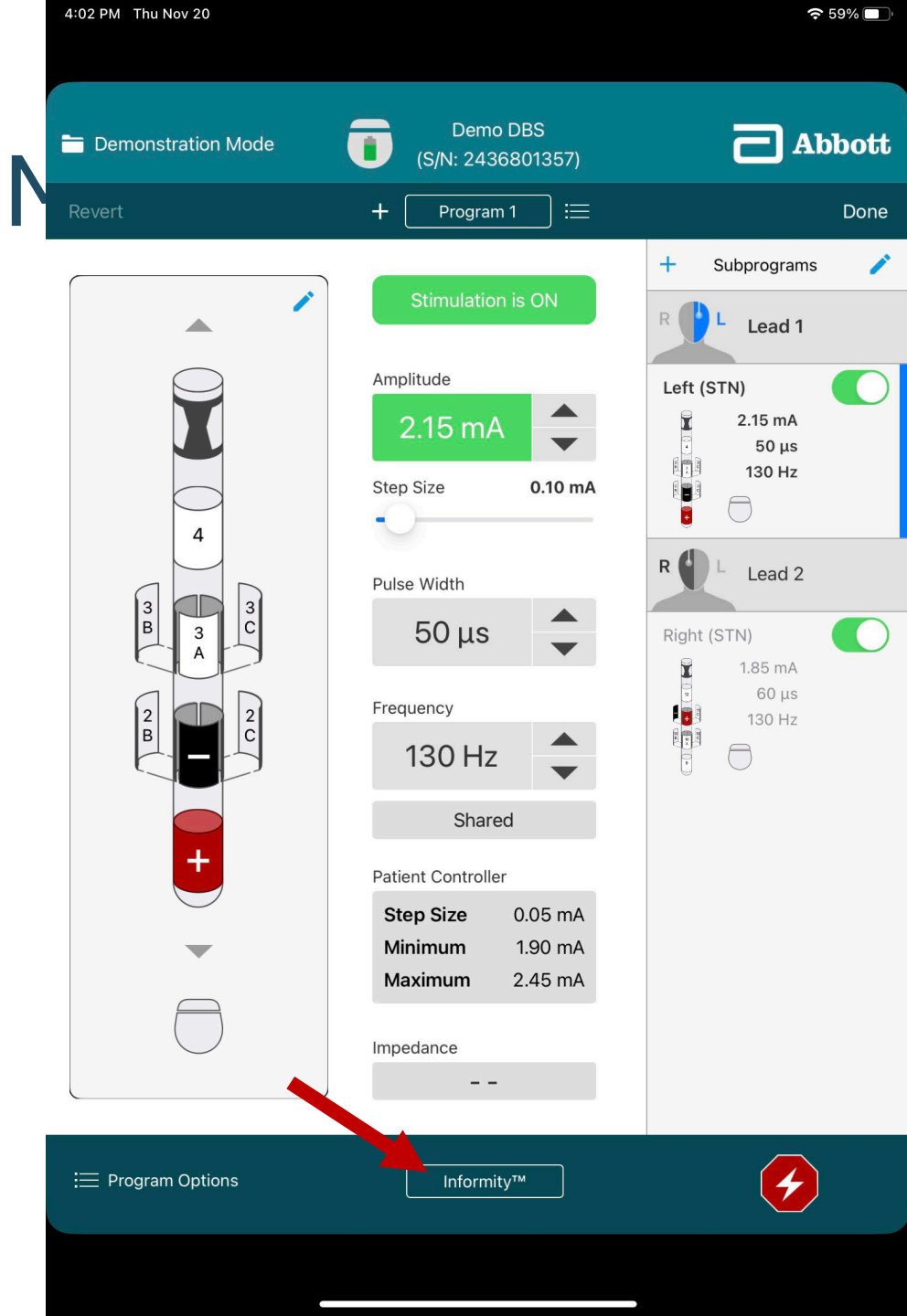

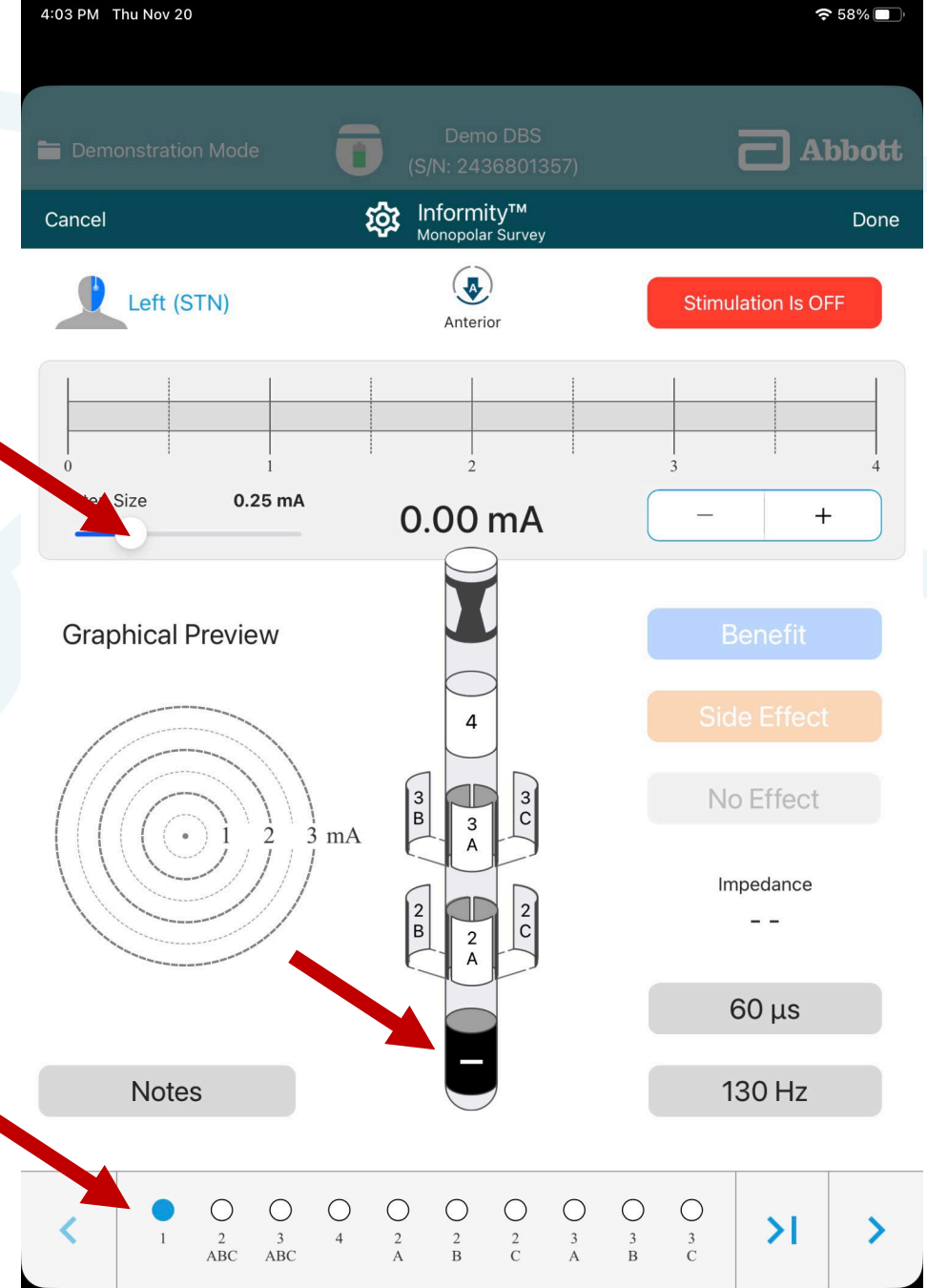
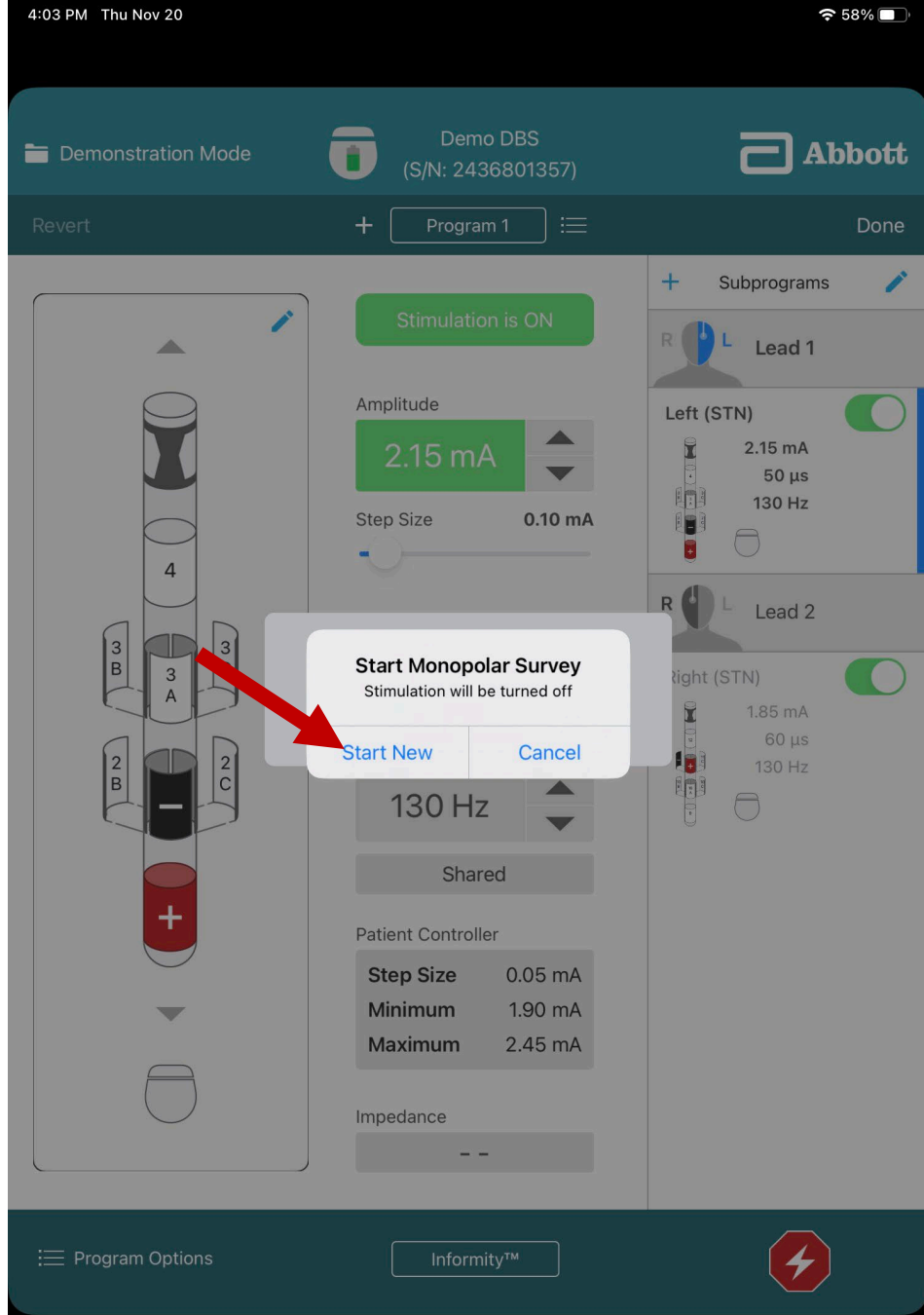

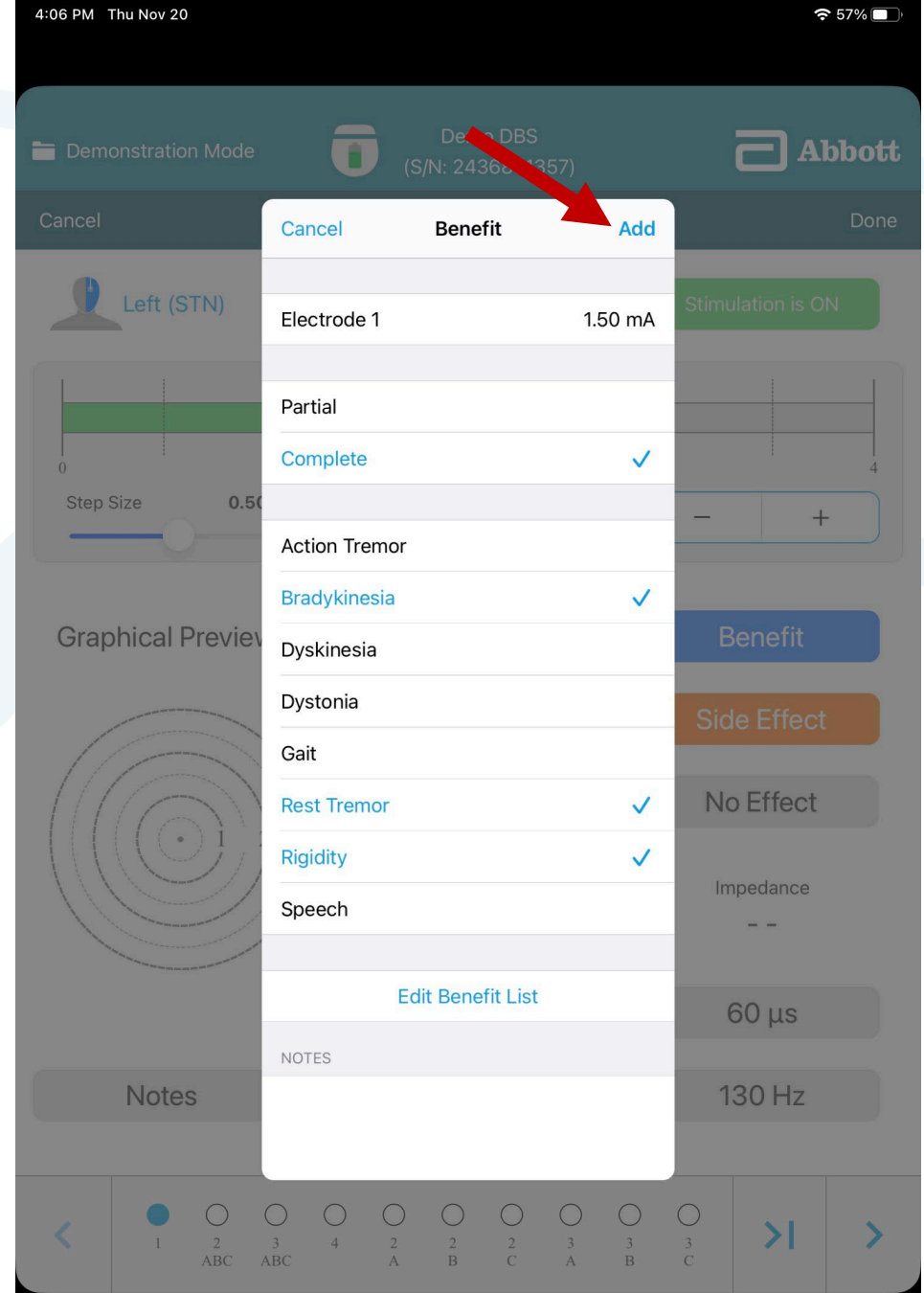
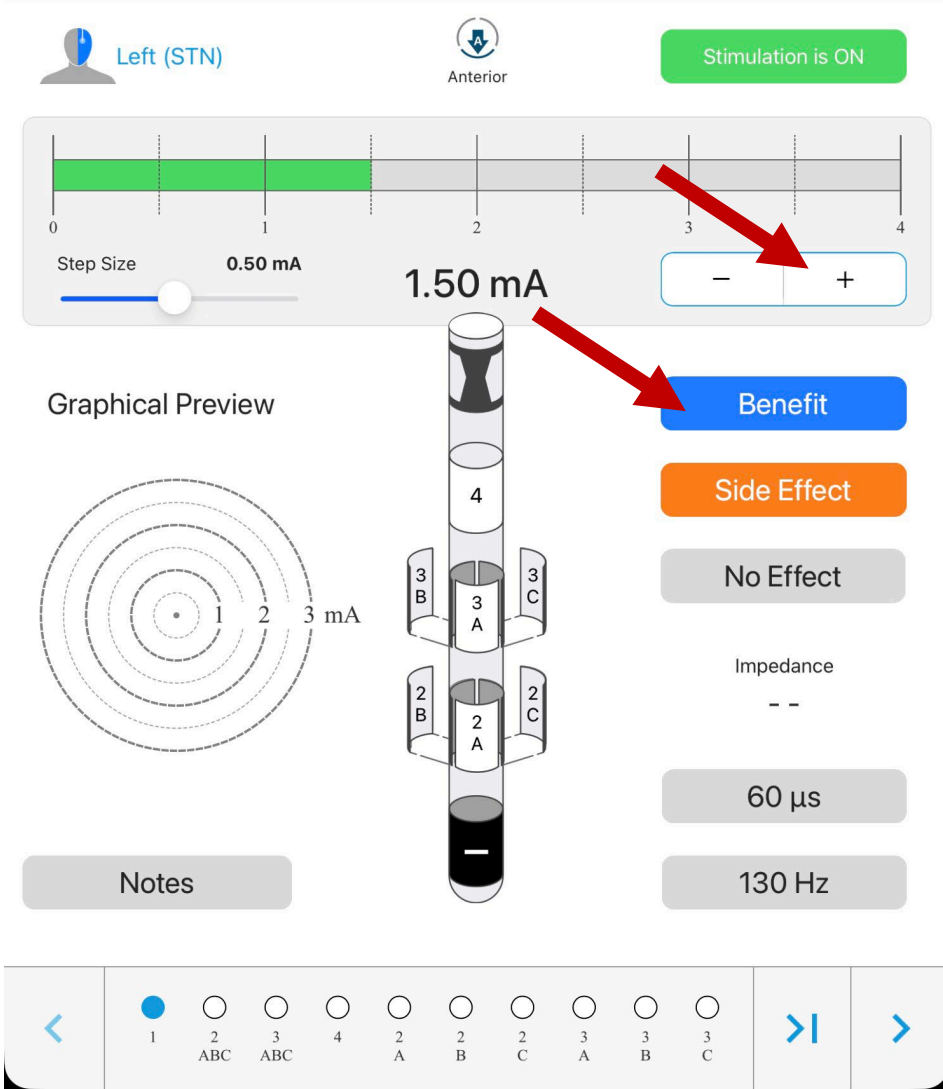

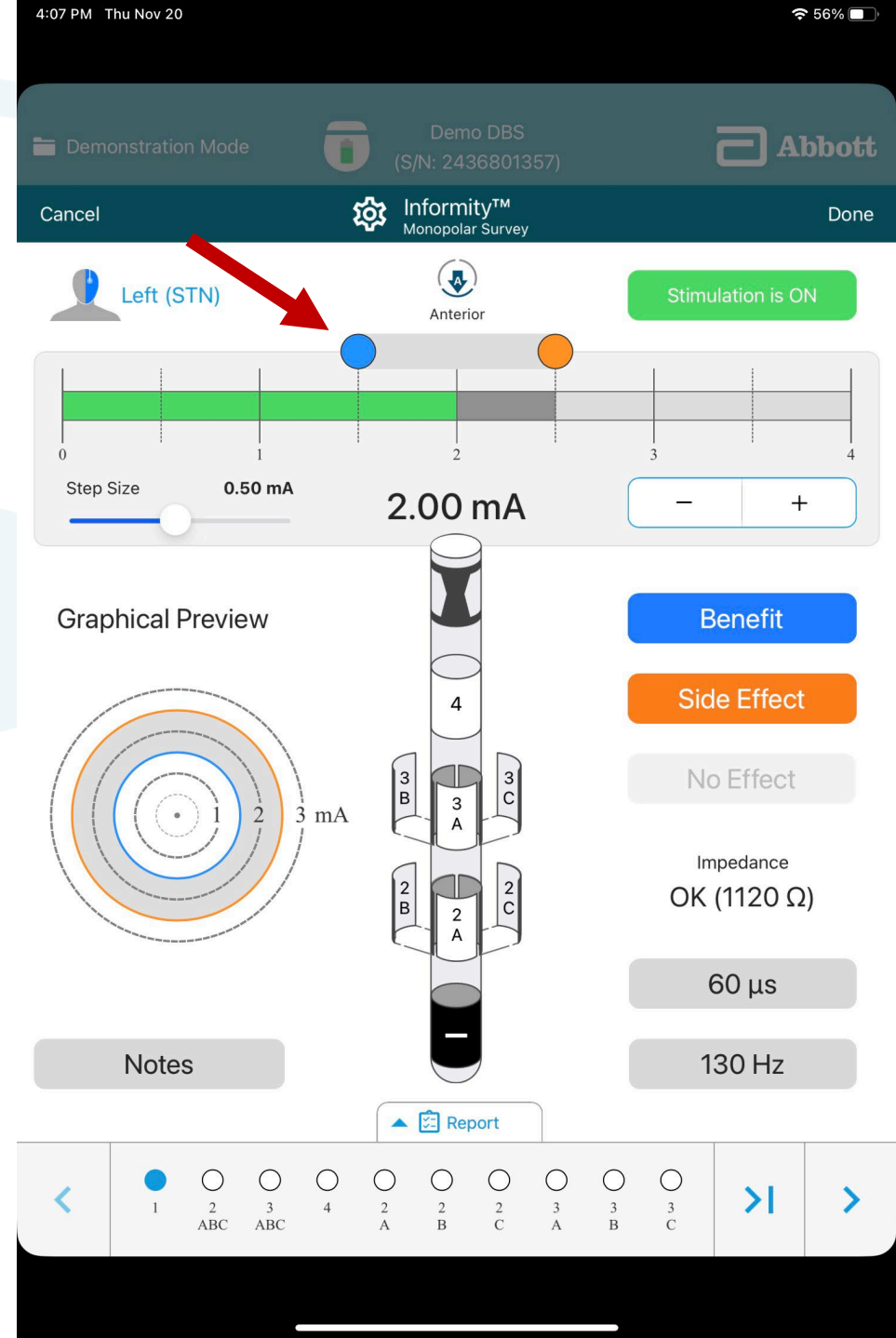
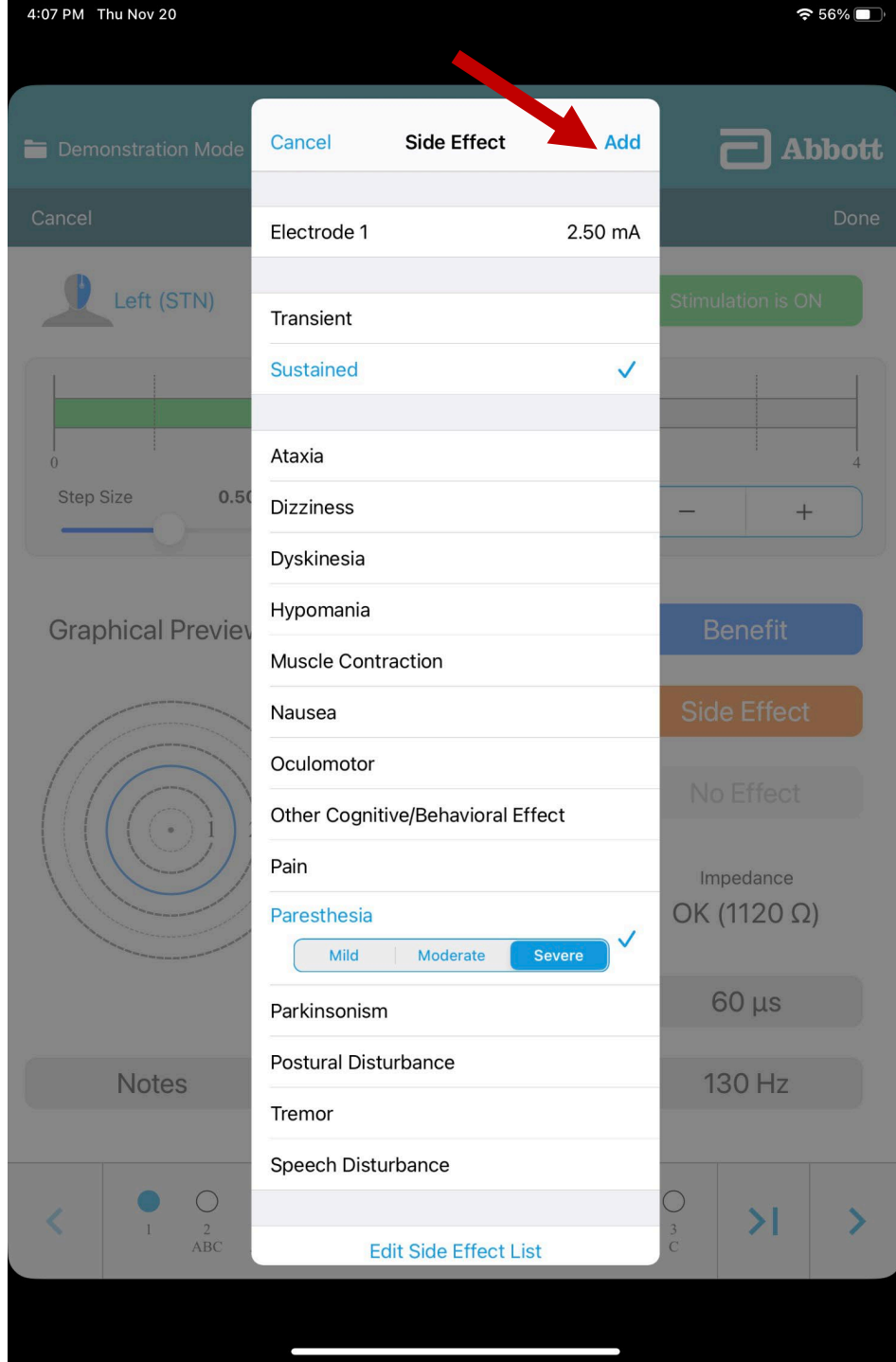

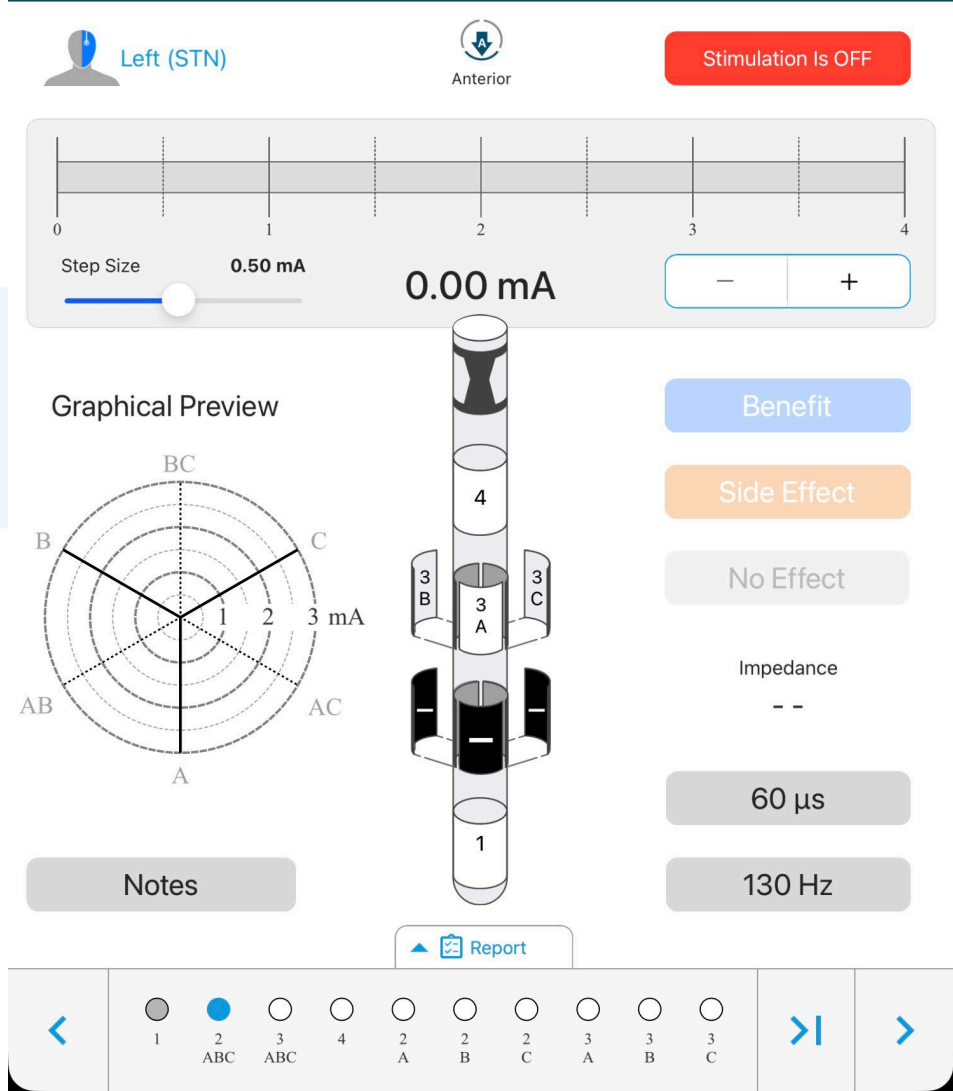
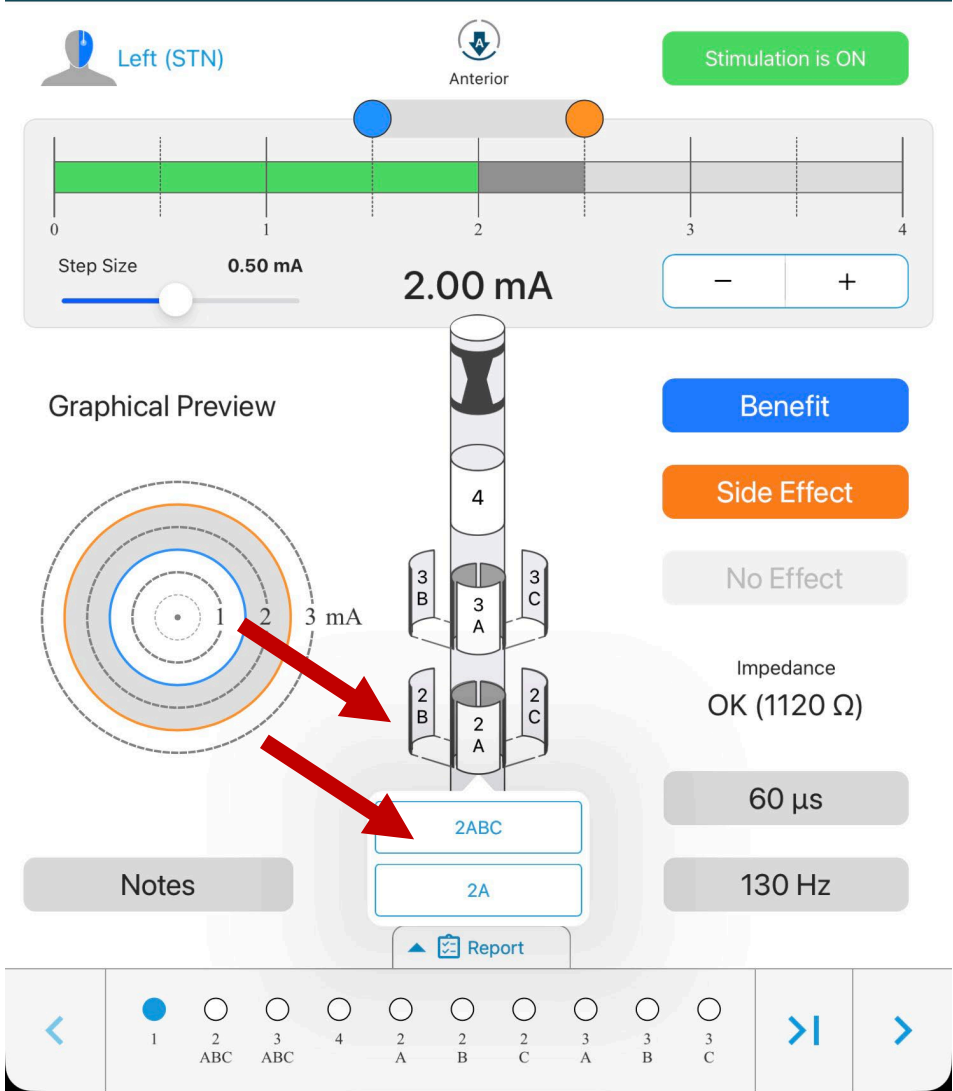

4:10 PM Thu Nov 20 55%

Demonstration Mode Demo DBS (S/N: 2436801357) Abbott

Cancel Informity™ Monopolar Survey Done

Left (STN) Anterior Stimulation is ON

0 1 2 3 4

Step Size 0.50 mA 3.00 mA - +

Graphical Preview

BC B C 4 mA 3 B 3 A 3 C 1 2 3 4

AB AC A

Notes

Report

Benefit Side Effect No Effect

Impedance OK (1120 Ω)

60 μ s 130 Hz

1 2 ABC 3 ABC 4 2 A 2 B 2 C 3 A 3 B 3 C

4:11 PM Thu Nov 20 55%

Demonstration Mode Demo DBS (S/N: 2436801357) Abbott

Cancel Informity™ Monopolar Survey Done

Left (STN) Anterior Stimulation is ON

0 1 2 3 4

Step Size 0.50 mA 3.00 mA - +

Graphical Preview

BC B C 4 mA 3 B 3 A 3 C 1 2 3 4

AB AC A

Notes

Report

Benefit Side Effect No Effect

Impedance OK (1120 Ω)

60 μ s 130 Hz

1 2 ABC 3 ABC 4 2 A 2 B 2 C 3 A 3 B 3 C

2ABC 2A

4:11 PM Thu Nov 20 55%

?

Suggestion
A lower step size of 0.25 is recommended when testing electrode 2A because the benefit threshold for 2ABC was 2.50 mA.

Ignore Do It

Cancel Informity™ Monopolar Survey Done

Left (STN)

Anterior

Stimulation Is OFF

Step Size 0.50 mA

0.00 mA

— +

Graphical Preview

Benefit

Side Effect

No Effect

Impedance --

60 μ s

130 Hz

Notes

Report

1 2 ABC 3 ABC 4 2 A 2 B 2 C 3 A 3 B 3 C

4:12 PM Thu Nov 20 54%

Demonstration Mode

Demo DBS (S/N: 2436801357)

Abbott

Cancel Informity™ Monopolar Survey Done

Left (STN)

Anterior

Stimulation is ON

Step Size 0.25 mA

2.50 mA

— +

Graphical Preview

Benefit

Side Effect

No Effect

Impedance OK (1120 Ω)

60 μ s

130 Hz

Notes

Report

1 2 ABC 3 ABC 4 2 A 2 B 2 C 3 A 3 B 3 C

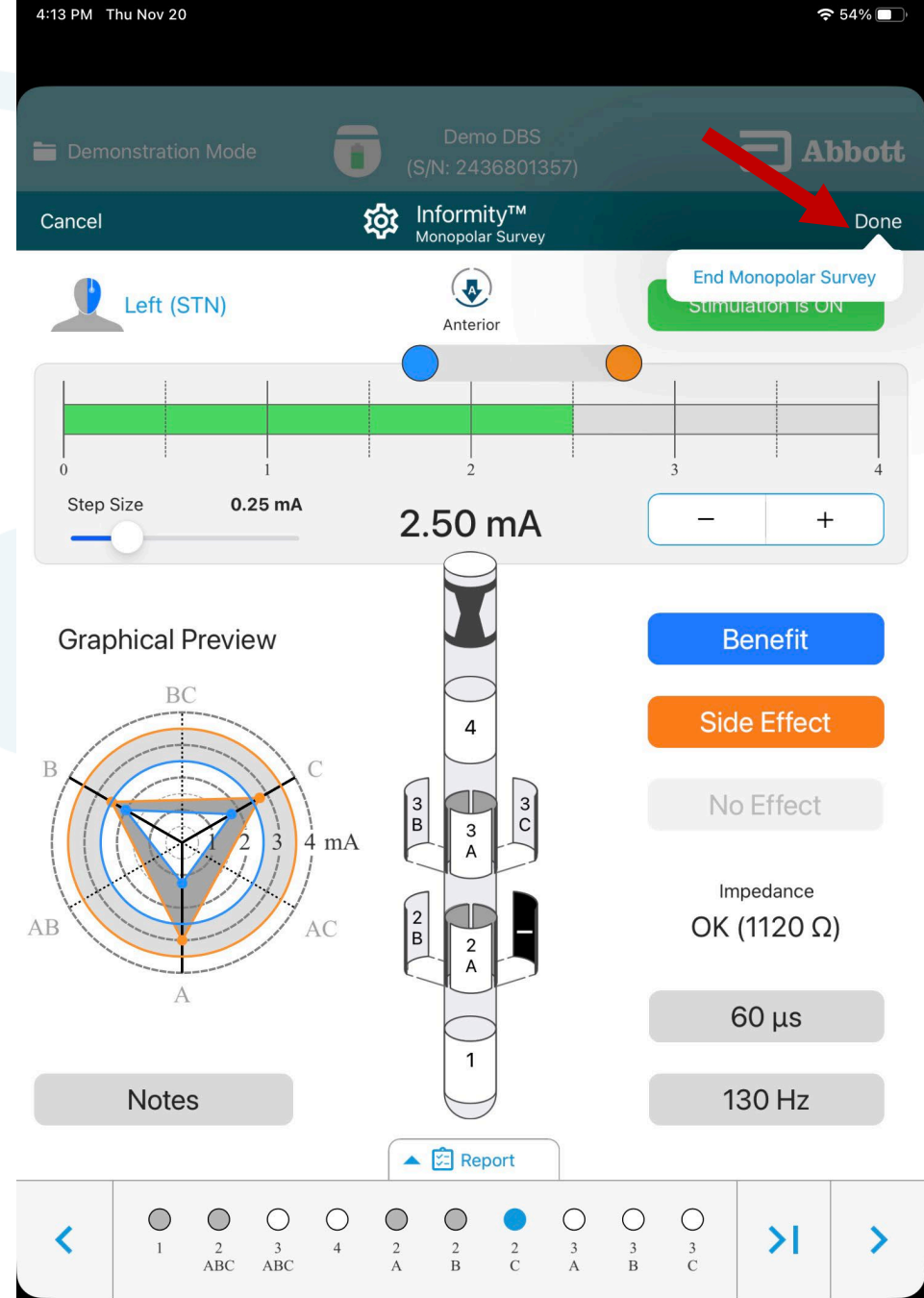
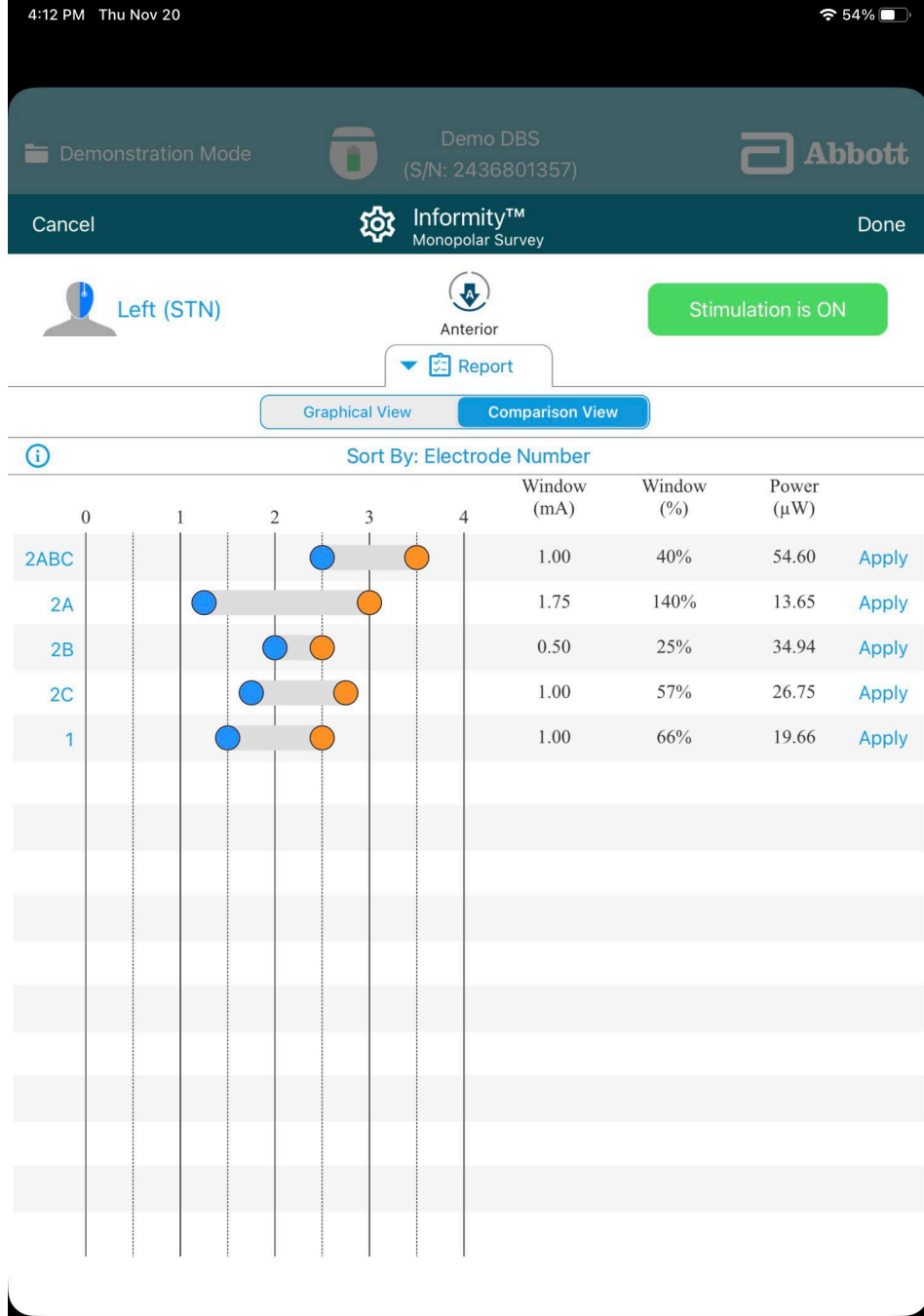

[< Back](#)

Jack Shephard

Overview

Patient Devices

Patient Information

Notes

Reports

Session Reports

Program Impedance

System Impedance

Informity™ Records

Therapy Events

Charging History

Informity™ Records

PERSONALLY IDENTIFIABLE INFORMATION

 PII [Include >](#)



Demo DBS (62400)

Serial Number
2436801357

Patient BirthDate: 01/01/0001

Port 1 (1-8): Infinity 1-3-3-1 (1.29 x 1.5 mm) (6171)

Port 2 (9-16): Infinity 1-3-3-1 (1.29 x 1.5 mm) (6171)

Implant Date: 11/15/2025

 11/20/2025 [4:03 PM >](#)

FACTOR TO CONSIDER DURING DIRECTIONAL PROGRAMMING

-Laterality with SSA

IMPACT OF SINGLE SEGMENT, TWO SEGMENT AND THREE SEGMENT ACTIVATION ON VTA LATERALITY

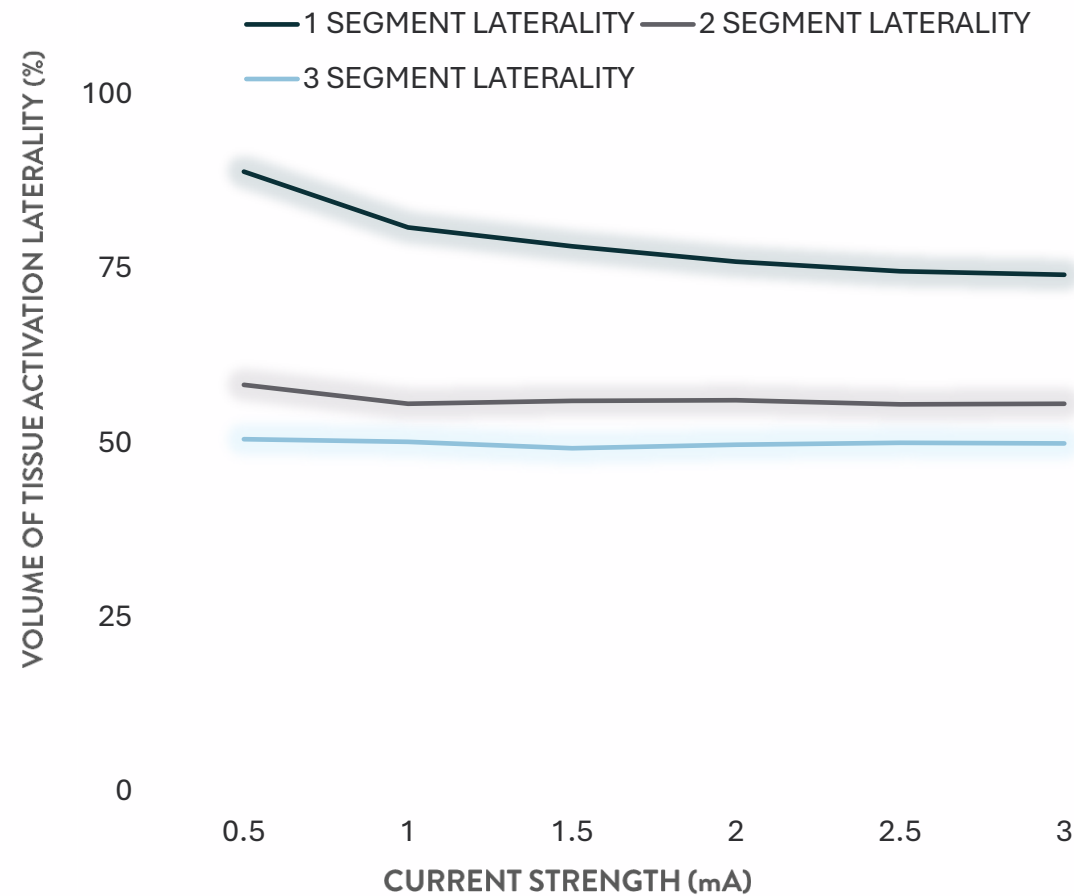

FACTORS TO CONSIDER DURING DIRECTIONAL PROGRAMMING

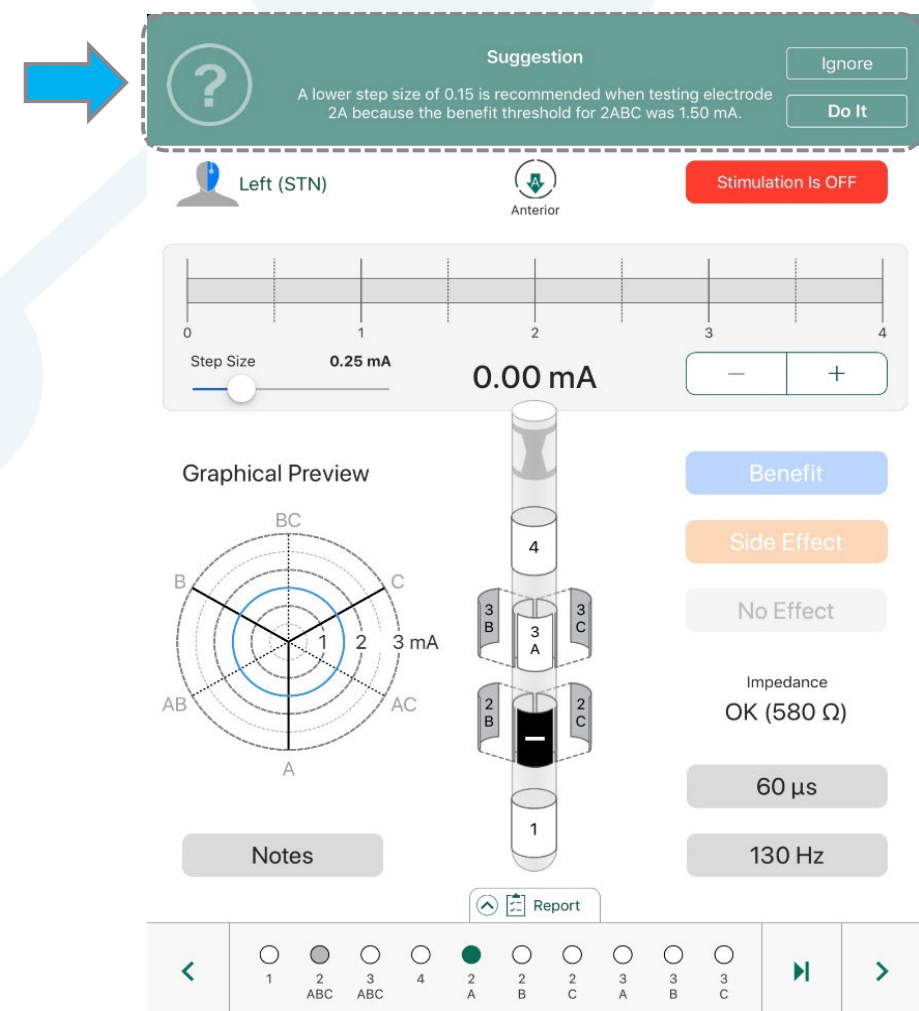
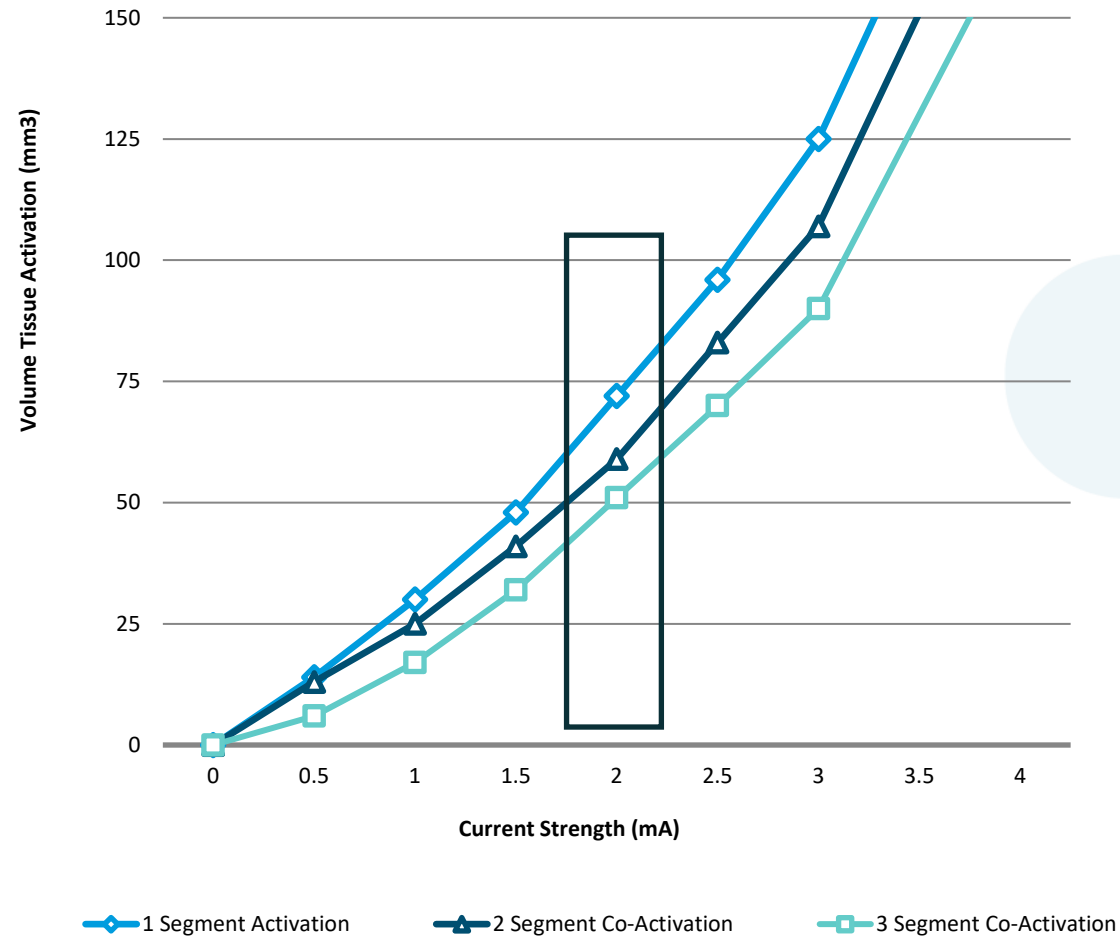

Rebelo et al., Thalamic Directional Deep Brain Stimulation for Tremor: Spend Less, Get More, Brain Stimulation, 2017

A SIMPLE SYSTEMATIC APPROACH TO DIRECTIONAL PROGRAMMING USING INFORMITY™

Best Segmented Level

- Conduct the usual full-ring monopolar review on the 4 levels (1, 2ABC, 3ABC, 4)
- Identify **Best Segmented Level (BSL)** using the Informity™ comparison view

Single Segment Activation

- **Prioritize Single Segment Activation (SSA)** for the segments (A, B, C) on BSL
- Start with **smaller amplitudes** and use **small step size** compared to Omni; consider automatic step size recommendation by Informity™

INFORMITY™

- Use the “sorting” tools in Informity to maximize therapeutic window and minimize power consumption **simultaneously**
- **Sorting** by TW%, Power, Balance Threshold

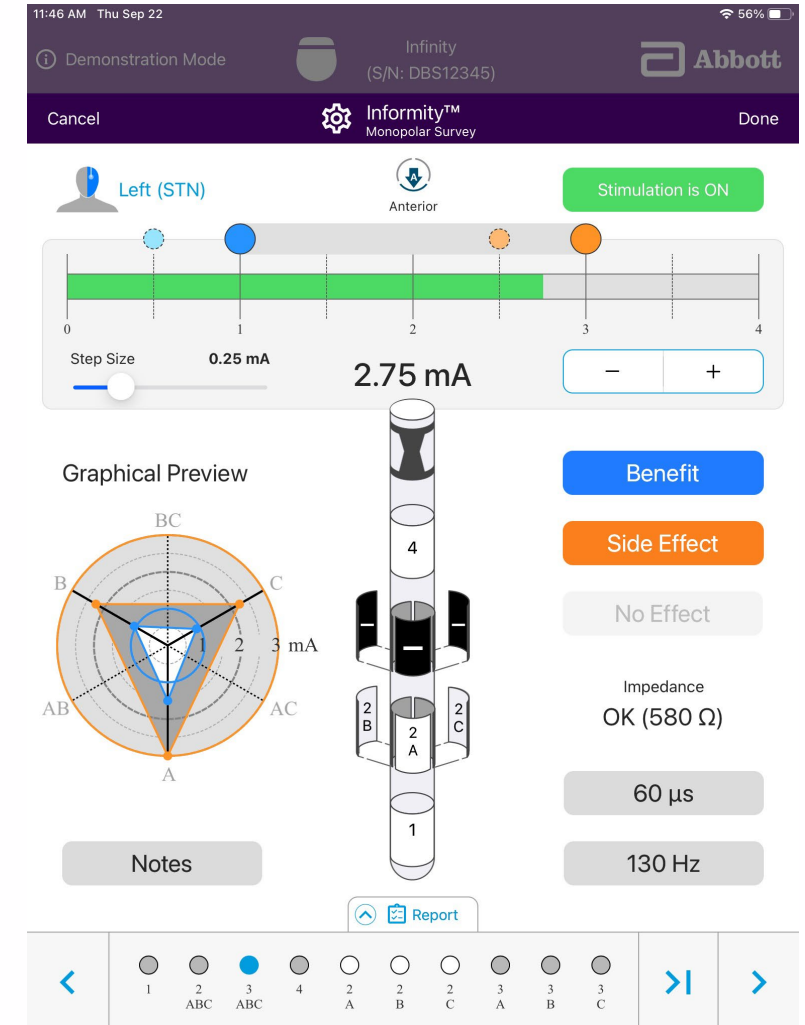

Thank you!



AMDAPP
Association of Movement Disorder Advanced Practice Providers