

Mastercam®

DESIGN

Focused CAD means machine-ready parts faster.

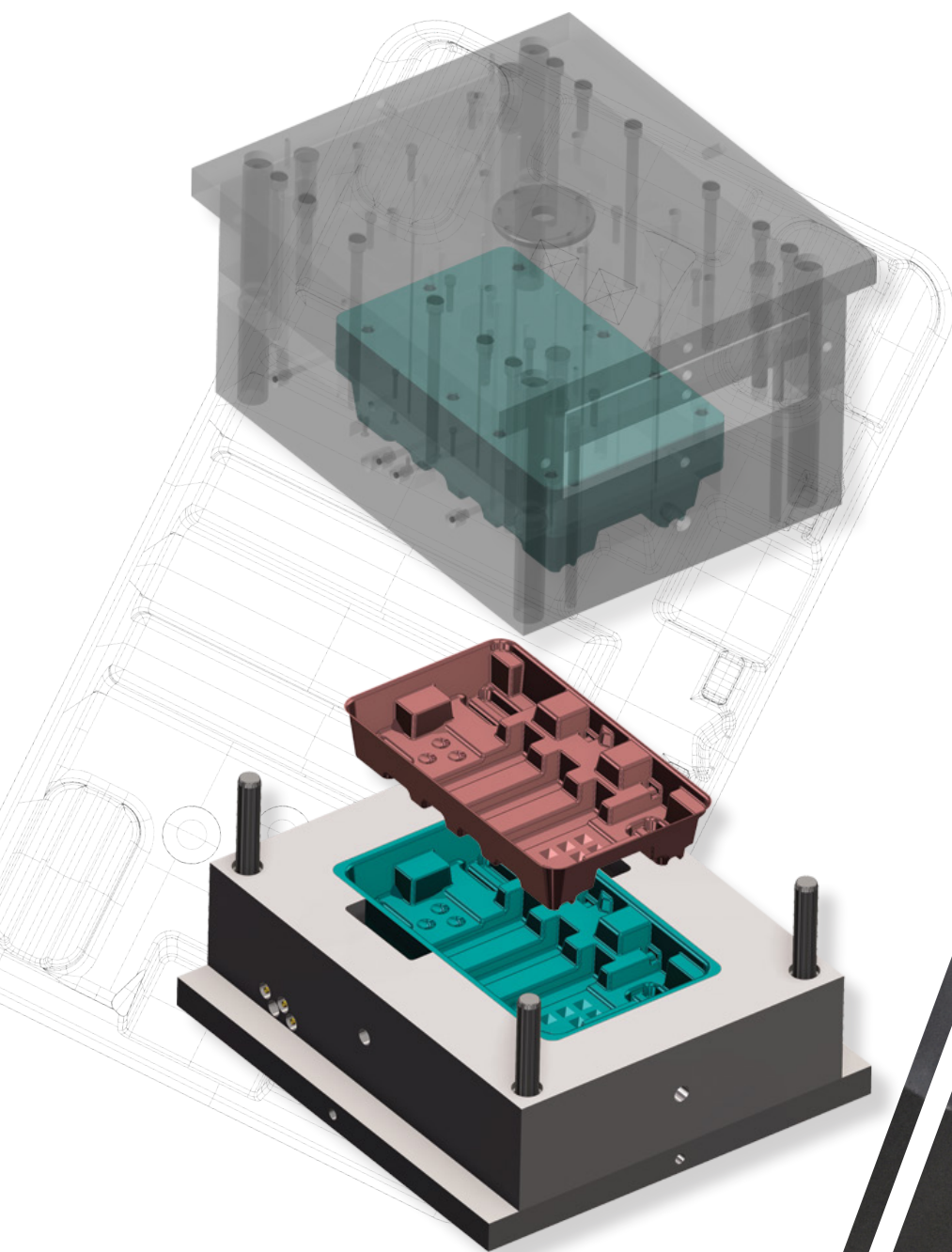

MODELING AND PREP TOOLS

Get your parts on and off the machine quickly.

Whether you bring in a file from an outside CAD package or design one yourself, Mastercam's powerful, easy-to-use CAD engine is included in each main Mastercam product and is also available separately.

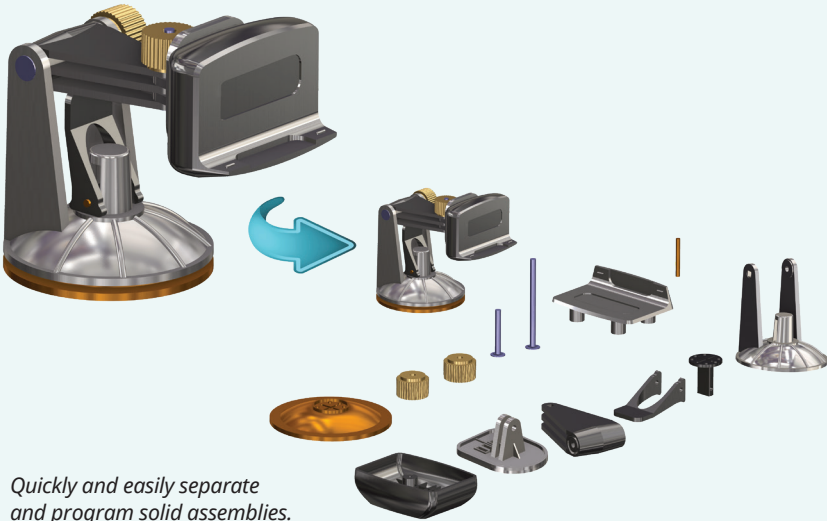

Work with your existing CAD files.

Mastercam helps to preserve design intent with Model Based Definition (MBD) support and acceptance of varied file formats. These include IGES, Parasolid®, SAT (ACIS solids), AutoCAD® (DXF, DWG, and Inventor™ files), SOLIDWORKS® (including history tree), Solid Edge®, SpaceClaim, STEP, STL, and more. Add-On translators are available for Siemens NX, CATIA™, Pro/E (PTC Creo), and more.

Whether you are prepping customer files...

Getting a part file from an outside source can pose unique challenges. You might need to repair a surface, cap or hide a feature, or create an electrode. You may need to streamline, fix, or modify a complex mesh, or just make sure your fixtures are represented on the part. Mastercam includes a powerful set of model prep tools to make sure the process goes smoothly. Focused mesh, surface, and solid model creation and editing tools let you bring a part from the designer's desk to your machining process, fast.

...or designing your parts from scratch.

Having powerful CAD at your fingertips makes your CAM system that much more effective. Mastercam includes a robust set of modeling tools, from complete wireframe to surface and solid modeling. A true hybrid modeling system, Mastercam lets you create, combine, and machine whichever CAD geometry suits your needs.

Top	Depth	Bottom	Taper
69.85	0.381	69.85	0.0
49.8348	3.3528	48.03804	30.0
48.03804	0.20652	47.625	90.0
47.625	15.49068	47.625	0.0
45.5676	4.0894	45.5676	0.0
45.5676	5.58954	25.4	122.0
25.4	21.69006	25.4	0.0
25.4	7.03972	0.0	122.0

