

Evaporative Air Cooler

RKFS06α-A

Owner's manual



Thank you very much for choosing the Evaporative Air Cooler “RKF”.



- Read this manual thoroughly before using this cooler and use the cooler correctly.
- Keep and store this manual in a place that users can reach and read at anytime.

Contents

Preface	1
1. Special precautions	2
2. Name of components	3
3. To the first-time user	3
4. How to use	7
5. Periodical inspection and cleaning method	9
6. Troubleshooting	11
7. Specifications	12
8. Safety labels	13
9. Storing (When not using for a long time)	13
10. Periodic replacement parts	13
WARRANTY POLICY	14

Preface

◆ In this manual, precautions to be followed are described to use this cooler safely and properly. Precautions are divided into: **⚠ DANGER**, **⚠ WARNING** and **⚠ CAUTION**. Please read and understand the meanings and the details of each category.

- ⚠ DANGER** This means that failure to follow the given precaution(s) may lead to death, serious injury and/or major fire.
- ⚠ WARNING** This means that failure to follow the given precaution(s) may likely result in death, serious injury, fire and/or possible explosion.
- ⚠ CAUTION** This means that failure to follow the given precaution(s) may result in serious injury and/or property damage.
- ⚠** This means "actions" that require careful attention.

* Depending on the circumstances, even the category of “**⚠ CAUTION**” can lead to significant results. Each category describes important contents regarding safety, and please make sure to follow them.

USER REGISTRATION



1 Special precautions

For your safety, please comply with the following precautions.

*The following precautions are all important items to use this cooler safely. Please read before using this cooler.

DANGER

Be sure to ground the cooler.

- Always perform grounding to prevent electric shock. Also, use the outlet that has the ground leakage breaker.
- Do NOT connect the ground wire to the gas pipe, water pipe, ground wire for lightning rod, or telephone ground wire.
- If the cooler is not properly grounded, it may cause electric shock. Make sure a grounded power pin or connection is used.

WARNING

Do NOT expose the cooler to water

Do NOT use the cooler where it can be exposed to rain, snow, etc. Also, do NOT operate switches with wet hands. It may cause electric shock.

Do NOT touch the rotating parts

Do NOT insert fingers, sticks, etc. into the air inlet/outlet. It may cause injury.

Do NOT modify the cooler

Do NOT apply modification to the cooler. It may cause failure and fire.

Do NOT expose the cooler to sparks

Do NOT use the cooler where it can be exposed to sparks like an iron factory. It may cause fire.

CAUTION

Securing ventilation

Use this cooler in fully ventilated facility. Operating in closed area results in significant increase of humidity, and the cooling effect cannot be gained from this cooler. Also, it may cause rust generation on peripheral devices. The cooling effect increases if used with forced ventilation.

Securing a space on the air inlet side

Secure enough space (50 cm (1.7 ft) or more) on the cooler's air inlet side. When the air inlet side is blocked by a wall, etc., the air volume becomes insufficient causing performance deterioration.

Do NOT place in slope

Place the cooler on a level surface. If tilted for 5 degrees or more, water may overflow from the tank.

When connecting automated water supply piping

Please make proper piping connection to supply water. Improper connection may cause water leakage resulting in wetting surroundings. When installing, choose a place that is not easily damaged by water leakage.

Be sure to use tap water only

Always use tap water. Using well water and industrial water may cause abnormal odor.

Do NOT leave residual water in the tank

Drain the residual water after use every day. The residual water in the tank may cause abnormal odor due to decomposition and microbial growth.

Do NOT use if abnormality is found

If anything abnormal is found (unusual noise, water leakage, burning smell, etc.), stop the operation immediately. If continued to operate, it may cause serious failure, electric shock, and fire.

Do NOT move the cooler during operation

Do NOT move the cooler in operation. Water may overflow from the tank, and wet the floor.

Do NOT damage the power cord and power plug

Do NOT forcibly bend, pull, twist, pinch, modify the power cord and power plug. Also, do NOT place anything heavy on the power cord and power plug. Clean the dust adhered to the power plug. It may cause fire and electric shock.

Do NOT pour water on the electric components

Do NOT pour water on the electric components. Make sure the electric components are protected from water when supplying water and cleaning the cooling element. The insulation of the electric components gets deteriorated causing electric shock.

Watch out for rust generation

Since the blown cool air contains humidity, do NOT place anything prone to corrosion in front of the air outlet.

Be cautious of ambient environment

Do NOT use the cooler where oily particles are present in the environment. Oil may mix with water causing the cooler unusable. Place the cooler where clean external air can be obtained.

Do NOT use acid and alkaline detergents

Use only neutral detergent for cleaning. Use of acid and alkaline detergents or chemicals may cause adverse effects on the cooler.

Precautions for transferring and moving the cooler

When transferring and moving the cooler, fallen filters and jumping out of the tank may cause injury and accident. Secure these parts when transferring and moving the cooler.

2 Name of components

- ① Water pump
- ② Top panel
- ③ Lamps
- ④ Switches
- ⑤ Circuit board
- ⑥ Auto louver
- ⑦ Water level hose
- ⑧ Wheels
- ⑨ Flow switch
- ⑩ Wind outlet
- ⑪ Water spray board
- ⑫ Outer air filter
- ⑬ Inner air filter

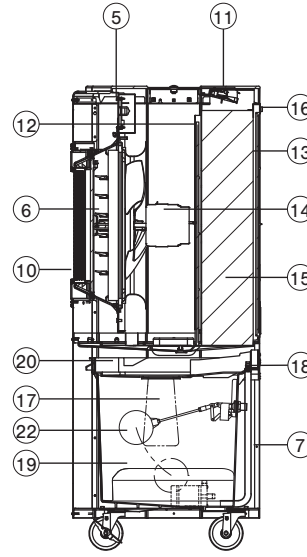
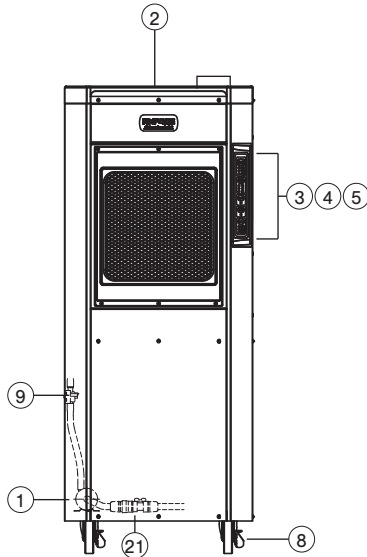

- ⑭ Blower fan
- ⑮ Cooling element
- ⑯ Element retainer
- ⑰ Water filter
- ⑱ supply-water inlet tap
- ⑲ Water tank
- ⑳ Tank lid
- ㉑ Joint connection
- ㉒ Automatic water supply ball tap

*⑫ and ⑬ are identical parts.

Description of safety devices	
Electric overload system (Fuse)	It shuts off the power supply and automatically stops the cooler when excessive electric current passes through the electric system. Operation state: The whole operation stops.
Flow switch	When the water level in the tank becomes low, the flow switch detects it, and stops the pump. The cooler stops automatically after a while. Operation state: When low water level is detected, the Cool Air lamp flashes, and the pump is stopped. Then, the fan stops after 20 to 40 minutes (depends on the fan speed setting).
Overheat protection for blower fan motor	When the motor is overheated due to over current, the electric circuit is shutdown automatically, and the motor is stopped. Operation state: After the motor is stopped, and cooled, it restarts operation automatically.

3 To the first-time user

3-1. Preparation for operation

★ Unpacking (Removal of packaging materials at shipping)

- 1** Open the package and remove the water tray and the tape securing the filter.

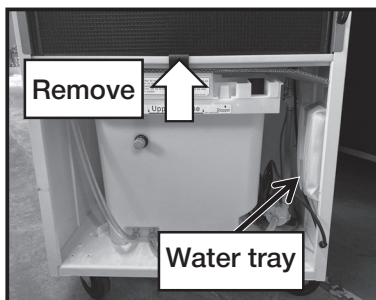

- 2** Remove the fixing cardboard at the top surface of the tank.

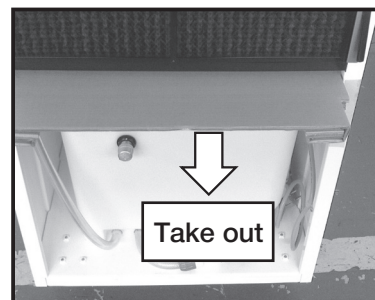

- 3** Check the joint connection is "ON".

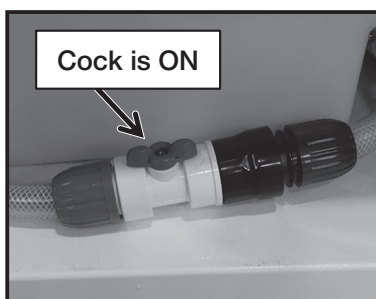

- 4** Place the water tray in the gap behind the plate on the right side of the unit when not using it.

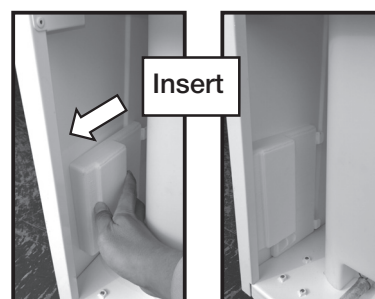

3-2. Setting the Cooler

Place the cooler on a level surface and fix it securely, so that it does not move. The cooler is equipped with wheels used for moving. During operation, fix the cooler using the stoppers on the wheels. (Lower the stopper's "ON" side to lock)

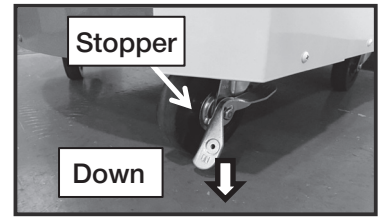

3-3. Instruction for water refreshener tablet

1 Pull out white bag with water refreshener tablet from silver aluminum bag.

Do not tear white cloth bag. Keep water refreshener tablet inside the white cloth bag. If white cloth bag is torn, water treatment will not be effective.

2 Drop a water refreshener white bag into a evaporative cooler's water tank.

One Water refreshener tablet is included with the product.

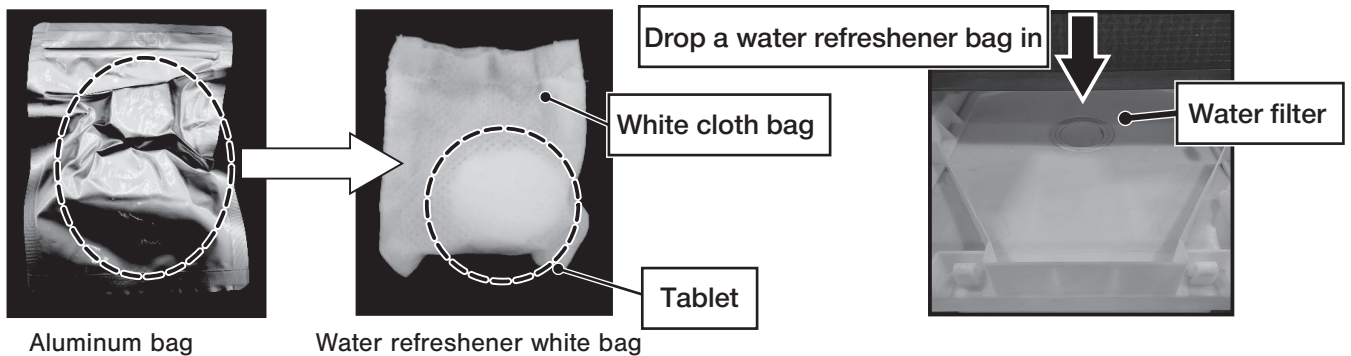

- CAUTION**
- Never ingest or put into eyes.
 - Keep reach out of children.
 - Water refreshener tablet is for water treatment of RKF cooler series only. Do NOT use for other purpose.
 - Water refreshener tablet will last about a month.(Contact your dealer when replacement tablet is necessary.)

3-4. Supplying water at every use

- CAUTION**
- Before supplying water, check the joint connection is connected securely.
 - Check the joint connection is "ON".
 - Use tap water only. When well water and industrial water are used, algae and bacteria can grow easily in the cooling element. It may cause deterioration of cooling efficiency and abnormal odor.
 - Do NOT fill water over the "Water upper limit line". It may cause overflow of water when moving the cooler.
 - If the water level is too low, water is not supplied to the pump when the cooler is turned on. Then, the Cool Air lamp flashes, and the pump is stopped.

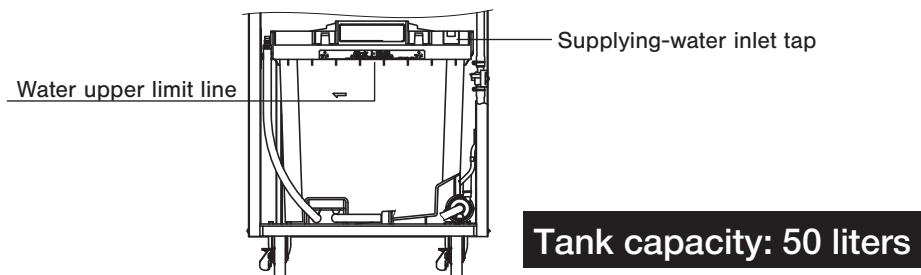

Water supply from a plastic container with nozzle

Remove the tank's supply-water inlet tap, and insert the nozzle into the hole to supply water.



Water supply with a hose

Remove the tank's supply-water inlet tap, and insert the hose into the hole to supply water.

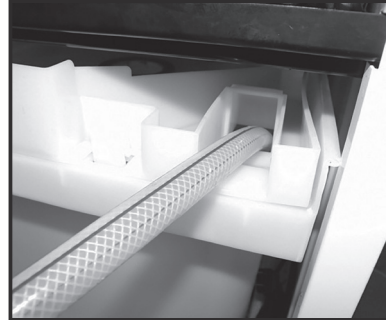

After supplying water, always place the supply-water inlet tap back on.

Water supply from a plastic container and bucket

1 Remove 2 stoppers of the tank lid, and pull the tank only about 17 cm (6.69 in) toward you.

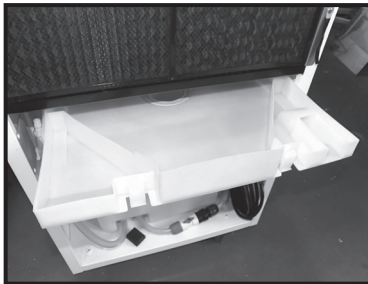

2 Move the plastic container and bucket closer to the tank lid and supply water little by little.



After supplying water, push the tank lid back in place, and always lock the tank with 2 stoppers.

<p>⚠ CAUTION</p>	<ul style="list-style-type: none"> ● Do NOT step on the tank lid that is pulled out. Also, do NOT place anything 20 kg (44.1 lbs) or more. It may damage the tank lid causing injury. ● Do NOT pull out the tank lid strongly. It may damage the stoppers and the cooler may fall over. When supplying water using the tank lid, supply water little by little. Supplying the water roughly may cause the spread of the water. ● Lock the casters. The cooler may move when supplying water. ● Anytime except for supplying water, store the tank lid and lock the stoppers. ● If the tank lid is not stored, dusts may penetrate into the tank causing the cooler to break.
-------------------------	---

3-5. Automatic supply of water (the automatic water supply ball tap is used)

<p>⚠ CAUTION</p>	<ul style="list-style-type: none"> ● To prevent water leakage accident, piping work shall be conducted with the user's responsibility. Also, it is recommended to install a reducing valve of about 80 kPa, a strainer, and a water valve on the water supply side. (It prevents the valve malfunction from unexpected water pressure or penetration of foreign objects.)
-------------------------	--

● When using the automatic water supply method, the user must prepare the followings commercially available items in addition to the automatic water supply ball tap.

- | |
|--|
| <ul style="list-style-type: none"> ● Socket (1/2B) ● Hose nipple (1/2B) ● Hose binding ● Hose (with mesh) ● Thread sealing tape |
|--|

Example for piping work

- 1 Wrap the thread sealing tape on the thread part, and attach the socket and hose nipple to the automatic water supply ball tap.

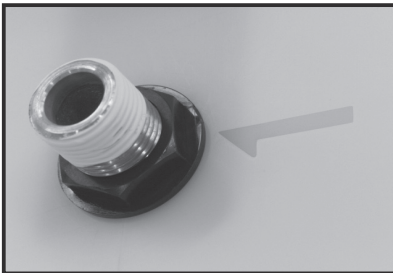

- 2 Insert the hose to the hose nipple.

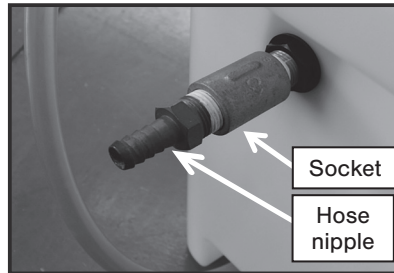

- 3 Fix the hose with the hose band.

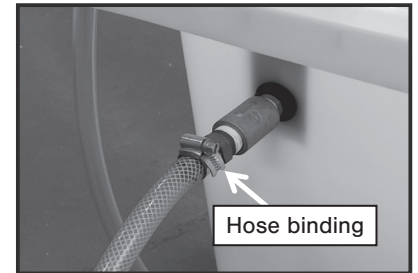

- CAUTION**
- When installing the piping materials, maintain the parts inside the tank not to turn, and fix them securely. After installation is done, make sure the supply-water inlet of the automatic water supply ball tap inside the tank is facing directly downward.
 - Verify the automatic water supply ball tap functions correctly for the first time. If the automatic water supply ball tap does not work properly, water supplying does not stop causing water to overflow from the tank wetting the floor.

3-6. Draining the water

- 1 Lift the joint connection with cock. Insert the two hooks of the water tray into the notches in the base, and slide the water tray all the way to the right edge.

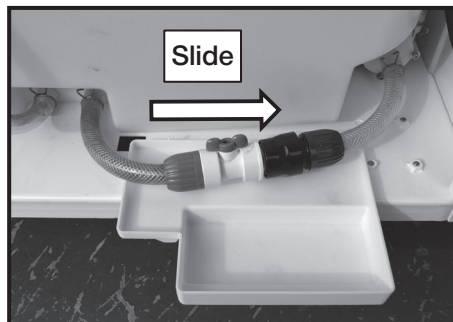
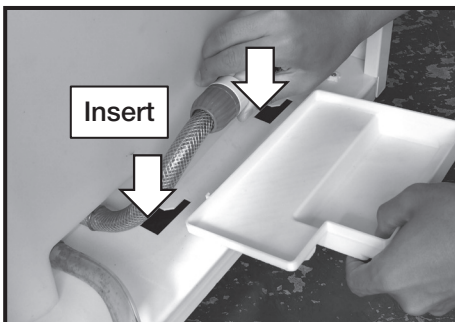

- 2 Turn off the joint connection's cock. While pulling the grip, pull the operation part and remove the joint. Drain the water in the hose into the water tray.

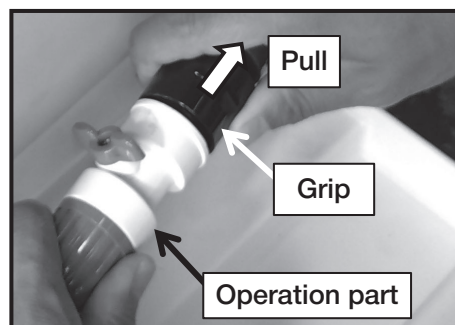
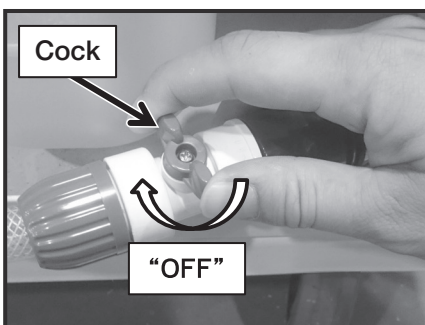

- 3 Slide the water tray, lift it straight up so as not to spill the water, and throw out the water that has accumulated in the tray.

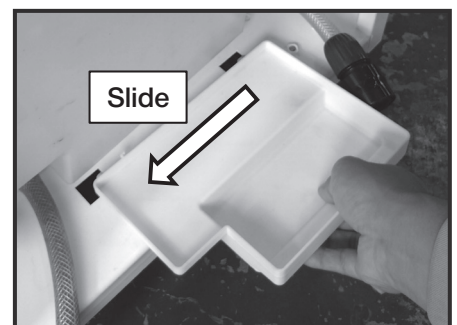

- 4 After draining, insert until you hear a click, then connect and turn the joint connection's cock on.
* Water comes out when the cock is turned on. The water tray is used for draining the residual water in the hose. It is not large enough to hold the water remaining in the tank. Drain the water remaining in the tank separately.

- CAUTION**
- Do not rub the removed joint against the ground or the unit's body. Doing so may scratch the connection, leading to water leaks.
 - Do not move the unit with the water tray installed. Doing so may result in damage.

4 How to use

When using for the first time, the smell of cooling element may come out. It is harmless and the smell will go away in 4 - 5 days.

To generate clean cool air, make sure to discharge water in the tank every day. Clean inside the tank once a week.

■ Precautions when using

★ Pre-operation check (Perform without connecting power source)

- Is the cooler placed in a level place, and are the stoppers on the casters locked?
- Is there water leakage from the cooler or drain pipe?
- Is the joint connection turned "ON"?

★ Precautions when operating

- Do NOT operate without water. If repeatedly operated without water, it affects the life of the pump.
- When supplying water to the tank for the first time and ON/OFF switch is pressed, the Cool Air lamp may flash. In the case, supply water more than half of the tank and restart.
- Do NOT move the cooler in operation. It may cause water to leak.

★ Ventilation in operation

- This cooler cools air by evaporating water, therefore, the in-room humidity increases. When the humidity significantly increases where ventilation is insufficient, the cooling effect deteriorates.
- Open windows and doors to make it easy for outside air to come in and go out.
- The increasing ambient humidity reduces its cooling effect.
(Just like the laundry takes longer to dry on a rainy day.)

★ Precautions after operation

- Make sure to discharge water in the tank every day. Clean inside the tank once a week.
Various dust floats in the intake air, which adheres to the cooling element. Suctioned dust moves to the tank with the water flow. Then, bacteria are gradually increased in the water of the tank.
- When disconnecting the power plug, always hold the tip of the power plug instead of the power cord. It may cause electric shock and ignition.

4-1. Operation procedure

- As the "ON/OFF" switch is pressed, it loops through [Cool Air] → [Auto-stop] → [Blower] → OFF.

- 1 When the "ON/OFF" switch is pressed once from the OFF state, the [Cool Air] lamp turns ON, and the fan and pump operate.
- 2 As the pump operates, water is supplied to the cooling element from the water spray board at the top of the cooler. When the water in the tank runs out, the [Cool Air] lamp flashes. In the case, feed water to the tank. To restart operation, press the "ON/OFF" switch.
- 3 When the "ON/OFF" switch is pressed once from the Cool Air state, the [Auto-stop] lamp turns ON. Then, the fan stops after 20 to 40 minutes.

Always use the Auto-stop to stop the Cool Air operation.

⚠ CAUTION If operation is not stopped with Auto-stop, undried cooling element may cause odor by growth of bacteria.

- 4 While the [Auto-stop] lamp is ON, if the "ON/OFF" switch is pressed, the [Blower] lamp becomes ON, and blower operation starts.
- 5 When the "ON/OFF" switch is pressed during blower operation, the fan stops immediately.

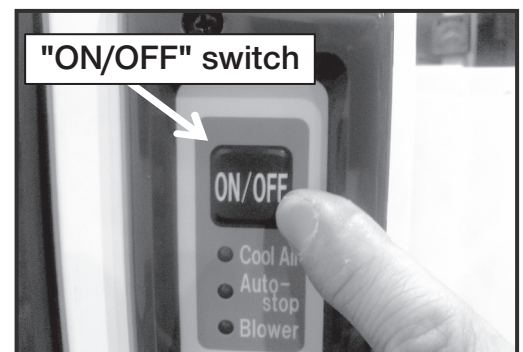

4-2. Changing the fan speed

Press the "Fan speed" switch to adjust the fan speed. The fan speed lamp turns ON in the order of [HI] → [MID] → [LOW] → [MID] → [HI], and the fan speed changes. Use with the fan speed of your choice.

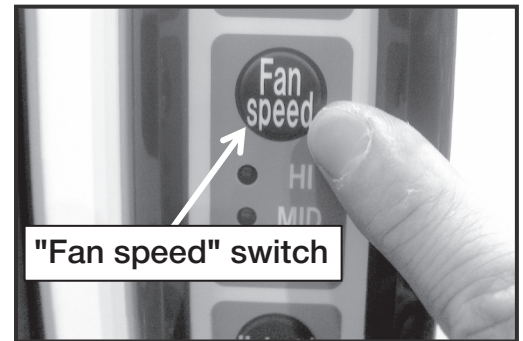

"Fan speed" switch

4-3. Changing the fan direction

- 1 The [Horizontal] lamp turns ON when the "Horizontal" switch is pressed once. The louver starts moving **right and left**, and fan direction changes.
- 2 When the "Horizontal" switch is pressed once while the [Horizontal] lamp is ON, the [Horizontal] lamp turns OFF, and the fan direction board stops.
- 3 Up and down fan direction can be also changed with the "Vertical" switch like the "Horizontal" switch.

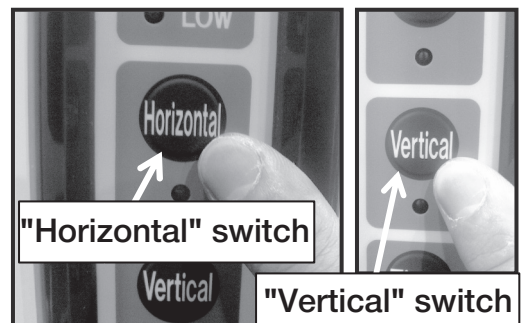

"Horizontal" switch

"Vertical" switch

4-4. Timer operation (The timer works as OFF-timer)

- Cooler operation or blower operation is stopped after the set time.

- 1 When "Timer" switch is pressed during operation, each lamp is lit for **1, 4, 8 hours**.
- 2 During the cooler operation when the timer operation ends, the set timer lamp switches from ON to flashing, and the pump stops. Then, the fan stops after 20 to 40 minutes. The duration differs depending on the set fan speed.
- 3 During timer operation, the set timer lamp keeps flashing. To cancel the timer operation, press the "Timer" switch one to three times. The timer lamp turns OFF and the timer is canceled.

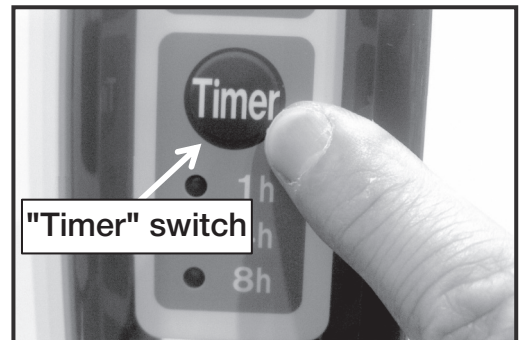

"Timer" switch

4-5. Notification function

- 1 The three lamps (Cool Air, Auto-stop and Blower) below the ON/OFF switch flash when it is time to clean the filter or replace water refreshener tablet. Press and hold the ON/OFF switch for more than 3 seconds when the lamps are flashing to turn the lamps off and reset the notification function.
- 2 The three lamps (HI, MID and LOW) below the Fan speed switch flash when it is time to replace the cooling element. Press and hold the Fan speed switch for more than 3 seconds when the lamps are flashing to turn the lamps off and reset the notification function.
- 3 Plug the power cord into a power outlet while simultaneously pressing the ON/OFF and Fan speed switches to display whether the notification function is on or off. The function is on if the three lamps (Cool Air, Auto-stop and Blower) below the ON/OFF switch are lit, off if the three lamps (HI, MID and LOW) below the Fan speed switch are lit. To change the setting, press the ON/OFF or the Fan speed switch and select. The setting is set when the power cord is unplugged from the power outlet in the desired status.



5 Periodical inspection and cleaning method

Periodical inspection and cleaning are required to use the cooler in a good condition for a long time.

Clean the inner air filter, cooling element, and tank accordingly by observing the contamination condition. If cleaned early, dirt can be removed easily, and the cooling effect is maintained. Always inspect and clean the inner air filter and cooling element at the beginning and end of the season.



CAUTION

- Pull the power plug out before performing inspection and cleaning. It may cause electric shock.
- Do NOT pour water on the electric components inside the cooler.

5-1. Removing the filter, cooling element, and water spray board

1 Inner air filter

Hold the handle of the inner air filter, lift it lightly and pull it out toward you.

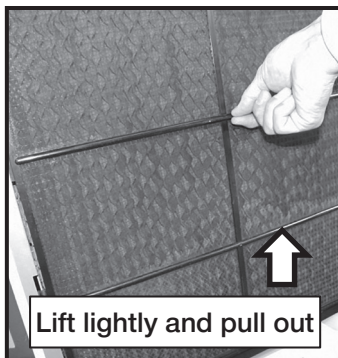

2 Element retainer

Remove the two resin screws, and remove the element retainer.

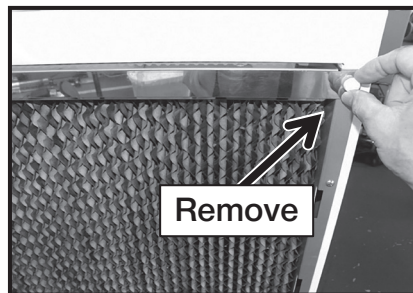

3 Cooling element

Pull the upper part of the cooling element and take it out obliquely upward.

Handle it with care since the element is fragile and easy to break.

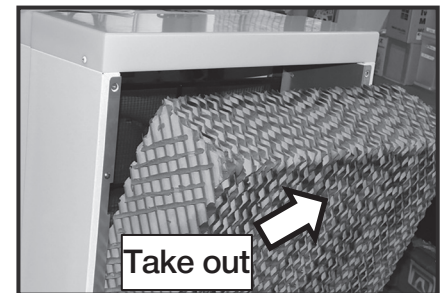

4 Outer air filter

Hold the handle of the outer air filter, shift right and left to pull it out.

(The filter is restrained on the plate on both sides. Pull it out while pushing to open the board outward.)

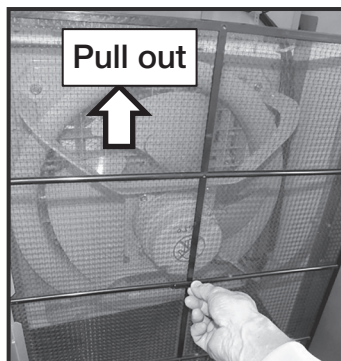

5 Water spray board

Remove the butterfly nut and pull the water spray board from the two upper left and right hooks.

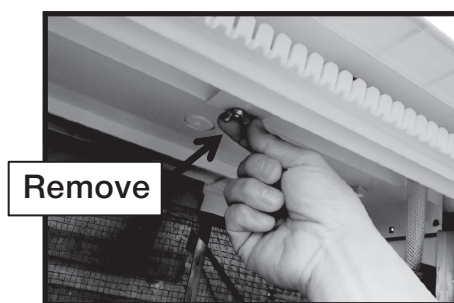

6 Water spray board and water spray lid

Shift the hose clip, and remove the hose. Loosen two installation screws on the water spray lid, and remove the water spray board.

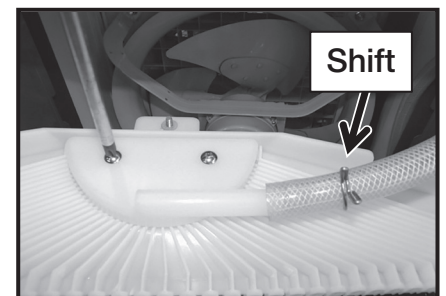

5-2. Inspection and cleaning of filter, cooling element, and water spray board

- 1 Inner air filter and outer air filter**
Perform air blow when dirt and clogging are observed. (If an air gun is not available, use a brush to clean.)
If contamination is significant, replace the filter.
Dispose the used filter according to the disposal laws and guidelines.

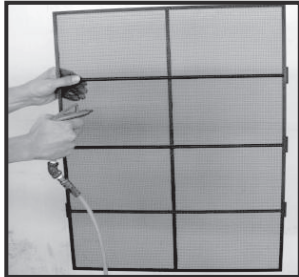

- 2 Cooling element**
In case of dirt/clogging and abnormal odor are observed, clean with a high pressure washer.
(Be careful that if the pressure is high, the element may be damaged.)
After cleaning, expose the element under the sun to dry thoroughly.
If contamination is significant, replace the cooling element.
Dispose the used filter according to the disposal laws and guidelines.



- 3 Water spray board**
If dirt and clogging are observed, use a brush to clean.
If contamination is significant, replace the water spray board.



5-3. Cleaning the tank and water filter (Perform at least once a week)

- 1** Discharge the water inside the tank. (See 3-5.)
Lift the rear of the tank a little and pull it out.
* If you are using the water tray, remove it first.
- 2** Remove two stoppers on the tank lid, and remove the tank lid from the tank.

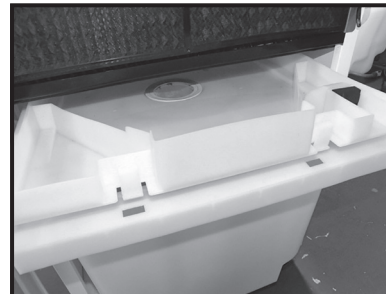

- 3** When contamination of the tank, tank lid, and water filter is significant, wash with neutral detergent.
- 4** After cleaning, assemble the tank lid and water filter, and place the tank in its original position securely. Be careful that the hose under the tank does not bend.
When the hose is bent tightly, the water sensor may function and cooling performance may deteriorate. Check the water level hose is fixed in its receiving part. If water is supplied while the water level hose is not fixed in its receiving part, it may result in a large water leakage accident.

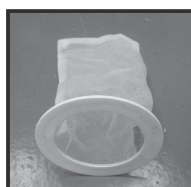

Water filter



Hose

6 Troubleshooting

When you face problems with your cooler, please refer to this checklist before consulting with your dealer. In case satisfactory results could not be obtained by referring to the table, or you have problems not described in this table, please contact your dealer.

When consulting with the dealer, please describe the problem you have together with model name and serial number of your cooler.

Phenomenon	Causes	Measures
<ul style="list-style-type: none"> Abnormal odor at opening the package and initial operation 	<ul style="list-style-type: none"> Initial order from the cooling element 	<ul style="list-style-type: none"> Make sure to replace water in the tank every day. The abnormal odor goes away in 4 - 5 days.
<ul style="list-style-type: none"> Does not start 	<ul style="list-style-type: none"> The main power is not ON 	<ul style="list-style-type: none"> Turn the main power ON
<ul style="list-style-type: none"> Airflow is insufficient 	<ul style="list-style-type: none"> Power voltage is low Inner/outer air filter and cooling element are clogged The space on the inlet side is narrow 	<ul style="list-style-type: none"> Contact an electrician Clean the inner/outer air filter and cooling element Securing a space on the air inlet side
<ul style="list-style-type: none"> The [Cool Air] lamp flashes 	<ul style="list-style-type: none"> Water level in the tank is low The cock of the joint connection is OFF Bent hose Water spray board is clogged Clogged hose Except above 	<ul style="list-style-type: none"> Supply water Turn the cock of the joint connection ON Correct the bent hose Clean the water spray board Clean the hose Contact your dealer
<ul style="list-style-type: none"> Water leakage from the cooler 	<ul style="list-style-type: none"> The cooler is not placed in a level surface Connection failure of parts Damaged parts 	<ul style="list-style-type: none"> Place the cooler on a level surface Reconnect the leaking point Contact your dealer
<ul style="list-style-type: none"> Abnormal vibration and noise 	<ul style="list-style-type: none"> Failure on the blower fan or surrounding the blower fan 	<ul style="list-style-type: none"> Contact your dealer
<ul style="list-style-type: none"> Cool air has abnormal odor 	<ul style="list-style-type: none"> Bacteria growth on the water and circulation route Dirt such as black mold on the cooling element stands out Abnormal odor from environment and water quality 	<ul style="list-style-type: none"> Clean the tank and water filter, and put the new tap water Replace the cooling element
<ul style="list-style-type: none"> The three lamps (Cool Air, Auto-stop and Blower) below the ON/OFF switch flash 	<ul style="list-style-type: none"> Time to clean the filter or the replace water refreshener tablet 	<ul style="list-style-type: none"> See "4-5 Notification function" on page 8.
<ul style="list-style-type: none"> The three lamps (HI, MID and LOW) below the Fan speed switch flash 	<ul style="list-style-type: none"> Time to replace the cooling element 	

7 Specifications

Model		RKF506α-A
Power source		110-120V 50/60Hz
Power consumption	W	335/510
Airflow direction		Vertical and Horizontal automatic airflow direction
Air speed *1	m/s	3.7/4.5 (High Speed)
Air volume	m ³ /min	130/150 (High Speed)
	CFM	4,600/5,300
Water evaporation amount *2	L/h	10.2/12.2
	gallons/h	2.7/3.2
Tank capacity	L	50
	gallon	13.2
Continuous operating time *2	h	4.8/4.0
Water supply method		Tank reservoir-type (Automatic water supplying possible)
Safety device		Fuse, Water shortage detection, Motor overheat protection
Operating noise	dB(A)	68
Dimensions (H×W×D)	mm	1,565×673×658
	inch	61.6×26.5×25.9
Dry weight	kg	74
	lbs	163.0

*Operating temperature: 5 to 45°C (41 to 113°F)

(The values may be changed without notice)

*1: Air speed at 4 m from the front of the cooler.

*2: Inlet air condition: 30°C (86°F), relative humidity 50%, set to HI

■ Guide for cleaning and replacing the consumables

Drain residual water in the tank	Every day
Disassembly cleaning of parts	
Tank	Once a week
Cooling element	Once a month
Water spray board	Once a month
Water filter	Once a month
Outer air filter	Once a month
Inner air filter	Once a month
Replacing the consumables	
Cooling element	Once a year
Inner air filter	Once a year
Outer air filter	Once a year

■ Dimensional outline drawing

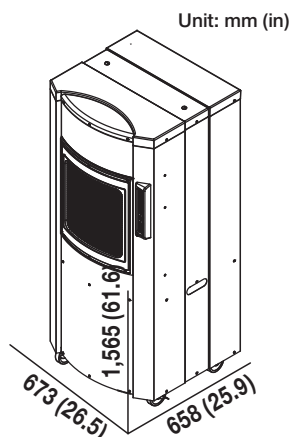

■ Wiring diagram

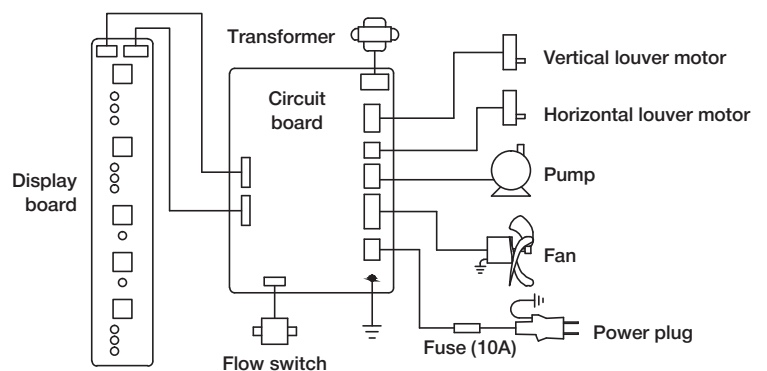

8 Safety labels

Safety labels provide important information to use this cooler safely. Do NOT remove or soil them. If the contents of labels are erased and unreadable, contact your dealer, and replace with new one.

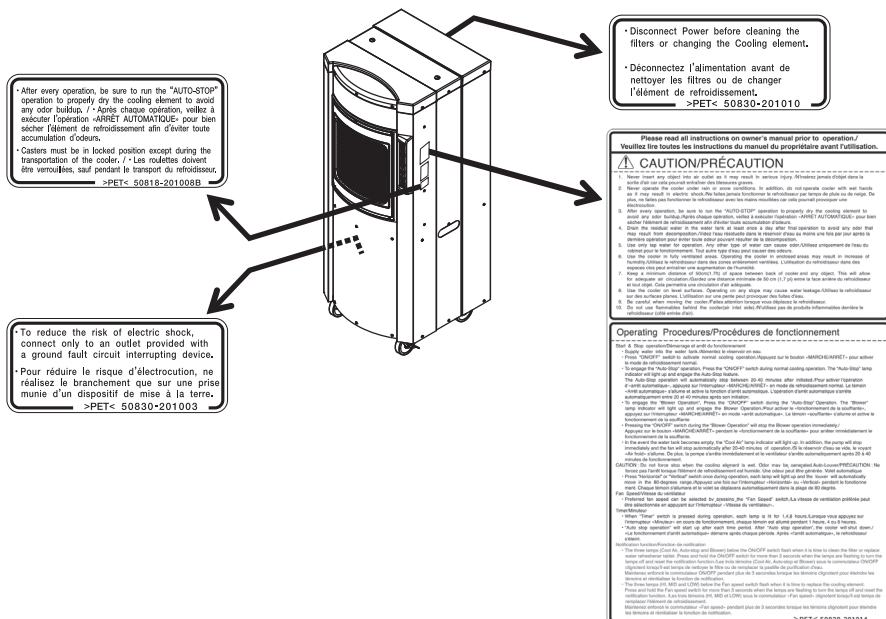

9 Storing (When not using for a long time)

When not used for a long time, store it after performing the following care.

Abnormal odor may be generated due to growth of microorganisms and parts may be damaged due to freezing.

CAUTION • When disconnecting the power plug, always hold the tip of the power plug instead of the power cord. It may cause electric shock and ignition.

- 1 Conduct blower operation to dry the cooling element. (Right a, see page 7)
- 2 After the cooling element is thoroughly dried, press the "ON/OFF" switch to stop the operation.
- 3 Unplug the power code from the outlet.
- 4 Remove the joint connection, take out the tank, and discharge the water in the tank completely. (How to remove the joint connection: See right b and c, page 5 and 6)
Discharge the water in the hose on the pump side, too.
- 5 Wash the tank and water filter with neutral detergent. (See right d)
- 6 Drain water inside the joint connection thoroughly, and then connect the joint connection. It may be damaged due to freezing in the winter.
- 7 Check the condition of inner air filter and cooling element, and clean any dirt observed. (See page 8 and 9)
- 8 Store in low humidity indoor warehouse.

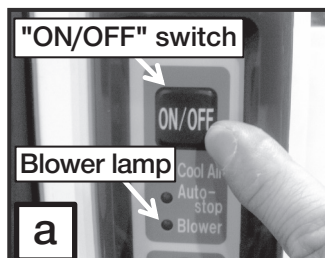

Blower operation

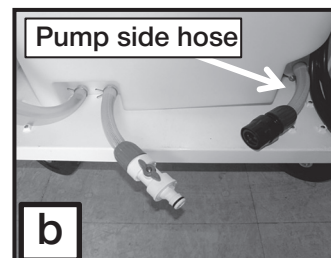

Drain water



Take out water tank

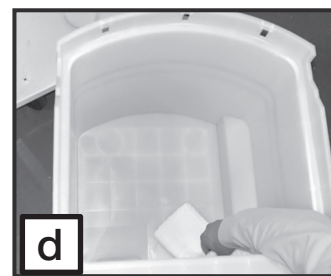

Washing the tank

10 Periodic replacement parts

- Cooling element
5 0 8 1 3—2 0 1 0 1 8
- Water filter
5 0 8 0 5—2 0 1 0 0 5
- Water spray board assembly
5 0 8 2 6—1 8 0 0 0 7

WARRANTY POLICY

RKF Evaporative Air Cooler

SHIZUOKA SEIKI warrants that its coolers and component parts will be free from defects in material and workmanship for a period of 24 months from date of purchase, when properly installed, operated, and maintained in accordance with the installation and Maintenance Instructions, safety guides and labels contained with each unit. If any component proves defective in either material or workmanship during the limited warranty period, Shizuoka Seiki, at its option, repair the defective part or equipment, or replace it with a new part or equipment.

Proof of purchase and warranty qualification must be established at time of return.

*A copy of the bill of sale must be provided at time of return.

Claim Procedure

All claims are to be submitted to the warranty processing center at 1-424-286-0111. After the initial evaluation by phone discussion, the most appropriate agent or specific procedure will be informed.

This limited warranty does not apply to cooler, component or replacement part damage resulting from incorrect installation, misuse, abuse, accident, act of God, neglect, mishandling, modification, incorrect environments, or wear from ordinary use.

The warranty set forth above is the exclusive warranty provided by Shizuoka Seiki and all other warranties, including any implied warranties or merchantability or fitness for a particular purpose, are expressly disclaimed. In the event any implied warranty is not hereby effectively disclaimed due to operation of law, such implied warranty is limited in duration to the duration of the applicable warranty stated above. The remedies set forth above are the sole and exclusive remedies available hereunder. Shizuoka Seiki will not be liable for any incidental or consequential damages directly or indirectly related to the sales, handling or use of the equipment, and in any event Shizuoka Seiki in connection with the equipment, including for claims based on negligence or strict liability, is limited to the purchase price.

Some states do not allow limitation on how long and implied warranty lasts, so the above limitation may not apply to you. Some states do not allow the exclusion or limitation of incidental or consequential damages, so the above limitation or exclusion may not apply to you. This warranty gives you specific legal rights, and you may also have other rights which vary from state to state.



USER REGISTRATION

Please scan QR code or visit as below and complete the registration and questionnaire in order to activate warranty.

This also allows you to download the owner's manual and/or parts list from our website.



<https://www.shizuoka-seiki.co.jp/english/login>

Manufacturer

Shizuoka Seiki Co.,Ltd.

1300 Moroi, Fukuroi-shi, Shizuoka-ken 437-1121 Japan

Phone: +81-538-23-3990 Fax: +81-538-23-3192

Printed in Japan

50830-201007C
2308-ATC