

THE PRESBYTERY OF NEW HARMONY COMMISSIONERS' HANDBOOK

February 21, 2026

Georgetown Presbyterian Church
558 Black River Road, Georgetown S.C. 29440
843-332-3622

***We are delighted to have the Rev. Dr. Laurie Ferguson
preaching, presenting, and facilitating!
You very likely will want to print
the Renewal Practices of New Harmony slides (p. 5-13)
in order to take notes during the presentation.***

Content	Page
Cover Page	1
Georgetown Presbyterian Church Map	2
Church History	3
Preacher Biography for Today's Worship	4
Renewal Practices of New Harmony	5-13
Docket	14
Omnibus Motion	15
Stated Clerk Report	16
Guiding Council Report	17-18
G.I.V.E. Fund	19-22
Special Fund Flyer and Application	23-24
NHP Scholarship and Grant Application	25-26
Joel Long Flyer	27
Christopher Weichman - Faith Journey	28
Christopher Weichman - Statement of Faith	29
CORN - 2026 Committee Representation Analysis	30
New Harvest AC Report	31
Fraser, Fork, Hebron, Salem Black River, and Timmons ville AC Reports	32-34
PADD Report	35-36
Financial Reports	37-46

The information to access the online version of this handbook is being emailed to each minister member of NHP and every Clerk of Session. It is the Clerk's responsibility to distribute that information to the Ruling Elder Commissioner eligible to vote at the meeting.

A limited number of printed handbooks will be available at the meeting. Please print their own Handbook, or parts you believe you need; better still for the good stewardship of God's creation, download it on your laptop or notebook and bring that to the meeting.

All Minister Members and Ruling Elder Commissioners are urged to **read all the reports** in order to be fully prepared for the meeting.

The price of lunch is \$15.00.

Georgetown Presbyterian Church Map

Follow the Arrows to Registration from either parking lot.

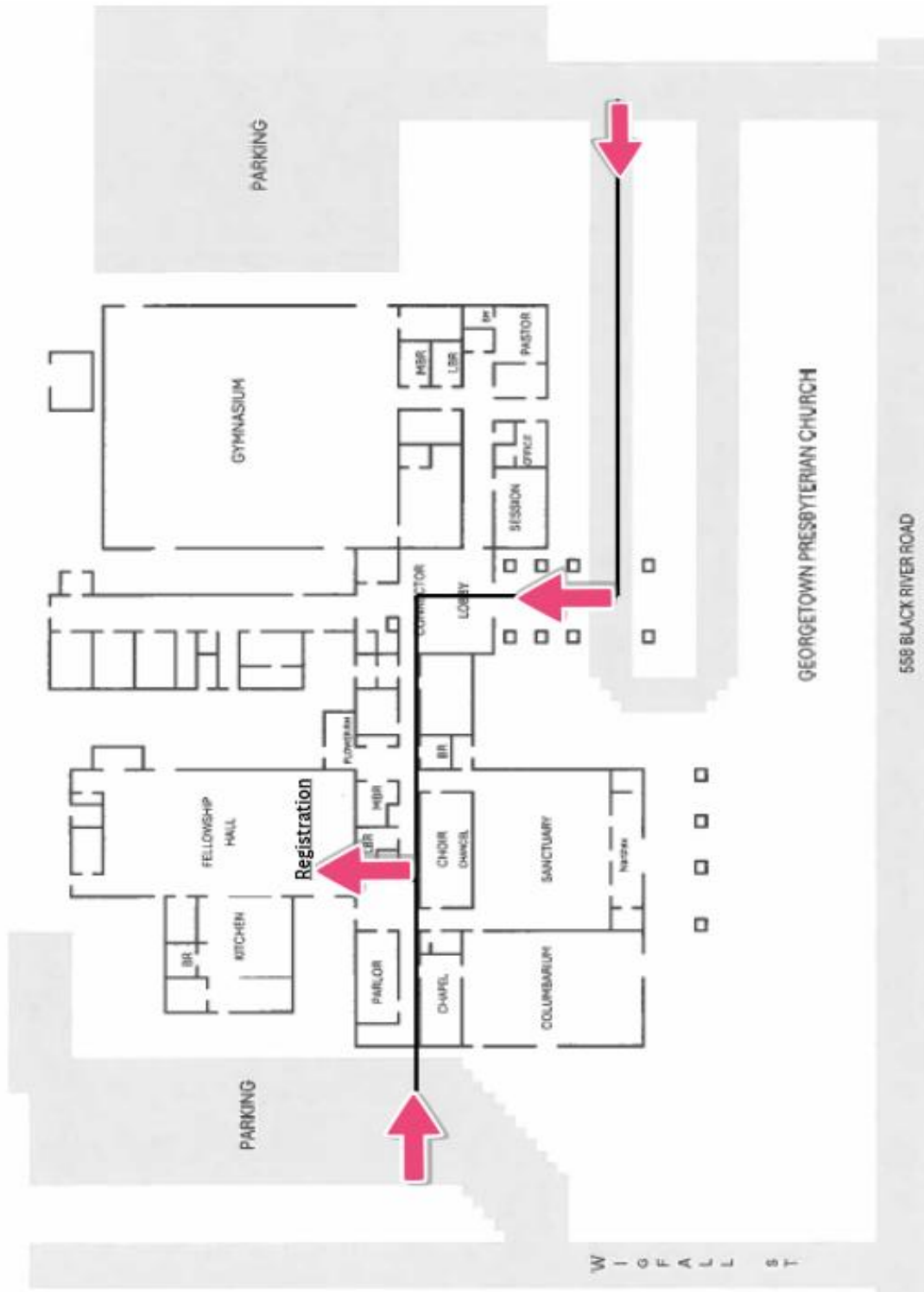

HISTORY OF THE GEORGETOWN PRESBYTERIAN CHURCH

In 1729, when Elisha Screven laid out Georgetown's lots, he included a lot for a Presbyterian Meeting House. However, today no church exists on Church street. In all likelihood the presbyterians moved to Black Mingo Creek (near the Williamsburg County line on the Black River 12 miles north) around 1734 to get away from the state-established Episcopal Church. The church on Black Mingo was shared by the Baptists, Huguenots, and Presbyterians. In 1754 it was solely a Presbyterian meeting house. By 1840 the Black Mingo Presbyterian Church was dissolved.

On October 24, 1897, a band of eight presbyterians petitioned Harmony Presbytery to organize a church in Georgetown. The first meeting was at the fire department. The first minister was Rev. James E. Dunlop, a 64 year-old described as "a rugged Scotsman of massive size and height with flowing white beard and locks." He also served the Union Church in Salters.

Services were regularly held at Winyah Indigo Hall until a sanctuary and manse were built at the corner of Winyah Road and Hazard Street. A hurricane severely damaged the wooden structure in 1906.

In 1907 a brick church was built on the same location for \$10,600 in 1907 with the assistance of Harmony Presbytery and the Synod of South Carolina.

In 1953, under the pastorate of Ace Tubbs, the church built a brick manse at the corner of Front and St. James Streets; the manse was subsequently sold in 2005. The present sanctuary and educational wing behind it was built in 1957. It is located on a four-acre site donated by T.S. Ragsdale, a presiding elder.

Georgetown Presbyterian Church aided in founding the ecumenical summer chapel on Pawleys Island, and also helped establish Friendfield Presbyterian Church (organized 8/9/53). Georgetown and Friendfield shared the same minister until 1983.

In 1987 the church raised \$120,000 in benevolent dollars to provide a health clinic in Zaire, (Congo) and raise funds for a missionary to supervise the clinic, and funds to help build a new sanctuary for Pawleys Island Presbyterian Church.

Through the years the present campus of Georgetown Presbyterian Church has undergone many changes. The fellowship hall was added in 1976 under the leadership of Rev. Bobby Wilkes. On April 17, 1983, the congregation dedicated a family center and new administrative wing. In 1997, the church celebrated its 100th anniversary by building a Habitat House, and laying a time capsule in its new Memorial garden and columbarium. On September 15, 2002 the church dedicated its new preschool/music wing. The first floor is dedicated to ministry with young children and will house our child development center and Sunday School. Our second floor has a choir room, music office, and large meeting area. In the fall of 2013, the congregation completed a series of capital improvements to our facility, including the construction of a chapel, a new kitchen, and our youth center in the building next door to the main church building.

But Georgetown Presbyterian Church is far more than bricks and mortar and a series of capital improvements; we are a congregation of dedicated men and women of faith who seek to serve the Lord Jesus Christ. In 129 years we have had more than 2,600 members, 800+ baptisms, and 18 ministers. We have helped start two churches and helped begin Habitat for Humanity and Helping Hands of Georgetown County. Looking back, through pain and pleasure we can see God's guiding and blessing hand upon us. An understood motto of this church is that we are blessed to be a blessing.

New Harmony Presbytery's February 21

Preacher, Presenter, and Facilitator



Resilience in Ministry

Rev. Dr. Laurie J. Ferguson

Georgetown Presbyterian Church – Worship at 9:45 a.m. and Presentation at 11:00 a.m.

Open to all pastoral leaders and congregants

**For anyone seeking deeper understanding of resilience in daily ministry
-especially in these challenging times.**

Ministry in today's world asks us to navigate constant change, deep emotional demands, and the call to lead with courage and compassion. This gathering offers space to learn, reflect, and strengthen the resilience needed for faithful service. Rev. Dr. Laurie Ferguson, Ph.D., PCC, brings a distinctive blend of pastoral experience and psychological expertise to her role as an Executive and Leadership Coach. She specializes in helping individuals and organizations develop resilience skills and achieve their goals through faithful courage. Her coaching approach draws on her church leadership experience, theological study, and advanced training in clinical psychology, Jungian and transpersonal psychology, life cycles, human development, and organizational development.

As a recognized leader in coach training, Rev. Dr. Ferguson directed the Coaching Institute at Auburn Seminary and established a certificate program at the Life Long Learning Center at Columbia Seminary. In 2020, she founded **Loaves and Fishes Coach Training**, a program dedicated to advancing professional coaching skills among faith leaders (<https://loavesandfishescoachtraining.com>).

Rev. Dr. Ferguson holds degrees from Smith College, Princeton Seminary, and Adelphi University, including a Ph.D. in psychology and a Master of Divinity. She is a licensed clinical psychologist and a Professional Certified Coach (PCC).

She resides in the Hudson River Valley in New York and is a minister member of Hudson River Presbytery. To learn more, visit her website: lauriejferguson.com



Laurie J. Ferguson Ph.D



ROLE OF STRESS

- Chronic stress is most damaging - constant annoying stressors
- **Creates cognitive, emotional and perceptual impairment**
- “helping position” leads to more stress - because managing your own and others’ (emotional contagion)
- stress is a physiological state that leads to increased cortisol
- stops neurogenesis in brain - cannot learn new things



RESULTS OF CHRONIC STRESS

- Impairment
 - difficulty concentrating/focusing
 - less creativity
 - more difficulty with complex tasks
 - reduced field of vision
 - fatigue

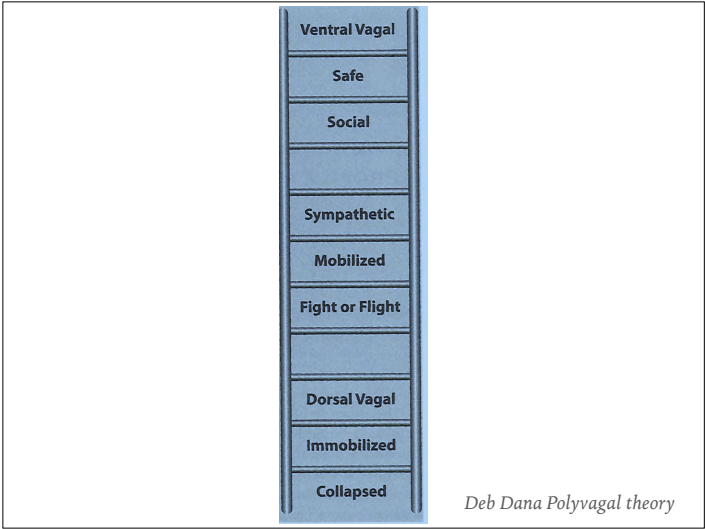

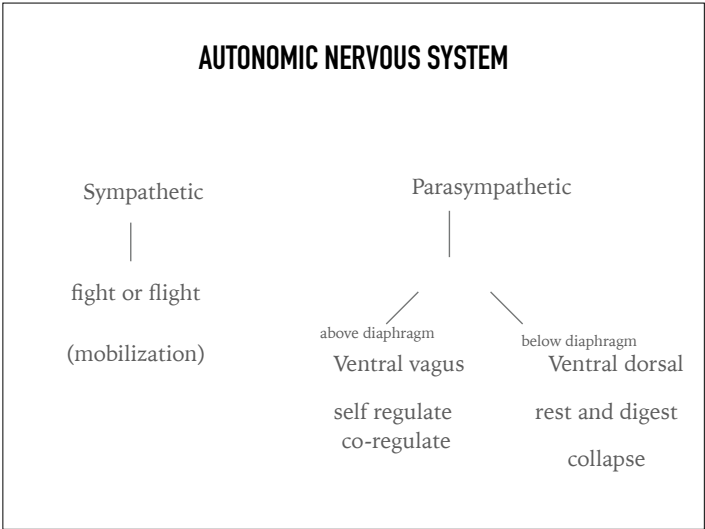



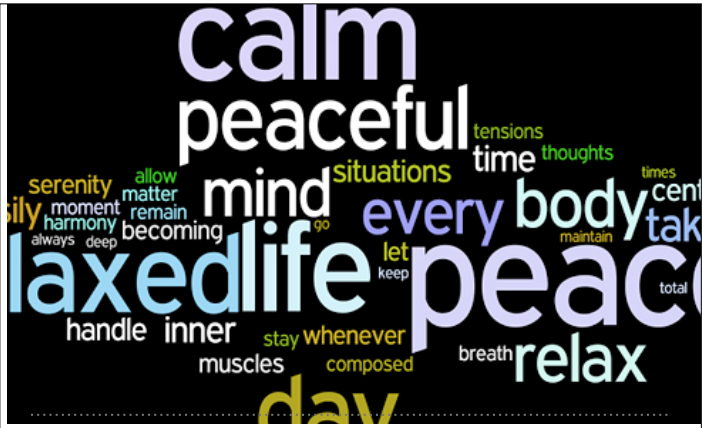

Green Zone

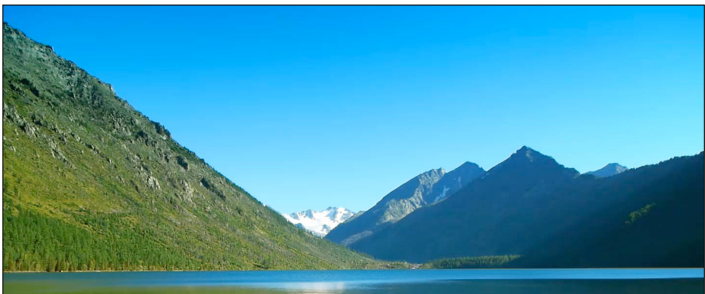

SAFE~BELONGING~SIGNIFICANCE

Identify a recent time you were in the green zone.

How did you feel?

What was going on in your body?

What helped you be there?

RED ZONE

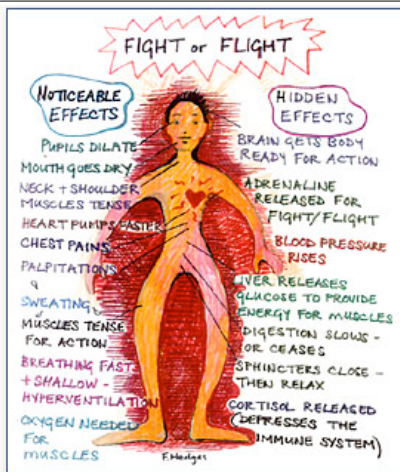

RED ZONE

- stress
- worry
- problems
- frustration
- fears
- being defensive
-

When were you last in the red zone?

What triggers it for you?

How do you feel it in your body?

NEGATIVITY BIAS

VELCRO FOR BAD NEWS

and we ruminate on it



TEFLON FOR GOOD NEWS

CHALLENGING TO BE RESILIENT AND FAITHFUL LEADERS

I, I only am left and they seek my life to take it away..

Elijah



PRACTICES FOR RESILIENT LEADERS

- Spiritual experiences
- Cultivating renewal
- Feeling “in charge”/agency
- Risk Taking
- Nourishing Relationships



SPIRITUAL EXPERIENCES



RENEWAL PRACTICES

- meditation
- yoga/tai chi
- modest physical exercise
- prayer
- being in a loving relationship
- caring for others
- having a cat, dog, rabbit (stroking)
- walk in nature
- playing music
- dancing

CULTIVATING RENEWAL

- Practice shifting from red zone stress to green zone practices
- Embodied (not just thinking)
- Counterbalance red zone moments by regularly cycling into green *2-5 x more often*
- Dosage (15 minutes) and Variety
- 68 days to make a habit in your neural networks



► **BEING
IN
CHARGE**

WILLING TO TAKE RISKS







PRACTICES FOR RESILIENT LEADERS

- Spiritual experiences
- Cultivating renewal
- Feeling “in charge”/agency
- Risk Taking
- Nourishing Relationships

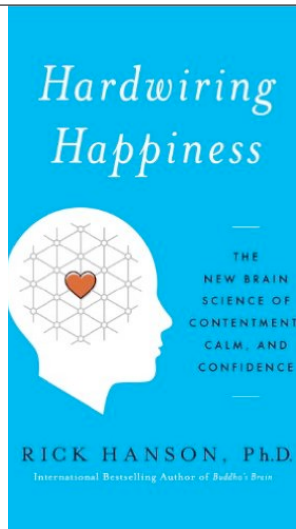

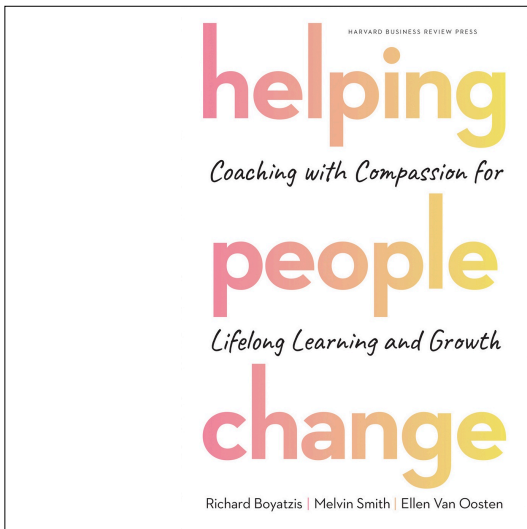

PROPOSED DOCKET

PRESBYTERY OF NEW HARMONY 120th STATED MEETING

9:30 a.m. Saturday, February 21, 2026 at Georgetown

Moderator's Theme: "Partnership Throughout the World"

2-9-26

- 8:30 A.M. Registration, Gathering, Fellowship and Refreshments
- 9:30 Determination of a Quorum and Call to Order with Prayer Rev. Ashley Cheek, Moderator
Land and Labor Acknowledgement
Review and Adoption of the Docket and Omnibus Motion (see Commissioners' Handbook)
Welcome and Recognition of First Time Ruling Elders and Corresponding Members
Introduce and Seat Corresponding Members
Welcome by the Host Pastor Rev. Chris Weichman
- 9:50 Worship (Offering check to "*New Harmony Presbytery*") Rev. Dr. Laurie Ferguson, preaching
- 11:00 Conversation about Resilience in Ministry Rev. Dr. Laurie Ferguson, presenting and facilitating
- 12:00 Lunch – **ORDER OF THE DAY** (cost - \$15; checks - "*Georgetown Presbyterian Church*")
- 1:00 Good News from our Congregations (not announcements) **Ruling Elders ONLY!!!**
- 1:20 Black Church Cornerstone Collaborative (BCCC) Dr. Perzavia Praylow BCCC Director,
Louisville Presbyterian Theological Seminary
- 1:30 Worship & Music Conf. in Montreat Rev. Elizabeth Deibert, Dev. Mgr., Presby. Assoc. of Musicians
- 1:40 Guiding Council Rev. Gavin D. Meek, Guiding Council Moderator
- 2:00 New Harvest Presbyterian Church Administrative Commission Elder Sheryl Davis, Moderator
- 2:15 Committee on Ministry (COM) Rev. Tom Langston, Moderator
Introducing Rev. Chris Weichman, Pastor, Georgetown and Joel Long, Assoc. for COM
Honorable Retirement of Tom Dendy
- 2:45 New Business and any items which might have been removed from the Omnibus Motion
Announcements, Expression of Thanks, Adjournment & Prayer Elder James Wilson, Moderator

Pastors involved in the Black Church Cornerstone Collaborative are to meet with Dr. Perzavia Praylow, BCCC Director, and the Rev. Dr. Ella Busby immediately after Adjournment.

OMNIBUS MOTION

The Presbytery of New Harmony – Saturday, February 21, 2026

(An **Omnibus Motion** expedites business and contains “many” or several items believed to be straight-forward, easily understood, and non-controversial, thus thought not to elicit questions or debate. An Omnibus Motion is acted upon in one vote by the presbytery and comes at the beginning of the meeting. At the time of its consideration at the beginning of the meeting, any Commissioner or Minister member may request the removal of any item in the Omnibus Motion; if that occurs, that item/s will be placed as the first item/s under New Business.)

Your Guiding Council recommends the following OMNIBUS MOTION:

Receive the following written reports and approve the actions therein:

(The Commissioners' Handbook Index has the page number for each report/document.)

- **Stated Clerk**, including...
 - the recommendation to concerning the balance of REs and TEs at NHP meetings.
- **Guiding Council**, including...
 - receiving the 2026 PADD Report (attached), approving its recommendation that Sunday, March 15, 2026, be dedicated “*PADD Sunday*” across NHP, and that a special offering be taken for the ongoing support of the PADD mission. (Note: If, due to conflicting special offerings on this date at a particular church, please choose an alternative date for this special collection).
- **Committee on Ministry (COM)**.
- **Committee on Preparation (CPM)**.
- **Committee on Representation and Nominations (CORN)**, including...
 - receiving the 2026 Committee Representation Analysis (attached).
- **Fork Administrative Commission**.
- **Fraser Memorial Administration Commission**, including...
 - The approval of the request from the congregation of the distribution of 25% of the funds from the sale of the building to local missions that the congregation long supported.
- **Hebron Administrative Commission**.
- **New Harvest Administrative Commission**, NOT including...
 - the dissolution of the congregation.
- **Salem Black River Administration Commission**.
- **Timmonsville Administrative Commission**.

STATED CLERK REPORT

The Presbytery of New Harmony – February 21, 2026
Rev. Gavin D. Meek, Executive Presbyter and Stated Clerk

1. 2026 COMMISSIONER BALANCE (G-3.0301) for NHP Stated Meeting

RULING ELDERS w/vote	TEACHING ELDERS
57 RE Commissioners from 57 Sessions	65 Minister members 1/1/26
+7 Guiding Council RE members (Moderator, Moderator-Elect; 3 at- large; PW and Black Caucus reps)	-4 Transferred: Robert M. Brearley, Nicholas T. Cheek, Mark E. Durrett, Ben William Wilson
+10 Commissioned Pastors	+1 Received: Christopher J Weichman
74 TOTAL RULING ELDERS	62 TOTAL TEACHING ELDERS (14 live outside NHP bounds, 13 of whom are HR)

Given this, the Stated Clerk continues to **recommend for 2026** that First, Myrtle Beach, with a membership of 1,495 as of 1/1/25, which is well over three times the next size congregation, be allotted two (2) Ruling Elder commissioners, and the remaining NHP Sessions be allotted one (1) which has NHP in fair compliance with the *Constitution* (G-3.0301) of the Presbyterian Church (U.S.A.) for the balance of Ruling and Teaching elders.

2. NHP's **Permanent Judicial Commission** continues with **Elder Elizabeth Munnerlyn (First, Bennettsville) as Moderator and Rev. Joan Yates (Supply Pastor, Second, Pageland) as Clerk** and this still applies through 2026. Further, to comply with the Book of Order (D-5.0206b), the following past members of the **Permanent Judicial Commission** continue to be eligible for service if a quorum cannot be obtained from current members:

2022 – Areatha Clark, David Holler 2024 – Rev. Dr. Frank Colclough, Deloris Weaver

3. The annual reporting of statistics based on the reporting of our NHP Clerks of Session will be provided at the May Stated Meeting of NHP.

Guiding Council Report

Presbytery of New Harmony – Saturday, February 21, 2026

Rev. Gavin D. Meek, Moderator of the Guiding Council

RECOMMENDATIONS (in the Omnibus Motion)

1. Receive the 2024 PADD Report (attached), approving its recommendation that **Sunday, March 16, 2025, be dedicated “PADD Sunday” across NHP, and that a special offering be taken for the ongoing support of the PADD mission.** (Note: If, due to conflicting special offerings on this date at a particular church, please choose an alternative date for this special collection).

The Guiding Council (GC) reports the following actions taken on behalf of NHP:

1. Approved the **minutes** of the **November 11, 2025 Stated Meeting of NHP.**
2. Approved today’s offering going to our host congregation for its local mission work.
3. Reviewed the dates and locations of the upcoming **2026 NHP Gatherings:**
 - Feb. 21 (Saturday) Georgetown (last hosted 2/15)
 - May 19 (Tuesday) Indiantown (last hosted 10/18)
 - Aug. 15 (Saturday) ZOOM
 - Nov. 17 (Tuesday) Presbyterian Communities of Florence (last hosted 7/18)
4. Received any and all reports and acted on recommendations from its committees (**Cultivation and Empowerment [CEC]** and **Personnel and Finance [P&F]**) both Moderators reported that their first meeting of the year went well. CEC voted to split the remaining amount in the Ministry to Prisoners & Their Families Special Fund between First Bennettsville and Kingston, Conway with each receiving \$1,742.41 for their respective ministry.
5. Received the following **report from the Executive Presbyter & Stated Clerk:** Gavin is very grateful to have **Rev. Joel Long, Associate for Committee on Ministry (ACOM)** on board assisting with the vast and important COM responsibilities; he is very excited assisting the **Clarendon County (and Congruity/Goodwill Parishes** develop their Parish Commissions and begin their pastoral searches – NHP will give both \$50,000 over five years upon the call of an installed Pastor; Rev. Dr. Busby and Rev. Dr. Praylow will be meeting with the pastoral leaders of our black congregations at the end of the upcoming NHP Gathering to conferring about \$60,000 **Black Church Cornerstone Collaborative (BCCC)** grant from Louisville Presbyterian Seminary for strengthening rural black congregations by way of micro-grants to NHP black congregations; he shared briefly about his participation with the **PCUSA Presbytery Leader delegation to Palestine** (Dec. 9-20) and the terrible conditions for everyone under occupation, including the Christians – he does refer to it as the Holy Lands,

but the Sad Lands; shared that his service on the PCUSA committee that is doing the **6-year review of the Board of Pensions, the Presbyterian Foundation, and the Presbyterian Investment and Loan Program** will end after the General Assembly this summer and his service, after eight years, as one of the eight faculty members for the **Presbytery Leader Formation** that trains new presbytery leaders will end following the week of training in May.

6. Discussed how NHP will want and need to do to move forward both with our **Global Covenant Partnership with Kajiado Presbytery** and the promotion of new outreach initiatives in and with our NHP congregations utilizing the newly revamped **G.I.V.E. Fund (Growth – Innovation – Vitality – Evangelism)**.
7. Approved the request of **Fraser Memorial AC** that from the net proceeds of \$250,641.20 from the sale of the property at 1746 Hwy. 521 S, Sumter, SC, 29150 (Tax Map # 252-00-02-022) 15% be given to Sumter United Ministries and 10% Christian Charities of Sumter; this was the request of the congregation as they were two organizations the congregation supported over many years. What NHP Funds the remaining amount will go is to be decided in the near future. **The Guiding Council dissolved the AC with deep appreciation and thanks: Commissioned Pastor Chuck Staggs, Elder Margaret Joyner, Rev. Stewart Rawson, and Elder Hal Stuckey.**
8. Established, at the anticipated request of COM and on behalf of NHP, an Administration Commission (AC), to be populated by COM to **negotiate and recommend the final terms for the dismissal of the Marion Presbyterian Church to the ECO denomination upon their reception into ECO.**

BACKGROUND: On May 7, 2023, Marion's Session voted 8 to 5 to begin the process as outlined in NHP's policy "A Covenant for Discernment and Mutual Understanding." A Discernment Team of eight, four each from NHP (Rev. Judy Cettei, Rev. Dr. Frank Colclough, RE Frances Dennis, RE Edwin Hinds) and the congregation, worked through the process. On May 16, 2025, the Session called a meeting for January 4, 2026, consider the following motion: ***"Shall the Session of Marion Presbyterian Church be authorized to request dismissal of this congregation from the Presbyterian Church (U.S.A.) to (ECO) A Covenant Order Evangelical Presbyterians, pending acceptance by ECO."*** The attendance was 89 of the 103, well over the two-thirds needed for the quorum and the vote was 79-10-1, well over the 75% needed to adopt the motion. The NHP part of the Discernment Team requested that the COM request the establishment of a that an AC be established to execute the procedures in the above policy.

9. Received reports on **NHP Administrative Commissions:** PDAC, Fork, Fraser Memorial, Hebron, New Harvest, Salem Black River and Timmonsville (see attached AC reports).

G.I.V.E. Fund

Growth, Innovation, Vitality, and Evangelism Fund

New Harmony Presbytery

(Approved by the Guiding Council: 10/29/25)

Purpose

The G.I.V.E. Fund exists to assist and support the witness of New Harmony Presbytery and its congregations to the sovereign activity of God in the world, so that all congregations become communities of faith, hope, love, and witness. The fund provides resources for strategic investments that grow discipleship, innovate ministry approaches, enhance congregational vitality, and extend the church's mission in new and creative ways giving new life and purpose to funds that were once used for new church development.

The G.I.V.E Fund Alings with NHP's Mission and Goals

The G.I.V.E. Fund directly supports New Harmony Presbytery's mission:

- **Nurturing togetherness** through collaborative initiatives and resources that address 21st century challenges
- **Walking alongside pastoral leaders** by funding efforts that equip and encourage their faithfulness, growth, and creativity
- **Supporting racial equality, social justice, and diversity** in all forms of worship and ministry

The fund advances NHP's ministry goals by:

- Engaging in new and creative ministries as we live out of (not on) Presbyterian and Christian traditions
- Embracing and being empowered by our diversity through connecting congregations and communities
- Discovering, highlighting, celebrating, and utilizing the various resources in our midst to grow, innovate, revitalize, and extend the witness of the Presbytery and its congregations.

Principles

The G.I.V.E. Fund operates as an endowment, with ordinarily 5% of the fund balance available annually for distribution. This approach ensures the fund's sustainability and ongoing impact across generations while providing substantial resources for significant ministry initiatives.

Eligible Initiatives

The G.I.V.E. Fund may support initiatives in four key categories:

Growth Initiatives

Projects that grow communities of faith, hope, love, and witness by deepening discipleship, expanding participation, or strengthening spiritual formation.

Examples may include:

Discipleship & Formation

- Comprehensive faith formation programs for youth and adults
- Small group ministry infrastructure (curriculum, leader training, coordination)

- Intergenerational programming that connects age groups in shared ministry
- New member incorporation pathways with mentoring and spiritual gift discernment

Targeted Outreach

- Young adult and young family ministries
- Bilingual or multicultural ministry development
- Digital discipleship strategies for online community building and faith formation
- Community listening projects that lead to relationship-building and invitation

Strategic Partnerships

- Joint ministry ventures with neighboring congregations to reach new populations
- Partnerships with schools, community organizations, or businesses that create natural connection points

Innovation Initiatives

New and creative ministries that live out our Presbyterian witness in our contemporary context while addressing contemporary challenges and opportunities.

Examples may include:

Fresh Expressions of Church

- Dinner church models (worship around shared meals)
- Outdoor or nature-based worship communities
- Jazz vespers, contemplative services, or other alternative worship formats
- Micro-churches or house church networks
- "Church on Tap" or cafe-based faith communities

Creative Use of Resources

- Reimagining building use (community co-working spaces, after-school programs, farmer's markets)
- Shared or collaborative staffing models between congregations
- Bi-vocational ministry models that connect pastors to community contexts
- Social enterprise ministries (coffee shops, thrift stores, community kitchens)

Digital Innovation

- Hybrid worship excellence (intentional online community, not just streaming)
- Virtual small groups, classes, and fellowship
- Podcast or digital content creation for faith formation
- Online giving and engagement platforms that lower barriers

Experimental Ministry

- Ministry prototyping with permission to fail and learn
- Pop-up worship experiences in public spaces
- Arts-based ministry and community engagement

Vitality Initiatives

Multi-year strategies that renew congregational energy, embrace diversity, promote justice, or build capacity for sustained ministry and witness.

Examples may include:

Organizational Health

- Strategic planning and congregational visioning processes

- Conflict transformation and mediation support
- Transitional ministry consultation for congregations in pastoral transitions
- Financial sustainability planning and stewardship renewal

Pastoral Care & Renewal

- Programs addressing clergy burnout and resilience
- Peer learning cohorts for pastors
- Spiritual direction and sabbatical support for ministry leaders

Worship Renewal

- Music and worship arts investments (equipment, musicians, training)
- Liturgical education and worship planning resources
- Preaching excellence workshops

Justice & Equity Work

- Anti-racism training and implementation (Facing Systemic Racism, Sacred Conversations on Race)
- LGBTQ+ inclusion processes (More Light, Covenant Network resources)
- Accessibility audits and improvements for full inclusion

Evangelism Initiatives

Extending the witness of the church by being bearers of good news particularly to vulnerable, under-served, and excluded areas or populations through means other than new church planting and construction.

Examples may include:

Community-Engaged Ministry

- Food security partnerships (community gardens, food pantries, community kitchens)
- Affordable housing advocacy and development partnerships
- Health ministry collaborations (parish nurses, mental health first aid, health fairs)
- Educational partnerships (tutoring, literacy programs, GED preparation)

Justice & Advocacy

- Living wage and economic justice campaigns
- Environmental justice and creation care ministries
- Immigration accompaniment and advocacy
- Gun violence prevention initiatives
- Maternal health and reproductive justice education

Ministry with Marginalized Populations

- Prison and jail ministry (reentry support, family ministry)
- Ministry with those experiencing homelessness (shelter partnerships, street outreach)
- Refugee resettlement partnership and welcome
- Ministry with those experiencing addiction (recovery groups, harm reduction)

Ecumenical & Interfaith Collaboration

- Shared ministry in rural areas or where multiple small congregations exist

Geographic Extension

- Satellite worship or ministry sites in underserved areas
- Ministry in non-traditional locations (apartment complexes, community centers, parks)
- Regional ministries serving clusters of rural congregations

Alternative Models

- Chaplaincy in non-traditional settings (workplaces, public schools, hospitals)
- Community organizing training and participation
- Social enterprise that combines mission and sustainability

Distinction from CEC Grants

While the Cultivation and Empowerment Committee provides grants for specific congregation-initiated projects with defined scopes and timelines, the G.I.V.E. Fund supports:

- **Strategic, transformational initiatives** rather than individual projects
- **Multi-year investments** requiring sustained funding beyond annual grant cycles
- **Larger-scale efforts** that may exceed CEC grant limits
- **Capacity-building and systemic change** that creates lasting organizational, ministry, or justice infrastructure

CEC grants empower congregations to experiment with specific ministry projects; G.I.V.E. Fund investments create the conditions for sustained growth, innovation, vitality, and extension across the presbytery.

Eligible Recipients

G.I.V.E. Fund recipients may include:

- New Harmony Presbytery itself for presbytery-wide initiatives, including engaging part-time consultants as a resource to work on developing new worshiping communities and new outreach/transformation efforts within current congregations. Consultants to implement Anti-racism training, LGBTQ+ inclusion training, as well as justice and advocacy training for work with marginalized groups can also be included in these initiatives.
- Individual congregations pursuing transformational change
- Clusters of congregations working collaboratively
- New Worshipping Communities
- Partnerships between NHP congregations and community organizations advancing shared mission

Application and Accountability

Proposals should demonstrate:

- Strategic approach to growing faith communities or extending witness
- Emphasis on creativity, diversity, justice, or collaborative resource-sharing
- Defined goals with measurable outcomes
- Plan for sustainability beyond initial funding
- Potential for significant, lasting impact

The **G.I.V.E. Fund** shall be administered by [the Guiding Council/appropriate committee], which will develop detailed application guidelines, evaluate proposals, approve funding, and monitor outcomes. Recipients will be required to provide regular progress reports and final evaluations demonstrating faithful stewardship and results.



SPECIAL FUNDS



Cultivation and Empowerment Committee (CEC)

New Harmony Presbytery

The Guiding Council has approved the conversion of some longtime, unused funds and given CEC authority to make them available to NHP congregations through its grant application process:

Green Grants: \$23,000 total available

Grants ordinarily for 50% of the project cost, up to \$2,000 to assist NHP congregations with their green projects (e.g., installing LED lights or new installation).

Peacemaking Grants: \$3,715.79 total available

Grants ordinarily for 50% of the cost, up to \$500 to assist NHP congregations with their peacemaking work (e.g., a racial reconciliation project or an anti-gang initiative in the local community).

Ministry to Prisoners & their Families Grants: \$4,484.82 total available

Grants ordinarily for 50% of the cost, up to \$500 to assist NHP congregations with their ministry (e.g., transportation for family to visit their loved one or support for a congregational ministry to those incarcerated or formerly incarcerated).

Youth Mission Trip Grants: \$20,299.70 total available

Grants ordinary for 50% of the cost of the trip, up to \$1,000 to assist NHP congregations with their youth mission trips.

Campus Ministry Grants: \$7,994.30 total available

Grants ordinarily for 50% of the cost, up to \$1,000 to assist NHP congregation with their campus ministry efforts (e.g., providing lunch for college students after worship or providing fellowship time and food for a weekday event).

THE PRESBYTERY OF NEW HARMONY

2352 Presbyterian Road, Florence, SC 29501

www.NewHarmonyPres.org

Office@NewHarmonyPres.org

Rev. Gavin D. Meek

Executive Presbyter and Stated Clerk

646-546-0522

Gavin@NewHarmonyPres.org



Rev. Dr. Ella F. Busby

Associate for Pastor Concerns and Fellowship

843-298-2300

Ella@NewHarmonyPres.org

SPECIAL FUND APPLICATION – New Harmony Presbytery

Thank you for completing and submitting this application, so that New Harmony Presbytery (NHP) can be in partnership with your congregation in order to assist and support the witness of congregations (and their leaders) to the sovereign activity of God in the world so that congregations might be communities of faith, hope, love, and witness to Jesus Christ.

Please note: Only one application/congregation/year/fund.

Please provide ALL of the following:

- Your Name:
- Email:
- Cell number:
- Name of Congregation:
- Date submitted:
- Date this application was approved by the Session:
- Special Fund for which you apply: ☐ Green
☐ Peacemaking
☐ Ministry to Prisoners & Their Families
☐ Youth Mission Trip
☐ Campus Ministry
- Briefly describe the work of this project:
- What is the **TOTAL COST** of the project?
- **Keeping in mind the largest amount per Fund, what amount is requested?**
- If you receive this grant, how will that news be shared with your congregation?

When completed, please email to office@newharmoniypres.org with “SPECIAL FUND APPLICATION” in the subject line.

Every request will be prayerfully considered.

If you have any questions, please contact the NHP Office. Thank you!

NEW HARMONY IS A PRESBYTERY THAT...

➤ NURTURES TOGETHERNESS WITH RESOURCES FOR ADDRESSING THE ISSUES OF THE 21ST CENTURY;

➤ WALKS ALONGSIDE ITS PASTORAL LEADERS WITH CARE, EQUIPPING AND ENCOURAGING FAITHFULNESS, GROWTH AND CREATIVITY; AND

➤ SUPPORTS, ENCOURAGES AND PROMOTES RACIAL EQUALITY, SOCIAL JUSTICE AND ALL FORMS OF DIVERSITY WITHIN WORSHIP AND MINISTRY.

SCHOLARSHIP (individual) or GRANT (congregation) APPLICATION

New Harmony Presbytery

Thank you for submitting this request, applying to be in partnership with New Harmony Presbytery (NHP). We intend for any financial assistance provided by NHP to bear witness to the connectional nature of the PCUSA and our desire to be in partnership to assist and support the witness of congregations (and their leaders) to the sovereign activity of God in the world so that congregations might be communities of faith, hope, love, and witness to Jesus Christ. We take the stewardship of these funds very seriously because they are the faithful gifts of our congregations. We are grateful for this partnership with all our congregations, its leaders, and members.

EXPECTATIONS for NHP GRANTS and SCHOLARSHIPS

- **NHP SCHOLARSHIP:** We believe that shared financial responsibility is wise, therefore, we ordinarily encourage a cost sharing plan of 1/3 by the individual, 1/3 by the individual's congregation, and 1/3 by the NHP Scholarship. We expect that the event will be PC(USA) sponsored, held at one of our conference centers or seminaries, or sponsored by an ecumenical sibling or partner. The recipient is expected to attend the entire event, and following the event, share their learning and experience with their congregation and NHP.
- **NHP GRANTS:** These Session endorsed grants are for new ministry within the congregation or new mission in the community. Ordinarily, we **do not** provide financial support for building maintenance, operating budget support, or "aid to field" (salary support for pastoral leadership).
- Following participation in the event or the beginning of the ministry or mission, the scholarship recipient or the congregational leaders will provide a report or presentation to NHP and/or to the Cultivation and Empowerment Committee (CEC)..

OTHER HELPFUL INFORMATION:

- Every request will be prayerfully considered.
- Requests of more than \$5,000 will require two approvals by the committee.
- We expect any funds not used for the event, ministry or mission will be returned.
- Ordinarily, priority goes to those persons/congregations that have not received a scholarship, grant, or other financial assistance in recent years; subsequent requests will be considered at a lessor amount of the full amount requested.

Please provide ALL of the following:

- Your Name:
- Email:
- Telephone number:
- Name of your Congregation:
- Date submitted:
- If this application was approved by the Session, include the date of that meeting:
- Name of Moderator of Session:
- Name of Clerk of Session:
- Check one: Is this for an individual's scholarship__ OR a congregational grant __?
- What is **the exact amount being requested from NHP?**
- What is the breakdown of all your anticipated expenses **and** all sources of funding?
- If a scholarship, who is sponsoring/organizing the event?
- How will this experience be shared with your congregation?
- How will this experience impact your congregation?

When completed, please email to office@newharmoniypres.org with “GRANT APPLICATION” or “SCHOLARSHIP APPLICATION” in the subject line.

If you have any questions, please contact the NHP Office. Thank you!



Rev. Joel Long

Minister of Word and Sacrament

Honorably Retired Teaching Elder
Member of Salem Presbytery

Formal Education:

BA, Lenoir Rhyne University, Hickory, NC
M.Div., Columbia Theological Seminary, PCUSA

Certification: Interim/Transitional Ministry Week 1 and 2

Continuing Education: Stewardship, Conflict Mediation, Interim/Transitional Training

Work Experience:

First, Quitman, Georgia, Solo Pastor, 125, 3 years
Mulberry, Charlotte, NC, Solo Pastor, 400, 5 years
Sharon, Charlotte, NC, Head of Staff (supervised 1 Teaching Elder and staff), 1,050, 2 years
Carolina Freight Carriers, Cherryville, NC, Corporate Chaplain, 11,000 employees, 5 years
First, Eden, NC, Head of Staff (Supervised several staff members), 650, 15 years

Interim/Transitional Ministry:

Fellowship, Greensboro, NC, Interim, Head of Staff, 250, 2 years
First, Boone, NC, Interim, Head of staff, 400, 2 years
Acting General Presbyter, Salem Presbytery, 3 months
New Philadelphia Moravian, Winston-Salem, NC, Interim Associate Pastor, 1,100, 6 months
Alamance, Greensboro, NC, Interim, Head of Staff, 500, 2 years
Sinking Spring, Abingdon, Virginia, Interim, Head of Staff, 250, 2 years

Congregations Served in New Harmony Presbytery:

First, Sumter, SC, Bridge Interim Pastor, 400, 6 months
Trinity, Surfside Beach, SC, Parish Associate for Pastoral Care, 125, 4 Years (actively serving)
Georgetown Presbyterian, Georgetown, SC, Transitional Pastor/Head of Staff, 400, 11/23-9/25

Service to the Church:

Commissioner, General Assembly
Committee/Commission on Ministry, Salem Presbytery
Administrative Commissions
COM Liaison to Pastor Nominating Committees
Acting General Presbyter, Salem Presbytery

Faith Journey

Rev. Chris Weichman

I was born in Evanston, IL and moved to Pittsburgh, PA at the age of four. I grew up with three younger sisters. I did not grow up in a Christian family. My mother was raised Catholic and attend parochial school; my father had no faith background.

My youngest sister began attending a youth group at a Presbyterian church. One evening she returned from youth group and announced to the family, "We need to go to church." We attend four or five times a year. It wasn't until I went to Westminster College that I became interested in church, the Bible, and faith. I was invited to Sunday evening vesper services and was greatly encouraged by Rev. Wayne Nickerson, Dean of the Chapel. His messages connected the gospel to real life. Through the chapel office I began volunteering with our Habitat for Humanity student group. This helped me grasp faith not just as an intellectual exercise, but as something that is lived out. When I was twenty-one, I was baptized and joined the church.

My faith has always been connected to mission. After a brief stint with Dun & Bradstreet after graduation I began to volunteer with a Christian housing Ministry called Hosanna Industries in Pittsburgh. Hosanna specializes in home repairs for families in need. Eventually they offered me a full-time position. It was during my time at Hosanna Industries that I felt a call to ministry. After a long season of prayer and discernment I enrolled at Pittsburgh Theological Seminary. In seminary I was discerning if was being called to the mission field or to the pastorate, so between my middle and senior year I spent ten months in Berlin Germany working with Kurdish refugees from Iraq and Turkey. My senior year I committed to pursue pastoral ministry. I was ordained in June 1998. I am grateful God has graced me with this call.

I have been blessed to serve in churches with a strong missional identity. My current church is First Presbyterian Church of the Covenant in Erie, PA. As a downtown church we are very active in our neighborhood, with an outreach to Gannon University students and a vibrant ministry with the unhoused and families that struggle to make ends meet. This ministry has had a powerful impact on me and the church. We now advocate for our neighbors and friends who work to find stability for themselves and their families. We strive to be a place of welcome for our neighborhood.

I enjoy serving the church in various ways. I have served as the moderator of Shenango Presbytery and as a presbytery representative to the Synod of the Trinity. I am currently serving on the board of directors for The Outreach Foundation and as a Trustee at Pittsburgh Theological Seminary.

I have been married to my wife Karen for twenty-six years. We have two daughters, Emma and her husband live in Charlotte, NC and Noelle will be graduating in December from Clarion University with a degree in psychology and early childhood intervention.

Statement of Faith

Rev. Chris Weichman

I believe in the Triune God – Father, Son, and Holy Spirit. There is only one living and true God, the author of creation, who was before the foundations of the world. In scripture, prayer, and worship the living God encounters human beings. God desires to be in relationship with us and in grace covenants with us strengthening the bonds of relationship and reconciliation.

I believe in the sufficiency of God's grace. In the fullness of time God sent Jesus Christ into the world, to bear the sins of the world and to reconcile the world to himself. In his life and on the cross Jesus made atonement for our sins. As Jesus is one with God it was impossible for him to be defeated by death. Jesus rose from the dead and ascended to heaven. It is as true God and true flesh that Jesus acts as our mediator and intercessor at the right hand of God. Just as Jesus ascended so he shall come again in the fullness of time. At his coming the dead will be raised and the creation will be renewed and restored.

Our faith comes from the Holy Spirit through the proclamation of the gospel. It is the Holy Spirit which at Pentecost gave birth to the church. The Holy Spirit dwells within us and among us and unites us with Christ. Faith is our God given response to the gospel whereby we come to trust God. We come to know scripture as the word of God by the testimony of the Holy Spirit moving our hearts and minds to be transformed more and more into the image of Christ. The Holy Spirit unites us with Christ, elicits our faith, and makes us alive to the presence of God in the sacraments.

It is through the sacraments that we are marked as believers and empowered for mission in the world. Baptism is a symbol of our participation in Christ's death and resurrection. We are engrafted into Christ and become united with him. We have died to the old and are raised in newness of life. Through baptism we are not only united with Christ but to believers past and present. In baptism we are called to live lives of faithfulness and discipleship. Baptism is a sign of God's enduring grace; though we may falter God's grace endures.

The celebration of the Lord's Supper is a celebration in the presence of Christ. We give thanks for God's presence and work in the world, and anticipate the fulfillment of the Kingdom. In the Lord's Supper we declare of faith in Christ and remember his life, death, and resurrection. It is a communion with the risen Lord and with other Christians in the body of Christ. In the breaking of the bread and pour out of the cup we are fed spiritually by faith, and are renewed by the presence of Christ for mission in the world.

By the gift of faith we are called to serve the world. We are to proclaim the gospel boldly in the struggle against injustice, poverty, and evil. God has given the church a special calling, to speak about the hope of the good news in Jesus Christ.

2026 Committee Representation Analysis

Committee on Representation and Nominations - Presbytery of New Harmony

	Teaching Elders	Ruling Elders	Members	White	Black	Asian	Other	Male	Female	Under 50 yrs. Old
Guiding Council	4	7	-	5	6	-	-	5	6	1
Cultivation and Empowerment (CEC)	4	4	1	7	2	-	-	5	4	-
Personnel and Finance (P&F)	2	7	-	6	3	-	-	4	5	1
Committee on Ministry (COM)_	4	11	-	10	5	-	-	5	10	3
Committee on Preparation for Ministry (CPM)	6	6	-	9	3	-	-	6	6	1
Committee on Representation and Nomination	3	5	1	5	4	-	-	4	5	-
Permanent Judicial Commission (PJC)	4	3	-	5	2	-	-	3	4	-
Self Development of People (SDOP)	3	2	-	2	3	-	-	2	3	1
Presbytery Disaster Administration Commission (PDAC)	4	3	-	3	4	-	-	3	4	-
¹² TOTAL	34	48	2	52	32	0	0	37	47	7
GRAND TOTAL	84			84				84		7

Staff: 2 female, 3 male; 1 black , 4 white, 1 lgbtqia+

As required, the committee shares the following observations about New Harmony Presbytery (NHP):

- NHP embraces racial/ethnic diversity as a core value.
- NHP has improved its gender representation which is also a core value.
- NHP has not made it a core value to seek the participation of younger leaders as we have very few serving, due, in large part, because many of our committees meet during the weekday.
- The Guiding Council, which has commission powers, is not balanced between Teaching and Ruling elders as the Book of Order indicates “should” be the case for entities that have commission powers. However, Ruling Elders out number Teaching Elders which is likely best.
- NHP has used technology (ZOOM) to facilitate its committee meetings and that has allowed more and different people to serve.
- Some congregations could have more participation, especially those which are less involved and connected to NHP and those with larger memberships.
- Pastoral leaders and Session Moderators are our best ways of identifying persons who possess the particular gifts and skills needed for service in NHP.

New Harvest Administrative Commission Report

The Presbytery of New Harmony – November 11, 2025

Elder Sheryl Davis (Moderator) Rev. Dr. Christa Brewer (Clerk)

Elder Janice Smith, Elder Tom Hoffmeyer, Commissioned Pastor Marshall

Ivey Rev. Gavin D. Meek, Ex-Officio and Stated Clerk

RECOMMENDATION

The New Harvest Presbyterian Church Administrative Commission, respectfully and with deep sadness, unanimously recommends that the congregation of New Harvest Presbyterian Church be dissolved.

Having been established in the spring of 2024 and having its first meeting on May 21, 2024, the AC has prayerfully walked, first with the session and then with the congregation to provide prayer and support. A Session was re-constituted in early spring of 2024 after the previous AC assumed Original Jurisdiction (This means the AC is the Session; see G-3.0303e) in the spring of 2017. However, in the summer of 2025, this current AC requested and received from the Guiding Council the authority to assume Original Jurisdiction due to one of the three Session members transferred membership and another, Elder Anne Crump, was not able to serve due to health concerns; Elder Crump joined the Church Triumphant and Eternal on January 2, 2026, (A life-long and dedicated member, her celebration of life was held in New Harvest with the Rev. Dr. Ella Busby officiating and members of the AC attending and serving.)

Since assuming Original Jurisdiction, the AC has been assessing the viability of the congregation. Prior to the death of Elder Crump there were ten faithful members, one of whom cannot be located

and several not attending with any regularity or able to do so. The financial resources and giving are not able to sustain any kind of part-time pastoral leadership or the church facility; NHP provided \$35,000 for required roof replacement and the replacement of the three HVAC units, the latter of which is on hold for various reasons, including there is currently not enough money to do the job.

The AC called a meeting of the congregation for November 16 2025 and asked the congregation to vote on a proposal to dissolve the congregation. A letter was mailed to the members, and four were present along with the entire AC and the COM Moderator and New Harvest COM Liaison. After fully hearing from every member present on the proposal, the vote followed, resulting in a 2 to 2 tie.

The AC met afterwards and adopted unanimously the recommendation before you today. This recommendation comes to you after many months of careful discernment and prayer and is believed to be the most faithful path forward given all the circumstances. This is a difficult moment. However, we trust that God will continue to use the seeds planted at New Harvest for God's glory.

Respectfully submitted,
Elder Sheryl Davis, Moderator

Fraser Administrative Commission Report

The Presbytery of New Harmony

Commissioned Pastor Chuck Staggs Moderator

Rev. Gavin Meek, Stated Clerk and Ex-Officio

Chuck Staggs (moderator): Commissioned Pastor for Fraser Memorial (dissolved) and Swan Lake PCs in Sumter, S.C., former member of C.O.M.

Elder Margaret Joyner: (Clerk) Clerk of Session at Fraser Memorial PC

Rev. Dr. Stewart Rawson: Minister at First Presbyterian Church in Sumter, S.C.

Elder Hal Stuckey: Liaison from NHP to Fraser Memorial PC, Sumter, S.C.

Elder Lisa Cooper: Elder at Second Presbyterian Church, Sumter, S.C.

Fraser Memorial Presbyterian Church had their last church service and the congregation dissolved on November 8, 2025. 92 people attended this service and shared dinner afterwards where many memories were shared about the ministry and members of Fraser Memorial Presbyterian Church.

An offer was received by the Administrative Committee from Ein Geddi Ministries for the Fraser Church building and property of \$274,000.00 which was voted on and accepted by the Fraser A/C.

A closing meeting was scheduled for December 9, 2025 with William Croft, Attorney to with Fraser A/C Moderator Chuck Staggs representing Fraser Church and representatives from Ein Geddi Ministries. After paperwork was signed and all fees and cost were deducted, a check was accepted in the amount of \$250,641.20 and deposited in the Fraser Church bank account. After all Fraser accounts were closed and paid, a check for \$260,292.92 was issued to The Presbytery of New Harmony.

The Guiding Council of New Harmony Presbytery met on February 4 and approved the percentages, asked for by Fraser Church and recommended by the Fraser A/C to the Guiding Council, for Sumter United Ministries (15%) to be for homeless ministry and Sumter Christian Charities (10%) to support the community in times of need.

The Fraser Administrative Committee for Fraser Memorial Presbyterian Church has been dissolved being that it's work was accomplished.

Respectfully submitted by Moderator: Commissioned Pastor Chuck Staggs

Fork Administrative Commission Report

The Presbytery of New Harmony – January 4, 2025

BACKGROUND: The congregation has dwindled to only a few active and regular members and attenders, with little remaining financial resources.

The AC met for its first time on January 4th. Those in attendance were:

Commissioned Pastor Bob Henry (AC Moderator) Commissioned Pastor for Fork Presbyterian Church (FPC) and Cultivation and Empowerment Committee member

Rev. Robert Bannan: Pastor, Kingston PC, Conway; Committee on Ministry member and FPC COM Liaison;

Rev. Jen Kottler, Supply Pastor at John Calvin and Committee on Ministry member;

Elder James David Lane: Clerk of Session, Fork PC

Elder Janice Rosier: First PC, Bennettsville

Rev. Gavin Meek: EP & SC, ex. officio with voice, no vote.

After introductions were made, discussions on where the Church attendance and finances were made. Then how the Church was to move on. The Church currently does not have insurance so Gavin said he would look into procuring it through the Presbytery. With attendance and finances dwindling there was discussion as to how low to allow the accounts to go prior to the closing and possible sale of the Church.

We have not scheduled the next meeting yet. We will set the next meeting when the actual voter roles is gathered and insurance is procured.

Hebron Administrative Commission

Report to the Presbytery of New Harmony - February 21, 20226

The Hebron Administrative Commission is working amicably with the Hebron Presbyterian Church families in the direction of dissolving the congregation and disposing of the property in such a way that it continues to be holy ground for the people who love it the most.

The Commission, consisting of Rev. Carnell Hampton, and Ruling Elders Dorothy McBride and David Holler, in addition to the co-moderators, has learned that the Hebron property is one parcel, church and cemetery; and further, that the church's cemetery association is not incorporated, though it long has been assigned an E.I. N. by the IRS for tax purposes. Consequently, the Hebron families will be advised to seek the services of a real estate attorney.

On legal processes, we wait. On cemetery financial reporting, we wait. In the meantime, conversations continue with the principals of the Hebron heritage. Hebron's local ministries continue: occasional community special events and regularly scheduled bible studies (prayer meetings) that embrace the concerns of community neighbors, including Hebron's former supply pastor and AC moderator, Jack Humphries.

The church weathered the winter storms without incident. Hebron Ruling Elder Hugh Fraser checked on the property, and does upkeep.

As provided by Will Fraser, the cash balance of Hebron's operating account on Jan. 1, 2026 was \$12,617. Bills are paid; property insurance is current; there is no indebtedness.

Jody P. Foster and Chuck Staggs, co-moderators

Salem Black River Administrative Commission Report

The Presbytery of New Harmony – February 21, 2026

Elder Johnny Raffield, Co-Moderator, **Rev. Dr. Stewart Rawson**, Co-Moderator, **Rev. Dr. Frank Colclough**, Clerk, **Elder Margaret Cooper**, **Elder Ellaree Hampton**, **Rev. Gavin Meek**, Stated Clerk and Ex-Officio

The AC has met four times by Zoom.

On September 28, the members of the AC worshiped at SBR. Following worship, the session received the AC with cake prior to meeting. The meeting began with introductions of all present. The AC expressed to the session that it wanted them to remain in the PCUSA with New Harmony Presbytery. Discussion for a way forward to address all concerns was not achieved; however, making the face-to-face connection directly with the session did convey how important historically and contemporarily the SBR congregation has been as a strong supporter of NHP. Although no specific progress was made, just sitting down over refreshments was helpful.

On September 30, the AC appointed Rev. Dr. Frank Colclough, Rev. Dr. Stewart Rawson and Rev. Gavin Meek to meet with a representative selected by the SBR which occurred by Zoom on October 29. The focus of the meeting was to move forward in a way that is favorable and acceptable to both parties. The members of the AC felt the meeting was productive and positive. The SBR representative stated he will meet with the session in order to work out a way to move forward. The AC looks forward to his report.

Timmonsville Administrative Commission Report

The Presbytery of New Harmony – February 21, 2026

Commissioned Pastor Bob Henry, Moderator, **Rev. Jen Kottler**, **Elder Christie McLeod** and **Elder Cheryl Jackson**

The Timmonsville AC has not met since our last report. The Timmonsville property is still up for sale, and a sign has been placed in front of the building. All of the information on the building has been provided to the Realtor. The water has been shut off, and the power has been switched to the Presbytery.

Presbyterian Agency for the Developmentally Disabled, Inc. (PADD)

Presbytery Report

February 21, 2026

Information

The current serving members of the PADD volunteer Board of Trustees are: Bob Kearns (Chair), Frank Colclough (Vice Chair), Vicky Moore (Secretary), Dorothy McBride (Treasurer), Frank Holsclaw, Janet Elvington, Jennifer Kottler.

PADD is always seeking individuals who would be interested in becoming involved in this mission. There are many ways to participate. One could join the Board of Trustees or the PADD Human Rights Committee; provide opportunities for residents to volunteer in community organizations; invite residents to participate in your social activities, and visit the residents.

A rebuild of the floor system was completed at the Kearns Home in June. During the rebuild the residents were relocated to temporary housing for close to six months, as they could not remain in the home during the reconstruction. In addition to the hardships experienced by our residents and staff during the reconstruction, this event has added significant expense to PADD; all of which was unbudgeted. The poor condition of the floor system should have been made known to us by several parties prior to the purchase of this house. PADD has filed a law suit to recover damages.

Due to recent discharges, PADD has two openings for male residents, and one female resident. This is a wonderful opportunity for individuals seeking a residential placement for a loved one. Information on entrance requirements can be obtained by contacting the Executive Director.

PADD has employment opportunities. Full time and part time positions are available. PADD is always searching for employees with a “heart for service” and a love for people with disabilities.

PADD’s fiscal year is July 1 to June 30. A financial audit and “Agreed Upon Procedures” audits were completed in 2025. PADD was found to be in a sound financial and operating position.

On behalf of the Board of Trustees, our staff and our residents and their families, we express our sincere gratitude for the Presbytery’s continuing prayerful and financial support. You are a blessing to all of us.

Recommendation

It is recommended that Sunday, March 15, 2026 be dedicated “PADD Sunday” across the Presbytery, and that a special offering be taken for the ongoing support of the PADD mission. (Note: If, due to conflicting special offerings on this date at a particular church, please choose an alternate date for this special collection).

Submitted by:

Robert W. Kearns, Chair: PADD Board of Trustees

Contact Information: Ms. Kimberly Tumbleson, Executive Director. PADD Wren Home, 2350 Regional Road, Florence, SC 29501. Cell: 843-687-7046. E-mail: ktumbleson@paddsc.org

PADD, Inc. Addendum to Annual Presbytery Report

The following information is provided annually in the form of “Frequently Asked Questions” to further acquaint members of Presbytery with the PADD organization and operation.

What is PADD? The complete name of the mission is: “Presbyterian Agency for the Developmentally Disabled, Inc”. This mission was founded by The Presbytery of New Harmony and chartered as a sub-unit of PCUSA as a non-profit 501c3 in 2000. PADD maintains a close link with NHP and its congregations. The mission is directed by a volunteer Board of Trustees. The board currently has 7 members. The by-laws require that 2/3 of the Board be members of PCUSA.

What is PADD’s Mission? “To provide the highest quality of life and the greatest possible level of independence for each resident within the context of a community based residential facility.”

Who does PADD serve? PADD serves individuals who have an intellectual or related disability. Commonly abbreviated ID/RD. ID standing for Intellectual Disability. RD standing for Related Disability such as Autism. PADD is a contract Qualified Provider for the South Carolina Department of Disabilities and Special Needs (SCDDSN). As a provider, PADD is able to accept persons on the DDSN Critical List; persons desiring to transfer from one DDSN facility to another, persons in the “centers” who seek a less restrictive environment. PADD is not able to accept private pay residents. Applications for residence in the group home will be accepted from any interested individuals or their representatives. For the application process, and admissions criteria, please contact the Executive Director.

How does PADD implement its mission? 1. PADD acquires and manages homes for people with intellectual disabilities. 2. PADD Creates and/or coordinates programs and services for residents. These would include items such as day programming, community activities and medical support. 3. PADD maintains standards and compliance with all state and federal rules and regulations. This is a major responsibility 4. PADD Secures funding to support ongoing operations and future growth. 5. PADD builds community awareness.

How many homes does PADD operate? PADD currently operates three homes in Florence. One home is a 6 bed Community Residential Care Facility (CRCF) located next to Presbyterian Community of Florence. This is a home for 6 female residents. Second is a Community Training Home II (CTH II) which is home for four women. Third home is a CTH II for four men.

Who takes care of the residents? Residents are cared for by a 24/7 awake staff. The staff is led by a Licensed Administrator/Executive Director. The staff includes one Activity Director/Administrative Assistant and 18 Direct Service Personnel (full, part time and PRN). PADD also contracts with outside organizations to provide services. Contractors include a CPA, a Registered Nurse, and a Behavior Specialist.

What activities do the residents engage in? During the day, and depending on ability and personal choice, residents volunteer at various locations in the community or attend a structured day program. Residents also go shopping, out for meals, take field trips, attend worship and go to special events.

Who provides health care? All residents have their own doctors. Staff transports residents to their appointments, and under a tightly regulated system, monitor resident’s health and administer medications as prescribed. An independent nurse conducts regular record checks to ensure compliance and also checks on residents.

Who does transportation? Each home has a van. Staff are all qualified to transport residents to their daily activities and outside appointments.

What is life like in the home? The objective is to make the resident’s living experience as close as possible to living in a family setting. Each resident has a private bedroom with internet, cable and phone. The common areas are shared. Meals are prepared by staff. Under supervision residents do household chores and their own laundry.

What are PADD’s annual expenses? In Fiscal Year 2025/2026 the proposed budgeted expenses will be 1.3 million dollars. Major expense items are Salaries/wages; Insurance; Food and provisions. Other larger expenses include utilities, professional fees, van, resident activities, cable and internet.

What are the funding sources? Major sources of funding include: Resident’s Social Security; the Medicaid Residential Waiver through Health and Human Services; Optional State Supplementation; Presbytery mission budget; donations from individual churches; grants, and individual gifts.

Who can I call for additional information?

Mr. Robert Kearns, Chair PADD Board of Trustees. 304 Warner Drive, Hartsville, SC 29550. kearnsr@aol.com
Cell: 843-858-6976. (Board Membership. Committee Opportunities. Donations.)

Ms. Kimberly Tumbleson, Executive Director. PADD Wren Home, 2350 Regional Road, Florence, SC 29501.
Cell: 843-687-7046. ktumbleson@paddsc.org (Employment. Volunteer Opportunities. Admissions. Overall Operations)

2025.12.31 YE NHP Operating Budget FINAL

Date Range: Jan 1st 2025 - Dec 31st 2025 | Includes Open Transactions

Accounts	Actual Last Year Year to Date	Actual This Year Year to Date	Annual Budget This Year Year	Annual Budget Remaining This Year Year	Annual Budget % Used This Year Year
Revenues					
Budgeted Receipts					
400100 Shared Mission Support	371,529.34	389,586.56	380,000.00	(9,586.56)	102.52 %
400200 Per Capita Apportionment	113,664.42	139,491.14	132,405.00	(7,086.14)	105.35 %
400400 Trans - Candidate/Scholarship Fund	3,000.00	3,600.00	7,000.00	3,400.00	51.43 % #
400405 Trans - Mission & Ministry (M&M) Fund	0.00	23,665.49	65,250.00	41,584.51	36.27 % *
400415 Trans - Small Church Support/Redevelopment Fund	3,551.14	3,600.00	40,000.00	36,400.00	9.00 % \$
400422 Trans - Unrestricted Reserve	66,101.39	(22,518.92)	0.00	22,518.92	0.00 % *
400424 Trans - Campus Christian Life Fund	2,000.00	2,000.00	2,000.00	0.00	100.00 % +
400900 Interest Income	1,087.12	1,257.83	1,000.00	(257.83)	125.78 %
Total Budgeted Receipts	560,933.41	540,682.10	627,655.00	86,972.90	86.14 %
Other Income					
400580 Mortgage Income	22,048.00	27,750.41	27,200.00	(550.41)	102.02 %
Total Other Income	22,048.00	27,750.41	27,200.00	(550.41)	102.02 %
Total Revenues	\$ 582,981.41	\$ 568,432.51	\$ 654,855.00	\$ 86,422.49	86.80 %
Expenses					
Mission					
520000 GA Shared Mission Support	80,000.00	70,000.00	70,000.00	0.00	100.00 %
520050 GA Per Capita	64,346.80	70,470.84	70,460.00	(10.84)	100.02 %
520100 Synod Shared Mission Support	6,566.00	6,501.00	6,500.00	(1.00)	100.02 %
520103 Synod Per Capita	9,849.00	9,751.50	9,750.00	(1.50)	100.02 %
520105 Presbyterian College	5,000.00	5,000.00	5,000.00	0.00	100.00 %
520110 SC Christian Action Council	5,000.00	5,000.00	5,000.00	0.00	100.00 %
520400 Presby Retirement Communities SC	10,000.00	10,000.00	10,000.00	0.00	100.00 %
520500 SC Inn at Montreat	5,000.00	5,000.00	5,000.00	0.00	100.00 %
520505 SC Campus Ministry	2,000.00	2,000.00	2,000.00	0.00	100.00 % +
520810 P.A.D.D.	5,000.00	5,000.00	5,000.00	0.00	100.00 %
520815 Presbytery Leader Formation	197.63	250.00	250.00	0.00	100.00 %
Total Mission	192,959.43	188,973.34	188,960.00	(13.34)	100.01 %
Guiding Council					
522010 Council Expenses	388.82	57.40	300.00	242.60	19.13 %
522024 Administrative Commissions	965.51	472.06	500.00	27.94	94.41 %
522025 Presbytery Gatherings	8,583.23	1,628.76	6,000.00	4,371.24	27.15 % *
522027 Presbytery Functions	2,990.94	1,000.00	3,000.00	2,000.00	33.33 % *
522029 Gifts and Memorials	873.00	401.19	500.00	98.81	80.24 %
522040 Communications Administrator	10,197.00	10,472.28	10,472.32	0.04	100.00 %
522042 Communication Services Mileage	0.00	0.00	200.00	200.00	0.00 %
522043 Youth Coordinator (Contracted)	0.00	0.00	6,000.00	6,000.00	0.00 %
522045 General Assembly Expenses	3,979.55	2,500.00	2,500.00	0.00	100.00 %
522046 Moderators Conference	820.57	0.00	1,500.00	1,500.00	0.00 % *
522047 Synod Commissioner Training	0.00	500.00	1,000.00	500.00	50.00 % *
Total Guiding Council	28,798.62	17,031.69	31,972.32	14,940.63	53.27 %
Presbytery Office Expenses					
521020 Electricity	4,629.05	4,421.31	5,000.00	578.69	88.43 %
521030 Water & Sewer	204.38	220.00	200.00	(20.00)	110.00 %
521040 Telephone-Nextiva	1,676.94	1,394.99	1,670.00	275.01	83.53 %
521041 Cellular Phone	2,288.69	2,450.00	1,800.00	(650.00)	136.11 %
521042 Copier	1,673.26	1,246.53	1,600.00	353.47	77.91 %

Accounts	Actual Last Year Year to Date	Actual This Year Year to Date	Annual Budget This Year Year	Annual Budget Remaining This Year Year	Annual Budget % Used This Year Year
521050 Office Supplies	1,700.08	2,691.89	1,500.00	(1,191.89)	179.46 %
521060 Staff Travel	491.33	278.82	750.00	471.18	37.18 %
521070 Equipment Purchases	532.88	1,387.16	500.00	(887.16)	277.43 %
521080 Computer and Tech	12,212.05	13,995.21	11,500.00	(2,495.21)	121.70 %
521090 Postage	0.00	146.00	200.00	54.00	73.00 %
521100 General Insurance	6,138.00	5,127.00	8,000.00	2,873.00	64.09 %
521130 Audit	8,500.00	4,450.00	8,000.00	3,550.00	55.62 %
521140 Conferences and Training	6,281.79	6,934.94	7,500.00	565.06	92.47 %
521142 Coaching	1,800.00	1,500.00	1,800.00	300.00	83.33 %
521300 Constant Contact Subscription	474.72	538.11	400.00	(138.11)	134.53 %
521400 Miscellaneous	193.20	384.80	500.00	115.20	76.96 %
521402 Bank Analysis Charges	113.00	152.95	200.00	47.05	76.48 %
522600 Property Maintenance	4,344.67	5,084.86	2,500.00	(2,584.86)	203.39 %
Total Presbytery Office Expenses	53,254.04	52,404.57	53,620.00	1,215.43	97.73 %
Committee on Representation and Nominations (CORN)					
522100 Committee Expenses	0.00	0.00	50.00	50.00	0.00 %
Total Committee on Representation and Nominations (CORN)	0.00	0.00	50.00	50.00	0.00 %
Permanent Judicial Commission (PJC)					
522700 Commission Expenses	280.14	0.00	400.00	400.00	0.00 %
522710 Travel Expenses	0.00	0.00	100.00	100.00	0.00 %
Total Permanent Judicial Commission (PJC)	280.14	0.00	500.00	500.00	0.00 %
Committee on Ministry (COM)					
523010 Committee Expenses	522.96	0.00	100.00	100.00	0.00 %
523020 Travel Expenses	143.38	0.00	100.00	100.00	0.00 %
523030 Shared Grants	0.00	34.22	500.00	465.78	6.84 % *
523040 School of Theology	203.23	0.00	0.00	0.00	0.00 %
523044 Fall Ministers' Retreat	0.00	0.00	250.00	250.00	0.00 %
523046 Coaching for Pastors	800.00	600.00	5,000.00	4,400.00	12.00 % *
523048 Cluster Lunches	4,071.03	4,548.18	5,000.00	451.82	90.96 % *
523049 Training and Workshops	1,207.04	2,041.76	2,000.00	(41.76)	102.09 % *
523052 EP Visitation	1,805.68	1,463.92	1,500.00	36.08	97.59 % *
523053 APC Visitation	989.26	353.45	750.00	396.55	47.13 % *
523054 Background Checks	325.84	555.56	250.00	(305.56)	222.22 % *
523056 Events and Gatherings	4,636.98	4,602.77	6,000.00	1,397.23	76.71 % *
523057 Commission Pastors Scholarship	0.00	0.00	2,000.00	2,000.00	0.00 % *
523058 Children/Youth M&M (Mission & Ministry)	0.00	0.00	3,000.00	3,000.00	0.00 % *
Total Committee on Ministry (COM)	14,705.40	14,199.86	26,450.00	12,250.14	53.69 %
Committee on Preparation for Ministry (CPM)					
523810 Committee Expenses	1,303.82	(262.12)	200.00	462.12 (131.06 %)	
523820 Travel Expenses	0.00	0.00	200.00	200.00	0.00 %
523830 Annual Consultations	0.00	0.00	300.00	300.00	0.00 %
523840 Consultations	0.00	0.00	200.00	200.00	0.00 %
523845 Scholarships for Candidates	3,000.00	3,600.00	5,000.00	1,400.00	72.00 % #
523850 Extraordinary Grants	445.00	441.75	1,500.00	1,058.25	29.45 % *
523860 Psychological Testing	2,474.35	6,370.13	10,000.00	3,629.87	63.70 % *
523865 Scholarships Future Commissioned Pastors	0.00	0.00	2,000.00	2,000.00	0.00 %
523870 School of Theology	0.00	80.55	1,500.00	1,419.45	5.37 % *
Total Committee on Preparation for Ministry (CPM)	7,223.17	10,230.31	20,900.00	10,669.69	48.95 %
Cultivation & Empowerment Commission (CEC)					
522900 Committee Expenses	0.00	0.00	500.00	500.00	0.00 %
522910 Grants ONLY \$3,600	2,501.14	5,000.00	25,000.00	20,000.00	20.00 % \$
522930 Scholarships APPLICABLE	700.00	7,600.00	15,000.00	7,400.00	50.67 % \$
522950 Events	0.00	0.00	5,000.00	5,000.00	0.00 % *
522960 Resources	0.00	0.00	3,500.00	3,500.00	0.00 % *
Total Cultivation & Empowerment Commission (CEC)	3,201.14	12,600.00	49,000.00	36,400.00	25.71 %
Personnel & Finance (P&F)					

Accounts	Actual Last Year Year to Date	Actual This Year Year to Date	Annual Budget This Year Year	Annual Budget Remaining This Year Year	Annual Budget % Used This Year Year
527010 Committee Expenses	575.00	1,161.51	750.00	(411.51)	154.87 %
Total Personnel & Finance (P&F)	575.00	1,161.51	750.00	(411.51)	154.87 %
Self Development of People Committee (SDOP)					
528010 Committee Expenses	0.00	0.00	100.00	100.00	0.00 %
528020 Travel Expenses	0.00	0.00	100.00	100.00	0.00 %
Total Self Development of People Committee (SDOP)	0.00	0.00	200.00	200.00	0.00 %
Presbytery Disaster Assistance Commission (PDAC)					
529010 Commission Expenses	360.07	0.00	400.00	400.00	0.00 %
529020 Travel Expenses	0.00	0.00	100.00	100.00	0.00 %
Total Presbytery Disaster Assistance Commission (PDAC)	360.07	0.00	500.00	500.00	0.00 %
Salaries & Benefits					
Executive Presbyter & Stated Clerk					
530010 Salary & Housing	108,675.12	111,609.12	111,609.00	(0.12)	100.00 %
530020 Mileage/Cont. Ed/Prof. Expenses	8,500.00	8,501.08	8,500.00	(1.08)	100.01 %
530030 Board of Pensions	42,383.16	39,649.32	40,633.00	983.68	97.58 %
530040 SECA	8,314.08	8,538.00	8,538.00	0.00	100.00 %
Total Executive Presbyter & Stated Clerk	167,872.36	168,297.52	169,280.00	982.48	99.42 %
Assoc. Pastoral Concerns & Fellowship					
530310 Salary & Housing	39,382.08	21,907.86	21,908.00	0.14	100.00 %
Total Assoc. Pastoral Concerns & Fellowship	39,382.08	21,907.86	21,908.00	0.14	100.00 %
Financial Administrator					
530600 Salary	17,045.04	17,505.12	17,505.00	(0.12)	100.00 %
Total Financial Administrator	17,045.04	17,505.12	17,505.00	(0.12)	100.00 %
Office Administrator					
530700 Salary	37,833.12	42,465.52	38,854.00	(3,611.52)	109.30 %
530730 BOP/Major Medical & D&D	12,843.48	15,767.58	13,302.00	(2,465.58)	118.54 %
530740 Deferred Compensation	2,450.00	1,300.00	2,400.00	1,100.00	54.17 %
Total Office Administrator	53,126.60	59,533.10	54,556.00	(4,977.10)	109.12 %
Other Personnel Expenses					
530750 Employer Matching SS/Medicare	4,198.32	4,587.63	5,000.00	412.37	91.75 %
Total Other Personnel Expenses	4,198.32	4,587.63	5,000.00	412.37	91.75 %
Total Salaries & Benefits	281,624.40	271,831.23	268,249.00	(3,582.23)	101.34 %
Total Expenses	\$ 582,981.41	\$ 568,432.51	\$ 641,151.32	\$ 72,718.81	88.66 %
Net Total	\$ 0.00	\$ 0.00	\$ 13,703.68	\$ 13,703.68	0.00 %

The Presbytery of New Harmony
Our Churches in Support of
the Mission of the Whole Church
for Year-to-Date through December 2025

		(1)	(2)	(3)	(4)	(5)	(6)	(7)
Pin	Church Name	Shared Mission Support Pledge	Shared Mission Support Pledge YTD Paid	Direct Mission Support YTD	Mission Support YTD Total (2+3)	Other Mission Support YTD	2025 Per Capita Apportionment	Per Capita YTD Paid
22464	BENNETTSVILLE FIRST PRESBYTERIAN CH	8,000	8,000.04	-	8,000.04	2,403.85	3,528.00	3,528.00
22493	CAROLINA PRESBYTERIAN CHURCH	2,500	2,500.00	-	2,500.00	8,065.00	525.00	475.00
11881	CELEBRATION PRESBYTERIAN CHURCH	2,000	2,000.00	-	2,000.00	2,552.00	1,554.00	1,596.00
22467	CHERAW FIRST PRESBYTERIAN CHURCH	32,000	29,333.36	-	29,333.36	6,428.45	3,675.00	3,675.00
22468	CHESTERFIELD PRESBYTERIAN CHURCH	500	500.00	-	500.00	-	147.00	147.00
201	CONGRUITY PRESBYTERIAN CHURCH	7,000	7,000.00	-	7,000.00	2,015.00	3,150.00	3,150.00
22432	COUSAR MEMORIAL PRESBYTERIAN CH	2,000	2,000.00	-	2,000.00	200.00	1,260.00	1,260.00
182	EBENEZER PRESBYTERIAN CHURCH	3,500	3,500.00	-	3,500.00	500.00	3,192.00	3,192.00
22484	FORK PRESBYTERIAN CHURCH	NO PLEDGE	-	-	-	-	777.00	-
22459	FRASER MEMORIAL PRESBYTERIAN CH	50	50.00	-	50.00	-	294.00	244.00
191	FRIENDSHIP PRESBYTERIAN CHURCH	6,500	6,500.00	-	6,500.00	635.00	1,239.00	1,239.00
177	GEORGE W LONG PRESBYTERIAN CHURCH	2,500	2,500.00	-	2,500.00	1,060.00	420.00	420.00
22436	GEORGETOWN PRESBYTERIAN CHURCH	18,420	18,420.00	-	18,420.00	9,960.05	7,812.00	7,100.00
188	GOODWILL PRESBYTERIAN CHURCH	7,500	7,759.78	-	7,759.78	1,935.44	3,276.00	3,286.62
180	GRANDVIEW PRESBYTERIAN CHURCH	1,000	1,000.00	-	1,000.00	100.00	462.00	462.00
169	HARMONY PRESBYTERIAN CHURCH	3,000	3,000.00	-	3,000.00	300.00	1,029.00	1,029.00
22487	HARTSVILLE FIRST PRESBYTERIAN CH	34,000	34,000.00	-	34,000.00	2,010.00	9,534.00	9,534.00
22452	HEBRON PRESBYTERIAN CHURCH	-	-	-	-	-	-	-
22438	INDIANTOWN PRESBYTERIAN CHURCH	4,000	5,000.00	-	5,000.00	5,174.28	2,016.00	1,407.00
22490	JEFFERSON PRESBYTERIAN CHURCH	-	-	-	-	-	546.00	-
22480	JOHN CALVIN PRESBYTERIAN CHURCH	5,000	5,000.00	-	5,000.00	5,073.00	2,268.00	2,268.00
22485	KENTYRE PRESBYTERIAN CHURCH	1,000	1,000.00	-	1,000.00	200.00	210.00	210.00
22471	KINGSTON PRESBYTERIAN CHURCH	13,000	13,000.00	-	13,000.00	4,225.00	4,431.00	4,431.00
11233	KOREAN-AMERICAN PRESBYTERIAN	1,000	1,000.00	-	1,000.00	500.00	483.00	483.00
22442	LAKE CITY PRESBYTERIAN CHURCH	3,500	5,250.00	-	5,250.00	675.00	735.00	1,061.00
22492	LATTA PRESBYTERIAN CHURCH	NO PLEDGE	-	-	-	704.00	798.00	798.00
22495	MARION PRESBYTERIAN CHURCH	5,000	5,000.00	-	5,000.00	1,968.00	2,667.00	2,667.00
22497	MCCOLL FIRST PRESBYTERIAN CHURCH	2,000	2,000.00	-	2,000.00	700.00	168.00	168.00
197	MELINA PRESBYTERIAN CHURCH	6,000	6,000.00	-	6,000.00	100.00	4,032.00	4,032.00
22488	MORTON PRESBYTERIAN CHURCH	5,000	5,000.00	-	5,000.00	700.00	609.00	609.00
170	MT LISBON PRESBYTERIAN CHURCH	300	300.00	-	300.00	110.00	672.00	672.00
22489	MT PISGAH PRESBYTERIAN CHURCH	-	1,000.00	-	1,000.00	560.00	714.00	710.00
196	MT SINAI PRESBYTERIAN CHURCH	500	500.00	-	500.00	50.00	462.00	472.52
22455	MT ZION PRESBYTERIAN CHURCH	-	-	-	-	-	462.00	-
22449	MURRELLS INLET PRESBYTERIAN CHURCH	1,000	1,000.00	-	1,000.00	851.00	1,260.00	1,276.00
22501	MYRTLE BEACH FIRST PRESBYTERIAN CH	75,000	93,750.00	-	93,750.00	24,111.00	31,143.00	37,869.00
22474	NEW BETHEL PRESBYTERIAN DILLON	500	500.00	-	500.00	400.00	504.00	504.00
10761	NEW COVENANT PRESBYTERIAN CHURCH	-	200.00	-	200.00	250.00	987.00	1,994.00
11507	NEW HARVEST PRESBYTERIAN CHURCH	100	-	-	-	-	273.00	-
22451	OLANTA PRESBYTERIAN CHURCH	-	-	-	-	-	924.00	-
22482	PARKWOOD PRESBYTERIAN CHURCH	1,200	1,200.00	-	1,200.00	50.00	441.00	441.00
22503	PATRICK PRESBYTERIAN CHURCH	500	500.00	-	500.00	100.00	651.00	310.00
22453	PAWLEYS ISLAND PRESBYTERIAN CHURCH	20,000	20,000.00	-	20,000.00	4,745.00	8,946.00	8,946.00
22445	PRESBYTERIAN CHURCH AT MANNING	10,000	10,000.00	-	10,000.00	-	3,843.00	3,843.00
22504	RUBY PRESBYTERIAN CHURCH	1,250	1,250.00	-	1,250.00	405.00	504.00	504.00
22448	SALEM BLACK RIVER PRESBY CHURCH	750	-	-	-	-	630.00	630.00
22506	SOCIETY HILL PRESBYTERIAN CHURCH	1,000	1,000.00	-	1,000.00	255.00	273.00	273.00
22439	ST PAUL'S PRESBYTERIAN CHURCH	8,000	2,640.00	-	2,640.00	3,291.00	399.00	399.00
22457	SUMMERTON PRESBYTERIAN CHURCH	1,500	1,500.00	-	1,500.00	1,230.00	840.00	840.00
22458	SUMTER FIRST PRESBYTERIAN CHURCH	40,000	40,000.00	-	40,000.00	16,147.02	8,421.00	8,421.00

The Presbytery of New Harmony
Our Churches in Support of
the Mission of the Whole Church
for Year-to-Date through December 2025

		(1)	(2)	(3)	(4)	(5)	(6)	(7)
Pin	Church Name	Shared Mission Support Pledge	Shared Mission Support Pledge YTD Paid	Direct Mission Support YTD	Mission Support YTD Total (2+3)	Other Mission Support YTD	2025 Per Capita Apportionment	Per Capita YTD Paid
200	SUMTER SECOND PRESBYTERIAN CHURCH	2,200	2,200.00	-	2,200.00	400.00	903.00	903.00
22462	SWAN LAKE PRESBYTERIAN CHURCH	1,500	1,500.00	-	1,500.00	1,096.67	294.00	294.00
22507	TIMMONSVILLE PRESBYTERIAN CHURCH	150	150.00	-	150.00	2,001.00	126.00	126.00
189	TRINITY PRESBYTERIAN MAYESVILLE	3,000	500.00	-	500.00	25.00	1,575.00	1,575.00
23382	TRINITY PRESBYTERIAN SURFSIDE BEACH	1,500	1,500.00	-	1,500.00	3,206.00	2,793.00	2,793.00
23343	WEDGEFIELD PRESBYTERIAN CHURCH	7,500	7,500.00	-	7,500.00	1,932.00	840.00	840.00
168	WESTMINSTER PRESBYTERIAN ALCOLU	3,500	3,500.00	-	3,500.00	1,583.75	1,428.00	1,428.00
22505	WHITE OAK PRESBYTERIAN CHURCH	NO PLEDGE	-	-	-	360.00	609.00	609.00
22441	WILLIAMSBURG PRESBYTERIAN CHURCH	NO PLEDGE	1,000.00	-	1,000.00	2,741.00	4,347.00	4,347.00
	Individual Gifts	-	3,300.00	-	3,300.00	250.00	-	-
	Dismissed/Closed Churches	-			-	-		-
	TOTAL	356,920.00	372,803.18	-	372,803.18	124,334.51	136,101.00	139,491.14

2025.12.31 YE Summary of Funds and Accounts FINAL

Date Range: Jan 1st 2025 - Dec 31st 2025 | Includes Open Transactions

Accounts	Beginning Balance	Income	Expense	Ending Balance
Restricted Net Assets				
Temporarily Restricted				
Pass-Through Funds				
General Assembly Pass-Throughs				
840415 Pentecost Offering	0.00	2,873.10	2,873.10	0.00
840420 One Great Hour of Sharing	0.00	25,698.54	25,698.54	0.00
840430 Peace & Global Witness Offering	0.00	796.00	796.00	0.00
840450 Christmas Joy Offering	0.00	17,928.17	17,928.17	0.00
840460 ECO Projects	0.00	1,600.00	1,600.00	0.00
840480 GA Disaster Relief Projects	0.00	10,480.02	10,480.02	0.00
Total General Assembly Pass-Throughs	0.00	59,375.83	59,375.83	0.00
Other Pass-Throughs				
840470 Theological Education Fund	0.00	18,261.89	18,261.89	0.00
840510 Thornwell	0.00	15,519.43	15,519.43	0.00
840530 Presbyterian College	0.00	320.00	320.00	0.00
840560 Johnson C. Smith Seminary	0.00	35.00	35.00	0.00
840610 Presbyterian Retirement Comm of SC (PCSC)	0.00	6,635.00	6,635.00	0.00
840630 Mother's Day Offering for PCSC	0.00	17,087.66	17,087.66	0.00
840765 P.A.D.D.	0.00	7,652.00	7,652.00	0.00
840775 E.W. Matthew Memorial Fund	0.00	176.25	176.25	0.00
840777 Lee Memorial Fund #11 for PADD	0.00	3,709.91	3,709.91	0.00
840779 Lee Memorial Fund #16 for PeeDee Church	0.00	4,638.45	4,638.45	0.00
840850 Other Special Mission	0.00	1,300.00	1,300.00	0.00
850001 Youth Mission Trip Grant	0.00	3,000.00	3,000.00	0.00
850307 GA Meeting	0.00	1,980.63	1,980.63	0.00
850311 Green Grants	0.00	5,000.00	5,000.00	0.00
850520 Mission & Ministry (M&M) Fund	0.00	1,645.56	1,645.56	0.00
850530 Candidate/Scholarship Fund	0.00	1,423.03	1,423.03	0.00
850540 G.I.V.E. Fund	0.00	9,138.95	9,138.95	0.00
850570 Campus Christian Life	0.00	250.00	250.00	0.00
850660 Pastor's Assistance	0.00	241.88	241.88	0.00
850780 Mizpah	0.00	545.00	545.00	0.00
850782 Timmons ville	0.00	8,851.21	8,851.21	0.00
850785 Peacemaking Grants	0.00	265.07	265.07	0.00
850980 Unrestricted Reserve	0.00	7,814.55	7,814.55	0.00
850995 Miscellaneous	0.00	4,552.00	4,552.00	0.00
Total Other Pass-Throughs	0.00	120,043.47	120,043.47	0.00
Total Pass-Through Funds	0.00	179,419.30	179,419.30	0.00
Presbytery Invested Funds				
54398 Unrestricted Reserve and NHP Projects Fund				
800307 General Assembly Meeting	0.00	1,980.63	0.00	1,980.63
800311 Green Grants	19,200.00	0.00	5,000.00	14,200.00
800312 Youth Triennium	167.89	0.00	0.00	167.89
823006 Ministry to Prisoners & Family Grants	3,484.82	0.00	0.00	3,484.82
824001 Youth Mission Trip Grants	19,299.70	0.00	3,000.00	16,299.70
840640 NHP Mission Projects	10,545.00	0.00	0.00	10,545.00

Accounts	Beginning Balance	Income	Expense	Ending Balance
840660 Pastor's Assistance	7,252.77	0.00	141.88	7,110.89
840715 Campus Ministry Grants	7,994.30	0.00	0.00	7,994.30
840740 NHP Disaster Assistance	26,239.12	0.00	0.00	26,239.12
840782 Timmonsville	0.00	8,519.32	0.00	8,519.32
840785 Peacemaking Grants	3,877.12	265.07	0.00	4,142.19
840980 Unrestricted Reserve	159,033.60	67,008.38	11,881.65	214,160.33
Total 54398 Unrestricted Reserve and NHP Projects Fund	257,094.32	77,773.40	20,023.53	314,844.19
54399 Mission & Ministry (M&M) Fund				
880520 Mission & Ministry (M&M) Fund	1,605,465.15	252,411.29	65,262.73	1,792,613.71
Total 54399 Mission & Ministry (M&M) Fund	1,605,465.15	252,411.29	65,262.73	1,792,613.71
54400 Candidate/Scholarship Fund				
880530 Candidate/Scholarship Fund	152,373.89	25,254.78	7,548.84	170,079.83
Total 54400 Candidate/Scholarship Fund	152,373.89	25,254.78	7,548.84	170,079.83
54401 G.I.V.E. Fund				
850111 New Covenant Funds PCFND	362,586.39	44,934.91	7,323.33	400,197.97
850114 PCUSA Invest & Loan Program (PILP)	105,462.23	2,637.27	0.00	108,099.50
880540 G.I.V.E. Fund	825,958.82	129,045.77	30,540.36	924,464.23
Total 54401 G.I.V.E. Fund	1,294,007.44	176,617.95	37,863.69	1,432,761.70
54402 Small Church Support/Redevelopment Fund				
880550 Small Church Support/ Redevelopment Fund	320,337.74	50,375.10	11,904.52	358,808.32
Total 54402 Small Church Support/ Redevelopment Fund	320,337.74	50,375.10	11,904.52	358,808.32
54404 Campus Christian Life Fund				
880570 Campus Christian Life Fund	48,874.64	8,063.76	3,271.44	53,666.96
Total 54404 Campus Christian Life Fund	48,874.64	8,063.76	3,271.44	53,666.96
Total Presbytery Invested Funds	3,678,153.18	590,496.28	145,874.75	4,122,774.71
Total Temporarily Restricted	3,678,153.18	769,915.58	325,294.05	4,122,774.71
Total Restricted Net Assets	\$ 3,678,153.18	\$ 769,915.58	\$ 325,294.05	\$ 4,122,774.71

The Presbytery of New Harmony

Concentration of All Funds at December 31, 2025

Bank Name	Bankrate.com Rating	Balance at 12/31/2025
Texas Presbyterian Foundation ⁽¹⁾	n/a	3,614,477.24
PC(USA) Foundation New Covenant Funds ⁽¹⁾	n/a	400,197.97
PC(USA) Investment & Loan Program ⁽¹⁾	n/a	108,099.50
South State Bank - Checking	****	59,203.01
South State Bank - Money Market		230,193.50
Miscellaneous Income	n/a	21,728.75
First Citizens Bank	****	25,232.88
Total		<u>\$ 4,459,132.85</u>
<i>(1) Not FDIC insured</i>		

The Presbytery Of New Harmony
Statement of Financial Position

As of: Dec 31st 2025

Assets

Current Assets

Checking Accounts

150010 First Citizens Payroll Checking Account	25,232.88
150012 SouthState Operating Disbursements	59,203.01

Southstate MM

150022 SouthState Operating Receipts	230,193.50
150040 Miscellaneous Income	21,728.75

Total Southstate MM	251,922.25
---------------------	------------

Total Checking Accounts	336,358.14
-------------------------	------------

Total Current Assets	336,358.14
----------------------	------------

Long-Term Investments

150111 New Covenant Funds (Church Extension Fund)	400,197.97
150114 PCUSA Invest & Loan Program (Church Extension Fund)	108,099.50

TPF

TPF - Acct #54398 (Unrestricted Reserve&NHP Proj)

150160 Balanced Fund - 54398	252,269.87
150161 Money Market - 54398	62,574.32

Total TPF - Acct #54398 (Unrestricted Reserve&NHP Proj)	314,844.19
---	------------

TPF - Acct #54399 (Mission & Ministry [M&M] Fund)

150162 Balanced Fund - 54399	1,436,519.34
150163 Money Market - 54399	356,094.37

Total TPF - Acct #54399 (Mission & Ministry [M&M] Fund)	1,792,613.71
---	--------------

TPF - Acct #54400 (Candidate/Scholarship Fund)

150164 Balanced Fund - 54400	136,294.38
150165 Money Market - 54400	33,785.45

Total TPF - Acct #54400 (Candidate/Scholarship Fund)	170,079.83
--	------------

TPF - Acct #54401 (G.I.V.E. Fund)

150166 Balanced Fund - 54401	740,820.75
150167 Money Market - 54401	183,643.48

Total TPF - Acct #54401 (G.I.V.E. Fund)	924,464.23
---	------------

TPF - Acct #54402 (Sm ChurchSupport/Redevelopment)

150168 Balanced Fund - 54402	287,531.40
150169 Money Market - 54402	71,276.92

Total TPF - Acct #54402 (Sm ChurchSupport/Redevelopment)	358,808.32
--	------------

TPF - Acct #54404 (Campus Christian Life Fund)

150172 Balanced Fund - 54404	43,007.73
150173 Money Market - 54404	10,659.23

Total TPF - Acct #54404 (Campus Christian Life Fund)	53,666.96
--	-----------

Total TPF	3,614,477.24
-----------	--------------

Total Long-Term Investments	4,122,774.71
-----------------------------	--------------

Total Assets	\$ 4,459,132.85
---------------------	------------------------

Liabilities & Net Assets

Liabilities

Total Liabilities	0.00
-------------------	------

Net Assets

Temporarily Restricted

Presbytery Invested Funds

54398 Unrestricted Reserve and NHP Projects Fund	
800307 General Assembly Meeting	1,980.63
800311 Green Grants	14,200.00
800312 Youth Triennium	167.89
823006 Ministry to Prisoners & Family Grants	3,484.82
824001 Youth Mission Trip Grants	16,299.70
840640 NHP Mission Projects	10,545.00
840660 Pastor's Assistance	7,110.89
840715 Campus Ministry Grants	7,994.30
840740 NHP Disaster Assistance	26,239.12
840782 Timmons ville	8,519.32
840785 Peacemaking Grants	4,142.19
840980 Unrestricted Reserve	214,160.33
Total 54398 Unrestricted Reserve and NHP Projects Fund	314,844.19
54399 Mission & Ministry (M&M) Fund	
880520 Mission & Ministry (M&M) Fund	1,792,613.71
Total 54399 Mission & Ministry (M&M) Fund	1,792,613.71
54400 Candidate/Scholarship Fund	
880530 Candidate/Scholarship Fund	170,079.83
Total 54400 Candidate/Scholarship Fund	170,079.83
54401 G.I.V.E. Fund	
850111 New Covenant Funds PCFND	400,197.97
850114 PCUSA Invest & Loan Program (PILP)	108,099.50
880540 G.I.V.E. Fund	924,464.23
Total 54401 G.I.V.E. Fund	1,432,761.70
54402 Small Church Support/Redevelopment Fund	
880550 Small Church Support/Redevelopment Fund	358,808.32
Total 54402 Small Church Support/Redevelopment Fund	358,808.32
54404 Campus Christian Life Fund	
880570 Campus Christian Life Fund	53,666.96
Total 54404 Campus Christian Life Fund	53,666.96
Total Presbytery Invested Funds	4,122,774.71
Total Temporarily Restricted	4,122,774.71
Unrestricted Net Assets	
290010 Gen. Fund Principal (Excess Cash)	336,358.14
Total Unrestricted Net Assets	336,358.14
Total Net Assets	4,459,132.85
Total Liabilities & Net Assets	\$ 4,459,132.85