

Ideal Lighting LLC

TRAILER LIGHTING & ACCESSORIES CATALOG



OUR SELECTION OF PRODUCTS IS
OUT OF THIS WORLD!



TO ORDER CALL **1-717-442-4605**

TAIL LIGHTS
MARKER LIGHTS
WORK LIGHTS
INTERIOR LIGHTS

AGRICULTURAL LIGHTS
WARNING LIGHTS
LIGHT BARS
REFLECTOR TAPE

JUNCTION BOXES
TRUCK/TRAILER PLUGS
WIRE
TERMINALS

BATTERY CABLES
WELDING CABLE
TOGGLE SWITCHES



Ideal Lighting LLC

TRAILER LIGHTING & ACCESSORIES CATALOG

CLEARANCE/MARKER/ID LIGHTS

Compact Marker Lights	4, 5
2" Round.....	6, 7
2½" Round.....	6, 7
Rectangle.....	8
Beehive.....	8
I.D. Bar.....	12
Stainless Steel Oval Clearance Light.....	11

STOP/TURN/TAIL LIGHTS

4" Round Light.....	13, 14
Oval Light.....	14-17
Thin Line Stop/Turn/Tail Light.....	19
Universal Tail Light.....	18
Truck Tail Light.....	14

AG LIGHTS

Double-Face Light.....	22-23
Pedestal Mount Light.....	22-23
Agricultural Light.....	22

DOMES/INTERIOR/BACKUP

Dome Light	24, 25, 27
Interior Light.....	24-25
Backup Light.....	27

LICENSE & UTILITY LIGHTS 28-29

WORK LIGHTS

Rubber Tractor Light.....	30
LED Work Light.....	30-32

MID/TURN LIGHTS 33

WARNING & EMERGENCY LIGHTING

Light Bars	35
Flashing Lights.....	34, 35
Warning Lights.....	34
Safety Lights.....	36

REFLECTORS/REFLECTIVE TAPE

Reflective Tape.....	37
Reflectors.....	38
SMV Sign	38

TURN SIGNAL SWITCHES..... 39

FLASHERS / RESISTORS

Flashers.....	40, 41
Resistors.....	41

MOUNTING GROMMETS

Round Grommets	42, 43
Oval Grommets	42
¾" Grommets	43
Bezels.....	43

BRACKETS

4" Round Bracket.....	44
Oval Bracket.....	44
2" and 2½" Round Bracket	44, 45
Mounting Bracket.....	44
Nylon Cord Grips	47

LIGHT PLUG CONNECTIONS 46

BOXES47

TRUCK/TRAILER/CONNECTORS

7 Pole Truck/Trailer Plug48
 7 RV Truck/Trailer Plug49
 6&4 Round Plug51
 4 Flat Plug.....51
 Adapter Plug49
 Wiring Diagrams53

FUSES/CIRCUIT BREAKERS

High Amp Circuit Breaker 56-57
 Circuit Breaker54
 Fuse Holder..... 55-56
 Fuses 56-57

SWITCHES

Rocker Switches58,64
 Toggle Switches 59-61, 64
 Pull Switches62
 Relay.....64
 Limited Switch64

WIRE/BATTERY CABLE/WELDING CABLE

GPT Primary Wire65
 Bonded Parallel Wire66
 Jacketed Duplex Wire.....67
 Trailer Wire.....68
 Starter Cable69
 Welding Cable70
 Dual Booster Cable Wire.....69

WIRE ACCESSORIES/TERMINAL BLOCKS

Heat Shrink Tubing 71
 Wire Covering..... 71
 Electrical Tape.....72
 Wire Ties72
 Terminal Blocks73

CONNECTORS/CLAMPS/CABLES

Post Terminals..... 74, 75
 Connectors.....76, 77
 Terminal Protectors.....78
 Battery Boxes.....78
 Battery Clamps 68, 69, 71
 Booster Cables..... 79

BATTERIES

Sealed Batteries 80
 Alkaline Batteries 80
 Battery Chargers 80
 Digital Voltmeters 81

SOLAR PANELS

Solar Panel Controllers82

FLASHLIGHTS

Flashlights83, 84
 Headlamps.....84

TOOLS

Wire Cutters85
 Wire Crimpers85, 86
 Wire Strippers85
 Cable Cutters86
 Cable Crimpers86
 Digital Multimeters..... 87

TERMINALS/CONNECTORS/COMPARTMENT BOXES

Terminals.....88, 89
 Connectors..... 89, 90, 91
 Compartment Boxes.....92

TECHNICAL REFERENCE 93

ORDER FORM 94



1.25" Low Profile P2PC Clearance Markers

- Grommet or surface mount
- Mounting via grommet 3/4" hole cutout

- #29-M09410R Red Lens
- #29-M09410Y Amber Lens
- #29-M09410WCL White Lens
(for auxiliary use only)

Light Source

- 6 LEDs
- .08 amp at 12.6 volts

1.25" Mini P2PC Combination Clearance Markers

- Grommet mount
- 1 3/8" hole cutout

- #29-M09400R Red Lens
- #29-M09400RCL Red Clear Lens
- #29-M09400Y Amber Lens
- #29-M09400YCL Amber Clear Lens
- #29-M09400BCL Blue Clear Lens Aux
- #29-M09400G Green Aux
- #29-M09400WCL White Aux
- #29-M50118 Stainless Steel Bezel
- #29-M50132 Black Grommet



3/4" Mini P2PC Combination Clearance Markers

- Grommet mount
- 3/4" hole cutout

- #29-M09200R Red Lens
- #29-M09300RCL Red Clear Lens
- #29-M9300Y Amber Lens
- #29-M09300YCL Amber Clear Lens
- #29-M09300BCL Blue Clear Lens Aux
- #29-M9300G Green Aux
- #29-M9300WCL White Aux
- #29-M50112 Stainless Steel Bezel

Light Source

- 3 LEDs
- .05 amp at 12.6 volts



LED Marker Light Flat Face

- Compact single diode design fits 3/4" hole
- Meets D.O.T. requirements for clearance or side marker lights
- Hard wire leads
- Includes rubber grommet
- Chrome base available
- Extra rubber grommet available

- #13-171R Red Clearance Light
- #13-171A Amber Clearance Light
- #13-177-18 3/4" Grommet
- #13-176-09X Chrome Base

Light Source

- 1 LED
- .04 amp at 12.6 volts

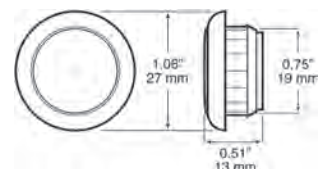

Material

- Polycarbonate lens
- Over-molded hot-melt housing/substrate
- 20 gauge wire

Light Source

- Light emitting diodes (LEDs)
- Designed at 12.8v, .03 amp (red), .05 amp (yellow)



LED Flex-Lite Marker Light

- Provides clearance/marker solution that requires no mounting brackets or installation screws
- Lamps adhere directly to application surface through use of heavy-duty adhesive backing
- Easy-to-install peel-off liner
- Hard-wired with .180 connector
- Rear exit wire version requires 3/8" mounting hole; hole self-seals upon installation
- Side mount options can be mounted without any mounting holes
- Electronics are completely sealed in epoxy to resist damage caused by moisture & corrosion

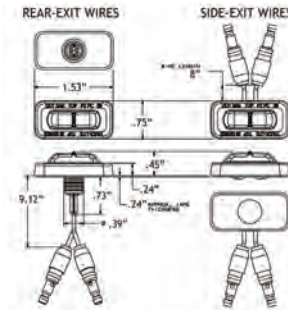

- #15-36105R Red Lamp, Side Exit Wires
- #15-36105Y Yellow Lamp, Side Exit Wires
- #15-36115R Red Lamp, Rear Exit Wires
- #15-36115Y Yellow Lamp, Rear Exit Wires
- #15-36203R Marker Light, Red, 3 Wire
- #15-36203Y Marker Light, Yellow, 3 Wire

Light Source

- 2 LEDs
- .05 amp at 12.6 volts



LED Clearance & Marker Lights

- Mini clearance, side marker light
- Hard wired leads
- Mounts on 1 5/16" centers
- Optional bracket for mounting
- Mounting gasket, black bracket, chrome bracket

- #13-168R Red Marker Light
- #13-168A Yellow Marker Light
- #13-168CR-BT2 Red Clear Lens w/ .180 Bullet
- #13-168CA-BT2 Yellow Clear Lens w/ .180 Bullet
- #13-168-9 Black Bracket
- #13-168-10 Chrome Bracket
- #13-168-18 Mounting Gasket



Light can be mounted without bracket. Bracket sold separately.

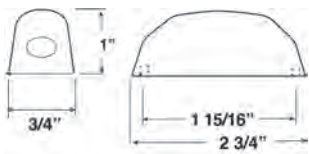

Light Source

- 2 LEDs
- .05 amp at 12.6 volts



LED Clearance and Marker Light

- Small size fits in narrow applications
- Sleek, aerodynamic styling
- Hard wire with .180 connector
- Grommet mount has no exposed fasteners
- Grommet or chrome bezel mounts

- #14-47952 Red with Chrome Bezel
- #14-47962 Red with Grommet
- #14-47982 Red Clear Lens with Chrome Bezel
- #14-47953 Yellow with Chrome Bezel
- #14-47963 Yellow with Grommet
- #14-47983 Yellow Clear Lens with Chrome Bezel



Note: #14-47962 and #14-47963 mount in a 3/4" hole, no screws needed.

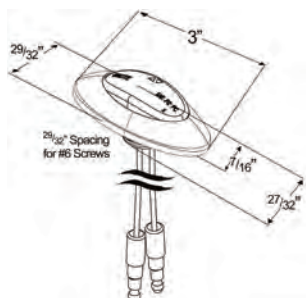



LED Marker Light

- 2" round marker, clearance light
- 10 diode light pattern
- Mounts in rubber grommet
- 2⁵/₁₆" mounting hole
- Standard 2 prong connection

#24-79281R Red 2" Clearance Light
 #24-79280Y Yellow 2" Clearance Light

Light Source

- 10 LEDs
- .04 amp at 12.6 volts

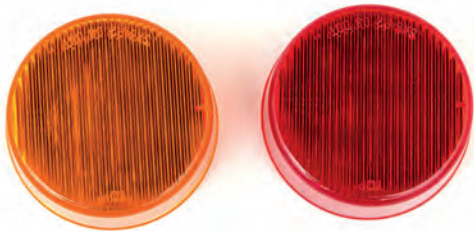
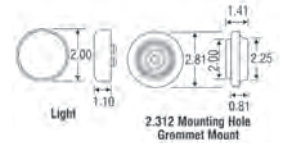

LED Marker Light

- 2½" round marker, clearance light
- 13 diode light pattern
- Mounts in rubber grommet
- 3" mounting hole
- Standard 2 prong connection

#24-79311R Red 2½" Clearance Light
 #24-79310Y Yellow 2½" Clearance Light

Light Source

- 13 LEDs
- .09 amp at 12.6 volts

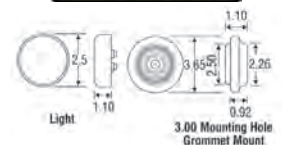

LED Marker Light

- 2" round sealed clearance & marker light
- 10 diode pattern
- Mounts in rubber grommet
- 2⁵/₁₆" hole size
- Standard 2 prong connection
- Use #13-146-18 grommet
- Use #15-94902 for pigtail
- Comes in clear, red and yellow lenses

#15-3050 Red 2" Clearance Light
 #15-3050A Yellow 2" Clearance Light
 #15-3051 Red 2" Clearance Light with Clear Lens
 #15-3051A Yellow 2" Clearance Light with Clear Lens

Light Source

- 10 LEDs
- .04 amp at 12.6 volts

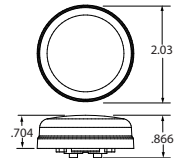

LED Marker Light

- 2½" round sealed clearance & marker light
- 10 diode pattern
- Mounts in rubber grommet
- 3" hole size
- Standard 2 prong connection
- Use #13-142-18 grommet
- Use #15-94902 for pigtail
- Comes in clear, red and yellow lenses

#15-1050 Red 2½" Clearance Light
 #15-1050A Yellow 2½" Clearance Light
 #15-1051 Red 2½" Clearance Light with Clear Lens
 #15-1051A Yellow 2½" Clearance Light with Clear Lens

Light Source

- 10 LEDs
- .08 amp at 12.6 volts

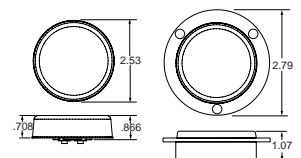

LED Glo Light

- Grommet mount available
- Available in 2" and 2½"

#24-MCL155RB Red 2" Glo Light
 #24-MCL155AB Amber 2" Glo Light

#24-MCL157RB Red 2½" Glo Light
 #24-MCL157AB Amber 2½" Glo Light

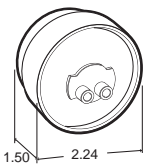

LED High Profile Clearance Marker Light

- 2" round LED clearance light
- LEDs have no filament, therefore are not susceptible to shock or vibration
- Mounts in rubber grommet
- SAE PC rated for combination clearance and marker lights
- High profile 8 diode pattern
- Standard 2 prong connection

#15-30275R Red 2" High Profile Marker Light
 #15-30275Y Yellow 2" High Profile Marker Light

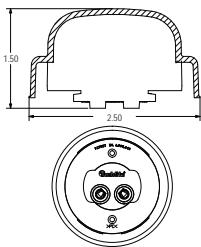

LED High Profile Clearance Marker Light

- 2½" round LED clearance light
- Use for rubber grommet mount
- SAE PC rated for combination clearance and marker lights
- Electronics completely sealed in epoxy to resist corrosion & moisture
- High profile 8 diode pattern
- Standard 2 prong connection

#15-10275R Red 2½" High Profile Marker Light
 #15-10275Y Yellow 2½" High Profile Marker Light



Light Source

- Incandescent
- .30 amp at 12.6 volts

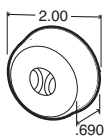

Incandescent Clearance & Marker Light

- 2" round sealed clearance/marker light
- Standard 2 prong connection
- For grommet mount, use 2⁵/₁₆" hole

#15-30200R Red 2" Incandescent Marker Light
 #15-30200Y Yellow 2" Incandescent Marker Light



Light Source

- Incandescent
- .30 amp at 12.6 volts

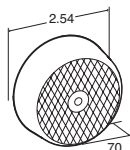

Incandescent Clearance & Marker Light

- 2½" sealed clearance/marker light
- Standard 2 prong connection
- Reflector lens
- 2 sizes of grommet available for 3" hole or 2²⁵/₃₂" hole

#15-10525R Red 2½" Incandescent Marker Light
 #15-10525Y Yellow 2½" Incandescent Marker Light





LED Marker & Clearance Light

- 4 diode sealed light
- Use mount and plug #15-19721, #15-19726, #15-19739, mount with plug
- Sealed, moisture-proof electronics
- Light size: 3.78"L x 1.2"W x 8.20"D

- #15-1960 Red Clearance Light
- #15-1960A Yellow Clearance Light
- #15-1961 Red Light with Clear Lens
- #15-1961A Yellow Light with Clear Lens

Light Source

- 4 LEDs
- .05 amp at 12.6 volts

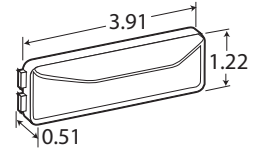

LED Marker & Clearance Light

- 2 & 3 diode pattern
- Red as 2 diode, yellow 3 diode pattern
- Standard 2 prong connection
- Use #15-00802 Black Base
#15-00791 Chrome Base

- #15-1560 Red Clearance Light
- #15-1560A Yellow Clearance Light
- #15-1561 Red Light with Clear Lens
- #15-1561A Yellow Light with Clear Lens

Light Source

- .04 amp at 12.6 volts

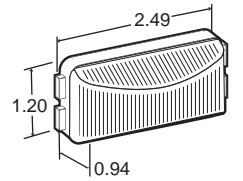

LED Beehive Light

- 2" marker clearance light
- 10 diode pattern
- Rubber grommet mounting
- 2 prong connector

- #15-3075R Red Beehive Clearance Light
- #15-3075A Yellow Beehive Clearance Light
- #15-3076R Red Beehive Clearance Light with Clear Lens
- #15-3076A Yellow Beehive Clearance Light with Clear Lens

Light Source

- 10 LEDs
- .01 amp at 12.6 volts

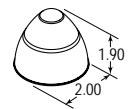

LED Beehive Light

- 2½" marker clearance light
- 10 diode pattern
- Rubber grommet mounting
- 2 prong connector

- #15-1075R Red Beehive Clearance Light
- #15-1075A Yellow Beehive Clearance Light
- #15-1076R Red Beehive Clearance Light with Clear Lens
- #15-1076A Yellow Beehive Clearance Light with Clear Lens

Light Source

- 10 LEDs
- .01 amp at 12.6 volts

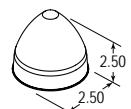

3/4" Fender Light with Bracket

- 1 amber and 1 red
- #30-MCL12ARLB Driver's Side Fender Light
 #30-MCL12ARRB Passenger's Side Fender Light



1"x4" Incandescent Fender Light

- Red and amber
- #13-154 A-R 1x4 Incandescent Light Only
 #30-A65B Bracket Only – Black



1"x4" LED Fender Light

- Red and amber
- #30-MCL65ARB 1x4 LED Light Only
 #30-A65B Bracket Only – Black



LED Fender Light with Black Housing

- Red & amber, clear lens
- #30-MCL180ARB



Small Fender Light

- Red & amber lens
- #30-MCL181ARCRB



2"x3" LED Marker Light

- #24-78590 Amber 2x3 LED Marker Light
- #24-78592 Red 2x3 LED Marker Light



2"x6" LED Marker Light

- 20 extra bright LEDs
 - Red or amber
- #15-21280R Red 2x6 LED Marker Light
 #15-21280Y Amber 2x6 LED Marker Light



2"x6" Amber Marker Light

- 3 wire with Amp hardshell connector
- #15-21096Y 2x6 Amber Marker Light

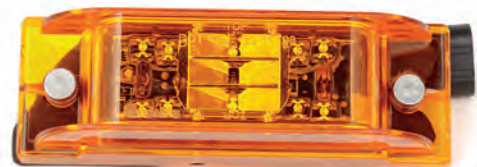



LED Clearance & Marker Light

- 8 diode pattern
- Reflectorized lens on color lens version
- Hard wire leads
- Popular in owner/operator and show trucks
- Optional gaskets to improve seal between lamp & body
- Acrylic lens & housing
- Less susceptible to shock & vibration
- Size: 2" x 6"

- #15-2150 Red Clearance Light
- #15-2150A Yellow Clearance Light
- #15-2152 Red Clearance Light with Clear Lens
- #15-2152A Yellow Clearance Light with Clear Lens

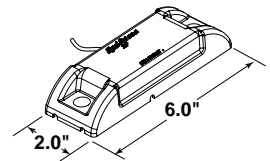

LED Marker & Clearance Light

- Hard wired design eliminates pin corrosion
- Encapsulated electronics
- 16 diode double bullseye LED pattern
- Size: 2.03"W x 4.05"L x 1.09"D

- #15-2660 Red Clearance Light
- #15-2660A Yellow Clearance Light
- #15-2661 Red Clearance Light with Clear Lens
- #15-2661A Yellow Clearance Light with Clear Lens

Light Source

- 16 LEDs
- .05 amp at 12.6 volts

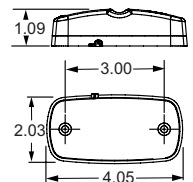

LED Marker & Clearance Light

- Slim 3/4" wide design makes lamp perfect solution for narrow rail designs
- Must be mounted horizontally
- Optional gasket improves seal between lamp & body
- Requires #15-94862 amp connector
- Red has 1 diode, yellow 2 diodes

- #15-35200R Red Clearance Light
- #15-35200Y Yellow Clearance Light
- #15-35201R Red Clearance Light with Clear Lens
- #15-35201Y Yellow Clearance Light with Clear Lens

Light Source

- 10 to 30 volts
- .05 amp

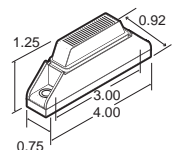

LED Marker & Clearance Light

- Full pattern light output
- Designed for areas with limited space
- Hard-wired design eliminates pin corrosion

- #15-3550 Red Clearance Light
- #15-3550A Yellow Clearance Light

Light Source

- 6 LEDs
- .04 amp at 12.6 volts

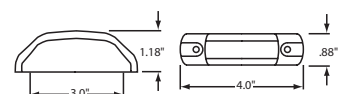

Light Source

- 13 LEDs
- .06 amp at 12.6 volts



LED Clearance Light

- Stainless steel oval clearance marker
- Snap on stainless steel bezel
- Standard 2 prong connection
- 2 hole surface mount

- #29-M72270R Red Stainless Steel Marker Light
- #29-M72270Y Amber Stainless Steel Marker Light
- #29-M7220RCL Red Clear Lens
- #29-M7220YCL Amber Clear Lens
- #29-PL-2 Right Angle Plug



Light Source

- 12 LEDs
- .05 amp at 12.6 volts

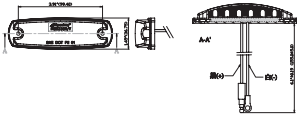

LED Clearance Light

- 6" clearance marker
- Stainless steel bezel
- 6" wire leads with .180 connector
- No plug needed
- 2 hole surface mount

- #29-M20332R Red 6" Clearance Marker
- #29-M20332Y Amber 6" Clearance Marker



LED Clearance Light with Chrome Trim

- Comes with chrome trim
- Size: 4 3/4"x2"
- Amber or red lens

- #15-2671 LED Clearance Light with Chrome, Red
- #15-2671A LED Clearance Light with Chrome, Amber



Light Source

- Incandescent
- .60 amp at 12.6 volts

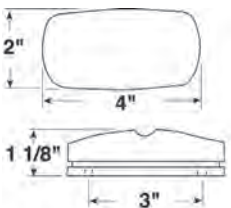

Incandescent 2 Bulb Light

- PC-rated clearance/side marker light
- "Double bulls-eye" twin bulb design
- Acrylic lens snaps onto housing
- Surface mounts on 3" centers
- Single 4.5" wire connection, grounds through mounting hardware
- Features two 15,000-hour-rated long-life bulbs
- Blue, clear and green available for accessory use only

- #13-138R Red PC-Rated Clearance Side Marker
- #13-138A Amber PC-Rated Clearance Side Marker
- #13-138C Clear Light Accessory
- #13-138B Blue Light Accessory
- #13-138G Green Light Accessory
- #13-138-15R Red Lens
- #13-138-15A Amber Lens
- #13-138-15C Clear Lens
- #13-138-15B Blue Lens
- #13-138-15G Green Lens



Light Source

- 24 LEDs

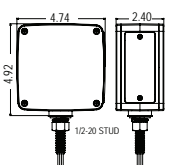

Double-Face Pedestal Lamp

- 24 LED pattern
- Chrome-plated housing
- Ideal for trucks, municipal and farm equipment

- #15-2753 Red/Yellow Roadside Double-Face Lamp
- #15-2756 Red/Yellow Curbside Double-Face Lamp
- #15-2752 Yellow/Yellow Double-Face Lamp with Sidemarkers



#15-2752

Incandescent Light Bar

- Economical identification light bar for over 80" applications
- White powder-coated bar with 3 lights attached
- Mounts on 16 $\frac{1}{8}$ " centers
- Size: 1"W x 16 $\frac{3}{4}$ "L

#13-107-3R Mini ID Light Bar



Light Source

- Incandescent
- .95 amp at 12.6 volts

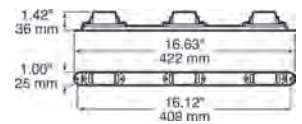

LED Light Bar

- Aluminum identification bar with three lights
- 2 hole surface mount
- 2 – 12" leads
- Size: 1"W x 17.1"L

#29-M20343R Red ID Light Bar



Light Source

- 21 LEDs
- .12 amp at 12.6 volts

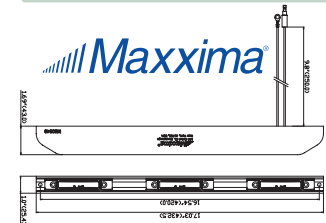

Red I Bar

- 3 Red $\frac{3}{4}$ " lights
- Black molded base
- Size: 15"L x 1 $\frac{3}{16}$ "W x 1"H

#30-MCL922RB Red I Bar with Black Molded Base



Light Source

- 1 LED
- .02 amp at 12.6 volts



LEDs for Light Bar

- 3 light unit
- Grommet mount $\frac{3}{4}$ " hole
- Space-saving design
- Grommet included for $\frac{3}{4}$ " hole
- 2 male .180 bullets

#29-M09300R-3 3 Light ID System

Light Source

- 3 LEDs
- .05 amp at 12.6 volts

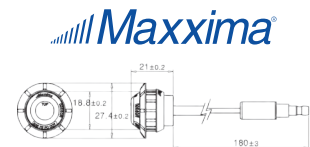

ID Bar

- Three 1"x2" LED lights
- Stainless steel
- Size: 1.5"W x 16"L

#29-M20323R Stainless Steel ID Light Bar



ID Bar

- Three 1 $\frac{1}{4}$ " LED lights
- Size: 2"W x 16 $\frac{1}{4}$ "L x 1 $\frac{1}{8}$ "H

#29-M09410R-RME ID Light Bar



Light Source

- 6 LEDs
Low .02 amp
High -.23 amp at 12.6 volts
- 42 LEDs
Low .06 amp
High .42 amp at 12.6 volts

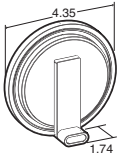

4" Round LED Stop/Turn/Tail Light

- 6 or 42 diode pattern available
- Use with rubber grommet mounted in 4½" hole
- Hard shell connector

#15-44302R Red 4" 6 Diode LED Tail Light
#15-44202R Red 4" 42 Diode LED Tail Light



#15-44302R



#15-44202R

Light Source

- 18 LEDs
Low .02 amp
High .24 amp at 12.6 volts

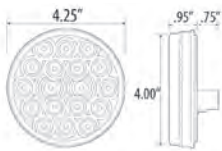

4" Round LED Stop/Turn/Tail Light

- 18 diode light pattern
- Standard 3 pin connector
- Available in red or yellow

#24-76452 Red 4" Round LED Light
#24-76450 Amber 4" Round LED Light



Light Source

- 24 LEDs
Low .02 amp
High .24 amp at 12.6 volts

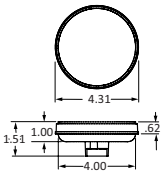

4" Round LED Stop/Turn/Tail Light

- 24 diode pattern
- Standard 3 pin connector
- Unique LED array displays a full pattern light output
- Available in red, yellow, or clear lens

#15-4050 4" Red LED Tail Light
#15-4050A 4" Yellow LED Tail Light
#15-4051 4" Red with Clear Lens LED Tail Light
#15-4051A 4" Yellow with Clear Lens LED Tail Light



#15-4050A

#15-4050



#15-4051

Light Source

- 10 LEDs
Low .04 amp
High .30 amp at 12.6 volts

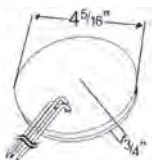

4" Round LED Stop/Turn/Tail Light

- Lens design spreads light for maximum dispersion
- 10 diode light pattern
- Hard wire, pig tail

#14-53532 4" Round Hard Wire Red Light





4" Round Grommet Mount Signal Lights

- Red stop/turn/tail, 56 LEDs
- Amber park/rear turn, 48 LEDs

#29-M56100R Red 4" Grommet Mount Signal Light
 #29-M42100Y Amber 4" Grommet Mount Signal Light

7 LED 4" Round Light

- Stop/turn/tail backup combo
- Hardshell connector
- 3 pin hardshell and 1 pin hardshell connector

#13-417-49 7 LED 4" Round Light,
 3 Pin Hardshell Connector

Connectors for this light:

#15-94707 3 Pin Hardshell
 Connector

#13-B880-40 1 Pin Hardshell
 Connector



7 LED 4" Round Light with PL3 Connector

- Stop/turn/tail
- PL3 connector

#13-826R-7 7 LED 4" Round Light – PL3 Connector



6 LED Oval Tail Light – Clear Red

- Stop/turn/tail backup combo
- Red clear lens

#30-STL211XRCB 6 LED Oval Tail Light - Clear Red



7 LED Oval Tail Light with PL3 Connector

- Stop/turn/tail
- Grommet mount
- PL3 connector
- Pig tail

#13-821R-7 7 LED Oval Tail Light



7 LED Oval Tail Light

- Stop/turn/tail backup combo
- Choose from hardshell, 3 pin, or 1 pin connector

#13-M880-7 7 LED Oval Tail Light with Hardshell Connector

Connectors for this light:

#15-94707 3 Pin Hardshell Connector

#13-B880-40 1 Pin Hardshell Connector

Light Source

- 26 LEDs

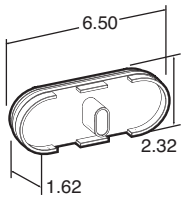

LED Oval Stop/Turn/Tail Light

- 26 diode pattern
- Rubber grommet mount
- Mounts horizontally or vertically
- Hard shell connector
- Size: 6.50"L x 2.32"W

#15-60250R Red Oval Tail Light



Light Source

- 20 LEDs
- Low .02 amp
- High .24 amp at 12.6 volts



LED Oval Stop/Turn/Tail Light

- 20 diode pattern
- Uses standard 3 pin connector
- Available in red or yellow

#24-87721 Red Oval Tail Light
#24-87720 Yellow Oval Tail Light



#24-87721



#24-87720

Light Source

- 24 LEDs
- Low .02 amp
- High .24 amp at 12.6 volts

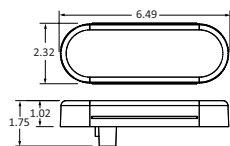

LED Oval Stop/Turn/Tail Light

- 24 diode pattern
- Uses standard 3 pin connector
- Red, yellow or clear lens

#15-6050 Oval Red Tail Light
#15-6050A Oval Yellow Tail Light
#15-6051 Oval Red Light with Clear Lens
#15-6051A Oval Yellow light with Clear Lens



#15-6050A

#15-6050



#15-6051



#15-6051A

Light Source

- Incandescent
- Low .45 amp
- High 2.10 amp at 12.6 volts

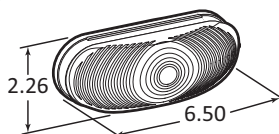

Incandescent Oval Stop/Turn/Tail Light

- Heavy-duty dual filament bulb
- Mounts horizontally or vertically
- Standard 3 pin connector

#15-60283R Oval Red Tail Light
#15-60283Y Oval Yellow Tail Light



#15-60283R

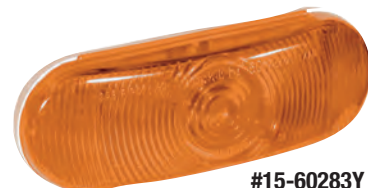

#15-60283Y



#29-M63100Y



#29-M63100R

6" Oval Stop/Turn/Tail Light – Grommet Mount

- 60 LEDs
- PL3 connector
- Grommet mount
- Available in red or amber
- Size: 6" oval light

#29-M63100Y Grommet Mount Tail Light, Amber
 #29-M63100R Grommet Mount Tail Light, Red



#37-CPL65A



#37-CPL65R

Oval Surface Mount Stop/Turn/Tail Lights

- 3 wire connector
- Comes with chrome trim
- Amber, red, or clear lens
- Size: 6" oval light

#37-CPL65A Surface Mount Oval Light with Chrome, Amber
 #37-CPL65R Surface Mount Oval Light with Chrome, Red
 #37-CPL65C Surface Mount Oval Light with Chrome, Clear



6" Oval Sequential Arrow Light

- Rubber mount
- PL3 Connector
- Size: 6" oval light

#19-38143 Oval Sequential Arrow Light, Amber Light
 #24-77125 Oval Sequential Arrow Light, Amber, Clear Lens



6" Clear Oval Backup Glow Light

- Rubber grommet mount
- PL3 Connector
- Size: 6" oval light

#30-BUL111CB 6" Clear Oval Backup Glow Light

Grommet Mount S/T/T Lights

- Grommet mount
- S/T/T backup combo
- Standard PL3 connector
- 4" round has 21 diodes
- 6" oval has 22 diodes

#30-STL201XRB 4" Round Grommet Mount STT Light
 #30-STL211XRB 6" Oval Grommet Mount STT Light



Grommet Mount Glow Lights – Red

- Standard PL3 connector
- 4" round has 21 diodes
- 6" oval has 22 diodes

#30-STL101RB 4" Round Grommet Mount Glow Light, Red
 #30-STL111RB 6" Oval Grommet Mount Glow Light, Red



Clear Backup Light

- Rubber grommet mount
- Standard PL3 connector
- 4" round has 7 diodes
- 6" oval has 7 diodes

#13-826C-7 4" Round Backup Light
 #13-821C-7 6" Oval Backup Light



Light Source

- Incandescent
- Low .44 amp
- High .210 amp at 12.6 volts

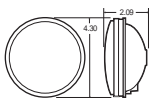
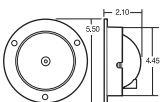

4" Round Incandescent Stop/Turn/Tail Light

- Mounts in rubber grommet
- Heavy-duty dual filament bulb
- Standard 3 pin connector
- Regular or reflector lens

#15-40282R Red 4" Round Light
 #15-40282Y Yellow 4" Round Light
 #15-40285R Red 4" Round Reflector Lens





Incandescent 3 Stud Tail Light

- Universal stud mount combination tail light
- Includes stop, turn, tail, back-up, license light functions
- Features three 1/4" diameter mounting studs, 2" triangle pattern
- Connects through 3-wire loom
- Grounds through mounting studs

#13-445 Three Stud Incandescent Rear Light



LED 3 Stud Tail Light

- Popular 3 stud mounting design fits wide range of applications
- Combination stop, turn, tail, back-up light with integral reflex
- Hard wire design
- "L" version includes LED license light
- Potted LED circuitry protects against moisture and road shock

#13-845 LED 3 Stud Tail Light
#13-845L LED 3 Stud Tail Light with License Light

Light Source

- LEDs
- Low .01 amp High .16 amp Backup .20 amp at 12.6 volts

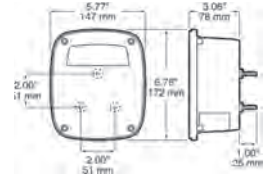

#15-4550A



#15-4550



#15-4560C

3"x5" Stop/Turn/Tail Lights

- PL3 connector
- Rubber grommet mount
- Red, amber, or clear lens

#15-4550 3x5 Tail Light, Amber
#15-4550A 3x5 Tail Light, Red
#15-4560C 3x5 Tail Light, Clear



#29-M42206R

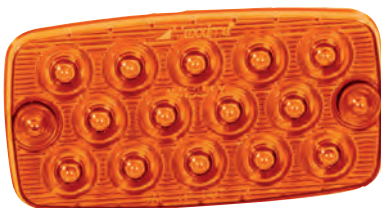

#29-M42206Y

Rectangle Surface Mount

- 2 hole surface mount
- High-impact polycarbonate lens
- Moisture, vibration, and corrosion proof
- 3 blunt-cut 6" leads
- Red has 10 diodes, amber has 17 diodes

#29-M42206R Red Stop/Tail/Turn Light
#29-M42206Y Amber Turn Light
#29-M42206 Adhesive Kit

Material

- Polycarbonate lens

Light Source

- 14 LEDs
- Red .23 amp Amber .29 amp at 12.8 volts

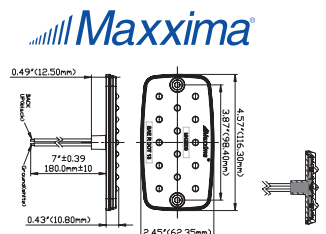

Light Source

- 8 LEDs
- Low .01 amp
- High .17 amp at 12.6 volts

LED Thin Line Stop/Turn/Tail Light

- Meets D.O.T. requirements vertically, horizontally, or at a 45 degree angle
- Thin line design fits narrow channel applications
- Hard wired design mounts on 14¼" centers
- Size: 15¾"L x 1.30"W

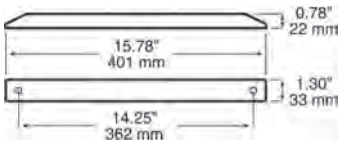

#13-869 Thin Line Stop/Turn/Tail Light



15" Tail Light

- Hard wire connector
- Stop/Turn/Tail
- Size: 15"L x 1.2"W x 0.7"H

- #29-M63318R-A 15" Tail Light, Red
- #29-M63318RCL-A 15" Tail Light, Red Clear Lens
- #29-M63318Y-A 15" Tail Light, Amber
- #29-M63318-A 15" Backup Light, White

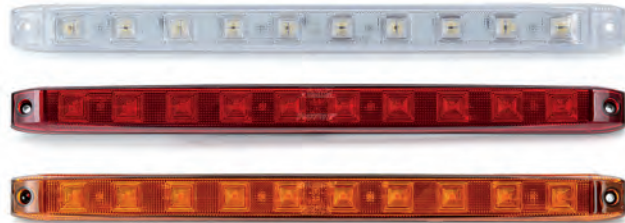

Thinline Stop/Turn/Tail Backup Combo

- Hard wire design
- Size: 20½"L x 1⅞"W x ¾"H

- #30-STL264RB Thinline STT, Red Lens
- #30-STL264CB Thinline STT, Clear Lens Red



LED ID Light – 4 Wire

- 4 wire connector
- Can use for ID plus brake and turn signal
- Size: 15½"L x 1⅞"W x ½"H

#16-TEC LED ID Light, 4 Wire



LED Tail Light – 3 Wire

- 3 wire connector
- Hard wire stop/turn/tail
- Size: 12¾"L x 1"W x ½"H

- #30-STL59RB LED Tail Light, Red
- #30-STL59RCB LED Tail Light, Red Clear Lens



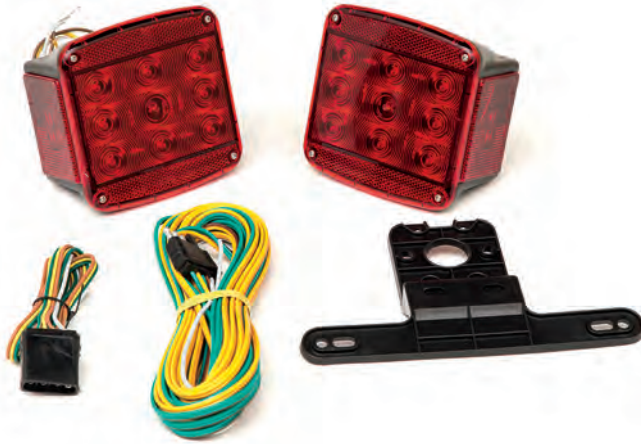

LED Trailer Light Kit



- Includes 2 tail lights, 20' trailer harness, truck connector, license bracket, mounting hardware and installation instructions
- Secure visual pack

#13-941 LED Light Kit



Submersible LED Stop/Turn/Tail Light



- Exceeds all D.O.T. rear lighting and reflex requirements for trailers
- Option with license light or without

#13-840 LED without License Light

#13-840L LED with License Light

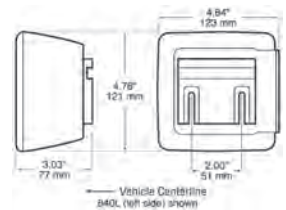

#13-214Y

LED Clearance Light with Integral Reflex



- Two 24" lead wires
- Convenient single stud mounting
- Functions as side marker or clearance light with built-in reflective optics

#13-214Y LED Side Marker Light, Amber

#13-214R LED Side Marker Light, Red

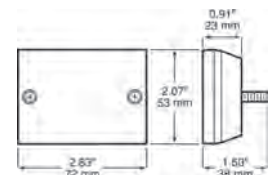

Incandescent Trailer Light Kit



- Complete light kit for small trailers
- Provides all legal lighting and reflectors for trailers under 80" wide
- Kit includes 2 tail lights, 2 amber side marker lights, 20' trailer harness, 48" truck connector, license bracket, mounting hardware, and installation instructions

#13-540 Incandescent Trailer Light Kit

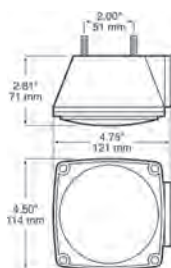

Incandescent Tail Light with Side Marker Light

- Rear tail light for trailer
- Includes the following functions: stop, turn, tail, rear
- Reflex with side marker
- Mounts on 1/4" mounting stud on 2" centers

#13-440 Incandescent Tail Light without License Light

#13-440L Incandescent Tail Light with License Light

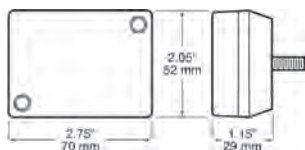

Incandescent Marker Light

- Clearance light with integral reflex
- One 1/4" stud for mounting
- Functions as side marker or clearance light
- Available in red or yellow

#13-114R Incandescent Red Marker Light with Reflex

#13-114Y Incandescent Yellow Marker Light with Reflex



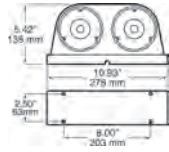
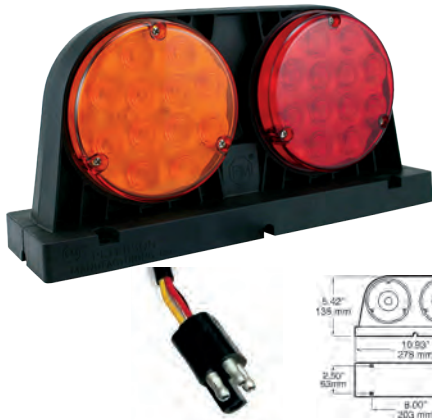

LED Agricultural Stop, Tail, Turn & Warning Lights

- Perfect for all agricultural applications
- Works with all 12 volt vehicles
- Can be mounted to vertical or horizontal surface
- Combination lights function both as red stop and tail light, amber turn signal, and flashing warning light
- Comes with a 4-pin plug

#13-318L-P LED Ag Stop/Turn/Tail & Warning Light
 #13-318R-P LED Ag Stop/Turn/Tail & Warning Light

Material:

- Plastic surface mount housing
- SQ4-pin plug

Light Source:

- LED
- High .42 amp
- Low .02 amp at 12.6 volts

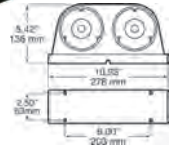

Agricultural Stop, Tail, Turn & Warning Lights

- Perfect for all agricultural applications
- Works with all 12 volt vehicles
- Can be mounted to vertical or horizontal surface
- Combination lights function both as red stop and tail light, amber turn signal, and flashing warning light
- Comes with a 4-pin plug

#13-308L Ag Stop/Turn/Tail & Warning Light
 #13-308R Ag Stop/Turn/Tail & Warning Light

Material:

- Plastic surface mount housing
- SQ4-pin plug

Light Source:

- Incandescent
- High 2.16 amp
- Low .53 at 12.6 volts

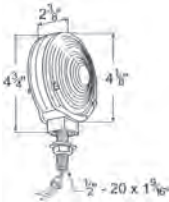

Incandescent Double-Face Light

- Red and amber light
- Replaceable bulbs
- Single stud pedestal mount
- Chrome die-cast housing

#24-80300 Die-cast Double-Face Lamp
 #24-80304 Red Replacement Lens
 #24-80301 Amber Replacement Lens
 #24-1157 Replaceable Bulb

Features:

- Double face light
- Chrome fixture
- Polycarbonate lens
- 6" wire leads

Light Source:

- 1157 bulb

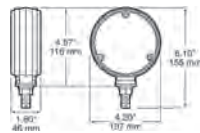

LED Double-Face Light

- Red and amber light
- Single stud pedestal mount
- 2 – 4" round acrylic lenses
- Chrome die-cast housing
- Has lens screws

#13-338-2 LED Red/Amber Light
 #13-4744 LED Amber/Amber Light

Note: #13-4744 is a single function light.

Features:

- LED double face light
- Sealed light unit
- 6" wire leads

Material:

- Polycarbonate lens
- Chrome fixture

Light Source:

- 24 LEDs per side
- High .40 amp
- Low .03 amp at 12.6 volts





LED Single-Face Stop/Turn/Tail Light

- Available in red or amber
- Single stud pedestal mount
- Single 4" round acrylic lens
- Chrome die cast housing

#13-339R Red LED Single-face Light
 #13-339Y Yellow LED Single-face Light

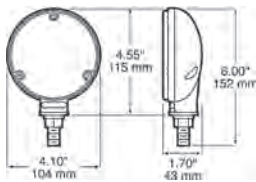

Double-Face Pedestal Lamp

- 24 LED pattern
- Chrome-plated housing
- Ideal for trucks, municipal and farm equipment

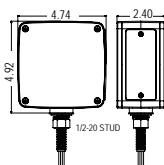

#15-2752

#15-2753 Red/Yellow Roadside Double-Face Lamp
 #15-2756 Red/Yellow Curbside Double-Face Lamp
 #15-2752 Yellow/Yellow Double-Face Lamp with Sidemarker

4" Round LED Double-Face Light

- Red and amber
- Clear lens

#24-7863 4" Round LED Double-Face Light



Double-Face Pedestal Lamp

- Double stud mount
- 24 diode pattern per side
- Specify curbside or roadside

#15-2758 Curbside Red/Yellow Double-Face Pedestal Lamp

#15-2759 Roadside Red/Yellow Double-Face Pedestal Lamp



Double-Face Pedestal Lamp with Clear Lens

- Double stud mount
- 25 LED
- Specify passenger side or driver side

#19-38759 Passenger Side Clear Lens Double-Face Pedestal Lamp

#19-38758 Driver Side Clear Lens Double-Face Pedestal Lamp





LED Flush Mount Light

- Flush mount
- Bright cool white light output
- 1500 lumens
- Refrigeration/moisture safe
- Splash-proof design
- Frosted lens
- Hard wire
- Amp draw 1.92 amp
- Size: 18.3"L x 1"D x 5.3"H

#29-M84415 Interior Flush Mount Light

Light Source:

- 66 LEDs
- 1,500 lumens
- 1.92 amps at 12.8 volts



LED Round Interior Light

- 900 lumens
- Low profile design
- Polycarbonate lens and base
- Wire channel guide for flat surface mounting
- 3 hole mount
- On/off rocker switch
- Size: 6" diameter x 1"D

#29-M84434 Interior Light with Switch

Light Source:

- 42 LEDs
- 900 lumens
- .95 amps at 12.8 volts

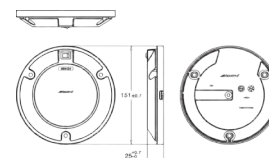

LED Round Interior Light

- 325 lumens
- Interior dome light
- Low amp draw
- 3 hole surface mount
- 2 wire pigtail
- Size: 5.5" diameter x .08"D

#29-M84405-B Interior Light

Light Source:

- 15 LEDs
- 325 lumens
- .36 amps at 12.8 volts

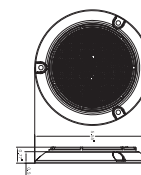

LED Rectangular Interior Light

- Surface mount
- Potted circuit
- Hard wire
- Black metal base
- Polycarbonate frosted lens

#25-179-3 3 LED Interior Light

Light Source:

- #25-179-1: 1 watt LED, .30 at 12.6 v
- #25-179-3: 3-1 watt LEDs, .30 at 12.6v

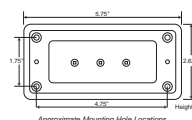

Carriage-Lite

Light Source:

- 18 LEDs
- 530 lumens
- .56 amps at 12.8 volts

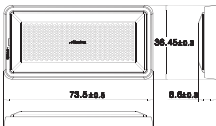

LED Interior Rectangular Interior Light

- Surface mount
- 530 lumen high output
- Polycarbonate frosted lens
- Hard wired
- Size: 5.8"L x 2.9"W x .07"H

#29-M84427 Interior Light



Light Source:

- 20 LEDs
- .25 amps at 12.8 volts



LED Surface-Mount Light

- 2 hole surface mount
- Polycarbonate lens & housing
- 2 wire leads
- Size: 4.6"W x 2.4"H x 1"D

#29-M42206 LED Interior Light

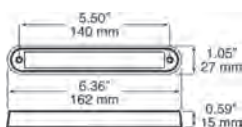
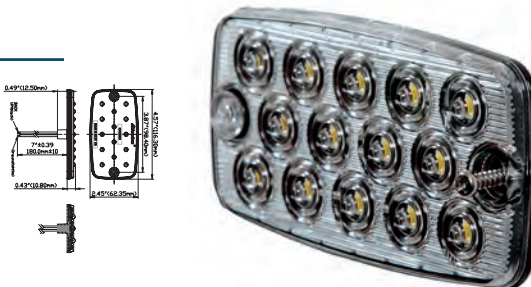

Utility LED Interior Light

- Multi-volt design, 12 or 24 volt
- Low amp draw • Hard wire
- Comes with custom surface mount bracket or can be flush-mounted without bracket

#13-388C Interior Light



Light Source:

- 2 LEDs
- .03 amps at 12.6 volts

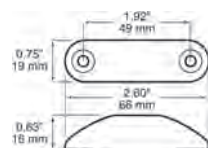

LED Interior Light

- LED utility, interior courtesy light
- 2 white LED diodes
- Mounts on 1 5/16" centers
- Optional bracket allows for mounting on 1 5/16" or 1 1/8" centers
- Mounting gasket, black bracket, and chrome bezel sold separately

#13-168C Interior Light
 #13-B168-09 Black Bracket
 #13-B168-10 Chrome Bezel
 #13-B168-18 Mounting Gasket



#13-168C

#13-B168-18



#13-B168-09

#13-B168-10

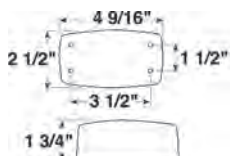

Incandescent Dome Light

- 12 volt interior dome light
- Polycarbonate with nylon switch
- Metal base surface mount with screw on 3 1/2" center
- On/off switch
- Separate ground and lead wire supplied for electrical connection

#13-391 Incandescent Dome Light





LED Utility Light

- Small clear grommet mount light
- 3/4" mounting hole
- Included grommet and .180 bullet plugs

#14-49341 White LED Dot Light

Light Source:

- 1 LED
- .03 amp at 12.6 volts



Light Source:

- .02 amp at 12.6 volts

LED Pilot Light

- 1/2" pilot light
- Chrome bezel
- 6" wire leads
- Requires 1/2" mounting hole

- #25-183R LED Pilot Light Red w/Chrome Bezel
- #25-183A LED Pilot Light Amber w/Chrome Bezel
- #25-183B LED Pilot Light Blue w/Chrome Bezel
- #25-183G LED Pilot Light Green w/Chrome Bezel



Light Source:

- .02 amp at 12.6 volts

LED Pilot Light

- 1/4" pilot light
- Chrome bezel or housing
- 6" wire leads
- Requires 5/16" mounting hole

- #25-184R LED Pilot Light Red w/Chrome Bezel
- #25-184B LED Pilot Light Blue w/Chrome Bezel
- #25-184G LED Pilot Light Green w/Chrome Bezel
- #25-184P LED Pilot Light Purple w/Chrome Bezel



Indicator Light with Black Base

- 8" wire leads
- Requires 5/16" mounting hole

- #19-36520B Red Indicator Light
- #19-36517B Amber Indicator Light
- #19-36518B Blue Indicator Light
- #19-36519B Green Indicator Light

Light Source:

- 1 LED
- .02 amps at 12.6 volts

Light Source:

- .16 amps at 12.6 volts

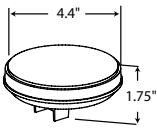

LED Backup Light

- 4" round clear backup or work light
- Standard 3 pin plug
- Designed at 13.5 volt .249 amp

#13-826C 7 LED 4" Round Clear Backup Light – Peterson

#15-4060C 4" Round Clear Backup Light – Truck-Lite

For a brighter backup light, choose Optronics.

#24-76454 18 LED 4" Round Clear Backup Light – Optronics



Light Source:

- .16 amps at 12.6 volts

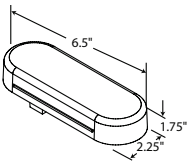

LED Oval Clear Backup or Work Light

- Standard 3 pin plug
- Designed at 13.5 volt .249 amp

#13-821C 7 LED Oval Clear Backup Light – Peterson

#15-6060C LED Oval Clear Backup Light – Truck-Lite

For a brighter backup light, choose Optronics.

#24-87719 20 LED Oval Clear Backup Light – Optronics



Light Source:

- Incandescent
- 2.1 amps at 12.8 volts

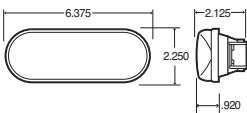

Incandescent Oval Backup or Work Light

- Shock mounted bulb to extend life
- Standard 3 pin connector
- Not recommended for dome lamp

#15-60284C Incandescent Oval Backup Light



Light Source:

- Incandescent
- 2.1 amps at 12.8 volts

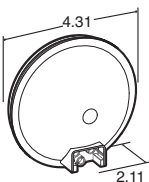

Incandescent 4" Round Backup or Work Light

- Shock mounted bulb to extend life
- Standard 3 pin connector
- Not recommended for dome lamp

#15-40204 4" Round Incandescent Backup Light





LED License & Utility Light

- Durable low amp LED light
- Hard wire leads
- Mounting screws with mounting pad
- Spacer bracket available

#13-294 LED License Light
 #13-294-09 Spacer Bracket

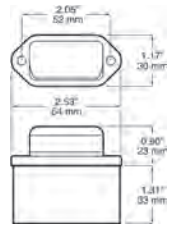

LED Metal License Light

- Hard wire leads
- Single unit meets D.O.T. requirements above the license plate

#13-M296C LED License Plate Light

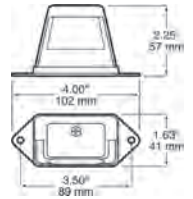

LED License Light

- Plastic chrome finish
- Chrome bezel

#30-LPL31CB SS LED License Light with Chrome Bezel



LED License Light

- Hard wire light with .180 bullet connectors
- Requires 3/4" hole
- Comes with hooded grommet
- Top and side plate mounting options

#14-60721 Hooded LED License Light

Light Source:

- 1 LED
- .03 amp at 12.6 volts



Replacement LED License Light

- License light only
- Fits in standard license light bracket
- Snap fits into #13-B150-141 bracket

#14-60671 Replacement LED License Light

Light Source:

- 1 LED
- .03 amp at 12.6 volts



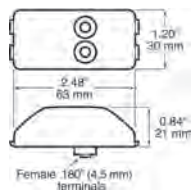
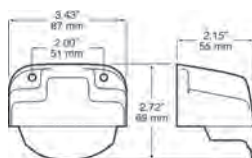

Incandescent License Light

- High impact black plastic housing
- Incandescent clear painted light
- Kit includes bracket and light
- Pigtail sold separately, #15-94902

#13-B150-141 **Black License Light Bracket**
#13-150C **Clear Painted Light – Incandescent**
#30-LPL91CB **LED Light Only**



#13-B150-141



#13-150C

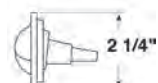
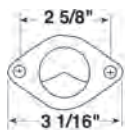

Incandescent License Utility Light

- Chrome-plated hood, steel housing
- Single lead wire grounds through mounting hardware

#13-437 **Incandescent License Utility Light**

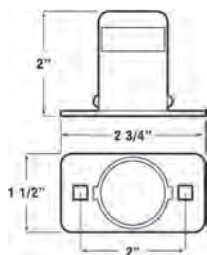

Incandescent License Light

- Chrome-plated steel housing
- 2 mounting holes, 2" centers
- Traditional style replaceable bulb

#13-435 **Incandescent License Light**



LED License Light

- High impact black plastic housing with LED light
- Kit includes LED light and bracket
- Hard wire with .180 bullet connector

#14-42322 **LED License Light with Bracket**





LED Work Light

- Work pattern ideal for light utility, construction lighting, agricultural lighting
- Operates at 9 to 32 volts
- 1600 lumens

#98-JT1210-24W LED Work Light

Material:

- Die cast aluminum housing
- Polycarbonate lens
- Stainless steel hardware
- Encapsulated circuitry

Light Source:

- 8 LEDs
- 1.26 amp at 12.6 volts



LED Work Light

- 3600 lumens work light
- Work pattern ideal for utility construction lighting, agricultural lighting
- Operates at 9 to 30 volts
- Size: 4.5"w x 4.5"h x 3"d

#JT1210-48 LED Work Light

Features:

- 9 to 36 volts
- Stainless steel hardware

Material:

- Black aluminum housing
- Polycarbonate lens

Light Source:

- 2.59 amp at 12.6 volts



Par 36 Rubber Tractor Light

- PVC molded housing cushions lamp from shock and vibration
- Replacement flush-mount par 36 sealed beam
- Incandescent light

#13-507 Trapezoid Light
 #13-507F Flood Light
 #13-507LU Housing Only
 #13-H4411 Trapezoid Bulb

Material:

- Rubber shell light
- Zinc hardware

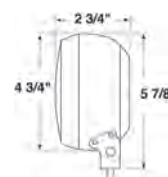

LED Driving Light

- Low current draw
- Economy light

#29-630A LED Driving Light

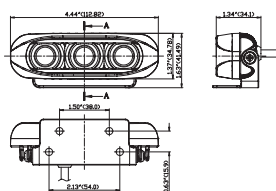

Material:

- Black housing
- Stainless mounting hardware
- Polycarbonate lens
- 3 - 1 watt LEDs
- .26 amp at 12.8 volts



3" LED Work Light

- 750 lumens
- Dual voltage 12/24
- Size: 3.38"W x 3"H x 1.75"D

#29-MWL-45 3" 750 Lumen LED Work Light



3" LED Work Light

- Choose from flood beam (1,000 lumens) or focus beam (800 lumens) versions
- Dual voltage 12/24
- Size: 3.2"W x 3.2"H x 2.2"D

#29-MWL-20 Flood Beam 3" LED Work Light
 #29-MWL-20FB Focus Beam 3" LED Work Light



1200 Lumen 6 LED Work Lights

- 1200 lumens
- Dual voltage 12/24
- Choose from:
 - 4.7" Round Light
 - 4.7" x 4.5" Square Light
 - 5.9" x 3.6" Rectangular Light

#29-MWL-28 4.7" Round Light
 #29-MWL-30 4.7" x 4.5" Square Light
 #29-MWL-29 5.9" x 3.6" Rectangular Light



#29-MWL-28



#29-MWL-30



#29-MWL-29

2100 Lumen 16 LED Work Lights

- 2100 lumens
- Dual voltage 12/24
- Choose from:
 - 4.7" Round Light
 - 4.7" Square Light
 - 5.9" x 3.6" Rectangular Light

#29-MWL-41 4.7" Round Light
 #29-MWL-43 4.7" Square Light
 #29-MWL-42 5.9" x 3.6" Rectangular Light



#29-MWL-41



#29-MWL-43



#29-MWL-42



LED Light Bars

- Spot flood light bar
- Dual voltage 12/24
- Aluminum housing
- 5-year warranty
- See chart for options

Part Number	Width	Lumens	Draw
#30-UCL18CB	4"	800	1.0 amp
#30-UCL18CB	9"	2100	3.3 amp
#30-UCL18CB	13"	3700	4.0 amp
#30-UCL18CB	22"	7500	6.8 amp
#30-UCL18CB	33"	12,000	9.8 amp
#30-UCL18CB	50"	20,000	11.9 amp



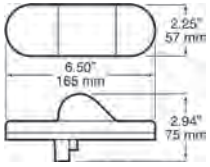

LED Oval Mid Turn Light

- Use for turn and marker light
- 10 diode LED light pattern
- Standard 3 pin connector
- Reflector lens
- Standard oval size

#13-351A LED Mid Turn Light

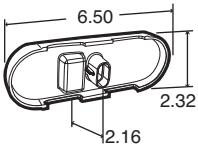

LED Oval Mid Turn Light

- Use for turn and marker light
- 11 diode LED light pattern
- Hard shell connector

#15-60315Y Mid Turn LED Light

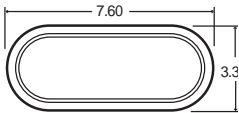

Incandescent Mid Turn Light

- Oval mid turn and marker light
- Reflector lens
- Standard 3 pin connector

#15-60215Y Incandescent Mid Turn Light



LED Turn Signal Light

- Amber 35 LED sequential light for auxiliary applications
- Cycles through multiple sequential arrow until fully illuminated
- Hard wire design includes 3 molded adapter plug
- Standard oval size

#13-420 QA-P Arrow Mid Turn Oval Turn Signal Light

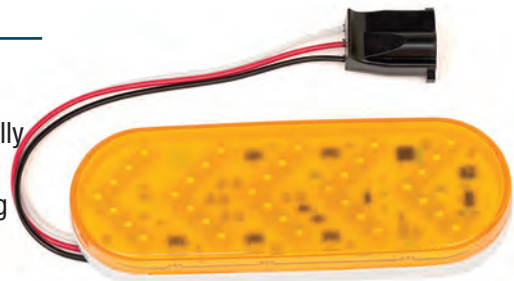



4 LED Surface Mount Emergency Warning

- 18 selectable flash patterns
- Class 1 & title 13 included
- Synchronized/alternating flash
- Snap-on black bezel included
- Low profile design
- Completely resin-sealed electronics
- 6" wire leads
- Surface or grommet mount
- Optional chrome bezel, stainless steel bracket and grommets
- Size: 4.8"W x 1.6"D x 1.3"H

- #29-M20384BRCL Blue/Red Clear Lens 4 LED Surface Mount
- #29-M20384BWCL Blue/White Clear Lens 4 LED Surface Mount
- #29-M20384GYCL Green/Amber Clear Lens 4 LED Surface Mount
- #29-M20384GWCL Green/White Clear Lens 4 LED Surface Mount
- #29-M20384RCL Red Clear Lens 4 LED Surface Mount
- #29-M20384RWCL Red/White Clear Lens 4 LED Surface Mount
- #29-M20384YCL Amber Clear Lens 4 LED Surface Mount
- #29-M20384WYCL White/Amber Clear Lens 4 LED Surface Mount
- #29-M20384WCL White Clear Lens 4 LED Surface Mount
- #29-M50143 Black Grommet
- #29-M50138 Chrome Bezel
- #29-M50116 Stainless Steel Bracket

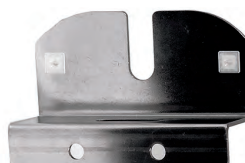

Material:

- Polycarbonate lens & housing

Light Source:

- 4 LEDs
- .40 amp at 12.8 volts

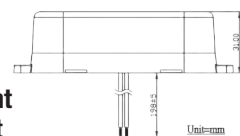

3 LED Surface Mount Emergency Warning

- 11 selectable flash patterns
- Class 1 & title 13 included
- Synchronized/alternating flash
- Snap-on black bezel included
- Low profile design
- Completely resin-sealed electronics
- 6" wire leads
- Surface or grommet mount
- Optional chrome bezel, stainless steel bracket and grommets
- Size: 3.9"W x 1.7"D x 1.3"H

- #29-M20383YCL Amber Clear Lens 3 LED Surface Mount
- #29-M20383WCL White Clear Lens 3 LED Surface Mount
- #29-M20383RCL Red Clear Lens 3 LED Surface Mount
- #29-M50141 Black Grommet
- #29-M50142 Wide Channel Black Grommet
- #29-M50137 Chrome Bezel
- #29-M50115 Stainless Steel Bracket

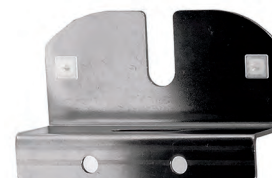

Material:

- Polycarbonate lens & housing

Light Source:

- 3 LEDs
- .20 amp at 12.8 volts

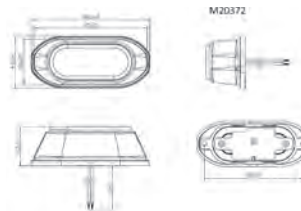

Material:

- Polycarbonate lens & housing

Light Source:

- 3 LEDs
- .24 amp at 12.8 volts



5" LED Beacon Light

- Surface mount beacon flashing light
- 2 hole mounting with 2 wire lead
- Size: 2.9" diameter x 4.8"H
- Wire leads

#29-M427054 5" LED Beacon Light

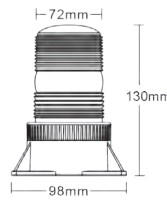

L10 Series Strobe Light

- SAE class 1 certified, amber only
- Economical LED amber beacons
- High and low dome
- Eighteen total flash patterns
- 6" polycarbonate base
- Magnet mount comes with cigar plug

- #26-L10HM High Dome Magnetic Mount Strobe Light
- #26-L10HP High Dome Permanent Mount Strobe Light
- #26-L10LM Low Dome Magnetic Mount Strobe Light
- #26-L10LP Low Dome Permanent Mount Strobe Light
- #26-BBKT20 Stainless Steel Shelf Mount Bracket
- #61-875 3/4" Stainless Steel Pipe Mount
- #61-876 1" Stainless Steel Pipe Mount



#26-L10HP



#61-875



#26-BBKT20

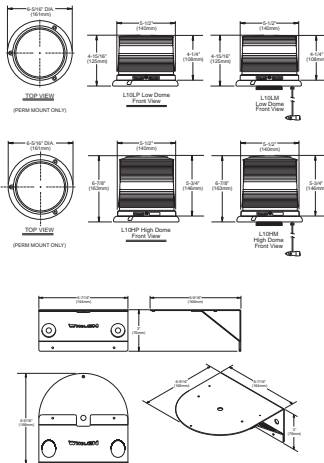

LED 50" Light Bar

- SAE J845 class 1 certified
- Four corner modules plus eight super-LED modules
- Front, rear and all bar operation control
- Clear outer lens
- Permanent mount foot
- Size: 12"W x 50"L x 2.25"H

#26-JE8AMB Justice® 50" LED Light Bar



NOTE

Special Justice Light Bar can be ordered and built to your design.

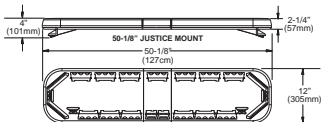

LED 16" Low Profile Mini Light Bar

- Extruded aluminum platform
- Magnetic or permanent mount
- Magnet mount comes with cigar plug
- Comes standard with clear lens and amber flash
- Size: 7.5"W x 16"L x 2.5"H

- #26-MC 16PA Low Profile Permanent Mount Mini Light Bar
- #26-MC 16MA Low Profile Magnetic Mount Mini Light Bar

Also available as an 11" light bar

- #26-MC11MA 11" Low Profile Magnetic Light Bar – Amber
- #26-MC11MCA 11" Low Profile Magnetic Light Bar – Clear/Amber
- #26-MC11PA 11" Low Profile Permanent Light Bar – Amber
- #26-MC11PCA 11" Low Profile Permanent Light Bar – Clear/Amber



#26-MC 16MA



#26-MC 16PA

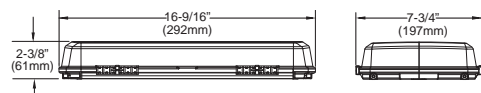



360° Portable LED Battery-Operated Flasher

- Magnetic base
- 360° LED beacon
- 60 triple flashes per minute
- 300-400 hours of operation on 2 D-cell batteries
- Batteries not included

#13-740A Portable Amber Flasher

#13-740R Portable Red Flasher

#13-740-09 Steel Mounting Bracket

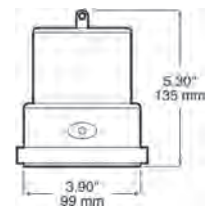
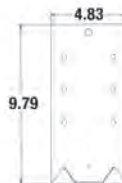

Material:

- Plastic light

Light Source:

- 24 LEDs
- Operates on 2 D-cell batteries



Battery-Operated Safety Flasher

- Magnetic backing
- Self-supporting stand
- Visible for over 1 mile
- 3 settings
- Weather resistant
- Heavy-duty magnets available
- P.C. steel brackets available
- Battery not included

#25-171A Amber Safety Flasher

#25-171R Red Safety Flasher

#25-171W White Safety Flasher

#25-171MA Set of 2" Magnets with Screws

#25-174 Mounting Bracket

#25-174-2 Double Mounting Bracket



#25-174



#25-174-2



#25-171MA



Material:

- ABS plastic light

Light Source:

- Operates on 4 AA batteries

Carriage-Lite



Triangle Flare Kit

- Triangle unfolds and locks together
- Non-skid heavy base
- Reflex reflector strips form border for nighttime visibility, fluorescent orange inner triangle for daytime warning
- Housed in a strong, heavy-duty box, size: 18" x 4" x 4.5"

#61-73-0711-00 Triangle Kit

Reflexite® Reflective D.O.T. Marking Tape V82

- Exceeds minimum requirements by 200%
- Microprismatic technology ensures the longest sight detection distance
- Single-layer construction is thin and flexible for easy application with 100% adhesion
- Superior durability withstands high-pressure washing and resists edge lift
- Maximum nighttime performance
- Impact resistant – keeps photometric requirements after impact – maintains safety after collision or years of wear
- No cracking – tough construction

- #11-5549 Reflexite® 2" x 150' 7" Red 11" White Tape
- #11-5449 Reflexite® 2" x 150' Solid White Tape
- #11-5549-18 Reflexite® 2" x 18" Strips 7" Red 11" White
- #11-1241 Reflexite® 2" x 150' Solid Red Tape

Note: 1" tape also available



Reflexite®

10 YEAR WARRANTY

Reflexite® Day Bright Conspicuity Reflective D.O.T. Marking Tape V92

- Economical
- Exceeds minimum requirements by 200%
- Microprismatic technology ensures the longest sight detection distance
- Single-layer construction is thin and flexible for easy application with 100% adhesion
- Superior durability withstands high-pressure washing and resists edge lift
- Maximum nighttime performance
- Impact resistant – keeps photometric requirements after impact – maintains safety after collision or years of wear
- No cracking – tough construction

- #11-18806 Reflexite® 2" x 150' 7" Red 11" White Tape



Reflexite®

5 YEAR WARRANTY

NOTE

All tape is also available by the foot.

Reflective Marking Tape

- Premium reflective tape with D.O.T. markings
- Exceeds FHWA specifications
- 1,000 candle-power
- Tough, durable and rigid
- Strong tape construction and adhesive

- #97-57384 Grote 2" x 150' 7" Red 11" White Tape
- #97-57384-18 Grote 2" x 18" Strips - 7" Red 11" White
- #97-57387 Grote 1.5" x 150' 7" Red 11" White Tape
- #97-57218 Grote 2" x 150' Solid White Tape



Grote®
The first name in vehicle safety systems.

5 YEAR WARRANTY



Rectangular Reflector

- Industrial strength adhesive
- Ultra-thin design, just .012" thick
- Easy to install
- Exceeds D.O.T. specifications
- Size: 2.75" x 1.75"

#13-B489R Red Rectangular Reflector
 #13-B489A Amber Rectangular Reflector



Round Reflector

- Industrial strength adhesive
- Ultra-thin design, just .012" thick
- Easy to install
- Exceeds D.O.T. specifications
- Size: round 2.875" diameter

#13-B490R Red Round Reflector
 #13-B490A Amber Round Reflector



#25-424R

Adhesive-backed Reflector

- Red or amber
- Chrome frame
- Size: 1.75" x 3.5"

#25-424R Red Stick-on Reflector
 #25-424A Amber Stick-on Reflector



#25-428R

Adhesive-backed Reflector

- Red or amber
- Chrome base
- Size: 2.125" diameter

#25-428R Red Round Stick-on Reflector
 #25-428A Amber Round Stick-on Reflector



#25-429R

Screw Mount 3" Reflector

- Red or amber
- Size: 3" diameter

#25-429R Red 3" Reflector
 #25-429A Amber 3" Reflector

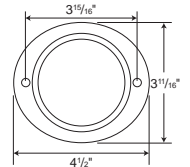

#25-421



#25-423

Slow Moving Vehicle Sign

- For agricultural vehicles
- For horse-drawn vehicles
- Meets ANSI and ASAE standards S-276.5 for slow moving vehicles

#25-423 Plastic Back SMV Sign
 #25-421 Extra Heavy-duty Plastic Back SMV
 #25-417 Galvanized Steel Backed SMV Sign
 #25-422 Adhesive Backed SMV Decal

Note: All SMV items above include red Reflexite tape border



SMV Sign Mounting

- Galvanized and zinc hardware

#25-415 Spade and Socket with Bolts
 #25-415-10 Socket Only
 #25-415-2 Spade Only

Carriage-Lite

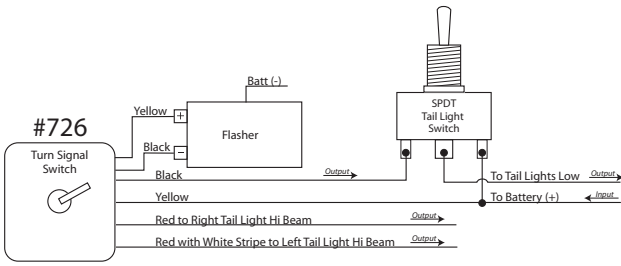

Turn Signal Switch

- Heavy-duty 15 amp switch
- Sealed
- 15" wire leads
- Flasher wire with terminals
- Turn signal switch puts opposite side on steady bright when turn signal is flashing
- #728 has a built-in beeper



- #25-726 Turn Signal Switch
- #25-728 Turn Signal Switch w/Beeper

NOTE

This diagram has an SPDT tail light switch for a flash & steady option for the tail lights. If you are using only 1 option, you can use an SPST switch and use only the (Black wire for flash) (or Battery (+) for steady.)

Carriage-Lite

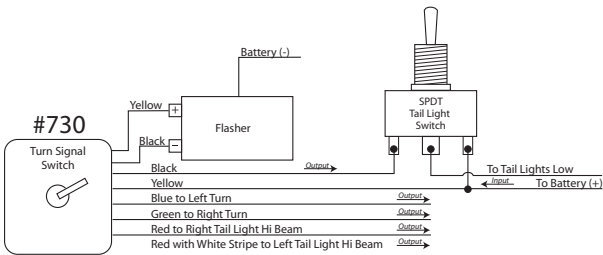

Turn Signal Switch

- Heavy-duty 15 amp switch
- Sealed
- 15" wire leads
- Flasher wire with terminals
- Turn signal switch puts opposite side on steady bright when turn signal is flashing
- Blue & green wire are for extra turn signal or for indicator lights (when turn signal light flashes opposite side stays out)
- #732 has a built-in beeper



- #25-730 Turn Signal Switch
- #25-732 Turn Signal Switch w/Beeper

NOTE

This diagram has an SPDT tail light switch for a flash & steady option for the tail lights. If you are using only 1 option, you can use an SPST switch and use only the (Black wire for flash) (or Battery (+) for steady.)

Carriage-Lite

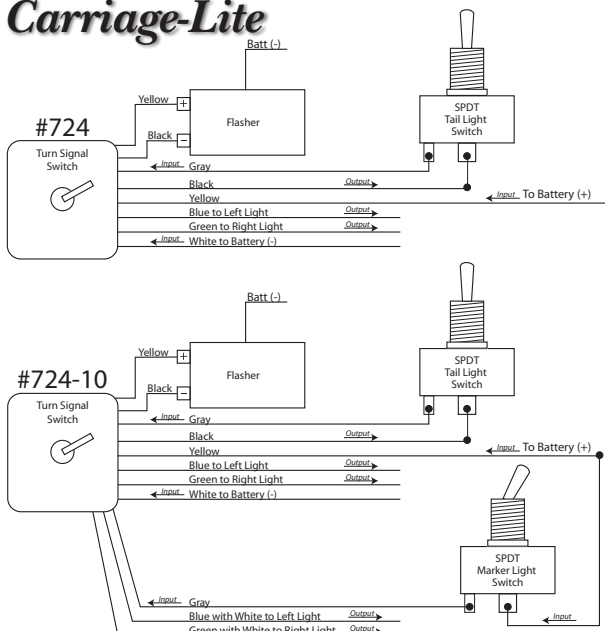

Tractor and Agricultural Turn Signal Switch

- Heavy-duty 15 amp switch
- Sealed
- 15" wire leads
- Flasher wire with terminals
- Turn signal switch puts opposite side on steady bright when turn signal is flashing
- This switch is designed for tractors or farm equipment using single filament lights (flashing & turn)



- #25-724 Turn Signal Switch
- #25-724-10 Turn Signal Switch

NOTE

Turn signal switch works alone or in combination with a tail light switch.



Solid State Electronic Flasher

- Provides steady flash rate on any load up to 12 amps
- Fully potted solid state electronics
- Short circuit protected
- Surface mount

#14-44010 Solid State Electronic Flasher

Features:

- LED solid state time flasher
- 3 wire
- 12 to 24 volt



Features:

- LED solid state flasher
- 3 wire leads
- 12 volt

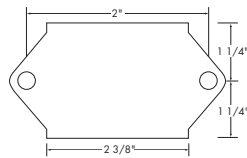

Solid State Flasher

- Overload circuit protection
- Flash load up to 5 amps
- Surface mount

#25-232 Silent Flash Solid State Flasher



Features:

- LED solid state flasher
- 2 wire leads
- 12 volt

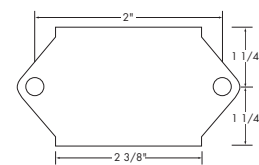

Solid State Flasher

- 2 wire hookup, no ground wire needed
- Overload circuit protection
- Flash load up to 5 amps
- Surface mount

#25-235 Carriage Flash Solid State Flasher



LED Strobe Flasher

- Turn LED light into strobe light
- 11 different flash patterns
- 4 amp load
- 9 to 20 volts
- Size: 1" x 1.5" x .75"H

#25-1244 LED Strobe Flasher



LED Strobe Flasher

- Turn LED light into a strobe light
- 12 volt input voltage
- 2 amp output
- Quad flash
- 12" wire lead

#25-1245 LED Strobe Flasher

Electromechanical Flasher

- 2 terminal flasher
- Flashes load from 2 to 20 amps

#19-40006 2 Terminal Flasher



Electromechanical Flasher

- 3 terminal flasher
- Heavy-duty contacts
- 12 volt 2 to 20 amp load

#14-44820 3 Terminal Flasher



Heavy-Duty 3 Prong Flasher

- Aluminum housing
- 12 volt

#25-230 3 Prong Flasher



2 Prong Flasher

- Aluminum housing
- 12 volt

#25-233 2 Prong Flasher



LED 2 Pin Flasher

- 1 LED to 20 amp
- 12 volt
- Needs to be grounded

#25-228 LED 2 Pin Flasher



Flasher Load Resistor

- For use when upgrading existing vehicle signals from incandescent to LED
- This will solve LED hyperflashing
- Hardware and directions included

#19-34205 Load Resistor



Carriage-Lite

Flasher Socket with Mounting Bracket

- 8" hard wire

#25-231 Flasher Socket

#25-3604 Push On Terminal for Prong Flasher



#25-3604



#25-231

Load Resistor Harness

- For use when upgrading existing vehicle signals from incandescent to LED
- In-line 50 watt 10 ohm resistor
- Provides adequate resistance for proper flasher module operation
- Terminated with one male and one female P13 plug

#13-421-491RS Resistor Harness





Black PVC Rubber Grommet



- For use with 4" round stop/turn/tail and accessory light
- For 4.5" hole
- Provides shock absorption

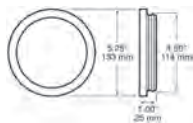

#13-426-18 4" Rubber Grommet



Black PVC Grommet



- For use with flush mount oval style lamps
- For 6.5" x 3.375" oval hole

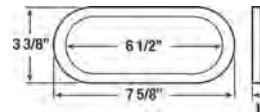

#13-421-18 Oval PVC Grommet



Black PVC Rubber Grommet



- For use with 2.5" round clearance light
- 2²⁵/₃₂" mounting hole
- Available with an open or closed back

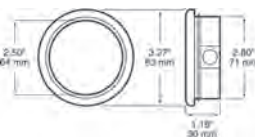

#13-143-18 Open Back Grommet
#13-144-18 Closed Back Grommet



Black PVC Rubber Grommet



- For use with 2.5" round clearance light
- 3" mounting hole
- Available with an open or closed back

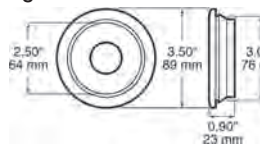

#13-142-18 Open Back Grommet
#13-143-17 Closed Back Grommet



Black PVC Rubber Grommet



- For use with 2" round clearance light
- 2⁵/₁₆" mounting hole
- Available with an open or closed back

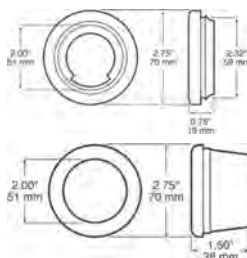

#13-146-18 Open Back Grommet
#13-146-182 Closed Back Grommet



Black PVC Rubber Grommet



- Rectangular rubber grommet
- For 3" x 5" mounting hole

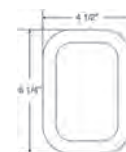

#13-450-18 Rectangular Grommet



14 Series Black Grommet

- For 3" x 2" mounting hole
- #15-14700 14 Series 3" x 2" Grommet



15 Series Black Rubber Grommet

- Open back
 - For 2" x 1" mounting hole
- #15-15702 15 Series 2" x 1" Grommet



Stainless Steel Bezel

- Designed for 3/4" light
 - Install over rubber grommets between grommet and light
- #37-CPL-1-Bezel Stainless Steel Bezel



Black Rubber Grommet

- Designed for 3/4" mounting hole
 - Chrome mounting bracket also available
- #13-177-18 3/4" Rubber Grommet
#13-176-09x 3/4" Plastic Chrome Base

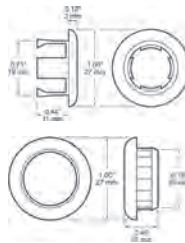

Adapter Plate

- Black plastic adapter to reduce 2" mounting hole to install 3/4" marker light
- #14-42302-3 2" x 3/4" Reducer Adapter



Adapter Plate

- Black plastic adapter to reduce 2.5" mounting hole to install 3/4" marker light
- #14-42312-3 3" x 3/4" Reducer Adapter



Rubber Grommet

- Rubber grommet for small light
 - 3/4" mounting hole
- #14-60-1084-03 3/4" Rubber Grommet



Hooded Rubber Grommet

- Visor style or hooded rubber grommet for small light
 - 3/4" mounting hole
- #14-94360 Hooded 3/4" Rubber Grommet





Material:
• Steel bracket

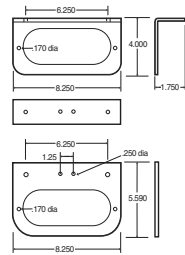

Steel Oval Mounting Bracket

- Designed for oval products with grommet or flange mounts
- Black epoxy painted steel

#15-60720 Steel Bracket Mount with Flange
#15-60722 Steel Bracket Mount without Flange



Material:
• Steel bracket

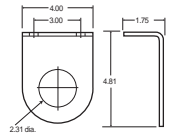

2" Steel Light Mounting Bracket

- 2" light mounting bracket
- 2⁵/₁₆" hole
- For grommet mount
- Black epoxy painted steel

#15-30728 2" Light Mounting Bracket



Material:
• Steel bracket

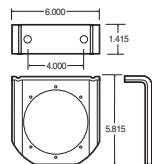

4" Steel Mounting Bracket

- 4" light mounting bracket
- Designed with 4.5" hole
- For grommet or flange mount
- Black epoxy painted steel

#15-40720 4" Light Mounting Bracket with Flange
#15-40719 4" Light Mounting Bracket without Flange



Material:
• Steel bracket

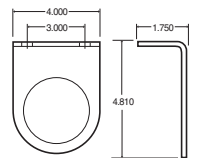

2.5" Steel Mounting Bracket

- Designed with 3" hole
- For grommet mount
- Black epoxy painted steel

#15-10730 2.5" Light Mounting Bracket



Material:
• Polished stainless steel

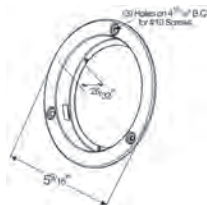

Stainless Steel Mounting Flange

- For use with 4" round lamps
- Easily snaps into place
- Mounting hole size: 4.5" diameter

#14-43253 Stainless Steel Mounting Flange



Material:
• Polished stainless steel



Stainless Steel Oval Mounting Flange

- Oval mounting flange
- Snap-in feature locks lamp in place
- Reduces chance of theft
- Attractive, improves looks

#14-43723 Stainless Steel Oval Mounting Flange



Bracket for 1 1/4" Light

- 1 3/8" mounting hole

#25-751 Regular Bracket for 1 1/4" Light
 #25-751S Narrow Mount Bracket for 1 1/4" Light

Bracket for 3/4" Light

#25-750 Regular Bracket for 3/4" Light
 #25-650 Slim Bracket for 3/4" Light



Bracket for Round Voltmeter

- 2" mounting hole

#25-444 Bracket for Round Voltmeter

Material:

- Aluminum



Oval Light Mounting Boxes

- Designed for oval products with grommets or flange mounted

#37-650 Single Oval Mounting Box
 #37-6502 Double Oval Mounting Box
 #37-6503 Triple Oval Mounting Box

Material:

- Polycarbonate



Deflector Mount

- High-impact plastic deflector mount
- 3/4" round hole
- 3" mounting hole spacing
- Surface mount
- Available in gray or black

#14-42110 Gray 3/4" Deflector Mount
 #14-42112 Black 3/4" Deflector Mount

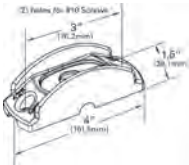

Material:

- Polycarbonate



Mounting Bracket

- 2-piece mounting bracket
- For clearance side markers or license lights
- Gray base
- Use snap-in light bracket
- 3" mounting hole spacing

#14-43780 Gray Base
 #14-94350 Light Mount

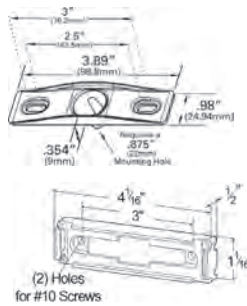

#15-00791



Chrome Base Mount

- Plastic bracket with chrome finish
- For LED or incandescent lights
- Base available in chrome or black

#15-00802 Black Base Mount
 #15-00791 Chrome Base Mount

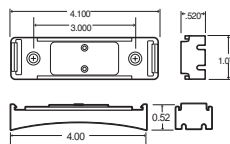
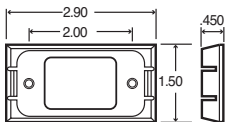

Plastic Base Mount with Plug

- Features unique plug-in design for ease of installation
- Low profile, extra strength base
- Suitable for P.C. requirements on a 45° angle
- Base available gray, black, or chrome

#15-19721 Gray Mount & Hot Wire
 #15-19726 Black Mount & Hot Wire
 #15-19739 Chrome Mount & Hot Wire



Molded 3 Prong Plug - 16 Gauge GPT Wire

- Right angle stop/turn/tail plug
- Standard PL3 plug
- For 4" round or oval light

#15-94993 Right Angle Stop/Turn/Tail Plug



Molded 2 Prong Plug - 16 Gauge GPT Wire

- Right angle single function plug
- Back up Lights

#15-94992 Right Angle Single Function Plug



Molded 3 Prong Amp Connector Plug - 16 Gauge GPT Wire

- Amp connector
- 3 wire LED lights

#15-94707 Amp Connector Stop/Turn/Tail Plug



Molded 2 Prong Clearance Light Plug - 16 Gauge GPT Wire

- Clearance light connectors
- 2 wire LED lights

#15-94862 Amp Connector Clearance Light Plug



Molded 2 Prong Right Angle Clearance Plug - 16 Gauge GTS Wire

- Clearance light 2 prong plug
- Right angle design

#15-94924 Right Angle Clearance Light Plug



Molded 2 Prong Clearance Light Plug - 16 Gauge GTS Wire

- Clearance light 2 prong plug
- Conventional plug system

#15-94902 Clearance Light Plug



Molded 2 Prong Plug - 14 Gauge Wire

- Clearance light identification harness
- 3 light wire harness
- 8" on center

#15-93943 Clearance Light Identification Harness Plug



Molded 2 Prong Plug - 16 Gauge GTS Wire

- Clearance light identification harness
- 3 light wire harness
- 6" on center
- Amp connector

#15-94892 Clearance Light Identification Harness Plug



Molded Connectors

- Molded connectors with color-coded wires
- Male connector on one end, female connector on the other end



Female End



Male End



Contacts	12" Loop	Female End	Male End
1	18-37009	18-37129	18-37119
2	18-37000	18-37130	18-37120
3	18-37001	18-37131	18-37121
4 Flat	18-37002	18-37132	18-37122
4 Square	18-37143	18-37163	18-37153
6	18-37145	18-37165	18-37155

Material:

- 16 gauge wire
- Contacts are .180 diameter
- GPT wire

Molded Bullet Connector

- .180 size
- 16 gauge 8" wire leads
- Please specify wire color: red, black, or white

- #25-570 .180 Male Bullet with 8" Wire
- #25-571 .180 Female Bullet with 8" Wire
- #25-572 .180 Double Female Bullet with 8" Wire
- #24-88105 Double Female Plug - 2 Wire

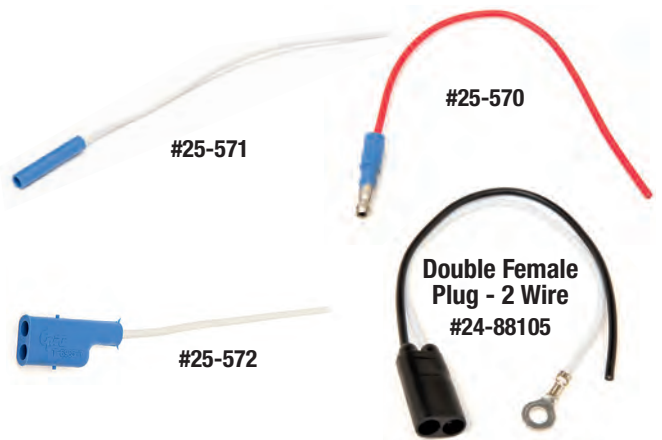

Material:

- Plastic box
- Zinc hardware

7 Terminal Junction Box

- 7 terminal junction box
- 5 access slots
- Grommets included
- 7 #10-32 studs

#48-82-1000 7 Terminal Junction Box



Material:

- Plastic box
- Zinc hardware

Junction Box

- 6 access slots
- Grommets and hardware included
- 10 #10-32 studs

- #PH1053 7 Pole Junction Box
- #PH310 10 Pole Junction Box
- #PH3320 12 Pole Junction Box
- #PH4450 18 Pole Junction Box
- #PH4518 24 Pole Junction Box



Material:

- Black ABS plastic

Project Box

- Plastic enclosures
- Screw on cover
- 6 sizes to choose from
- Textured finish

- #25-406-10F Project Box - 4.375" x 3.125" x 2" with Flange
- #25-406-12F Project Box - 4.62" x 4.62" x 2.25" with Flange
- #25-406-14F Project Box - 6.12" x 4.62" x 2.25" with Flange
- #25-406-18F Project Box - 7.62" x 4.62" x 2.25" with Flange
- #25-406-20F Project Box - 8.25" x 5" x 3" with Flange
- #25-406-22F Project Box - 10" x 6" x 3" with Flange



#25-406-20F



#4032

#4034

#4040

#4044

Project Boxes

- Plastic enclosures
- Textured finish
- Include lids

#4032	1.50"l	1.25"w	.80"h	Box with Flange
#4034	2.00"l	1.50"w	1.00"h	Box with Flange
#4036	2.00"l	2.00"w	1.50"h	Box with Flange
#4038	3.00"l	2.00"w	.90"h	Box with Flange
#4040	3.00"l	2.00"w	1.50"h	Box with Flange
#4042	3.00"l	3.00"w	1.50"h	Box with Flange
#4044	4.00"l	2.125"w	2.00"h	Box with Flange
#4052	2.40"l	1.40"w	.80"h	Box with Screw
#4054	3.20"l	1.60"w	.80"h	Box with Screw
#4056	3.00"l	2.00"w	.75"h	Box with Screw

Material:

- Black rubber

Rubber Grommets



1/8" Groove Width

Part No.	Inside Dia.	Groove Dia.	Outside Dia.	Overall Thickness
38-5150	3/16"	5/16"	7/16"	1/4"
38-5152	1/4"	3/8"	1/2"	3/32"
38-5154	3/8"	17/32"	3/4"	1/2"
38-5158	1/2"	3/4"	1"	1/2"
38-5160	5/8"	7/8"	1 1/8"	3/8"
38-5164	3/4"	1 1/16"	1 3/8"	7/16"
38-5168	1"	1 3/8"	1 3/4"	1/2"
38-5170	1 1/2"	1 3/4"	2 1/8"	1/2"
38-5172	2 1/8"	2 1/2"	2 7/8"	7/16"

3/16" Groove Width

Part No.	Inside Dia.	Groove Dia.	Outside Dia.	Overall Thickness
38-5184	1/2"	13/16"	1 1/16"	7/16"
38-5187	1"	1 3/8"	1 3/4"	9/16"
38-5188	1 1/2"	1 3/4"	2 1/8"	9/16"

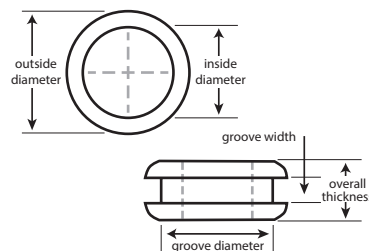

Liquid-Tight Nylon Cord Grips

- Resists salt water, weak acids, gasoline, alcohol, oil, grease, and common solvents
- Use minimum size strain relief that fits your cable

Cable Diam Min.	Cable Diam Max.	Designed to Fit Thread Size	Mounting Hole Sizes	Dome Nut Stock No.	Lock Nut Stock No.	Seal Ring Stock No.
.115	.250	1/4"	.540	18-24589	18-24610	18-24654
.181	.312	3/8"	.670	18-24591	18-24611	18-24655
.230	.546	1/2"	.875	18-24593	18-24612	18-24656
.450	.709	3/4"	1.068	18-24595	18-24613	18-24657
.590	1.00	1"	1.350	18-24597	18-24614	—



#18-24593



#18-24656



#18-24612



#17-11-700



#17-11-702

Pollak

A Stoneridge Company

Standard 7 Pole Truck Plug

- Zinc die cast housing
- Available with or without spring cable guard

#17-11-700 7 Pole Plug

#17-11-702 7 Pole Plug w/Cable Guard



Pollak

A Stoneridge Company

Standard 7 Pole Socket

- Zinc die cast housing
- 2 hole mount
- Solid pin

#17-11-720 7 Pole Solid Pin Socket



7 Pole Nylon Plug with Cable Guard

#17-11-710 7 Pole Nylon Plug w/Cable Guard

Pollak

A Stoneridge Company



Standard 7 Pole Nylon Socket

- Nylon housing with rubber boot in back
- 2 hole mount
- Split pin

#17-11-724 7 Pole Nylon Socket

Pollak

A Stoneridge Company



Socket Bracket

- Fits 7 pole socket #17-11-720
- Fits 6 pole socket #17-11-604 & #17-11-605

#17-11-771 Socket Bracket

Pollak

A Stoneridge Company



Rubber Socket Boot

- Fits #17-11-720 & #17-11-724
- Seals against dust and moisture

#17-11-761 Rubber Socket Boot



Heavy-duty Connector Cord

- Coiled truck trailer cord
- Ideal for supplying power to trailer
- 7 pole plug on each end
- 10', 12', and 15' lengths

#48-87020 12' Coil Cord 6/12, 1/10
 #48-87023 15' Coil Cord 6/12, -1/10
 #48-81-0610 10' Coil Cord 6/14 ga.
 #48-81-0612 12' Coil Cord 6/14 ga.
 #48-81-0410 10' Coil Cord 4/14 ga.
 #48-81-2212 12' Coil Cord 2/4 ga.



7RV Plug Adapter

- Black plastic housing
 - 7 pole trailer plug
 - Fits most standard vehicles
- #17-12-706 7RV Plug Adapter



7RV Socket

- Black plastic housing
 - 4 hole mounting
 - Uses #12-711V RV bracket
- #17-12-707 7RV Socket



7RV to 6 Round Adapter

- Black plastic housing
 - Adapter has auxiliary pin in center of 6 pole
- #17-12-729 7RV 6 Round Adapter



7RV to 4 Flat Adapter

- Black plastic housing
 - Converts 7RV to 4 flat connector
- #17-12-716 7RV x 4 Flat Adapter

7 Pole Plug Adapter

- Plug and socket have nylon housing
- #17-12-724 7 Way Pin to 7RV Plug Adapter
 #17-12-727 7RV Plug to 7 Round Pin



Tractor Switch Box

- Includes:
 - 6' battery wire
 - 8' wire with socket
 - Running light switch
 - Warning light switch
 - Turn signal switch
- Switch box, wire harness and lights plug together for simple installation



#25-1300 Tractor Switch Box
 #25-1310 35' Light Harness with 7 Pole Plug
 #25-1312 35' Split Harness with 7 Pole Plug



Carriage-Lite



7RV Socket Bracket

- Fits #12-707 socket
- Black epoxy coated

#17-11-711U 7RV Socket Bracket



Bracket for 7RV Receptacle

- Fits #33-40930 socket

#17-11-712U Bracket for Twist on 7RV Receptacle



Endurance - Plug Connector

- 7RV truck receptacle
- With plug connector in back

#33-40941 Endurance Receptacle - Plug



Endurance - Screw Connector

- 7RV & 5 or 4 Flat
- With screw connector in back

#33-48470 Endurance Receptacle - Screw



Endurance - Twist Mount Connector

- 7RV receptacle
- Twist mount plug in back

#33-40930 Endurance Receptacle - Twist



7RV Electrical Tester

- To test truck tail light, turn signal, back up lights, and auxiliary lights, and brakes.

#33-HEET7 7RV Electrical Tester



Electrical Tester

- 7RV truck tester
- For lights only, *not to test brake controller*

#17-12-741 Electrical Tester for Lights

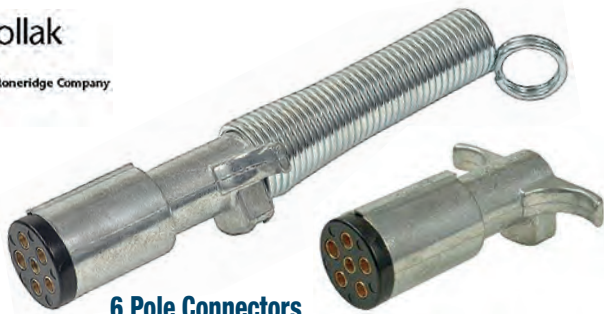

6 Pole Connectors

- 6 Pole Plug
- Zinc die cast housing
- Available with or without spring cable guard

#17-11-604 6 Pole Plug
#17-11-605 6 Pole Plug with Cable Guard



6 Pole Socket

- Zinc die cast housing
- 2 hole mount
- With rubber boot in back or die cast shell

#17-11-608 Socket with Rubber Boot
#17-11-609 Socket with Die Cast Shell
#17-11-616 Boot Only

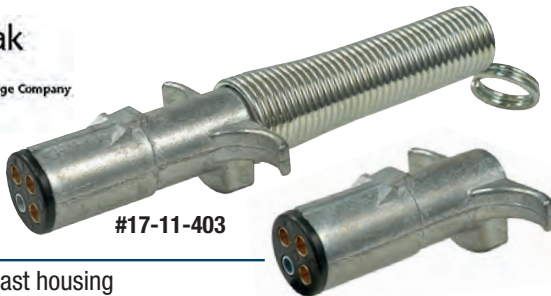

4 Pole Plug

#17-11-403

#17-11-402

- Zinc die cast housing
- Available with or without spring cable guard

#17-11-402 4 Pole Plug
#17-11-403 4 Pole Plug w/Cable Guard



4 Pole Socket

- 2 hole mount
- Die cast shell only

#17-11-404 4 Pole Socket

Socket Bracket

- Bracket for 6 pole or 4 pole socket
- 2 hole frame mounting
- Heavy gauge black zinc coating
- Fits #17-11-608, #17-11-609, #17-11-404 sockets



#17-11-627 Socket Bracket



6 Round to 4 Flat Adapter

- Black plastic housing
- Converts 6 round to 4 flat
- Quick and easy to connect

#17-12-717 6 Round x 4 Flat Adapter



Molded 4 Flat Trailer End Connector

- 12" 4-colored wire
- 16 gauge wire: white, brown, yellow, green

#18-37122 4 Flat Trailer End Connector

NOTE
For more connectors, see page 46.

Tail Light Converter

- Converts 5-wire system down to 4-wire system
- Heavy-duty, 10-amp transistors prevent premature failure
- Includes all electrical connections and installation instructions

#13-5410 Tail Light Converter



Ideal Lighting LLC 717.442.4605

Magnets

Part #	Pull	Size
#37-CP0850	35 lbs.	2 1/8" diameter
#37-CP0865	65 lbs.	2 3/4" diameter
#37-CP0808	95 lbs.	3 1/4" diameter
#37-CP0885	120 lbs.	3 7/8" diameter

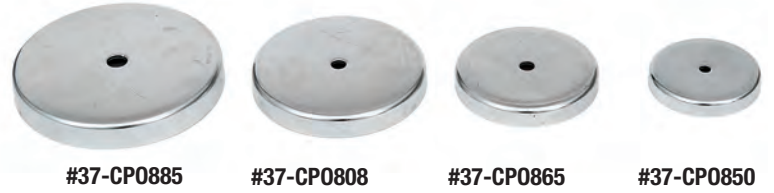

Tekonsha Breakaway Switch

- #HE-2010 Breakaway Switch
- #HE-2010A Pin & Cable Only



7RV Molded Cable

- 8 ft. of cable with 7RV plug
- #33-20041 7RV Molded Cable - 8 ft.



Breakaway Switch with Zip Cable

- #HE-2040 Breakaway Switch with Zip Cable



Red Zip Cable with Hardware

- 4 ft. cable only
- #HE-2042 Red Zip Cable with Hardware – 4 ft.



Typical Wiring Diagram 7 Pole Round Pin Style

View of wire connection side (rear side)

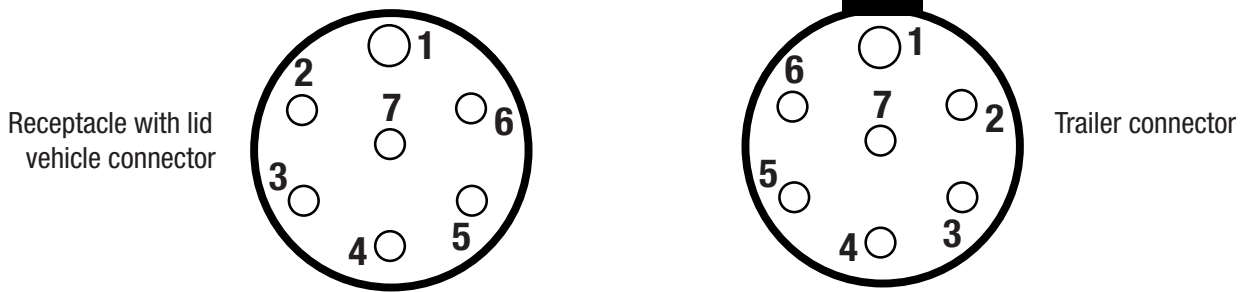

Tractor trailers with air brakes

- 1 - ground
- 2 - marker/clearance
- 3 - left turn
- 4 - brake lights
- 5 - right turn
- 6 - three bar marker, tail
- 7 - auxiliary

Note: Locate wires by function only. Color coding is not standard among all manufacturers

Farm Equipment

- 1 - ground
- 2 - work lights
- 3 - left turn
- 4 - key on auxiliary power
- 5 - right turn
- 6 - road/tail lights
- 7 - key on auxiliary power

Typical Wiring Diagram 7 RV Connectors

7 Way RV Blade Style

View of wire connection side (rear side)

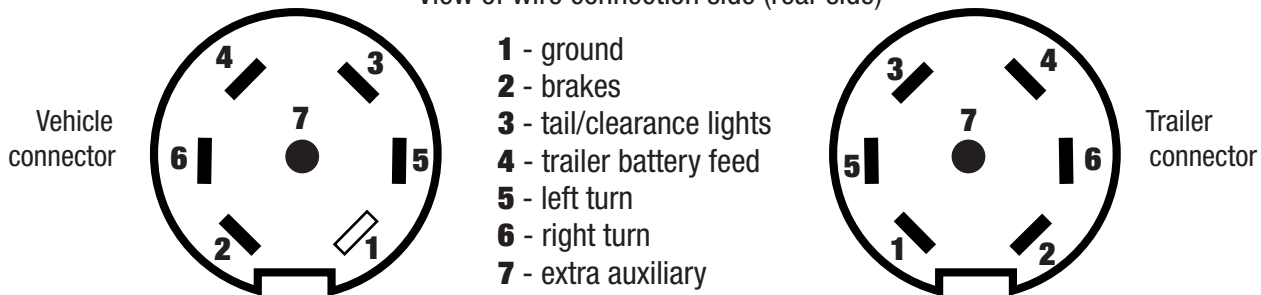

Typical Wiring Diagram 6 Round Connectors

View of wire connection side (rear side)

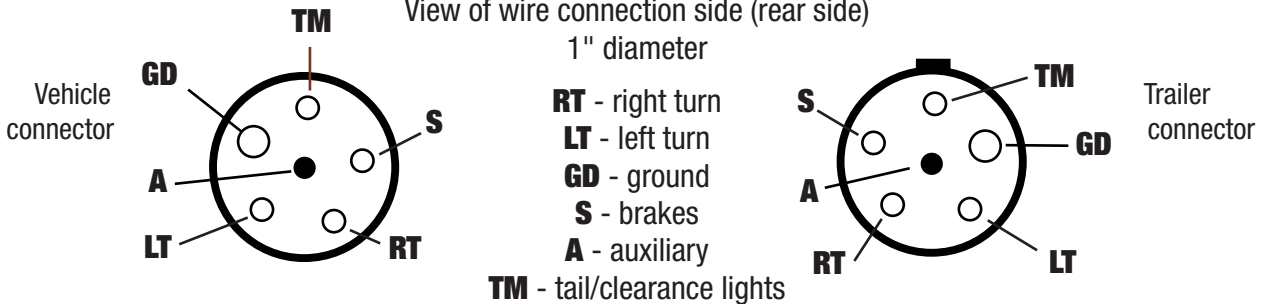

Typical Wiring Diagram 4 Way Flat Trailer Connectors

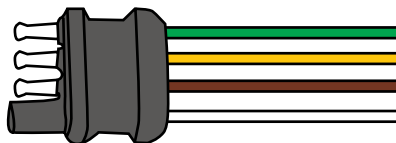

- Green** - right turn
- Yellow** - left turn
- White** - ground
- Brown** - running lights



12 Volt Socket with Clamps

- 10 foot wire

#45-CL120 12 Volt Socket with Clamps



12 Volt Fused Dual Socket Adaptor

- Plugs into 12 volt power receptacle
- Doubles a DC outlet

#45-SAC-101 Dual Socket Adaptor



Male Lighter Plug

- Fits into power points or cigarette lighter to provide 12 volt power
- 15 amp rated
- Plug has 10 amp fuse
- Interchangeable fuse

#25-979 Male Lighter Plug

#25-978 Male Lighter Plug with 8" Wire Lead



12 Volt Outlet Cigar Plug

- Compact outlet provides dependable source of power for electrical accessories using standard plug
- Spring-loaded flip cover, mounting bracket, and 12" leads rated for 8 amps
- All weather power source

#25-975 All Weather Power Source



Power Source with Cap

- One piece housing includes cap & requires .86" diameter hole
- Rated for 20 amps

#25-954 Power Source with Cap

#25-954-10 Power Source Mount



Panel Mount Breaker

- Screw connectors in back

Amps	Part #
2	W58-XC4C12A-2
5	W58-XC4C12A-5
10	W58-XC4C12A-10
15	W58-XC4C12A-15
20	W58-XC4C12A-20
25	W58-XC4C12A-25
30	W58-XC4C12A-30

Automatic Reset Circuit Breakers

- 12 Volt DC
- 90% mounting bracket



Amps	Part # Plastic Housing	Part # Metal Housing
15	17-54-215PL	17-54-215
20	17-54-220PL	17-54-220
30	17-54-230PL	17-54-230
40	17-54-240PL	17-54-240
50	17-54-250PL	17-54-250

Automatic Reset Circuit Breakers with Metal Housing

- 12 Volt DC
- Metal housing



Manual Reset Circuit Breakers

- 12-48 Volt DC
- Ranging from 30-250 amp



Amps	Part #
30	41-285030
40	41-285040
50	41-285050
60	41-285060
80	41-285080
100	41-2850100
120	41-2850120
150	41-2850150
200	17-54-875
250	17-54-876

Automatic Reset Circuit Breakers

- 30 Volt DC
- Ranging from 80-150 amp



Amps	Part #	Amps	Part #
80	18-46913	120	18-46917
100	18-46915	150	18-46919

Mid Range Circuit Breakers

- 32 Volt DC
- Ranging from 10-40 amp



Amps	Part #
10	18-46970
15	18-46971
20	18-46972
25	18-46973
30	18-46974
40	18-46975

Sealed Circuit Breakers

- Designed for applications exposed to moisture, dust and oil
- Comes with mounting bracket and 6" wire leads



Amps	Part #
20	17-54-921
30	17-54-931
40	17-54-941



ATC Circuit Breakers

- Automatic reset
- Work with fuse holder

Amps	Part #
10	18-46751
20	18-46753
30	18-46755



Inline Fuse Holder with Cover

- Holder for ATC & ATO fuses
- Weather-resistant with cover

- #18-46229 18 Gauge Fuse Holder with Cap
- #18-46236 16 Gauge Fuse Holder with Cap
- #18-46237 12 Gauge Fuse Holder with Cap
- #18-46238 10 Gauge Fuse Holder with Cap



Inline Fuse Holder

- Two 4" pigtails in 16 gauge GPT wire
- #25-948 ATC Inline Fuse Holder



Fuse Cover

- Fits #25-948 & #25-950 fuse holder
- #25-951 Fuse Cover

Inline Fuse Holder

- Two 4" pigtails in 12 gauge GPT wire
- #25-950 ATC Inline Fuse Holder



MAXI Fuse Holder

- 32V, 60 amp
- 6 gauge tinned 5" red wire leads
- #18-46022 Maxi Fuse Holder



Inline Fuse Holder

- 6" wire leads
- #18-46238 10 ga. Fuse Holder with Cap
- #18-46150 8 ga. J Case Fuse Holder
- #18-46022 6 ga. Maxi Fuse Holder



ATO / ATC Fuse Holder

- 32V, 30 amp
- 12 gauge GPT wire
- 8" leads
- #18-46032 ATO / ATC Fuse Holder



Circuit Tap – Add a Fuse

- 6" 16 gauge wire lead
- #18-36045 ATC Fuse
- #18-36044 Mini Fuse



ATO / ATC Fuse Holder Complete Assembly

- 32V, 30 amp
- 12 gauge GPT wire
- 9" leads
- #18-46047 ATO / ATC Fuse Holder Complete Assembly





ATC Fuse Panel

- With ground terminal
- Holds up to 6 fuses
- Fuses not included
- Size: 3.35" x 3.75"

#18-46060 Fuse Panel

ATC Replacement Fuses

- Standard ¼ blade type



Part # - Amp	Color	Part# - Amp	Color	Part # - Amp	Color
25-952-1	Black	25-952-5	Tan	25-952-25	Natural
25-952-2	Gray	25-952-10	Red	25-952-30	Light Green
25-952-3	Violet	25-952-15	Light Blue	25-952-40	Amber
25-952-4	Pink	25-952-20	Yellow		

Glass Type AGC Fuse

- ¼" diameter
- 1¼" long



Amps	Volts	Stock No.	Amps	Volts	Stock No.
¼	250	18-46132	8	250	18-46108
½	250	18-46133	10	250	18-46110
1	250	18-46101	15	32	18-46115
2	250	18-46102	20	32	18-46120
3	250	18-46103	25	32	18-46125
4	250	18-46104	30	32	18-46130
5	250	18-46105	40	32	18-46140
7½	250	18-46137			



Panel-mounted Fuse Holder

- For AGC fuses ¼" diameter x 1¼" long
- ¼" push-on terminals
- Mounting hole .506"
- Rated to 250 volt, 20 amps

#18-46018 Panel Mounted Fuse Holder



AMG High Amp Fuses

- Ideal for battery and alternator cable
- Bolt-down design
- Mounting hole .34" diameter, spaced 2" apart

#18-46270 100 Amp Fuse
 #18-46272 150 Amp Fuse
 #18-46274 200 Amp Fuse
 #18-46279 300 Amp Fuse



AMG High Amp Fuse Holder

- AMG fuse holder with cover
- ¼" mounting hole

#18-46038 AMG High Amp Fuse Holder



AGC In-line Fuse Holder

- Heavy-duty in-line fuse retainer
- 6" GPT wire
- Wire color may vary
- Holder rated to 250 volt DC
- 20 amp with 14 gauge wire
- 30 amp with 10 gauge wire

#38-79020 20 Amp In-line Fuse Holder
 #38-79030 30 Amp In-line Fuse Holder



In-line Fuse Holder

- 32V, 30 amp
- 10 gauge tinned 12" wire loop

#18-46238 30 Amp In-line Fuse Holder



ATC Blade Auto-Reset Fused Circuit Breaker

- Snap-off feature

Amps	Part #
5	17-54-705
10	17-54-710
15	17-54-715
20	17-54-720
25	17-54-725
30	17-54-730

MCASE® + Cartridge Fuse

- Cartridge style fuse up to 60 A with female terminals for 2.8mm male terminals
- Miniaturized footprint for optimal use of space
- Handles inrush currents



Amps	Part #	Color
15	18-46600	Gray
20	18-46601	Blue
25	18-46602	Tan
30	18-46603	Pink
40	18-46604	Green
50	18-46605	Red
60	18-46606	Yellow
Shunt	18-46607	Black

JCASE® Cartridge Style Fuses

- JCASE® provides both increased time delay and low voltage drop to protect high current circuits



Amps	Part #	Color
20	18-46590	Blue
25	18-46595	White
30	18-46591	Pink
40	18-46592	Green
50	18-46593	Red
60	18-46594	Yellow

Low Profile JCASE® Cartridge Style Fuses

- Lower overall height allows for space and weight savings



Amps	Part #	Color
20	18-46300	Blue
25	18-46305	White
30	18-46301	Pink
40	18-46302	Green
50	18-46303	Red
60	18-46304	Yellow

Maxi Fuses

- Used where a high amperage circuit is required from 20-80 amps
- Color-coded for amperage
- Provides predictable time delay characteristics and low heat dissipation



Amps	Part #	Color
20	18-46240	Yellow
25	18-46226	Gray
30	18-46241	Green
35	18-46227	Brown
40	18-46242	Orange

Amps	Part #	Color
50	18-46243	Red
60	18-46244	Blue
70	18-46245	Tan
80	18-46246	Clear

Mini Fuses

- Smaller than the standard automotive blade fuses
- Color-coded for amperage



Amps	Part #	Color
2	18-46250	Gray
3	18-46251	Violet
4	18-46252	Pink
5	18-46253	Tan
7.5	18-46254	Brown

Amps	Part #	Color
10	18-46255	Red
15	18-46256	Blue
20	18-46257	Yellow
25	18-46258	Clear
30	18-46259	Green



#25-782-28

Carling Rocker Switches

Carling rocker switches are a quality line of rocker switches. These switches are rated for 20 amps at 12 volts. Lighted LED switches are rated at 100,000 hour life, while the incandescent switch is rated at 10,000 hours. Their overall life is 50,000 to 100,000 switch cycles and they are environmentally sealed to protect against dust, moisture, and vibration. These switch styles are being used in the marine and construction industries, and have been proven to hold up under very harsh conditions. Stackable mounting brackets make for very easy installation, whether you're installing one or five switches. Available in on/off, on/off/on and in spade termination.

Rocker Switch Body

- Select the switch body
- Removable actuators are separate from switch
- Easy installation, actuators snap on to switch body



Part #	Circuit	Type	Contacts	Lighting
18-44301	on – off	SPST	2	Unlit
18-44302	mom (on) – off	SPST	2	Unlit
18-44303	on – off – on	SPDT	3	Unlit
18-44304	mom (on) – off – mom (on)	SPDT	3	Unlit
18-44305	on – off	SPST	3	1 Light
18-44306	on – off – on	SPDT	4	2 Lights
18-44325	on – off on – off	DPST	5	1 Light
18-44326	on – off – on on – off – on	DPDT	7	2 Lights
25-770	on – off	SPST	3	1 Red LED
25-782	on – off – on	SPDT	4	2 Red LEDs
25-771	on – off on – off	DPST	5	1 Red LED
25-784	on – off – on on – off – on	DPDT	7	2 Red LEDs



-20



-28

Switch Actuators

NOTE: Order switch plus actuator. Actuator part number behind switch part number. (For example, 25-782-28)

Part #	Lens Style and Color
-10	no lens
-20	1 square red lens
-22	1 square blue lens
-23	1 square blue & 1 bar lens
-24	1 square amber lens
-26	1 square green lens
-27	1 square green & 1 bar lens
-28	1 square red & 1 bar lens

Rocker Switch Accessories



#25-792



#25-788



#25-790



#25-793



#25-799

Single Mounting Panel

- Used for a single switch
- Cut-out size: .98" x 1.90"

#25-792 Single Mounting Panel

Stackable Middle

- Used where multiple switches can be installed with only one hole to cut in your panel

#25-790 Stackable Middle

Stackable End

- Cut out size for 2 units: 1.90" x 2.03" – add 1.03" for each additional unit

#25-788 Stackable End

Mounting Panel Plug

- Used to plug vacant switch hole
- Blank for #25-788, #25-790, or #25-792

#25-793 Mounting Panel Plug

Actuator Removal Tool

#25-799 Actuator Removal Tool

Toggle Switches

- 20 amps at 12 volts
- Variety of types available
- 1⁵/₃₂" mounting stem, 3⁵/₈" long
- 1¹/₁₆" chrome handle
- Screw connectors
- Available in Carling or Pollak

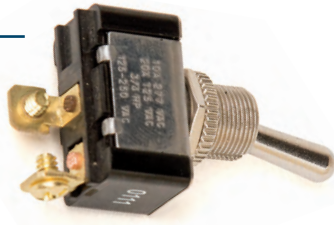

Carling

Two-Position Toggle Switch

- On – Off
 - S.P.S.T.
- #25-800



Three-Position Toggle Switch

- On – Off – On
 - S.P.D.T.
- #25-801



D.P.D.T. Toggle Switch

- On – Off – On
 - D.P.D.T.
- #25-809

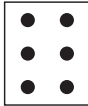

Toggle Switch

- Off – On
 - D.P.S.T.
- #25-815

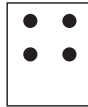

On-On Switch

- On – On
 - S.P.S.T.
- #25-821



Momentary Switches

- (On) Off
- #25-8800



- (On) Off (On)
- #25-6FC54-73



- (On) Off (On)
 - (On) Off (On)
- #25-6GM55-73



Screw Terminal Switches

- (On) Off (On)
- #17-34-575



- (On) Off (On)
 - (On) Off (On)
- #17-34-580



Sealed Stem

- On – Off
- #18-44252



- On – Off – On
- #18-44256



- On – On
- #18-44254



- On – On
- #18-44262



- On – Off – On
 - On – Off – On
- #18-44265



- On – Off
- #18-44260



Screw Terminal

- (On) Off
- #25-8800



- (On) Off (On)
- #18-44258



- (On) Off (On)
 - (On) Off (On)
- #18-44273



- Reversing Switch
- #18-44269



Momentary Sealed Stem

- (On) Off
- #25-8800



- (On) Off (On)
- #18-44258



- (On) Off (On)
 - (On) Off (On)
- #18-44273



- Reversing Switch
- #18-44269



Toggle Switches

- Heavy-duty 15 amp switch
- .250 tabs
- Slip-on connectors

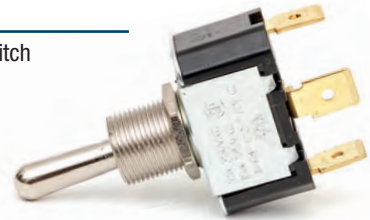

Two-Position Toggle Switch

- On – Off
 - S.P.S.T.
- #17-34-571Q



- On – Off – On
 - S.P.D.T.
- #17-34-573Q



- On – Off – On
 - On – Off – On
 - D.P.D.T.
- #18-44264



- On – Off
 - D.P.S.T.
- #18-44259

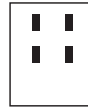

- On – On
 - D.P.S.T.
- #18-44263



Momentary Switch

- (On) – Off
 - S.P.S.T.
- #18-44240

- (On) – Off – (On)
 - D.P.D.T.
- #18-44287

- (On) – Off – (On)
 - (On) – Off – (On)
 - D.P.D.T.
- #18-44270

- (On) – Off
 - D.P.S.T.
- #18-44259

- On – On
 - D.P.S.T.
- #18-44263

Sealed Stem 1/4 Blade Type

- On – Off
- #18-44251



- On – Off – On
- #18-44257



- On – On
- #18-44255



- On – Off – On
- #18-44266



- Reversing Switch
- #18-44268



Momentary Sealed Stem 1/4 Blade Type

- (On) – Off
- #18-44240



- (On) – Off – (On)
- #18-44287



- On – (On)
- #18-44191



- (On) – Off – (On)
- #18-44272



- (On) – Off – (On)
- #18-44197



- (On) – Off – On
 - (On) – Off – On
- #18-44196



- (On) – Off – On
- #18-44195



Toggle Switch with Leads

- On – off
- Heavy-duty 15 amp switch
- Lead wire
- Compact design
- ½" mounting hole

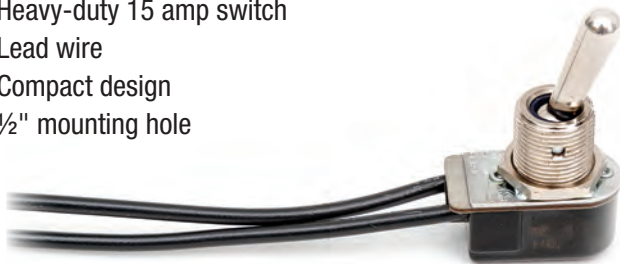

#25-762 Toggle Switch with Leads
#25-763 Sealed Toggle Switch with Leads

Heavy-duty 50 Amp Switch

- Designed for high-current applications
- #8 brass screws
- 1" chrome handle
- Mounting stem 15/32" diameter, 3/8" long



#17-34-212 On – Off 50 Amp Switch
#17-34-216 On – Off – On 50 Amp Switch
#17-34-215 Mom (On) – Off – Mom (On) 50 Amp Switch



Weather-resistant Toggle Switch

- Plastic coating with O-ring in stem
- 2 positions, on – off SPST
- Rated 20 amps at 12 volts
- 8" plastic-coated leads
- Mounting stem 15/32" diameter, 3/8" long



#17-34-571 Weather-resistant Toggle Switch



Toggle Switch Guard

- Spring-loaded design with face plate and plastic cover
- For use with on – off toggle switch

#17-34-508 Toggle Switch Guard



Toggle Switch Boot

- Fits any standard toggle switch

#25-820 Toggle Switch Boot
#17-25-371 Half Boot

Battery Disconnect Switch

- Lever operated
- 180 amps continuous capacity
- 1000 amps in rush
- On/off two stud terminals

#17-51-902 Battery Disconnect Switch
#17-51-303 Face Plate for Battery Disconnect Switch



Solenoid Switch

- 12 volt, 100 amp continuous duty
- 24 – 5/16" contact terminals
- 10 – 32 ignition & ground terminals

#17-52-307-01 Solenoid Switch



Protective Collar and Caps

- Fits #17-24-359 and #17-52-611 switches

#17-25-358 Black Rubber Boot Nut
#17-25-352 Red Rubber Boot Nut
#17-25-372 Protective Collar



Sealed Toggle Switches

These switches meet severe environmental applications for a rugged, cost-effective toggle switch. Quality construction features include a molded-in elastomer seal between the toggle lever and bushing, and between the cover and case. Flat base with silver cadmium oxide contacts with #6 screws

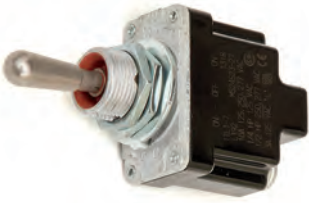

Honeywell Part #	Circuit	Type	Contacts
61-1TL1-2	on – off	SPST	2
61-1TL1-1	on – off – on	SPDT	3
61-2TL1-1	on – off – on on – off – on	DPDT	6
61-1TL1-7	mom (on) – off – mom (on)	SPDT	3
61-2TL1-7	mom (on) – off – mom (on) mom (on) – off – mom (on)	DPDT	6



#25-813-3

Switch Panels

- #28-813 Switch Panel - Stainless Steel Chrome P.C. (3) ½" Holes
- #28-813-1 Switch Panel - Stainless Steel Black P.C. (1) ½" Hole
- #28-813-2 Switch Panel - Stainless Steel Black P.C. (2) ½" Holes
- #28-813-3 Switch Panel - Stainless Steel Black P.C. (3) ½" Holes
- #28-813-4 Switch Panel - Stainless Steel Black P.C. (4) ½" Holes



Plastic Switch Holder

- ½" mounting hole
- For rocker or toggle switches

#25-833 Plastic Switch Holder



Toggle Switch Nut

- Fits most standard toggle switches

#25-824 Toggle Switch Nut



On/Off Face Plate

- #25-818 On/Off Switch Face Plate
- #25-819 Black & Red On/Off Face Plate



Hex Toggle Switch Nut

- Fits most standard toggle switches

#25-825 Hex Toggle Switch Nut



Stainless Switch Washer

- Fits any standard toggle switch

#25-725 Stainless Switch Washer



Example



#25-870B



#25-870G



#25-870R



#25-870C

Jeweled Toggle Switch Covers

- #25-870B Blue Toggle Switch Cover
- #25-870G Green Toggle Switch Cover
- #25-870R Red Toggle Switch Cover
- #25-870C Chrome-Pointed Toggle Switch Cover

Two-Way Off-On Pull Switch

- Mounting stem
7/16" diameter, 1/2" long
- Yellow switch knob

#25-803 Two-Way Off-On Pull Switch



Three-Way Off-On-On Pull Switch

- Mounting stem
7/16" diameter, 1/2" long

#25-804 Three-Way Off-On-On Pull Switch
#25-812 Yellow Knob Only

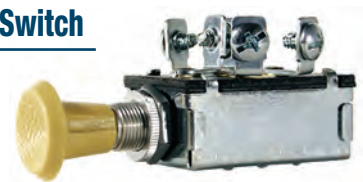

Two-Way Off-On Pull Switch

- Mounting stem
3/8" diameter, 1 1/4" long
- Chrome switch knob

#25-805 Two-Way Off-On Pull Switch



Three-Way Off-On-On Pull Switch

- Chrome switch knob
- Long-stemmed mounting stem
3/8" diameter 1 1/4" long

#25-807 Three-Way Off-On-On Pull Switch
#25-811 Chrome Knob Only



Heavy-Duty Push-Pull Switch

- 75 amp DC
- On/off 2 screw contact
- Plated knob

#17-35-306 Heavy-Duty Push-Pull Switch



Sealed Plunger Switches

- 2 positions, on/off
- Normally on, push to off

#17-52-620 Sealed Plunger Switch
#17-52-622 Mating Connector

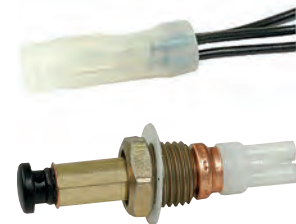

Horn Button or Momentary Switch

- Normally off, push to on
- Two #6 screw contacts
- 2 mounting holes 1/8"

#25-844 Horn Button



Door Switch

- 5 amp at 12 volts
- Screw terminals
- On when plunger is out

#17-52-616 Door Switch



Dimmer Switch

- Universal, mounts through floorboard
1/4" screw hole
- 3 #8 screw contacts

#25-846 Dimmer Switch

4 Position Key Switch

- Momentary start
- Universal, includes 2 keys
- 4 position (acc/off/on acc/start spring return to on)
- 1" shank

#17-31-610 Universal Key Switch

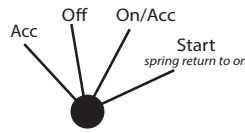

4 Position Key Switch

- Momentary start
- 4 position (acc/off/on acc/start spring return to on)
- 1" shank

#17-31-180 Various Key Switch

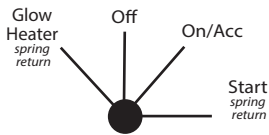
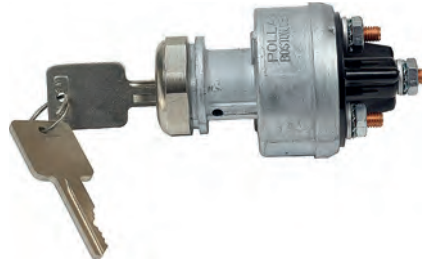

4 Position Key Switch

- For glow plug and start switch
- 1" shank

#17-31-527 Key Switch

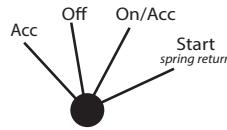

4 Position Key Switch

- 3/4" shank

#17-31-103 Key Switch

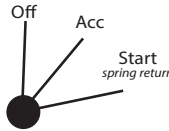

3 Position Key Switch

- 3/4" shank

#17-31-609 Key Switch

4 Position Key Switch

- Key with sealed cover
- 4 position (acc/off/ign acc/start)

#17-95060 4 Position Key Switch



3 Position Key Switch

- On/off/on switch
- 2 keys included
- Mounting stem 3/4" diameter, 3/4" long

#17-31-600 3 Position Key Switch

#61-49-187 2 Position Key Switch



Momentary Push Switch

- Normally off, push to on
- Mounting stem 5/8" diameter, 32 thread, 3/4" long
- 15 amps at 12 volts

#17-52-611 Momentary Push Switch



Momentary Push Switch

- Normally off, push to on
- Mounting stem 5/8" diameter, 32 thread
- Up to 1/4" panel thickness
- 70 amps break, 20 amps inductive load

#17-24-359 Momentary Push Switch

#17-24-360 Switch Plus Boot

Lighted Rocker Switches

- Requires 7/16" mounting hole
- On/off switch

- #25-795R Red Lighted Rocker Switch
- #25-795B Blue Lighted Rocker Switch
- #25-795G Green Lighted Rocker Switch



Round Rocker Switch

- Red LED light
- 15/16" mounting hole
- On/off switch

- #25-830 Round Rocker Switch



Lighted Oval Rocker Switch

- 7/16" mounting hole
- On/off switch

- #25-832R Red Oval Rocker Switch
- #25-832B Blue Oval Rocker Switch
- #25-832G Green Oval Rocker Switch



On/Off LED Lighted Toggle Switch

- Red LED in tip of switch
- Lights when switch is on
- 16 amp rating

- #25-802 On/Off LED Lighted Toggle Switch



Momentary or On/Off Switch

- Small switch
- 7/16" mounting hole

- #25-842 Momentary (On)/Off Switch
- #25-840 On/Off Switch



Coil Spring Limited Switch

- Robust, heavy-duty switch
- 15 amps at 12 volts DC
- Single pole, double throw with 360° movement

- #17-41-802 Coil Spring Limited Switch



Pre-made Relay Harness

- Molded 5 pole socket base
- 5 - 12" 14 gauge wires
 - Black - power
 - Red - ground
 - White - switch
 - Blue and Green - end device

- #38-73570 Relay Harness



Automotive Relays

- Push on type terminals
- SPDT
- 40 amp

- #18-75411 Relay Five Terminals - Bracket Mount
- #18-75413 Relay Five Terminals



Skirted Cube Relay

- With bracket
- 30 amp

- #18-75605 Skirted Cube Relay



Relay Connectors

- Build your own relay harnesses
- #18-75280 can be stacked together

- #18-75280 Stackable Connector
- #18-75281 Connector
- #18-31073 Terminal 1/4 Push on 16-14 Gauge
- #18-32074 Terminal 1/4 Push on 12-10 Gauge

8 Pin Relays

- 15 amp 30 volt DC
- 15 amp 120 volt AC

- #36-K10P-11D15-12 8 Pin Relay 12 Volt
- #36-K10P-11D15-24 8 Pin Relay 24 Volt

8 Pin Bases

- #36-K27E487 Base for 8 Pin Relay
- #36-K27E895 8 Pin Base for Din Rail



Automotive GPT Primary Wire

This single conductor, stranded, bare copper automotive primary wire comes insulated in a PVC jacket. It is standard for original equipment and replacement automotive applications, and for trucks and trailers. This is the most widely used general purpose wire in the industry. Smooth surface makes it ideal for pulling through loom or conduit.

Voltage: Rated at 60 volts or less
Temperature: Rated 80°C (176°F)
Specifications: SAE J1128



Stock #	Gauge	Typical Stranding	Normal Size	Standard Spool Sizes (ft.)	Weight (lbs.) per 1000'
25-308	18 ga. single	16/30	0.093	100, 500, 1000	8

Black	White	Red	Blue	Green	Yellow
Brown	Orange	Gray	Purple		

Stock #	Gauge	Typical Stranding	Normal Size	Standard Spool Sizes (ft.)	Weight (lbs.) per 1000'
25-300	16 ga. single	19/29	0.105	100, 500, 1000	11

Black	White	Red	Blue	Green	Yellow
Brown	Orange	Gray	Purple		

Stock #	Gauge	Typical Stranding	Normal Size	Standard Spool Sizes (ft.)	Weight (lbs.) per 1000'
25-302	14 ga. single	19/27	0.118	100, 500, 1000	16

Black	White	Red	Blue	Green	Yellow
Brown	Orange	Gray	Purple		

Stock #	Gauge	Typical Stranding	Normal Size	Standard Spool Sizes (ft.)	Weight (lbs.) per 1000'
25-304	12 ga. single	19/25	0.143	100, 500, 1000	24

Black	White	Red	Blue	Green	Brown	Yellow
-------	-------	-----	------	-------	-------	--------

Stock #	Gauge	Typical Stranding	Normal Size	Standard Spool Sizes (ft.)	Weight (lbs.) per 1000'
25-306	10 ga. single	19/23	0.176	100, 500, 1000	37

Black	White	Red	Brown	Yellow
-------	-------	-----	-------	--------

Stock #	Color	Gauge	Typical Stranding	Normal Size	Standard Spool Sizes (ft.)	Weight (lbs.) per 1000'
21-02558	Red	8 ga. single	19/21	0.215	100, 500, 1000	68
21-02559	White					
21-02560	Black					

Black	White	Red
-------	-------	-----

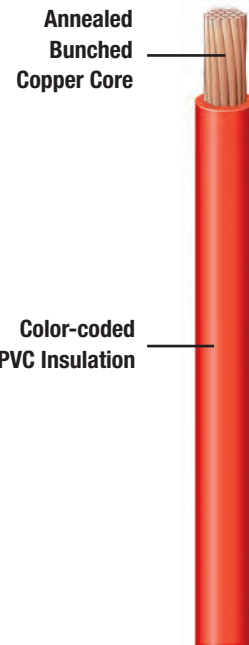

When ordering wire, specify part #, spool size and color. Example: 25-300 500' Red

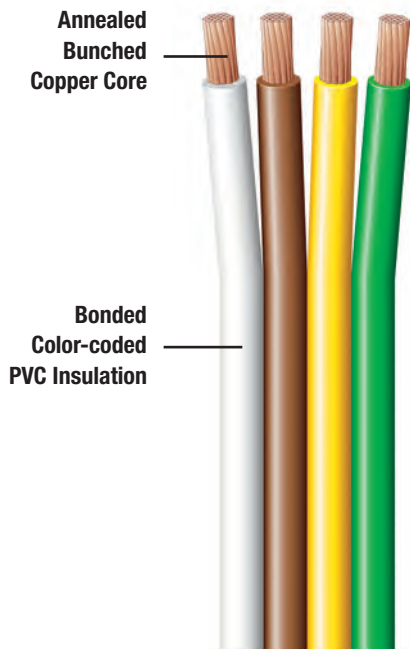

Bonded Parallel Wire

Multiple primary wires bonded with color-coding for identification purposes. Especially ideal for use in RVs, marine, and utility trailer applications. Built to stay together under the toughest operating conditions, yet easy to separate at the end of a run for final terminal connection. All-copper stranded core is highly conductive, maximizing current transfer while remaining flexible for easy installation. Customized printing is available to best meet individual needs. Contact salesperson for details.

- Voltage:** Rated at 60 volts or less
Temperature: Rated -30°C (-22°F) to 80°C (176°F)
Specifications: SAE J1128

Gauge	Part #	Description	Weight (lbs.) per 100 feet	Color
18/2 Gauge Stranding 16/30 Nominal OD .095 x .190	21-14834-ft	18-2 Bonded Parallel Wire	2	Red Black
	21-14834-100			
	21-14834-500			
16/2 Gauge Stranding 19/29 Nominal OD .102 x .204	21-14833-ft	16-2 Bonded Parallel Wire	2	Red Black
	21-14833-100			
	21-14833-500			
16/3 Gauge Stranding 19/29 Nominal OD .102 x .306	21-14836-ft	16-3 Bonded Parallel Wire	4	Brown Yellow Green
	21-14836-100			
	21-14836-500			
16/4 Gauge Stranding 19/29 Nominal OD .102 x .408	21-14839-ft	16-4 Bonded Parallel Wire	5	White Brown Yellow Green
	21-14839-100			
	21-14839-500			
14/2 Gauge Stranding 19/27 Nominal OD .117 x .234	21-14832-ft	14-2 Bonded Parallel Wire	4	Red Black
	21-14832-100			
	21-14832-500			
14/3 Gauge Stranding 19/27 Nominal OD .117 x .351	21-14835-ft	14-3 Bonded Parallel Wire	5	Brown Yellow Green
	21-14835-100			
	21-14835-500			
14/4 Gauge Stranding 19/27 Nominal OD .117 x .234	21-14838-ft	14-4 Bonded Parallel Wire	7	White Brown Yellow Green
	21-14838-100			
	21-14838-500			



Clear Jacketed PVC Wire Polarity Marked Conductors 18-2 Gauge

- Typical Stranding: 16/30
- Nominal O.D.: .092 x .190

#25-320 FT Foot of Clear Jacketed PVC Wire
 #25-320-100 100 Feet of Clear Jacketed PVC Wire
 #25-320-500 500 Feet of Clear Jacketed PVC Wire



Black Jacketed PVC Wire Polarity Marked Conductors 18-2 Gauge

#19-218105 FT Foot of Black Jacketed PVC Wire
 #19-218105-100 100 Feet of Black Jacketed PVC Wire
 #19-218105-500 500 Feet of Black Jacketed PVC Wire

Gray Jacketed PVC Wire Polarity Marked Conductors 22-2 Gauge

- Typical Stranding: 7/30
- Nominal O.D.: .060 x .120

#25-322 FT Foot of Gray Jacketed PVC Wire
 #25-322-100 100 Feet of Gray Jacketed PVC Wire
 #25-322-500 500 Feet of Gray Jacketed PVC Wire

Jacketed Duplex Wire

Two-conductor, general-purpose wires covered in a high-quality PVC jacket. Especially ideal for use in truck, bus, tractor, light-duty boats, and general service applications. Heavy-duty compact cable protects insulated conductors against weathering, chemicals, and abrasion. Color-coded conductors enable easy identification.



Voltage:
Rated at 60 volts or less

Temperature:
Rated -30°C (-22°F) to 105°C (221°F)

Specifications:
Inner wires meet SAE J1128

Black Jacket with Black and White Inner Wires			
Gauge	Part #	Description	Weight (lbs.) per 100 feet
16/2 Gauge Stranding 19/29 Nominal OD .185 x .290	25-291-ft	16-2 Jacketed Duplex Wire	4
	25-291-100		
	25-291-500		

Black Jacket with Brown and White Inner Wires			
Gauge	Part #	Description	Weight (lbs.) per 100 feet
14/2 Gauge Stranding 19/27 Nominal OD .299 x .518	25-295-ft	14-2 Jacketed Duplex Wire	5
	25-295-100		
	25-295-500		

Gray Jacket with Black and White Inner Wires			
Gauge	Part #	Description	Weight (lbs.) per 100 feet
18/2 Gauge Stranding 16/30 Nominal OD .178 x .276	21-14846-ft	18-2 Jacketed Duplex Wire	4
	21-14846-100		
	21-14846-500		
16/2 Gauge Stranding 19/29 Nominal OD .162 x .264	21-14845-ft	16-2 Jacketed Duplex Wire	4
	21-14845-100		
	21-14845-500		
16/3 Gauge Stranding 19/29 Nominal OD .162 x .366	21-14851-ft	16-3 Jacketed Triplex Wire	6
	21-14851-100		
	21-14851-500		
14/2 Gauge Stranding 19/27 Nominal OD .200 x .320	21-14342-ft	14-2 Jacketed Duplex Wire	5
	21-14342-100		
	21-14342-500		
14/3 Gauge Stranding 19/27 Nominal OD .220 x .440	21-14850-ft	14-3 Jacketed Triplex Wire	8
	21-14850-100		
	21-14850-500		
12/2 Gauge Stranding 19/25 Nominal OD .225 x .370	21-14847-ft	12-2 Jacketed Duplex Wire	7
	21-14847-100		
	21-14847-500		
10/2 Gauge Stranding 19/23 Nominal OD .257 x .434	21-14842-ft	10-2 Jacketed Duplex Wire	10
	21-14842-100		
	21-14842-500		
8/2 Gauge Stranding 19/21 Nominal OD .299 x .518	21-14841-ft	8-2 Jacketed Duplex Wire	16
	21-14841-100		
	21-14841-500		

Grey Jacket with Red and Black Inner Wires			
Gauge	Part #	Description	Weight (lbs.) per 100 feet
16/2 Gauge Stranding 19/29 Nominal OD .162 x .264	21-99234-ft	16-2 Jacketed Duplex Wire	4
	21-99234-100		
	21-99234-500		
14/2 Gauge Stranding 19/27 Nominal OD .177 x .294	21-99987-ft	14-2 Jacketed Duplex Wire	5
	21-99987-100		
	21-99987-500		
12/2 Gauge Stranding 19/25 Nominal OD .202 x .344	21-98270-ft	12-2 Jacketed Duplex Wire	6
	21-98270-100		
	21-98270-500		

Round Cable with Thin Outside Black Jacket

Please specify length when ordering.

#25-324	18-2 Gauge Round Cable w/ Thin Black Jacket
#25-292	18-3 Gauge Round Cable w/ Thin Black Jacket
#25-293	18-4 Gauge Round Cable w/ Thin Black Jacket
#25-294	18-5 Gauge Round Cable w/ Thin Black Jacket

SJO Power Cord

- Round cable with black jacket
- AC 300 volts
- For power tools, welder, AC power cord
- Available in the following gauges:
SJO 18-2, SJO 18-3, SJO 18-4
SJO 16-2, SJO 16-3, SJO 16-4
SJO 14-2, SJO 14-3, SJO 14-4
SJO 12-3, SJO 12-4
SJO 10-3, SJO 10-4
SJO 8-3, SJO 8-4

Please specify gauge and length when ordering.

SJO Power Cord

Trailer Cable Wire

General-purpose primary wires covered in a high-quality, PVC jacket. Especially designed for reliability as an integral part of the brake and safety system. Heavy-duty compact cable protects insulated conductors against weathering, chemicals, and abrasion. Color-coded conductors enable easy identification.

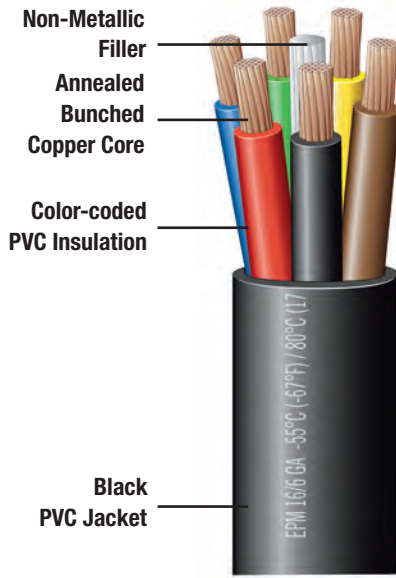

Voltage:
Rated at 60 volts or less

Temperature:
Rated -55°C (-67°F) to 80°C (176°F)

Specifications:
Inner wires meet SAE J1128

Gauge	Part #	Description	Weight (lbs.) per 100 feet	Diagram
16/4 Gauge Stranding 19/29 Nominal OD .360	21-14869-ft	16-4 Trailer Wire	12	
	21-14869-100			
	21-14869-500			
14/4 Gauge Stranding 19/27 Nominal OD .410	21-14871-ft	14-4 Trailer Wire	16	
	21-14871-100			
	21-14871-500			
16/6 Gauge Stranding 19/29 Nominal OD .425	21-14870-ft	16-6 Trailer Wire	20	
	21-14870-100			
	21-14870-500			
14/6 Gauge Stranding 19/27 Nominal OD .500	21-14872-ft	14-6 Trailer Wire	22	
	21-14872-100			
	21-14872-500			
14/7 Gauge Stranding 19/27 Nominal OD .500	21-14873-ft	14-7 Trailer Wire	35	
	21-14873-100			
	21-14873-500			
12/6 -10/1 Gauge Stranding 19/25, 19/23 Nominal OD .600	21-14876-ft	12-6/10-1 Trailer Wire	31	
	21-14876-100			
	21-14876-500			
14/4 - 12/1 - 10-2 Gauge Stranding 19/27 Nominal OD .560	21-14877-ft	14-4/12-1 Trailer Wire	27	
	21-14877-100			
	21-14877-500			
12/4 -10/2 - 8/1 Gauge Stranding 65/30 Nominal OD .690	21-14878-ft	GREEN JACKET 12-4/10-2 Trailer Wire	43	
	21-14878-100			
	21-14878-500			



Gauge	Part #	Description	Weight (lbs.) per 100 feet
6 Gauge Stranding 49/22.5 Nominal OD .330	21-14856-ft	6 Gauge Starter Cable	15
	21-14856-100		
	21-14856-500		
4 Gauge Stranding 70/22.5 Nominal OD .380	21-14858-ft	4 Gauge Starter Cable	16
	21-14858-100		
	21-14858-500		
2 Gauge Stranding 133/23 Nominal OD .450	21-14860-ft	2 Gauge Starter Cable	30
	21-14860-100		
	21-14860-500		
2/0 Gauge Stranding 133/20 Nominal OD .605	21-14866-ft	2/0 Gauge Starter Cable	55
	21-14866-100		
	21-14866-500		



Starter Cable Available in Red or Black.

When ordering wire, specify part #, and color.

Example: 21-14858-100-Red

Starter Cable Wire

Full-gauge copper conductor wire ideal for connecting battery to switch, starter, and ground. Tough, high temperature resistant PVC insulation is durable enough to handle heavy-duty automotive demands. Copper stranding is highly conductive, maximizing current transfer while remaining flexible for easy installation

Voltage:

Rated at 60 volts or less

Temperature:

Rated -50°C (-58°F) to 105°C (221°F)

Specifications:

SAE J1128

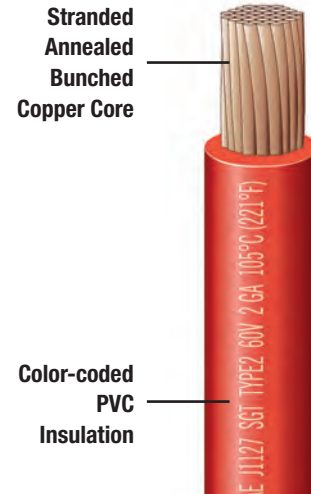

Gauge	Part #	Description	Weight (lbs.) per 100 feet	Color
2 Gauge 2 Conductor TPE Insulated Stranding 7 x 37/26 Nominal OD .450 x .960	21-14913-ft	2 Gauge Dual Booster Cable	56	Red Black
	21-14913-100			
	21-14913-500			
4 Gauge 2 Conductor PVC Insulated Stranding 7 x 19/25 Nominal OD .410 x .880	21-14914-ft	4 Gauge Dual Booster Cable	41	Black White
	21-14914-100			
	21-14914-500			
6 Gauge 2 Conductor PVC Insulated Stranding 7 x 19/27 Nominal OD .360 x .780	21-14915-ft	6 Gauge Dual Booster Cable	29	Black Orange
	21-14915-100			
	21-14915-500			
8 Gauge 2 Conductor PVC Insulated Stranding 30/23 Nominal OD .320 x .700	21-14916-ft	8 Gauge Dual Booster Cable	19	Black Yellow
	21-14916-100			
	21-14916-500			



Dual Booster Cable Wire

2, 4, 6, and 8 gauge booster cable wire with highly conductive, 100% copper stranding to maximize current transfer. TPE insulation on 2-gauge and PVC insulation on 4, 6, & 8 provides a durable barrier to protect against weathering, chemicals, and abrasion. Tangle-free cables are color-coded for easy polarity identification.

Voltage:

Rated at 60 volts or less

Temperature:

TPE to 105°C (221°F);
PVC to 80°C (176°F)

Specifications:

2, 4, & 6 gauge meets SAE J1127;
8 gauge meets J1128

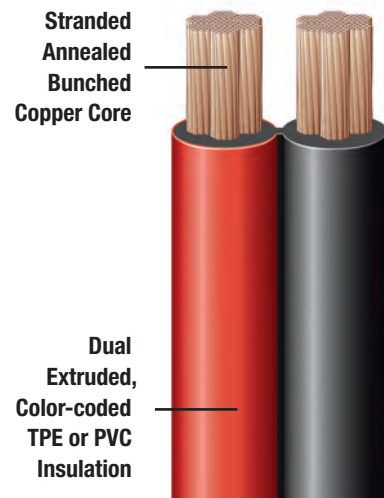

Welding Cable

An EPR cable or Ethylene Propylene Rubber that is chemically cross-linked for excellent insulation, dielectric strength, abrasion resistance, and cold-weather flexibility. Great alternative to battery cable for a wider variety of applications due to its weather-resistance, durability in heavy-duty use, high voltage rating, and insulating properties. Excellent flexibility in hot and cold temperatures for easier installation and dependable performance.



Voltage:
Rated at up to 600 volts

Temperature:
Rated -50°C (-58°F) to 105°C (221°F)



Suggested Ampacity for Welding Cable									
Gauge	50'	75'	100'	125'	150'	175'	200'	225'	250'
#4	100	100							
#3	150								
#2	200	150	100	100					
#1	250/300	200	150		100				
1/0	350	250	200	150		100	100		
2/0	400/450	300	250	200	150		100	100	
3/0	500	350/400	300	250	200	150	150		
4/0	550/600	450/500	350/400	300	250	200	200	150	150

Gauge	Part #	Description	Weight (lbs.) per 100 feet
6 Gauge Stranding 7 x 38/30 Nominal OD .320	21-04730-ft	6 Ga. Red Welding Cable	12
	21-04730-100	6 Ga. Red Welding Cable	
	21-04731-ft	6 Ga. Black Welding Cable	
	21-04731-100	6 Ga. Black Welding Cable	
4 Gauge Stranding 7 x 56/30 Nominal OD .275	21-04702-ft	4 Ga. Red Welding Cable	16
	21-04702-100	4 Ga. Red Welding Cable	
	21-04703-ft	4 Ga. Black Welding Cable	
	21-04703-100	4 Ga. Black Welding Cable	
2 Gauge Stranding 7 x 92/30 Nominal OD .440	21-04706-ft	2 Ga. Red Welding Cable	25
	21-04706-100	2 Ga. Red Welding Cable	
	21-04707-ft	2 Ga. Black Welding Cable	
	21-04707-100	2 Ga. Black Welding Cable	
1 Gauge Stranding 7 x 112/30 Nominal OD .515	21-04734-ft	1 Ga. Red Welding Cable	32
	21-04734-100	1 Ga. Red Welding Cable	
	21-04735-ft	1 Ga. Black Welding Cable	
	21-04735-100	1 Ga. Black Welding Cable	
1/0 Gauge Stranding 1026/30 Nominal OD .525	21-04715-ft	1/0 Ga. Red Welding Cable	39
	21-04715-100	1/0 Ga. Red Welding Cable	
	21-04714-ft	1/0 Ga. Black Welding Cable	
	21-04714-100	1/0 Ga. Black Welding Cable	
2/0 Gauge Stranding 19 x 66/30 Nominal OD .590	21-04718-ft	2/0 Ga. Red Welding Cable	47
	21-04718-100	2/0 Ga. Red Welding Cable	
	21-04719-ft	2/0 Ga. Black Welding Cable	
	21-04719-100	2/0 Ga. Black Welding Cable	
3/0 Gauge Stranding 1615/30 Nominal OD .635	21-04714-ft	3/0 Ga. Red Welding Cable	60
	21-04714-100	3/0 Ga. Red Welding Cable	
	21-04740-100	3/0 Ga. Black Welding Cable	
4/0 Gauge Stranding 2052/30 Nominal OD .695	21-04727-ft	4/0 Ga. Red Welding Cable	76
	21-04727-100	4/0 Ga. Red Welding Cable	
	21-04727-ft	4/0 Ga. Black Welding Cable	
	21-04727-100	4/0 Ga. Black Welding Cable	

Wire Services

- Larger roll sizes available
- Custom spooling
- Additional types of wire available
- Custom wire cutting
- Custom wire striping
- Custom wire harnesses



Call For Pricing!

Material:

- Polyolefin tubing

Features:

- 3:1 shrink ratio
- Flexible
- Adheres to wide variety of substrates
- Available in black or red
- 4' sticks or cut to size

Adhesive Lined Heat Shrinkable Tubing

Grayline AL3X is a dual wall, flexible, heat shrinkable polyolefin with a thick adhesive lining. When heated, the outer wall quickly shrinks while the adhesive liner melts and flows, forming a watertight barrier. AL3X is an excellent choice when additional adhesive or a 3:1 recovery is desired.



*Standard Length 4'
Custom Length Available*

#44-22202	1/8" Black Adhesive Line Heat Shrink Tubing
#44-3189	3/16" Black Adhesive Lined Heat Shrink Tubing
#44-3252	1/4" Black Adhesive Lined Heat Shrink Tubing
#44-3374	3/8" Black Adhesive Lined Heat Shrink Tubing
#44-3500	1/2" Black Adhesive Lined Heat Shrink Tubing
#44-3748	3/4" Black Adhesive Lined Heat Shrink Tubing
#44-3945	1" Black Adhesive Lined Heat Shrink Tubing
#44-31-575	1 1/2" Black Adhesive Lined Heat Shrink Tubing

#18-22452	1/8" Red Adhesive Lined Heat Shrink Tubing
#18-22453	3/16" Red Adhesive Lined Heat Shrink Tubing
#18-22454	1/4" Red Adhesive Lined Heat Shrink Tubing
#18-22456	3/8" Red Adhesive Lined Heat Shrink Tubing
#18-22458	1/2" Red Adhesive Lined Heat Shrink Tubing
#18-22462	3/4" Red Adhesive Lined Heat Shrink Tubing
#18-22466	1" Red Adhesive Lined Heat Shrink Tubing
#18-22469	1 1/2" Red Adhesive Lined Heat Shrink Tubing

Features:

- Adhesive lined
- 3:1 shrink ratio
- 4' pieces
- Available in black or red

Extra Heavy-Duty Shrinkable Tubing

- For battery wire and lugs

#18-22240B	Black 1/2" Extra Heavy-Duty Heat Shrink Tubing
#18-22241R	Red 1/2" Extra Heavy-Duty Heat Shrink Tubing
#18-22242B	Black 3/4" Extra Heavy-Duty Heat Shrink Tubing
#18-22243R	Red 3/4" Extra Heavy-Duty Heat Shrink Tubing
#18-22244B	Black 1" Extra Heavy-Duty Heat Shrink Tubing
#18-22245R	Red 1" Extra Heavy-Duty Heat Shrink Tubing



*Standard Length 4'
Custom Length Available*

Material:

- Polyolefin tubing

Features:

- 2:1 shrink ratio
- 4' sticks or cut to size
- Other colors available upon request

Heat Shrink Tubing

- Shrinks to half the original size

#18-22101	1/16" Black Heat Shrink Tubing
#18-22102	1/8" Black Heat Shrink Tubing
#18-22103	3/16" Black Heat Shrink Tubing
#18-22104	1/4" Black Heat Shrink Tubing
#18-22106	3/8" Black Heat Shrink Tubing
#18-22108	1/2" Black Heat Shrink Tubing
#18-22112	3/4" Black Heat Shrink Tubing
#18-22116	1" Black Heat Shrink Tubing
#18-22124	1 1/2" Black Heat Shrink Tubing
#18-22152	1/8" Red Heat Shrink Tubing
#18-22153	3/16" Red Heat Shrink Tubing
#18-22154	1/4" Red Heat Shrink Tubing
#18-22156	3/8" Red Heat Shrink Tubing
#18-22158	1/2" Red Heat Shrink Tubing
#18-22162	3/4" Red Heat Shrink Tubing
#18-22166	1" Red Heat Shrink Tubing
#18-22174	1 1/2" Red Heat Shrink Tubing

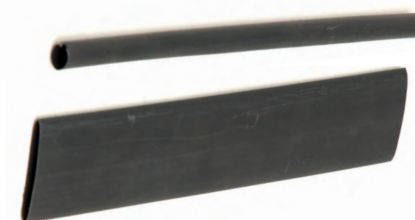

*Standard Length 4'
Custom Length Available*

Material:

- Polyethylene
- Black
- Split

Corrugated Slit Loom

- Shrinks to half the original size

#38-1923	1/4" Corrugated Slit Loom
#38-1924	3/8" Corrugated Slit Loom
#38-1926	1/2" Corrugated Slit Loom
#38-1928	5/8" Corrugated Slit Loom
#38-1929	3/4" Corrugated Slit Loom
#38-1930	1" Corrugated Slit Loom
#38-1932	1 1/4" Corrugated Slit Loom
#38-1934	1 1/2" Corrugated Slit Loom

*Standard Length 100'
or Cut to Length*



Loctite 5570 Adhesive Caulk

- Adheres to a wide range of substrates; metals, glass, nylon ABC, PVC
- Fills gaps, seals and bonds at same time
- High initial tack and short curing time
- Insulates against vibration and sound, replace rivets and mechanical fasteners
- Paintable, non-staining • Available in white

#61-1073348 Loctite Adhesive Caulk



PVC Electrical Tape



- Resists oil, water, and weather
- Insulates and protects electrical splices

#18-2100 PVC Electrical Tape

Material:

- PVC Tape
- #### Features:
- 7 mil thick
 - ¾" x 66'



Material:

- Vinyl
- #### Features:
- 7 mil thick
 - ¾" x 66'
 - 0° to 220°F

Scotch Super 33 Vinyl Electrical Tape

- Premium grade, all-weather electrical insulating tape
- Resistant to abrasion, UV rays, corrosion, moisture, alkaline solvents, oil, and most acids
- Aggressive adhesive & elastic backing; easily conforms to irregular surfaces
- Flexible & easy-to handle

#25-383 Scotch Vinyl Electrical Tape



Colored Electrical Tape



Positions	Stock No.
Brown	18-20911
Red	18-20912
Yellow	18-20914
Green	18-20915
Blue	18-20916
White	18-20919

Features:

- 7 mil thick
- ¾" x 66'

Nylon Clamps

- High quality black nylon

- #18-25050 1/8" Nylon Clamp
- #18-25051 3/16" Nylon Clamp
- #18-25052 1/4" Nylon Clamp
- #18-25053 5/16" Nylon Clamp
- #18-25054 3/8" Nylon Clamp
- #18-25056 1/2" Nylon Clamp



Nylon Clamp

Metal Cable Clamps

- Plate steel
- Durable cushion helps reduce vibration while protecting your product

- #18-25104 1/4" Metal Cable Clamp
- #18-25106 3/8" Metal Cable Clamp
- #18-25108 1/2" Metal Cable Clamp
- #18-25110 5/8" Metal Cable Clamp
- #18-25112 3/4" Metal Cable Clamp
- #18-25116 1" Metal Cable Clamp



Metal Cable Clamp

Heavy-duty Mount

- Accepts all standard ties up to 1/2" wide

- #18-21256 Cable Tie Mount with 1/4" Hole
- #18-21257 Cable Tie Mount with 3/8" Hole



Heavy-Duty Mount

Assorted Color Cable Ties

- 8" x 3/16"
- 10 different colors
- 10 qty. per color
- 100 ties per bag

#18-21530-100 Pack of Assorted Cable Ties



Nylon Cable Ties



#18-21941



#18-21993



#18-21947

Part #	Length	Appox. Width	Appox. Bundle Dia. Max.	Tensile Strength	Package Quantity
18-21941	4"	.100	0.86"	18 lb.	100
18-21841	4"	.100	2.00"	18 lb.	100
18-21993	7½"	.180	1.75"	50 lb.	100
18-21995	14½"	.80	4.00"	50 lb.	100
18-21990	8¾"	.30	2.00"	120 lb.	50
18-21947	15¼"	.30	4.00"	120 lb.	100
18-21949	29¾"	.30	8.75"	120 lb.	50
Double Clamp ties					
18-21089	19"	.50	2"	150 lb.	Per Piece

Double Row Terminal Block

- Used for general purpose electronic and electrical work
- Helps eliminate splicing
- High density circuitry can be attained to conserve panel space
- Tin-plated brass terminals and zinc-plated steel screws
- Molded from UL rated 94 VO thermoplastic
- Dimensions may vary



#18-47108

Type	Positions	Stock No.	Typical Dimensions								
			L	W	T	D	S	A	B	C	
20 amp rating 150 volt max #6-32 screws 2 mounting holes	2	18-47102	1.40	0.88	0.41	0.31	0.38	0.30	1.12	0.17	
	3	18-47103	1.78	0.88	0.41	0.31	0.38	0.30	1.50	0.17	
	4	18-47104	2.16	0.88	0.41	0.31	0.38	0.30	1.88	0.17	
	5	18-47105	2.53	0.88	0.41	0.31	0.38	0.30	2.25	0.17	
	6	18-47106	2.90	0.88	0.41	0.31	0.38	0.30	2.62	0.17	
	8	18-47108	3.66	0.88	0.41	0.31	0.38	0.30	3.38	0.17	
	10	18-47110	4.40	0.88	0.41	0.31	0.38	0.30	4.12	0.17	
30 amp rating 600 volt max #8-32 screws 3 mounting holes	4	18-47354	3.25	1.33	0.81	0.50	0.56	0.41	2.81	0.21	
	6	18-47356	4.37	1.33	0.81	0.50	0.56	0.41	3.94	0.21	
	8	18-47358	5.50	1.33	0.81	0.50	0.56	0.41	5.06	0.21	
	12	18-47362	7.75	1.33	0.81	0.50	0.56	0.41	7.31	0.21	

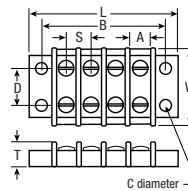

20 amp/150 volt style

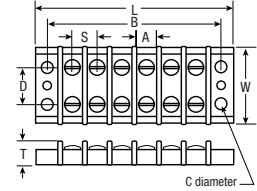

60 or 75 amp/600 volt style

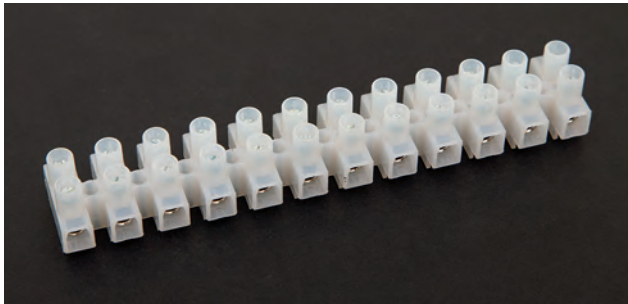

Terminal Strips

- 12 pole
- Modular design allows larger blocks to be easily cut into smaller circuit sizes
- Contacts and screws are recessed within the housing to help prevent short circuits

- #18-47159 20 Amp Terminal Strip
- #18-47158 40 Amp Terminal Strip
- #18-47160 50 Amp Terminal Strip

Part #	Amps	Volts	Length
18-47159	20	300	3.68
18-47158	40	600	5.51
18-47160	50	300	6.25



#18-47218

Terminal Strips – Stud Type

- #18-47211 Black 3/8" Single Stud Block
- #18-47213 Red 3/8" Single Stud Block
- #18-47214 4 Stud Barriers 10-24 Studs
- #18-47216 6 Stud Barriers 10-24 Studs
- #18-47218 8 Stud Barriers 10-24 Studs

Push On Tabs

- #18-37221 Quick Connect for 20 Amp
- #18-37251 Quick Connect for 30 Amp



Jumper for 30 Amp Block

- #18-37214 Jumper for 30 Amp Block
- #18-37212 Jumper for 20 Amp Block





#23-940

#23-1384



#23-945

Heavy-duty Connectors

- Provide a quick disconnect for power distribution
 - Housings mate together with same color connector for plug and receptacle
 - Different sizes for different amp ratings
 - Available in kits or just the housing alone
 - Kit includes housing plus 2 contacts
 - 50 amp to 350 amp
- | | | | |
|----------|--------------------------------------|-------------|-------------------------------------|
| #23-906 | 350 Amp Gray Housing Only | #23-920 | 120 Amp Gray Housing Only |
| #23-912 | 350 Amp Blue Housing Only | #23-1319-G4 | 4 Ga. Contact for 120 Amp Connector |
| #23-913 | 350 Amp Red Housing Only | #23-1319-G2 | 2 Ga. Contact for 120 Amp Connector |
| #23-908 | 4/0 Contact for 350 Housing | #23-945 | 175 Amp Gray Housing Only |
| #23-907 | 2/0 Contact for 350 Housing | #23-940 | 175 Amp Blue Housing Only |
| #23-992 | 50 Amp Gray Housing Only | #23-949 | 175 Amp Red Housing Only |
| #23-992R | 50 Amp Red Housing Only | #23-1384 | 4 Ga. Contact for 175 Amp Housing |
| #23-903 | 6 Ga. Contact for 50 Amp Housing | #23-1383 | 2 Ga. Contact for 175 Amp Housing |
| #23-904 | 10-12 Ga. Contact for 50 Amp Housing | #23-1384 | 1/0 Ga. Contact for 175 Amp Housing |



Post Terminal

- Heavy-duty top
- #21-05300 Universal Post Terminal
 #21-00369 Carded 10 Pack of Post Terminals



Crimpable Straight Terminals

- Tin-plated copper
- Bolt & shoulder nut included
- Resists corrosion
- Copper die casting
- Gauge and polarity stamped on terminal
- Thick wall for strong crimp

Part #	Gauge	Polarity
21-05359	4	Universal
21-05360	4	Positive
21-05361	4	Negative
21-05513	2	Positive
21-05514	2	Negative
21-05362	1	Positive
21-05363	1	Negative
21-05364	1/0	Positive
21-05365	1/0	Negative
21-05366	2/0	Positive
21-05367	2/0	Negative
21-05368	3/0	Positive
21-05369	3/0	Negative
21-05370	4/0	Positive
21-05371	4/0	Negative



Post Terminal

- Heavy-duty top post
 - Epoxy-coated terminals
- #21-05305 Red Positive Post Terminal
 #21-05306 Black Positive Post Terminal



Battery Protector Terminal Protector Boots

- Protects battery terminal
- Straight boots
- Identifies polarity



Part #	Gauge	Color
21-06100	4-6	Black
21-06101	4-6	Red
21-06102	1-2	Black
21-06103	1-2	Red
21-06104	1/0 - 2/0	Black
21-06105	1/0 - 2/0	Red



Universal Long Bolt Terminal

#21-05317 Universal Long Bolt Terminal



Stud Conversion Post

- For battery with 3/8" Stud
- #21-05768 Positive Stud Conversion Post
- #21-05769 Negative Stud Conversion Post



Battery Post for Side Terminal

- 3/8" thread
- #21-05313 Positive Battery Post
- #21-05314 Negative Battery Post



Top Post Terminal

- To 3/8" stud type
- #21-05318 Top Post Terminal



Heavy-Duty Top Post Terminal

- Fits 2 ga. to 4/0 cable
- #21-05301 Heavy-Duty Top Post Terminal



Top Post Terminal Bolt Extender

- Extender only
- #21-05418 Top Post Terminal Bolt Extender

Braided Ground Strap

- Battery post to 3/8" bolt



Part #	Gauge	Length	Part #	Gauge	Length
21-04345	4	7"	21-04337	2	7"
21-04346	4	9"	21-04338	2	9"
21-04347	4	11"	21-04339	2	11"
21-04348	4	14"	21-04340	2	14"
21-04349	4	16"	21-04341	2	16"
21-04350	4	19"	21-04342	2	19"
21-04351	4	24"	21-04343	2	24"



8 Point Power Post

- (8) #8-32 connection points carry up to 10 amps each @ 12 VDC
- Total amperage: 160 amps
- Maximum voltage: 48 VDC
- Mounting center: 2.5" / 63.5mm
- 3/8" post size
- #43-77837N02 8 Point Power Post - Red
- #43-77837N14 8 Point Power Post - Black



Pass Through Power Post

- Allows for multiple connections on either side of barrier
- Maximum voltage: 48 VDC
- Maximum amperage: 250 amps @ 12 VDC
- 3/8" post size
- #43-77237N02 Pass Through Power Post- Red
- #43-77237N14 Pass Through Power Post- Black

Single Power Point Power Distribution Post with Mounting Base

- Maximum voltage: 48 VDC
- All hardware stainless steel

*Color modifier
Red: 02
Black: 14

Example:

- #43-77010N02 (red)
- #43-77010N14 (black)



Part #*	Post Size	Amperage
#43-77010N	#10	30 amp**
#43-77025N	1/4"	150 amp**
#43-77037N	3/8"	240 amp**

**Maximum amperage @ 12 VDC

Copper Plated Lugs Part #	Gauge	Stud Hole	Plated Lugs Part #
21-05470	8	#10	28-8101
21-05472	8	1/4"	28-8141
21-05474	8	5/16"	28-8562
21-05473	8	3/8"	28-8382
21-05471	8	1/2"	28-8503
21-05466	6	#10	28-6101
21-05467	6	1/4"	28-6141
21-05468	6	5/16"	28-6562
21-05326	6	3/8"	28-6382
21-05469	6	1/2"	28-6503
21-05465	4	1/4"	28-4141
21-05328	4	5/16"	28-4562
21-05327	4	3/8"	28-4382
21-05464	4	1/2"	28-4503
21-05461	2	1/4"	28-2141
21-05462	2	5/16"	28-2561
21-05329	2	3/8"	28-2381
21-05330	2	1/2"	28-2503
21-05458	1	1/4"	28-1141
21-05459	1	5/16"	28-1561
21-05331	1	3/8"	28-1381
21-05332	1	1/2"	28-1503
21-05506	1/0	1/4"	28-10141
21-05460	1/0	5/16"	28-10561
21-05333	1/0	3/8"	28-10381
21-05334	1/0	1/2"	28-10501
21-05507	2/0	1/4"	28-20141
21-05463	2/0	5/16"	28-20561
21-05335	2/0	3/8"	28-20381
21-05336	2/0	1/2"	28-20501
21-05337	3/0	3/8"	--
21-05338	3/0	1/2"	--
21-05339	4/0	3/8"	--
21-05340	4/0	1/2"	--

Copper-Plated Lugs

- Lugs can be crimped or soldered and are stackable
- Gauge stamped on lug for easy identification
- Flared ends for easy entry
- UL Listed



Tin Plated Lugs

- Lugs can be crimped or soldered and are stackable
- Gauge stamped on lug for easy identification
- Flared ends for easy entry
- UL Listed



Extra Heavy-Duty Tin-Plated Lugs

- Thicker wall for greater strength and conductivity
- Lugs can be crimped or soldered

Part #	Gauge	Stud Hole
21-05341	4	1/4"
21-05486	4	5/16"
21-05342	4	3/8"
21-05480	1-2	5/16"
21-05343	1-2	3/8"
21-05344	1-2	1/2"

Part #	Gauge	Stud Hole
21-05477	1/0	1/4"
21-05478	1/0	5/16"
21-05345	1/0	3/8"
21-05346	1/0	1/2"
21-05482	2/0	5/16"
21-05347	2/0	3/8"

Part #	Gauge	Stud Hole
21-05349	2/0	1/2"
21-05350	3/0	3/8"
21-05351	3/0	1/2"
21-05352	4/0	3/8"
21-05352	4/0	1/2"

Solder Pellets

- Fast method for attaching battery lug to cable



Part #	Gauge	Packaging
21-05498	4	Bag of 10
21-05499	2	Bag of 10
21-05500	1	Bag of 10
21-05501	1/0	Bag of 10

Part #	Gauge	Packaging
21-05502	2/0	Bag of 10
21-05503	3/0	Bag of 10
21-05504	4/0	Bag of 10

Stainless Steel Battery Clamp

- No rusting
- Less corrosion
- 3" long



#25-250 Stainless Steel Clamp

Heavy-Duty Copper Battery Clamp

- 3" long



- #25-251 75 Amp Solid Copper Clamp
- #24-BU21CPN 100 Amp Solid Copper Clamp
- #25-BU23-2 Red Clamp Cover
- #25-BU23-0 Black Clamp Cover

Steel Battery Clamp

- Rated at 40 amps
- Heavy-duty spring clamp
- 3" long



#25-252 Steel Battery Clamp

Insulated Copper Battery Clamp

- Rated at 50 amps
- Red or black insulator



- #21-06143 Red Insulated Copper Clamp
- #21-06144 Black Insulated Copper Clamp

Clamp Insulators

- Helps identify + or -
- Added protection against shorting
- Fits #25-250, #25-251, #25-252 clamps

#25-255R Red Battery Clamp Insulator
#25-255B Black Battery Clamp Insulator



4 Gauge Battery Cable

- 3/8" eyelet to battery post

4 Gauge Part #	Color	Length
21-04153	Black	10"
21-04318	Red	10"
21-04154	Black	12"
21-04139	Red	12"
21-04155	Black	15"
21-04140	Red	15"
21-04156	Black	20"
21-04141	Red	20"

4 Gauge Part #	Color	Length
21-04157	Black	25"
21-04142	Red	25"
21-04158	Black	27"
21-04143	Red	27"
21-04159	Black	32"
21-04144	Red	32"
21-04160	Black	34"
21-04145	Red	34"

4 Gauge Part #	Color	Length
21-04161	Black	38"
21-04146	Red	38"
21-04162	Black	43"
21-04147	Red	43"
21-04163	Black	48"
21-04148	Red	48"



2 Gauge Battery Cable

- 3/8" eyelet to battery post

2 Gauge Part #	Color	Length
21-04214	Black	10"
21-04200	Red	10"
21-04215	Black	15"
21-04201	Red	15"
21-04216	Black	20"
21-04202	Red	20"

2 Gauge Part #	Color	Length
21-04217	Black	23"
21-04203	Red	23"
21-04218	Black	27"
21-04204	Red	27"
21-04220	Black	34"
21-04206	Red	34"

2 Gauge Part #	Color	Length
21-04221	Black	38"
21-04207	Red	38"
21-04222	Black	43"
21-04208	Red	43"
21-04223	Black	48"
21-04209	Red	48"

4 Gauge Battery Cable

- 3/8" eyelet to 3/8" eyelet

2 Gauge Part #	Color	Length
21-04282	Black	16"
21-04276	Red	16"
21-04283	Black	18"
21-04277	Red	18"
21-04284	Black	24"
21-04278	Red	24"

2 Gauge Part #	Color	Length
21-04285	Black	32"
21-04279	Red	32"
21-04286	Black	40"
21-04280	Red	40"
21-04287	Black	49"
21-04281	Red	49"

2 Gauge Battery Cable

- 3/8" eyelet to 3/8" eyelet

2 Gauge Part #	Color	Length
21-04294	Black	16"
21-04288	Red	16"
21-04295	Black	18"
21-04289	Red	18"
21-04296	Black	24"
21-04290	Red	24"

2 Gauge Part #	Color	Length
21-04297	Black	32"
21-04291	Red	32"
21-04298	Black	40"
21-04292	Red	40"
21-04299	Black	49"
21-04293	Red	49"



Ultra-Seal Tube Grease

- Helps keep moisture out of electronic connections
- Used to prevent rust and corrosion on electrical contacts, switches & junction boxes

#14-99170 4 oz. Ultra-Seal Tube Grease
 #15-97944 2 oz. Ultra-Seal Tube Grease



Terminal Protectors

- Extend the life of batteries and terminals
- Helps prevent corrosion
- 2 per package

#21-01253 Red & Black Terminal Protectors



#21-00323

Battery Cleaner Spray

- Penetrates, loosens, and neutralizes all acid corrosion deposits
- Helps eliminate energy loss with regular maintenance

#21-00321

#21-00323 1½ oz. Battery Cleaner Spray
 #21-00321 15 oz. Battery Cleaner Spray



#21-00322

Battery Terminal Protection Spray

- Resists battery corrosion and prolongs battery life
- Lead-free formula

#21-00320

#21-00322 ¾ oz. Battery Terminal Protection Spray
 #21-00320 10 oz. Battery Terminal Protection Spray



Battery Protection Kit

- Kit includes:
 - Terminal protectors
 - Battery cleaner brush
 - ¾ oz. can terminal protection spray
 - 1½ oz. can cleaner spray
 - Hand cleaning towelette

#21-00317 Battery Protection Kit



#21-03009



#21-03189

Battery Boxes

- Polypropylene boxes protect battery in marine and commercial applications
- Vented for safety
- Includes all hardware for installation



Part #	Group Size	Outside Dimensions (LxWxH)	Inside Dimensions (LxWxH)
21-03188	UI	10½" x 7¼" x 8½"	8¼" x 5½" x 8½"
21-03009	Marine 24	14⅞" x 9¾" x 10¾"	10⅞" x 7⅞" x 9¾"
21-03189	Marine 27/31	17" x 9¾" x 11"	13½" x 7⅞" x 10"

Material:

- 4 gauge
- 16' long
- Black and white cables



4 Gauge Booster Cables

- 100% copper conductors
- Tough PVC insulation
- Color-coded
- Tangle-free dual cable construction

#21-00170 4 Gauge Booster Cables

Material:

- 2 gauge
- 24' long
- Black and red cables



2 Gauge Booster Cables

- 100% copper conductors
- Made with welding cable
- High stranding and EPR jacket allow for greater cold weather flexibility

#21-00161 2 Gauge Booster Cables



600P Heavy-duty Battery Clamp

- 600P chrome plated steel extra heavy-duty clamp



#21-06137 Red 600P Clamp
#21-06138 Black 600P Clamp



500G PVC Coated Heavy-Duty Battery Clamp

- 500G PVC coated steel heavy-duty clamp



#21-06139 Red 500G Clamp
#21-06140 Black 500G Clamp



#21-01484



#21-04315



2/0 Gauge Top Stud Stackable Battery Cables

- Made with welding cable
- Fits up to 3/8" stud

#21-04315 7" 2/0 Gauge Black Pad Cable
#21-01484 7" 2/0 Gauge Red Pad Cable
#21-08754 9" 2/0 Gauge Black Pad Cable
#21-04316 13" 2/0 Gauge Black Pad Cable
#21-01485 13" 2/0 Gauge Red Pad Cable

Backup Beeper 12 Volt

#13-V780 97 Decibel Backup Beeper

#13-V781 102 Decibel Backup Beeper



Battery Jumper Terminals

- Provides remote mounting for battery connections
- Includes color-coded rubber cap, solid brass studs, brass hex nuts, and brass lock washer



#18-36660 Red Battery Jumper Terminal
#18-36661 Black Battery Jumper Terminal

Bracket Mount Jumper Panel

- 3/8" stud in back to fasten battery cable

#43-JB3768MK Bracket Mount Jumper Panel with Bracket



Sealed Battery – 12V AGM Deep Cycle

- 1-year warranty
- Other sizes available
- Can be shipped by UPS



#25-981

#25-988 – 12V 20Ah AGM

#25-987 – 12V 35Ah AGM

#989 – 12V 80Ah AGM

Features & Benefits

- 100% maintenance-free
- Sealed – non-spillable
- Can be mounted in any position
- Faster recharging
- Longer life

Note: These AGM batteries can take the abuse of discharge better than a flooded battery.

Sealed Battery

- 100% maintenance free
- Can be mounted in any position
- SLA regulated battery or AGM deep cycle battery available

#25-981	AGM 5AH Deep Cycle Battery	#25-989	AGM 12AH Battery
#25-984	AGM 9AH Deep Cycle Battery	#25-988	AGM 20AH Battery
		#25-987	AGM 35AH Battery

Type	Length	Width	Height	Battery Terminals
5AH	3.54"	2.76"	4.21"	.250 tabs
9AH	6.00"	2.50"	3.85"	.250 tabs
18AH	7.13"	2.99"	6.58"	bolts
35AH	7.70"	5.12"	7.01"	bolts

Note: Other Sizes Are Available.



#25-1122

#25-1124

#25-1126

#25-1129

Alkaline Batteries

#25-1122	AAAA Batteries 6 Pk.	#25-1126	C Batteries 2 Pk.
#25-1123	AAA Batteries 4 Pk.	#25-1127	D Batteries 2 Pk.
#25-1124	AA Batteries 4 Pk.	#25-1128	9 Volt Batteries 1 Pk.
#25-1125	N Batteries 6 Pk.	#25-1129	6 Volt Batteries 1 Pk.



Features:

- Plug & clamps included
- Short circuit, over currents, over voltage, reverse polarity protection

Specifications:

- Input voltage: 100-120V AC
- Output voltage: fast charge 14.4V float DC 13-6V

Battery Charger

- Three stage 12 volt charger
- Battery charger and maintainer
- For sealed, starting and deep cycle batteries

#25-936-4	4 Amp Battery Charger
#25-936-2	2 Amp Battery Charger



Specifications:

- Input voltage: 100-120V AC
- Output voltage: 13-6
- Output current: 1 amp

Battery Charger

- 1 amp battery charger and maintainer with clamps

#25-936	1 Amp 110 Battery Charger
---------	---------------------------

Digital Voltmeter

- For 12 to 24 volt systems
- Accurately measures battery voltage
- 2" mounting hole required

#21-440-12 12 Volt Digital Voltmeter
 #24-440-24 24 Volt Digital Voltmeter



Battery Condition Indicator

- Mounts with adhesive back
- Wire leads
- Easy to read

#25-918 3 Bar Battery Indicator



Material:

- ABS plastic with red digits

Current:

- Draws .01 amp at 12.6 volts



Digital Voltmeter

- Mounts in .98" x 1.74"
- Tests 3 to 30 volts
- 6" wire leads
- Easy to read by day or night

#25-924 Digital Voltmeter

Black Battery Condition Indicator

- For 12 volt systems
- Illuminates for nighttime use
- Accurately tests 12 volt battery
- 2" mounting hole required

#25-442B Black Battery Condition Indicator

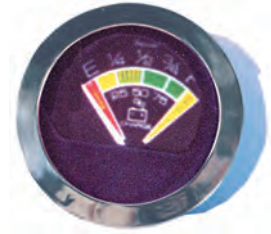

Voltmeter with Clamps

- Hand held tester
- Tests 3 to 30 volts

#25-925 Voltmeter with Clamps



Voltmeter with Box and Switch

- Surface mount
- Tests 3 to 30 volts
- On/off switch pre-wired to voltmeter
- 6" wire leads

#25-926 Voltmeter with Box and Switch



Voltmeter Mount

- L bracket
- Black P.C.
- For #25-924 voltmeter

#25-923 Voltmeter Mount

Voltmeter Mount

- Mount for #915, #440, & #442 voltmeter
- 2" hole size
- Black powder-coated

#25-444 Voltmeter Mount

Voltmeter Mount

- L bracket with switch hole
- Black P.C.
- For #25-924 voltmeter

#25-927 Voltmeter and Switch Mount
 #25-928 Voltmeter Switch



Sun Saver Charge Controller

- 12 volt controller
- Up to 10 amp load
- Battery status LED
- Screw connection

#25-930-6 6 Amp Charge Controller
 #25-930-10 10 Amp Charge Controller

Morning Star Sun Saver is the leading small solar controller for both professional and consumer applications

- Exceptional reliability
- PWM battery charging
- Potted and sealed for high quality
- Low cost



Sun Guard Charge Controller

- 12 volt controller
- 4 amp controller
- 4 – 6" wire leads

#25-931-4 4 Amp Charge Controller



ProStar Controller

- Mid-range solar controller
- 12 or 24 volt controller
- Highly accurate voltage and current display
- Displays 9 different controller statuses including: battery volts, solar amps, load amps, battery status, charging status

#61-PS-15M 15 Amp ProStar Controller
 #61-PS-30M 30 Amp ProStar Controller



TriStar Controller

- Three function controller that provides reliable solar battery charging, load control or diversion regulation
- 12 or 48 volts
- 45 amps
- Meter display optional

#61-TS-45 45 Amp TriStar Controller
 #61-M2 Meter for TriStar Controller



#62-958



#62-951

#62-955

Wire Harness

- #62-951 harness comes with MC connector and spade terminals
- #62-955 and #62-956 comes with battery, clamp and fuse

#62-951 30 Feet 12 Gauge Panel Harness
 #62-952 30 Feet 14 Gauge Panel Harness
 #62-955 6 Feet 12 Gauge Controller Wire
 #62-956 6 Feet 14 Gauge Controller Wire
 #62-958 MC4 Connector Kit
 #62-959 MC Crimping Tool

Light Source:

- LEDs
- 350 lumens

Lens:

- Polycarbonate

Battery:

- rechargeable 3 cell nickel cadmium sub c.

Dimensions:

- 8.41"L x 1.62"D

Weight:

- 12.4 oz

Stinger® LED Flashlight

- Rechargeable
- Includes 12 volt charger
- This powerful, long-range, long-running flashlight has a wide peripheral circle of bright white light coupled with an intense spot of light
- Warranty

#61-75712 Stinger® LED Flashlight

Includes: flashlight and 12 volt charger



Light Source:

- LEDs
- 260 lumens

Lens:

- Glass

Battery:

- rechargeable lithium ion

Dimensions:

- 5.3"L x 1.25"D

Weight:

- 4.6 oz

Strion® LED Flashlight

- Rechargeable
- Includes 12 volt charger
- Compact size
- Light weight, only 4.6 oz.
- 3 light output and strobe
- Black
- Warranty

#61-74004 Strion® LED Flashlight

Includes: flashlight and 12 volt charger

Note: All Streamlight items on this page feature a lifetime warranty.



Stinger® from Streamlight

The popular Stinger® from Streamlight® combines extreme power and durability in a line of compact, rechargeable flashlights. The Poly Stinger™ is about as long as your palm. Extremely bright Xenon bulbs produce up to 15,000 candlepower for up to 1 hour between charges. You can recharge Stinger® flashlights 1,000 times (about 4 years of hard professional use) before their nickel-cadmium batteries need replacing. The self-cleaning switch is side mounted and the lens is unbreakable polycarbonate. There's a spare bi-pin Xenon bulb in the tailcap.

- #25-1155 Poly Stinger®
- #25-1156 Poly Stinger® Bulb
- #25-1157 Poly Stinger® Batteries

Includes: flashlight, 12 volt charger, extra bulb, warranty



Stylus® LED Penlight

This black ultra-slim amazingly bright penlight features an LED bulb that lasts for 100,000 hours and is visible from a mile away. For hands-free lighting, clip it to your hat or clothing. Plus, you can easily switch between momentary "blink" or constant "on." The virtually indestructible Stylus is constructed from an aircraft aluminum casing and is waterproof. With these features, plus a run time of up to 60 hours, it's no wonder the Stylus is used by everyone from the avid recreationist to the serious professional.

- #25-1170-BL Black Stylus® Penlight
- #25-1170-R Red Stylus® Penlight





Stylus Pro® Flashlight

#25-1174 Stylus Pro® Flashlight
#25-1174USB Rechargeable

Light Source:

- C4® LED technology
- 350 lumens

Battery:

- Includes 2 AAA batteries

Dimensions:

- 5.3"L x 0.6"D (134 x 15 mm)



Microstream® Flashlight

#25-1173 Microstream® Flashlight
#25-1173USB Rechargeable

Light Source:

- C4® LED technology
- 250 lumens

Battery:

- Includes 1 AAA battery

Dimensions:

- 3.5"L x 0.6"D (90 x 15 mm)

Task-Light® 2AA Flashlight

- 2 modes of lighting, high and low

#25-1175 Task-Light® 2AA Flashlight



Light Source:

- 0.5W super-bright 100,000 hr. high-flux LED never needs to be replaced
- Up to 25 lumens

Battery:

- Includes 2 AA batteries

Dimensions:

- 6.85"L x 1.125"D

Run Time:

- Up to 50 hours in "low" mode

Note: All Streamlight items on this page feature a lifetime warranty.



Enduro® Headlamp

- Waterproof
- Has visor clip

#25-1159 Enduro® Headlamp



Light Source:

- 0.5 watt high-flux LED
- 14.5 lumens

Battery:

- Includes 2 AAA batteries

Run Time:

- Up to 24 hours

Weight:

- 2.75 oz.



Septor® Headlamp

- 7 LEDs
- 90° tilting head

#25-1160 Septor® Headlamp



Light Source:

- 100,000 hour life LEDs
- 50 lumens

Battery:

- Includes 3 AAA batteries

Run Time:

- Up to 150 hours

Weight:

- 4.75 oz.



**Stripper and Crimper
Combination Tools**

- Wire stripper
- Terminal crimper
- Wire cutter
- Bolt cutter

#25-390 Thomas & Betts Stripper & Crimper Combo



#25-97388 Stripper & Crimper Combo



Heavy-duty Crimper and Cutter

- Great for crimping terminals

#25-391 Heavy-duty Crimper & Cutter



Wire Stripper

- Adjustable length
- Smooth mechanism makes wire stripping a one-hand job
- Adjustable length stripper
- Replaceable blades

#25-388 Wire Stripper & Cutter
#25-388B Replacement Blade



Wire Cutter

- Heavy-duty
- 7" overall length

#25-392 Wire Cutter



Round Cable Stripper

- Strips round construction wire
- Excellent for round trailer cable

#25-387 Round Cable Stripper



Heavy-duty Wire Stripper

- Heavy-duty wire stripper/crimper
- Adjustable wire strip length
- Strips 26 through 10 gauge wire
- Includes wire cutter and terminal crimp

#25-394 Heavy-duty Wire Strippers



Self-adjusting Wire Stripper

- 20 ga. to 10 ga.

#52-CP-367A Self-adjusting Wire Stripper



Crimping Tool

- Crimps 22-10 gauge PVC, nylon, heat shrink, uninsulated terminals
- Sure grip vinyl handles for safety
- Ratchet style with safety release
- Ergonomic handle for easy use
- Ratchet mechanism to assure complete crimp every time

#25-389 Crimping Tool



Ratchet Crimping Tool

- 12-10 ga., 8 ga., 6 ga., 4 ga

#52-CP-353 Ratchet Crimping Tool



Heavy-Duty Crimping Tool

- 8 ga. to 4/0 lugs.

#52-300-107 Heavy-Duty Crimping Tool



Battery Cable Cutter

- Cuts battery cable up to 2/0 gauge
- Insulated grips

#21-05408 Battery Cable Cutter

Battery Lug Crimping Tool

- Economically priced
- Use with a hammer for a quick crimp
- Handles terminals from 8-4/0 gauge

#21-05410 Hammer Crimper



Battery Lug Crimping Tool

- Light-duty crimping tool
- Crimps battery lugs from 8-1 gauge

#21-05434 Battery Lug Crimping Tool



Battery Lug Crimping Tool

- Heavy-duty crimping tool
- Crimps battery lugs from 8-4/0 gauge

#21-05409 Battery Lug Crimping Tool



Heat Shrink Terminal Crimping Tool

- Ratchet style tool properly crimps heat shrink terminals
- Specially designed die ensures a clean crimp that protects the heat shrink jacket from over-crimping

#48-83-6519 Heat Shrink Terminal Crimping Tool



Heavy-duty Crimper

- Use to crimp right angle terminal or flag terminal
- Special jaws hold right angle terminal in place until terminals are crimped

#18-495 Heavy-duty Crimper



Circuit Tester

- Tests all 12 volt systems

#25-393 Circuit Tester



Cable Tie Tension Tool

- Tightens & cuts cable ties
- Adjustable tension

#25-395 Cable Tie Tension Tool



Soldering Station

- Adjustable solder station
- Temperature range 100-800 ° F
- Replaceable tips
- Input voltage 110V AC

#25-1630 Soldering Station

#25-1632 Replaceable Tip

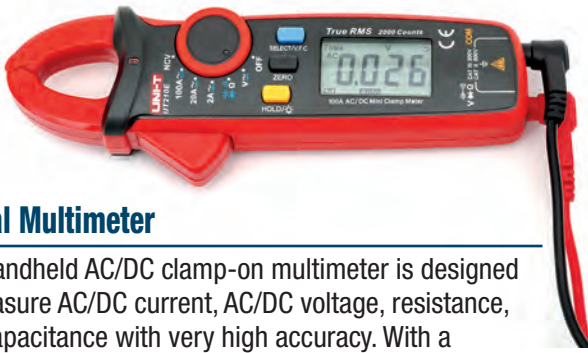

Digital Multimeter

This handheld AC/DC clamp-on multimeter is designed to measure AC/DC current, AC/DC voltage, resistance, and capacitance with very high accuracy. With a convenient clamp design, you can easily clamp it over any wire and quickly get an accurate amperage reading. The tough ABS construction is durable for long life.

#25-399 Digital Multimeter

Digital Multimeter

- Autoranging meter features a wide range of measurement
- Measures AC/DC voltage and current, ohms, diode check and transistor
- Includes test leads, standard 9 volt battery and owners manual

#25-397 Digital Multimeter



Master Butane Torch

- Microtorch
- 60 minute continuous run time

#18-541 Master Butane Torch



Pro Butane Torch

- State-of-the-art waterproof piezo electronic ignition system
- Up to 90 minutes use on each filling
- Powerful wind-resistant flame
- Compact size with ergonomic grip
- Child-resistant ignition for safety
- Easily refilled with any brand of butane gas
- Flame adjustment for any size job

#61-94902 Pro Butane Torch



Bernzomatic® Butane Torch

- Micro torch
- Solder tip
- Hot blower
- Self standing
- Has solder tip option & heat shrink blower

#25-396 Bernzomatic® Butane Torch



Butane Fuel

- 5.82 oz

#25-377 5.82 oz Butane Fuel



Rosin-core Solder

- For industrial or hobbyist use
- 1 lb.
- Precise 60/40 lead/tin formula
- .062 diameter

#25-398 Rosin-core Solder



Battery Hydrometer

- Accurate test for specific gravity
- Test for weak or bad cells

#25-447 Battery Hydrometer



Ring Terminals

These terminals provide a variety of design features assuring consistent, reliable performance and easy installation.

Insulator Color Coding

	22-18 & 8 gauge
	16-14 & 6 gauge
	12-10 & 4 gauge



#28-10020BZ #28-50030 #28-50040N #28-40020

Wire Size	Stud Size	Vinyl IN	Non IN	Nylon	Heat-Shrinkable
22-18	6	28-50020	28-10020BZ	28-50020N	28-40020
	8	28-50030	28-10030BZ	28-50030N	28-40030
	10	28-50040	28-10040BZ	28-50040N	28-40040
	1/4	18-30504			
	5/16	18-30505			
	3/8	18-30506			



#28-50090 #28-10090BZ #28-50100N #28-40090

Wire Size	Stud Size	Vinyl IN	Non IN	Nylon	Heat-Shrinkable
16-14	6	28-50086	28-10086BZ	28-50086N	28-40086
	8	28-50090	28-10090BZ	28-50090N	28-40090
	10	28-50100	28-10100BZ	28-50100N	28-40100
	1/4	28-50101	28-10101BZ	28-50101N	28-40101
	5/16	28-50102	28-10102BZ	28-50102N	28-40102
	3/8	28-50103	28-10103BZ	28-50103N	28-40103
	1/2	28-50104	28-10104BZ		28-40104



#28-50220 #28-10230BZ #28-50230N #28-40220

Wire Size	Stud Size	Vinyl IN	Non IN	Nylon	Heat-Shrinkable
12-10	6	28-50210	28-10210BZ	28-50210N	28-40210
	8	28-50220	28-10220BZ	28-50220N	28-40220
	10	28-50230	28-10230BZ	28-50230N	28-40230
	1/4	28-50240	28-10240BZ	28-50240N	28-40240
	5/16	28-50250	28-10250BZ	28-50250N	28-40250
	3/8	28-50260	28-10260BZ	28-50260N	28-40260
	1/2	28-50233	28-10233BZ		28-40233

We Offer 4 Different Types of Terminals

- **Non-Insulated Terminals** – bare brazen seam tin-plated copper terminals can be crimped or soldered
- **Vinyl-Insulated Terminals** – with funnel entry for easy wire insertion
- **Nylon-Insulated Terminals** – with funnel entry for easy wire insertion, easy to crimp and inspect
- **Heat-Shrinkable Terminals** – provide a sealed connection, insulate, seal and protect joints from abrasion, water, salt, and other corrosive elements

INSTALLATION PROCEDURE:

Funnel Barrel Feature provides an excellent electrical and mechanical connection:

1. Funnel design guides wire into position.
2. No wire strand hang-up as the wire is inserted, giving a fast, positive installation.
3. Wire is in place, ready for crimping.

For maximum crimping performance, barrel of connector must be properly indexed in the crimp tool station.

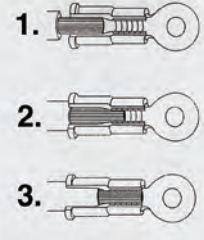

Correct crimping is important to assure a strong connection.

Insulated Terminals & Connectors

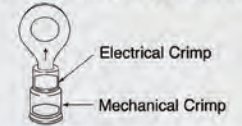

Non-Insulated Terminals & Connectors

Indent should be opposite the barrel seam.



#28-50610 #28-10612

Wire Size	Stud Size	Vinyl IN	Non IN	Nylon
8	8-10	28-50610	28-10610	28-50610N
	1/4	28-50611	28-10611	28-50611N
	5/16	28-50612	28-10612	28-50612N
	3/8	28-50613	28-10613	28-50613N



#28-50617 #28-10616

Wire Size	Stud Size	Vinyl IN	Non IN	Nylon
6	8-10	28-50615	28-10615	28-50615N
	1/4	28-50616	28-10616	28-50616N
	5/16	28-50617	28-10617	28-50617N
	3/8	28-50618	28-10618	28-50618N

Snap Spade Terminals



Wire Size	Stud Size	Non IN	Vinyl IN	Nylon	Heat-Shrinkable
22-18	6	28-10051BZ	28-50051	28-50051N	28-40051
	8	28-10061BZ	28-50061	28-50061N	28-40061
	10	28-10071BZ	28-50071	28-50071N	28-40071
16-14	6	28-10141BZ	28-50141	28-50141N	28-40141
	8	28-10151BZ	28-50151	28-50151N	28-40151
	10	28-10161BZ	28-50161	28-50161N	28-40161
12-10	6	28-10271BZ	28-50271	28-50271N	28-40271
	8	28-10281BZ	28-50281	28-50281N	28-40281
	10	28-10291BZ	28-50291	28-50291N	28-40291

Butt Connectors



Wire Size	Vinyl IN	Non IN	Nylon	Heat-Shrinkable
26-24		28-12403		
22-18	28-20080	28-10083	28-20081	28-20082
16-14	28-20170	28-10173	28-20171	28-20172
12-10	28-20310	28-10313	28-20311	28-20312
8	28-20624	28-10624		28-40624
6	28-20625	28-10625		

Step Down Butt Connectors



Wire Size	Non IN	Vinyl IN	Nylon	Heat-Shrinkable
22-18 – 16-24	28-10316	28-20316		28-40316
16-14 – 12-10	28-10317	28-20317		28-40317
12-10 – 8	28-10318	28-20318		28-40318

Three-Way Connectors



Wire Size	Vinyl IN	Nylon	Heat-Shrinkable
22-18	28-50400	28-50400N	28-40400
16-14	28-50410	28-50410N	28-40410
12-10	28-50420	28-50420N	28-40420

Wire Caps



Color	Wire Range	Part Number
Gray	22-16	18-37071
Blue	22-14	18-37072
Orange	22-14	18-37073
Yellow	18-10	18-37074
Red	18-10	18-37075

Closed End Connectors

- Crimp end connectors
- Nylon insulation



Typical Wire Range	Part Number
22-20	28-37024
18-16	28-37021
16-14	28-37020
12-10	28-37025

Four-Way Connectors



Wire Size	Vinyl IN	Nylon	Heat-Shrinkable
22-18	28-50430	28-50430N	28-40430
16-14	28-50440	28-50440N	28-40440
12-10	28-50450	28-50450N	28-40450

Male Bullet Connectors



Wire Size	Size	Bare	Vinyl	Nylon
22-18	.156	28-10284	28-20284	
	.180	28-30067	28-20784	
16-14	.156	28-31061	28-20184	
	.180	28-31067	28-20684	

Female Bullet Connectors



Wire Size	Size	Bare	Vinyl	Nylon
22-18	.156		28-20285	
	.180		28-20785	
16-14	.156		28-20185	
	.180		28-20685	

Fully Nylon Insulated Disconnects



Wire Size	Tab Size	Nylon Male	Nylon Female	Heat Shrink Male	Heat Shrink Female
22-18	.187 x .020	18-30550	18-30518		
	.250 x .032	18-20178	18-20179	28-44178	28-44179
16-14	.187 x .020	18-31550	18-31518		
	.250 x .032	28-50208	28-50209	28-44182	28-44183
12-10	.250 x .032	28-50212	28-50213	28-40212	28-40213

Fully Nylon Insulated Female Flag

Wire Size	Tab Size	Part Number
22-18	.250 x .032	28-20188
16-14	.250 x .032	28-20189
12-10	.250 x .032	28-20190



Insulated Male and Female .250 Nylon Connector

Wire Size	Tab Size	Nylon	Vinyl
16-14	.250 x .032	28-20663N	28-20663



Female Quick Disconnects



Wire Size	Tab Size	Bare Butted Seam	Vinyl Insulated	3 Piece Nylon	Heat-Shrinkable
22-18	.110 x .020		28-20191		
	.187 x .020		28-20192	28-30192	
	.250 x .032	28-10176	28-50176	28-30176	28-40176
16-14	.110 x .020		28-20194		
	.187 x .020		28-20195	28-30195	
	.250 x .032	28-10180	28-50180	28-30180	28-40180
12-10	.250 x .032	28-10187	28-50187	28-50187N	28-40187
	.375 x .032		28-20166		

Male Quick Disconnects



Wire Size	Tab Size	Bare Butted Seam	Vinyl Insulated	3 Piece Nylon	Heat-Shrinkable
22-18	.110 x .020		28-20088		
	.187 x .020	28-10197	28-20197		
	.250 x .032	28-10177	28-50177	28-50177N	28-40177
16-14	.110 x .020		28-20089		
	.187 x .020	28-10198	28-20198		
	.250 x .032	28-10181	28-50181	28-50181N	28-40198
12-10	.250 x .032	28-10186	28-50186	28-50186N	28-40186

T-Tap Connector

- Make a quick mid-span connection with a T-Tap connector
- Simply insert the wire and crimp down with pliers
- The mating connector is then snapped into place on the T-Tap

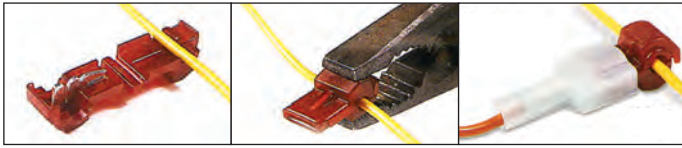

#18-31512



#18-30572 #18-31572 #18-32572

Wire Size	Part Number	Mating Connector
22-18	18-30572	18-30512
16-14	18-31572	18-31512
12	18-32572	18-32514



Wire Size	Part Number
22-18	18-30562
16-14	18-31562
12-10	18-32562

Splicer

- Used for quick connections with no wire stripping
 - 1 Insert both wires
 - 2 Squeeze down on the metal
 - 3 Snap the cover in place



Wire Size	Part Number
16-14	18-31762

Splicer

- Moisture-resistant
- Provides an economically sealed contact
- Gel filling provides moisture-resistant barrier



Wire Size	Part Number
22-14	18-37041

Electrical Pigtail Connectors

- Accepts three 22-14 gauge wires
- No wire stripping is required, simply press top down with pliers

Dual Wall – Flexible, Adhesive-Lined Heat Shrink Tubing Kit – 3:1 Shrink Ratio

- 50, 6" black flexible dual wall heat shrink pieces
- 6 compartment re-closable box
- Re-order chart on inside cover

#44-250 3:1 Heat Shrink Tubing Kit



#44-250 Kit Contents		
Part Number	Size	Quantity
44-3189	3/16"	16
44-3252	1/4"	20
44-3374	3/8"	6
44-3500	1/2"	6
44-3748	3/4"	2

Copper Lug Assortment Kit

- Includes 235 of the most popular automotive and heavy-duty copper tube lugs
- Provides superior conductivity
- Can be crimped or soldered
- 24 compartment re-closable box
- Re-order chart on inside cover

#25-2506 Copper Lugs



#25-240 6-210 Kit Contents			
Copper Plated Lug Part #	Gauge	Stud Hole	Qty.
21-05467	6	1/4"	10
21-05468	6	5/16"	20
21-05326	6	3/8"	10
21-05469	6	1/2"	5
21-05465	4	1/4"	10
21-05328	4	5/16"	20
21-05327	4	3/8"	10
21-05464	4	1/2"	5
21-05461	2	1/4"	10
21-05462	2	5/16"	20
21-05329	2	3/8"	10

#25-240 6-210 Kit Contents			
Copper Plated Lug Part #	Gauge	Stud Hole	Qty.
21-05330	2	1/2"	5
21-05458	1	1/4"	10
21-05459	1	5/16"	20
21-05331	1	3/8"	10
21-05332	1	1/2"	5
21-05506	1/0	1/4"	10
21-05460	1/0	5/16"	10
21-05333	1/0	3/8"	10
21-05334	1/0	1/2"	5
21-05463	2/0	5/16"	10
21-05335	2/0	3/8"	10

Plastic Compartment Boxes

These high strength, oil resistant, polypropylene, clear plastic boxes are ideal for organizing and storing small parts. Tight fitting cover keeps out dust, and remains locked open in the up position. Choose fixed compartment sizes or choose the adjustable type and arrange the dividers to fit your requirements. Optional steel racks hold up to 5 boxes for an efficient storage unit.

- #25-3620 Rack Unit
- #25-3622 6 compartment - 2 $\frac{1}{16}$ " x 8 $\frac{1}{2}$ "
- #25-3624 12 compartment - 2 $\frac{1}{16}$ " x 4 $\frac{1}{4}$ "
- #25-3626 16 compartment - 3 $\frac{1}{8}$ " x 2 $\frac{1}{16}$ "
- #25-3628 up to 24 compartment - adjustable
- #25-3627 24 compartment fixed - 2" x 2"



#25-3624

Note: Terminals do not come with box.

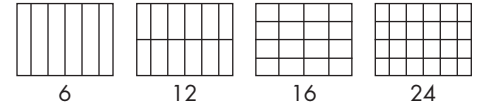

Metal Compartment Boxes & Racks

- By Durham Mfg.
- 18"w x 12"d x 3"h
- Durable gray powder-coat finish

- #40-102-95 24 Compartment Box
- #40-109-95 21 Compartment Box
- #40-111-95 20 Compartment Box
- #40-113-95 16 Compartment Box
- #40-115-95 12 Compartment Box
- #40-117-95 6 Compartment Box
- #40-119-95 Adjustable Compartment Box
- #40-120-95 9 Extra Dividers For #40-119-95
- #40-312 Locking Hinge



#40-102-95



#40-113-95



#40-119-95 Box with adjustable compartments

Slide Racks & Base

Features

- Sturdy construction
- Easy glide slides
- Boxes can easily be removed
- Holds 2 or 4 compartment boxes
- Non bearing



#40-303-95







- #40-302-95 Rack - Holds 2 Boxes
- #40-303-95 Rack - Holds 4 Boxes
- #40-304-95 Rack Base
- #40-303B-15 Rack With Bearing Slides - Holds 4 Boxes
- #40-310B-95 Rack Size 20" x 12 $\frac{1}{2}$ " x 15"

Heavy-Duty Bearing Slide Rack Features

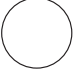
- Sturdy construction
- Slides can be replaced
- Positive closure feature keeps trays from sliding out unintentionally
- Rack size 20 $\frac{3}{8}$ " x 15 $\frac{3}{4}$ " x 14 $\frac{1}{8}$ "



#40-303B-15

HEAVY-DUTY TRUCK 7-POLE CONNECTORS			
Number	Color		Circuits
1	White		Ground Return
2	Black		Clearance, Side Marker, and Identification Lamps
3	Yellow		Left Turn & Hazard Signal
4	Red		Stop Lamps & Anti-Lock Devices
5	Green		Right Turn Signal & Hazard Signal
6	Brown		Tail, Rear Clearance, Marker, and License Lamps
7	Blue		Auxiliary Circuit/ABS

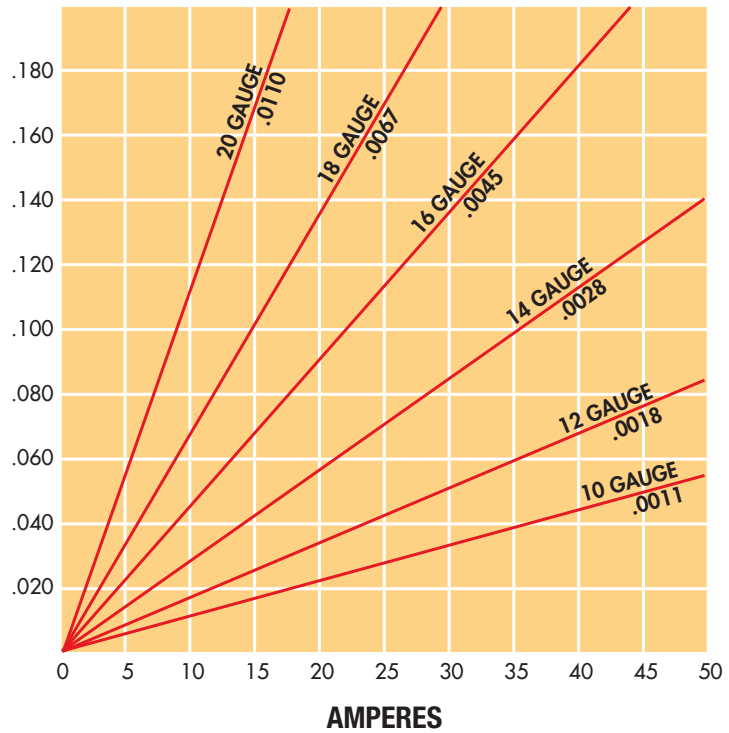

WIRE SIZE CHART											
For a 12 Volt System	For a 6 Volt System	Length of Wire (Most Distant Light)									
		10'	20'	30'	40'	50'	60'	70'	80'	90'	100'
Load in Amps	Load in Amps	Wire Gauge	Wire Gauge	Wire Gauge	Wire Gauge	Wire Gauge	Wire Gauge	Wire Gauge	Wire Gauge	Wire Gauge	Wire Gauge
1.0	0.5	18	18	18	18	18	18	18	18	18	18
1.5	0.75	18	18	18	18	18	18	18	18	18	18
2.0	1.0	18	18	18	18	18	18	18	16	16	16
3.0	1.5	18	18	18	18	18	16	16	16	14	14
4.0	2.0	18	18	18	16	16	16	14	14	14	12
5.0	2.5	18	18	18	16	14	14	14	12	12	12
6.0	3.0	18	18	16	16	14	14	12	12	12	12
7.0	3.5	18	18	16	14	14	12	12	12	12	10
8.0	4.0	18	16	16	14	12	12	12	10	10	10
10.0	5.0	18	16	14	12	12	12	10	10	10	10
11.0	5.5	18	16	14	12	12	10	10	10	10	8
12.0	6.0	18	16	14	12	12	10	10	10	8	8
15.0	7.5	18	14	12	12	10	10	10	8	8	8
18.0	9.0	16	14	12	10	10	8	8	8	8	8
20.0	10.0	16	16	12	12	10	10	8	8	8	8

TEMPERATURE CHART			
Cable Size	Maximum Current Carrying Capacity (For 12 Volts at Listed Temperatures)		
	120° F	125° F	150° F
20 Gauge	15 Amps	13 Amps	9 Amps
18 Gauge	18 Amps	15 Amps	11 Amps
16 Gauge	22 Amps	19 Amps	14 Amps
14 Gauge	27 Amps	23 Amps	17 Amps
12 Gauge	40 Amps	32 Amps	24 Amps
10 Gauge	50 Amps	42 Amps	31 Amps

Voltage Reference Chart			
Voltage	Specific Gravity	State of Charge	Depth of Discharge
12.66	1.265	100%	0%
12.45	1.225	75%	25%
12.25	1.190	50%	50%
12.05	1.145	25%	75%
11.90	1.100	0%	100%

Ideal Lighting LLC

TRAILER LIGHTING AND ACCESSORIES

Welcome to our wholesale trailer lighting and accessory catalog. We are a supplier of lighting, switches, wire, terminals, fuses, breakers and much more for trailer, agricultural, and heavy-duty equipment, solar industry and other industrial manufacturers. We stock a full line of lights and supplies, including wire and terminals, at very competitive prices. We are a distributor and dealer for the following companies:

LIGHTS

Truck-Lite
Peterson
Grote
Maxxima
UPI
Grand General
Whelen

REFLECTIVE TAPE

3M
Avery
Reflexite

SWITCHES

Carling
Pollak
Honeywell

WIRE

East Penn Manufacturing
Kalas
Industrial Wire

TOOLS

Thomas & Betts
Deka
Streamlight
Bernzomatic

PLUGS

Pollak
Marinco

FUSES

Bussman

SHRINK TUBING

Grayline

CABLE TIES

Hellermann Tyton

TAPE

3M

Warranty

Ideal Lighting extends a limited warranty to the original purchaser, that the products you buy are free from defect in workmanship. Material warranty does not apply to severe applications such as construction equipment and off-road vehicles. Warranty not subject to improper installation or modification of product.

Please contact Ideal Lighting LLC for additional information regarding warranties on a specific product.

We are located at:

406 Mt. Vernon Road, Gap, PA 17527

Store hours:

Monday – Friday 7 am – 4:30 pm EST

Shipping:

We offer same day shipping for in-stock items. Local orders are shipped by 9 to 5 for same same day delivery. All other orders are shipped by UPS or truck freight. Shipping charges will be added to your invoice.

Terms:

- 2% 10 day, net 30 on all open accounts over \$100.00
- All returned items must be returned in original condition, be accompanied by a copy of the original invoice, and are subject to a 15% restocking charge.



Ideal Lighting LLC

406 Mt. Vernon Road. Gap, PA 17527

Hours:

Monday – Friday 7 am – 4:30 pm EST

TO ORDER CALL 1 - 7 1 7 - 4 4 2 - 4 6 0 5

FAX 7 1 7 - 4 4 2 - 0 1 4 8

EMAIL omar@ideallightingllc.com