

MINUTES OF THE REGULAR MEETING
OF THE BOARD OF COMMISSIONERS OF THE
JEFFERSON COUNTY EMERGENCY SERVICES DISTRICT NO. 3

A regular meeting of the Board of Commissioners of the Jefferson County Emergency Services District No. 3 ("District") was called for at 4:00 p.m. on November 10, 2025, at the District's administrative office, located at 3554 S. Pine Island Rd., Beaumont, Texas 77713, pursuant to notice duly posted according to law.

At approximately 4:00 p.m., the regular meeting was called to order. The roll was called of the duly constituted officers and members of the Board, to wit:

Brandon Rose	President
Mike Doguet	Vice President
Rich Courville	Secretary
Bryan Phelps	Treasurer
Collin Garrett	Assistant Treasurer

All of said Board members were present, thus constituting a quorum. Also present at the meeting were: Daniel Diaz, District Administrator; Phillip Kibodeaux, Fire Chief; Joshua Heinz of Benckenstein & Oxford, LLP, attorneys for the District; Mary Ellen Robertson, the District's accountant; and, various members of the fire department.

Upon establishing that a quorum was present, President Rose asked for public comment as set forth in Agenda Item No. 3, and being as there was none, the Board moved along to Agenda Item No. 4, at which time Mr. Diaz and Chief Kibodeaux reviewed with the Board their written monthly Administrator and Chief Reports, copies of which are attached hereto as **Exhibit A**.

The Board was then directed to Agenda Item No. 5 for review of the minutes of the regular meeting held on October 13, 2025. Upon motion by Treasurer Phelps and

seconded by Secretary Courville, and with the unanimous consent of the Board, the Minutes were approved.

Next, the Board was directed to Agenda Item No. 6 for review of the financial statements and payment of the District's bills. Mr. Diaz and Mrs. Robertson reviewed and discussed with the Board the monthly financial statements and listing of bills being presented for approval and payment, copies of which are attached hereto as **Exhibit B**. Mr. Diaz also recommended that \$85,000.00 be transferred from the District's Stellar Bank checking account (acct. no ending 9872) to the TexSTAR investment pool account (acct. no ending 2220). Upon motion by Treasurer Phelps and seconded by Vice President Doguet, and with the unanimous consent of all the Board members, the Board approved payment of the bills reflected in the check list and checking account register (Check Nos. 4957 and 5136-5151, and the Entergy, Sparklight, and other auto-debit/ACH payments), and the above-described account fund transfer.

President Rose then directed the Board's attention to Agenda Item No. 7, at which time Mr. Diaz reviewed with the Board new pumper/tanker apparatus purchase proposal from U.S. Fire Apparatus, a copy of which is attached hereto as **Exhibit C** (total purchase price of \$678,708.00, which will be partially funded through Texas A&M Forest Service Apparatus Grant Program, which is a 95% reimbursement grant up to \$285,000). Upon motion by Secretary Courville and seconded by Vice President Doguet, all of the Board members voted in favor of the proposed pumper/tanker purchase, except for Treasurer Phelps, who voted against the proposal. According, the proposed U.S. Fire Apparatus pumper/tanker purchase was approved.

After tabling Agenda Item No. 8, and being as there were no other matters to come before the Board under Agenda Item No. 9, the regular meeting was adjourned at approximately 4:40 p.m.

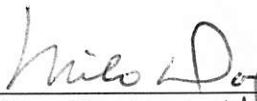
~~Brandon Rose, President~~ Mike Degret, Vice President
Date: 12/8/2025

ATTEST: 
Rich Courville, Secretary

Date: 12/8/2025

Exhibit A



DISTRICT ADMINISTRATOR'S
MONTHLY REPORT- November 10th, 2025

Updates-

Mid October, fraud was noticed in the Stellar Checking Account. I found the day that it happened. Stellar Rep was contacted, and fraud case started. ESD will begin utilizing positive pay for checking an ACH Debits at a total cost of \$35.00 per month. Multiple forms paperwork completed. Training will begin on Thursday.

Additional VFIS Insurance Grant Funds Received- \$3,474.90

Sales Tax Deposit- \$97,342.73

Property Tax Deposit- \$10,209.60

JCESD #3's Calls for Service

Total- 61

Station 1- See Chief's Report

Station 2- No Updates- See Chief's Report

Station 3- No Updates

Daniel J Diaz

ESD EXPENSES OVER \$2,500.00 / for approval.

Action Training Systems- \$2,700.00

Approved last meeting, obtained correct headcount for corrected invoice. 15 members.



Chief's Report

October 2025

- Station 1
 - No building issues
 - Changing out hoses on pump for B31
- Station 2
 - No building issues
 - B32 getting estimates for valve replacement and replacement of pump hoses
- Station 3
 - No building issues
 - No apparatus issues
- Equipment requests for purchase
 - Training complete on SEMS system for ICs
 - Need a dedicated computer/compatible tablet for incident commanders for electronic accountability systems
 - Approval request for new Tanker 31 and needed equipment.
- Calls for service-61
- Capt. Araujo attended level 2 extrication class at Katy Rescue School
- Fire Prevention at China Elem was completed
- ExxonMobil attended Halloween at station 1

Exhibit B

Jefferson County ESD No. 3
Statement of Activities (Cash Basis)
All Locations

	1 Month Ended 10/31/2025 Actual	1 Month Ended 10/31/2025 Actual	Annual Budget	Over (Under) Budget	% of Budget Used to Date
Revenue					
Property Tax Revenue	\$ 4,211	\$ 4,211	\$ 534,345	\$ (530,134)	0.79%
Sales and Use Tax Income	91,647	91,647	703,000	(611,353)	13.04%
Grants	-	-	20,000	(20,000)	0.00%
Interest Income	4,189	4,189	35,000	(30,811)	11.97%
Fire Recovery (Billing Svc)	-	-	2,500	(2,500)	0.00%
Delinquent Property Taxes	-	-	7,500	(7,500)	0.00%
Other Income	75	75	20,000	(19,925)	0.38%
Total Revenue	<u>100,122</u>	<u>100,122</u>	<u>1,322,345</u>	<u>(1,222,223)</u>	<u>7.57%</u>
Operating Expenses					
ISO/Hydrant Maint., Compliance & Improv.	-	-	4,500	(4,500)	0.00%
Software	5,660	5,660	6,200	(540)	91.29%
Office Supplies	-	-	500	(500)	0.00%
Cleaning Supplies	-	-	1,200	(1,200)	0.00%
Station Maintenance	967	967	14,000	(13,033)	6.91%
Insurance - Liability & Windstorm	-	-	40,000	(40,000)	0.00%
Insurance - Worker's Compensation	-	-	13,000	(13,000)	0.00%
Fuel	-	-	11,000	(11,000)	0.00%
Maintenance - Preventative - Trucks	-	-	12,000	(12,000)	0.00%
Repairs and Maintenance - Trucks	792	792	33,000	(32,208)	2.40%
Tests - Pump/Hose	-	-	6,500	(6,500)	0.00%
Training-China	1,144	1,144	13,500	(12,356)	8.47%
Equipment Purchase (< \$5,000)	-	-	7,000	(7,000)	0.00%
Legal	1,675	1,675	16,000	(14,325)	10.47%
Accounting	525	525	15,300	(14,775)	3.43%
Advertising, Promotion, Public Relations	1,897	1,897	5,000	(3,103)	37.94%
Utilities	750	750	7,500	(6,750)	10.00%
Website Expense	221	221	2,960	(2,739)	7.47%
Phone/Cable/Internet	371	371	6,000	(5,629)	6.18%
Dues, Subscriptions and Fees	212	212	3,500	(3,288)	6.06%
Communication Repairs	-	-	1,500	(1,500)	0.00%
Communication Maintenance Fee	11,318	11,318	11,000	318	102.89%
Communication Equipment Purchases	-	-	3,000	(3,000)	0.00%
Contract Labor	750	750	10,000	(9,250)	7.50%
Dispatch Expense	-	-	13,000	(13,000)	0.00%
District Fire Chief	950	950	11,400	(10,450)	8.33%
Assistant Chief Compensation	2,250	2,250	9,000	(6,750)	25.00%
Assistand Fire Chief - Insp/Inv	-	-	9,000	(9,000)	0.00%
Battallon Chief - Operations	-	-	9,000	(9,000)	0.00%
Fire Fighter Healthcare	-	-	31,000	(31,000)	0.00%
Fire Fighter Recognition	-	-	4,000	(4,000)	0.00%
Uniforms	90	90	4,000	(3,910)	2.25%
Travel	-	-	6,000	(6,000)	0.00%
Meals/emergency scenes	-	-	1,000	(1,000)	0.00%
Personal Protective Equipment	-	-	30,000	(30,000)	0.00%
Personal Protective Airpacks	-	-	10,000	(10,000)	0.00%
Rent - Nome Fire station	-	-	600	(600)	0.00%
Supplies-EMS	-	-	7,500	(7,500)	0.00%
Supplies - Firefighting	-	-	1,500	(1,500)	0.00%
Other Costs	56	56	500	(444)	11.20%
Total Operating Expenses	<u>29,628</u>	<u>29,628</u>	<u>391,660</u>	<u>(362,032)</u>	<u>7.56%</u>

These financial statements have not been audited or reviewed and no CPA expresses an opinion or a conclusion nor provides any assurance on them.

Jefferson County ESD No. 3
Statement of Activities (Cash Basis)
All Locations

	1 Month Ended 10/31/2025 Actual	1 Month Ended 10/31/2025 Actual	Annual Budget	Over (Under) Budget	% of Budget Used to Date
Administrative Expenses					
Administrative Wages	3,400	3,400	40,800	(37,400)	8.33%
Office Supplies	43	43	900	(857)	4.78%
Postage/Delivery	-	-	400	(400)	0.00%
Interest Expense - Notes Payable	-	-	24,132	(24,132)	0.00%
Licenses, Fees, Permits	-	-	150	(150)	0.00%
Training	-	-	3,000	(3,000)	0.00%
Bank Service Charges	-	-	100	(100)	0.00%
Service Fees- Tax Collection	-	-	4,800	(4,800)	0.00%
Service Fees - Tax Office	-	-	3,300	(3,300)	0.00%
State Sales Tax Service Fee	1,833	1,833	14,060	(12,227)	13.04%
Consulting	-	-	4,500	(4,500)	0.00%
Uniforms - Admin	-	-	400	(400)	0.00%
Travel - Admin	-	-	6,000	(6,000)	0.00%
Notes Payable - Principle	-	-	104,423	(104,423)	0.00%
Payroll Tax Expense	260	260	3,500	(3,240)	7.43%
Contingency	-	-	20,220	(20,220)	0.00%
Purchase of a Fixed Asset	87,108	87,108	300,000	(212,892)	29.04%
Capital Fund Allocation	-	-	400,000	(400,000)	0.00%
Total Administrative Expenses	<u>92,644</u>	<u>92,644</u>	<u>930,685</u>	<u>(838,041)</u>	<u>9.95%</u>
 Total Expenses	 <u>122,272</u>	 <u>122,272</u>	 <u>1,322,345</u>	 <u>(1,200,073)</u>	 <u>9.25%</u>
 Net Change in Fund Balance	 <u>\$ (22,150)</u>	 <u>\$ (22,150)</u>	 <u>\$ 0</u>		

JEFFESD3 - Jefferson County ESD No. 3**Check List**All Bank Accounts
November 10, 2025

Check Number	Check Date	Payee	Amount
Payroll Checks			
4957	11/10/25	Diaz, Daniel J	
			Payroll Check Total
			<u>2,815.90</u>
Vendor Checks			
5136	11/10/25	Clicktunity	220.92
5137	11/10/25	Emergency Services Marketing Corp., Inc	899.00
5138	11/10/25	Ethan Chick	750.00
5139	11/10/25	Hubert Oxford IV	400.00
5140	11/10/25	Joshua Carl Heinz	400.00
5141	11/10/25	Justin C. McGraw	750.00
5142	11/10/25	Lewis A. Kibodeaux	750.00
5143	11/10/25	Mary Ellen Robertson, CPA, PLLC	525.00
5144	11/10/25	O'Reilly Auto Parts	230.27
5145	11/10/25	Phillip Kibodeaux	950.00
5146	11/10/25	Ruben Araujo	1,189.78
5147	11/10/25	Scooter's Lawn Mower	476.48
5148	11/10/25	SETX Regional Planning Commission	150.00
5149	11/10/25	Sieben Equipment Service, Inc.	509.00
5150	11/10/25	Sean Gray	750.00
5151	11/10/25	Action Training Systems, Inc	
			Vendor Check Total
			<u>11,650.45</u>
			Check List Total
			<u><u>14,466.35</u></u>

Check count = 17

JEFFESD3 - Jefferson County ESD No. 3

Bank Account Register

Checking-Stellar Bank

October 14, 2025 - November 10, 2025

Date	Reference	Payee ID	Description	Checks/ Payments	Deposits/ Additions	Balance
10/15/25			Beginning Balance			74,422.45
10/15/25		Sparklight	Sparklight- Station 1 Cable/ Internet	182.28		74,240.17
10/22/25			Transfer of funds checking to TexStar	60,000.00		14,240.17
10/22/25			Fraud Capital One Debit- Reported Fraud	200.00		14,040.17
10/22/25			Capital One Fraud Debit- Reported Fraud	300.00		13,740.17
10/24/25			Check # 6203260- Fraud Check Cashed- Fraud Reported	2,850.00		10,890.17
10/24/25			Fraud Return from 10/22 Fraud Capital One Debit		200.00	11,090.17
10/24/25			Capital One Fraud Debit Return from Stellar Bank		300.00	11,390.17
10/24/25			Fraud Check #62033260 Fraud Fund Return Stellar Bank		2,850.00	14,240.17
10/27/25		ENTERGY	Entergy- 135558120- Sta. 1	222.82		14,017.35
10/27/25		ENTERGY	Entergy- Acct 135554277- Warehouse China	60.45		13,956.90
11/10/25			Property Tax Revenue Oct 2025- Deposit Nov 2025		10,209.60	24,166.50
11/10/25			Sales Tax Revenue- Sept 2025/ Deposit Nov 2025		97,342.73	121,509.23
11/10/25	4957		Diaz, Daniel J	2,815.90		118,693.33
11/10/25	5136	Clicktunity	Clicktunity	220.92		118,472.41
11/10/25	5137	IAR	Emergency Services Marketing Corp., Inc	899.00		117,573.41
11/10/25	5138	Ethan	Ethan Chick	750.00		116,823.41
11/10/25	5139	H Oxford	Hubert Oxford IV	400.00		116,423.41
11/10/25	5140	Josh Heinz	Joshua Carl Heinz	400.00		116,023.41
11/10/25	5141	McGraw	Justin C. McGraw	750.00		115,273.41
11/10/25	5142	Lewis	Lewis A. Kibodeaux	750.00		114,523.41
11/10/25	5143	MER	Mary Ellen Robertson, CPA, PLLC	525.00		113,998.41
11/10/25	5144	OREILLY	O'Reilly Auto Parts	230.27		113,768.14
11/10/25	5145	Phillip	Phillip Kibodeaux	950.00		112,818.14
11/10/25	5146	Ruben A	Ruben Araujo	1,189.78		111,628.36
11/10/25	5147	Scooters	Scooter's Lawn Mower	476.48		111,151.88
11/10/25	5148	SETXREGPLN	SETX Regional Planning Commission	150.00		111,001.88
11/10/25	5149	SIEBEN	Sieben Equipment Service, Inc.	509.00		110,492.88
11/10/25	5150	Gray	Sean Gray	750.00		109,742.88
11/10/25	5151	Action	Action Training Systems, Inc	2,700.00		107,042.88
Totals				78,281.90	110,902.33	107,042.88

Transaction count = 29

JEFFESD3 - Jefferson County ESD No. 3**Bank Account Register**

TexStar

October 14, 2025 - November 10, 2025

Date	Reference	Payee ID	Description	Checks/ Payments	Deposits/ Additions	Balance
			Beginning Balance			1,165,029.09
10/15/25			Transfer of funds checking to TexStar		60,000.00	1,225,029.09
10/31/25			Monthly Posting- Intrest Deposit		4,188.65	1,229,217.74
			Totals	<u>0.00</u>	<u>64,188.65</u>	<u>1,229,217.74</u>

Transaction count = 2



Good Afternoon, Daniel Diaz

PRIORITY ACCOUNTS

View all



Stellar Bank Checking Account 9872

Available Balance
Current Balance

\$119,928.91
\$119,928.91

Stellar Bank Savings Account 7793

Available Balance
Current Balance

\$25,615.58
\$25,615.58

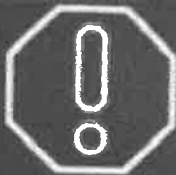

Turn on alerts. Stay protected.

→ Click for Alert Settings

View all accounts

LOCKED LOGINS



No locked logins

View all users



JEFFERSON COUNTY ESD 3
ATTN DANIEL J DIAZ
3554 S PINE ISLAND RD
BEAUMONT TX 77713-3260

MONTHLY STATEMENT OF ACCOUNT

ACCOUNT: 1231112220

ACCOUNT NAME: TS SAVINGS

STATEMENT PERIOD: 10/01/2025 - 10/31/2025

TEXSTAR MONTHLY SUMMARY: THE AVERAGE MONTHLY RATE WAS 4.1164%. THE AVERAGE WEIGHTED AVERAGE MATURITY WAS 47 DAYS AND THE NET ASSET VALUE FOR 10/31/25 WAS 1.000163.

MONTHLY ACTIVITY DETAIL

TRANSACTION DATE	DESCRIPTION	CONFIRMATION NUMBER	TRANSACTION AMOUNT	BALANCE
	BEGINNING BALANCE			
10/15/2025	ACH DEPOSIT			1,165,029.09
10/31/2025	MONTHLY POSTING	6213056	60,000.00	1,225,029.09
		9999888	4,188.65	1,229,217.74
	ENDING BALANCE			1,229,217.74

MONTHLY ACCOUNT SUMMARY

BEGINNING BALANCE	
TOTAL DEPOSITS	1,165,029.09
TOTAL WITHDRAWALS	60,000.00
TOTAL INTEREST	0.00
ENDING BALANCE	4,188.65
AVERAGE BALANCE	1,229,217.74
	1,197,932.32

ACTIVITY SUMMARY (YEAR-TO-DATE)

ACCOUNT NAME	DEPOSITS	WITHDRAWALS	INTEREST
TS SAVINGS	1,058,747.15	720,000.00	40,769.69

IF YOU HAVE ANY QUESTIONS, PLEASE CONTACT TEXSTAR PARTICIPANT SERVICES AT 1-800-839-7827.

PAGE: 1 of 1

Exhibit C



APPARATUS PROPOSAL PAGE

TO: Jefferson County E.S.D. #3
3554 S. Pine Island Rd.
Beaumont, TX 77713

DATE: 10/29/2025

US Fire Pump Company, LLC hereby proposes to manufacture and furnish to you, subject to your acceptance of this proposal and the proper signing and execution of a purchase order, by the parties thereto, the apparatus and equipment herein described and for the following prices listed below.

One-(1) US Fire Apparatus Commercial Pumper with heavy-duty extruded aluminum body, mounted upon a Freightliner M2-112 chassis with Waterous CSU 1500 GPM pump and 2500-gallon water tank, as described within attached specifications dated 29 October 2025, for the sum of:

***Six-Hundred Seventy-Eight Thousand Seven-Hundred Eight Dollars and Zero Cents
(\$678,708.00)***

No federal, state or local taxes are included.

This apparatus shall be purchased in accordance with HGAC Buy Contract # FS12-23.

Delivery shall commence within 14 months after receipt of the signed approval package.

All apparatus and equipment shall be manufactured in accordance with the attached specifications with the same specification becoming part of the agreement. Delivery shall be made within the time specified above after receipt and acceptance by US Fire Pump Company, LLC of the properly signed and executed approval package. The delivery time indicated is based on the best delivery knowledge available at this time. Delivery shall be contingent upon delays or failure to delivery from our suppliers, delays caused by, or resulting from labor problems, chassis shortages, strikes, fires, flood, accidents or other acts of God, or any other circumstances which are beyond the control of this company.

TERMS OF PAYMENT: All apparatus shall be paid NET UPON DELIVERY AND ACCEPTANCE. In the event equipment shortages occur the PURCHASER is to pay full purchase prices less a 5% retainer for such shortages. Any amount deducted is then payable upon receipt and acceptance of such shortages.

All prices or quotations are subject to change or withdrawal unless the purchase order is received within 30 days of this proposal date.

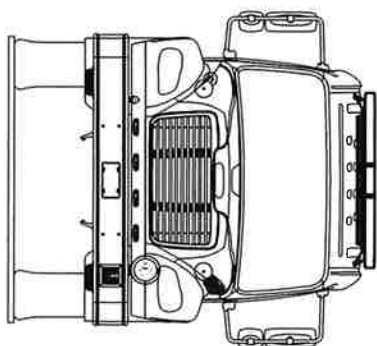
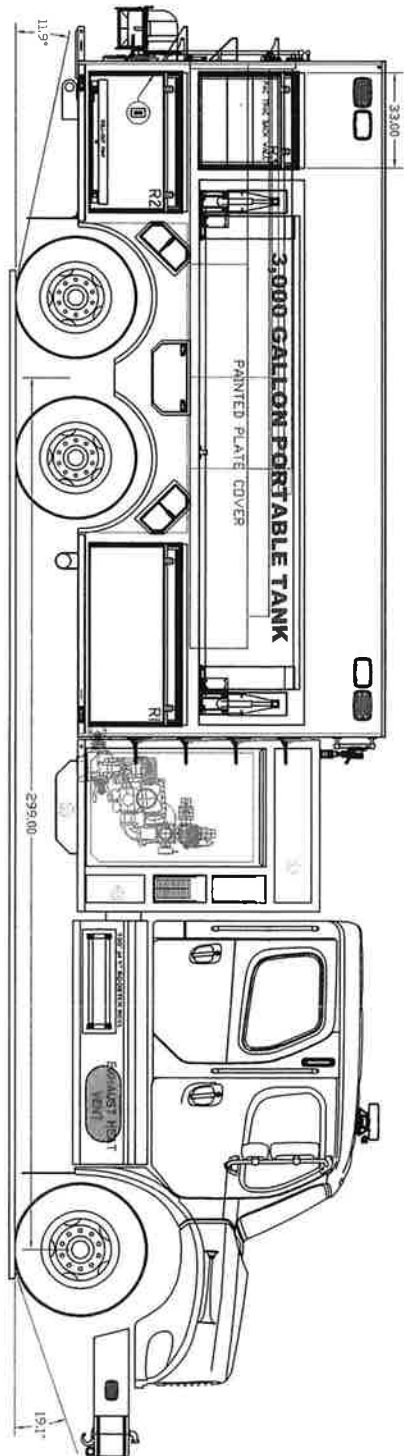

CUSTOMER ACCEPTANCE

NAME: _____

TITLE: _____

DATE: _____

THIS DRAWING IS FOR VEHICLE REFERENCE ONLY. THE MANUFACTURER'S SPECIFICATIONS SHALL PREVAIL OVER ANY OTHER SPECIFICATIONS. ALL DETAILS ARE NOTED OR SHOWN.

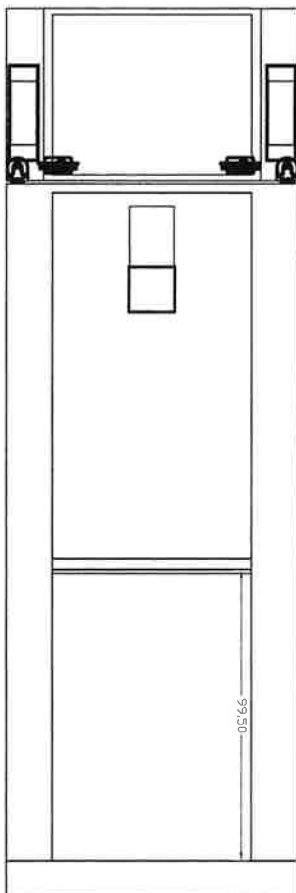

INTERIOR		OPENING
L1	62W X 74.25H X 15/28D	60.00W X 64.875H
L2/L3	106W X 37H X 15D	49.00W X 27.625H
L4	48W X 74.25H X 15/28D	46.00W X 64.875H
R1	62W X 33H X 28D	60.00W X 24.875H
R2	48W X 33H X 28D	46.00W X 24.875H
R3	33W X 36H X 15D	31.00W X 27.375H



JEFFERSON COUNTY ESD NO. 3
JOB NO.: REFERENCE DRAWING
1,500 GPM WATEROUS CSU PUMP
2,500 GALLON WATER TANK

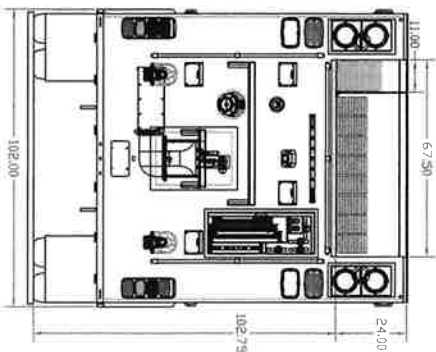
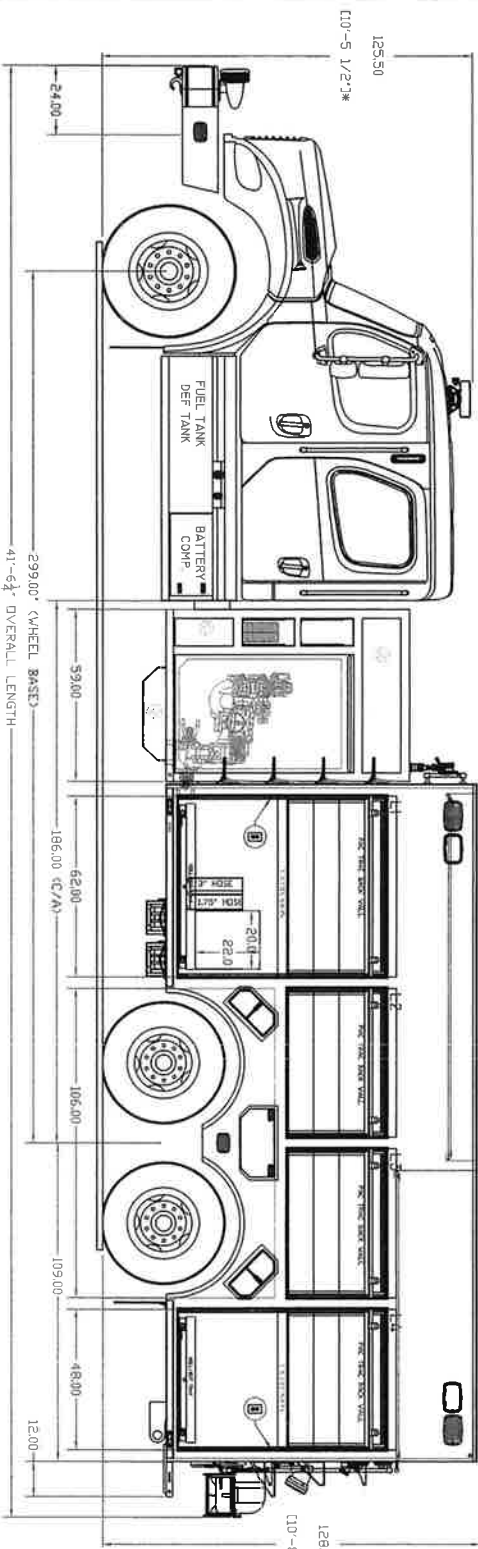

*HEIGHT COULD VARY +/-" BASED ON LOADING OF VEHICLE



Shop Order

Jefferson County E.S.D. No 3
Phillip Kibodeaux
133 W. Railroad
China, TX 77613

U.S. Fire Apparatus
John "Stevie" Stiles
27995 James Chapel Road N.
Holden, LA 70744
johns@usfirepump.com

Exp. Date: 11/30/2025
Quote No: 10186-0002
TANKER: USFA-3000 Commercial Tanker
LEGALS: USFA-8005 Commerical Chassis Legals - US Fire Apparatus
CHASSIS: USFA-8105 Chassis - Commerical Tanker
PUMPMODULE: USFA-8210 Pump Module - Commercial Tanker
ELECTRICAL: USFA-8320 Electrical - Commercial Tanker
BODY: USFA-8410 Body - Commercial Tanker
PAINT: USFA-8500 Paint / Graphics
EQUIPMENT: USFA-8605 Equipment - Tanker
ADMIN: USFA-88000 Administartion

10/29/2025

Page 1

PART NO	DESCRIPTION	QTY
== Commerical Chassis Legals - US Fire Apparatus - 1025.000 10/03/25 ==		
LEGALS / WARRANTIES / MANUALS		
00-00-1000	*****USFA September 2025 Data Book - Model 1B *****	1
00-02-0420	Proposal Response	1
00-02-2000	Payment Terms	1
00-02-2220	Apparatus Contract HGAC	1
00-02-4020	Principal Dimensions	1
	The apparatus will have the following dimensions:	
	Maximum Acceptable Overall Length: 41' 7"	
	Maximum Acceptable Overall Height: 10' 8"	
00-02-6020	Proposal Drawing	1
00-02-6220	Approval Drawing	1
00-03-0000	Pre-Construction Conference - Fire Departments Location	1
00-03-0010	Final Inspection - Factory (Lodging/Meals) Per Person	3

PART NO	DESCRIPTION	QTY
00-04-0420	Vehicle Transportation - USFA Supplied	1
00-04-1220	<p>Delivery Time - Order Commercial Chassis</p> <p>The apparatus will be complete within 240 days after receipt of signed approval package.</p> <p>Once approval package is signed and returned, USFA will review the delivery schedule once again before order release and provide the end user with a new delivery time.</p> <p>US Fire Apparatus will not be held liable for changes arising from its failure to make or delay in making delivery because of fire, flood, strike, riot, supply chain, work force shortages, accidents, acts of God or any circumstances beyond our control.</p>	1
00-06-4020	NFPA Required Safety Signs	1
00-06-4220	Fluid Data Plate	1
00-06-4420	Carry Capacity Plate	1
00-80-0220	<p>Apparatus Warranties - US Fire Apparatus</p> <p>US Fire Pump Company, LLC, ("USFP") warrants each new mobile fire apparatus be free of defects in material and workmanship for a determined warranty period from the date on which the vehicle is first delivered to the original purchaser.</p> <p>General Warranty-</p> <p>The general warranty is in effect for a warranty period that continues until 12 months from the date of delivery of the new fire apparatus to the original owner, or the first 12,000 actual miles from the delivery date, whichever occurs first. The general warranty is not valid if the odometer is disconnected, or its reading has been altered, or mileage cannot be determined.</p> <p>Body Structure Warranty-</p> <p>The body structure warranty is in effect for a warranty period that continues until 120 months from the date of delivery of the new fire apparatus to the original owner, or the first 100,000 actual miles from the delivery date, whichever occurs first. The body structure warranty is not valid if the odometer is disconnected, or its reading has been altered, or mileage cannot be determined.</p> <p>General Body Paint Warranty-</p> <p>The body paint warranty is in effect for a warranty period that continues until 60 months from the date of delivery of the new fire apparatus to the original owner.</p> <p>Plumbing Warranty-</p> <p>The plumbing warranty is in effect for a warranty period that continues until 120 months from the date of delivery of the new fire apparatus to the original owner, or the first 100,000 actual miles from the delivery date, whichever occurs first. The plumbing warranty is not valid if the odometer is disconnected, or its reading has been altered, or mileage cannot be determined.</p>	1
00-80-0620	<p>Cab / Chassis Warranties - Commercial Chassis</p> <p>General Warranty-</p> <p>The purchaser will receive a custom chassis 1 year.</p>	1

PART NO	DESCRIPTION	QTY
	<p>Cab Structure Warranty- The cab will be warranted against structural defects in material and workmanship under normal use and service for a period of 5 years from date of delivery.</p> <p>Cab Paint Warranty- A prorated paint warranty shall be provided for a period of 5 years pending the purchase and selection of the extended warranty period of 5 years.</p> <p>Chassis Frame Rails Warranty- The custom chassis frame and cross members will be warranted for 5 years from the date of delivery.</p> <p>Engine Warranty- The Cummins engine shall be warranted for a period of 5 years or 100,000 miles, whichever comes first by the engine manufacturer, Cummins.</p> <p>Transmission Warranty- The Allison EVS transmission engine shall be warranted for a period of 5 years by the transmission manufacturer, Allison.</p>	
00-80-2020	Apparatus Manuals	1
00-80-4020	Apparatus Body Wiring Diagrams	1
	== Chassis - Commerical Tanker - 1025.000 10/03/25 ==	
	CHASSIS	
02-A0-0100	*** Freightliner ***	1
02-A2-0620	<p>Commercial Chassis - Freightliner 4-Door M2-112 / 299" Wheel Base / Tandem Axle 2027 Freightliner 4-door M2-112+ cab and chassis.</p> <p>See Chassis Specification for Detail Description Includes: Cummins L9 450EV hp Engine Allison EVS3000 6-Speed Transmission</p> <p>NOTE: Truck must not be gear bond to NFPA top speed. Engine will be governed to top speed.</p> <p>Single Tone Cab Paint, Pierce #90 Elite Red, L4664EY Air Ride Driver's Seat w/ Occupant Sensor (Vinyl) SCBA Air Ride Officer Seat w/ Occupant Sensor (Vinyl) SCBA Non-Suspension LH, RH and Center Crew Seats (Vinyl) 18K Front Axle / 46K Rear Axle Alcoa Aluminum Wheels (22.5x12.25 Front/22.5x9 rear) 425/65R22.5 Continental HAC3 Front Tires 315/80R22.5 Continental HAU3 Rear Tires 75 Gallon Driver's Side Rectangular Aluminum Fuel Tank Add AM/FM/Bluetooth/WB Radio in Cab Wheelbase: 299" C/A: ~186.0"</p>	1

PART NO	DESCRIPTION	QTY
	<p>NFPA Included Items:</p> <p>293-058 - Positive Load Disconnect</p> <p>727-036 - Valve and Plumbing for USFA Furnished Air Horns</p> <p>264-033 - Steering Wheel Mounted Electric Horn Control</p> <p>49B-004 - Electronic Stability Control</p> <p>786-119 - VDR and Seat Belt Display</p> <p>586-024 - Front Fender Mud Flaps</p> <p>721-001 - 97DB Back-Up Alarm</p> <p>73H-014 - Back-Up Camera with Display Through 7" Touchscreen Radio Screen</p> <p>469-014 - Automatic On/Off Engine Compt. Work Light</p> <p>GREEN - Battery On Indicator Light</p>	
	CHASSIS MODIFICATIONS - 4-DOOR CAB	
02-B2-1200	*** Front Bumper Components ***	1
02-B2-1220	<p>Front Bumper - 12" High, Polished Stainless Steel</p> <p>The stock chrome bumper will be removed and replace with the 12" high polished stainless steel bumper.</p> <p>Reference FT1155 JCESD#3 for Front Bumper Layout</p>	1
02-B2-1220	<p>Front Bumper License Plate Mounting</p> <p>Will include front license plate provision in P2 position.</p> <p>Reference FT1155.</p>	1
02-B2-2620	<p>Front Bumper Option - Extended Bumper</p> <p>There will be a XX" front frame extension provided. The extension will be made from heavy-duty steel</p>	1
02-B2-2820	Front Bumper Option - Tread Plate Gravelshield	1
02-B2-4020	<p>Front Bumper Option - Center Storage Compartment</p> <p>Capacity: 150' of 1-3/4" DJ Hose</p> <p>Note: True ID Hose</p>	1
02-B2-4620	<p>Front Bumper Compartment Option - Tread Plate Cover</p> <p>Note: Bumper compartment to be notched on the officer's side to accept pre-connect jumpline. The bumper shall be notched for 2" hose.</p>	1
02-B2-6220	<p>Front Bumper Option - Pedestal Mount Federal Q2B Siren</p> <p>The siren will be mounted on the extended front bumper gravelshield on the driver's side.</p> <p>The siren brake switch will be located within the switch panel.</p> <p>The siren will be active in response mode only</p>	1

PART NO	DESCRIPTION	QTY
02-B2-6420	Q2B Siren Activation - Driver Side Foot / Officer's Side Console There will be one-(1) foot switch located on the driver's side cab floor, and one-(1) rocker switch located on the officer's side console, to activate the Q2B siren.	1
02-B2-8020	Front Bumper Option - 200 Watt Siren Speaker The 200-watt siren speaker will be surface mounted on the driver's side of the front bumper in position P7. Note: A USFA Stainless Grille shall be installed over the siren speaker. Reference FT1155.	1
02-B4-0000	*** Tires / Wheels ***	1
02-B4-0220	Tire Pressue Monitor System - LED AirGuard	1
02-B4-0820	Stainless Steel Wheel Trim w/ Lug Nut Covers Note: Baby Moons to be provided with Axle Grease Viewing Hold	1
02-B6-0000	*** Air System Components ***	1
02-B6-4020	Air System Option - Dual Hood Mounted Air Horns Note: Air Horns shall be 24.5" Hadley eTone Chrome Air Horns, H09324AC	1
02-B6-4420	Air Horn Activation - Dash / Center Console Mounted There will be one-(1) rocker switch located on the center cab console to alternate the chassis steering wheel button between City Horn/Air Horn. THIS SWITCH SHALL NOT ALTERNATE THE SIREN TONES IN ANY MODE There will be one-(1) rocker switch located on the officer's side center cab console to activate the air horns.	2
02-B8-0000	*** Battery Charger ***	1
02-B8-2020	Inverter/Charger - 5-80 AMP, Kussmaul XC2000, 817-2080 Note: The inverter/charger shall have a built in 30A automatic power transfer relay allowing the inverter to charge the batteries and onboard receptacles from grid power (shoreline) when plugged in to the station and battery power when the ignition switch is activated. Continuous AC output amperage - 16.7A. Reference FT1155 for Inverter/Charger Mounting Location	1
02-B8-2420	20A Household Receptacle - 120V Duplex The receptacle will be located in the on front of the center cab console. The receptacle will be wired to the inverter.	1
02-B8-4620	20A Battery Charger Receptacle - Kussmaul Auto Eject 091-55-20-120 The receptacle will be located on the left side pump panel.	1
02-B8-6020	Battery Charger Receptacle Cover - Kussmaul w/ Digital Status Center The battery charger receptacle cover will be a Kussmaul 091-817XC-YW w/ Bar Graph Display	1

PART NO	DESCRIPTION	QTY
02-B8-8820	Power Inlet Plate	1
04-A0-0100	*** Exterior Trim ***	1
04-A2-1020	HD Chassis Trim - 4 Door Cabs The trim shall extend as far upward as possible without interfering with the cab air ride system. The front cab steps and rear cab steps on each side of the apparatus will be covered with a 1-piece assembly constructed of 3/16" embossed (stepping surfaces) aluminum tread plate. This 1-piece assembly will also cover the chassis fuel, DEF and chassis batteries. The battery compartment will include a roll out storage tray that will be accessed from the driver's side through a hinged tread plate door. The officer's side assembly below the crew cab door will include stainless steel roller's with guides for installation of a 100' booster reel behind the chassis trim. An access panel shall be provided in the chassis trim to release the brake and manually rewind the booster reel in the event of motor failure.	1
04-A8-0100	*** Interior Trim ***	1
04-A8-0420	Interior Door Panel Reflective Striping - 4 Door Cabs There will be a minimum of 96 square inches of reflective material installed on the inside panel of each cab door.	1
06-A0-0200	*** Cab Electrical ***	1
06-A2-0420	Load Management System w/ High Idle	1
06-A2-0425	Switch - Manual Fast Idle	1
06-A2-0620	Vehicle Indicator Light Panel The center cab console will be equipped with a vehicle indicator light panel. The panel will include the following indicator lights: Battery On Ignition On Low Volts w/ audible alarm Door ajar w/ audible alarm	1
06-A2-0820	Center Console Switch Panel The center cab console will have an upper rocker switch panel for component controls. Reference FT1155 for Cab Console Layout. ADD: Guarded Dump Chute Open/Close and Manual High Idle Switch	1
06-A2-2220	12-Place 12V Fuse Block - Blue Sea 5032 The fuse block will be located inside the center cab console.	1
06-A2-2420	Dual USB Charging Port (USC-C / USB-A) There will be one-(1) charging port located on each side of the center cab console in the	2

PART NO	DESCRIPTION	QTY
	outboard positions.	
06-A2-2620	12V Power Outlet The power outlet will be located in the center cab console.	1
06-A2-4220	Radio Mounting - Customer Supplied Radio Make/Model: Kenwood VP8000	1
06-A2-4420	Antenna Mount & Coaxial Cable The coaxial cable will terminate inside the center cab console. Note: The radio/cabling shall be GPS capable for the Kenwood VP radio.	1
06-A2-4820	Radio Power Circuit The radio power circuit will be located inside the center cab console.	1
06-A2-4825	Installation - Customer Supplied Portable Radio Charger Location: Reference FT1155	1
06-A2-6020	Electronic Siren - Whelen 295SLSA1 The siren will be located in the center cab console.	1
06-A2-6025	Remote Siren & Control Center Module- Whelen CenCom Core-R, C399RD2 Only the warning lights and traffic light will be wired through the CORE system so that we have full programming capability over flash patterns and to have DVI set up to automatically activate when the parking brake is set. None of the scene lights would go through the CORE system.	1
06-A2-6030	Expansion Modules, Whelen WeCanX Whelen WeCanX expansion modules shall be provided and installed on the apparatus to utilize the CenCom Core-R CAN system and functionality.	1
06-A2-6035	Vehicle to Vehicle Sync Module, Whelen CV2V A Whelen, model CV2V, vehicle to vehicle sync module shall be provided and installed in the apparatus.	1
06-A2-6420	LED Ground Lights (4)	1
06-A2-8220	Cab Dome Light - Red / Clear There will be one-(1) dome light will be centered in the front and rear cab headliner.	1
06-A2-9420	Chassis Supplied Camera Installation The chassis supplied back-up camera will be installed on the rear of the apparatus and connected to the cab monitor.	1

PART NO	DESCRIPTION	QTY
06-A4-0000	*** Interior Cab Accessories ***	1
06-A6-8020	Center Cab Console - Black Poly	1
	== Pump Module - Commercial Tanker - 1025.000 10/03/25 ==	
	APPARATUS PUMP MODULE - TANKER	
20-A2-0420	59" Wide Apparatus Pump Module - USFA Side Mount	1
20-A2-2005	*** Apparatus Pump Module Components ***	1
20-A2-2220	Side Mount Pump Panels - Black Anodized Aluminum	1
20-A2-2820	Hinged Right Side Pump Panel	1
20-A2-4020	LED Pump Panel / Compartment Lights - Side Mount Pump Module	1
20-A2-8020	Pump Panel Running Boards - Embossed Tread Plate	1
20-A2-8220	Pump Panel Running Boards Hose Tray - Tread Plate Drop-In Style	2
20-A2-8620	Pump Panel Air Outlet	1
	The air outlet will be located on the left pump panel.	
20-A2-8820	Pump Panel Air Horn Activation Switch	1
	Note: Pump Panel Air Horn Switch to be labelled "AIR HORN"	
20-A2-8825	Pump Panel Scene Light Activation Switch(es)	4
	WORK LIGHTS, LEFT SCENE, RIGHT SCENE, REAR SCENE	
20-A2-8830	Gauge - Fuel Tank Level, Pump Panel	1
20-A4-0100	*** Apparatus Pump Controls & Instruments ***	1
20-A4-0220	Pump Pressure Governor - Fire Research Pump Boss PBA500-D10	1
	The following continuous displays shall be provided:	
	Engine RPM; shown on LCD screen	
	Check engine and stop engine warning; shown on LCD screen	
	Engine oil pressure; shown on LCD screen	
	Engine coolant temperature; shown on LCD screen	
	Transmission Temperature; shown on LCD screen	
	Battery voltage; shown on LCD screen	
	Pressure and RPM operating mode LEDs	
	Pressure / RPM setting; shown on LCD screen	
	Throttle ready / Ok to Pump LEDs.	
	inputs and support audible and visual warning alarms for the following conditions:	
	High Battery Voltage	
	Low Battery Voltage (Engine Off)	
	Low Battery Voltage (Engine Running)	
	High Transmission Temperature	
	Low Engine Oil Pressure	
	High Engine Coolant Temperature	
	Out of Water (visual alarm only)	
	No Engine Response (visual alarm only).	
20-A4-1020	4-1/2" White Face Master Intake (-30hg-400 PSI) / Pressure (0-400 PSI) Gauges	1

PART NO	DESCRIPTION	QTY
20-A4-1220	2-1/2" White Face Individual Pressure Gauges (0-400 PSI)	1
20-A4-2005	*** Fire Pump & Accessories ***	1
20-A4-4020	Single Stage Fire Pump - Waterous CSU	1
20-A4-4420	Fire Pump Mounting	1
20-A4-4620	Flame Plated Impeller Hub	1
20-A4-6220	Fire Pump Certification - 1500 GPM	1
20-A4-8020	Fire Pump Seal - Mechanical	1
20-A4-8420	Fire Pump Shift Control - Cab Mounted The pump shift will be located in the center cab console.	1
20-A4-8620	Fire Pump Priming System - Trident Manual Air Prime	1
20-A4-8820	Fire Pump Corrosion Protection - Alloy Anode	3
20-A6-0220	Fire Pump Thermal Relief Valve w/ Light	1
20-A6-2820	Fire Pump Test Points	1
20-A6-4020	Fire Pump Master Drain	1
20-A6-4220	Individual 3/4" Drain Valves - Lift-Up Style	1
20-A6-6220	Fire Pump & Engine Cooler Valves	1
20-A8-0000	*** Tags & Labeling ***	1
20-A8-0220	Color Coded Pump Panel Tags Speedlay #1: Red Speedlay #2: Yellow #1 Discharge: Dark Blue #2 Discharge: Purple #3 Discharge: Green PS Large Discharge: Brown Left Rear Discharge: Light Blue Front Jumpline: Orange	1
20-A8-0420	Fire Pump Certification Plate	1
20-A8-0620	Fire Pump Performance Plate	1
22-A0-0000	*** Plumbing ***	1
22-A2-0620	Stainless Steel / Flex Hose Plumbing	1
22-A2-1220	Intake & Discharge Apparatus Valves - Akron Brass 8800 Series	1
22-A2-1420	Fire Pump Paint - Standard OEM Black	1
22-A2-1620	Apparatus Valve & Plumbing Finish - Natural (No Paint)	1
22-A2-2020	Discharge Elbow & Caps All discharges will be equipped with elbows and caps.	1
22-A4-0000	*** Steamers & Intakes ***	1
22-A4-0220	6" Steamer Inlets - Left & Right Side w/ Long Handle Caps	1
22-A4-0225	DS Jumbo Ball Intake Valve - 4" Storz Rigid x 6" NHF Swivel, TFT AX1SP-NX	1
22-A4-0230	DS Inlet Cap - 4" Storz w/ Chain, Kocheck CC407-P07 (Red)	1
22-A4-0235	OS Suction Siamese - 6" NH SW RL F x (2) 2.5" NH SW FL F, Kocheck 20K60225-P07	1

PART NO	DESCRIPTION	QTY
22-A4-0240	OS Plug(s) w/ Chain - 2.5" NH, Kochek PC2552-P07 (Red)	2
22-A4-1020	2-1/2" Left Side Intake w/Plug - Swing Controlled @ Valve	1
22-A4-1420	2-1/2" Right Side Intake w/Plug - Swing Controlled @ Valve	1
22-A4-2020	2" Tank Fill Valve - Push Pull Controlled	1
22-A4-4020	3" Tank To Pump Valve - Push Pull Controlled	1
22-A4-6020	Fire Pump Intake Relief Valve (125 PSI Pre-Set)	1
22-A6-0010	*** Discharges ***	1
22-A6-0201	*** Bumper Discharge ***	1
22-A6-0420	1-1/2 Front Jump Line - Push Pull Controlled The swivel will terminate on top of the gravelshield, officer's side. A tread plate stop will be provided preventing the front bumper discharge swivel from incidental contact with the cab.	1
22-A6-2005	*** Booster Reel Discharge ***	1
22-A6-2220	Booster Reel w/ Rollers - Air Controlled The reel will be located behind the passenger side crew door chassis trim. The reel shall have a capacity of 100' of 1" rubber booster hose.	1
22-A6-4005	*** Crosslay / Speedlay Discharges ***	1
22-A6-4120	1-1/2" Speedlay #1 w/ 2" Valve - Push Pull Controlled The speedlay bed will accommodate 200' of 1-3/4" COMBAT SNIPER hose.	1
22-A6-6025	1-1/2" Speedlay #2 w/ 2" Valve - Push Pull Controlled The speedlay bed will accommodate 200' of 1-3/4" COMBAT SNIPER hose.	1
22-A6-8620	Removable Speedlay Tray The speedlay bed will accommodate 200' of 2-1/2" COMBAT SNIPER hose. Note: The speedlay trays shall dimensionally match those provided on FT1155 so they are interchangeable between the two apparatus.	2
22-A6-8625	Spare Speedlay Tray Note: The speedlay trays shall dimensionally match those provided on FT1155 so they are interchangeable between the two apparatus.	2
22-A6-9620	Speedlay End Flap - Hypalon w/ Bungee Cords The end flaps will be secured at the side and bottom with bungee cords and hard mounted at the top. The end flaps will be black in color.	1
22-A8-0000	*** Left Panel Discharges ***	1

PART NO	DESCRIPTION	QTY
22-A8-0220	2-1/2" Left Side Discharge #1 - Push Pull Controlled	1
22-A8-1020	2-1/2" Left Side Discharge #3 - Push Pul Controlled	1
22-A8-4000	*** Right Panel Discharges ***	1
22-A8-4020	2-1/2" Right Side Discharge #2 - Push Pull Controlled	1
22-A8-6620	4" Right Side Large Diameter Discharge - Electric Controlled	1
22-A8-6625	LDH Discharge Elbow - 30-Degree, 4" FNH Swivel x 4" Storz, Kocheck SKE44R-P07	1
22-A8-6630	LDH Discharge Gated Wye - 2-Way, 4" Storz x (2) 4" Storz, Kocheck 23K0404-H52	1
22-A8-6635	LDH Discharge Adapter - 4" Storz x 2-1/2" MNH, Kocheck S36S425-P07 (Red)	2
22-A8-6640	LDH Discharge Cap(s) w/ Chain - 2.5" NH, Kocheck CC2552-P07 (Red)	2
24-A4-0000	*** Left Rear Discharges ***	1
24-A4-0220	2-1/2" Left Rear Discharge - Push Pull Controlled	1
== Electrical - Commercial Tanker - 1025.000 10/03/25 ==		
APPARATUS ELECTRICAL SYSTEM		
40-A2-0000	*** Point to Point Body Wiring & Testing ***	1
40-A2-0220	Apparatus Electrical System - Commercial Chassis	1
40-A2-0620	NFPA Electrical System Testing	1
40-A2-0820	Electrical System Wiring Protection - Split Loom	1
40-A2-1020	EMI / RFI Protection	1
40-A4-0000	*** Warning Lights ***	1
40-A4-0100	*** Light Bars ***	1
40-A4-0220	Zone A Upper Light Bar - 60" LED, Whelen Freedom IV WCX Note: Light bar to be provided in Red with one-(1) blue module spaced two-(2) positions outboard the two forward facing White LED flashers (White shuts off with Park Brake per NFPA). Rear corner LED's shall be provided. The light bar shall be mounted level to earth, not level to cab roof.	1
Note: Add WeCan X Capabilities for DVI		
40-A4-1000	*** Zone B / D Upper Front Body Corner Lights ***	1
40-A4-1020	Zone B / D Upper Front Body Corner Lights (2) - Whelen M9*C Make / Model: Whelen M9RC The lights will be red in color with clear lens. There will be one-(1) light with chrome bezel installed on each side of the apparatus on the upper front body corners.	1
40-A4-2000	*** Zone B / D Upper Rear Body Corner Lights ***	1
40-A4-2020	Zone B / D Upper Rear Body Corner Lights (2) - Whelen M9*C Make / Model: Whelen M9RC The lights will be red in color with clear lens. There will be one-(1) light with chrome bezel installed on each side of the apparatus on the upper rear body corners.	1

PART NO	DESCRIPTION	QTY
40-A4-4000	*** Zone C Upper Rear Lights ***	1
40-A4-4020	Zone C Upper Lights (2) - Whelen M9*C Make / Model: Whelen M9RC	1
	The Driver's Side Light shall be Red with Clear Lens	
	The Officer's Side Light shall be Amber with Clear Lens	
	There will be one-(1) light with chrome bezel installed on each side of the apparatus on the upper rear of the apparatus.	
40-A4-6100	*** Zone A Lower Lights ***	1
40-A4-6620	Zone A Lower Lights (4) - Whelen ION TLI* Make / Model: Whelen TLI*	1
	The lights will be alternating Red / Blue / Red / Blue from the driver's side.	
	There will be four-(4) lights with black bezels installed on the front of the apparatus.	
40-A4-8100	*** Zone B / D Lower Front Lights ***	1
40-A4-8220	Zone B / D Lower Front Lights (2) - Whelen M6*C Make / Model: Whelen M6RC	1
	The lights will be red in color with clear lens.	
	There will be one-(1) light with chrome bezel installed on each side of the apparatus on the side of the hood (if the unit has an extended front bumper option lights will be located on the bumper ends).	
40-A6-0000	*** Zone B / D Lower Midship Lights ***	1
40-A6-0220	Zone B / D Lower Midship Lights (2) - Whelen M6*C Make / Model: Whelen M6RC	1
	The lights will be red in color with clear lens.	
	There will be one-(1) light with chrome bezel installed on each side of the apparatus in the body wheel well area.	
40-A6-1000	*** Additional Zone B / D Lower Midship Lights ***	1
40-A6-1020	Zone B / D Lower Midship Lights (2) - Whelen ION TLI* Make / Model: Whelen TLIR	1
	The lights will be red in color with clear lens.	
	There will be one-(1) light with black bezel installed on each side of the apparatus below compartment L1 / R1.	

PART NO	DESCRIPTION	QTY
40-A6-2000	*** Zone B / D Lower Rear Lights ***	1
40-A6-2020	Zone B / D Lower Rear Lights (2) - Whelen ION TLI* Make / Model: Whelen TLIR The lights will be red in color with clear lens. There will be one-(1) light with black bezel installed on each side of the apparatus below rearward compartments.	1
40-A6-4000	*** Zone C Lower Lights ***	1
40-A6-4020	Zone C Lower Lights (2) - Whelen M6*C Make / Model: Whelen M6*C The Driver's Side Light shall be Blue with Clear Lens. The Officer's Side Light shall be Red with Clear Lens. There will be one-(1) light installed on each side of the apparatus in the tail light housing.	1
40-A6-6000	*** Zone C Lower Tail Light Assemblies ***	1
40-A6-6020	Stop / Turn / Back-Up Lights - Whelen M Series The fixtures will be mounted on each rear face of the body in a model M6FCV4, four-(4) light head chrome housing.	1
40-A8-0000	*** Upper Rear Directional Lights ***	1
40-A8-0005	Light - LED Rear Directional, Whelen Dominator DTAW8 Note: Blue Warning Light on Officer's Side, Red Warning Light on Driver's Side. Warning Lights to activate by Zone C Warning switch in the cab, directional lights to be controlled by control head Reference FT1155	1
42-A0-0200	*** Additional Apparatus Lights ***	1
42-A2-0220	LED Clearance / Marker Lights	1
42-A2-0620	LED Ground Lights There will be one-(1) light located below compartment L1, compartment L3, compartment R1, compartment R3 and one-(1) each side below the rear tailboard. The light will activate when the park brake is set. There will also be a switch in the cab to to turn the lights off per NFPA.	6
42-A2-1020	LED License Plate Light & Mounting Holes	1
42-A2-2020	LED Compartment Lights There will be two-(2) LED lights installed in each body compartment. The light will activate when the park brake is set. There will also be a switch in the cab to to turn the lights off per NFPA.	14

PART NO	DESCRIPTION	QTY
42-A2-2420	LED Hose Bed Light There will be an LED light mounted on the front hose bed wall to illuminate the area. The light will be activated by a switch on the left rear of the apparatus. The switch will also activate the rear scene and reverse lights. The switch will be labeled REAR SCENE.	1
42-A2-2430	LED Fog Lights - Rigid Industries, 37202 Rigid Industries, model 37202, LED fog lights shall be installed one-(1) per side under the flat portion of the front bumper. These lights shall be controlled by a switch in the cab labeled "FOG LIGHTS".	1
42-A4-0000	*** Apparatus Surface Mount Scene Lights ***	1
42-A4-0220	LED Surface Mount Scene Lights (2) - Whelen M92SL* Make / Model: Whelen M92SLC Locations: (1) per Body Side, Zone B/D Upper Front (1) per Body Side, Zone B/D Upper Rear (1) per Side of Rear of Body The lights will be equipped with chrome bezels. The scene light(s) will be controlled by switch located in the cab.	3
42-A4-2000	*** Apparatus Brow Scene Lights ***	1
42-A4-2020	LED Brow Scene Light - Whelen Summit S58M* Make / Model: Whelen S58MB (Black) The scene light will be mounted to the bottom of the light bar. The scene light will be controlled by switch located in the cab.	1
42-A4-4000	*** Apparatus Telescoping LED Scene Lights ***	1
42-A4-4420	LED Telescoping Scene Light - Whelen PCH2 Locations: One-(1) per side in the dunnage area. Note: The lights shall be provided with powder coated black light heads. The light(s) will be controlled by a switch located on the light head.	2
42-A4-9000	*** Additional Scene Lights Options ***	1
42-A4-9220	Scene Light Activation - Reverse Circuit	1
42-A6-0220	20A Household Receptacle - 120V Duplex Locations:	3

PART NO	DESCRIPTION	QTY
	(1) Compartment L1, Lower Section, Left Side Wall	
	(1) Compartment L4, Lower Section, Right Side Wall	
	(1) Compartment R2, Left Side Wall	
	The receptacles will be wired to the shoreline.	
	== Body - Commercial Tanker - 1025.000 10/03/25 ==	
	TANKS / APPARATUS BODIES / BODY COMPONENTS	
58-A0-0000	*** Water Tank & Components ***	1
58-A2-1020	Polypropylene Water Tank - 2500 US Gallons w/ 6" Tank Vent & Tank Sleeve	1
58-A2-2005	*** Additional Tank Options ***	1
58-A2-2010	Water Level Gauge - Class One Intelli-Tank ITL-40M	1
58-A2-2220	10" Stainless Steel Rear Dump Valve - Newton Electric	1
	The rear dump valve will be controlled by a switch located in the cab and at the left rear of the apparatus.	
58-A2-2420	36" Stainless Steel Manual Telescoping Chute - Newton 4036-34	1
58-A2-2620	Stainless Steel Manual Swivel Dump Chute - Newton 6012SW	1
58-A2-4220	Additional Water Level Gauge - Whelen PSTANK2	3
	There will be one-(1) light installed on each side of the cab, between the front and crew doors, and one-(1) on the rear of the body.	
	The lights will activate with the application of the park brake.	
58-A2-8020	4" Left Rear Direct Tank Fill - Fireman's Friend	1
58-A2-8220	Rear Direct Tank Fill Elbow - Kocheck 4" FNPT RL x 4" Storz SKEP44R-H52	1
58-A2-8420	Rear Direct Tank Fill Adapter - 4" Storz x 2.5" FNH, Kocheck S37S425-P07 (Red)	1
58-A2-8425	Rear Direct Tank Fill Plug - 2.5" NH, CC2552-P07 (Red)	1
60-A0-0000	*** Apparatus Body - General Construction ***	1
60-A2-1020	Apparatus Body - Extruded Aluminum, Tanker	1
60-A2-3020	Apparatus Body Sub Frame - Extruded Aluminum	1
60-A2-3220	Body / Compartment Construction - 102" Wide Body	1
60-A2-3430	Apparatus Body Wheel Well Panels - Painted Aluminum w/ Polished S/S Fenderettes	1
60-A2-4000	*** Compartment Layout ***	1
60-A4-5020	Compartments - Left Side, Tanker (Rescue Style)	1
	L1	
	There will be a compartment located ahead of the rear wheels. The compartment will have an approximate interior dimensions of 62" wide x 74-1/4" high x 15" deep in the upper section and 28" deep in the lower.	
	L2/L3	
	There will be a compartment located above the rear wheels. The compartment will have an approximate interior dimensions of 106" wide x 37" high x 15" deep. This compartment shall have two-(2) usable door openings.	
	L4	
	There will be a compartment located behind the rear wheels. The compartment will have an approximate interior dimensions of 48" wide x 74-1/4" high x 15" deep in the	

PART NO	DESCRIPTION	QTY
	upper section and 28" deep in the lower.	
60-A4-5220	<p>Compartments - Right Side,Tanker (Rescue Style)</p> <p>R1</p> <p>There will be a compartment located ahead of the rear wheels. The compartment will have an approximate interior dimensions of 62" wide x 33" high x 28" deep.</p> <p>R2</p> <p>There will be a compartment located behind the rear wheels. The compartment will have an approximate interior dimensions of 48" wide x 33" high x 28" deep.</p> <p>R3</p> <p>There will be a high side compartment located behind the recessed dump tank storage rack. The compartment will have an approximate inferior dimensions of 33"W x 36" high x 15" deep.</p>	1
60-A4-6000	*** Body Modifications ***	1
60-A6-0050	*** Compartment Doors ***	1
60-A6-0420	Compartment Doors - Painted Roll-Up	7
60-A6-1000	*** Compartment Door Options ***	1
60-A6-1220	<p>Compartment Door Option - Pull Down Straps</p> <p>Locations: L1, L2, L3, L4 and R3</p> <p>Note: Bungee Style</p>	5
60-A6-2000	*** Hose Bed ***	1
60-A6-2020	Apparatus Body Hose Bed - Pumper (67-1/2" Wide)	1
60-A6-4020	Hose Bed Divider w/ Hand Hole	1
60-A6-4420	<p>Hose Bed Cover & End Flap - Hypalon w/ Bungee Cords & Weighted Bottom</p> <p>The cover and end flap will be black in color.</p>	1
60-A6-4425	<p>Endflap Lettering</p> <p>Endflap shall be embroidered with "JCESD3" on the rear. Lime/Yellow Block Font.</p> <p>Reference FT1155</p>	1
60-A6-6000	*** Hose Bed Accessories ***	1
60-A6-6620	<p>Hose Bed Capacity</p> <p>The hose bed will have the capacity to hold the following (left to right): 300' of 3" Combat Sniper Hose, 800-1,000' of 4" LDH</p>	1
60-A6-8000	*** Rear Body Components ***	1
60-A6-8020	Rear Body Construction - Flat Back Design	1
60-A6-8220	Intermediate Rear Step - Aluminum Tread Plate w/ Lights	1
60-A6-8420	<p>Rear Tailboard - Aluminum Tread Plate</p> <p>The tailboard will have a NFPA compliant depth of 12".</p>	1

PART NO	DESCRIPTION	QTY
60-A6-8620	Fixed Step w/ Light - Rear Body Panel The light will activate when the park brake is set. There will also be a switch in the cab to to turn the lights off per NFPA.	4
60-A6-8820	Folding Step w/ Light - Rear Body Panel Locations: One-(1) per side, outboard the dump chute swivel. The light will activate when the park brake is set. There will also be a switch in the cab to to turn the lights off per NFPA.	2
60-A6-9420	Rear Tow Eyes (2) - Black Steel	1
60-A6-9620	Rear Vertical Handrails (2) - Aluminum w/ Backlite Note: Handrails to be backlit Red. Reference FT1155. Handrails to be tied into Brake/Turn Signal Circuit	1
60-A6-9820	Below Hose Bed Handrail - Aluminum w/ Backlite Note: Handrails to be backlit Red. Reference FT1155. Handrails to be tied into Brake/Turn Signal Circuit	1
60-A8-0000	*** Body Trim Components ***	1
60-A8-0220	Body Trim - Extruded Bodies	1
60-A8-0420	Front Body Stone Guards (2)	1
60-A8-0820	Rear Mud Flaps (2)	1
60-A8-1020	Apparatus Body Rub Rail - Aluminum C-Channel	1
60-A8-1220	Folding Step - Front of Body The light will activate when the park brake is set. There will also be a switch in the cab to to turn the lights off per NFPA.	8
60-A8-2020	Front Body Handrail - Aluminum w/ Backlite Note: Handrails to be backlit Red. Reference FT1155.	2
62-A4-0100	*** Ladder / Pike Pole Storage ***	1
62-A4-0420	Ground Ladder / Pike Pole Compartment - Right Side Beside Tank Individual internal compartments will house one-(1) 35' 3-section extension ladder, one-(1) 16' roof ladder, one-(1) 10' folding ladder and two-(2) 8' NY Hooks and (2) 6' NY Hooks	1

PART NO	DESCRIPTION	QTY
62-A4-4020	Pike Pole / Roof Hook Storage Tubes	4
64-A0-0100	*** Suction Hose Storage ***	1
64-A2-1020	Suction Hose Compartments (2) - Above Side Compartments w/ Rear Access Each compartment will hold two-(2) sections of the specified hard suction hose. The driver's side lower section shall be capable of storing the barrel strainer on the on the suction hose.	1
64-A4-0000	*** Portable Tank Storage ***	1
64-A4-4020	Portable Tank Rack - Ziamatic PTS w/ Center Hinge Hardware Kit The dump tank rack will be recess mounted into the officer's side of the body. The rack shall be sized for one-(1) 3,000 gallon aluminum frame Fol-Da-Tank. The rack will be controlled by two-(2) switches located on the officer's side rear of the apparatus, labeled "ON/OFF" and "UP/DOWN". Note: The dump tank rack will be interlocked with the wheel well compartment doors, whereas if they are open the dump tank rack will not operate to prevent injury to personnel or damage to the apparatus.	1
64-A4-4420	Portable Tank Rack Cover - Painted Aluminum	1
64-A6-0000	*** Additional Storage ***	1
64-A6-6220	Body Wheel Well Storage Compartment & Divider - Double Cylinder / Extinguisher Locations: (1) Left Front Body Wheel Well (1) Left Rear Body Wheel Well (1) Right Front Body Wheel Well (1) Right Rear Body Wheel Well (Extinguishers)	4
64-A6-6820	Body Wheel Well Storage Compartment & NO Divider - Equipment Storage Locations: (1) Left Center, Between Tandem (capable of storing complete air pack) (1) (1) Right Center, Between Tandem (capable of storing complete air pack)	2
64-A8-0000	*** Apparatus Body Hardware ***	1
64-A8-2020	600 Pound Roll-Out Tray - Medium Depth Locations: (1) Compartment L1, Floor Mounted (1) Compartment L4, Floor Mounted (1) Compartment R2, Floor Mounted The tray(s) will be mounted on Slide Master slides with a combined capacity of 600-pounds. The tray and the rail system extend 70% out of the compartment.	3

PART NO	DESCRIPTION	QTY
64-A8-4420	Pac Trac Tool Board Locations: (1) L1, Upper Section, Rear Wall (1) L2, Rear Wall (1) L3, Rear Wall (1) L4, Upper Section, Rear Wall (1) R3 Rear Wall	5
94-A8-9220	Tool Box - C-Tech Manufacturing, Model #20192555 Note: Mounted on the left side of the L1 roll-out tray. Tool box measurements: 20"W x 21.82"H x 17.5"D Reference FT1155.	1
94-A8-9225	Rolled Hose Storage Module Dividers to be mounted within the L1 500 lb. roll-out tray, immediately to the left of the C-Tech Tool Box. Tool Box Measurements: 21.82"H x 20"W x 17.5"D. Dividers spaced to contain donut roll of 3" DJ hose and donut roll of 1-3/4" DJ Hose Reference FT1155.	1
== Paint / Graphics - 1025.000 10/03/25 ==		
PAINT / GRAPHICS		
70-A2-0220	Apparatus Body Paint - Single Color	1
70-A2-1020	Body Paint Color / Code - Special The apparatus body shall be painted to match Pierce #90 Red, L4664EY	1
70-A4-0220	Natural Interior Compartment Finish	1
70-A4-4620	1-6-1 Triple NFPA Scotchlite Striping The 6" striping will be white in color. The 1" striping will be white in color.	1
70-A4-6820	Striping Layout - Hockey Stick Design Note: Reference FT1155 for Reflective Striping	1
70-A6-0220	Rear NFPA Chevron Striping	1
70-A6-1820	Rear Chevron Colors - Special The Chevron striping shall be installed in an American Flag design. Reference FT1155 (Engine 31)	1
70-A6-4020	Reflective Material - Designated Walking Surfaces In addition to the designated walking surfaces material, the required DOT red and amber reflectors will be installed.	1
70-A6-6020	Graphics Package The graphics package installed shall match as closely as possible the previous unit	1

PART NO	DESCRIPTION	QTY
	FT1155 (Engine 31).	
	The unit designation on this apparatus is Tanker 31.	
	== Equipment - Tanker - 1025.000 10/03/25 ==	
	LOOSE EQUIPMENT	
82-A2-0000	*** Ground Ladders ***	1
82-A2-0220	10' Folding Attic Ladder - Alco Lite FL-10	1
82-A2-0820	16' Roof Ladder - Alco Lite PRL-16	1
82-A2-1620	35' 3-Section Extension Ladder - Alco Lite PEL3-35	1
90-A2-0000	*** Air Pack Brackets ***	1
90-A2-0220	Air Pack Bracket - Ziamatc ULLH Locations: Cab SCBA Seats	4
90-A4-0000	*** Suction Hose / Strainers ***	1
90-A4-0220	6" x 10' PVC Suction Hose (4) Note: Suction Hose is NH Thread, Male on one End, Female on the Other	1
90-A4-0820	6" Barrel Strainer w/ Bracket - Kochek BS60C / MM601M	1
92-A2-0000	*** Pike Poles / Roof Hooks ***	1
92-A2-2020	6' Roof Hook - Fire Hooks Unlimited RH-6	2
92-A2-2220	8' Roof Hook - Fire Hooks Unlimited RH-8	2
92-A6-0000	*** Portable Tanks ***	1
92-A6-1020	3000 Gallon Portable Tank 22 Oz. HPR w/ Aluminum Frame - Fol-Da-tank FDTA-3000	1
96-A6-0000	*** Booster Hose ***	1
96-A6-1220	1" x 100' Polyester Booster Hose - Niedner REELTEX	1
96-A8-0000	*** Miscellaneous Equipment ***	1
96-A8-0220	DOT Transportation Kit There will be a 24 unit DOT first air kit and emergency road triangles provided with the completed apparatus.	1
96-A8-2020	Folding Wheels Chocks (2) - Ziamatic SAC-44-E	1
96-A8-2220	Wheels Chock Holders (2) - Ziamatic SQCH-44-H The chocks will be located below compartment L1.	1
	== Administartion - 1025.000 10/03/25 ==	

Jefferson County E.S.D. #3

Loose Equipment Quote

Department Discription	Vendor	Model #	Price Each	QTY	Total
1,000' 4" LDH with 4" Storz Connection (Red)	Key Hose	RC40-500 (100' Lengths)	\$885	10	\$8,852
800' Combat Sniper 1-3/4" hose (400 yellow, 400 red)	Key Hose	DP17-100S (50' Section)	\$318	16	\$5,083
300' of 2.5" (yellow)	Key Hose	DP25-1000 (50' Lengths)	\$462	6	\$2,771
(10) Scott 4,500 PSI/45 Min Carbon Bottle	Scott Health & Safety	804722-01	\$1,917	10	\$19,165
(5) Med Scott AV3000 Mask	Scott Health & Safety	201215-22	\$392	5	\$1,960
(1) Water Extinguisher (2.5 gallon)	Buckeye	50000	\$243	1	\$243
(1) ABC Extinguisher (20#)	Buckeye	12120	\$276	1	\$276
(1) 2.5" playpipe (w/ triple stack tip) (2.5" XD Valve Body)	Elkhart	0034XD02 / ST-190-XD	\$1,697	1	\$1,697
(1) SB Chief XD Nozzle (color TBD)	Elkhart	187-XD (66757007)	\$176	1	\$176
(1) Fog Chief XD Nozzle (color TBD)	Elkhart	04XD0F57	\$904	1	\$904
(2) Streamlight Box Lights	Streamlight	44315 (Fire Vulcan LED 180)	\$506	2	\$1,012
3,500 gal Dump Tank Aluminum Frame	Fol-Da-Tank	FTDA-3500-22-HPR (Red)	\$2,587	1	\$2,587
(1) Electric Ice Chest	Igloo	ICF 40	\$529	1	\$529
(1) Blitz Monitor	TFT	XXC-52-NH1	\$4,448	1	\$4,448
(1) Hydrant Adapter (BMT x 4" Storz)	FHS	11279	\$460	1	\$460
(1) Hydrant Adapter (4" NST x 4" Storz)	TFT	AA1SP-NP	\$283	1	\$283
(1) Hydrant Adapter (4.5" NST x 4" Storz)	TFT	AA1SP-NR	\$346	1	\$346
(1) 2.5" Male-Male Adapter	Kochek	36R2525-H52	\$14	1	\$14
(1) 2.5" Female-Female Adapter	Kochek	35R2525-H52	\$28	1	\$28
(1) 2.5" Male - 1-3/4" Female Adatper	Kochek	37R1525-H52	\$13	1	\$13
(1) 2.5" Male - Water Hose Adapter	Kochek	37R25G-H52	\$17	1	\$17
(1) 4" Storz - 2.5" Female Adapter	Kochek	S37S425	INCLUDED WITH TRUCK		
(1) Haligan	Nupla	75.34-026	\$201	1	\$201
(1) Flat Head Axe	Ziamatic	FPC-6-E	\$185	1	\$185
(1) Bolt cutter	Ziamatic	HIT-750-R	\$254	1	\$254
(2) Jet Siphon	Kochek	JS60-P09	\$74	2	\$148
(1) Low Level Floating Strainer	Kochek	FBS60-P07	\$234	1	\$234

TOTAL	\$51,887
--------------	-----------------

Casco Industries, Inc.

Quotation

705 8TH STREET
LA PORTE, TEXAS 77571

281-443-0999

To: Jefferson County ESD #3
Attn: Sean Gray
Fax:
E-Mail: segray91@yahoo.com

Ship to: Same

Date	Quoted By	Date Expected	Ship Via	F.O.B.	Terms
10-23-25	ROBBIE YANCY		Best Way	Shipping Point	NET 30 Days

Qty	Description	Unit Price	Total
10	KURIYAMA-JR400R100-SZ400, Red 4" 100' Rubber Nitrile Hose w/ Storz Couplings	\$655.00	\$6,550.00
8	KEY-DP17-100S-50-Y-NH, Yellow 1.75" 50' Combat Sniper Hose	\$325.00	\$2,600.00
8	KEY-DP17-100S-50-R-NH, Red 1.75" 50' Combat Sniper Hose	\$325.00	\$2,600.00
6	KEY-DP22-TRU-50-Y-NH, Yellow 2.25" 50' TRU-ID Hose	\$355.00	\$2,130.00
1	AMEREX-240, 2.5 Gallon Water Extinguisher	\$155.00	\$155.00
1	AMEREX-A411, 20lb ABC Extinguisher	\$175.00	\$175.00
1	ELKHART-0069XD01, Black XD 2.5" Shut-Off w/ Pistol Grip	\$610.00	\$610.00
1	ELKHART-04XD0251, Orange Chief XD Fog Tip, 250GPM@50PSI	\$710.00	\$710.00

1	ELKHART-66759007, 1.5" XD 1 1/8" Smooth Bore Tip, Short Barrel	\$165.00	\$165.00
2	ELKHART-0033XD01, Black XD 1.5" Shut-Off w/ Pistol Grip	\$475.00	\$950.00
1	ELKHART-04XD0172, Orange Chief XD Fog Tip, 175GPM@50PSI	\$555.00	\$555.00
1	ELKHART-66755007, 1.5" XD 7/8" Smooth Bore Tip, Short Barrel	\$165.00	\$165.00
4	STREAMLIGHT-44311, Vulcan 180 Standard System (Div 2) - 120V/100V AC/12V DC - Includes quick release shoulder strap - Orange	\$255.00	\$1020.00
1	FOL-DA-TANK-FDT-AU-3500-22-V-R, Red 3500 Gallon Folding Tank, Aluminum Frame	\$1,970.00	\$1,970.00
1	TFT-AX1SP-NX, JUMBO BIV 4.0" STORZ RIGID X 6.0"NHF	\$2,700.00	\$2,700.00
1	TFT-XXC-32-NH1, BLITZFIRE COMBO PKG - 2.5"NHF	\$4,900.00	\$4,900.00
1	KOCHEK-S37S44(5.126x4)-H52, 4" Storz x 4"(5.126x4) BEAUMONT THREAD	\$165.00	\$165.00
1	KOCHEK-SPECIAL THREAD SETUP FEE	\$15.00	\$15.00
1	KOCHEK-S37S44-H52, 4" Storz x 4"M	\$165.00	\$165.00
1	KOCHEK-36R2525-H52, 2.5" Double Male	\$38.00	\$38.00
1	KOCHEK-35R2525-H52, 2.5" Double Female	\$75.00	\$75.00
1	KOCHEK-37R1525-H52, 1.5"F x 2.5"M	\$38.00	\$38.00
1	KOCHEK-37RG25-H52, GHT x 2.5"M	\$55.00	\$55.00
2	KOCHEK-37RG25-H52, 4" Storz x 2.5"F	\$155.00	\$310.00
1	FLAMEFIGHTER-FE30, 30" Halligan	\$195.00	\$195.00
1	FLAMEFIGHTER-FHA6R6LB, 6lb Flat Head Axe w/ Rubber Grip	\$50.00	\$50.00
1	FLAMEFIGHTER-BC24, 24" Bolt Cutters	\$45.00	\$45.00
1	TFT-AL92P2P3-SC, 5 WAY MANIFOLD - 4.0"STORZ X 4.0"STORZ	\$4,250.00	\$4,250.00
1	TFT-AS9NJ-SP, SIAMESE 2.5"NHF X 4.0"STORZ	\$765.00	\$765.00
1	KOCHEK-KS34-P09, Set of (4) Storz Wrenches w/ Mount	\$175.00	\$175.00
2	KOCHEK-K48-3-P09, Triple Set Holder, (2) Spanner Wrenches and (1) Adjustable Hydrant Wrench w/ Mount	\$150.00	\$300.00
1	R&B FABRICATIONS-442RD, Red Hydrant Bag w/ Tuff Bottom	\$145.00	\$145.00
1	TFT-A06HMX, FLOATING BARREL STRAINER 6.0"NHF	\$1,015.00	\$1,015.00
1	TFT-A03HMX-JET-F, LOW-LEVEL STRAINER 6.0"NHF WITH JET SIPHON 1.5"NH WITH FLOAT	\$1,350.00	\$1,350.00

6	HUSKY-HTV12X14, Red 12x14 18oz Vinyl Salvage Cover	\$150.00	\$900.00
2	FLAMEFIGHTER-FLHHH04S, 4' NY Roof Hook	\$135.00	\$270.00
2	FLAMEFIGHTER-FLHHH06S, 6' NY Roof Hook	\$160.00	\$320.00
2	FLAMEFIGHTER-FLHHH08S, 8' NY Roof Hook	\$175.00	\$350.00
1	LITTLE GIANT-15417-801, 17' Velocity Ladder w/ Ratchet Levelers	\$395.00	\$395.00
1	KOCHEK-JS40-P09, 4"NH Power Jet Syphon	\$275.00	\$275.00
3	NORTHERN TOOL-103468, Milwaukee M18 Rocket LED Tower Light and Charger, 6000 Lumens, Model# 2136-20	\$485.00	\$1455.00
3	NORTHERN TOOL-51491, Milwaukee M18 REDLITHIUM XC Battery, 5.0Ah	\$160.00	\$480.00

Sub Total	41,551.00
Shipping	PLUS
TOTAL	

ROBBIE YANCY / Sales Representative

H E A T Safety Equipment LLC.

Quotation

5465 Curran Rd.
Von Ormy, Texas 78073
Ph. (210) 624-2320

DATE	Quotation No.
10/30/2025	Q25-00927

NAME / ADDRESS
Jefferson County ESD 3 3554 S Pine Island Rd Beaumont, Tx 77713

P.O. NO.

ITEM	DESCRIPTION	QTY	COST	TOTAL
SCBAATO	X8814025005A04 Certification:NFPA 1981, 2018 Edition Model:Air-Pak X3 Pro (2018), CGA Harness:Padded, Parachute Buckles Pressure:4500 psig Belt:Standard Bag:None Regulator:E-Z Flo+, QD Hose, Rectus EBSS:None Airline:None Spare Harness:No Console:SEMS II Pro Case:No Case Smart Number:X8814025005A04	4	7,213.185	28,852.74
SCBAATO	X8814025005A03 Certification:NFPA 1981, 2018 Edition Model:Air-Pak X3 Pro (2018), CGA Harness:Padded, Parachute Buckles Pressure:4500 psig Belt:Standard Bag:None Regulator:E-Z Flo+, QD Hose, Rectus EBSS:None Airline:None Spare Harness:No Console:SEMS II Pro Case:No Case Smart Number:X8814025005A03	1	7,213.18	7,213.18
804722-01	CGA CYLINDER & VALVE ASSY, CARBON, 4500 PSI, 45 MIN STOCK# 7100293660	10	1,378.972	13,789.72
201215-23	Assy,AV3 HT W/4PT KEV,RED,L	5	339.646	1,698.23
		Total	\$51,553.87	

COASTAL
WELDING SUPPLY
SPECIALTY GAS
AN AWC COMPANY

Quote

For Inquires Contact:

Phone: 409-838-3757

Fax:

www.coastalws.com

10/30/2025

Quote # : 1615806

Page: 1

Customer: JEFFERSON COUNTY ESD #3

Customer #: 27351

Address: WEST RAILROAD
CHINA, TX 77613-0000

Terms: NET 30 DAYS

Ship Method: OUR TRUCK

PO #: QUOTE

Salesperson: BEAUMONT HOUSE ACCOUNT

Item Number	Qty	UOM	Description	Unit Price	Extended
JWH 4403261	1.00	EA	HARRIS PORTABLE TORCH KIT W/CYLS INCLUDES CYLINDERS LESS CONTENTS	585.729	\$585.73
* COMES WITH CYLINDERS AND TOTE					
AC MC	1.00	CYL	MC ACETYLENE PRESTOLITE	23.710	\$23.71
OX R	1.00	CYL	R OXYGEN	10.640	\$10.64
FEE HAZMAT	1.00	EA	HAZMAT COMPLIANCE CHARGE	4.120	\$4.12
FEE APMC	1.00	EA	SURCHARGE FOR APMC	0.450	\$0.45
Subtotal					624.65
Freight					0.00
Delivery					45.00
Total Tax					0.00
Grand Total					\$669.65

ALL PRICES ARE VALID UNTIL 11/29/2025

IMPORTANT: Acceptance of this quotation is subject to standard terms and conditions of Coastal Welding Supply . Prices quoted are based upon quantities specified. Changes in quantity may necessitate price revisions. Coastal Welding Supply is a warranty repair center for most equipment manufacturers, providing on site repairs.

JEFFERSON COUNTY ESD #3

Coastal Welding Supply

DATE: _____ **SIGNATURE:** _____

DATE: _____ **SIGNATURE:** _____

COASTAL
WELDING SUPPLY
SPECIALTY GAS
AN AMI COMPANY

Quote
For Inquires Contact:
Phone: 409-838-3757
Fax:
www.coastalws.com

10/30/2025
Quote # : 1615795
Page: 1

Customer: JEFFERSON COUNTY ESD #3
Customer #: 27351
Address: WEST RAILROAD
CHINA, TX 77613-0000

Terms: NET 30 DAYS
Ship Method: OUR TRUCK
PO #: QUOTE
Salesperson: BEAUMONT HOUSE ACCOUNT

Item Number	Qty	UOM	Description	Unit Price	Extended
JWH 4403261	1.00	EA	HARRIS PORTABLE TORCH KIT W/CYLS INCLUDES CYLINDERS LESS CONTENTS	585.729	\$585.73
* COMES WITH CARRY BAG, CYLINDERS EXTRA COST					
CYL ACMCSALE	1.00	EA	MC ACETYLENE CYLINDER SALE	96.000	\$96.00
CYL OXRSALE	1.00	EA	R OXYGEN CYLINDER SALE	120.000	\$120.00
AC MC	1.00	CYL	MC ACETYLENE PRESTOLITE	23.710	\$23.71
OX R	1.00	CYL	R OXYGEN	10.640	\$10.64
FEE HAZMAT	1.00	EA	HAZMAT COMPLIANCE CHARGE	4.120	\$4.12
FEE APMC	1.00	EA	SURCHARGE FOR APMC	0.450	\$0.45
				Subtotal	840.65
				Freight	0.00
				Delivery	45.00
				Total Tax	0.00
				Grand Total	\$885.65

ALL PRICES ARE VALID UNTIL 11/29/2025

IMPORTANT: Acceptance of this quotation is subject to standard terms and conditions of Coastal Welding Supply . Prices quoted are based upon quantities specified. Changes in quantity may necessitate price revisions. Coastal Welding Supply is a warranty repair center for most equipment manufacturers, providing on site repairs.

JEFFERSON COUNTY ESD #3

Coastal Welding Supply

DATE: _____ **SIGNATURE:** _____

DATE: _____ **SIGNATURE:** _____

[illegible]

Please call or email me with any questions Cell: 409-284-2461 tntrescuebmt@gmail.com				
			Subtotal	\$5,200.00
			Freight	\$185.00
			Total	\$5,385.00

THANK YOU FOR YOUR BUSINESS!



October 2025

Dear Valued Customer,

As part of our ongoing commitment to keep you informed about the latest developments impacting the 3M Scott self-contained breathing apparatus (SCBA) portfolio, we want to provide an update regarding the National Fire Protection Association (NFPA) 1970 Standard on Protective Ensembles for Structural and Proximity Firefighting, Work Apparel, Open-Circuit Self-Contained Breathing Apparatus (SCBA) for Emergency Services, and Personal Alert Safety Systems (PASS), 2025 Edition and how it will impact our SCBA product offering.

Personal Safety Division
3M Scott Fire & Safety
4320 Goldmine Road
Monroe, NC 28110, USA
Phone: 800 247 7257
Web: 3M.com/ScottFire

Corporate Office
3M Center, Building 220-4N-03
St. Paul, MN 55144-1000, USA
Web: 3M.com/WorkerSafety

3M Scott Fire & Safety is dedicated to delivering solutions that meet the highest standards of safety and performance. In line with this commitment, we are pleased to announce that we will continue to offer two Air-Pak™ SCBA platforms for the NFPA 1970, 2025 Edition standard: the X-series and the XD-series.

Both the X-series and XD-series SCBA products are planned for release next year, with shipments beginning on or before March 18, 2026. This date marks the last day we are permitted to ship SCBA labeled as compliant to the NFPA 1981, 2018 Edition standard, allowing for a seamless transition to products meeting and certified to the new standard.

To facilitate your planning and procurement processes, we will tentatively begin accepting orders for SCBA certified to the NFPA 1970, 2025 Edition standard in Q1 2026. This timing is designed to ensure you have ample opportunity to place orders and receive your equipment in a timely manner. Part numbers and pricing information will be made available to 3M authorized channel partners in Q1 2026. We estimate a 5% price increase over our current NFPA SCBA offering.

As part of our strategic approach to better align to customer demand, we will no longer offer an NFPA-certified 2216 PSIG SCBA. Instead, we will be focusing our efforts on advancing the 4500 PSIG and 5500 PSIG platforms, both of which offer enhanced performance and capabilities.

For those customers currently using a 2216 PSIG SCBA, we remain committed to supporting you through the life of your product. We will continue to provide service and support for your existing equipment to ensure its optimal performance and longevity.

Should you have any questions or require further information, please do not hesitate to contact us using the information below.

Thank you for your continued trust in 3M Scott SCBA products.

Click [here](#) for details on the changes required in the NFPA 1970 standard.



Sincerely,

3M Scott Fire & Safety
Personal Safety Division

3M Scott Fire & Safety
Customer Service: 1-800-247-7257, option 3
3msupport.scott.us@mmm.com

Technical Support: 1-800-247-7257, option 4
scotttechsupport@mmm.com

3M Personal Safety Division
Customer Service: 1-800-328-1667
Technical Service: 1-800-243-4630

3M Canada
Customer Service: 1-800-364-3577
Technical Service: 1-800-267-4414

5615 College St. / Beaumont, TX 77707

Phone - (409) 842-3790 / Fax -- (409) 842-1991

Lindasterling1@yahoo.com

October 16, 2025

Jefferson County ESD # 3

Attn: Phillip Kibodeaux

Dear Phillip,

This is the price which you requested.

	<u>Each</u>	<u>Total</u>
1 – Viking VM-8000 VHF 700/800 MHZ Mobile Radio w/ KCH-19 Remote Head, 17' Remote Cable, KES-5A Speaker & GPS /Wi-Fi/ Blue Tooth Antenna.	\$5,624.32	\$5,624.32
1 – Multi-Band NMO Antenna	\$ 92.00	\$ 92.00
1 – Labor to Install	\$ 150.00	\$ <u>150.00</u>
Total Purchase Price		\$5,866.32

If you have any questions about this quote, or any other type of Mobile Communication needs, Please don't hesitate to give me a call.

Thanks & have a great day!

Linda Sterling/Ricky Adams

Jefferson County ESD 3
New Tanker 31

Company	Price
US Fire App.	\$678,708.00
Heat Safety	\$51,553.87
Coastal Welding	\$885.65
Advanced Rescue	\$5,385.00
Casco	\$41,551.00
United Communications	\$5,866.23
Total	\$783,949.75
Grant	-\$285,000.00
ESD Funding	\$498,949.75



Jefferson County ESD NO. 3

November 5, 2025

Re: Financing for Fire Truck

We are pleased to offer the following preliminary overview of the financing terms:

Issuer: Jefferson County ESD NO. 3, TX
Lender: Government Capital Corporation
Financing structure: Tax Exempt Financing-775.085
Project Description: Fire Truck

Project Pricing Estimate: \$498,949.75

Term:	5 Years	7 Years	10 Years
Annual Payments:	\$116,186.21	\$87,466.83	\$66,178.68
Interest Rate Indication:	5.295%	5.395%	5.495%
Payments Commencing:	One year from contract date and annually thereafter		

The above terms assume qualifications under 265(b)3 of the Internal Revenue Code, underwriting approval and mutually acceptable documentation. Proposed funding considers all cost of borrowing. The rates outlined herein are good for 14 days from the date on the proposal.

Our team is prepared to move forward or provide other terms for consideration as needed.

Thank you for the opportunity.

Sincerely,

Landon Newton
Government Capital Corporation
345 Miron Dr
Southlake, Texas 76092
(817) 722-0213 Direct
Landon.Newton@govcap.com

The transaction described herein is an arm's length, commercial transaction between you and Government Capital Corporation ("GCC"), in which GCC: (i) is acting solely for its own financial and other interests that may differ from yours; (ii) is not acting as your municipal advisor or financial advisor, and has no fiduciary duty to you with respect to this transaction; and (iii) is not recommending that you take an action with respect to this transaction.