



NB NOT FOR CONSTRUCTION
- STRUCTURAL GRID SHOWN
INDICATIVELY. EXACT SETTING
OUT DIMENSIONS TO BE
CONFIRMED BY STRUCTURAL
ENGINEER

MVHR ducts shown indicatively
with high level inlet running
under ridge line within hall, and
horizontal outlet below inner
window to upper room. Refer
M&E Engineering drawings and
specification for full details.

Existing stone boundary
wall with decorative piers,
stone coping and arched
opening to remain.

Section of flat roof
recessed between new
hall and existing stone
boundary wall.

Glazed gable at high level
with external timber
louvres.

Section Line
B

Cylindrical ventilation
duct at high level under
ridge. Refer to M&E
engineer's drawings.

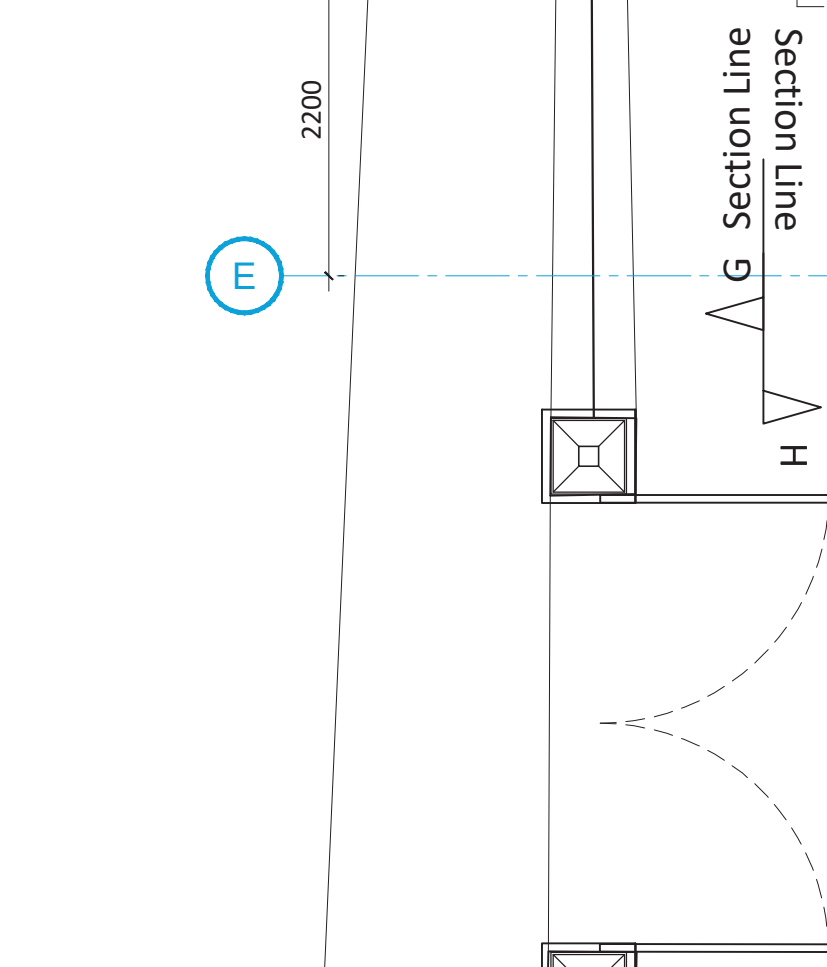

Section Line
G

Glazed gable at high level
to north elevation of hall
with external timber
louvres.

Section Line
A

Section Line
B

Section Line
C

Section Line
D

Section Line
E

Section Line
F

Section Line
G

Section Line
H

01

02

03

04

05

06

07

912 4905 823 280 3460 530

Glazed gable at high level
to north elevation of hall
with external timber
louvres.

Existing stone boundary
wall with decorative piers,
stone coping and arched
opening to remain.

Section of flat roof
recessed between new
hall and existing stone
boundary wall.

Glazed gable at high level
with external timber
louvres.

East elevation of hall
with inner stud wall to
conceal MVHR
ductwork, clad with
acoustic timber wall
panels.

VOID OVER HALL

Bespoke timber
framed window to
meeting room with
60min Fire Protection

MTG
ROOM/
OFFICE

MVHR

Glazed gable at high level
to south elevation of hall
with external timber
louvres.

Overhanging roof and
external steel column to
projecting office and
entrance lobby

Emergency egress
opening window at
first floor.

COURTYARD

Section Line
E

Section Line
F

Section Line
G

Section Line
H

Section Line
C

Section Line
F

06

07

MVHR at first floor level
within dormer roof with 4 No.
ventilation ducts. Refer to
M&E Engineers specification
and drawings for full details.

Fresh air inlet at high level in
apex of gable, air out at
lower level in east wall.

SVP up to vent tile terminal
in roof.

Glazed gable to stairwell.

Ventilation duct shown
routed to vent at top panel
of gable window. Refer to
M&E Engineer's drawings
for details.

Section Line
B

Meeting Room MVHR
unit within eaves. Ducts
routed to and from
meeting room, out
through vent in east
wall, and in through
apex of glazed gable.
Refer to M&E engineers
drawings.

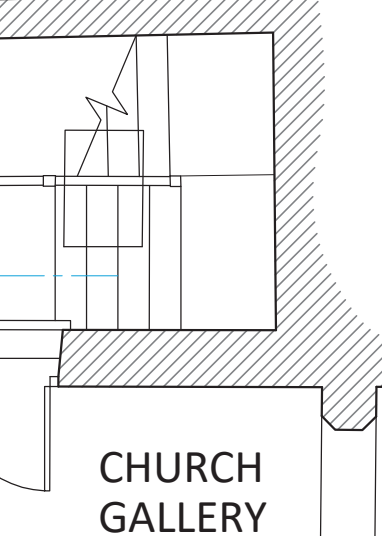

CHURCH
GALLERY

ORGAN

Section Line
F

Section Line
G

Section Line
H

FIRST FLOOR PLAN

Scale- 1:50



CHEDBURN•CODD
CONSERVATION ARCHITECTS
Historic Building Consultants

Glove Factory Studios, 1 Brook Lane, Holt,
Bradford-on-Avon, Wiltshire BA14 6RL
T: 01225 859999 www.chedburn.com e: chedburn@chedburn.com

PRELIMINARY

Project	St Aldhelm's Parish Hall Malmesbury
Drawing	First Floor Plan As Proposed
Stage	Tender
Drawing No.	2220/51
Scale	1:50 @ A2
Date	Aug 2024