

NOTES

1. SCALED INSULATION DIMENSIONS MUST NOT BE TAKEN FROM THIS DRAWING.
2. THIS DRAWING MUST BE READ IN CONJUNCTION WITH ALL RELEVANT DRAWINGS, DOCUMENTS AND INFORMATION PREPARED BY THE ARCHITECT AND OTHER CONSULTANTS.
3. ANY DISCREPANCY ON THIS DRAWING MUST BE REFERRED TO THE SUPERVISING OFFICER AND CLARIFICATION OBTAINED BEFORE COMMENCEMENT OF WORK.

LEGEND

- Ⓐ EXISTING CEILING MOUNTED PENDANT SET
- Ⓑ EXISTING CEILING MOUNTED RECESSED DOWN LIGHT
- Ⓒ EXISTING CEILING MOUNTED EXTERNAL BULBHEAD LIGHT
- Ⓓ EXISTING WALL MOUNTED FLOOD LIGHT
- Ⓔ EXISTING WALL MOUNTED SPOT LIGHT
- Ⓕ EXISTING ONE WAY WALL SWITCH
- Ⓖ EXISTING LIGHTING CONTROL PIR UNIT
- Ⓗ EXISTING CONSUMER UNIT POSITION
- Ⓘ EXISTING CONDUCTOR WITH ISOLATOR
- Ⓚ EXISTING 13W SWITCHED SOCKET OUTLET
- Ⓛ EXISTING SINGLE SWITCHED SOCKET OUTLET
- Ⓜ EXISTING SWITCHED CONNECTION UNIT
- Ⓝ EXISTING LOW VOLTAGE SUBMAIN CABLE
- Ⓟ EXISTING TELECOMS CABLE
- Ⓡ EXISTING IP66 ADAPTABLE JUNCTION BOX
- Ⓢ EXISTING ELECTRIC PANEL HEATER
- Ⓣ EXISTING ELECTRIC UNDER SINK WATER HEATER
- Ⓤ EXISTING WALL MOUNTED EXTRACT FAN

GREY SYMBOLS DENOTE EXISTING ELECTRICAL SERVICES TO BE REMOVED IN FULL

- Ⓜ EXISTING CONSUMER UNIT POSITION TO REMAIN
- Ⓜ EXISTING ENERGY METER POSITION TO REMAIN
- EXISTING INCOMING LV ELECTRICAL SUPPLY POSITION TO REMAIN
- Ⓡ EXISTING COPPER EARTHING ROD FOR TT SYSTEM
- Ⓡ EARTH CONNECTION FOR INCOMING LV ELECTRICAL SUPPLY TO REMAIN
- Ⓡ BUILDING TO BE DEMOLISHED AND REPLACED WITH NEW PARISH HALL

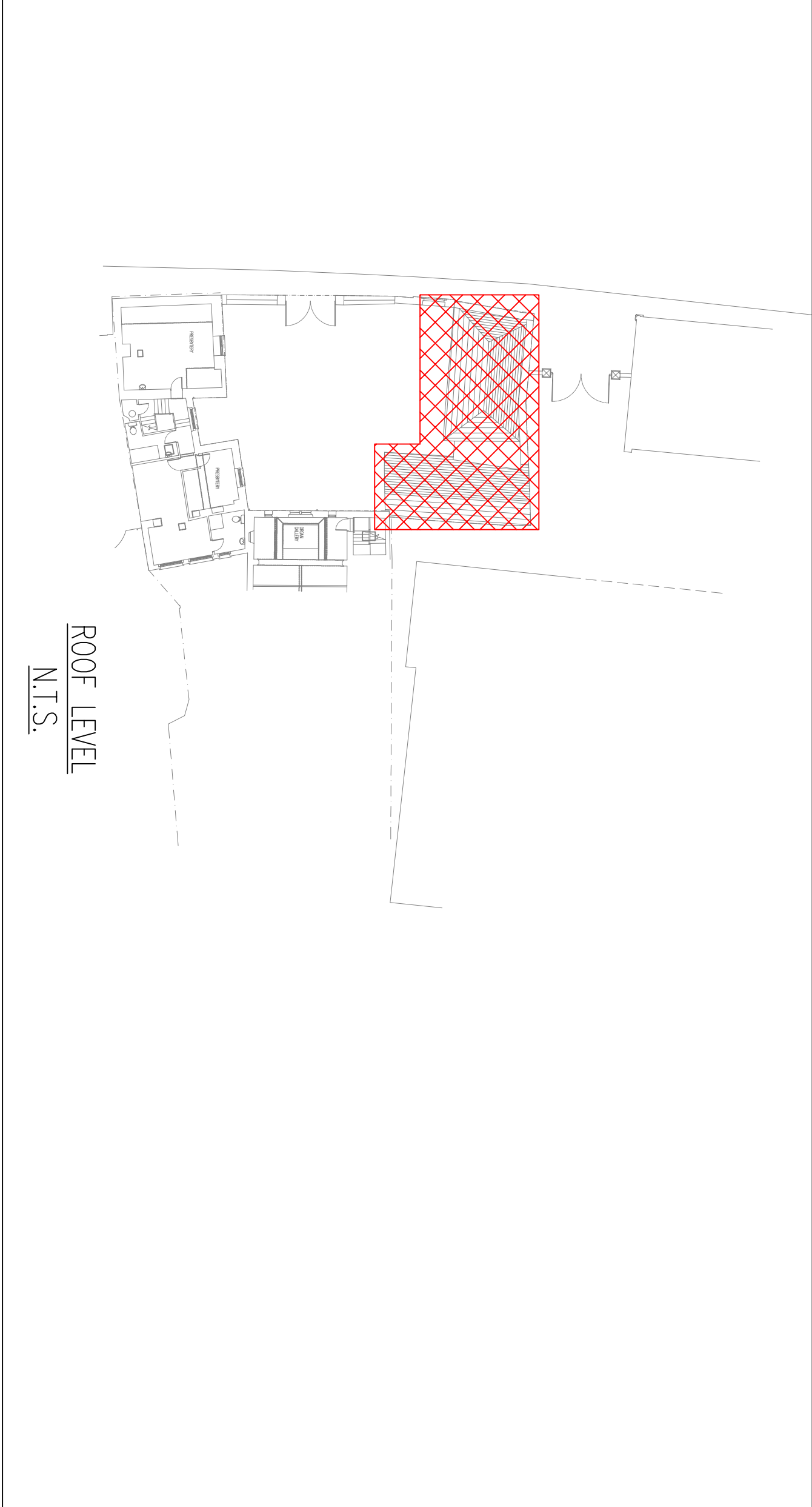
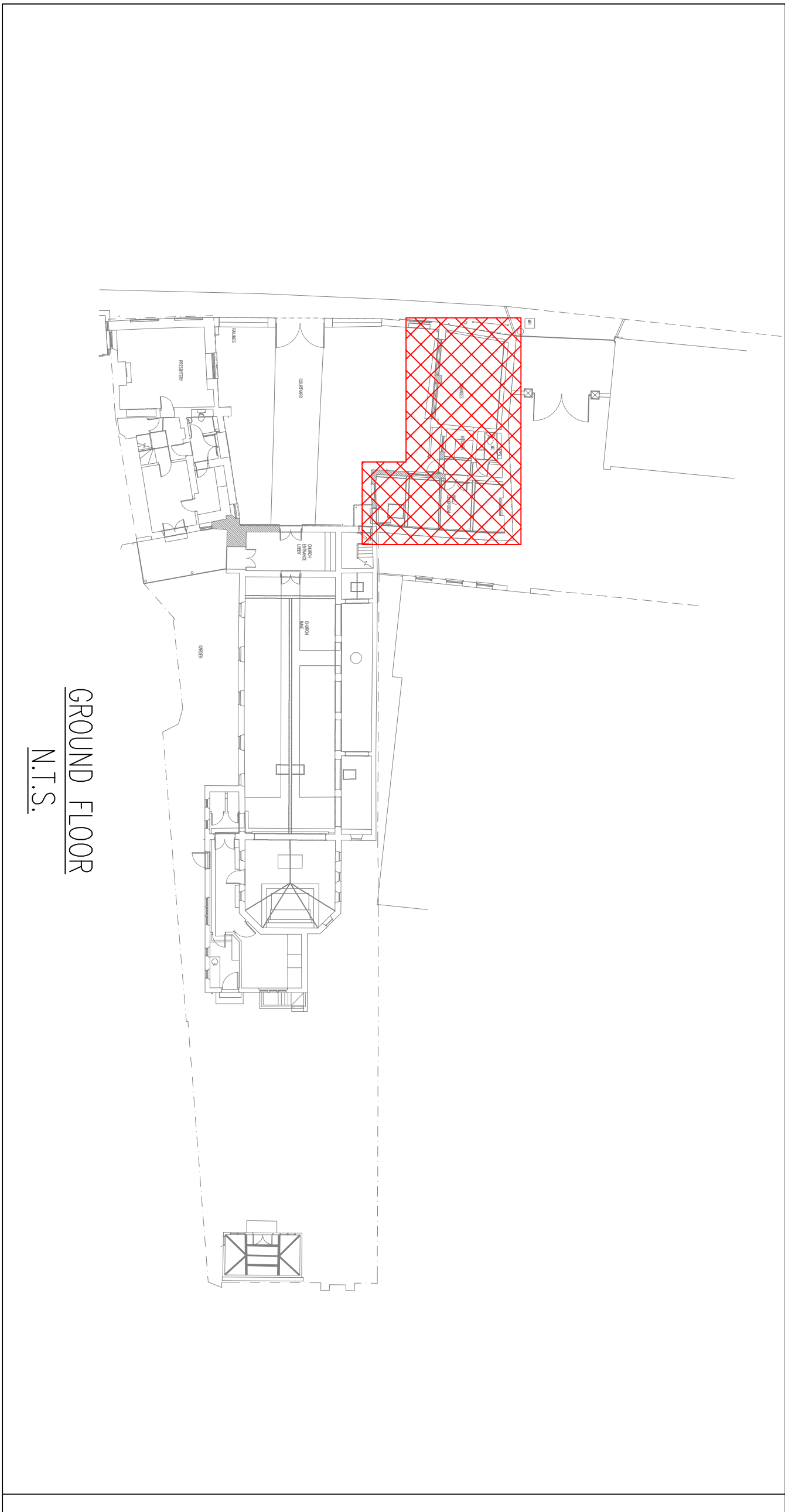

PROJECT TITLE	ST ALDELM'S CHURCH NEW PARISH HALL
DRAWING TITLE	EXISTING ELECTRICAL SERVICES TO BE REMOVED LAYOUT GROUND FLOOR
DRAWING NUMBER	24/1998/E/05
REVISION	
BASED ON BUILDING OUTLINE REF:	THE WELT HOUSE MAJOR COURTYARD STRATTON-ON-THE-FOSSE BATH BA3 4JF 01781 289189 mial@bjp-uk.com www.bjp-uk.com
TENDER ISSUE	DRAWN: PJH APPROVED: ALC DATE: OCT 2024 SCALE: 1:50