

Adem

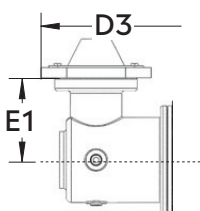

STDID / DCID

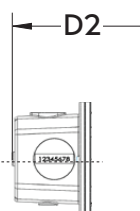

STD CTR
END INDEX

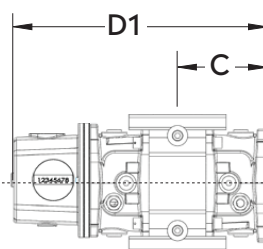

STD CTR
SIDE INDEX

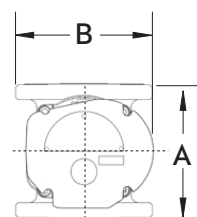

Note: AMI/AMR adaptors available upon request.

METER SIZE	ANSI 125 FF FLANGE	A	B	C	D1	D2	D3	D4	E1	WEIGHT (lbs)
RMT55	2"	6.75"	6.88"	5.33"	14.12"	15.60"	17.06"	17.26"	4.00"	20.30

SOFT METRIC RMT55 2" FLANGE CONNECTION

TECHNICAL SPECIFICATION

Connection (Flange)	ANSI 125 FF	2"
MAOP	(kPa)	1206
Flow Capacity	(m ³ /h)	55
Rangeability * @ ±2% / ±1% Error		1:145 / 1:100
Start Rate	(m ³ /h)	0.012
Stop Rate	(m ³ /h)	0.010
Differential @ 100 % Flow [AIR/N.G.]	(Pa)	197 / 117
Instrument Drive Rate	(m ³ /rev)	0.1
LF Pulser (Optional)	(m ³ /pulse)	0.1

*Note: It should be noted, that moving parts in the meters with a greater rangeability ratio are made to high class accuracy and tight tolerances.
Improper installation, stresses on piping system due to temperature changes, settling and gas conditions can create a risk of meter rejection.

CORRECTED FLOW CAPACITY AND TYPICAL ACCURACY GUIDE

RMT55 METER (Sm ³ /h)	
Gauge Pressure kPa 1.72	RMT55 Q _{max} = 55m ³ /h
5	57.5
10	60.2
50	82.0
100	109.1
150	136.2
200	163.3
250	190.5
300	217.7
500	326.2
750	461.9
1000	597.6
1100	651.9
1200	706.2

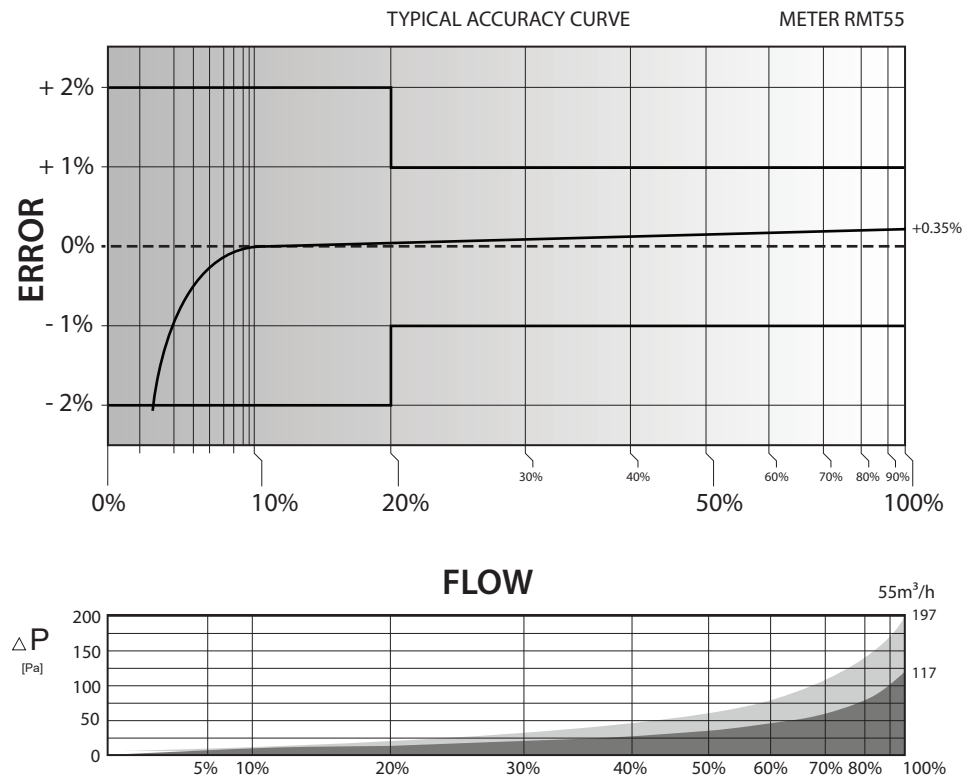

ROMET[®]
Innovate. Lead. Transform.

GAS METERS AND ELECTRONIC INSTRUMENTS

Phone 905-624-1591 USA 1-800-387-3201

www.rometlimited.com • email: romet@rometlimited.com

The values quoted are typical of normal production. They do not constitute a specification. Romet Limited reserves the right to change any information in this literature without notice. All of the information and data in this literature has been carefully compiled and thoroughly checked. However, Romet Limited will not assume responsibility for any possible omissions or errors.

ROMET and ROMET & DESIGN are registered trademarks of Romet Limited. Romet Limited's gas metering technology is protected under U.S. Patent No. 4,910,519 and 6,453,721 and Canadian Patent No. 1,293,568.