

Adem

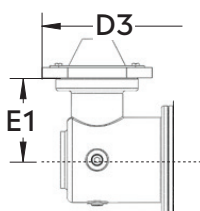

STDID / DCID

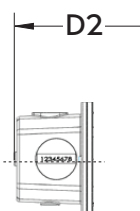

STD CTR
END INDEX

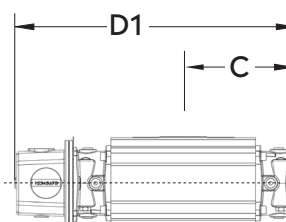

STD CTR
SIDE INDEX

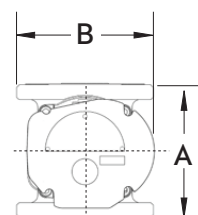

Note: AMI/AMR adaptors available upon request.

METER SIZE	ANSI 125 FF FLANGE	A	B	C	D1	D2	D3	D4	E1	WEIGHT (lbs)
RMT450	4"	9.5"	8.25"	10.27"	24.02"	25.50"	26.96"	27.16"	4.00"	70.5-76.5

Meets or exceeds ANSI B109.3

SOFT METRIC RMT450 4" FLANGE CONNECTION

TECHNICAL SPECIFICATION

Connection (Flange)	ANSI 125 FF	4"
MAOP	(kPa)	1206
Flow Capacity	(m ³ /h)	450
Rangeability * @ ±2% / ±1% Error		1:200 / 1:150
Start Rate	(cfh)	0.061
Stop Rate	(cfh)	0.037
Differential @ 100 % Flow [AIR/N.G.]	(Pa)	665 / 399
Instrument Drive Rate	(m ³ /rev)	0.1
LF Pulser (Optional)	(m ³ /pulse)	0.1

*Note: It should be noted, that moving parts in the meters with a greater rangeability ratio are made to high class accuracy and tight tolerances. Improper installation, stresses on piping system due to temperature changes, settling and gas conditions can create a risk of meter rejection.

CORRECTED FLOW CAPACITY AND TYPICAL ACCURACY GUIDE

RMT450 METER (Sm ³ /h)	
Gauge Pressure kPa 1.72	RMT450 Q _{max} = 450m ³ /h
5	470.8
10	493.0
50	670.6
100	892.7
150	1114.7
200	1336.8
250	1558.8
300	1780.9
500	2669.1
750	3779.4
1000	4889.7
1100	5333.8
1200	5777.9

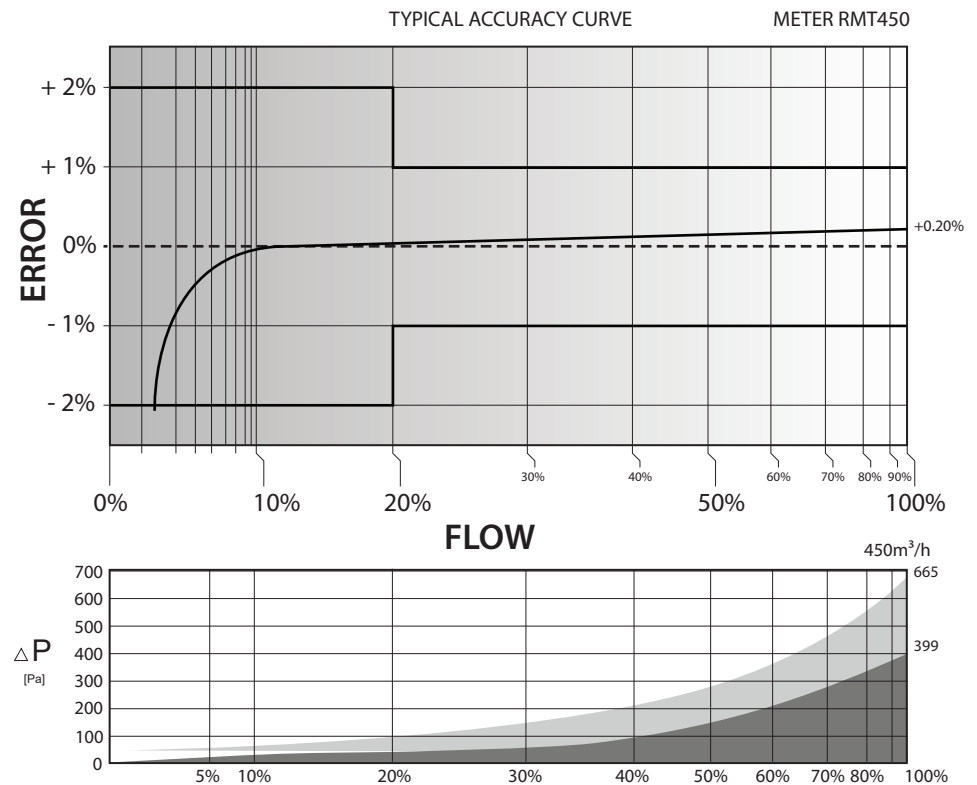

ROMET[®]
Innovate. Lead. Transform.

GAS METERS AND ELECTRONIC INSTRUMENTS

Phone 905-624-1591 USA 1-800-387-3201

www.rometlimited.com • email: romet@rometlimited.com

The values quoted are typical of normal production. They do not constitute a specification. Romet Limited reserves the right to change any information in this literature without notice. All of the information and data in this literature has been carefully compiled and thoroughly checked. However, Romet Limited will not assume responsibility for any possible omissions or errors.

ROMET and ROMET & DESIGN are registered trademarks of Romet Limited. Romet Limited's gas metering technology is protected under U.S. Patent No. 4,910,519 and 6,453,721 and Canadian Patent No. 1,293,568.