

**Special 2" Flange Connections**

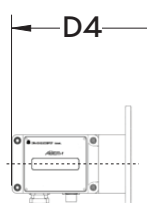

Adem

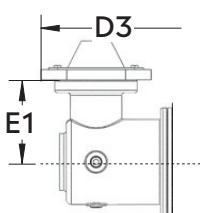

STDID / DCID

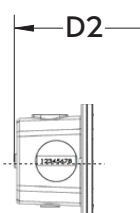

STD CTR  
END INDEX

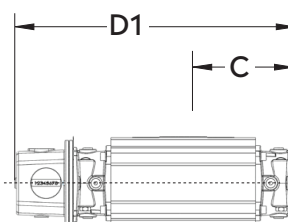

STD CTR  
SIDE INDEX

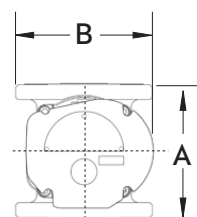

Note: AMI/AMR adaptors available upon request.

| METER SIZE | ANSI 125 FF FLANGE | A     | B     | C     | D1     | D2     | D3     | D4     | E1    | WEIGHT (lbs) |
|------------|--------------------|-------|-------|-------|--------|--------|--------|--------|-------|--------------|
| RMT140     | 2"                 | 6.75" | 6.88" | 8.22" | 19.90" | 21.38" | 22.84" | 23.04" | 4.00" | 33-43        |

Patent Pending USA

**Increase capacity without rebuilding the meter set**

# SOFT METRIC RMT140 2" FLANGE CONNECTION

## TECHNICAL SPECIFICATION

| Connection (Flange)                  | ANSI 125 FF             | 2"          |
|--------------------------------------|-------------------------|-------------|
| MAOP                                 | (kPa)                   | 1206        |
| Flow Capacity                        | (m <sup>3</sup> /h)     | 140         |
| Rangeability * @ ±2% / ±1% Error     |                         | 1:250/1:200 |
| Start Rate                           | (m <sup>3</sup> /h)     | 0.034       |
| Stop Rate                            | (m <sup>3</sup> /h)     | 0.010       |
| Differential @ 100 % Flow [AIR/N.G.] | (Pa)                    | 299 / 179   |
| Instrument Drive Rate                | (m <sup>3</sup> /rev)   | 0.1         |
| LF Pulser (Optional)                 | (m <sup>3</sup> /pulse) | 0.1         |

Meets or exceeds ANSI B109.3

\*Note: It should be noted, that moving parts in the meters with a greater rangeability ratio are made to high class accuracy and tight tolerances. Improper installation, stresses on piping system due to temperature changes, settling and gas conditions can create a risk of meter rejection.

### CORRECTED FLOW CAPACITY AND TYPICAL ACCURACY GUIDE

| RMT140 METER (Sm <sup>3</sup> /h) |                                                      |
|-----------------------------------|------------------------------------------------------|
| Gauge Pressure<br>kPa<br>1.72     | RMT140<br>Q <sub>max</sub> =<br>140m <sup>3</sup> /h |
| 5                                 | 146.4                                                |
| 10                                | 153.4                                                |
| 50                                | 208.6                                                |
| 100                               | 277.7                                                |
| 150                               | 346.8                                                |
| 200                               | 415.9                                                |
| 250                               | 485.0                                                |
| 300                               | 554.0                                                |
| 500                               | 830.4                                                |
| 750                               | 1175.8                                               |
| 1000                              | 1521.2                                               |
| 1100                              | 1659.4                                               |
| 1200                              | 1797.6                                               |

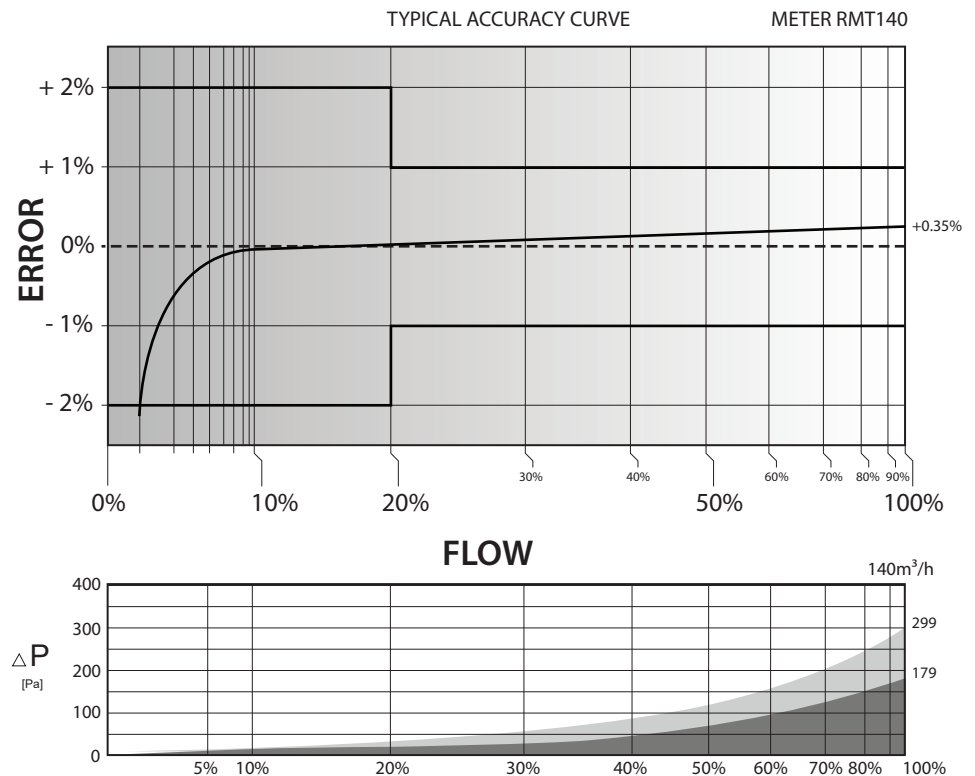

**ROMET**<sup>®</sup>  
Innovate. Lead. Transform.

#### GAS METERS AND ELECTRONIC INSTRUMENTS

Phone 905-624-1591 USA 1-800-387-3201

www.rometlimited.com • email: romet@rometlimited.com

The values quoted are typical of normal production. They do not constitute a specification. Romet Limited reserves the right to change any information in this literature without notice. All of the information and data in this literature has been carefully compiled and thoroughly checked. However, Romet Limited will not assume responsibility for any possible omissions or errors.

ROMET and ROMET & DESIGN are registered trademarks of Romet Limited. Romet Limited's gas metering technology is protected under U.S. Patent No. 4,910,519 and 6,453,721 and Canadian Patent No. 1,293,568.

TS-06 Rev 1, November 2025