

# sheltonhomes

CREATING *modern* QUEENSLANDERS

Est. 1995

## THE WATTLE 1.1



# THE WATTLE 1.1

The Wattle 1.1 is a unique Queenslander home that offers an impressive façade, featuring a traditional bay window.

The Wattle 1.1 floorplan is unique for many reasons. It utilises space and angles in a way that maximise space and evokes creativity. Bedroom 2, 3, 4 and 5 have built-in wardrobes and share their own wing with a main bathroom, ensuring guests or children have the ultimate convenience and comfort. The laundry offers a large amount of working space with a designated linen storage room.

The curved kitchen bench connecting you to the meals, living and verandah provides a truly spectacular feature to this space. The separate rumpus has its own deck, making it a perfect space to retreat or send the kids to hangout.

|                  |                     |
|------------------|---------------------|
| EXTERIOR WIDTH   | 25.64m              |
| LENGTH           | 16.34m              |
| TOTAL FLOOR AREA | 316.4m <sup>2</sup> |

5  | 2  | 1 

**sheltonhomes**  
CREATING *modern* QUEENSLANDERS

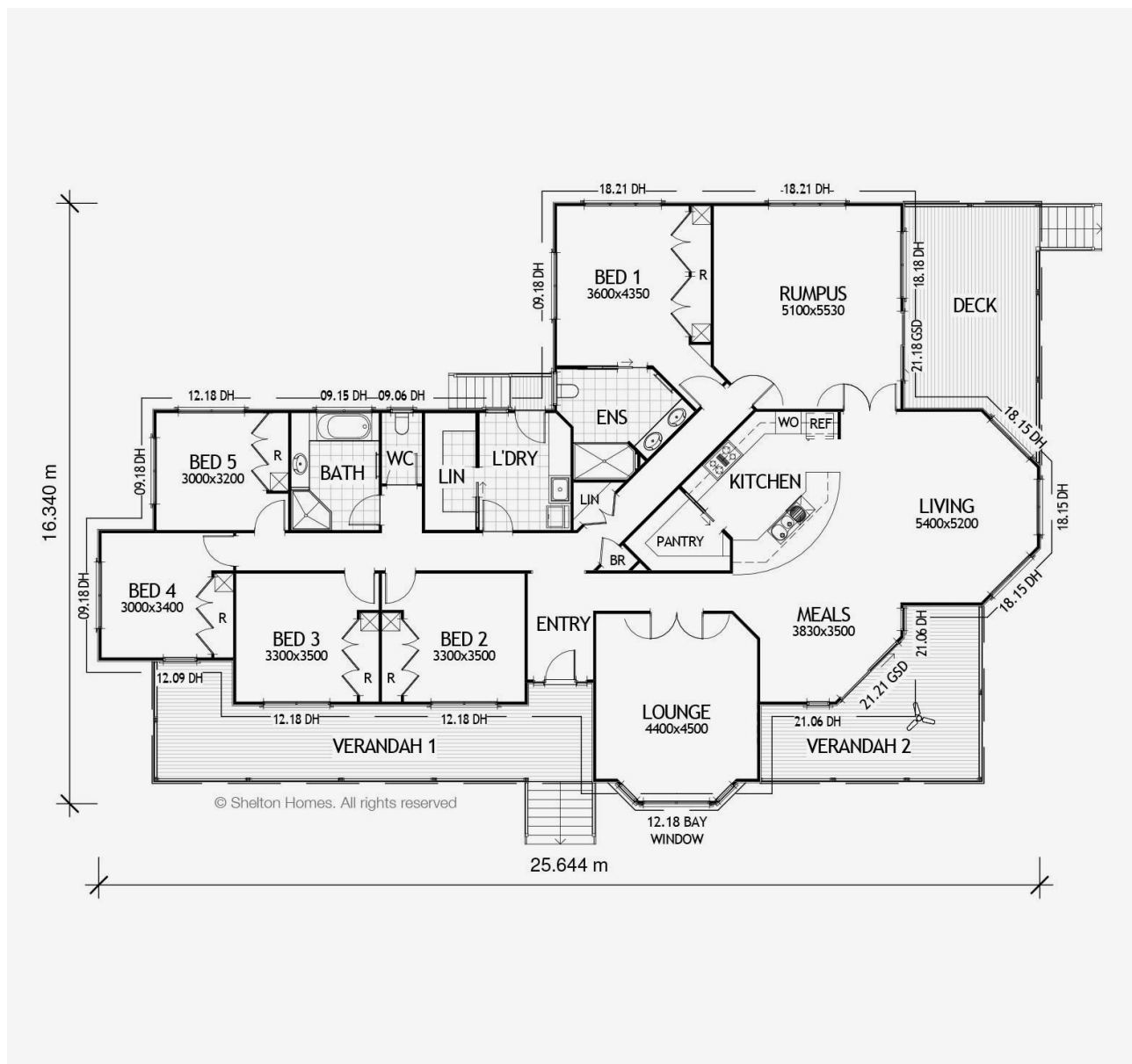

Please Note: The floor plan provided is for illustrative purposes only and is not drawn precisely to scale. However, the overall length and width can be assumed to be accurate. It is the home owner's responsibility to ensure that the house will fit on their land and that all applicable council regulations and estate requirements are met. The image of the façade is for illustrative purposes only and may contain items or finishes which may or may not be standard inclusions.



BUILD A HOME THAT  
FINALLY FEELS LIKE  
*home*

Simply call or email  
Scott and the team

0417 961 667

[scott@sheltonhomes.com.au](mailto:scott@sheltonhomes.com.au)

**shelton**homes  
CREATING *modern* QUEENSLANDERS