

sheltonhomes

CREATING *modern* QUEENSLANDERS

Est. 1995

THE SPRINGSIDE



THE SPRINGSIDE

The Springside is a stunning home that offers an impressive Queenslander façade, featuring a traditional verandah.

The Springside floorplan is a spacious and luxurious design. This plan offers all the practicality and modernism without losing the traditionalism of the Queenslander design.

The built-in garage with twin access into the home, large office, spacious rumpus room, butler's pantry and large amounts of storage are a favourite for many who have chosen this design. Each bedroom features its own walk-in wardrobe. The main bedroom offers a uniquely stylish design that ensures you have the ultimate level of practicality, including a walk-in wardrobe and ensuite.

EXTERIOR WIDTH 21.24m

LENGTH 23.24m

TOTAL FLOOR AREA 427.56m²

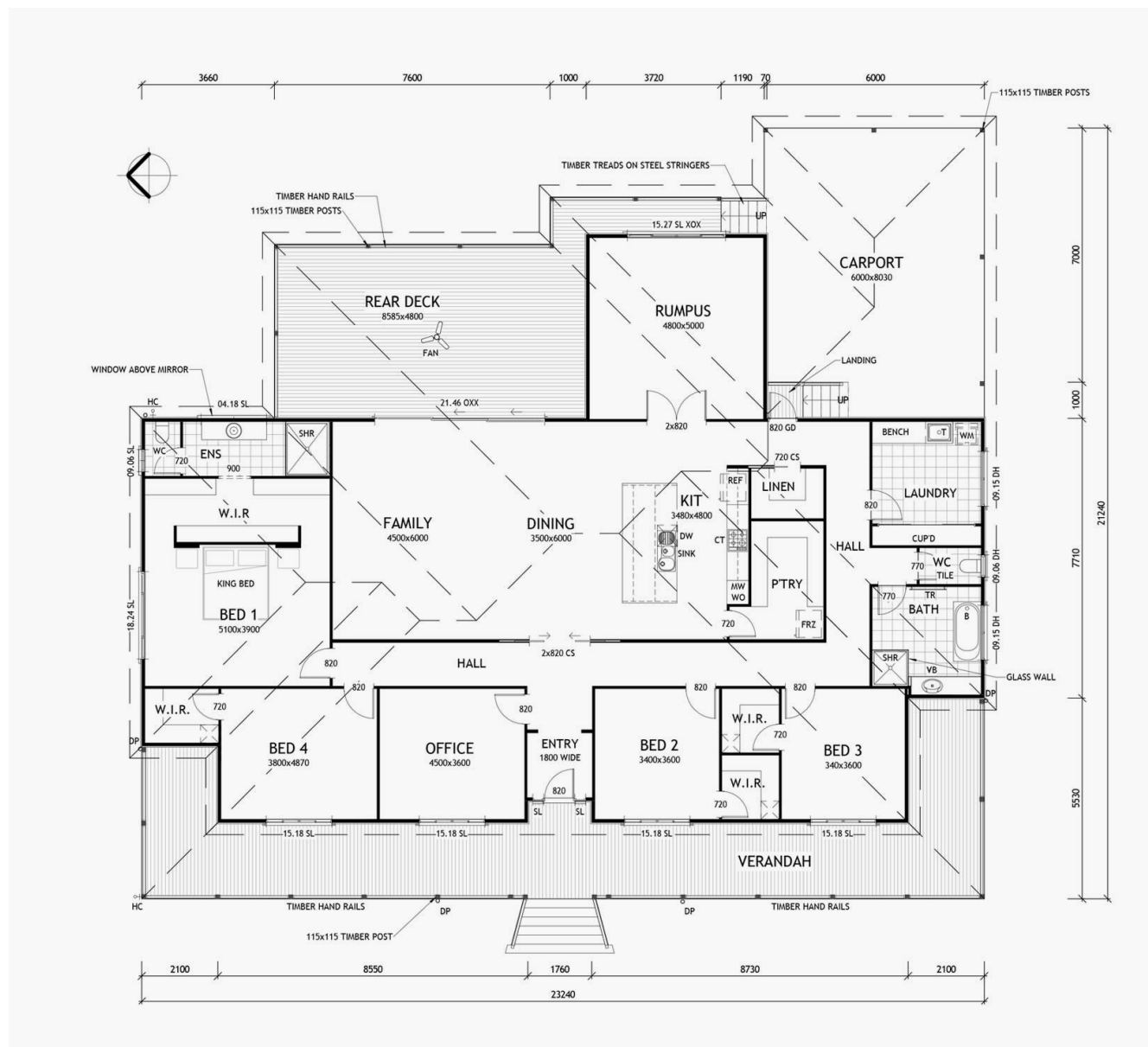

sheltonhomes
CREATING *modern* QUEENSLANDERS

Please Note: The floor plan provided is for illustrative purposes only and is not drawn precisely to scale. However, the overall length and width can be assumed to be accurate. It is the home owner's responsibility to ensure that the house will fit on their land and that all applicable council regulations and estate requirements are met. The image of the façade is for illustrative purposes only and may contain items or finishes which may or may not be standard inclusions.



BUILD A HOME THAT
FINALLY FEELS LIKE
home

Simply call or email
Scott and the team

0417 961 667

scott@sheltonhomes.com.au

sheltonhomes
CREATING *modern* QUEENSLANDERS