

sheltonhomes

CREATING *modern* QUEENSLANDERS

Est. 1995

THE KLEINTON



THE KLEINTON

The Kleinton is an elegant shaped Queenslander home.

Enjoy expansive front and back Queenslander verandahs all in 1 home design. This home welcomes guests into the open plan living immediately once you step inside, allowing you to see through the home and into your beautiful backyard. This clever design utilises space like never before from walk-in-ropes to a butlers pantry and rumpus room, you won't be short on smart space in this home.

EXTERIOR WIDTH 24.15m

LENGTH 19.92m

TOTAL FLOOR AREA 403.39m²

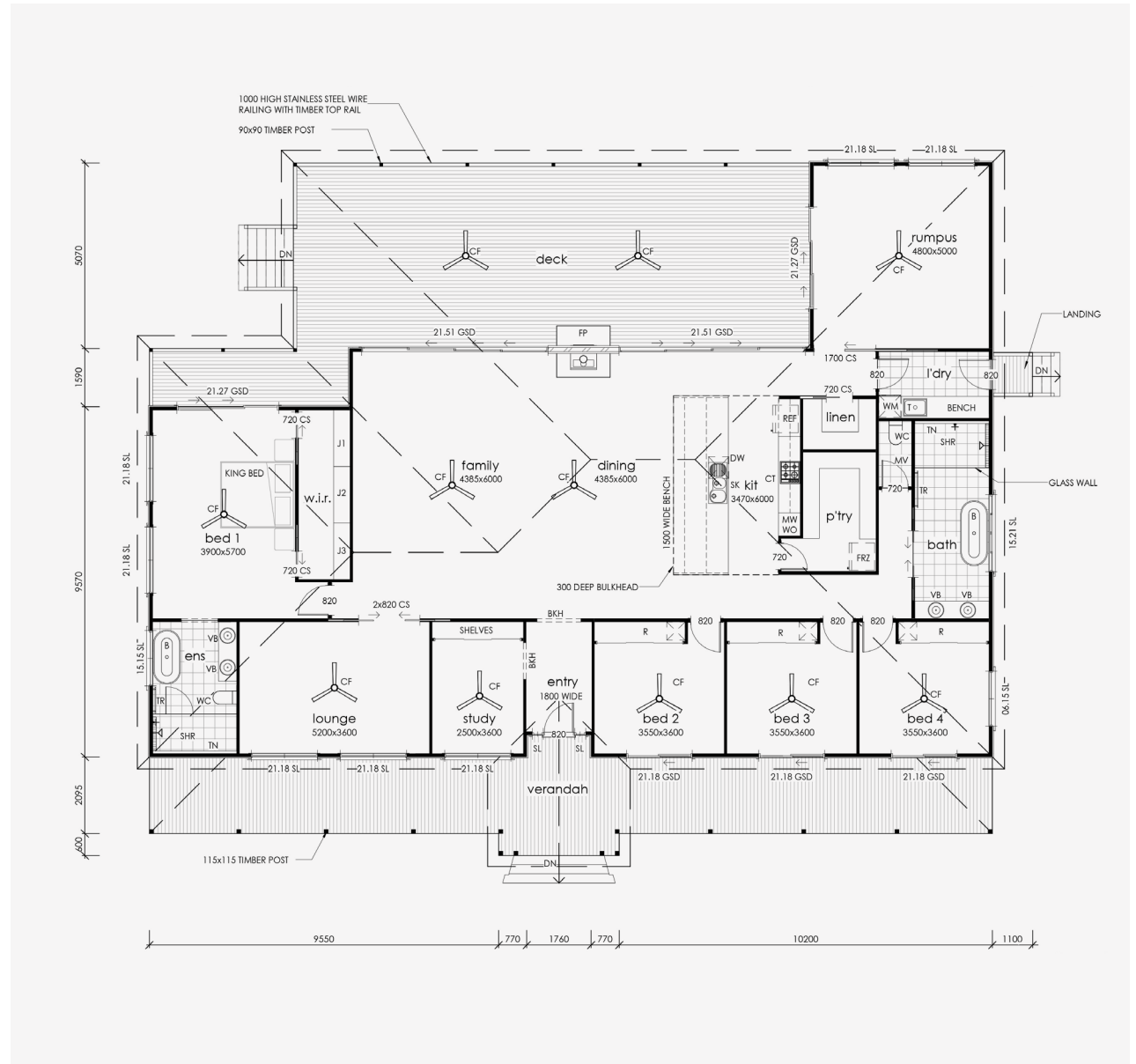

sheltonhomes
CREATING *modern* QUEENSLANDERS

Please Note: The floor plan provided is for illustrative purposes only and is not drawn precisely to scale. However, the overall length and width can be assumed to be accurate. It is the home owner's responsibility to ensure that the house will fit on their land and that all applicable council regulations and estate requirements are met. The image of the façade is for illustrative purposes only and may contain items or finishes which may or may not be standard inclusions.



BUILD A HOME THAT
FINALLY FEELS LIKE
home

Simply call or email
Scott and the team

0417 961 667
scott@sheltonhomes.com.au

sheltonhomes
CREATING *modern* QUEENSLANDERS