

sheltonhomes

CREATING *modern* QUEENSLANDERS

Est. 1995

THE KIRRA 1.1



THE KIRRA 1.1

The Kirra 1.1 is one of our slab home designs. The floorplan has truly maximised every inch of space in the most creative way possible.

This home offers 4 bedrooms in a spacious design ensuring each room has ample storage. The rumpus room connected to bedroom 2 and 4 makes for a perfect kid's retreat or play area. The main bathroom offers a smart configuration that allows for multiple people to be in the space without it feeling crowded. This floorplan offers a large amount of intentional practicality in its design. The builtin garage, butler's pantry, protected outdoor area and open plan meals, living and kitchen space is a favourite for many who have chosen this design.

EXTERIOR WIDTH 16.08m

LENGTH 17.32m

TOTAL FLOOR AREA 229.04m²

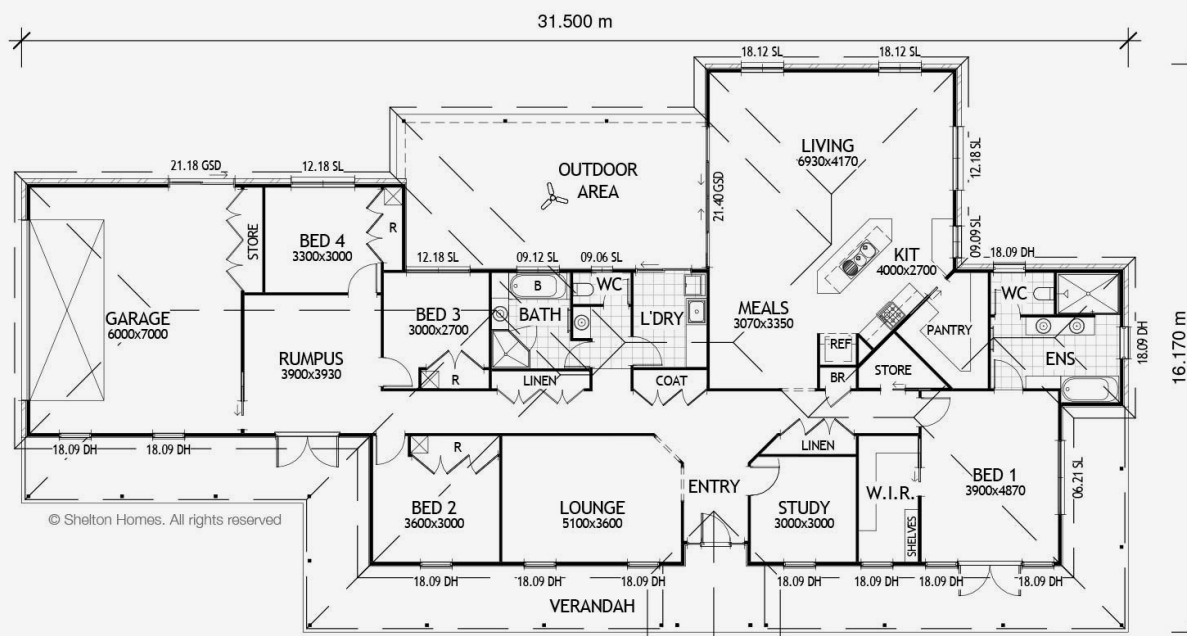

sheltonhomes
CREATING *modern* QUEENSLANDERS

Please Note: The floor plan provided is for illustrative purposes only and is not drawn precisely to scale. However, the overall length and width can be assumed to be accurate. It is the home owner's responsibility to ensure that the house will fit on their land and that all applicable council regulations and estate requirements are met. The image of the façade is for illustrative purposes only and may contain items or finishes which may or may not be standard inclusions.



BUILD A HOME THAT
FINALLY FEELS LIKE
home

Simply call or email
Scott and the team

0417 961 667

scott@sheltonhomes.com.au

sheltonhomes
CREATING *modern* QUEENSLANDERS