

Heavy Multi Hanger



The HMH hanger is designed to support multiple trusses connecting to girders in medium to high load situations.

Features & Benefits

- High load capacity can be achieved with fixings into the bottom chord only
- A variety of fixing details allows increased performance

Material Specification

- Galvanised mild steel - Z275

Fixings

All fixings supplied with hanger

Depth	Description
122mm	3.35 x 50mm Annular Ring Shank Nails
147mm	3.35 x 50mm Annular Ring Shank Nails
197mm	Paslode PSTS 6.5 x 65mm

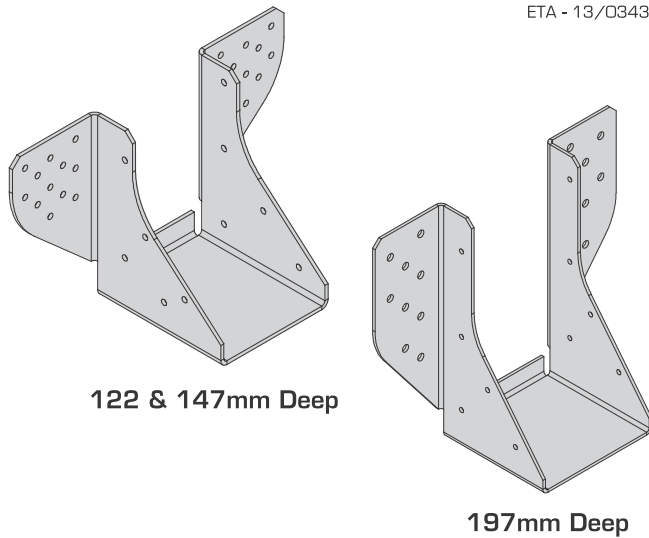

Available Sizes

Hanger Width (W) (mm)	Hanger Depth (mm)		
	122	147	197
80	HMH-80-122	HMH-80-147	HMH-80-197
102	HMH-102-122	HMH-102-147	HMH-102-197
118	-	HMH-118-147	HMH-118-197
153	-	HMH-153-147	HMH-153-197
198	-	-	HMH-198-197

Dimensions (mm)

122 & 147mm deep - 4mm Ø holes

197mm deep - 6mm Ø holes

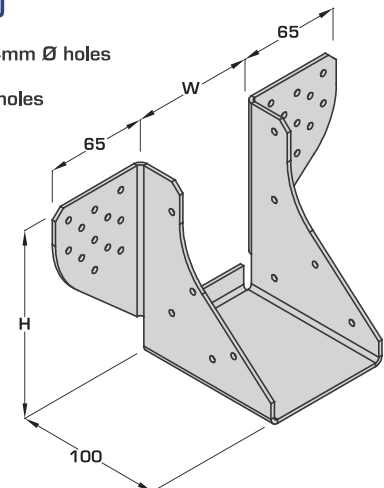

In Situ

Bottom Chord Fixing:

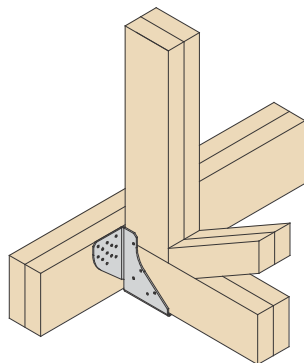

Ridge Connections:

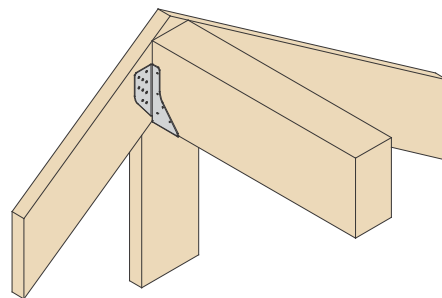

Please discuss suitability with Technical Support

Load Data

Hanger Depth (mm)	Dimensions (mm)	Fixings		Characteristic Capacity (kN)	
	H	Header (3.35 x 50mm)	Incoming (3.4 x 35mm)	Uplift**	Solid Timber Header (Min TR26)
122	122	24	10	9.83	26.08
147	145	34	10	9.83	32.45
		Header (PSTS 6.5 x 65mm)	Incoming (3.4 x 35mm)		
197	195	18	10	9.83	39.49

**Supported timber must be at least hanger height to achieve full uplift capacity. For reduced fixing capacity please contact Cullen Technical.
Incoming trusses must be connected together to act as a single unit.