

RYOBI

The Ryobi range of door closers are top quality high performance products. The quality and leading edge technology comes from being the worlds largest and most advanced die casting manufacturer Ryobi started producing surface mounted door closers in 1963, since then Ryobi has developed the production technology and quality that is recognized by architects,

installers and home owners, as second to none! Ryobi products have a massive edge over their competition in their strength and reliability, and are known as the longest lasting closers in the marketplace. The Ryobi door closer range is divided into consumer door closers and industrial door closers, to fit everything from basic screen doors to the heaviest grade industrial doors.

RYOBI DOOR CLOSERS

These closers are used in commercial applications and offer concealed fixing above the door. Feature include:

- Cast iron housing, high tensile cam shaft and ball bearing bottom pivot
- Cycle tested to over one million operations.
- Fully adjustable in door alignment, vertical positioning, heel to frame positioning via arm, arm channel and bottom pivot
- Have an adjustment for altering door closing speeds
- Available in hold open or non hold open models
- Available with opening options of 90 and 105 degrees
- When using the parallel arm model the door weight capacity is reduced by 20% compared to the standard arm application

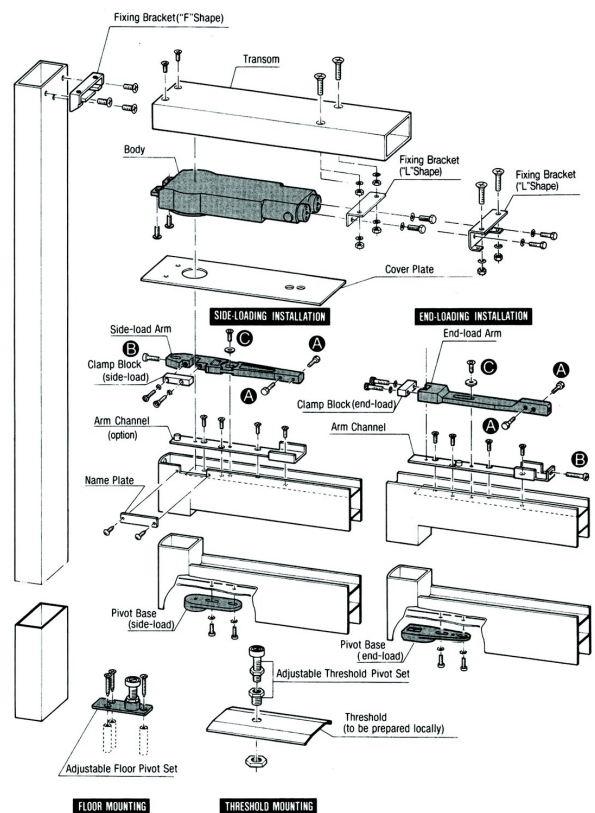
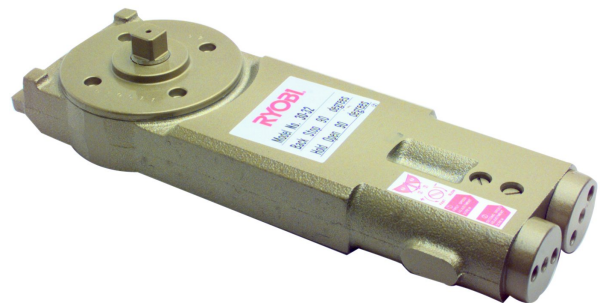

MODEL DETAILS

Product Code	Model option	Opening degrees	Door Weight	Packaging	Pack	Outer
30-33	Non hold open	90 degrees	110kg	Boxed	1	1