

PROJECT ROADMAP

KEMPSEY-ARMIDALE ROAD RESTORATION PROJECT (K2A)

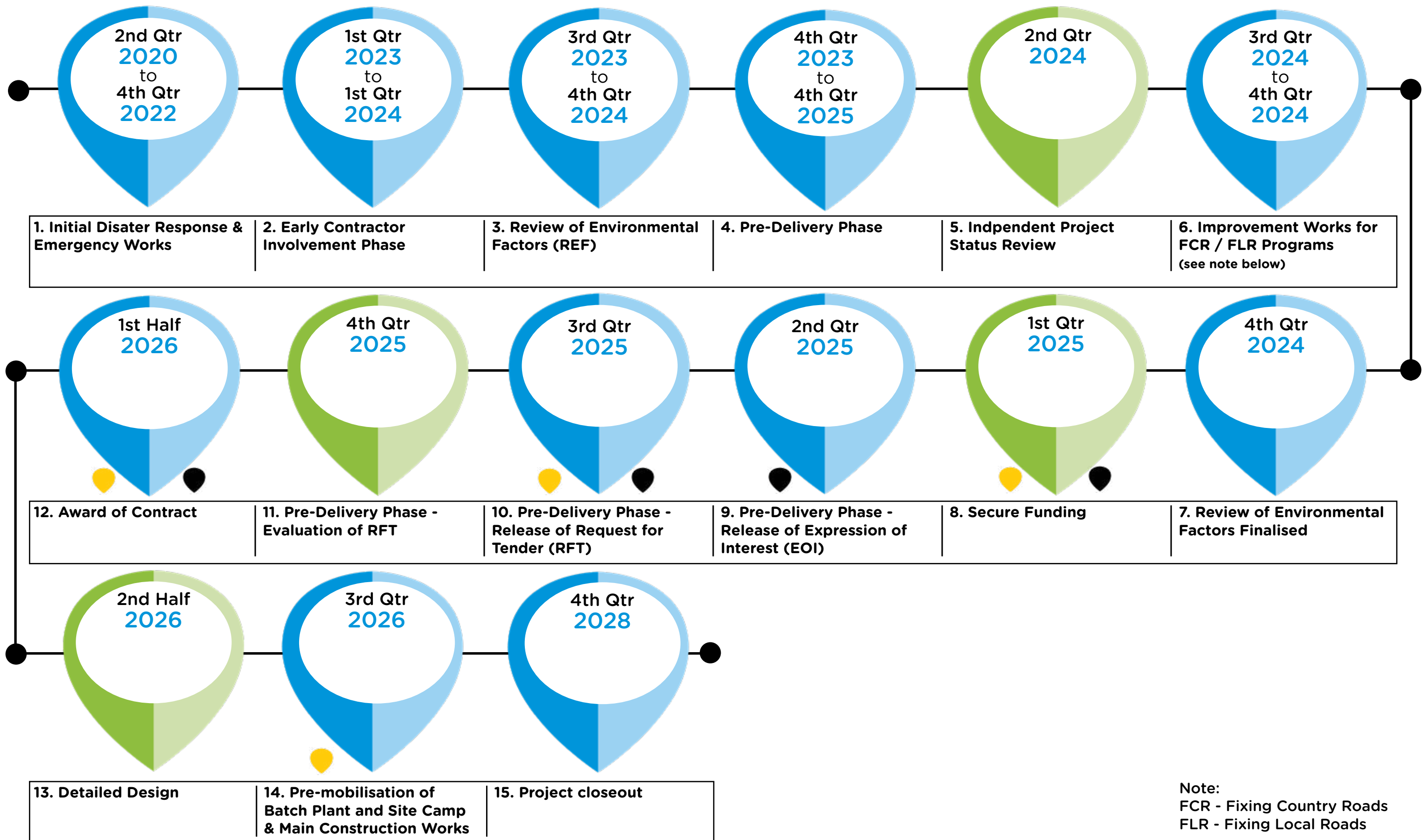

KEMPSEY-ARMIDALE ROAD RESTORATION PROJECT *Roadmap*



Note:
FCR - Fixing Country Roads
FLR - Fixing Local Roads

Works undertaken and planned prior to commencement of main construction

The Kempsey-Armidale Road Restoration Project was funded to carry out repair of the road following a series of disasters caused by fire and heavy rains since 2019. The project consists of a number of distinct programs:

- Emergency works soon after the natural disasters
- Reconstruction works to rebuild damaged sections of the road

- Improvement works at specific locations under the Fixing Country Roads and Fixing Local Roads programs
- Main construction works to rebuild the remainder of the road to pre-disaster condition.

Initial disaster response - emergency and critical recovery works undertaken since February 2022

Following geotechnical assessment of the damage done to Kempsey Road by the series of extreme weather and fire-related events, works commenced on the most severely damaged locations to restore the road to a safer and usable condition.

In addition to the massive task of clearing debris off the road, the following works were carried out at these locations:

FLYING FOX CUTTING

- Construction of 3 soil nail retaining walls
- Culvert works at 2 locations.

SMITH'S FLAT

Construction of a soil nail retaining wall.

THE SIX CURVES

Curve 1

- Construction of a gravity block retaining wall
- Culvert works
- Pavement repair

Curve 2 (Waterfall Corner)

- Construction of a soil nail retaining wall
- Culvert works

Curve 2 (separate location)

- Construction of a gravity block retaining wall
- Culvert works
- Asphalt pavement seal

Curve 3

- Construction of a gravity block retaining wall
- Culvert works
- Pavement repair

Culvert 4

- Construction of a gravity block retaining wall
- Culvert works
- Pavement repair

Curve 5

- Construction of a gravity block retaining wall
- Culvert works
- Pavement repair

Curve 6

- Construction of a gravity block retaining wall
- Culvert works
- Pavement repair



Benefits of the Improvement Works Program

The overall expected benefits of the program include:

- Improved and safer local access through restoration of road formation width and rehabilitation of road pavement
- Reduced environmental impacts through restoration of drainage infrastructure and minimisation of future erosion
- Reduced future maintenance costs.

Works completed in December 2024

BLACKBIRD FLAT

- Providing improved drainage including dish drains, culverts and outlet scour protection to manage stormwater and minimise future erosion - a total of 5 culverts
- Reinstating the road width on approach to Blackbird Creek bridge
- Rehabilitating and reshaping the road to provide crossfall to dish drains
- Spray sealing 550m of the road.

FLYING FOX CUTTING

- Providing improved drainage including dish drains, culverts and outlet scour protection to manage stormwater and minimise future erosion - a total of 25 culverts and 3 new inlet pits
- Reshaping road width and crossfall for a section of the road
- Completing pavement improvements and spray sealing 1850m of the road.

BIG HILL

- Providing improved drainage including dish drains, culverts and outlet scour protection to manage stormwater to minimise future erosion at three locations - a total of 4 culverts.

Works ongoing in 2025

FLR works will continue during 2025 at the following locations:

- Blackbird Flat - includes some pavement sealing
- Flying Fox Cutting - includes some pavement sealing
- Big Hill - includes three curves being constructed as unsealed pavements.



Other works & activities

Land Access Agreements

Prior to, and during main construction,

Council's authorised staff and contractors may need to access properties along the project alignment to carry out works which could have an impact on the property.

Council will work with the landowner to negotiate a land access agreement early in 2025 to enable the contractor for the main works to carry out works on the impacted land.

Lower Creek Community Hall

Delivery of this project is funded under the Black Summer Bushfire Recovery Grants Program. The objectives of the grant opportunity are to:

- Support recovery and resilience of communities impacted by the 2019-20 bushfires
- Build stronger communities by supporting social, economic and built environment recovery.

The intended outcomes of the grant opportunity are to empower local communities to address bushfire recovery priorities, including through:

- The creation of jobs, sustainable infrastructure and community investment targeted at the specific needs of the community
- Rebuilding and growing the economy of the local communities impacted by the bushfires.

Status:

- Construction of the on-grade carpark and building slab has been completed
- Erection of the building structure has begun, with the external wall cladding, roofing, doors and windows to follow.

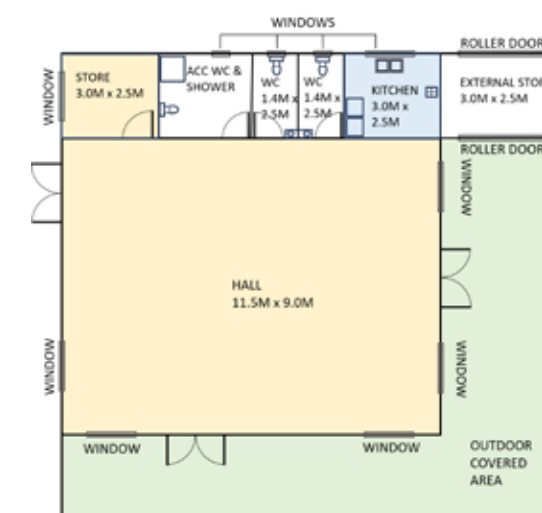

Petroi Road stabilisation works

Works will be carried out at three locations to stabilise the road where washouts have occurred. Further updates will be provided as preparation for the work progresses.

Oven Mountain Pumped Hydro Project

Alinta Energy is in the advanced stage of development for a 900 MW 8-hr pumped hydro project which will pass through sections of and, is adjacent to, the Kempsey-Armidale Road. Further information can be found at:

[Oven Mountain Pumped Hydro Project](#)

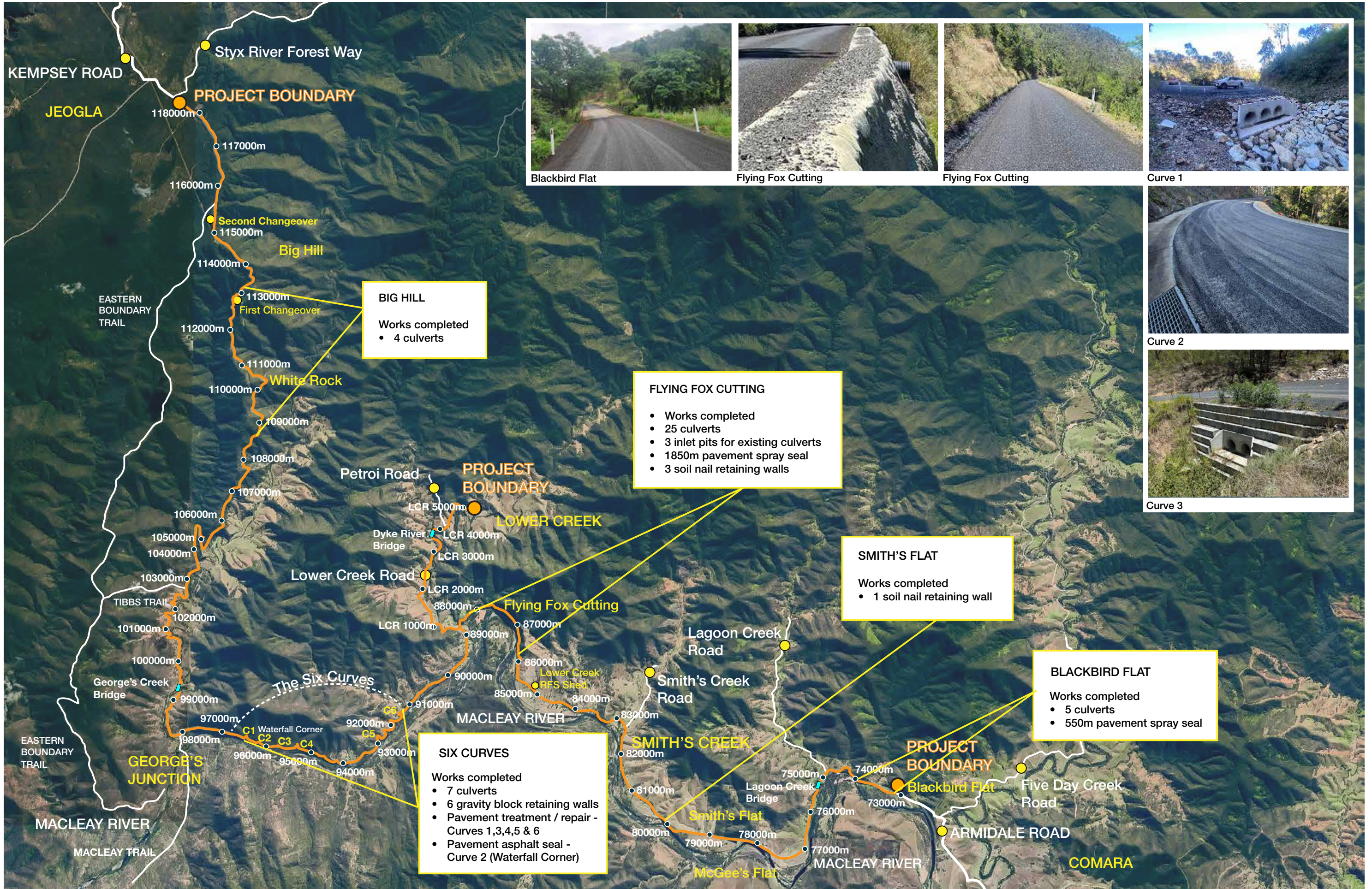

For more information, go to the
project website at:
www.karrp.com.au
or scan this QR code

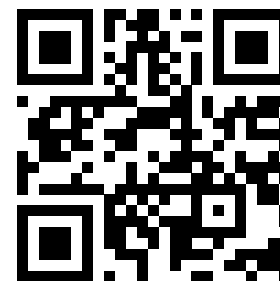

If you would like to receive regular project updates
via email or if you have a query,
contact the Project Communications Manager:
Freecall 1300 136 833 and press menu option 1, or
email - k2aproject@armidale.nsw.gov.au



www.armidale.nsw.gov.au

ARMIDALE
Regional Council