

Barn at Brynich Table Plans (not to scale)

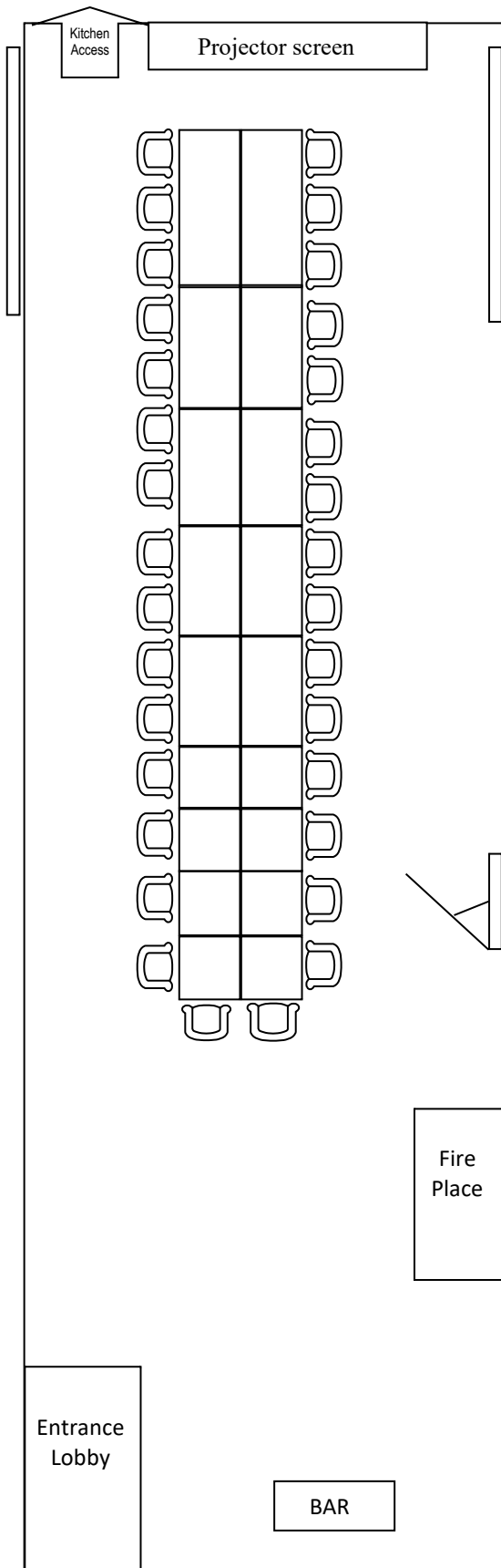

Option 1

32 delegates - Boardroom

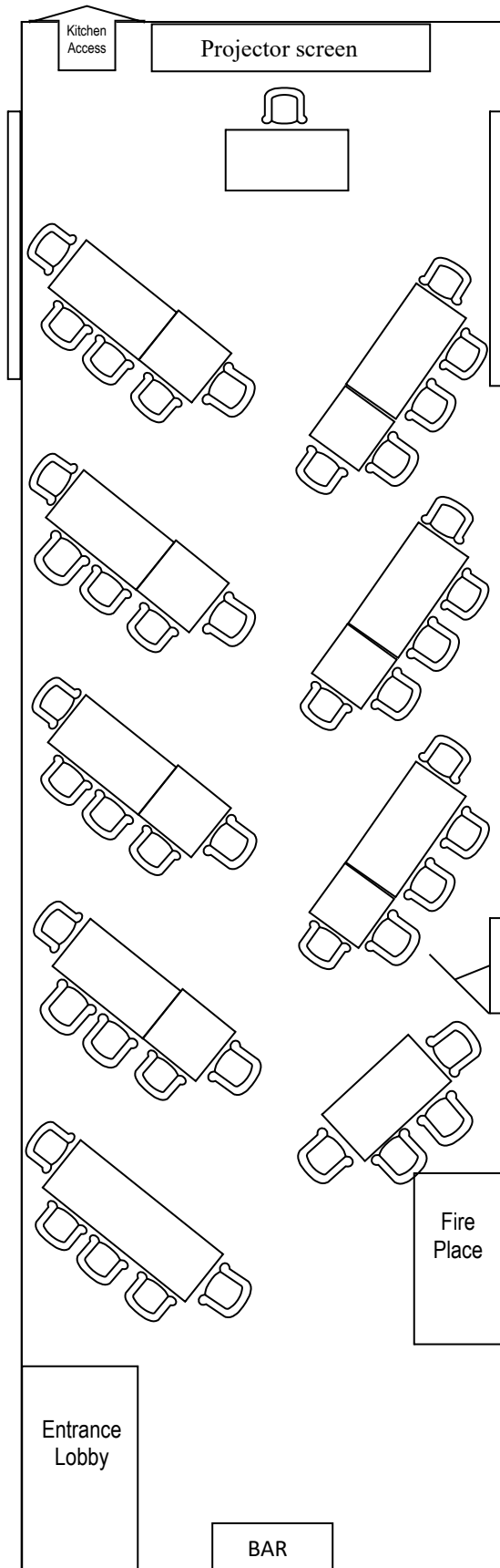

Option 2

44 delegates - Herringbone

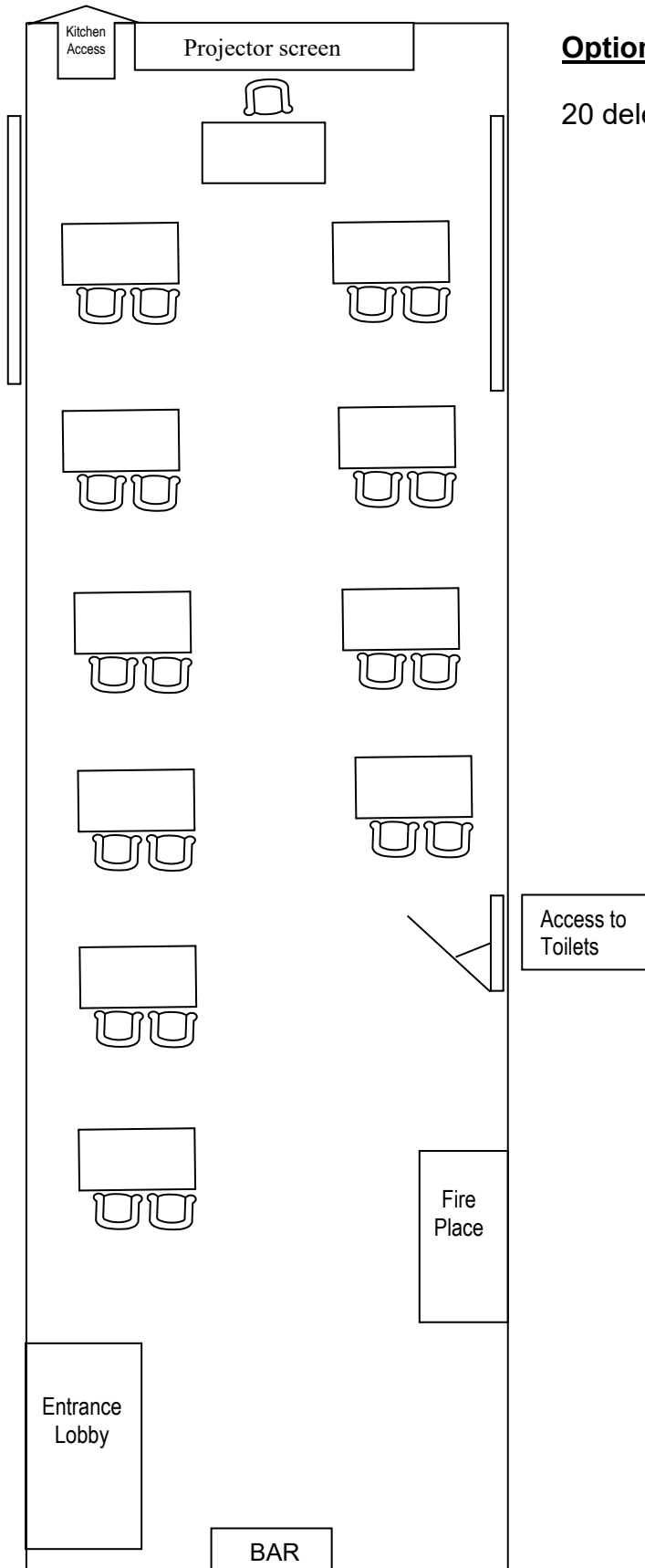

Option 3

20 delegates - Classroom

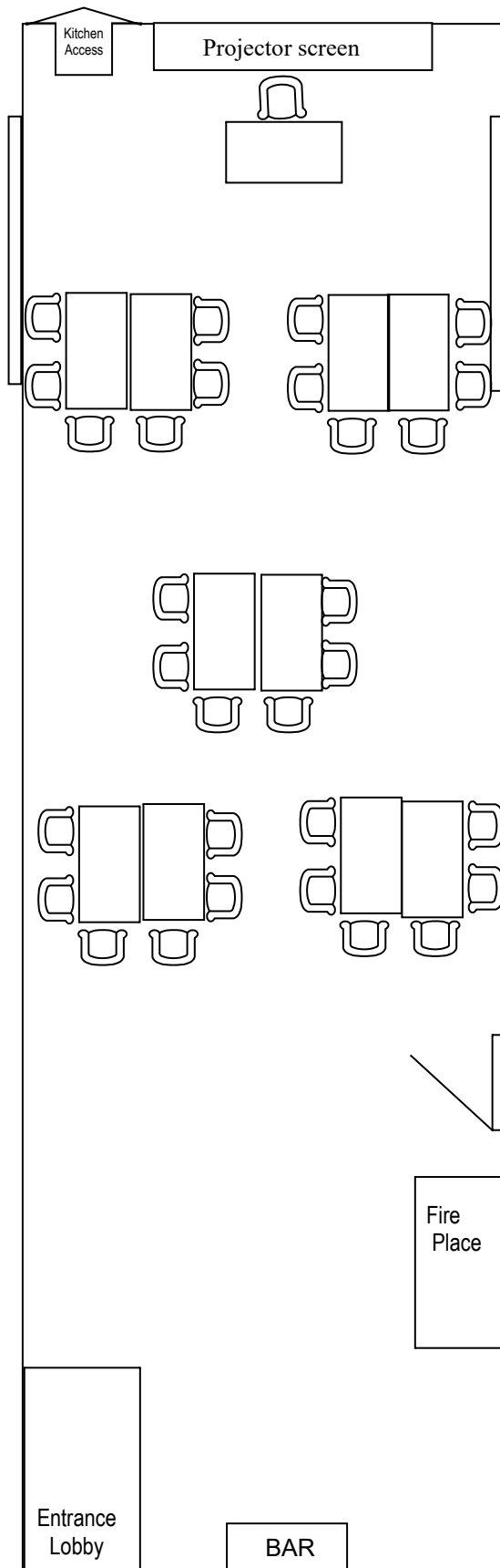

Option 4

30 delegates - Cabaret

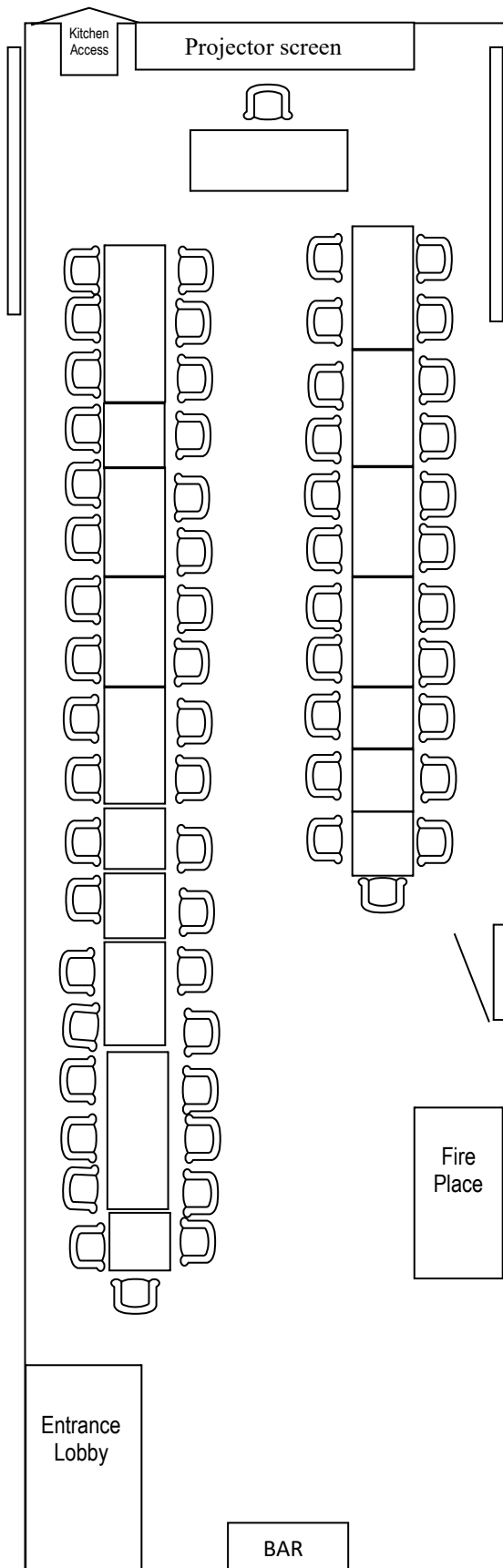

Option 5

60 delegates - Banquet

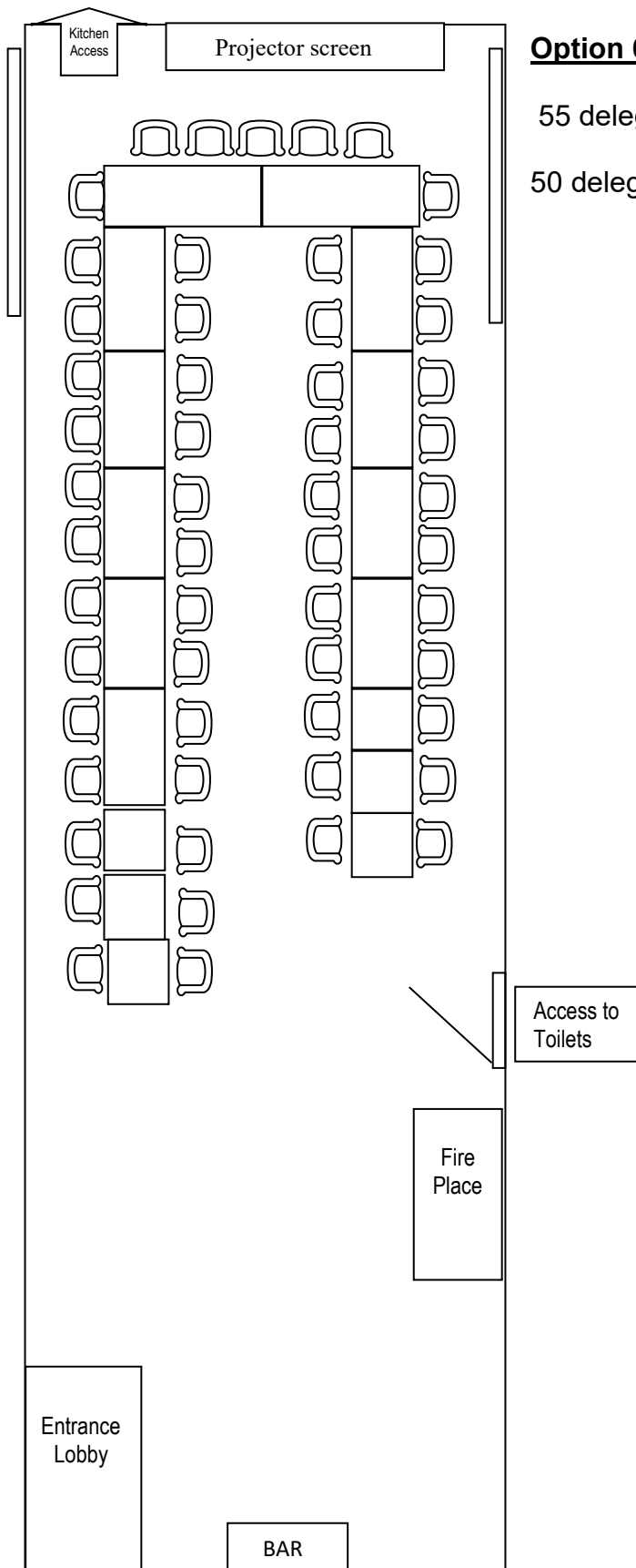

Option 6

55 delegates – Horseshoe without projector

50 delegates – with projector

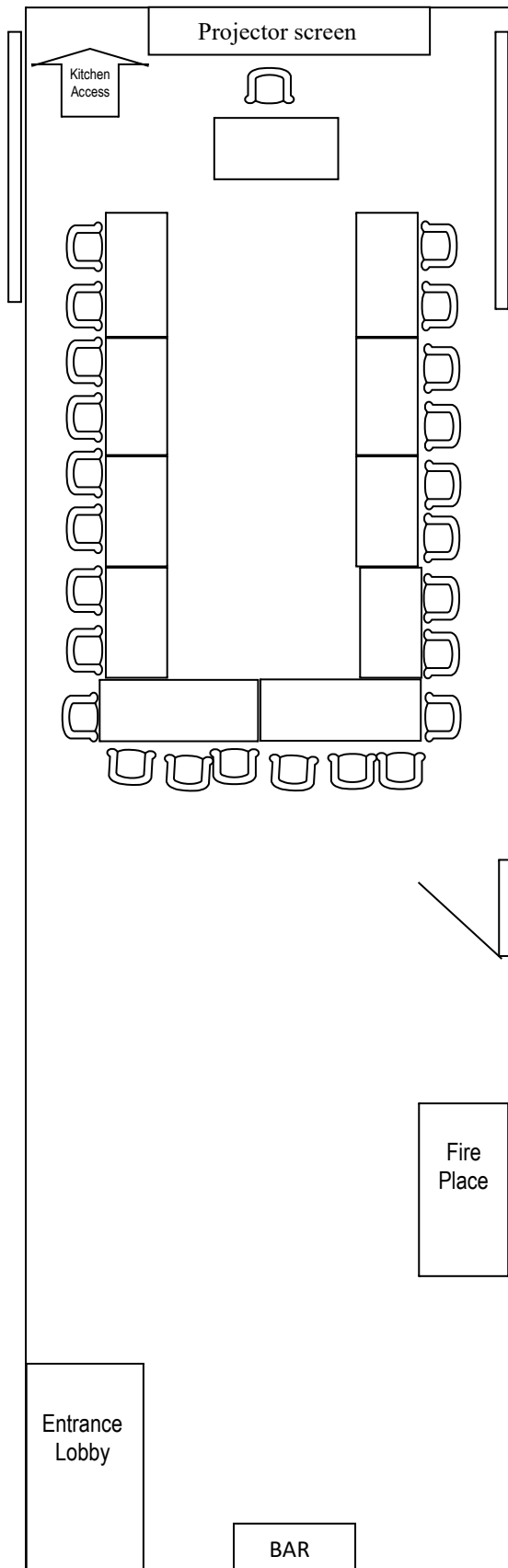

Option 7

25 delegates – U Shape

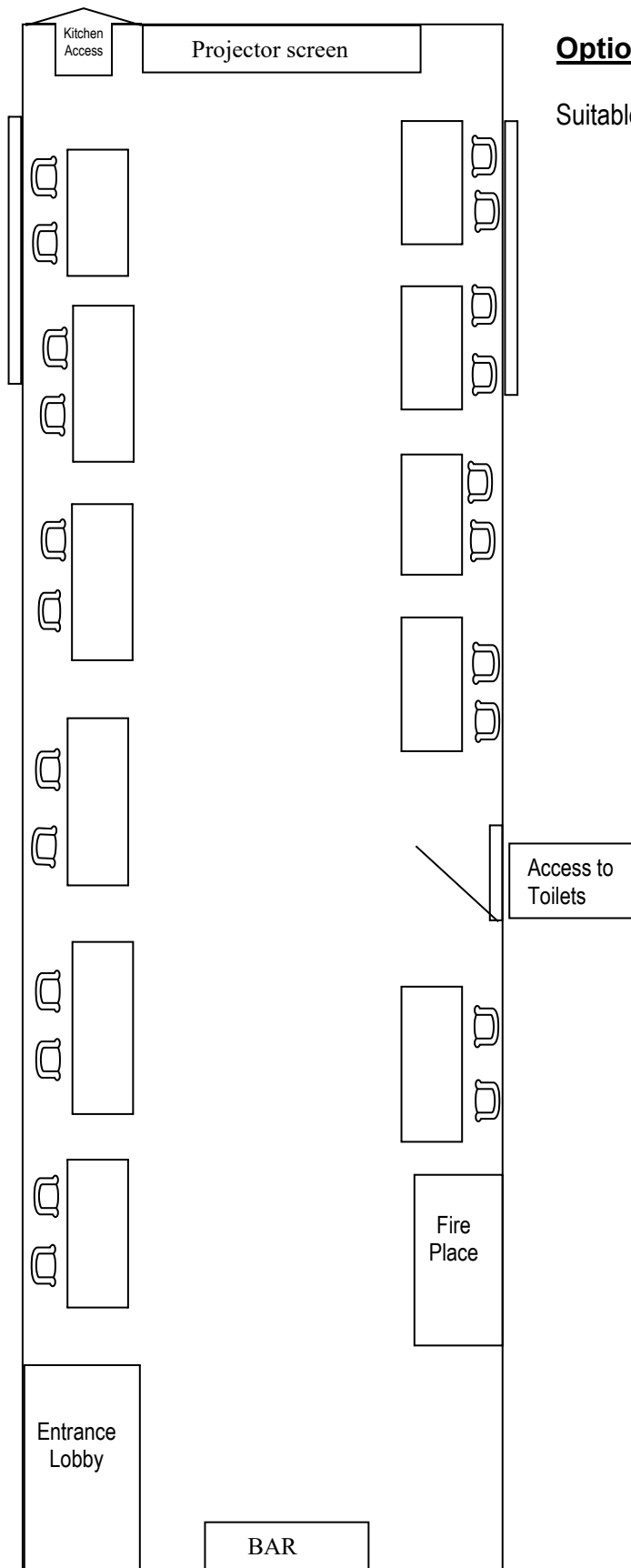

Option 8

Suitable for meet the buyer events, trade shows etc.

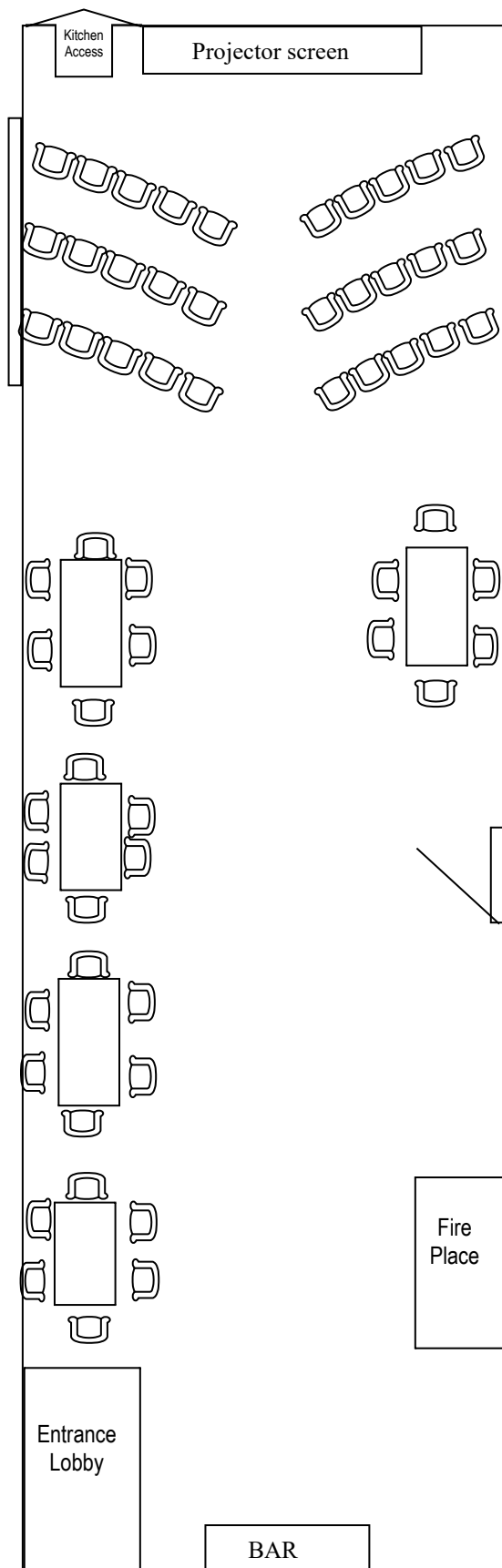

Option 9

30 delegates – Theatre with break out tables (additional tables on mezzanines if needed)

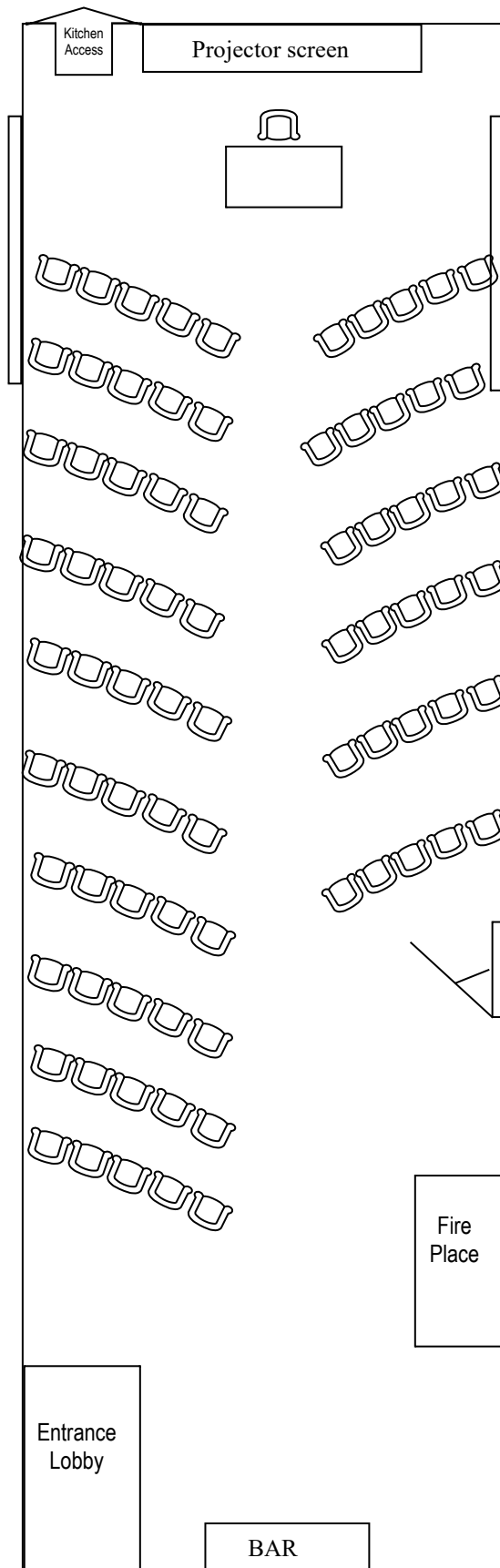

Option 10

80 delegates - Theatre

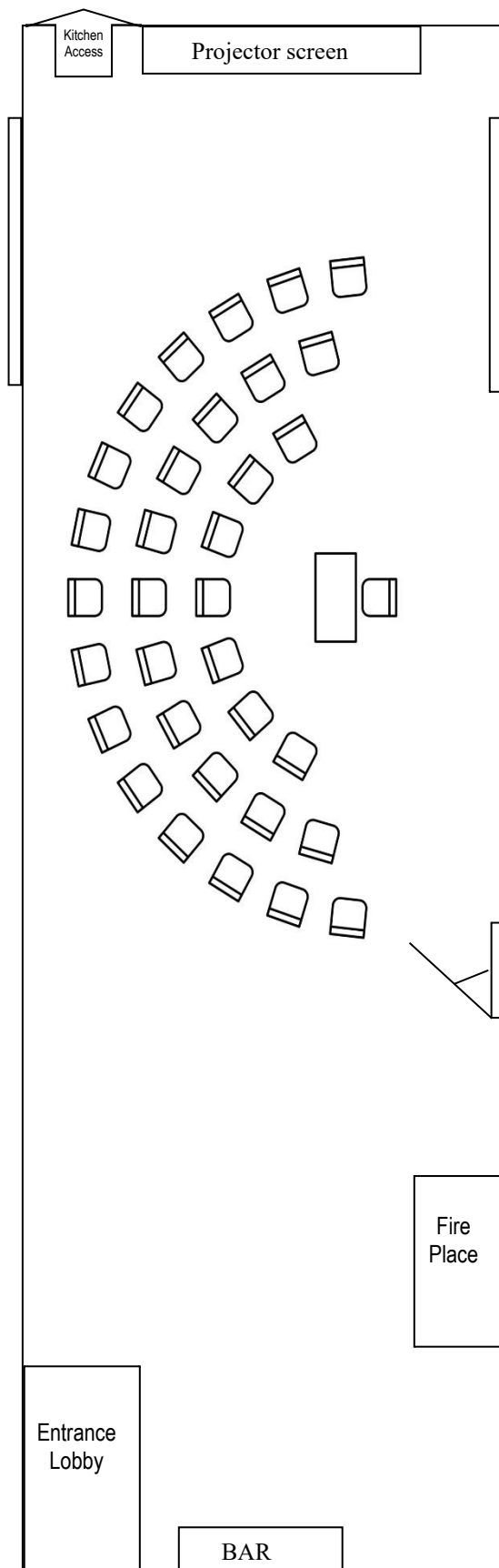

Option 11

80 delegates – Semi circle

Suitable for talks and presentations that don't require a projector screen



Please Note:

These layouts
are for the
Grain Shed
only and will
not fit in the
Barn.

Break out room available on the upstairs mezzanine seating 14.

Classroom Seats 70

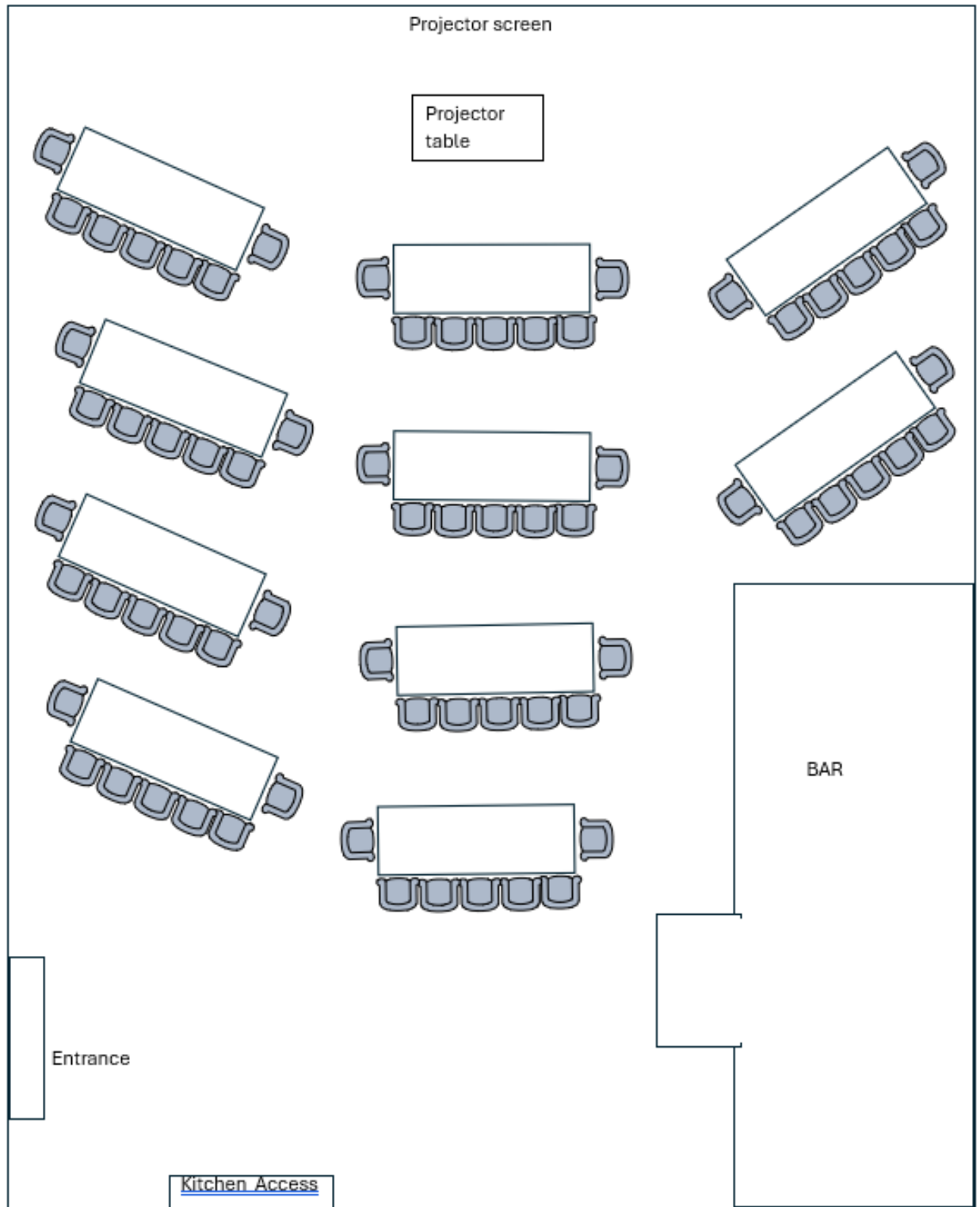

Access to toilets and upstairs

Boardroom seats 42

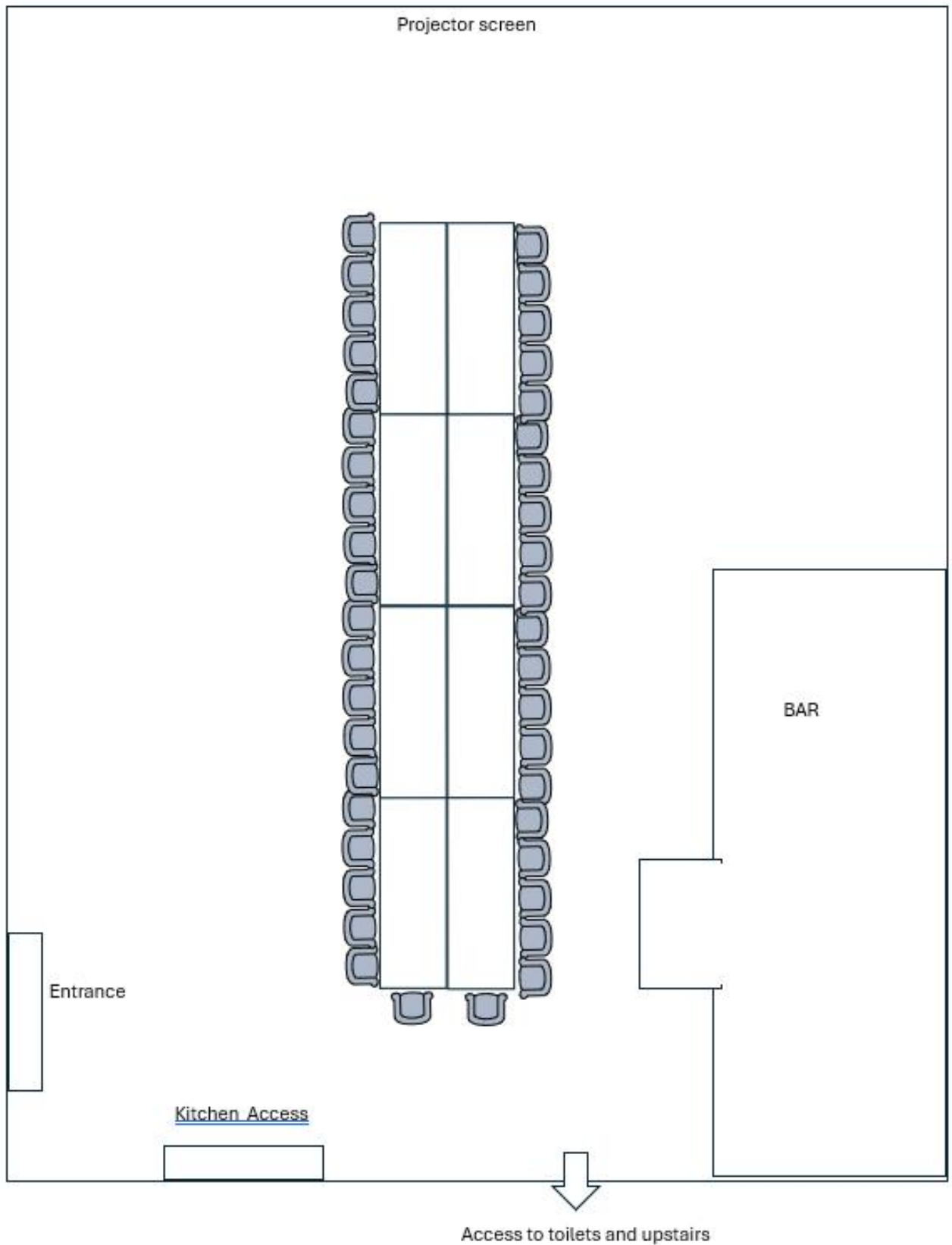

Herringbone seats 108

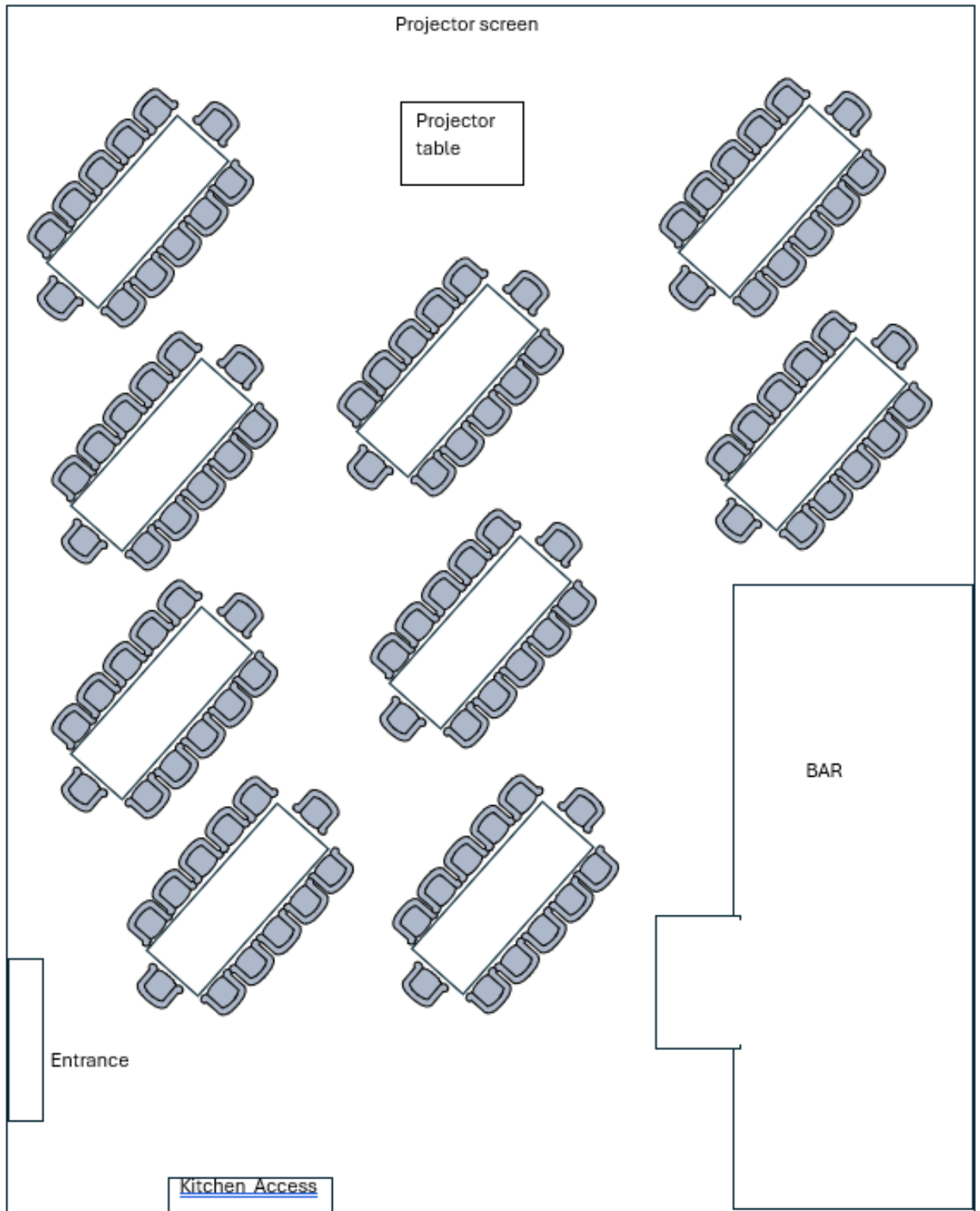

Access to toilets and upstairs

Cabaret. Seats 72

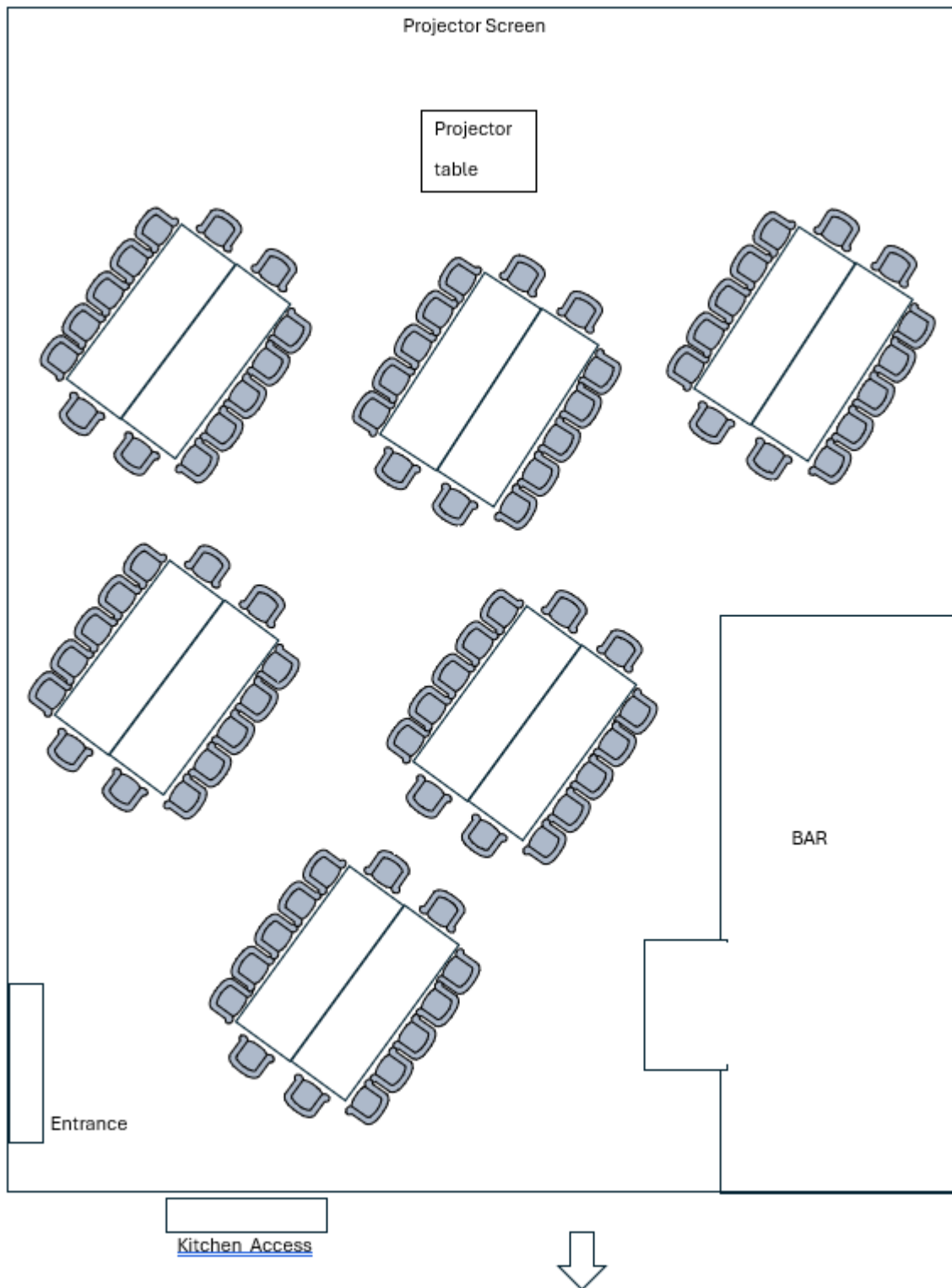

Horse-shoe Seats 80

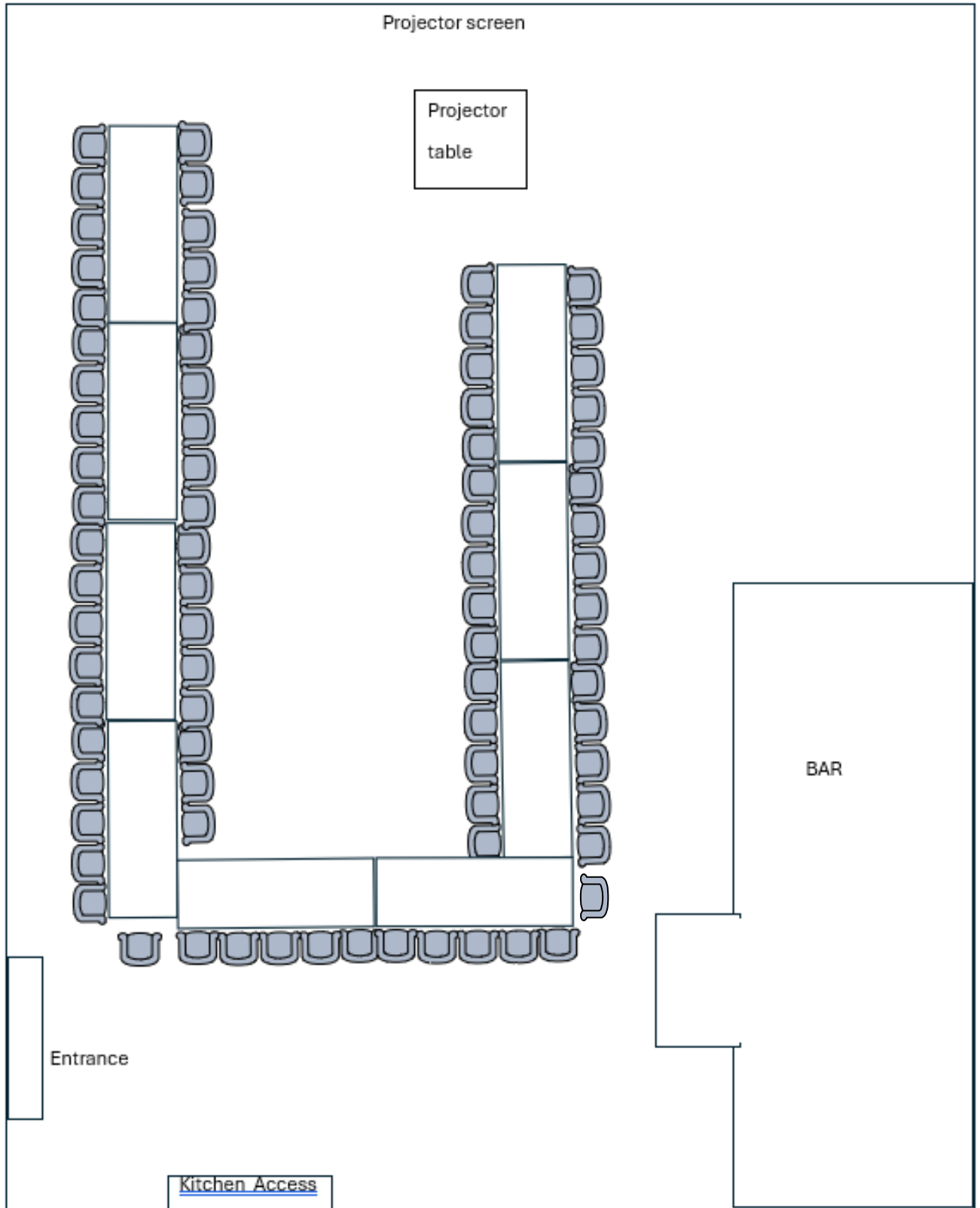

Banquet Seats 104, can go to 120 if you place chairs closer together

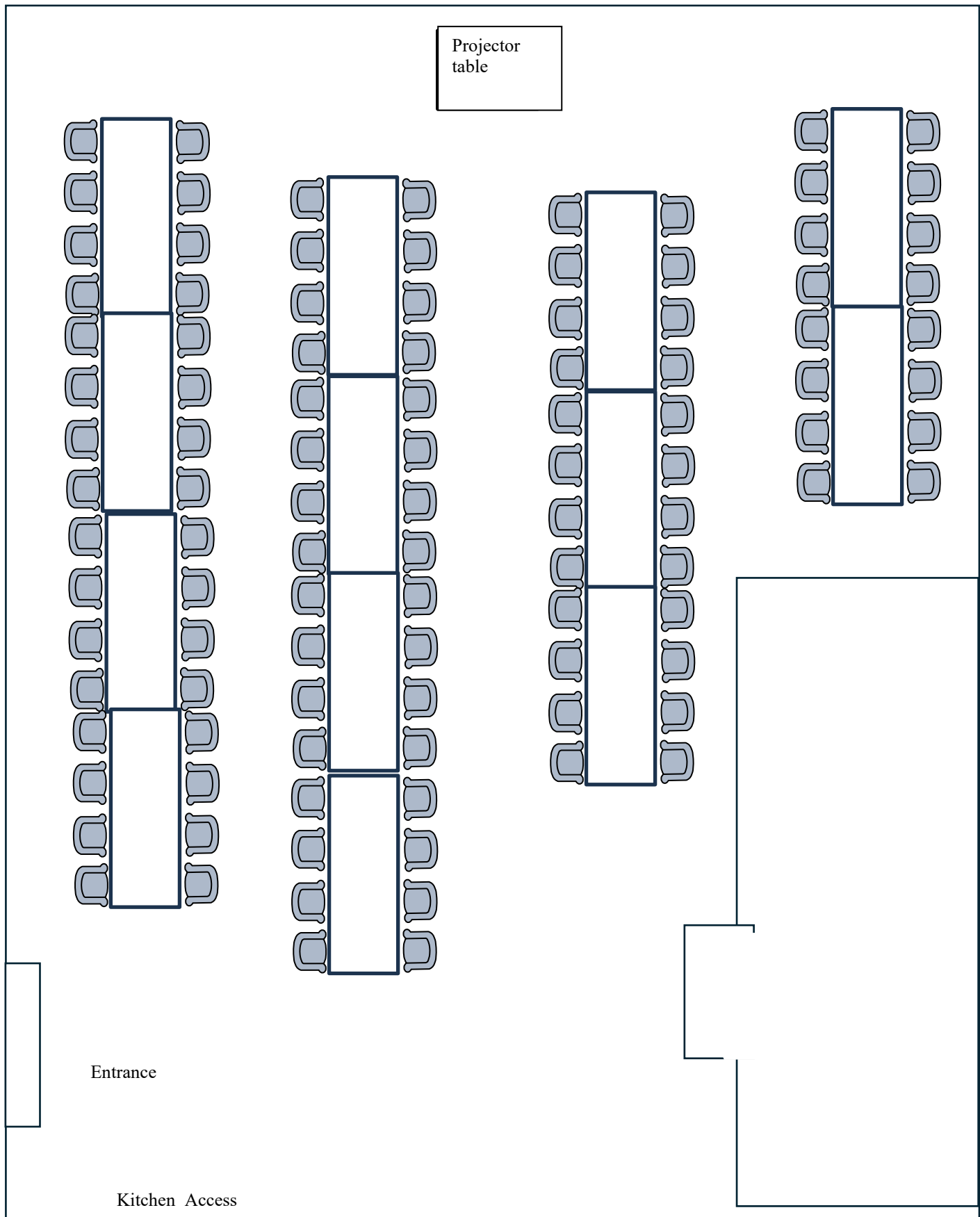

Access to toilets and upstairs

Theatre style 150

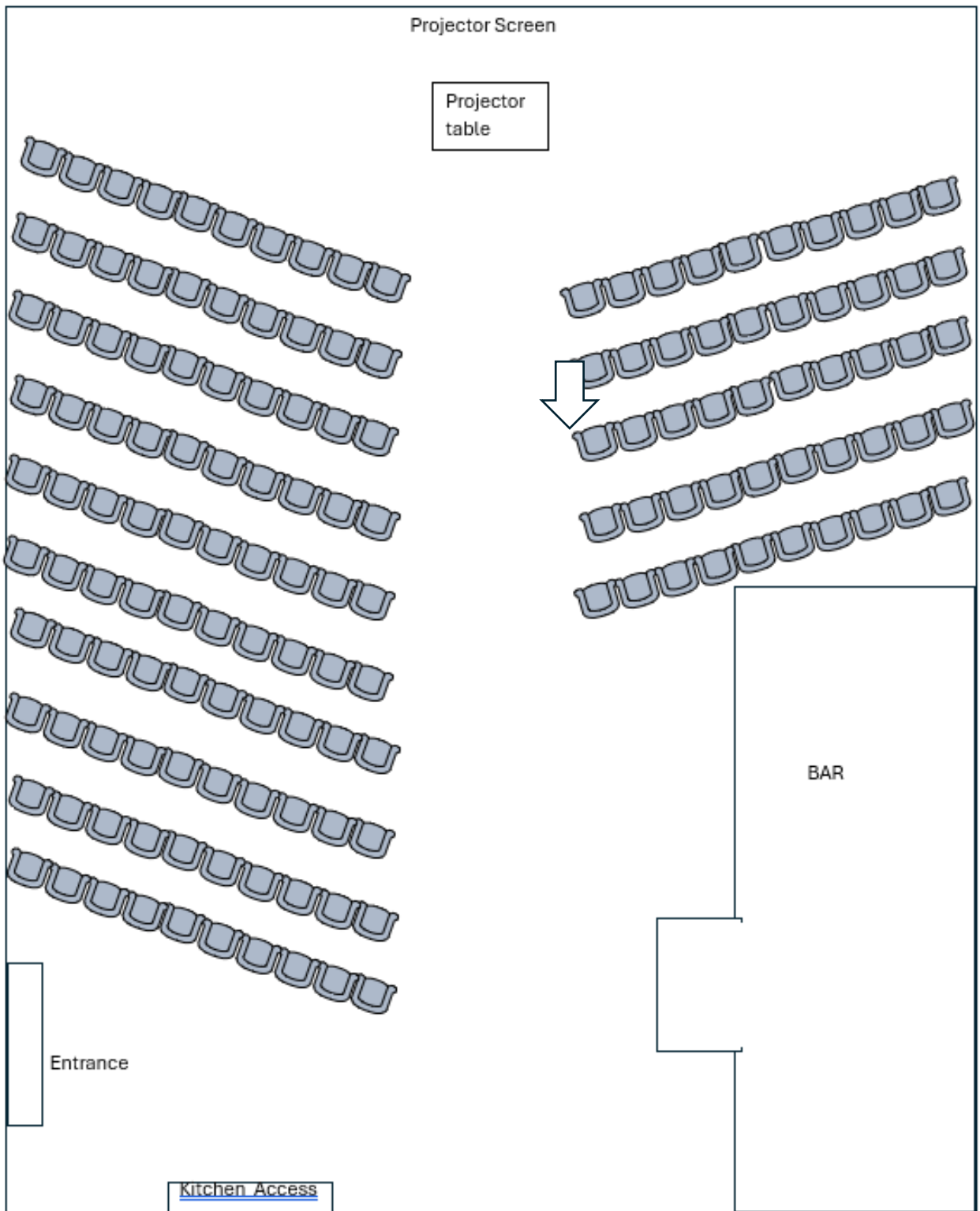

Theatre style with breakout tables max 50

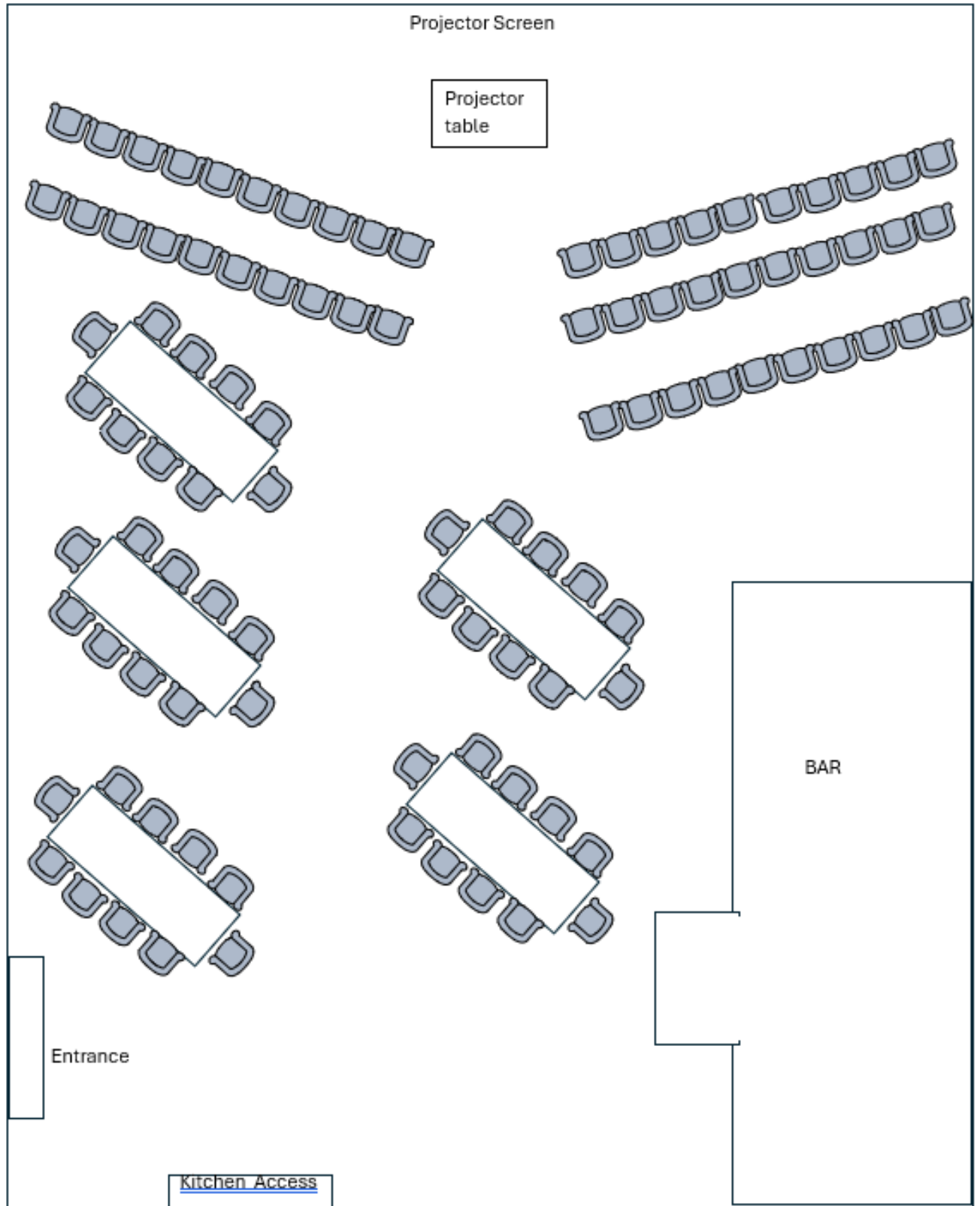

Meet the buyer / Expo Please see electric socket points document for supply

Using 13x 8ft tables. 2x 6ft tables

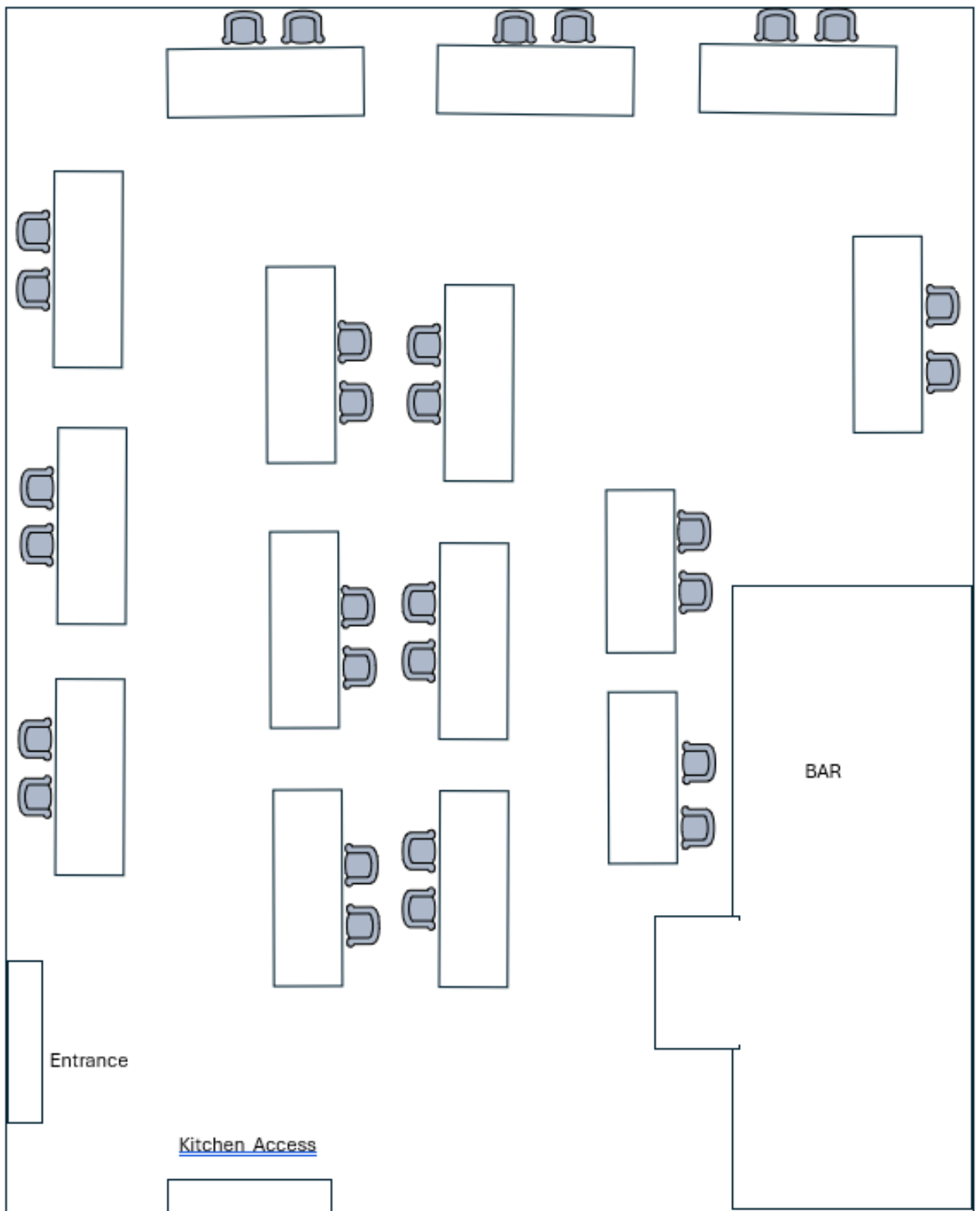

Upstairs mezzanine

*These tables are taken out of the break out room meaning it will no longer sit 14 people.

6x Tables measure 3.5ft long

