

# Barn at Brynich Table Plans (not to scale)

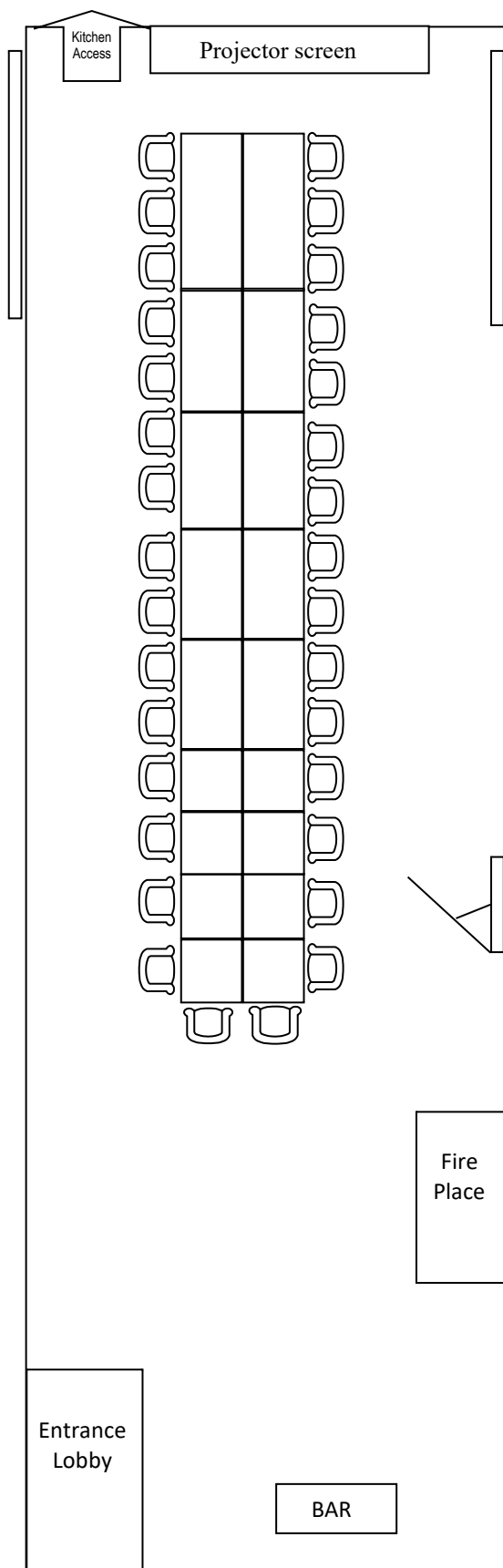

## Option 1

32 delegates - Boardroom

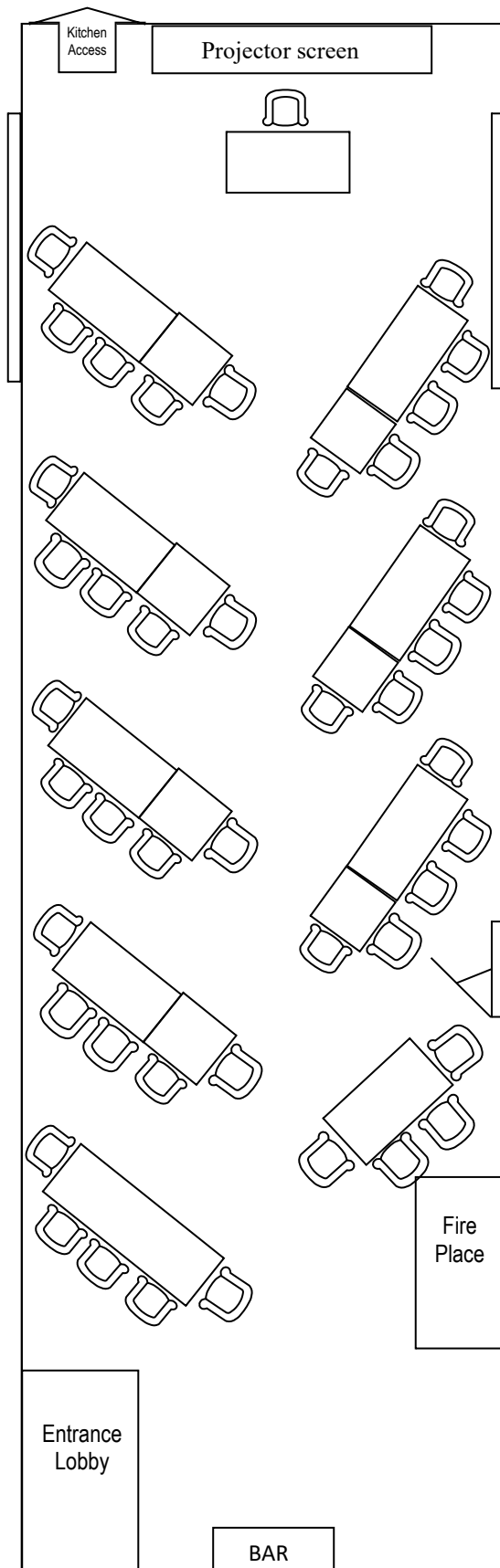

**Option 2**

44 delegates - Herringbone

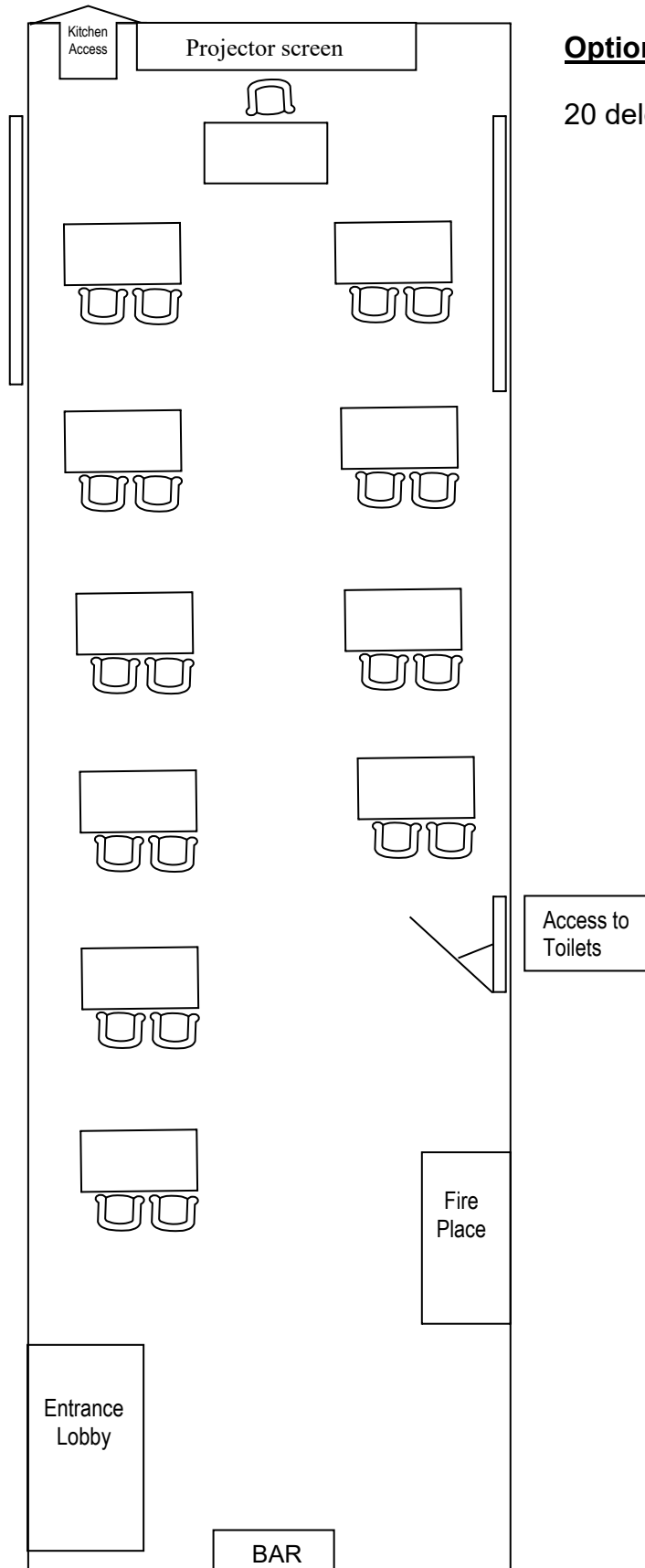

**Option 3**

20 delegates - Classroom

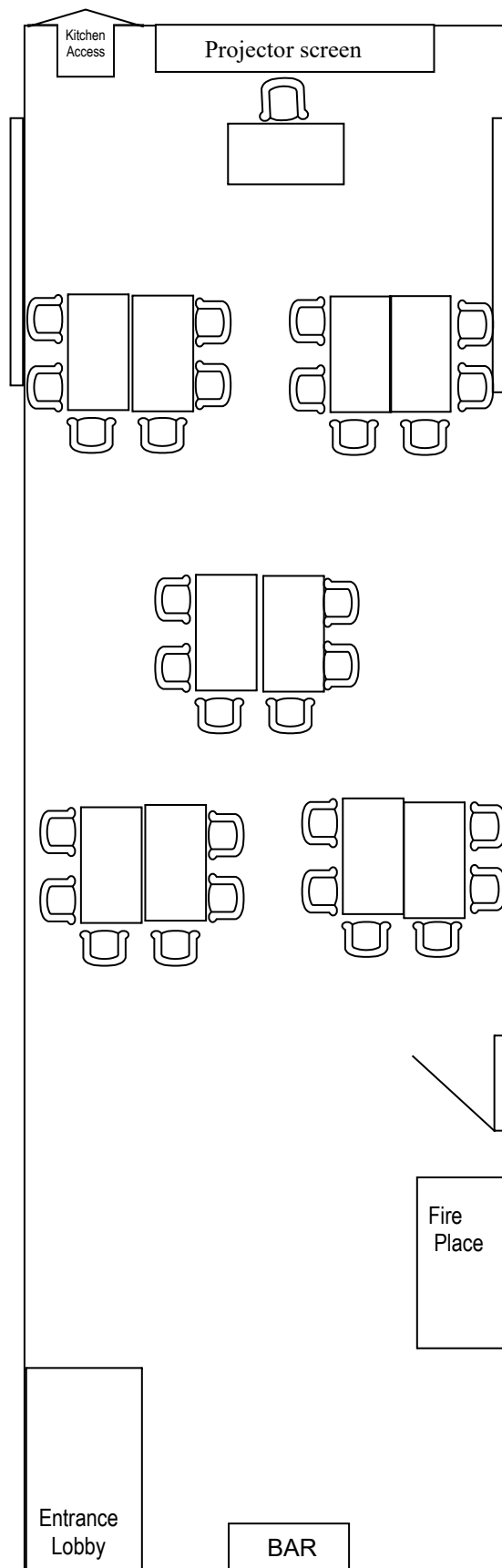

**Option 4**

30 delegates - Cabaret

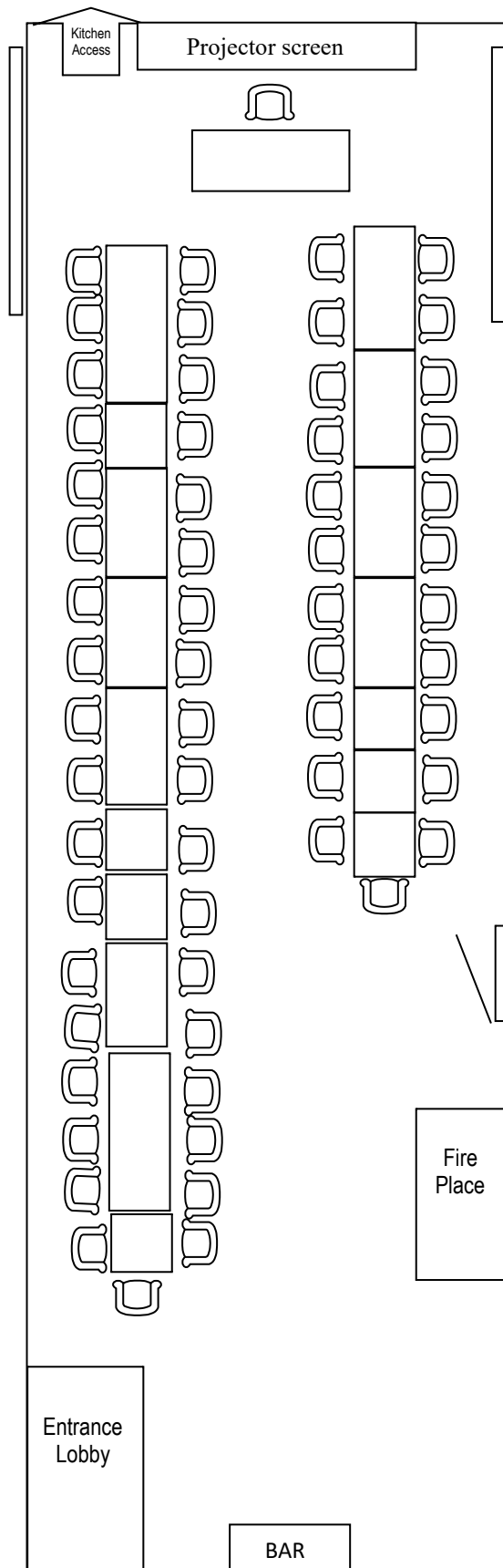

### Option 5

60 delegates - Banquet

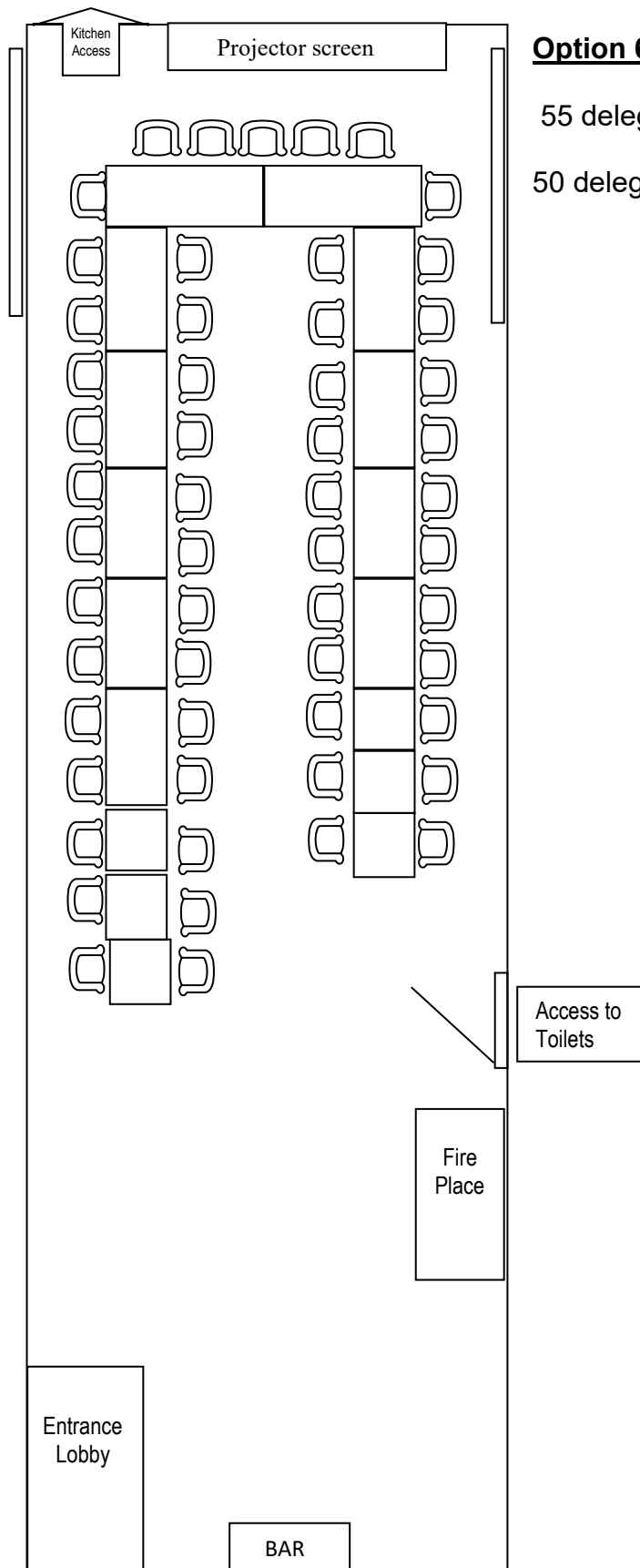

### Option 6

55 delegates – Horseshoe without projector

50 delegates – with projector

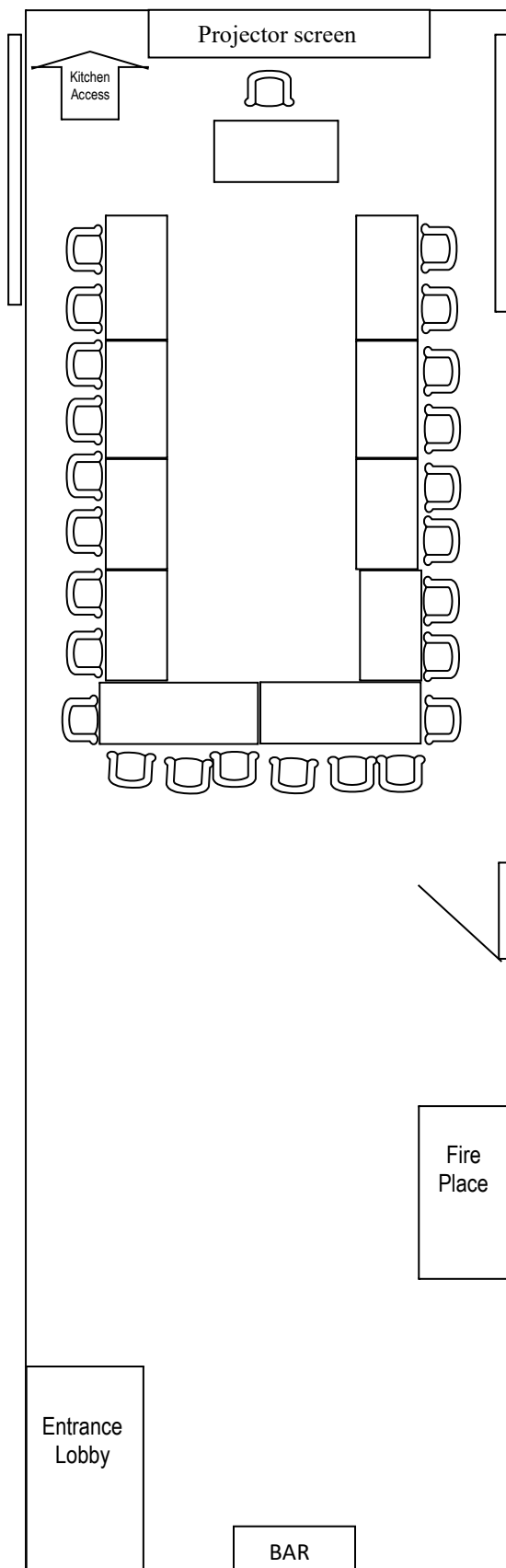

### Option 7

25 delegates – U Shape

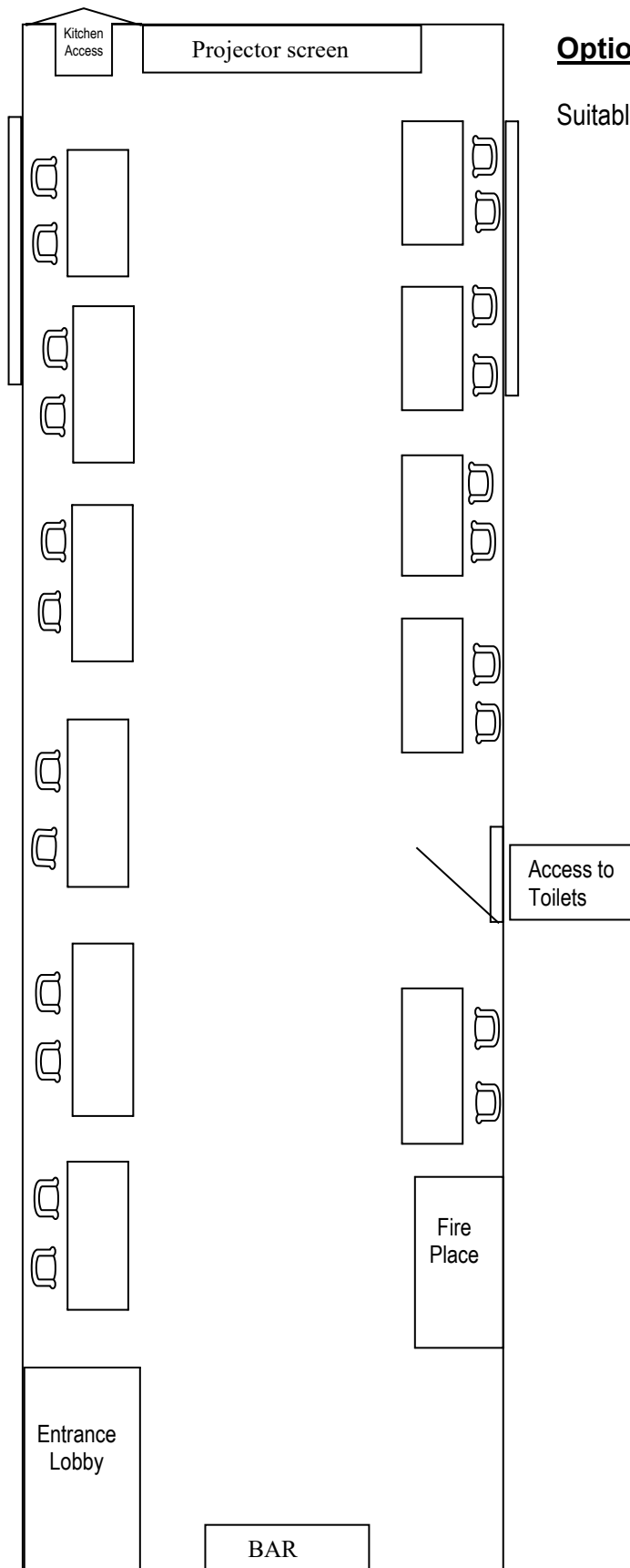

### **Option 8**

Suitable for meet the buyer events, trade shows etc.



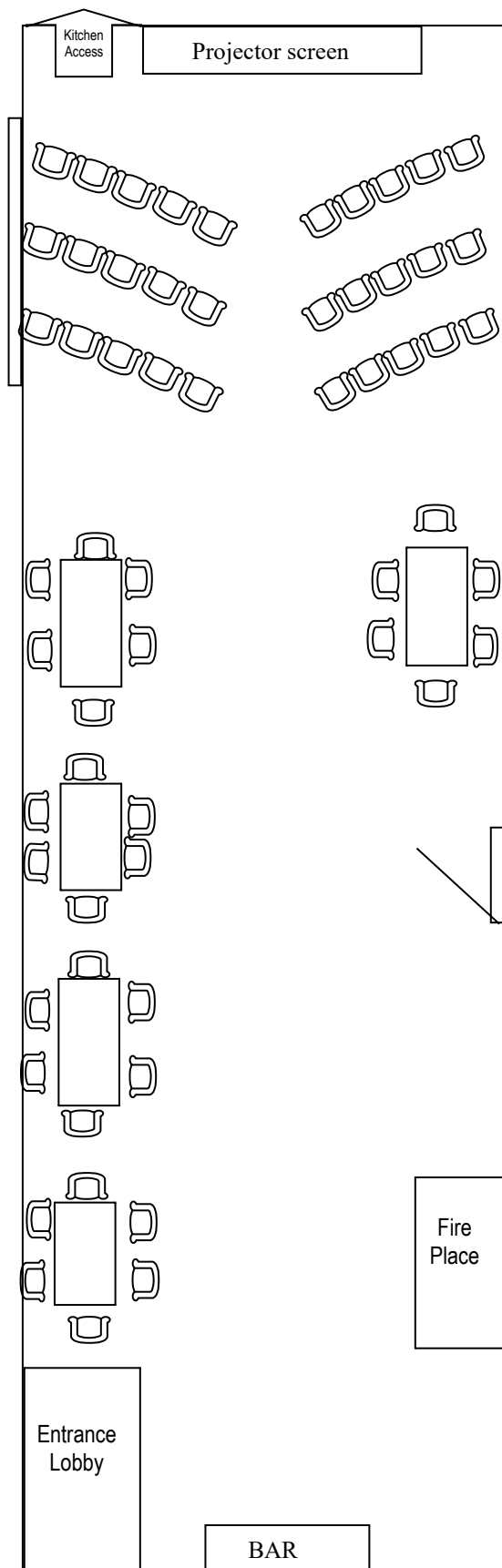

### Option 9

30 delegates – Theatre with break out tables (additional tables on mezzanines if needed)

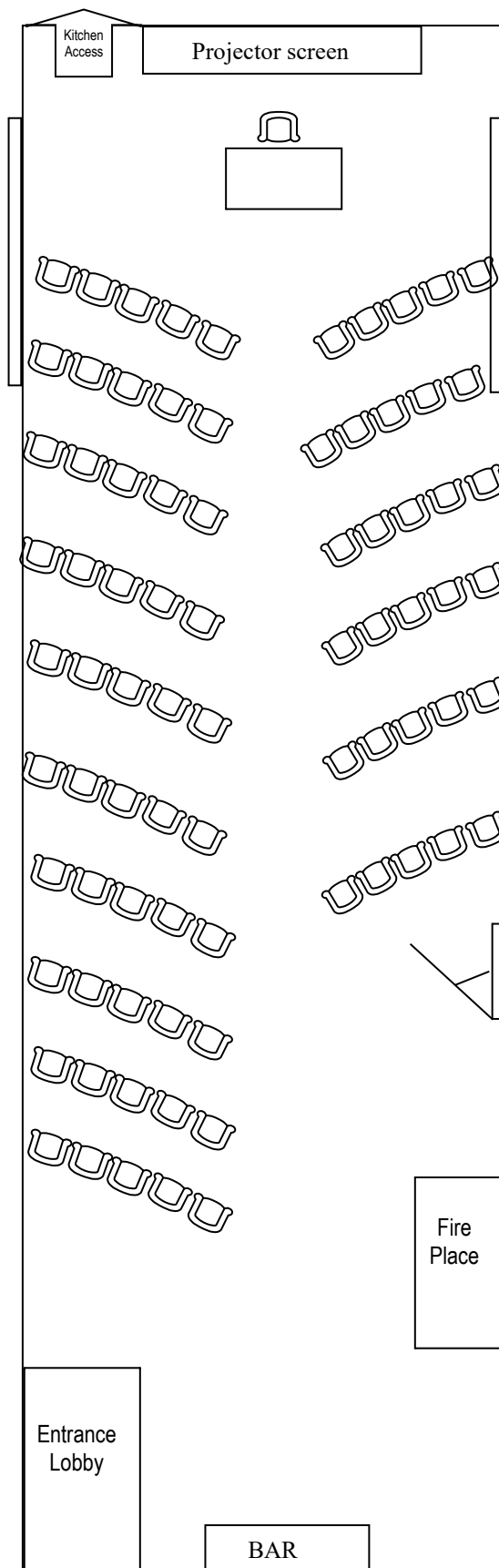

### Option 10

80 delegates - Theatre

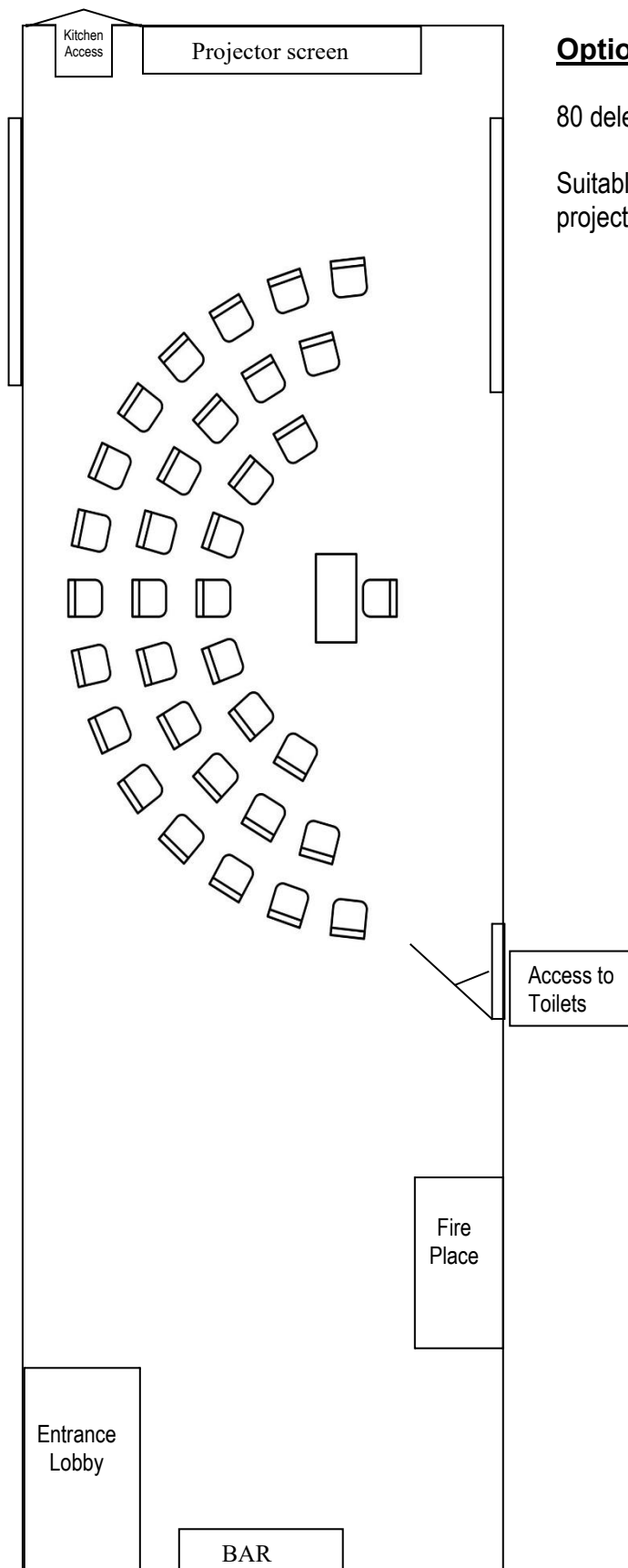

### Option 11

80 delegates – Semi circle

Suitable for talks and presentations that don't require a projector screen

Please Note:

These layouts  
are for the  
Grain Shed  
only and will  
not fit in the  
Barn.

Break out room available on the upstairs mezzanine seating 14.

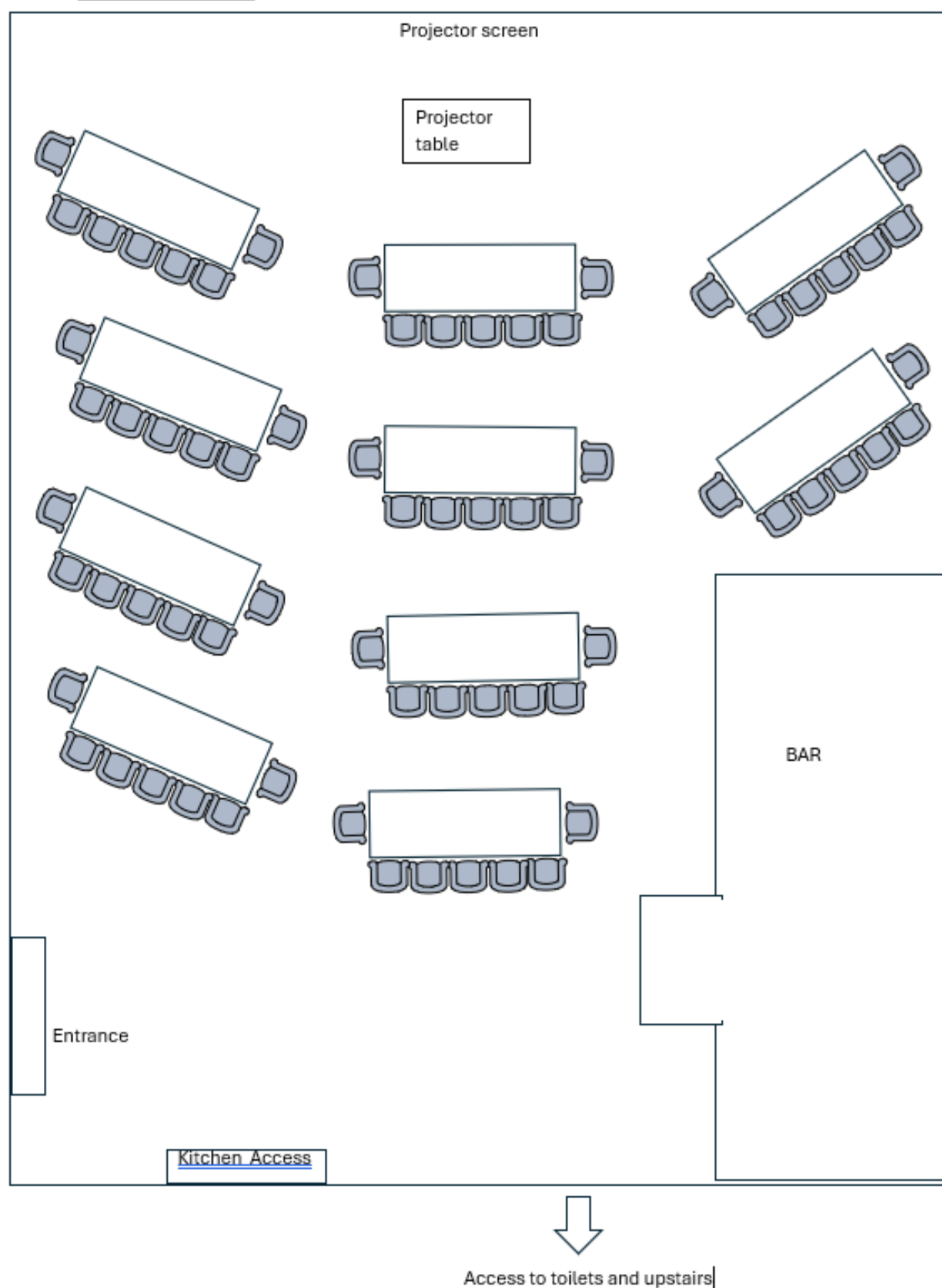
**Classroom Seats 70**

**Boardroom seats 42**

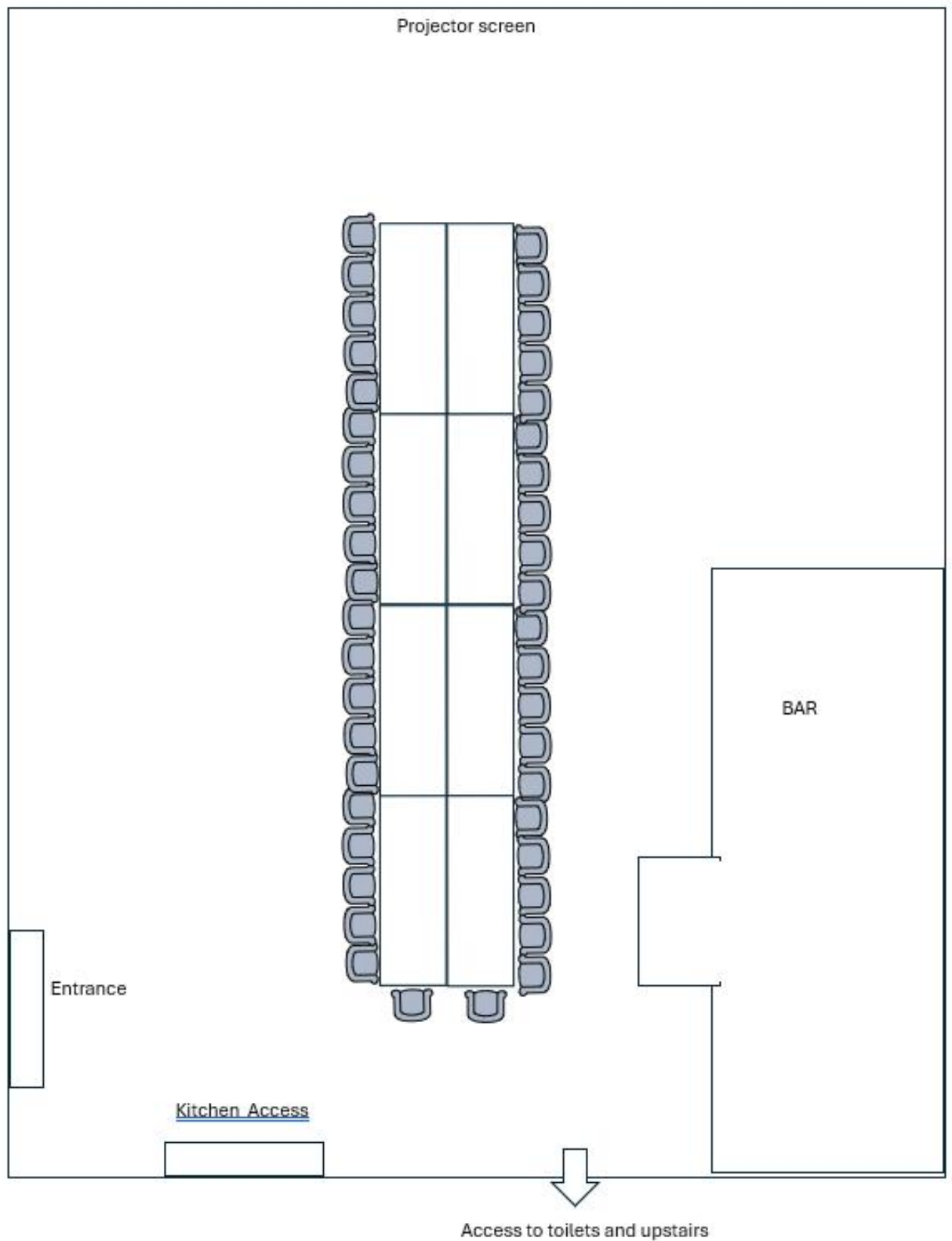

# Herringbone seats 108

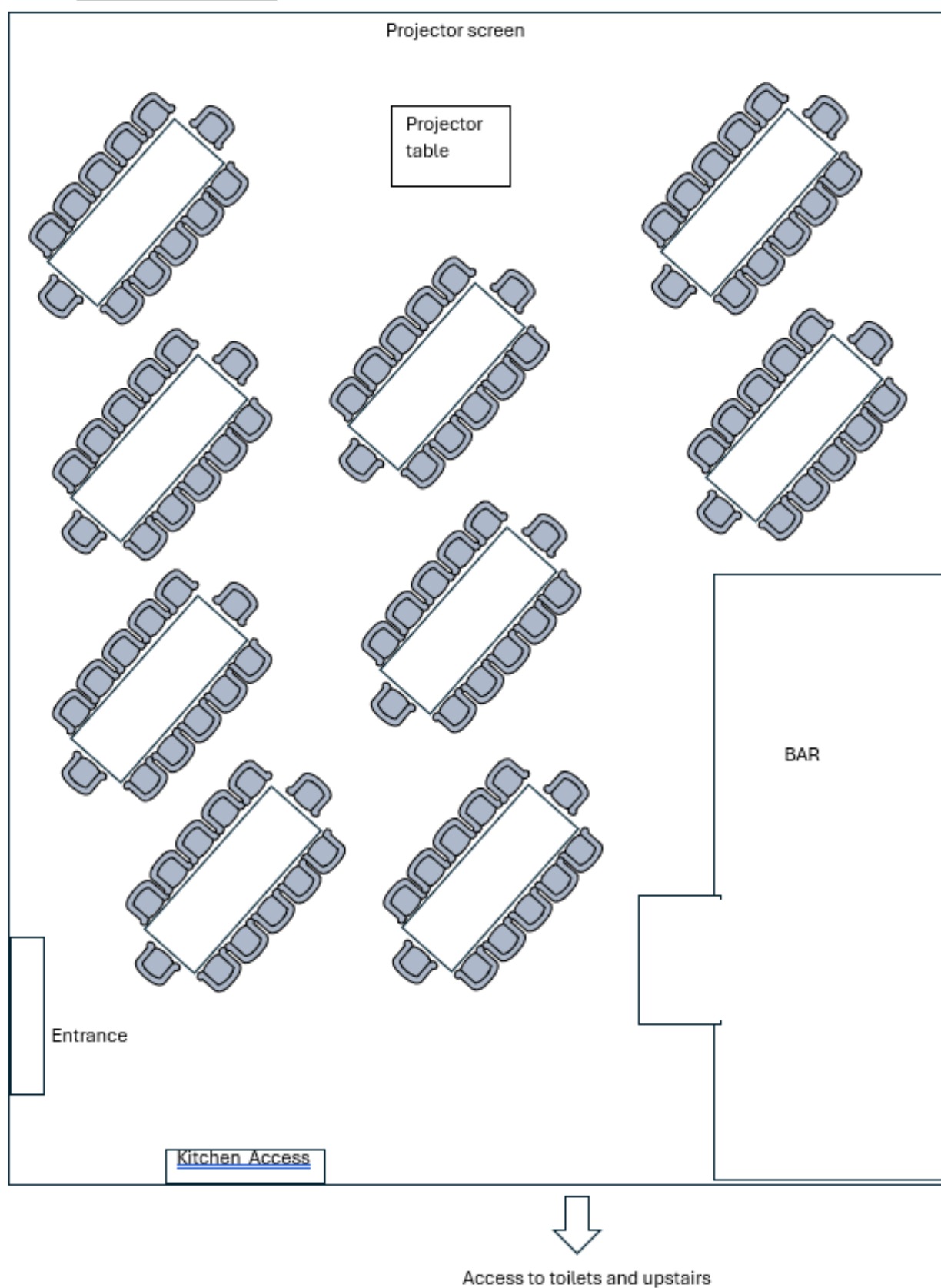

## Cabaret. Seats 72

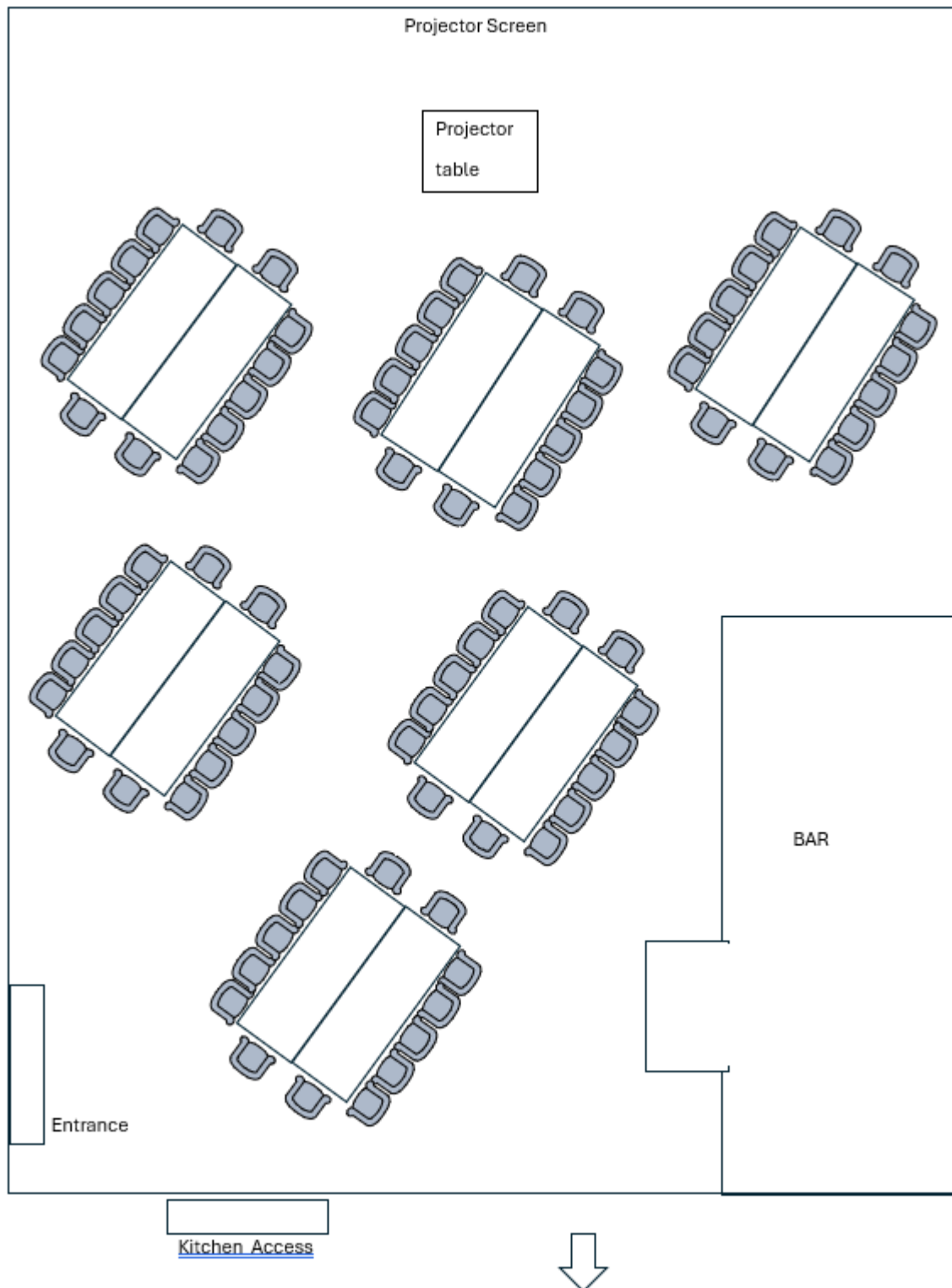



# Horse-shoe Seats 79

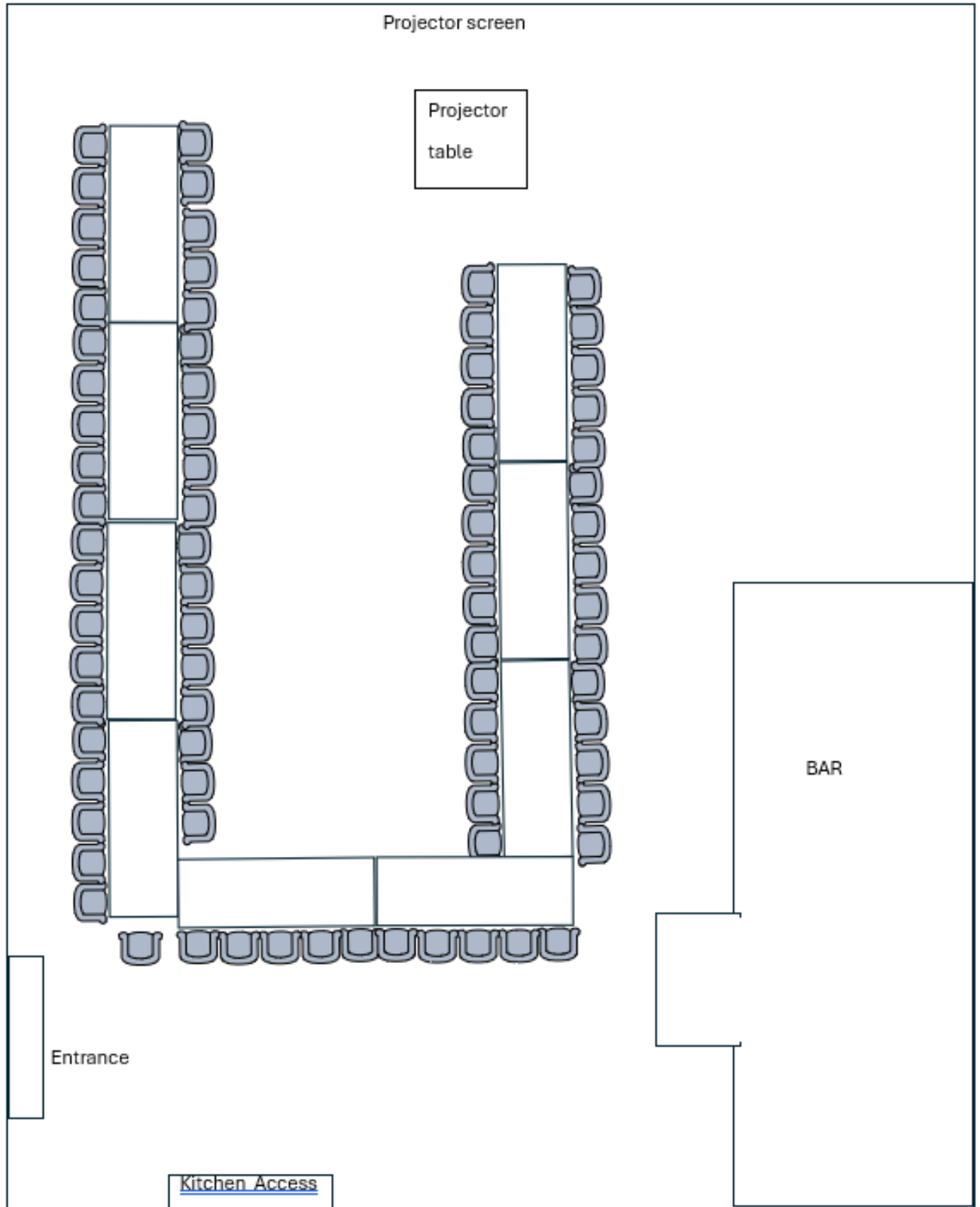

Banquet seats 134

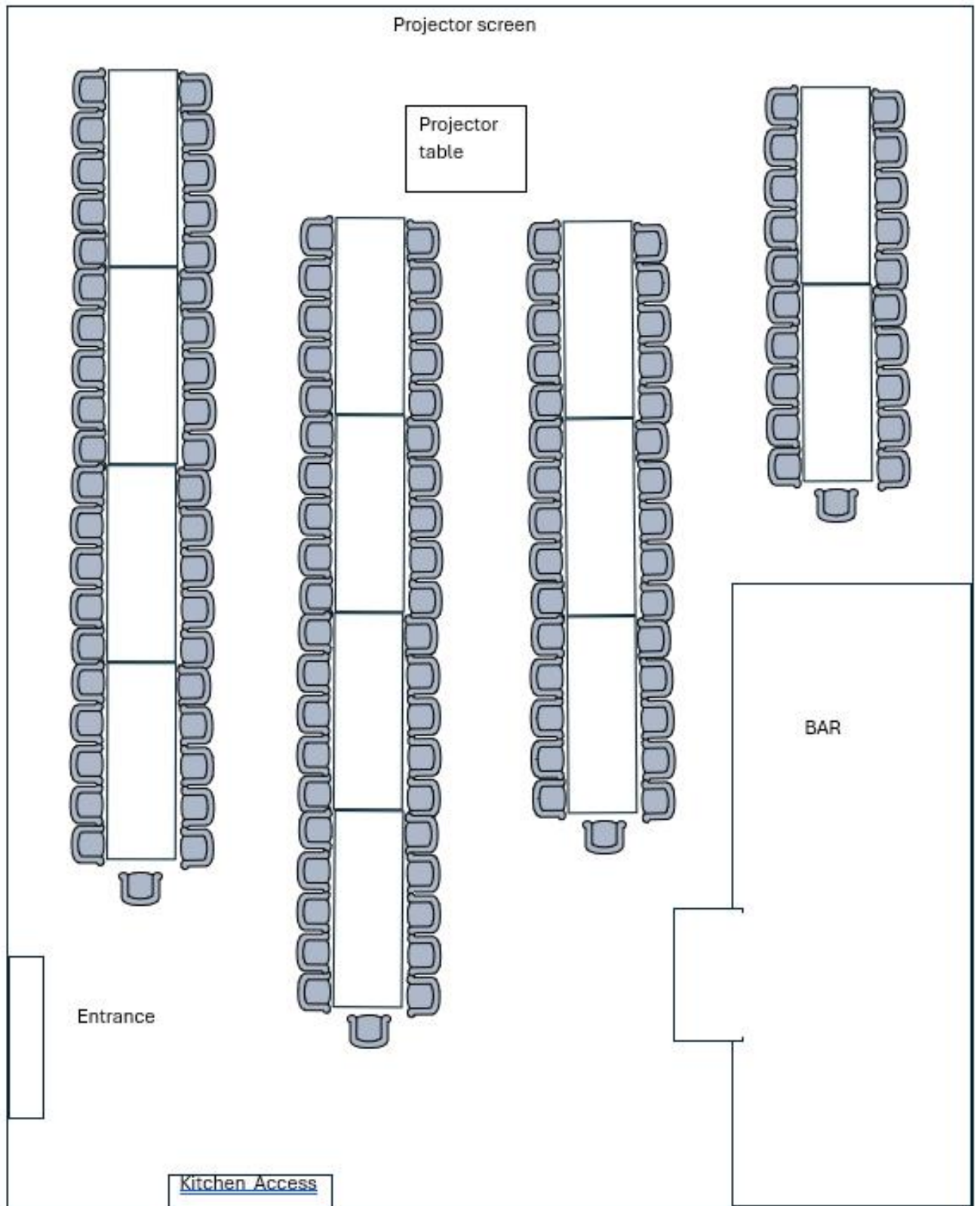

**Theatre style 150**

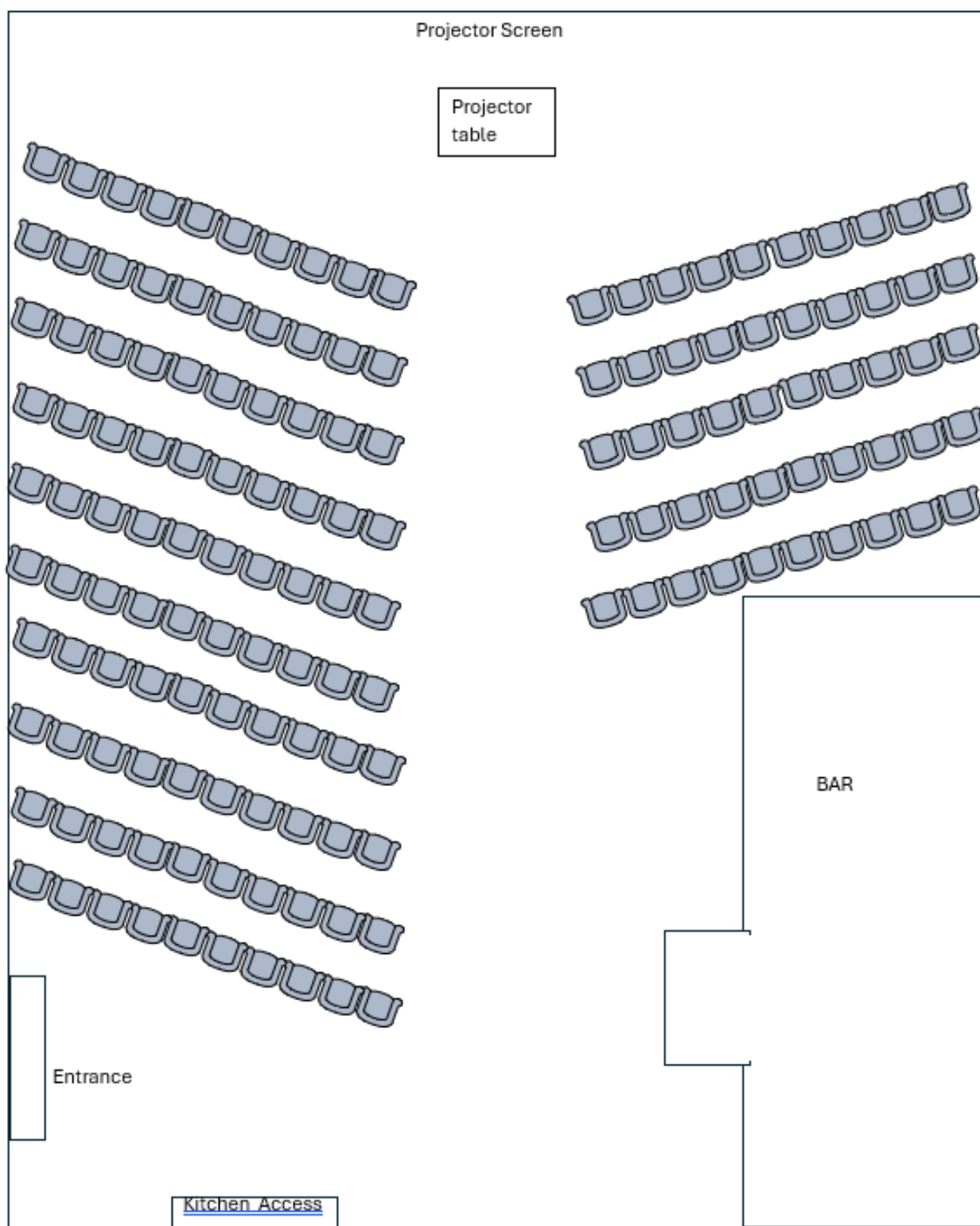

Theatre style with breakout tables max 50

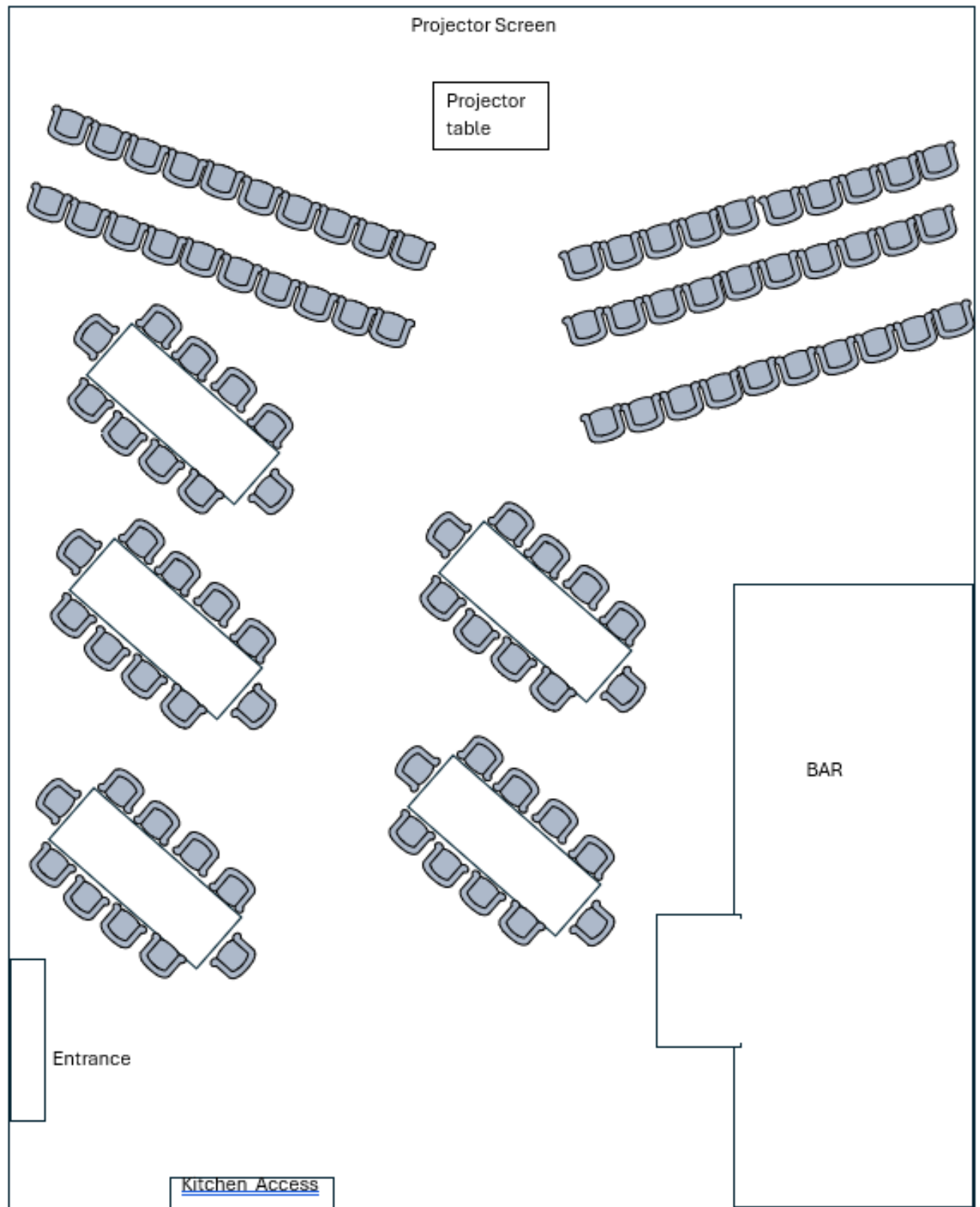

**Meet the buyer / Expo** Please see electric socket points document for supply

Using 13x 8ft tables. 2x 6ft tables

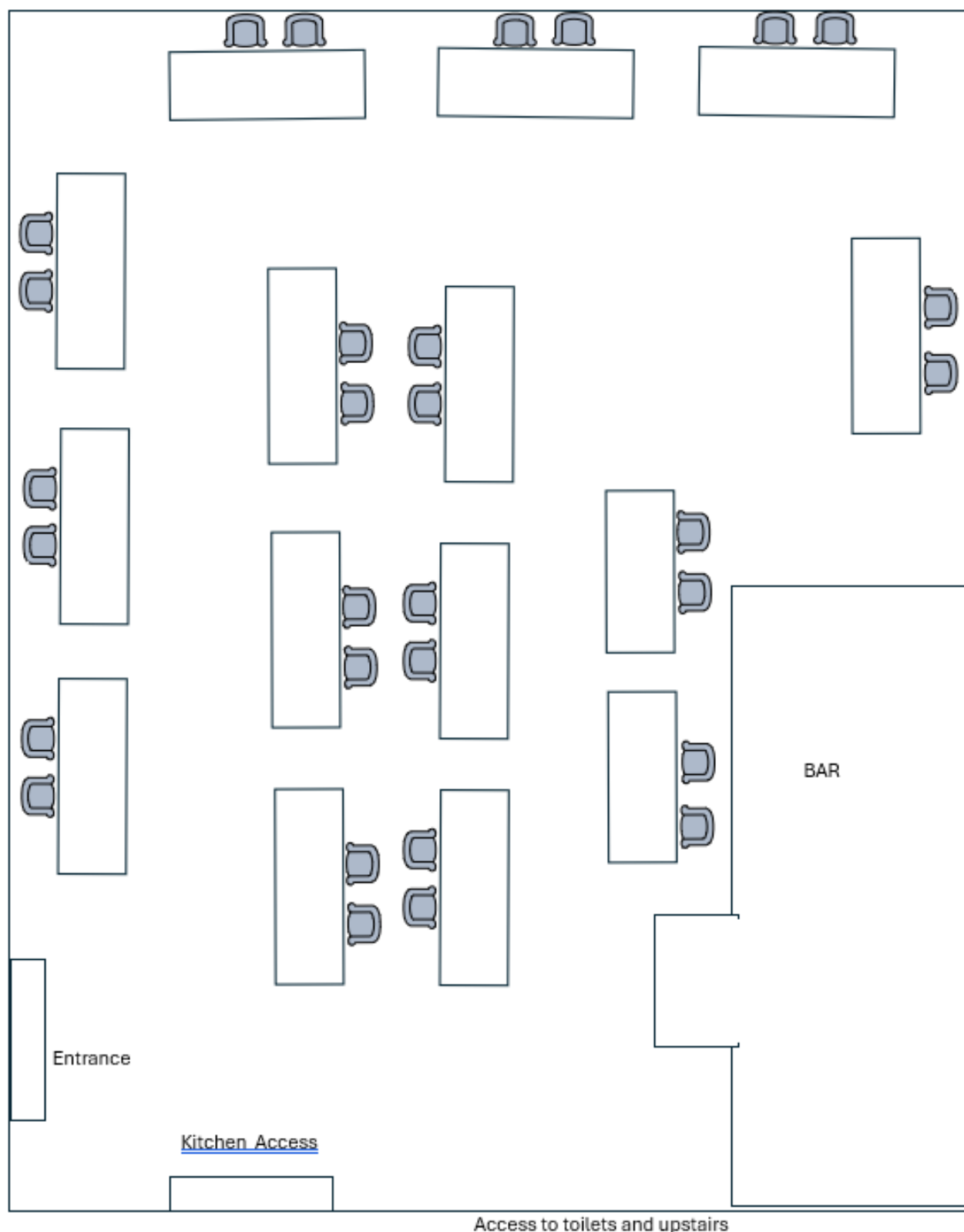

### Upstairs mezzanine

\*These tables are taken out of the break out room meaning it will no longer sit 14 people.

6x Tables measure 3.5ft long

