

Inline Check and Relief Check Valves

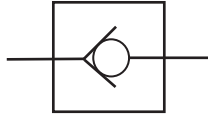

These spring-operated poppet valves, with optional relief settings, allow free flow in only one direction and prevent backflow - sometimes referred to as "backflow preventor", "flow stop", or "non-return" valve. They are also used for relief and bypass functions.

Kepner's *Flexible Seal Seat™* combines metal-to-metal contact with a resilient seal seat ensuring dependable bubble-tight shutoff of liquid or gas, and long service life. Standard and specialty valve designs handle a wide variety of applications.

Features and Benefits:

- *Flexible Seal Seat™* for zero leakage (bubble-tight) sealing at low and high pressures.
- O-Ring seal positively secured.
- Non-pressurized threads.
- Poppet stop inside valve body prevents spring from bottoming out.
- Generous flow passages allow full flow with minimal pressure drop.

Valve Specifications:

- Port Configurations: Pipe or Tube (NPT, JIC; 12 Combinations)
- Port Sizes: 1/8 inch to 3 inch (3.2 mm to 76 mm)
- Body Materials: Aluminum, Brass, Steel, 303 or 316 Stainless Steel
- O-Ring Seals: Buna-N, Neoprene, Teflon®, Viton®, EP, others available
- Temperature: -300°F to 450°F (-184°C to 232°C), O-Ring dependent
- Check Crack Pressure: 1 - 2 PSI (.07 bar to .14 bar)
- Relief/Check Crack Pressures: 5 PSI (.35 bar), 10 PSI (0.7 bar), 25 PSI (1.7 bar), 50 PSI (3.5 bar) and 65 PSI (4.5 bar), others available
- Operating Pressure: to 3,000 PSI (207 bar)
- Flow: to 500 GPM (1893 LPM)

Consult Factory or Distributor for more help. Customer/user is solely responsible to select products suitable for their specific application requirements and to ensure proper installation, operation and maintenance of these products. Improper selection or use of products can cause personal injury or property damage. All sales are subject to Kepner Products Company Standard Terms and Conditions of Sale. Design subject to change without notice.

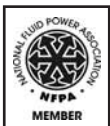

995 N. Ellsworth Avenue
Villa Park, IL 60181
Phone: 630-279-1550
FAX: 630-279-9669
www.kepner.com



KEPNER

PRODUCTS COMPANY



Inline Check and Relief Check Valves

Part Numbers: Fixed Settings 1/8" to 3" sizes

PORT CONFIGURATIONS

| | |
|--|--|
| 19 IJIC - IJIC IJIC TUBE TO TUBE | 7 JIC - MPT JIC TUBE TO PIPE |
| 17 JIC - IJIC JIC TUBE TO TUBE | 5 MPT - JIC MPT PIPE TO TUBE |
| 15 IJIC - JIC IJIC TUBE TO TUBE | 4 FPT - FPT FPT PIPE TO PIPE |
| 13 JIC - JIC JIC TUBE TO TUBE | 3 MPT - MPT MPT PIPE TO PIPE |
| 11 JIC - FPT JIC TUBE TO PIPE | 2 FPT - MPT FPT PIPE TO PIPE |
| 9 FPT - JIC FPT PIPE TO TUBE | 1 MPT - FPT MPT PIPE TO PIPE |

Consult Factory or Distributor for more help.

Customer/user is solely responsible to select products suitable for their specific application requirements and to ensure proper installation, operation and maintenance of these products. Improper selection or use of products can cause personal injury or property damage. All sales are subject to Kepner Products Company Standard Terms and Conditions of Sale. Design subject to change without notice.

PART NUMBER EXAMPLE

4 06 C - 1 - 25

PORT SIZES

| | |
|--------------------------|--------------------------------|
| 04 = 1/8 PIPE - 1/4 TUBE | 16 = 1" PIPE - 1" TUBE |
| 06 = 1/4 PIPE - 3/8 TUBE | 20 = 1 1/4 PIPE - 1 1/4 TUBE |
| 08 = 3/8 PIPE - 1/2 TUBE | 24 = 1 1/2 PIPE - 1 1/2 TUBE |
| 10 = 1/2 PIPE - 5/8 TUBE | 32 = 2" PIPE - 2" TUBE |
| 12 = 3/4 PIPE - 3/4 TUBE | 48 = 3" PIPE (CONSULT FACTORY) |

CRACK PRESSURE

"Blank" = 1-2 PSI CRACK (Standard)
5 = 5 PSI CRACK
10 = 10 PSI CRACK
25 = 25 PSI CRACK
50 = 50 PSI CRACK
65 = 65 PSI CRACK
OTHERS AVAILABLE

CONSTRUCTION MATERIALS

| | |
|--------------|-------------------------|
| A = ALUMINUM | D = 303 STAINLESS STEEL |
| B = BRASS | F = 316 STAINLESS STEEL |
| C = STEEL | |

O-RING SEALS

1 = BUNA-N
3* = TEFLON®
9 = NEOPRENE
18 = VITON®
25 = ETHYLENE PROPYLENE
OTHERS AVAILABLE

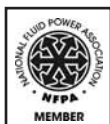

995 N. Ellsworth Avenue
Villa Park, IL 60181
Phone: 630-279-1550
FAX: 630-279-9669
www.kepner.com



KEPNER

PRODUCTS COMPANY



Inline Check and Relief Check Valves

Flow Charts: Sizes 1/8" - 1"

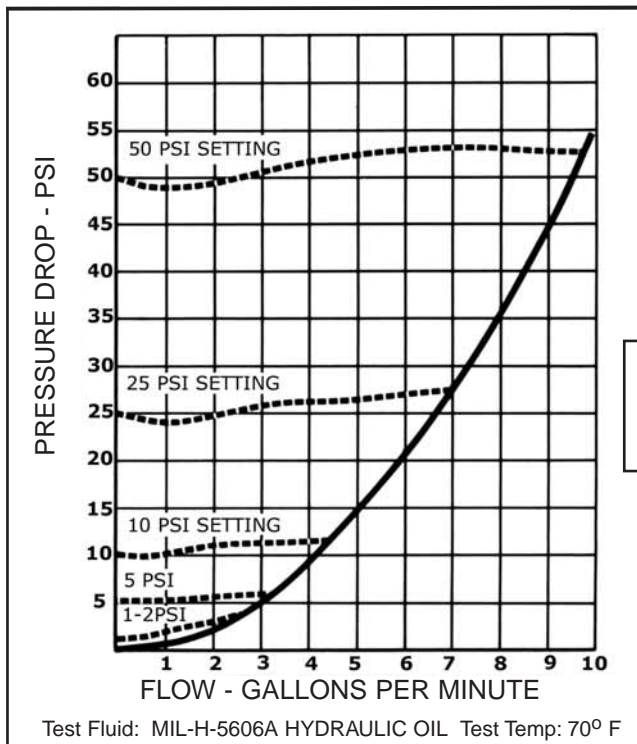
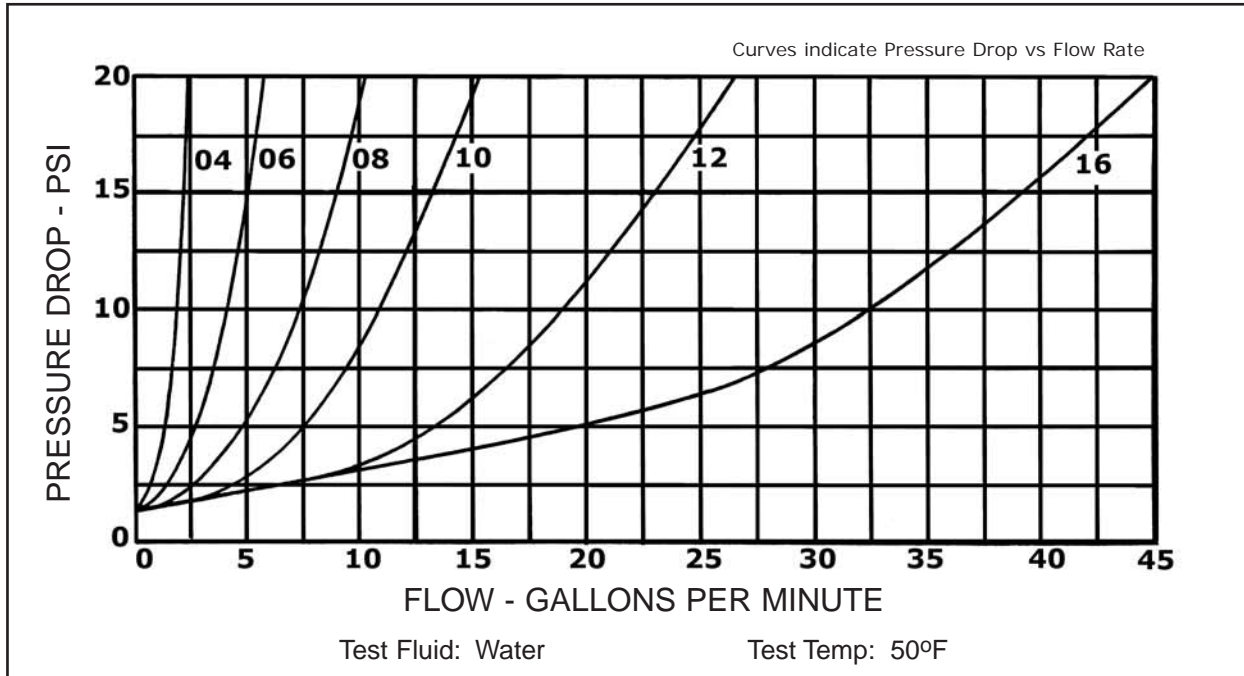

| SIZE | CONNECTIONS |
|------|------------------------|
| 04 | 1/8" Pipe or 1/4" Tube |
| 06 | 1/4" Pipe or 3/8" Tube |
| 08 | 3/8" Pipe or 1/2" Tube |
| 10 | 1/2" Pipe or 5/8" Tube |
| 12 | 3/4" Pipe or 3/4" Tube |
| 16 | 1" Pipe or 1" Tube |

EXAMPLE WITH VARIOUS RELIEF SETTINGS

Consult Factory or Distributor for more help. Customer/user is solely responsible to select products suitable for their specific application requirements and to ensure proper installation, operation and maintenance of these products. Improper selection or use of products can cause personal injury or property damage. All sales are subject to Kepner Products Company Standard Terms and Conditions of Sale. Design subject to change without notice.

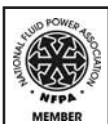

995 N. Ellsworth Avenue
Villa Park, IL 60181
Phone: 630-279-1550
FAX: 630-279-9669
www.kepner.com



KEPNER
PRODUCTS COMPANY



Inline Check and Relief Check Valves

Flow Charts: Sizes 1 $\frac{1}{4}$ " - 2"

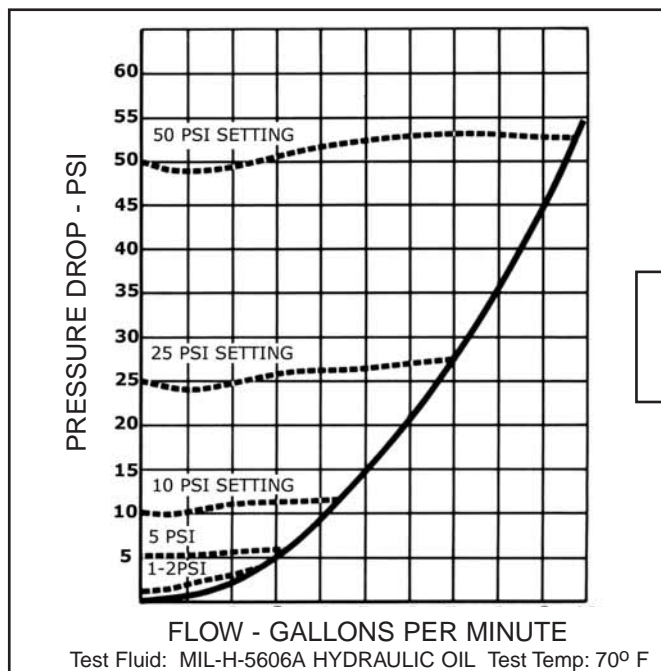
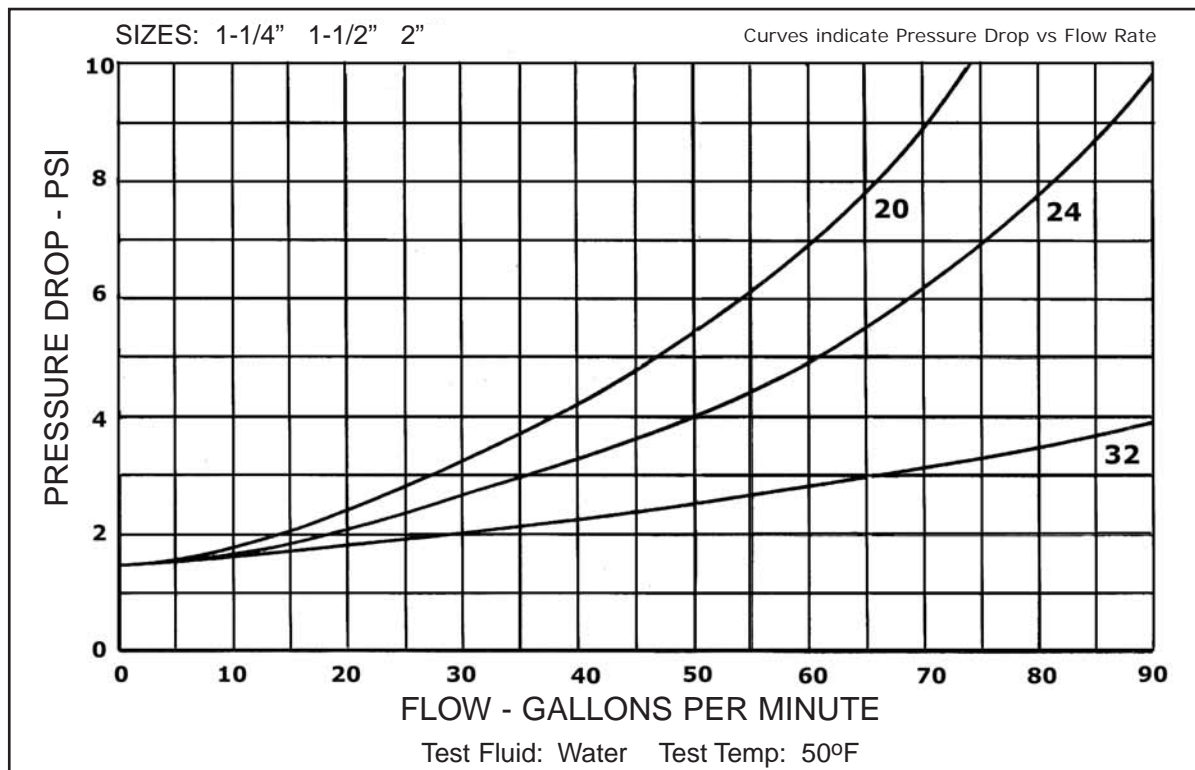

| SIZE | CONNECTIONS |
|------|---------------------|
| 20 | 1-1/4" Pipe or Tube |
| 24 | 1-1/2" Pipe or Tube |
| 32 | 2" Pipe or Tube |

EXAMPLE WITH VARIOUS RELIEF SETTINGS

Consult Factory or Distributor for more help. Customer/user is solely responsible to select products suitable for their specific application requirements and to ensure proper installation, operation and maintenance of these products. Improper selection or use of products can cause personal injury or property damage. All sales are subject to Kepner Products Company Standard Terms and Conditions of Sale. Design subject to change without notice.

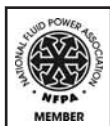

995 N. Ellsworth Avenue
Villa Park, IL 60181
Phone: 630-279-1550
FAX: 630-279-9669
www.kepner.com



KEPNER
PRODUCTS COMPANY



Inline Check and Relief Check Valves

Dimensions: Model 100

| MODEL | A | B | C (REF) | D | E | F HEX. | G MPT | H FPT |
|-------|------|------|---------|-----|------|-------------|-------|-------|
| 104 | 2.27 | .40 | 1.87 | .20 | .56 | 11/16 | 1/8 | 1/8 |
| 106 | 3.01 | .60 | 2.41 | .28 | .97 | 13/16 | 1/4 | 1/4 |
| 108 | 3.19 | .61 | 2.58 | .30 | .72 | 1 | 3/8 | 3/8 |
| 110 | 3.88 | .79 | 3.09 | .34 | 1.03 | 1 1/8 | 1/2 | 1/2 |
| 112 | 4.34 | .80 | 3.54 | .41 | 1.19 | 1 7/16 (1) | 3/4 | 3/4 |
| 116 | 5.18 | 1.00 | 4.18 | .53 | 1.31 | 1 13/16 (2) | 1 | 1 |
| 120 | 6.14 | .97 | 5.17 | .73 | 1.59 | 2 5/8 (3) | 1 1/4 | 1 1/4 |
| 124 | 6.17 | 1.00 | 5.17 | .73 | 1.59 | 2 5/8 (3) | 1 1/2 | 1 1/2 |
| 132 | 7.72 | 1.03 | 6.69 | .94 | 2.00 | 3 1/2 | 2 | 2 |

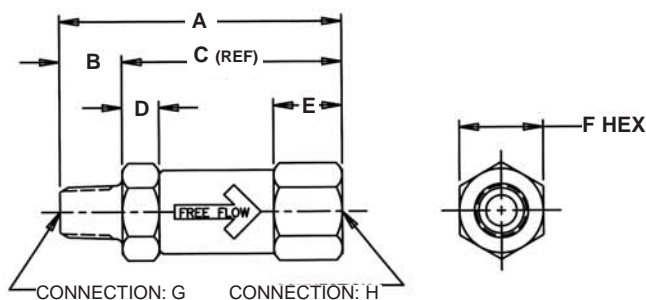

NOTES BELOW REFER TO COLUMN "F"

- (1) 1 1/2 FOR 316 STAINLESS STEEL
- (2) 1 7/8 FOR 303 & 316 STAINLESS STEEL
- (3) 2 3/4 FOR COMMERCIAL BRASS

Model 200

| MODEL | A | B | C (REF) | D | E | F HEX. | G FPT | H MPT |
|-------|------|------|---------|-----|------|-------------|-------|-------|
| 204 | 2.00 | .40 | 1.60 | .27 | .23 | 11/16 | 1/8 | 1/8 |
| 206 | 2.64 | .60 | 2.04 | .53 | .35 | 13/16 | 1/4 | 1/4 |
| 208 | 2.84 | .61 | 2.23 | .30 | .38 | 1 | 3/8 | 3/8 |
| 210 | 3.33 | .79 | 2.54 | .44 | .38 | 1 1/8 | 1/2 | 1/2 |
| 212 | 3.75 | .81 | 2.95 | .56 | .44 | 1 7/16 (1) | 3/4 | 3/4 |
| 216 | 4.47 | 1.00 | 3.47 | .53 | .60 | 1 13/16 (2) | 1 | 1 |
| 220 | 5.42 | .97 | 4.45 | .73 | .88 | 2 5/8 (3) | 1 1/4 | 1 1/4 |
| 224 | 5.47 | 1.00 | 4.47 | .75 | .88 | 2 5/8 (3) | 1 1/2 | 1 1/2 |
| 232 | 6.91 | 1.03 | 5.88 | .94 | 1.19 | 3 1/2 | 2 | 2 |

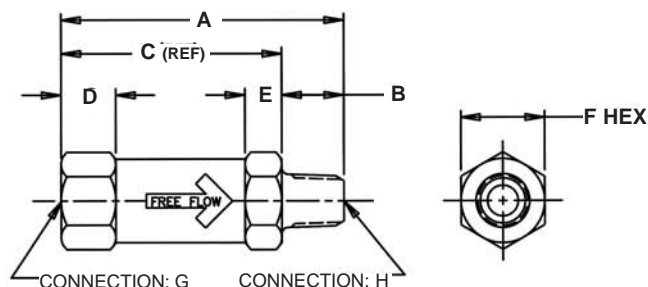

NOTES BELOW REFER TO COLUMN "F"

- (1) 1 1/2 FOR 316 STAINLESS STEEL
- (2) 1 7/8 FOR 303 & 316 STAINLESS STEEL
- (3) 2 3/4 FOR COMMERCIAL BRASS

Model 300

| MODEL | A | B | C (REF) | D | E | F HEX. | G MPT | H MPT |
|-------|------|------|---------|-----|------|-------------|-------|-------|
| 304 | 2.34 | .40 | 1.54 | .20 | .22 | 11/16 | 1/8 | 1/8 |
| 306 | 2.99 | .60 | 1.79 | .28 | .35 | 13/16 | 1/4 | 1/4 |
| 308 | 3.45 | .61 | 2.23 | .30 | .38 | 1 | 3/8 | 3/8 |
| 310 | 4.02 | .79 | 2.44 | .34 | .38 | 1 1/8 | 1/2 | 1/2 |
| 312 | 4.40 | .80 | 2.80 | .41 | .44 | 1 7/16 (1) | 3/4 | 3/4 |
| 316 | 5.46 | 1.00 | 3.46 | .53 | .60 | 1 13/16 (2) | 1 | 1 |
| 320 | 6.39 | .97 | 4.45 | .73 | .88 | 2 5/8 (3) | 1 1/4 | 1 1/4 |
| 324 | 6.45 | 1.00 | 4.45 | .73 | .88 | 2 5/8 (3) | 1 1/2 | 1 1/2 |
| 332 | 7.94 | 1.03 | 5.88 | .94 | 1.19 | 3 1/2 | 2 | 2 |

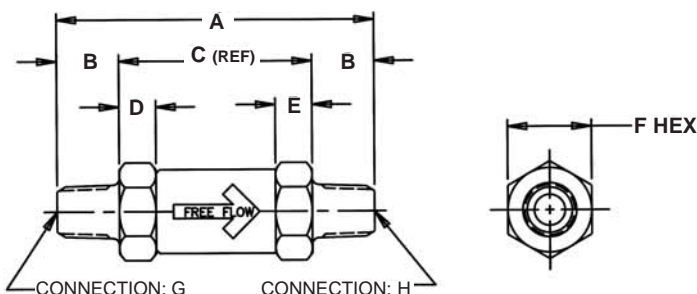

NOTES BELOW REFER TO COLUMN "F"

- (1) 1 1/2 FOR 316 STAINLESS STEEL
- (2) 1 7/8 FOR 303 & 316 STAINLESS STEEL
- (3) 2 3/4 FOR COMMERCIAL BRASS

ALL DIMENSIONS (IN INCHES) ARE FOR REFERENCE ONLY.

Consult Factory or Distributor for more help. Customer/user is solely responsible to select products suitable for their specific application requirements and to ensure proper installation, operation and maintenance of these products. Improper selection or use of products can cause personal injury or property damage. All sales are subject to Kepner Products Company Standard Terms and Conditions of Sale. Design subject to change without notice.

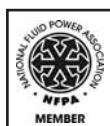

995 N. Ellsworth Avenue
Villa Park, IL 60181
Phone: 630-279-1550
FAX: 630-279-9669
www.kepner.com



KEPNER
PRODUCTS COMPANY



Inline Check and Relief Check Valves

Dimensions: Model 400

| MODEL | A | B | C (REF) | D | E | F HEX. | G FPT | H FPT |
|-------|------|---|------------|-----|------|-----------|----------|----------|
| 404 | 1.94 | - | - | .27 | .56 | 11/16 | 1/8 | 1/8 |
| 406 | 2.66 | - | - | .53 | .98 | 13/16 | 1/4 | 1/4 |
| 408 | 2.58 | - | - | .30 | .72 | 1 | 3/8 | 3/8 |
| 410 | 3.19 | - | - | .44 | 1.03 | 1 1/8 | 1/2 | 1/2 |
| 412 | 3.69 | - | - | .56 | 1.19 | 1 7/16 ① | 3/4 | 3/4 |
| 416 | 4.19 | - | - | .53 | 1.31 | 1 13/16 ② | 1 | 1 |
| 420 | 5.17 | - | - | .73 | 1.59 | 2 5/8 ③ | 1 1/4 | 1 1/4 |
| 424 | 5.19 | - | - | .75 | 1.59 | 2 5/8 ③ | 1 1/2 | 1 1/2 |
| 432 | 6.69 | - | - | .94 | 2.00 | 3 1/2 | 2 | 2 |

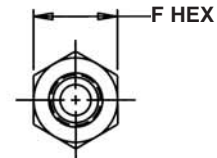
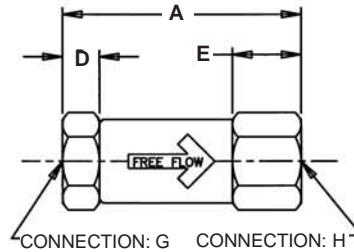

CONNECTION: G CONNECTION: H

NOTES BELOW REFER TO COLUMN "F"

- ① 1 1/2 FOR 316 STAINLESS STEEL
- ② 1 7/8 FOR 303 & 316 STAINLESS STEEL
- ③ 2 3/4 FOR COMMERCIAL BRASS

Model 500

| MODEL | A | B1 | B2 | C (REF) | D | E | F HEX. | G MPT | H JIC |
|-------|------|------|------|------------|-----|------|-----------|----------|----------|
| 504 | 2.48 | .40 | .55 | 1.53 | .20 | .22 | 11/16 | 1/8 | 1/4 |
| 506 | 2.95 | .60 | .56 | 1.79 | .28 | .35 | 13/16 | 1/4 | 3/8 |
| 508 | 3.50 | .61 | .66 | 2.23 | .30 | .37 | 1 | 3/8 | 1/2 |
| 510 | 3.98 | .79 | .76 | 2.43 | .34 | .37 | 1 1/8 | 1/2 | 5/8 |
| 512 | 4.45 | .80 | .86 | 2.79 | .41 | .44 | 1 7/16 ① | 3/4 | 3/4 |
| 516 | 5.37 | 1.00 | .91 | 3.46 | .53 | .59 | 1 13/16 ② | 1 | 1 |
| 520 | 6.37 | .97 | .96 | 4.44 | .73 | .87 | 2 5/8 ③ | 1 1/4 | 1 1/4 |
| 524 | 6.53 | 1.00 | 1.08 | 4.45 | .73 | .87 | 2 5/8 ③ | 1 1/2 | 1 1/2 |
| 532 | 8.24 | 1.03 | 1.33 | 5.88 | .94 | 1.18 | 3 1/2 | 2 | 2 |

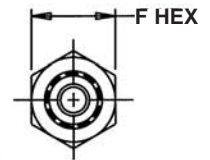
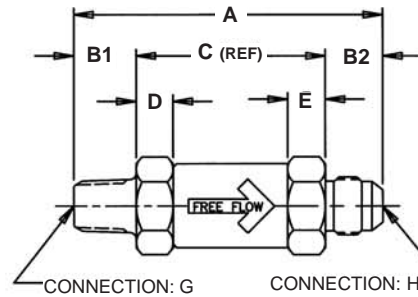

CONNECTION: G

CONNECTION: H

NOTES BELOW REFER TO COLUMN "F"

- ① 1 1/2 FOR 316 STAINLESS STEEL
- ② 1 7/8 FOR 303 & 316 STAINLESS STEEL
- ③ 2 3/4 FOR COMMERCIAL BRASS

Model 700

| MODEL | A | B1 | B2 | C (REF) | D | E | F HEX. | G JIC | H MPT |
|-------|------|------|------|------------|-----|------|-----------|----------|----------|
| 704 | 2.49 | .55 | .40 | 1.54 | .20 | .23 | 11/16 | 1/4 | 1/8 |
| 706 | 2.95 | .56 | .60 | 1.79 | .28 | .35 | 13/16 | 3/8 | 1/4 |
| 708 | 3.50 | .66 | .61 | 2.23 | .30 | .38 | 1 | 1/2 | 3/8 |
| 710 | 3.99 | .76 | .79 | 2.44 | .34 | .38 | 1 1/8 | 5/8 | 1/2 |
| 712 | 4.46 | .86 | .80 | 2.80 | .41 | .44 | 1 7/16 ① | 3/4 | 3/4 |
| 716 | 5.38 | .91 | 1.00 | 3.47 | .53 | .60 | 1 13/16 ② | 1 | 1 |
| 720 | 6.38 | .96 | .97 | 4.45 | .73 | .88 | 2 5/8 ③ | 1 1/4 | 1 1/4 |
| 724 | 6.54 | 1.08 | 1.00 | 4.46 | .73 | .88 | 2 5/8 ③ | 1 1/2 | 1 1/2 |
| 732 | 8.24 | 1.33 | 1.03 | 5.88 | .94 | 1.19 | 3 1/2 | 2 | 2 |

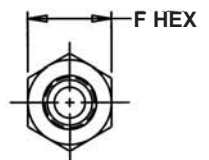
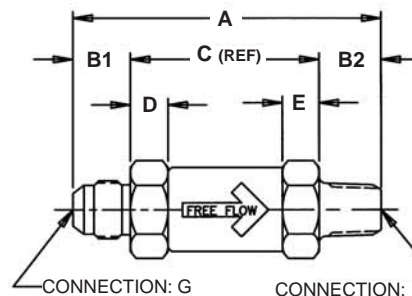

CONNECTION: G

CONNECTION: H

NOTES BELOW REFER TO COLUMN "F"

- ① 1 1/2 FOR 316 STAINLESS STEEL
- ② 1 7/8 FOR 303 & 316 STAINLESS STEEL
- ③ 2 3/4 FOR COMMERCIAL BRASS

ALL DIMENSIONS (IN INCHES) ARE FOR REFERENCE ONLY.

Consult Factory or Distributor for more help. Customer/user is solely responsible to select products suitable for their specific application requirements and to ensure proper installation, operation and maintenance of these products. Improper selection or use of products can cause personal injury or property damage. All sales are subject to Kepner Products Company Standard Terms and Conditions of Sale. Design subject to change without notice.

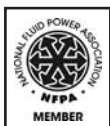

995 N. Ellsworth Avenue
Villa Park, IL 60181
Phone: 630-279-1550
FAX: 630-279-9669
www.kepner.com



KEPNER
PRODUCTS COMPANY



Inline Check and Relief Check Valves

Dimensions: Model 900

| MODEL | A | B | C (REF) | D | E | F HEX. | G FPT | H JIC |
|-------|------|------|---------|-----|------|---------|----------|----------|
| 904 | 2.14 | .55 | 1.59 | .27 | .22 | 11/16 | 1/8 | 1/4 |
| 906 | 2.59 | .56 | 2.03 | .53 | .35 | 13/16 | 1/4 | 3/8 |
| 908 | 2.89 | .66 | 2.23 | .30 | .37 | 1 | 3/8 | 1/2 |
| 910 | 3.28 | .76 | 2.52 | .44 | .37 | 1 1/8 | 1/2 | 5/8 |
| 912 | 3.80 | .86 | 2.94 | .56 | .44 | 1 7/16 | 3/4 | 3/4 |
| 916 | 4.38 | .91 | 3.47 | .53 | .59 | 1 13/16 | 1 | 1 |
| 920 | 5.41 | .96 | 4.45 | .73 | .87 | 2 5/8 | 1 1/4 | 1 1/4 |
| 924 | 5.55 | 1.08 | 4.47 | .75 | .87 | 2 5/8 | 1 1/2 | 1 1/2 |
| 932 | 7.20 | 1.33 | 5.87 | .94 | 1.18 | 3 1/2 | 2 | 2 |

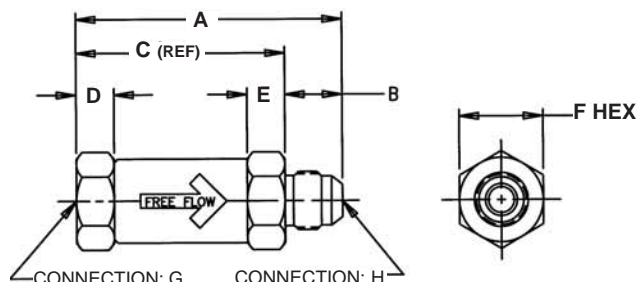

NOTES BELOW REFER TO COLUMN "F"

- ① 1 1/2 FOR 316 STAINLESS STEEL
- ② 1 7/8 FOR 303 & 316 STAINLESS STEEL
- ③ 2 3/4 FOR COMMERCIAL BRASS

Model 1100

| MODEL | A | B | C (REF) | D | E | F HEX. | G JIC | H FPT |
|-------|------|------|---------|-----|------|---------|----------|----------|
| 1104 | 2.43 | .55 | 1.88 | .20 | .56 | 11/16 | 1/4 | 1/8 |
| 1106 | 2.97 | .56 | 2.41 | .28 | .97 | 13/16 | 3/8 | 1/4 |
| 1108 | 3.24 | .66 | 2.58 | .30 | .72 | 1 | 1/2 | 3/8 |
| 1110 | 3.85 | .76 | 3.09 | .34 | 1.03 | 1 1/8 | 5/8 | 1/2 |
| 1112 | 4.40 | .86 | 3.54 | .41 | 1.19 | 1 7/16 | 3/4 | 3/4 |
| 1116 | 5.10 | .91 | 4.19 | .53 | 1.31 | 1 13/16 | 1 | 1 |
| 1120 | 6.13 | .96 | 5.17 | .73 | 1.59 | 2 5/8 | 1 1/4 | 1 1/4 |
| 1124 | 6.26 | 1.08 | 5.18 | .73 | 1.59 | 2 5/8 | 1 1/2 | 1 1/2 |
| 1132 | 8.02 | 1.33 | 6.69 | .94 | 2.00 | 3 1/2 | 2 | 2 |

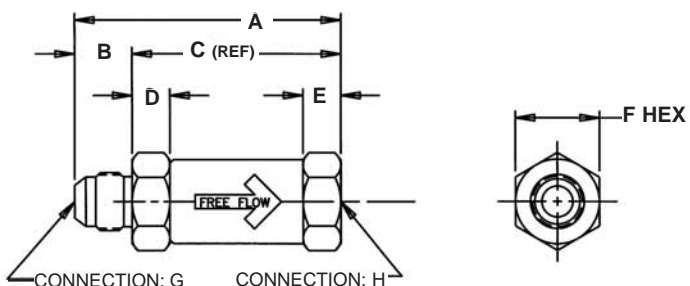

NOTES BELOW REFER TO COLUMN "F"

- ① 1 1/2 FOR 316 STAINLESS STEEL
- ② 1 7/8 FOR 303 & 316 STAINLESS STEEL
- ③ 2 3/4 FOR COMMERCIAL BRASS

Model 1300

| MODEL | A | B | C (REF) | D | E | F HEX. | G JIC | H JIC |
|-------|------|------|---------|-----|------|---------|----------|----------|
| 1304 | 2.63 | .55 | 1.53 | .20 | .22 | 11/16 | 1/4 | 1/4 |
| 1306 | 2.90 | .56 | 1.78 | .28 | .35 | 13/16 | 3/8 | 3/8 |
| 1308 | 3.55 | .66 | 2.23 | .30 | .37 | 1 | 1/2 | 1/2 |
| 1310 | 3.95 | .76 | 2.43 | .34 | .37 | 1 1/8 | 5/8 | 5/8 |
| 1312 | 4.51 | .86 | 2.79 | .41 | .44 | 1 7/16 | 3/4 | 3/4 |
| 1316 | 5.29 | .91 | 3.47 | .53 | .59 | 1 13/16 | 1 | 1 |
| 1320 | 6.36 | .96 | 4.44 | .73 | .87 | 2 5/8 | 1 1/4 | 1 1/4 |
| 1324 | 6.61 | 1.08 | 4.45 | .73 | .87 | 2 5/8 | 1 1/2 | 1 1/2 |
| 1332 | 8.54 | 1.33 | 5.88 | .94 | 1.18 | 3 1/2 | 2 | 2 |

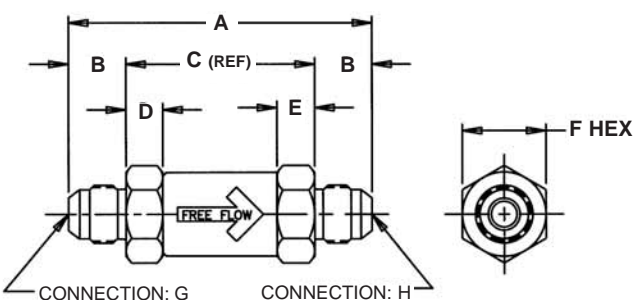

NOTES BELOW REFER TO COLUMN "F"

- ① 1 1/2 FOR 316 STAINLESS STEEL
- ② 1 7/8 FOR 303 & 316 STAINLESS STEEL
- ③ 2 3/4 FOR COMMERCIAL BRASS

ALL DIMENSIONS (IN INCHES) ARE FOR REFERENCE ONLY.

Consult Factory or Distributor for more help. Customer/user is solely responsible to select products suitable for their specific application requirements and to ensure proper installation, operation and maintenance of these products. Improper selection or use of products can cause personal injury or property damage. All sales are subject to Kepner Products Company Standard Terms and Conditions of Sale. Design subject to change without notice.

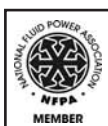

995 N. Ellsworth Avenue
Villa Park, IL 60181
Phone: 630-279-1550
FAX: 630-279-9669
www.kepner.com



KEPNER
PRODUCTS COMPANY



Inline Check and Relief Check Valves

Dimensions: Model 1500

| MODEL | A | B | C (REF) | D | E | F HEX. | G IJIC | H JIC |
|-------|------|------|---------|------|------|-------------|--------|-------|
| 1504 | 2.47 | .55 | 1.92 | .60 | .22 | 11/16 | 1/4 | 1/4 |
| 1506 | 2.65 | .56 | 2.09 | .58 | .35 | 13/16 | 3/8 | 3/8 |
| 1508 | 3.28 | .66 | 2.62 | .68 | .37 | 1 | 1/2 | 1/2 |
| 1510 | 3.61 | .76 | 2.85 | .77 | .37 | 1 1/8 | 5/8 | 5/8 |
| 1512 | 4.17 | .86 | 3.31 | .93 | .44 | 1 7/16 (1) | 3/4 | 3/4 |
| 1516 | 4.80 | .91 | 3.89 | .95 | .59 | 1 13/16 (2) | 1 | 1 |
| 1520 | 5.66 | .96 | 4.70 | .99 | .87 | 2 5/8 (3) | 1 1/4 | 1 1/4 |
| 1524 | 6.05 | 1.08 | 4.97 | 1.25 | .87 | 2 5/8 (3) | 1 1/2 | 1 1/2 |
| 1532 | 7.45 | 1.33 | 6.12 | 1.19 | 1.18 | 3 1/2 | 2 | 2 |

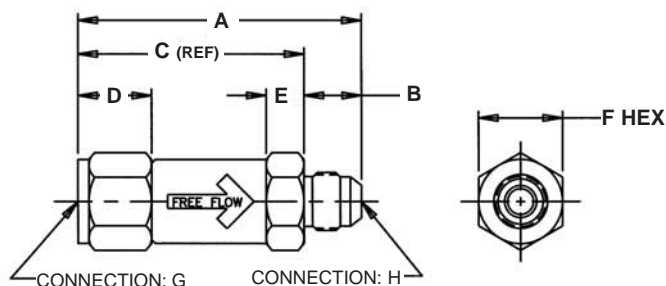

NOTES BELOW REFER TO COLUMN "F"

- (1) 1 1/2 FOR 316 STAINLESS STEEL
- (2) 1 7/8 FOR 303 & 316 STAINLESS STEEL
- (3) 2 3/4 FOR COMMERCIAL BRASS

Model 1700

| MODEL | A | B | C (REF) | D | E | F HEX. | G JIC | H IJIC |
|-------|------|------|---------|-----|------|-------------|-------|--------|
| 1704 | 2.55 | .55 | 2.00 | .20 | .69 | 11/16 | 1/4 | 1/4 |
| 1706 | 2.93 | .56 | 2.37 | .28 | .94 | 13/16 | 3/8 | 3/8 |
| 1708 | 3.25 | .66 | 2.59 | .30 | .73 | 1 | 1/2 | 1/2 |
| 1710 | 3.91 | .76 | 3.15 | .34 | 1.09 | 1 1/8 | 5/8 | 5/8 |
| 1712 | 4.47 | .86 | 3.61 | .41 | 1.27 | 1 7/16 (1) | 3/4 | 3/4 |
| 1716 | 5.19 | .91 | 4.28 | .53 | 1.41 | 1 13/16 (2) | 1 | 1 |
| 1720 | 6.54 | .96 | 5.58 | .73 | 2.00 | 2 5/8 (3) | 1 1/4 | 1 1/4 |
| 1724 | 6.66 | 1.08 | 5.58 | .73 | 2.00 | 2 5/8 (3) | 1 1/2 | 1 1/2 |
| 1732 | 8.52 | 1.33 | 7.19 | .94 | 2.50 | 3 1/2 | 2 | 2 |

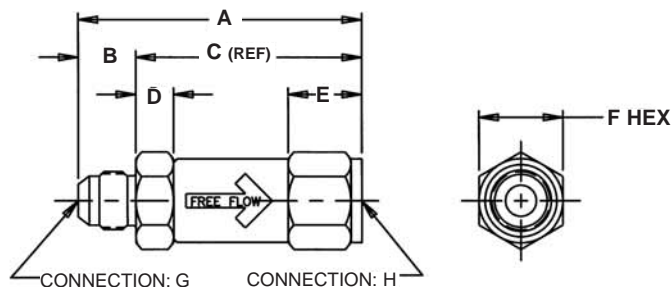

NOTES BELOW REFER TO COLUMN "F"

- (1) 1 1/2 FOR 316 STAINLESS STEEL
- (2) 1 7/8 FOR 303 & 316 STAINLESS STEEL
- (3) 2 3/4 FOR COMMERCIAL BRASS

Model 1900

| MODEL | A | B | C (REF) | D | E | F HEX. | G IJIC | H IJIC |
|-------|------|---|---------|------|------|-------------|--------|--------|
| 1904 | 2.40 | - | - | .60 | .69 | 11/16 | 1/4 | 1/4 |
| 1906 | 2.68 | - | - | .58 | .94 | 13/16 | 3/8 | 3/8 |
| 1908 | 2.98 | - | - | .68 | .73 | 1 | 1/2 | 1/2 |
| 1910 | 3.58 | - | - | .77 | 1.09 | 1 1/8 | 5/8 | 5/8 |
| 1912 | 4.13 | - | - | .93 | 1.27 | 1 7/16 (1) | 3/4 | 3/4 |
| 1916 | 4.70 | - | - | .95 | 1.41 | 1 13/16 (2) | 1 | 1 |
| 1920 | 5.83 | - | - | .99 | 2.00 | 2 5/8 (3) | 1 1/4 | 1 1/4 |
| 1924 | 6.10 | - | - | 1.25 | 2.00 | 2 5/8 (3) | 1 1/2 | 1 1/2 |
| 1932 | 7.44 | - | - | 1.19 | 2.50 | 3 1/2 | 2 | 2 |

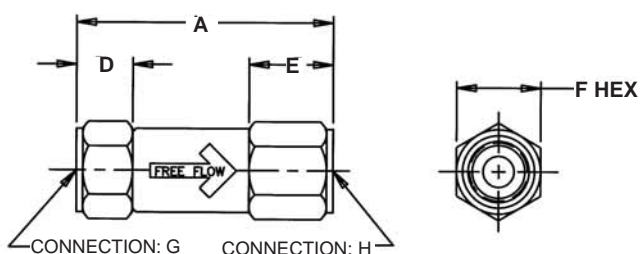

NOTES BELOW REFER TO COLUMN "F"

- (1) 1 1/2 FOR 316 STAINLESS STEEL
- (2) 1 7/8 FOR 303 & 316 STAINLESS STEEL
- (3) 2 3/4 FOR COMMERCIAL BRASS

ALL DIMENSIONS (IN INCHES) ARE FOR REFERENCE ONLY.

Consult Factory or Distributor for more help. Customer/user is solely responsible to select products suitable for their specific application requirements and to ensure proper installation, operation and maintenance of these products. Improper selection or use of products can cause personal injury or property damage. All sales are subject to Kepner Products Company Standard Terms and Conditions of Sale. Design subject to change without notice.

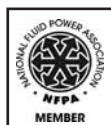

995 N. Ellsworth Avenue
Villa Park, IL 60181
Phone: 630-279-1550
FAX: 630-279-9669
www.kepner.com



KEPNER
PRODUCTS COMPANY