



WITH FAITH & LIGHT, WE BUILD TOGETHER

Multi-Purpose Hall & Capital Campaign Preview

OUR PROJECTS:

Illuminating Possibility

A New Multi-Purpose Hall for Our Parish Family

We are building a 16,000-square-foot Multi-Purpose Hall — a bright, welcoming space designed to serve every generation at St. Clare.

What our new hall will include:

- » Stadium seating for 700 people
- » Seating for 320 people at 40 round tables
- » Full gymnasium with regulation-size sport court
- » 24-foot ceilings with retractable bleachers
- » Elevated stage with vesting area / green room
- » Two flex meeting rooms seating up to 194 people
- » 1,200-square-foot commercial kitchen
- » Welcoming lobby with accessible restrooms
- » Concessions stand
- » Built-in storage throughout

WHY THIS MATTERS:

Our 71 ministries currently share tight or limited spaces. This new hall creates room to grow, gather and welcome.

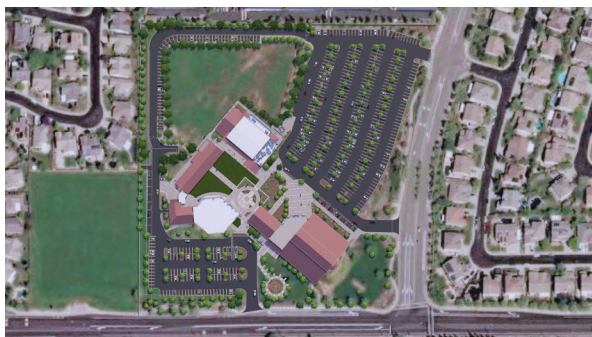
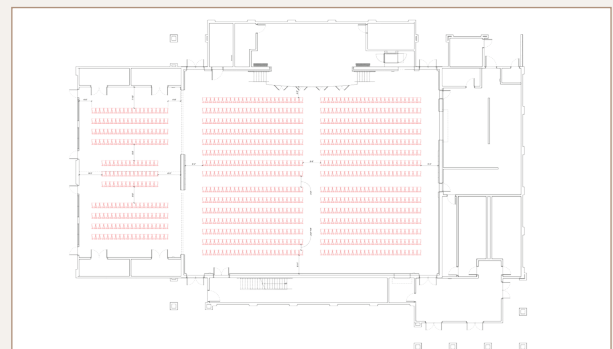
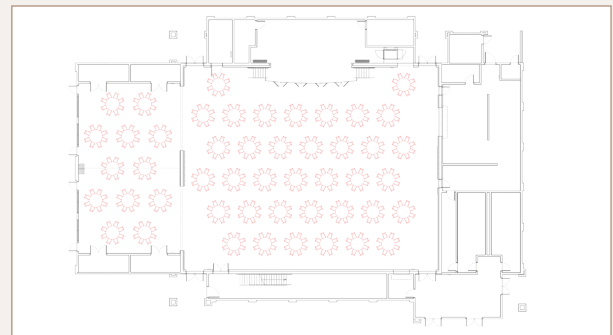

Campus Improvements:

- » New loop road connecting North and South parking lots
- » 56 new parking spaces
- » Improved traffic flow
- » Environmentally efficient design with solar offsets
- » Sustainable landscaping

*This project is not just about adding space.
It is about making room for people — and letting our parish shine.*

SHINING FORWARD:

Our New Hall as a Light for St. Clare

St. Clare is full of faith, families, and life. As our parish continues to grow, we are called to plan wisely and joyfully for the future.

Our new Multi-Purpose Hall will:

- » Support 71 ministries and many more to come
- » Give youth and young adults a place to belong
- » Welcome new families searching for a spiritual home
- » Create space for parish-wide prayer, learning and celebration
- » Strengthen our works of mercy and provide outreach to the broader Roseville area

This project is about more than a building. It is about making room for people and letting our parish shine.



OUR TIMELINE: *From Spark to Shine*

NOW



Learn about the project and pray about your part!

NEXT 3 WEEKS



Time for reflection and questions!

MARCH 7/8



We Kick off the Campaign – All are invited to our Celebration after each Mass!

AUGUST 2026



Construction Begins (anticipated)



FREQUENTLY ASKED QUESTIONS

What is a pledge?

A pledge is a promise to give a gift over time.

How long is the pledge period?

Pledges for our capital campaign may be fulfilled over four years.

Do I have to give a certain amount?

No. Every family will be invited to pray and give an amount that is meaningful to them.

Is this the same as weekly offertory?

No. Weekly offertory supports parish operating needs. Funds raised through the capital campaign will only be used to support this building project.

What if I can only give a small amount?

Every gift matters. Together, many gifts make a big difference.

Learn More or Connect With Us

We would love to walk with you and answer any questions you may have.

Scan the QR code to learn more about the Multi-Purpose Hall, see project updates, the capital campaign, and explore ways to participate.



 StClareRoseville.org/Multi-Purpose-Hall

 capcampaign@stclareroseville.org

 916-772-4717 x 131

Regina Jiron,
Capital Campaign Coordinator