

## Accent 100 Trimless Concrete Fixed Type 3

100 10 0123 --,---

Power	8W
Voltage	240V-AC
Class	III
Ingress Protection	IP20

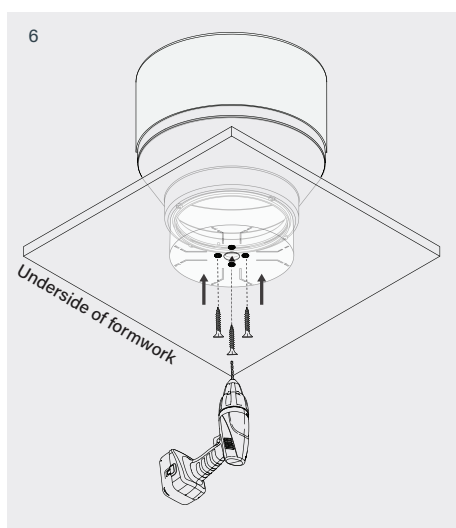
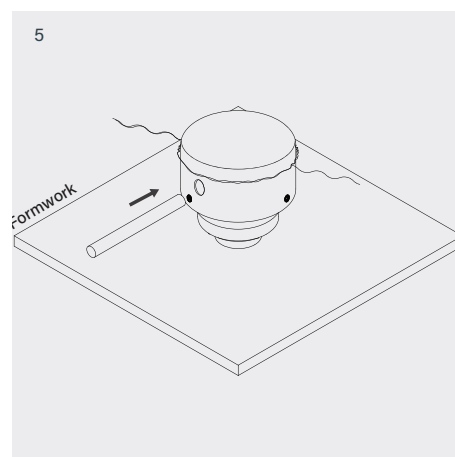
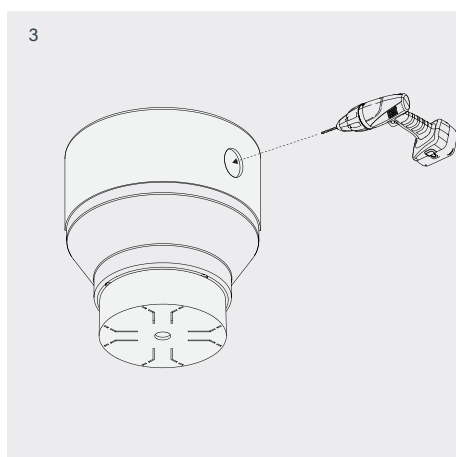
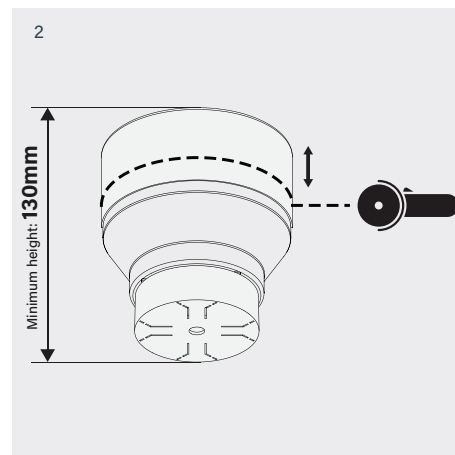
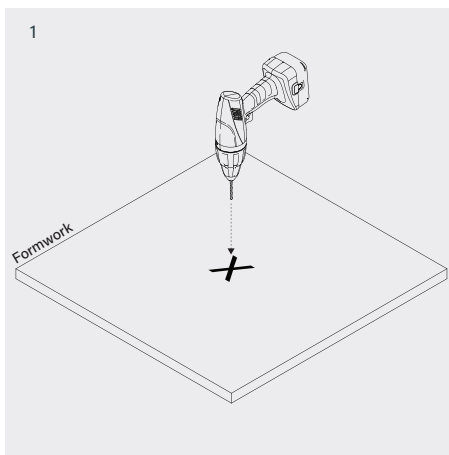
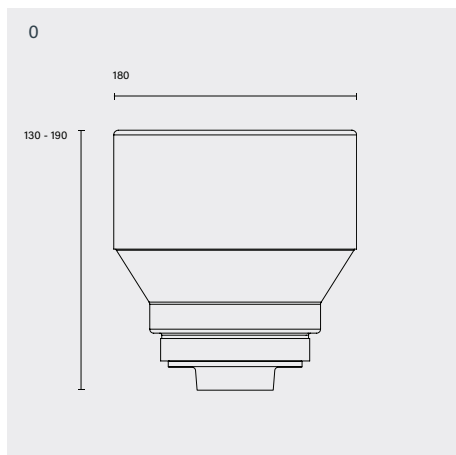

### Installation before concrete pour

- 1 Mark desired placement of light fitting and drill a location mark from the top of the formwork.
- 2 Mark height of light fitting. Cut to size if needed. If needed adjust by trimming to required height. **MINIMUM HEIGHT: 130MM**
- 3 To reduce stress on Plastic block mark and drill holes for conduits, before fixing the assembly to the formwork.
- 4 Fix and seal cover to body with screws. Seal openings with silicone.
- 5 Install conduit to concrete kit cover. Apply silicone to conduit hole.  
Tie down concrete kit to rebar with tie wire.  
**APPLY RELEASE AGENT ON PLASTIC BLOCKOUTS.**
- 6 Fix concrete kit by screwing block to formwork with mounting screws **FROM THE UNDERSIDE OF THE FORMWORK.**

## Accent 100 Trimless Concrete Fixed Type 3

100 10 0123 --,---

Power	8W
Voltage	240V-AC
Class	III
Ingress Protection	IP20

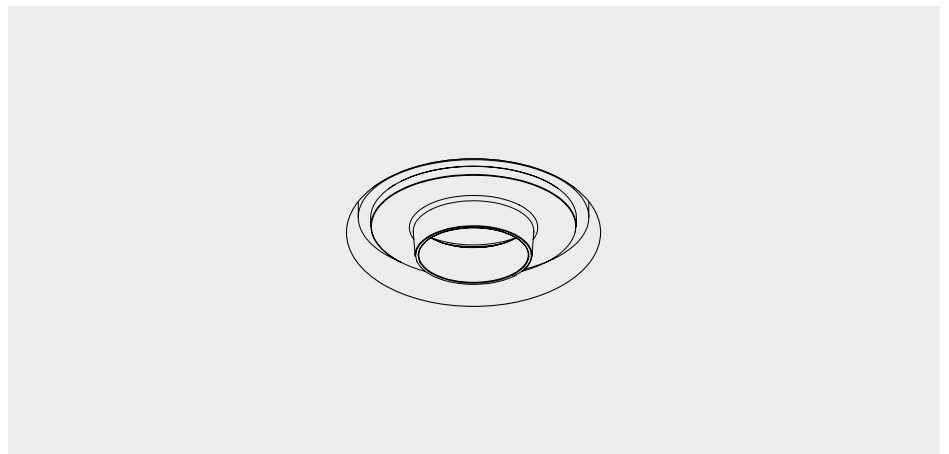
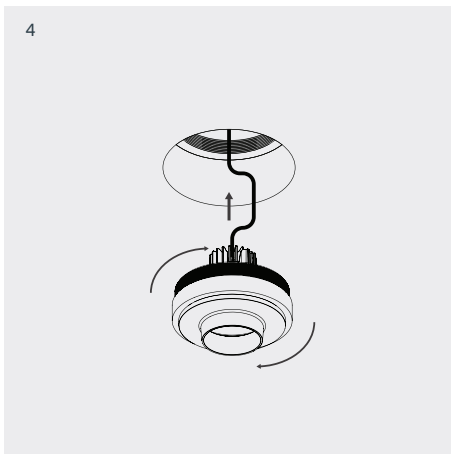
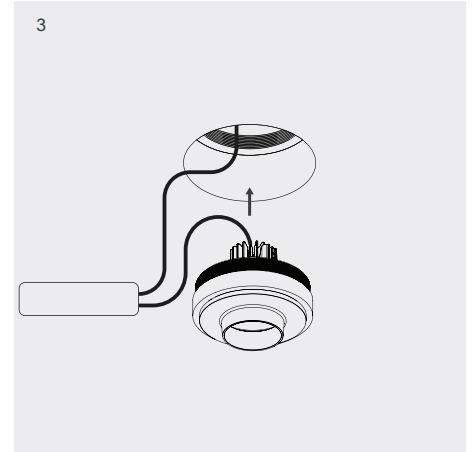
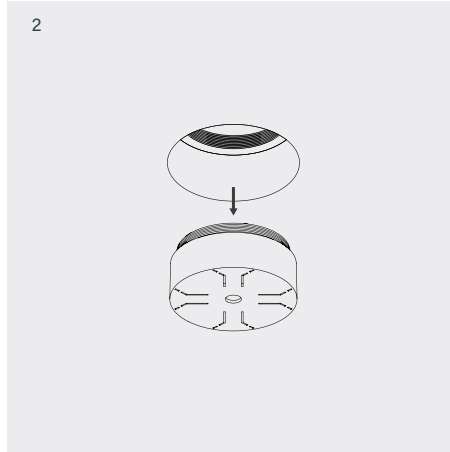
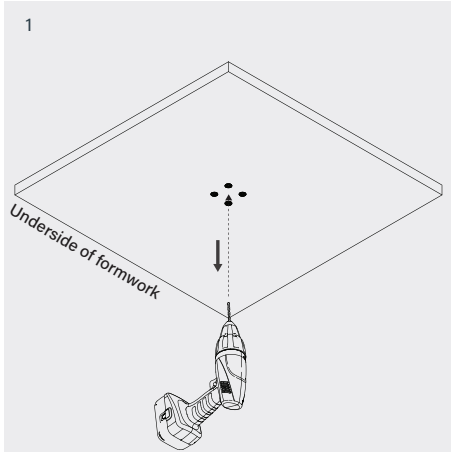

### Installation after concrete pour

- Once concrete has set, remove screws from the underside of the forwork before removing the forwork.  
**DO NOT REMOVE FORMWORK WITHOUT REMOVING THE SCREWS SECURING THE BLOCK.**  
Removing the forwork without removing the screws securing the block will cause the block to break.
- Remove the Block.
- Insert driver into concrete kit and attach it to cover with tape.
- Thread fitting into concrete kit.