

Accent 100 Trimless Asymmetrical Type 2

100 10 0052 --,---

Power	8W
Voltage	240V-AC
Class	III
Ingress Protection	IP20
Cut-Out	Ø130 x 130mm Depth

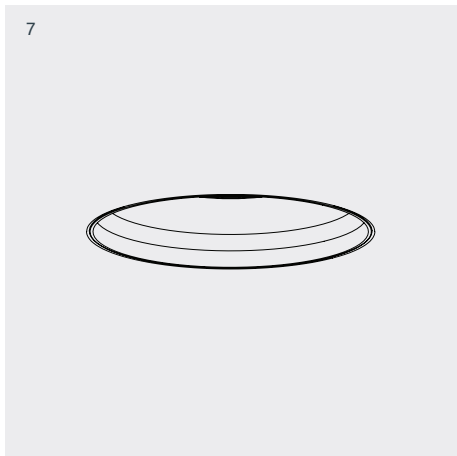
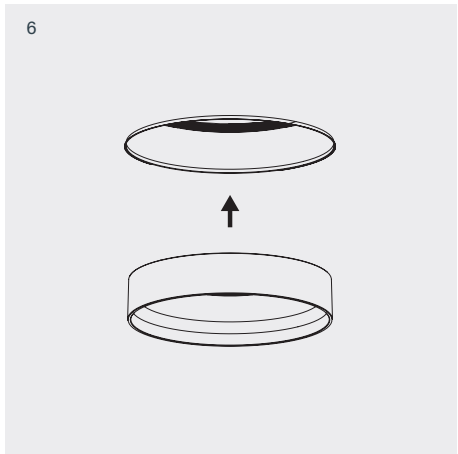
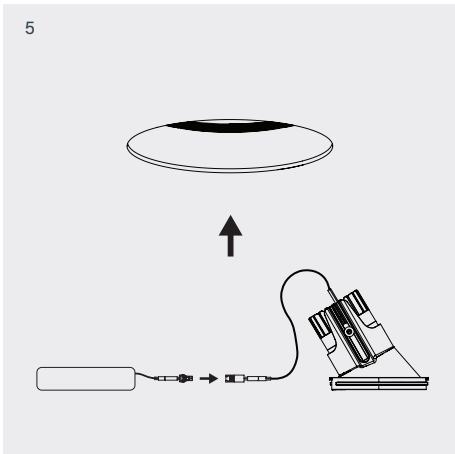
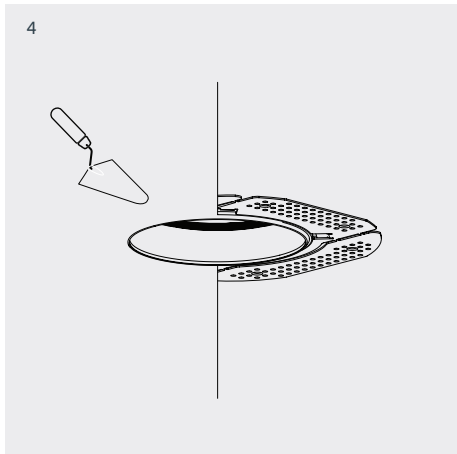
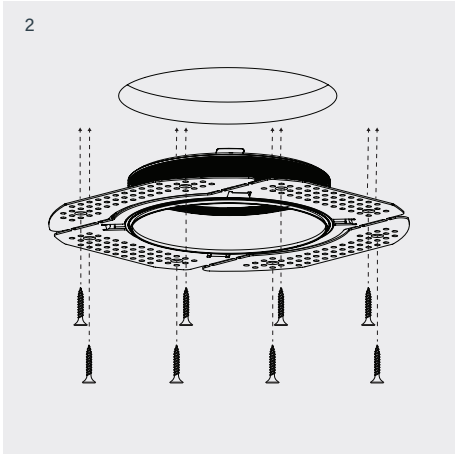
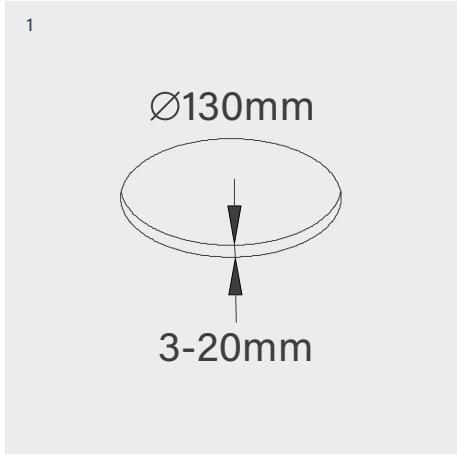

Installation below plasterboard

- 1 Cut 130mm diameter aperture.
- Lorem ipsum**
- 2-3 Adjust recessing kit face to appropriate depth and secure with locking screw located on the back of the housing. Screw recessing kit into plasterboard.
- 4 Plaster to edge of recessing kit.
- 5 Plug driver into luminaire and mount in recessing kit by lining up tabs on housing with tabs on recessing kit.
- 6 Screw facade into recessing kit.

## Accent 100 Trimless Asymmetrical Type 2

100 10 0052 --, ---

<b>Power</b>	8W
<b>Voltage</b>	240V-AC
<b>Class</b>	III
<b>Ingress Protection</b>	IP20
<b>Cut-Out</b>	Ø130 x 130mm Depth

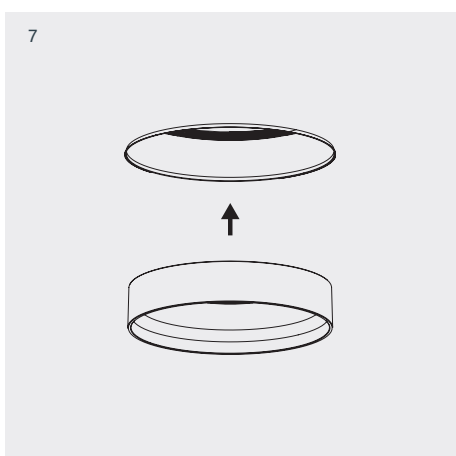
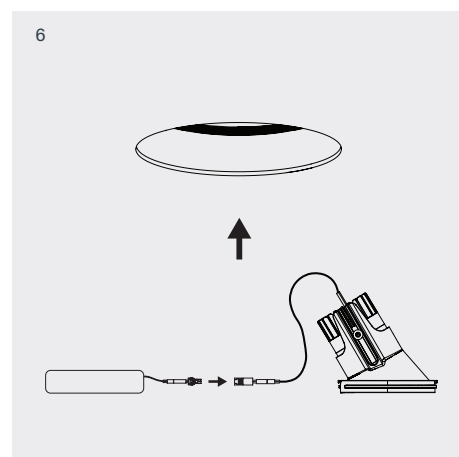
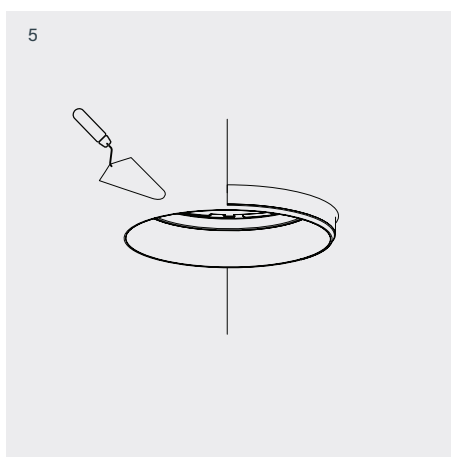
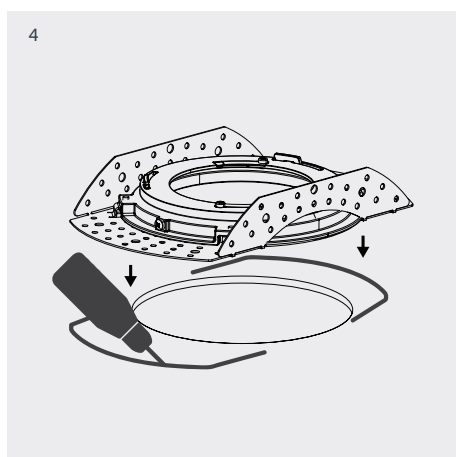
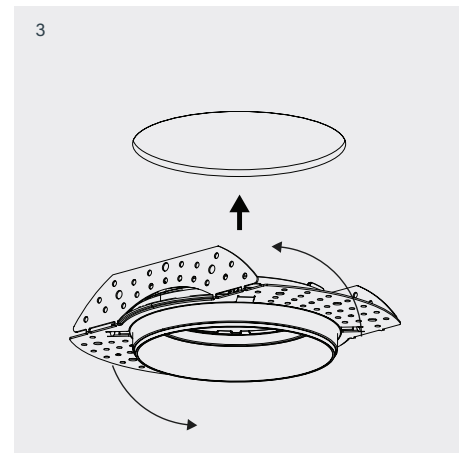
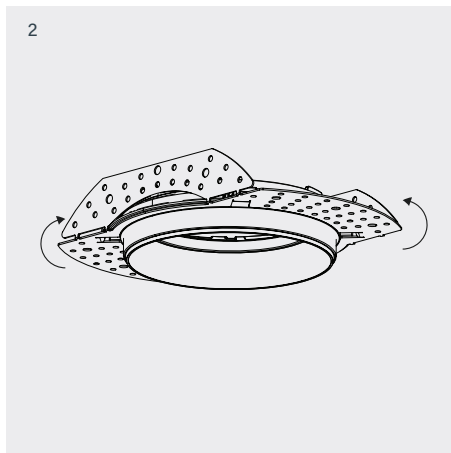
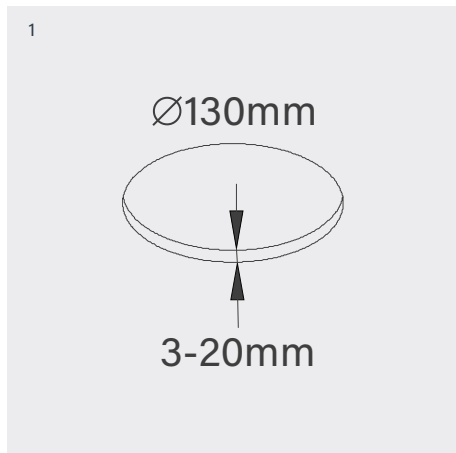

- Installation above plasterboard**
- 1 Cut 130mm diameter aperture.
  - 2 Adjust recessing kit face to appropriate depth and secure with locking screw located on the back of the housing. Fold back recessing kit mount's flaps.
  - 3 Rotate recessing kit and insert into the aperture.
  - 4 Apply liquid nails to secure recessing kit to plasterboard.
  - 5 Plaster to edge of recessing kit.
  - 6 Plug driver into luminaire and mount in recessing kit by lining up tabs on housing with tabs on recessing kit.
  - 7 Screw facade into recessing kit.