

SAU TECH'S AETA PARKING LOT

SOUTHERN ARKANSAS UNIVERSITY TECH
CAMDEN, ARKANSAS

PROJECT INFORMATION

DRAWINGS AND PROJECT MANUAL APPROVED AND IDENTIFIED AS PARTS OF THE OFFICIAL CONTRACT DOCUMENT

OWNER: SOUTHERN ARKANSAS UNIVERSITY TECH
FACILITY: SAU TECH'S AETA PARKING LOT
LOCATION: CAMDEN, ARKANSAS

BY: _____
DATE: _____

CONTRACTOR: --
ADDRESS: --
BY: _____
DATE: _____

ARCHITECT: LEWIS, ELLIOTT, McMORRAN, VADEN,
RAGSDALE, & WOODWARD INCORPORATED
ADDRESS: 11225 HURON LANE, SUITE 104
LITTLE ROCK, ARKANSAS 72211
BY: _____
DATE: _____

PROJECT NUMBER: 28030
DRAWINGS AND PROJECT MANUAL DATED: 2026 06-12

ABBREVIATIONS

AFF ABOVE FINISH FLOOR
AT ALUMINUM THRESHOLD
CEJC CEILING EXPANSION JOINT COVER
CJ CONTROL JOINT
CLG CEILING
CONC CONCRETE
CONT CONTINUOUS
DTL DETAIL
FD FLOOR DRAIN
FEC FIRE EXTINGUISHER CABINET
FEJ FLOOR EXPANSION JOINT
FLR FLOOR
GB GRAB BAR
MECH MECHANICAL
NHO NORMALLY HELD OPEN
NTS NOT TO SCALE
OPG OPENING
REQ REQUIRED
SHT SHEET
SIM SIMILAR
STO STORAGE
TYP TYPICAL
WEJC WALL EXPANSION JOINT COVER

VICINITY MAP

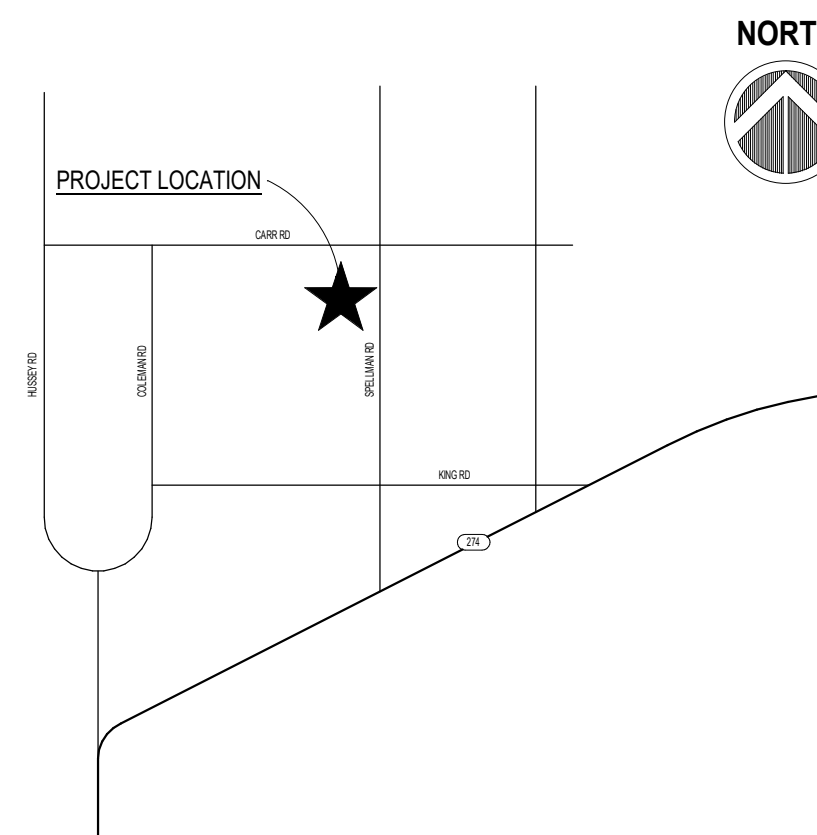

MATERIAL LEGEND

	CMU (PLAN)
	MASONRY (PLAN)
	METAL STUD FRAMING (PLAN)
	GYPSUM PANELS
	WOOD BLOCKING CONTINUOUS (SECTION)
	WOOD BLOCKING AS NEEDED (SECTION)
	WOOD FINISHED FACE OR SOLID WOOD
	WOOD PLYWOOD (SECTION)
	CONCRETE (SECTION)
	RIGID INSULATION (SECTION)
	BATT INSULATION (SECTION)
	FILL MATERIAL (SECTION)
	REPLACED SOIL (SECTION)

SYMBOL LEGEND

	DOOR MARK, SEE DOOR SCHEDULE
	CASEWORK ELEVATION MARK
	WINDOW / STOREFRONT FRAME MARK
CLASSROOM	ROOM NAME
	ROOM NUMBER
	ROOM CEILING HEIGHT
	CEILING FINISH
	DETAIL / SECTION NUMBER
	SHEET NUMBER

INDEX OF DRAWINGS

T1.1 TITLE SHEET

ARCHITECTURAL

A0.1 ARCHITECTURAL SITE PLAN
A0.2 SITE DETAILS

CERTIFICATION STATEMENT:

I HEREBY CERTIFY THAT THESE PLANS AND SPECIFICATIONS HAVE BEEN PREPARED BY ME, OR UNDER MY SUPERVISION. I FURTHER CERTIFY THAT TO THE BEST OF MY KNOWLEDGE THESE PLANS AND SPECIFICATIONS ARE AS REQUIRED BY LAW AND IN COMPLIANCE WITH THE "ARKANSAS FIRE PREVENTION CODE" FOR THE STATE OF ARKANSAS.

LEWIS, ELLIOTT, McMORRAN, VADEN, RAGSDALE, & WOODWARD, INCORPORATED

PAVING LEGEND

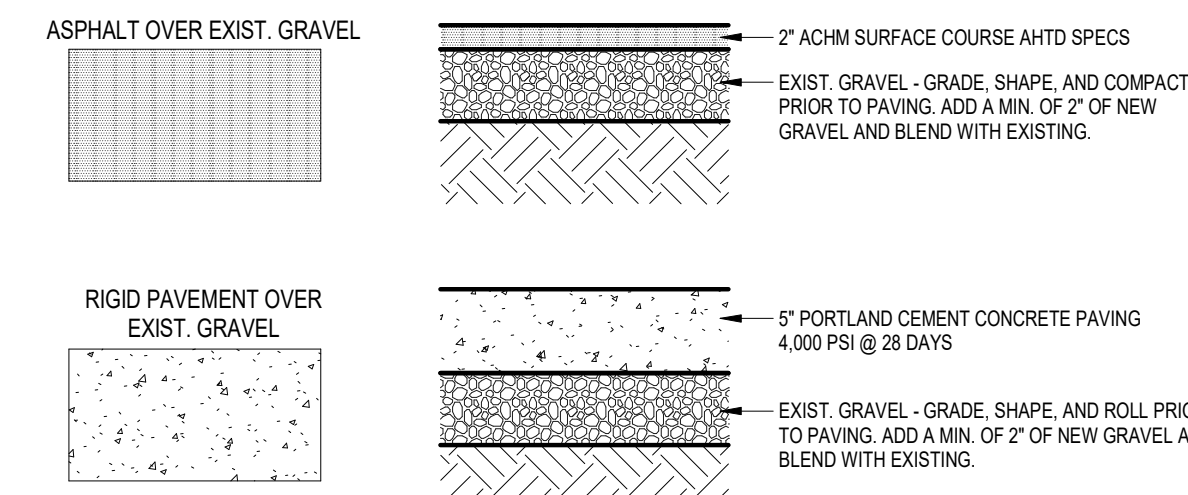

GENERAL SITE NOTES

1. ALL WORK AND MATERIALS SHALL COMPLY WITH ALL CITY/COUNTY REGULATIONS AND CODES AND O.S.H.A. STANDARDS.
2. THE SITE WORK FOR THIS PROJECT SHALL MEET OR EXCEED THE "PROJECT SPECIFICATIONS".
3. CONTRACTOR SHALL BE RESPONSIBLE FOR ALL RELOCATIONS, (UNLESS OTHERWISE NOTED ON PLANS) INCLUDING BUT NOT LIMITED TO, ALL UTILITIES, STORM DRAINAGE, SIGNS, ETC. AS REQUIRED. ALL WORK SHALL BE IN ACCORDANCE WITH GOVERNING AUTHORITIES REQUIREMENTS AND PROJECT SPECIFICATIONS AND SHALL BE APPROVED BY SUCH. ALL COSTS SHALL BE INCLUDED IN BASE BID.
4. ALL DIMENSIONS ARE TO THE FACE OF CURB UNLESS OTHERWISE NOTED.
5. ALL PAVING TO BE STANDARD DUTY ASPHALTIC CONCRETE PAVING UNLESS OTHERWISE NOTED.
6. ALL NEW PARKING SPACES ARE TO BE PAINTED WITH 4" SINGLE WHITE SOLID LINES UNLESS OTHERWISE NOTED.
7. ALL HANDICAP SPACES ARE TO RECEIVE A HANDICAP SIGN (SIGN R7-8 PER FEDERAL MANUAL ON TRAFFIC CONTROL DEVICES). PAINTED ACCESSIBLE SYMBOLS SHALL BE INSTALLED IN ALL HANDICAP SPACES AS SHOWN ON THE PLANS. HANDICAP SPACES AND SYMBOLS SHALL BE PAINTED BLUE OR PER LOCAL CODE.
8. ALL TRAFFIC SIGNAGE, PAVEMENT MARKINGS, AND PARKING LOT STRIPING SHALL CONFORM TO THE MANUAL ON UNIFORM TRAFFIC CONTROL DEVICES (MUTCD) REQUIREMENTS.
9. ALL DISTURBED AREAS ARE TO RECEIVE FOUR (4) INCHES OF TOPSOIL, SEED, MULCH AND WATER UNTIL A HEALTHY STAND OF GRASS IS ESTABLISHED.
10. PATCH AND REPAIR EXISTING PAVING WHERE DISTURBED BY NEW CONSTRUCTION BEYOND SAW-CUT JOINT FOR NEW CONSTRUCTION.
11. SITE BOUNDARY, TOPOGRAPHY, UTILITY AND ROAD INFORMATION WAS TAKEN FROM A SURVEY BY JOHNSTON SURVEYING OF ROLAND, ARKANSAS.

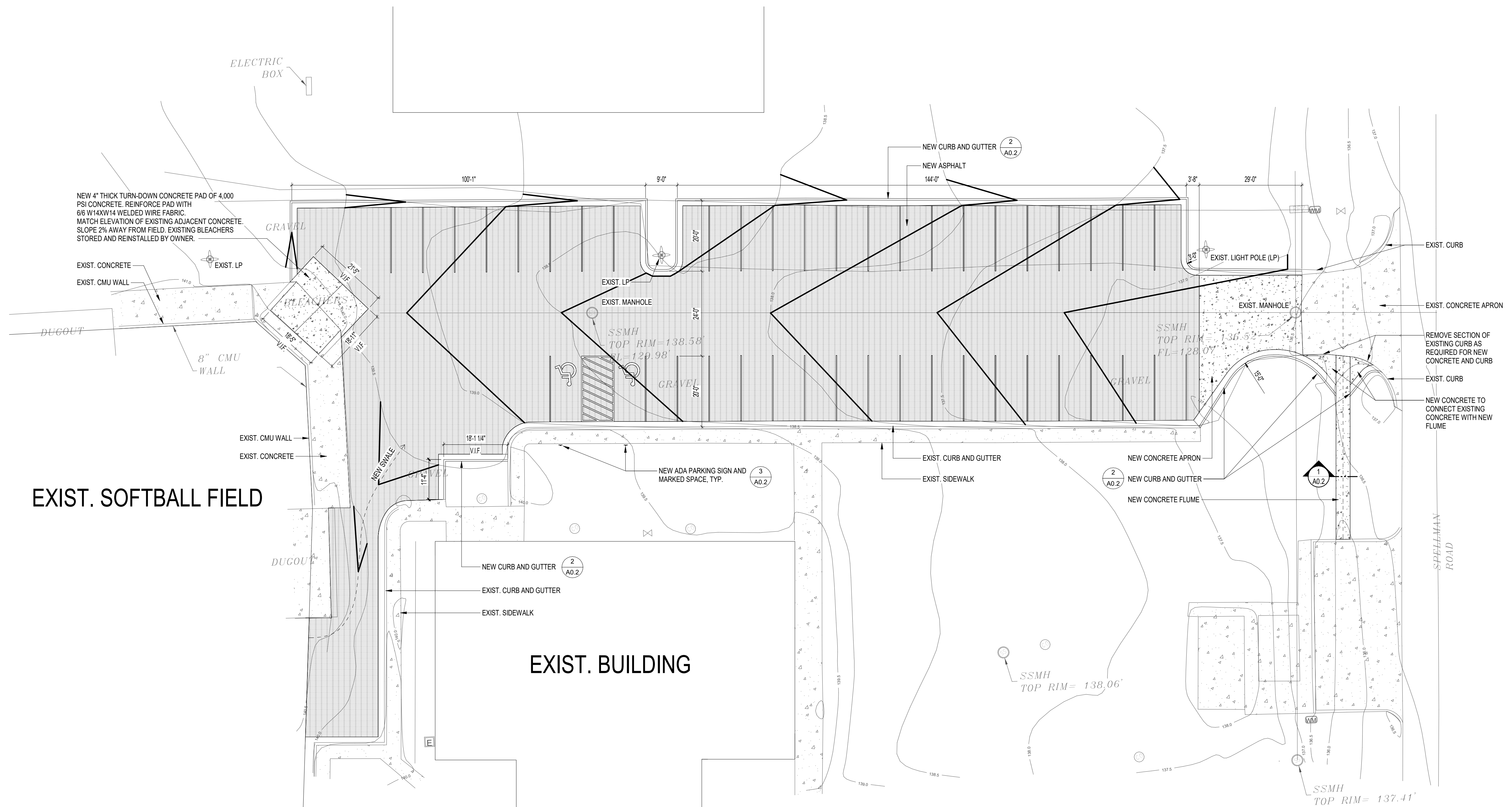

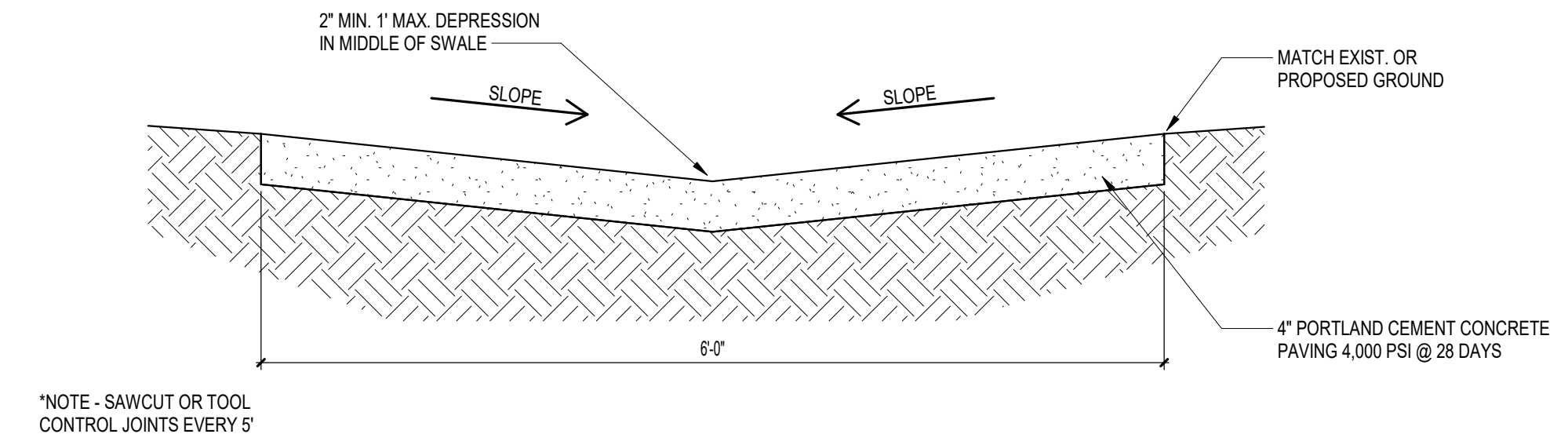

1
A0.2 CONCRETE FLUME (GREEN SPACE) DETAIL
1" = 1'-0"

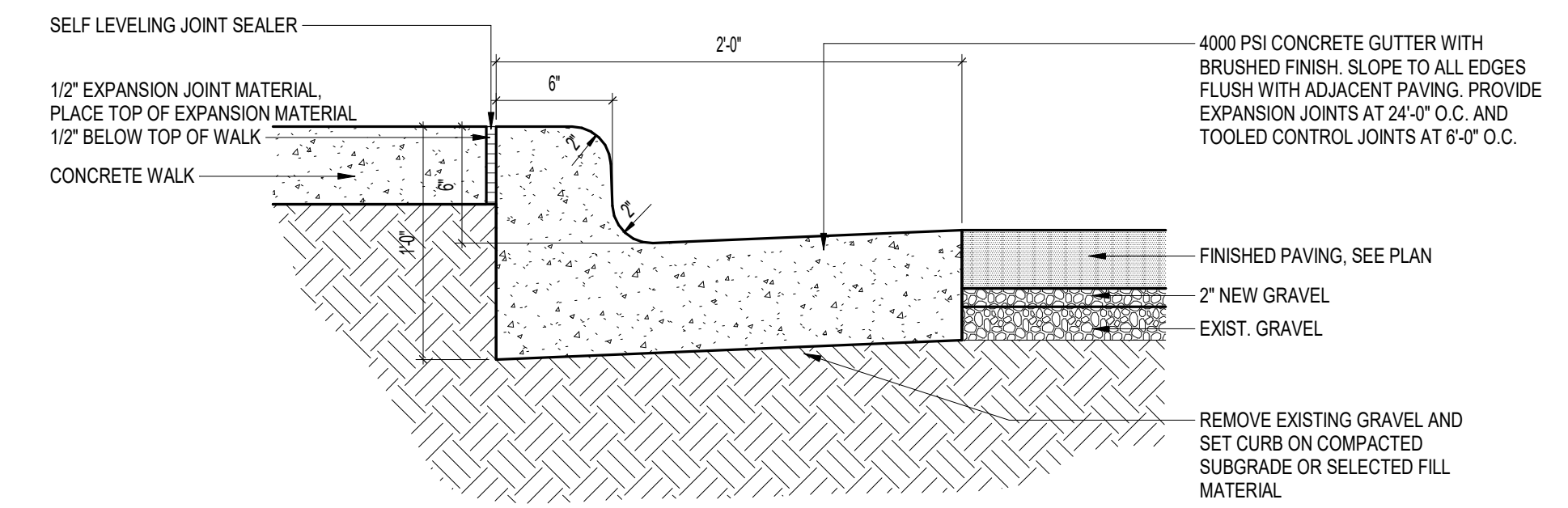

2
A0.2 TYPICAL CURB AND GUTTER DETAIL
1 1/2" = 1'-0"

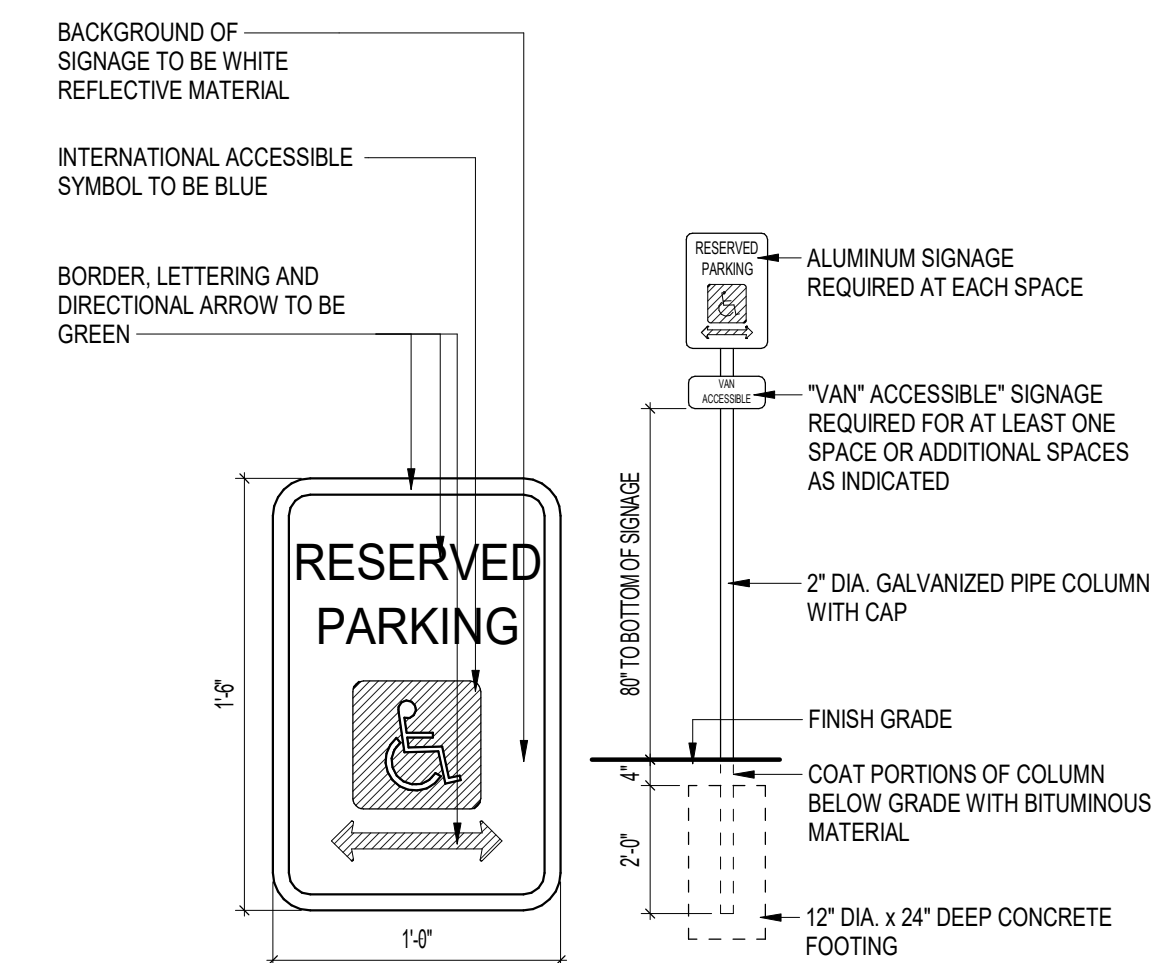

3
A0.2 ADA SIGN DETAIL
1 1/2" = 1'-0"